

## Solving Minor Problems Yourself

| Problem  | Possible Causes  | Solution  |
|--|--|---|
| Iron does not work or is not heating up              | Temperature control (H) set to minimum   | Turn the temperature control to the desired position  |
|  | Connection problems  | Check that the plug is inserted into the mains socket correctly   |
| Iron is not steaming                                 | There is no water in the tank  | Fill the water tank   |
|  | The steam regulator (C) is in the "0" position   | Set the steam regulator to the corresponding position   |
| Water is dripping from the holes in the soleplate    | The temperature control (H) is set too low for the iron to produce steam.  | Set the temperature control within the steam "☁️" area, between "••" and "max" or turn the steam regulator (C) to "0" |
|  | You have pressed the shot of steam button (A) repeatedly without waiting for 5 seconds between each press        | Wait 5 seconds between each press of the jet of steam button  |
|  | Water has been left in the tank (J) when the soleplate was cold, with the steam regulator (C) in 1 or 2 position | Always empty the tank after ironing and set the steam regulator to "0" after ironing and when filling the tank        |
| Deposits come out through the holes in the soleplate | Traces of lime scale from the steam chamber  | Carry out a cleaning cycle - see "Multiple de-scaling system" section of the instructions for use                     |

You can download this manual from the local homepages of Bosch

Thank you for buying the TDA23 steam iron from Bosch. This iron has a lightweight design and is built to perform.

These instructions contain valuable information about the unique features of this iron and some hints to make ironing easier for you.

**Please visit [www.bosch-home.co.uk](http://www.bosch-home.co.uk) for more product information or to register your product, just follow the link to the Online guarantee registration.**

## Before using the Iron for the first time

### Please carry out the following steps:

1. Remove the protective cover from the soleplate before using the iron.
2. While the iron is unplugged, fill the water tank (J) with tap water
3. Plug the appliance into the mains and set the temperature control (H) to the "max" position by lining it up with the pointer (G).
4. When the iron has reached the correct temperature (the pilot lamp (K) goes out), set the steam regulator (C) to the "2" position by lining it up with the pointer (D).
5. Hold the iron horizontally and repeatedly press the shot of steam button (A). Any residue should come out of the soleplate (I). It may smoke and smell – this is normal and will cease after a short while.
6. If necessary, carefully clean the soleplate down with a dry, folded cloth.

## Cleaning and Maintenance

### ⚠ Attention ! Risk of burns !

For general cleaning, follow the information below:

| Problem                                     | Solution  |
|---|---|
| Dirty/lightly marked iron body or soleplate | Clean the body of iron or soleplate with a damp cloth then dry it.  |
| Mark develops on soleplate during use       | Set the iron to its maximum temperature setting. Rub the iron a few times over with a dry cotton cloth folded several times.                        |
| Heavily stained soleplate                   | While the iron is cold, iron a linen cloth soaked in white vinegar. Then dampen a cloth with water and wipe the soleplate clean and dry thoroughly. |

**DO NOT** de-scale or clean the water tank with cleaning products or solvents, as these could cause the iron to drip when using the steam function.

**DO NOT** use a "professional steam cleaner" for cleaning the appliance.

**DO NOT** use sharp objects or abrasive products to clean the soleplate or any other part of the appliance. To keep the soleplate in good condition, do not allow it to come into contact with metal objects.

## BOSCH

### Customer Service

#### Great Britain

Bosch Customer Service  
Grand Union House  
Old Wolverton Road  
Milton Keynes  
MK12 5PT

UK +44 (0)844 892 8923  
IRL +353 (0)1450 2655

[www.bosch-home.co.uk](http://www.bosch-home.co.uk)

004 TDA23..GB/07/12

## GUARANTEE TERMS

The terms of the guarantee for this appliance are in accordance with that stated by our representative for the country in which it is sold. Details of those conditions can be obtained from the retailer from whom the appliance was purchased. The SALES RECEIPT must be presented when making any claims against the terms of this guarantee. We reserve the right to make technical modifications.

## Environmental Care

This iron has been designed according to ecological criteria, related to the sustainable development, analysing its whole lifecycle - from material selection to its later reuse or recycling - evaluating the improvement possibilities, from a technical, economical and environmental point of view.

Before throwing a used appliance away, you should make it noticeably inoperable e.g. cut off the mains lead and be certain to dispose of it in accordance with current laws and regulations. Your retailer, town council or local council can give you detailed information about these.



**This appliance is labelled in accordance with European Directive 2002/96/EG concerning used electrical and electronic appliances (waste electrical and electronic equipment - WEEE).**

**The guideline determines the framework for the return and recycling of used appliances as applicable throughout the EU.**

## Important

**This appliance has been designed exclusively for domestic use and must not be used for industrial purposes. Carefully read through the operating instructions for the appliance and safeguard them for future reference.**

## General safety instructions

- The iron must not be left unattended while it is connected to the supply mains.
- Remove the plug from the socket before filling the appliance with water or before pouring out the remaining water after use.
- The appliance must be used and placed on a stable surface.
- When placed on its stand, make sure that the surface on which the stand is placed is stable.

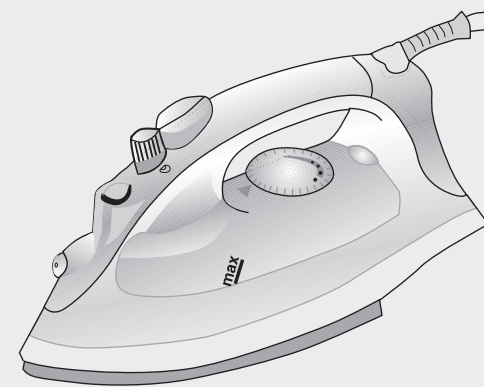

TDA 23..



## Operating instructions

- The iron should not be used if it has been dropped, if there are visible signs of damage or if it is leaking water. It must be checked by an authorized Technical Service Centre before it can be used again.
- With the aim of avoiding dangerous situations, any work or repair that the appliance may need, e.g. replacing a faulty mains cable, must only be carried out by qualified personnel from an Authorised Technical Service Centre.
- This appliance can be used by children aged from 8 years and above and persons with reduced physical, sensory or mental capabilities or lack of experience and knowledge if they have been given supervision or instruction concerning use of the appliance in a safe way and understand the hazards involved. Children shall not play with the appliance. Cleaning and user maintenance shall not be made by children without supervision.
- Keep the iron and its cord out of reach of children less than 8 years of age when it is energized or cooling down.

- This appliance is to be connected and used in accordance with the information stated on its characteristics plate.
- This appliance must be connected to an earthed socket. If it is absolutely necessary to use an extension cable, make sure that it is suitable for 16A and has a socket with an earth connection.
- If the safety fuse fitted in the appliance blows, the appliance will be rendered inoperative. To restore normal operation the appliance will have to be taken to an authorised Technical Service Centre.
- In order to avoid that, under unfavourable mains conditions, phenomena like transient voltage drops or lighting fluctuations can happen, it is recommended that the iron is connected to a power supply system with a maximum impedance of 0.27Ω. If necessary, the user can ask the public power supply company for the system impedance at the interface point.
- The appliance must never be placed directly under the tap to fill the water tank.
- Unplug the appliance from the mains supply after each use, or if a fault is suspected.
- The electrical plug must not be removed from the socket by pulling the cable.
- Never immerse the iron in water or any other fluid.
- Do not leave the appliance exposed to weather conditions (rain, sun, frost, etc.)

## Using Your Iron

### 1 Your iron

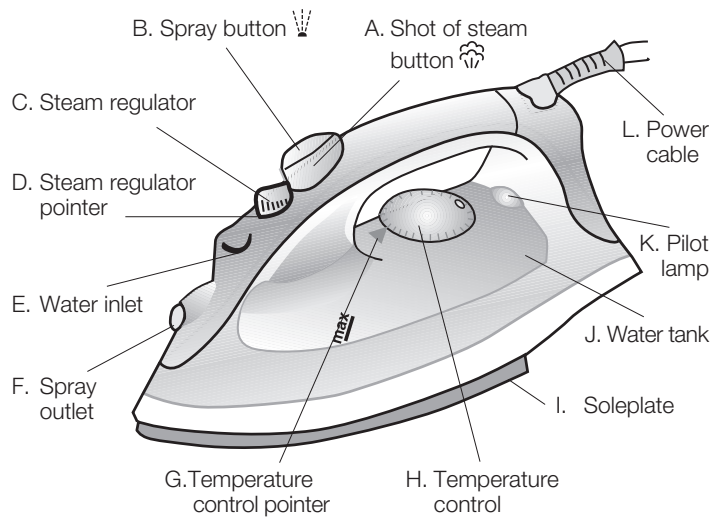

### 2 Filling the water tank

**i** Set the steam regulator (C) to the «0» position and unplug the iron from the mains!

1. Place the iron at an angle of 45°
2. Fill the tank but never above the “max” mark

Use only clean water from the tap and do not mix anything with it. The addition of other liquids, such as perfume, will damage the appliance.

Do not use condensation water from tumble dryers, air conditioners or similar appliances. This appliance has been designed to use normal tap water.

To prolong the optimum steam function it is possible to mix tap water with distilled water 1:1. If the tap water in your district is very hard, mix tap water with distilled water 1:2.

You can inquire about the water hardness with your local water supplier.

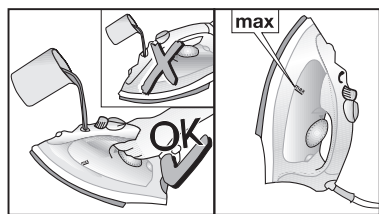

### 7 Vertical steaming with shot of steam

**This can be used to remove creases from hanging clothes, curtains etc. It cannot be used on a synthetic setting for delicate items.**

**WARNING!** Do not use vertical steam while the item is being worn. Never spray or aim steam at people or animals!

1. Make sure that there is water in the tank (J).
2. Set the temperature control (H) to the «•••» or «max» position and the steam regulator (C) to the «2» position.
3. Hold the iron in an upright position about 15 cm away from the garment being steamed.
4. Press the shot of steam button (A) on the handle at intervals of 5 seconds. However, after 4 jets of steam, wait for 10 seconds to allow for continued steam production.

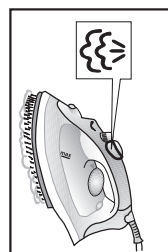

### 8 Ironing without steam

**This function enables the iron to be used for dry ironing.**

1. Set the steam regulator (C) to the «0» position.
2. Select an appropriate temperature for the type of material being ironed.



### 3 Setting the temperature

**The temperature control (H) adjusts the temperature of the soleplate (I).**

1. Check the temperature instructions shown on the care label of the garment you are ironing and set the temperature control (H) to the corresponding position by lining it up with the pointer (G) on the iron:

| Fabric         | Temperature Setting |
|----------------|---------------------|
| Synthetics     | •                   |
| Silk - Wool    | ••                  |
| Cotton - Linen | •••                 |



2. If you are unsure what type of material the garment is made from, start ironing on the lowest temperature setting and increase accordingly. If the garment is made from mixed fabrics, set the temperature for the most delicate material.
3. Sort your garments based on their care labels, always starting with clothes that have to be ironed at the lowest temperature.
4. The pilot lamp (K) will stay lit while the iron is heating up and go out once the selected temperature has been reached. Wait a few seconds after the lamp goes out before you start ironing. Once the iron is ready, you can continue to iron even if the pilot lamp comes on again.

### 4 Ironing with steam

**The steam regulator (C) is used to adjust the amount of steam produced when ironing.**

1. Make sure that there is water in the tank (J).
2. Adjust the temperature setting and then set the steam regulator according to the table below. Steam will automatically be produced:

| Temperature Setting | Steam Regulator Setting |
|---------------------|-------------------------|
| “to” max •••        | 2                       |
| ••                  | 1                       |

### 9 Spray

**This can be used to remove stubborn wrinkles.**

1. Do not use the spray function with silk as staining may occur.
2. Make sure that there is water in the tank (J).
3. When ironing, press the spray button (B) and water will spray out of the spray outlet (F) onto the garment.

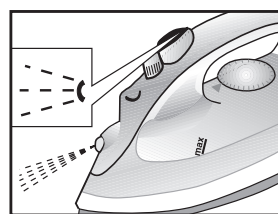

### 10 After finishing each ironing session

1. Unplug the iron from the mains socket.
2. Set the steam regulator (C) to the «0» position.
3. Hold the iron with the point facing down and shake it gently until all the water has come out.
4. Set the iron aside in a vertical position to cool down.
5. Coil the power cable (L) loosely around the heel of the iron, before storing.
6. Store the iron in an upright position.

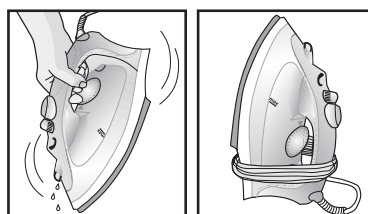

### 11 Multiple de-scaling system

**This range of irons is equipped with the following de-scaling features “AntiCalc”.**

#### A. self-clean

Each time you use the steam regulator (C), the “self-clean” system cleans the mechanism of any scale deposits.

#### B. calc'n clean

The “calc'n clean” function helps to remove scale particles out of the steam chamber. Use this function approximately every 2 weeks, if the water in your area is very hard.

Note: At a temperature setting of “•”, the soleplate is not hot enough to produce steam so the steam regulator should be set to the «0» position to avoid water dripping from the soleplate (I).

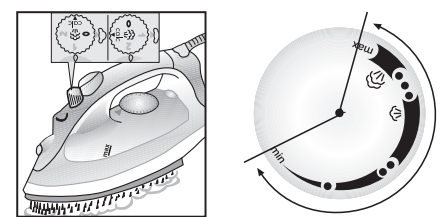

### 5 Ironing with shot of steam

**This can be used to remove stubborn wrinkles or to press in a sharp crease or pleat. It cannot be used on a synthetic setting for delicate items.**

1. Set the temperature control (H) to the “•••” or “max” position.
2. Set the steam regulator (C) to the «2» position.
3. Press the shot of steam button (A) on the handle repeatedly at intervals of 5 seconds.

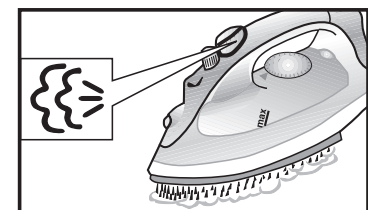

### 6 Extra steam

To facilitate the ironing of very creased laundry or thick materials, the volume of steam can be increased briefly. To do this, set the temperature regulator to “max.”. Press and hold the steam regulator (C) for a maximum of 2 seconds.

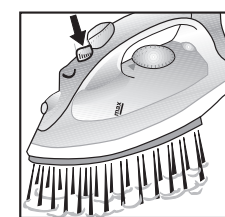

Fill the water tank, set the temperature dial (H) to the “max” position and plug in the iron.

After the necessary warm-up period, unplug the iron and hold it over a sink. Take out the steam regulator (C) by turning it to the position “calc” while pressing it. Gently shake the iron. Boiling water and steam will come out, carrying scale or deposits that might be there. When the iron stops dripping, reassemble the steam regulator in reverse order and move it to the «0» position. Heat up the iron again until the remaining water has evaporated.

If the steam regulator needle is soiled, remove any deposits from the needle tip with vinegar and rinse off with clean water.

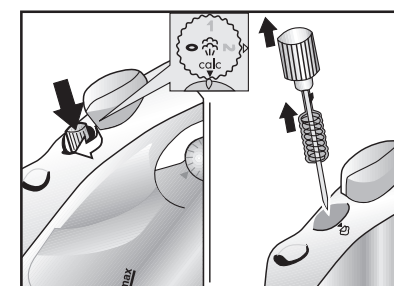

### Tips to help you save energy

Steam production consumes the most energy. To help minimise the energy used, follow the advice below:

- Start by ironing the fabrics that require the lowest ironing temperature.
- Regulate the steam according to the selected ironing temperature.
- Only use steam if necessary. If possible, use the spray function instead.
- Try to iron the fabrics while they are still damp and reduce the steam setting. Steam will be generated from the fabrics rather than the iron. If you tumble dry your fabrics before ironing them, set the tumble drier to the “iron dry” programme.
- If the fabrics are damp enough, turn off the steam regulator completely.
- Stand the iron upright during pauses. Resting it horizontally with the steam regulator on generates wasted steam.