

3**Fig 3**

Attach the long braces (F & G) to the base (A) using bolt set Q as shown. (Fig 3)

**Fig 4**

Attach the other ends of the two braces (F & G) to the lower frame (C) using bolt set M. (Fig 4)

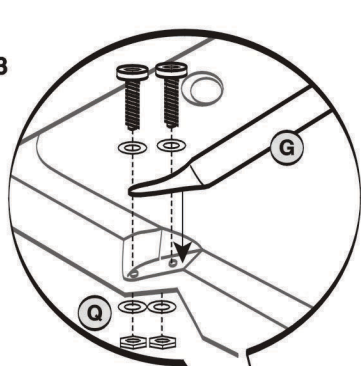
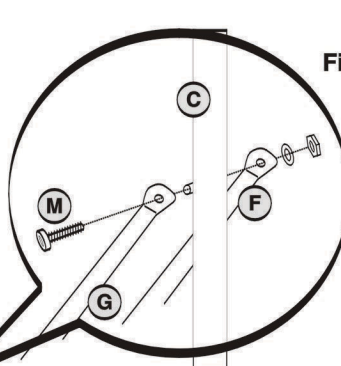

Connect L bracket "T" to the front of the frame as shown. Secure in place with the 2 nail keys (U).

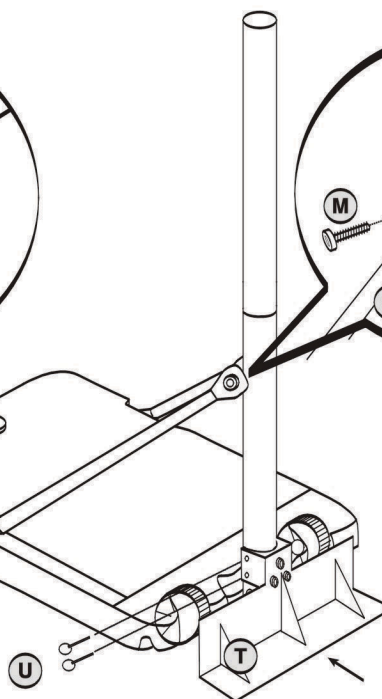
**4**

Attach the net (J) to the ring (H) by threading the net cord (R) through the LONG loops (Fig 5), starting at the rear of the ring. Space the loops evenly and tie the ends of the cord to the ring.

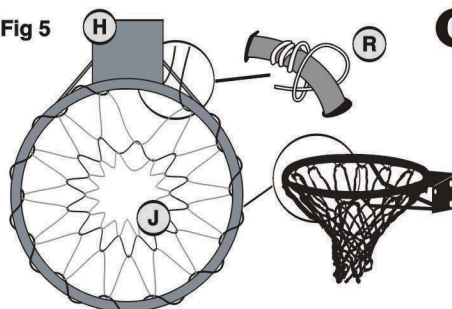
Fig 5**6**

WARNING: Please use a minimum of two adults who are capable of safely handling the weight of this unit to complete this step.

Carefully lower the assembled upper unit frame (B) onto the lower assembled frame tube (D) and lock in place by securing the grub screw S as shown. (Fig 8) Be careful to avoid finger entrapment.

5

Attach frame B to part E to be able to connect the backboard to the rest of the frame lock in place by securing the screw V as shown (Fig 6). Attach the assembled ring (H) backboard (I) and top frame (B) together using bolt set N through all four holes as shown. (Fig 7)

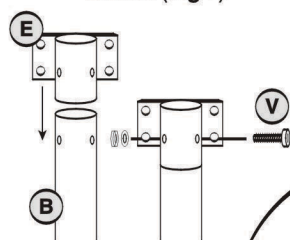
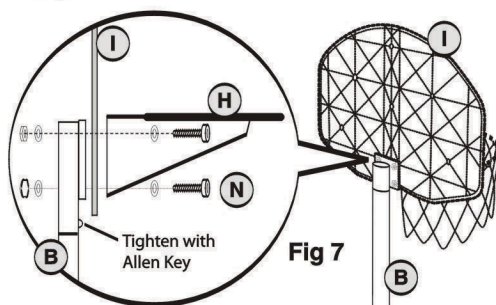
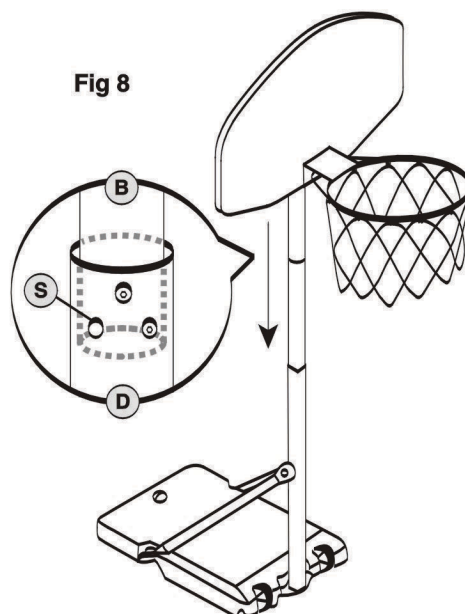
**Fig 6****Fig 7****Fig 8**

Debut Sports & Leisure Ltd
Unit 1.9 Paintworks, Bath road, Bristol BS4 3EH
Spare parts helpline: 0870 112 1928 Email: helpline@clickspares.co.uk
Please keep all the relevant information for future reference.



Made in China
Issue 3912/01

Carbrini Basketball Set Instructions

carbrini

Model No. 1428

Junior Basketball Set

Part List

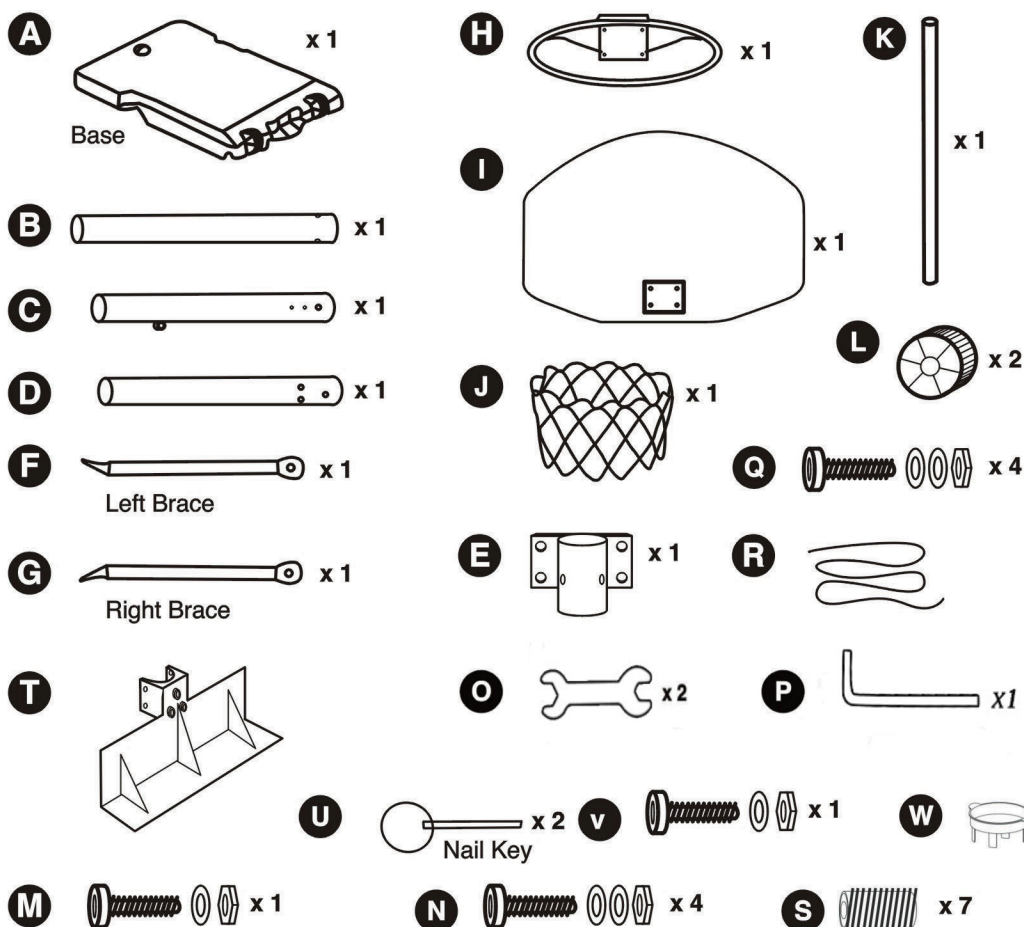

WARNING



- Do not hang or swing on the ring or use it to "Slam Dunk" or anything similar where you may touch the ring.

- This product should be assembled by two adults prior to use.
- The suppliers cannot accept responsibility for any damage caused to or by the product through misuse or incorrect installation.
- Please read the instructions carefully and check all component parts before assembly.
- Before assembly carefully choose the location of the finished unit. The chosen area should be flat, smooth and free from obstructions, gravel or sharp objects.
- The base should be fully filled with either water or sand before assembly.
- When moving the unit be careful not to cause damage by dragging the base.
- This equipment is for home use only and it is not designed or intended for formal matches or competition.
- Do not wear any type of jewellery (rings, watches, necklaces etc) while using this equipment. Such items can become caught against the rim or the net and cause serious injury.
- Do not use this equipment during severe weather conditions as the unit may fall over. When severe weather is expected adjust the unit to its lowest height and store in a safe and secure place.
- Check the equipment for loose and damaged parts prior to each use. If any problems are found discontinue use immediately.
- This equipment must be assembled, disassembled and moved by a minimum of two adults capable of safely handling the weight off the unit.



WARNING: CHOKING HAZARD-
This item contains small parts. Not suitable for children under 3 years old

ASSEMBLING THE BASE

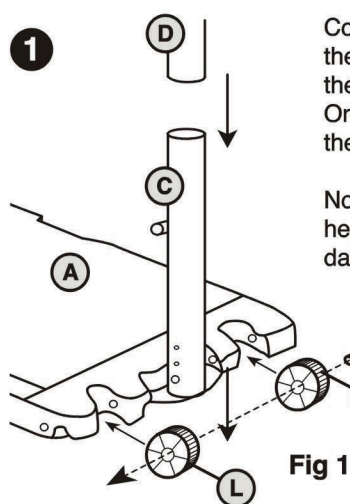

Connect parts **D** and **C** to make the frame and then connect **C** to the base (**A**) using axle **K** to attach the wheels (**L**) and frame to the base by slotting the axle through the holes as shown (**Fig 1**). Only allow part **D** to go into part **C** up to the white line drawn on the side of part **D** and screw in place.

Note: When adjusting tube heights, match with the white height lines drawn onto the poles. Exceeding this line may be dangerous.

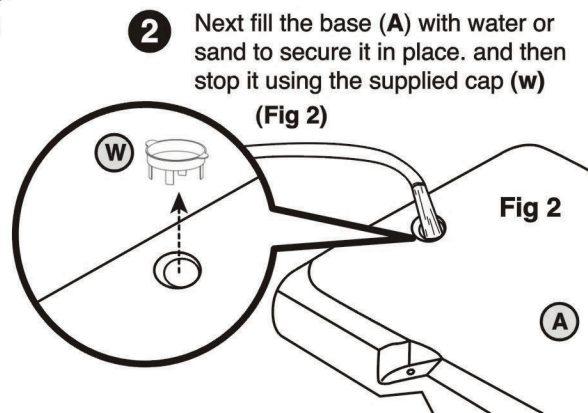

Next fill the base (**A**) with water or sand to secure it in place. and then stop it using the supplied cap (**W**)