

**18V**

# Cordless Hedge Trimmer

**HT04**

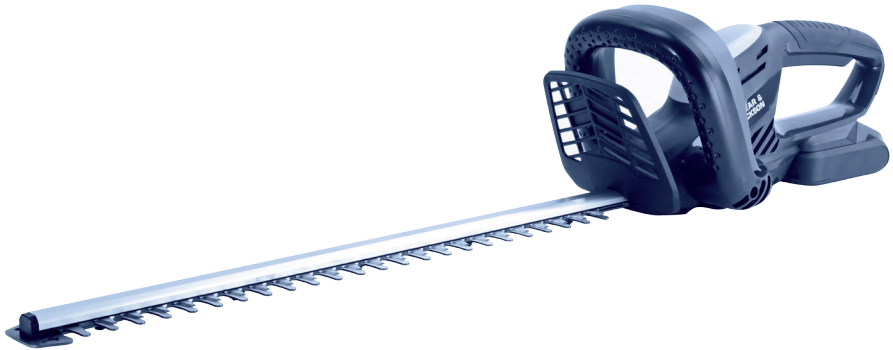

**Important - Please read these instructions  
fully before starting assembly**

These instructions contain important information that will help you get the best from your trimmer, ensuring it is assembled correctly and safely. If you need help or have damaged or missing parts, call the Customer Helpline on 0345 605 2067

**AFTER SALES SUPPORT  
0345 605 2067**

# SPEAR & JACKSON SINCE 1760

---

For more than 250 years gardeners have enjoyed high quality performance and great results using Spear & Jackson tools.

Our garden power tools combine continuous innovation and the latest in manufacturing technologies with a proud heritage.

Each product is carefully designed with performance, comfort and durability firmly in mind, which has earned Spear & Jackson an enviable reputation as a maker of tools to trust.

## 3 YEARS GUARANTEE

As a testament to the quality of our products, we offer a 3 year manufacturers warranty and a comprehensive after sales service.

The warranty covers manufacturing faults, however in the event that the item has been deliberately damaged, used in a commercial environment or disassembled then the warranty will be null and void.

Please retain proof of purchase.

## 7 DAYS A WEEK TECHNICAL SUPPORT

We want you to get the best out of your products. Our easy-to-read instruction manual guides you with best practice use and maintenance tips. Please call **0345 605 2067** for technical support, we can solve around 80% of questions directly over the phone.

We hope you enjoy your product and we look forward to any feedback, as this allows us to develop even better products for the future.

# CONTENTS

<b>Safety Information</b> .....	<b>04</b>
Description of symbols .....	04
General safety .....	05
Additional safety instructions for batteries and chargers .....	09
Additional safety instructions for hedge trimmer .....	13
Maintenance and storage safety .....	15
Intended use .....	16
<b>Box Content / Parts</b> .....	<b>17</b>
<b>Assembly</b> .....	<b>18</b>
Check battery capacity .....	18
Charging the battery .....	19
Unpacking .....	19
<b>Operation</b> .....	<b>22</b>
General operation .....	22
Switching on/off .....	22
Trimming times .....	22
Trimming .....	23
<b>Maintenance</b> .....	<b>25</b>
<b>Technical Data</b> .....	<b>28</b>
<b>Troubleshooting</b> .....	<b>30</b>
<b>Warranty</b> .....	<b>31</b>

# SAFETY INFORMATION

Please read these instructions fully before operating or maintaining your machine

## DESCRIPTION OF SYMBOLS

The following warning symbols appear throughout this manual and indicate the appropriate safety measures you should take when operating and maintaining the hedge trimmer.

## WARNING SYMBOLS ON THE MACHINE



**Read instruction handbook before operating this machine.**



### WARNING!

This is a warning symbol. This symbol is used throughout the user guide whenever there is a risk of personal injury. Ensure that these warnings are read and understood at all times.



**This symbol indicates the requirement of wearing ear.**



**Protection and eye protection when using the product.**



Keep bystanders away.



Disconnect the battery pack before any repair or maintenance.



Do not expose and operate the tool in rain.



Guaranteed sound power level value in 90dB.



Waste electrical products should not be disposed of with household waste. Please recycle where facilities exist. Check your Local Authority or retailer for recycling advice.



Conforms to all relevant safety standards.

## WARNING SYMBOLS ON THE CHARGER



Read instruction handbook before operating this machine.



The charger is for indoor use only.



Double insulation.



Pole orientation.

# SAFETY INFORMATION

Please read these instructions fully before operating or maintaining your machine



Waste electrical products should not be disposed of with household waste. Please recycle where facilities exist. Check your Local Authority or retailer for recycling advice.

## WARNING SYMBOLS ON THE BATTERY PACK



Batteries contain Li-ion, waste batteries should be sorted for eco-friendly. Do not dispose of waste batteries as unsorted municipal waste.



Do not dispose of batteries in rivers or immerse in water.



Do not dispose of in fire.



Do not subject the battery to strong sunlight over long periods and do not leave it on a heater (max.45 °C).



Do not dispose of batteries. Return exhausted batteries to your local collection or recycling point.

## GENERAL SAFETY



**WARNING!** Read all safety warnings and all instructions. Failure to follow the warnings and instructions may result in electric shock, fire and/or serious injury.

Save all warnings and instructions for future reference. The term “power tool” in all warnings listed below refers to your battery operated power tool.

- Read the instructions carefully. Be familiar with the controls and the correct use of the appliance. Read and understand the operator’s manual and observe the warnings and instruction labels affixed to the appliance.
- Users. Never allow children or people unfamiliar with these instructions to use the appliance. Local

# SAFETY INFORMATION

Please read these instructions fully before operating or maintaining your machine

regulations may restrict the age of operator. Never operate the tool under the influence of alcohol, medication or drugs.

- Do not operate power tools in explosive atmospheres, such as in the presence of flammable liquids, gases or dust. Power tools create sparks which may ignite the dust or fumes. Do not force the power tool. Use the correct power tool for your application. The correct power tool will do the job better and safer at the rate for which it was designed.
- Keep work area clean and well lit. Cluttered areas can cause accidents.
- Consider work area environment. Do not expose the tool to high humidity or rain. Do not use the tool in damp and wet conditions. Keep the work area well lit. Do not use the tool where there is a risk of causing fire or explosion, e.g. in the presence of flammable liquids and gases.
- Keep children and bystanders away while operating a power tool. Distractions can cause you to lose control. The operator or user is responsible for accidents or hazards occurring to other people or the property.
- Dress properly. Do not wear loose clothing or jewellery. Keep your hair, clothing and gloves away from moving parts. Loose clothes, jewellery or long hair can be caught in moving parts.
- Head protection. Always use safety glasses and gloves. Use a face or dust mask whenever the operations may produce dust or flying particles. Wear ear protection whenever the sound level

# SAFETY INFORMATION

Please read these instructions fully before operating or maintaining your machine

seems uncomfortable.

- Do not overreach. Keep proper footing and balance at all times. This enables better control of the power tool in unexpected situations
- Stay alert, watch what you are doing and use common sense when operating a power tool. Do not use a power tool while you are tired or under the influence of drugs, alcohol or medication. A moment of inattention while operating power tools may result in serious personal injury.
- Grip the tool securely. Operator should have one hand on the main handle, the other on the front handle. Keep finger off trigger until ready to use.
- Remove any adjusting key or wrench before turning the power tool on. A wrench or a key left attached to a rotating part of the power tool may

result in personal injury.

- Do not use the power tool if the switch does not turn it on and off. Any power tool that cannot be controlled with the switch is dangerous and must be repaired.
- Prevent unintentional starting. Ensure the switch is in the off-position before connecting to power source and/or battery pack, picking up or carrying the tool. Carrying power tools with your finger on the switch or energy sing power tools that have the switch on invites accidents.
- Check for damaged parts. Before further use, carefully check the tool for damage. Check for alignment of moving parts, binding of moving parts, breakage of parts, mounting and any other condition that may affect its operation. Do not use the tool if any parts are

# SAFETY INFORMATION

Please read these instructions fully before operating or maintaining your machine

damaged or defective. Have any damaged or defective parts repaired or replaced by an authorized service agent. Never attempt any repairs yourself.

- Store idle tools. When not in use, tools should be stored in a dry, locked-up place out of reach of children.
- Maintain tools with care. Keep tools clean and in good condition for better and safer performance. Follow the instructions for maintenance and changing accessories. Keep handles and switches dry, clean and free from oil and grease.
- Check for misalignment or binding of moving parts, breakage of parts and any other condition that may affect the power tool's operation. If damaged, have the power tool repaired before use. Many accidents are caused by

poorly maintained power tools.

- Have your tool repaired by an authorized service agent. This tool is manufactured in accordance with the relevant safety regulations. To avoid danger, electrical appliances must only be repaired by qualified technicians.
- Power tool plugs must match the outlet. Never modify the plug in any way. Do not use any adapter plugs with earthed (grounded) power tools. Unmodified plugs and matching outlets will reduce risk of electric shock.
- Avoid body contact with earthed or grounded surfaces, such as pipes, radiators, ranges and refrigerators. There is an increased risk of electric shock if your body is earthed or grounded.
- Do not expose power



# SAFETY INFORMATION

Please read these instructions fully before operating or maintaining your machine

tools to rain or wet conditions. Water entering a power tool will increase the risk of electric shock.

- Do not abuse the cord. Never use the cord for carrying, pulling or unplugging the power tool. Keep cord away from heat, oil, sharp edges or moving parts. Damaged or entangled cords increase the risk of electric shock.
- When operating a power tool outdoors, use an extension cord suitable for outdoor use. Use of a cord suitable for outdoor use reduces the risk of electric shock.
- If devices are provided for the connection of dust extraction and collection facilities, ensure these are connected and properly used. Use of dust collection can reduce dust-related hazards.



## WARNING!

Do not use any attachments or accessories not recommended by the manufacturer of this tool.

The use of attachments or accessories not recommended can result in serious personal injury.

## ADDITIONAL SAFETY INSTRUCTIONS FOR BATTERIES AND CHARGERS

### Batteries

- Never attempt to open for any reason.
- Do not expose to water.
- Do not incinerate the battery pack even if it is severely damaged or is completely worn out. The battery pack can explode in a fire.
- Do not store in locations

# SAFETY INFORMATION

Please read these instructions fully before operating or maintaining your machine

where the temperature may exceed 40 °C.

- Do not leave the battery pack in the charger when the charging is finished, otherwise battery leakage may occur.
- Charge only at room temperature.
- Recharge only with the charger specified by the manufacturer. A charger that is suitable for one type of battery pack may create a risk of fire when used with another battery pack.
- Before charging, make sure that the battery is dry and clean.
- Use power tools only with specifically designated battery packs. Use of any other battery packs may create a risk of injury and fire.
- When dispose of batteries follow the instructions given in the section “protecting the environment”.
- Under abusive conditions, liquid may be ejected from the battery; avoid contact. If contact accidentally occurs, flush with water. If liquid contacts eyes, additionally seek medical help. Liquid ejected from the battery may cause irritation or burns.
- The battery fluid, a 25-30% solution of potassium hydroxide, can be harmful. In case of skin contact, immediately rinse with water. Neutralize with a mild acid such as lemon juice or vinegar. In case of eye contact, rinse abundantly with clean water for at least 10 minutes. Consult a physician.
- When battery pack is not in use, keep it away from other metal objects, like paperclips, coins, keys, nails, screws or other small metal objects, that can make a connection

# SAFETY INFORMATION

Please read these instructions fully before operating or maintaining your machine

from one terminal to another. Shorting the battery terminals together may cause burns or a fire.

- **NOTE:** The batteries in your battery pack are the Lithium-Ion type. Do not dispose of battery packs/batteries into household waste, fire or water. Battery packs/batteries should be collected, recycled or disposed of in an environmentally-friendly manner.

## Chargers



### **WARNING!**

This appliance is not intended for use by persons (including children) with reduced physical, sensory or mental capabilities, or lack of experience and knowledge, unless they have been given supervision or instruction concerning

use of the appliance by a person responsible for their safety.

Children should be supervised to ensure that they do not play with the appliance.

- Before charging, ensure your charger is matching the local supply.
- Charger's plug must match the outlet. Never modify the plug in any way. Unmodified plug and matching outlets will reduce risk of electric shock.
- Use your charger only to charge batteries of the type supplied with your tool. Other batteries could burst, causing personal injury and damage.
- Only 2 battery packs are allowed to be charged continuously in order to prevent over heating of charger, necessary rest time is required to let the charger cool down before

# SAFETY INFORMATION

Please read these instructions fully before operating or maintaining your machine

further charging.

- When charging is finished, unplug the charger from mains socket outlet and takeaway the battery pack from the charger, do not leave the battery pack in the charger.
- Never carry the charger by its cord or pull it to disconnect from the socket. Keep the cord away from heat, oil and sharp edges.
- Never attempt to charge non-rechargeable batteries.
- Do not charge a leaking battery.
- The cord of the charger is not changeable, do not continue to use if the cord is damaged.
- Do not open the charger.
- Do not probe the charger.
- For indoor use, or do not expose to rain.
- Respect the polarity “+/-“ when charging.
- Ensure that the connection between the battery charger and battery is correctly positioned and is not obstructed by foreign bodies.
- Keep battery charger's slots are free of foreign objects and protect against dirt and humidity. Store in a dry and frost-free place.
- When charging batteries, ensure that the battery charger is in a well-ventilated area and away from inflammable materials. Batteries can get hot during charging. Do not overcharge any batteries. Ensure that batteries and chargers are not left unsupervised during charging.

# SAFETY INFORMATION

Please read these instructions fully before operating or maintaining your machine

## ADDITIONAL SAFETY INSTRUCTIONS FOR HEDGE TRIMMERS

- Keep all parts of the body away from the cutter blade. Do not remove cut material or hold material to be cut when blades are moving. Make sure the switch is off when clearing jammed material. A moment of inattention while operating the hedge trimmer may result in serious personal injury.
- Carry the hedge trimmer by the handle with the cutter blade stopped. When transporting or storing the hedge trimmer always fit the cutting device cover. Proper handling of the hedge trimmer will reduce possible personal injury from the cutting blades.
- Keep cable away from cutting area. During operation the cable may be hidden in shrubs and can be accidentally cut by the blade.
- Advice to check the hedge for foreign objects, e.g. wire fences.
- Hold the hedge trimmer properly, e.g. with both hands if two handles are provided
- Hold the power tool by insulated gripping surfaces only, because the cutting blade may contact hidden wiring. Cutting blades contacting a “live” wire may make exposed metal parts of the power tool “live” and could give the operator an electric shock.
- Check cutting blades regularly for damage, and if damaged repair immediately; check cable for damage before starting work and replace if necessary.
- Always ensure all handles and guards are fitted when using the tool.
- Do not use the machine

# SAFETY INFORMATION

Please read these instructions fully before operating or maintaining your machine

when it is raining or on wet hedges.

- Never allow children to use the tool.
- Choose a stable and safe position, especially on steps. When operating the machine take great care and always hold it firmly with both hands.
- Make yourself familiar with your working area and be alert for possible hazards, which you might not hear due to the motor noise.
- Never attempt to use a damaged or incomplete machine or one fitted with an unauthorized modification.
- Keep cutting tools sharp and clean. Properly maintained cutting tools with sharp cutting edges are less likely to bind and are easier to control.
- Use the power tool, accessories and tool bits etc. in accordance with these instructions, taking

into account the working conditions and the work to be performed. Use of the power tool for operations different from those intended could result in a hazardous situation

- Only use original spare parts and accessories supplied with the machine or recommended by the manufacturer.
- Always wear suitable clothing; anti-slip shoes and close-fitting garments, that cannot get caught, however do not restrict your movement. Tie long hair back or protect with a hair net. Do not wear bracelets or long jewelry which could get entangled in moving parts.
- Use personal protective equipment. Always wear eye protection. Protective equipment such as dust mask, non-skid safety shoes, hard hat, or hearing protection used for appropriate conditions will

# SAFETY INFORMATION

Please read these instructions fully before operating or maintaining your machine

reduce personal injuries.

- Within the working area, the person using the power tool is responsible for any damaged or injury sustained by third parties or their property, which has been caused by the power tool. Watch your working area and do not allow third persons or animals to be around.
- When operating the power tool take great care and always hold it firmly with both hands. Adopt a stable and safe position, especially on slopes.
- Never touch the unprotected blades and never carry the machine taking hold of the blades.

## MAINTENANCE AND STORAGE SAFETY

- Disconnect the product from the power supply

(i.e. remove the plug from the charger supply or the battery pack) and check for damage after use.

- Disconnect the plug from the power source and/or the battery pack from the power tool before making any adjustments, changing accessories, or storing power tools. Such preventive safety measures reduce the risk of starting the power tool accidentally.
- Inspect and maintain the product regularly. Have the product repaired only by an authorised service centre or similar qualified specialist.
- Store idle power tools out of the reach of children and do not allow persons unfamiliar with the power tool or these instructions to operate the power tool.
- Power tools are dangerous in the hands of untrained users.

# SAFETY INFORMATION

Please read these instructions fully before operating or maintaining your machine

- Have your power tools serviced by a qualified repair person using only identical replacement parts. This will ensure that safety of the power tool is maintained.

## INTENDED USE

This cordless hedge trimmer is designed for cutting and trimming of hedges, bushes and ornamental shrubs in the domestic environment.

For safety reasons it is essential to read the entire instruction manual before first operation and to observe all the instructions therein.

Any use of the machine that deviates from its intended use and is not included in these instructions is considered unauthorized use and relieves the manufacturer from his or her legal liability.



# BOX CONTENT

## PARTS

- |   |                     |    |                |
|---|---------------------|----|----------------|
| 1 | Main handle         | 7  | Trigger switch |
| 2 | Safety switch       | 8  | Charger        |
| 3 | Front handle        | 9  | Charger base   |
| 4 | Hand guard          | 10 | Battery pack   |
| 5 | Cutting blade       | 11 | Blade sheath   |
| 6 | Battery pack holder |    |                |

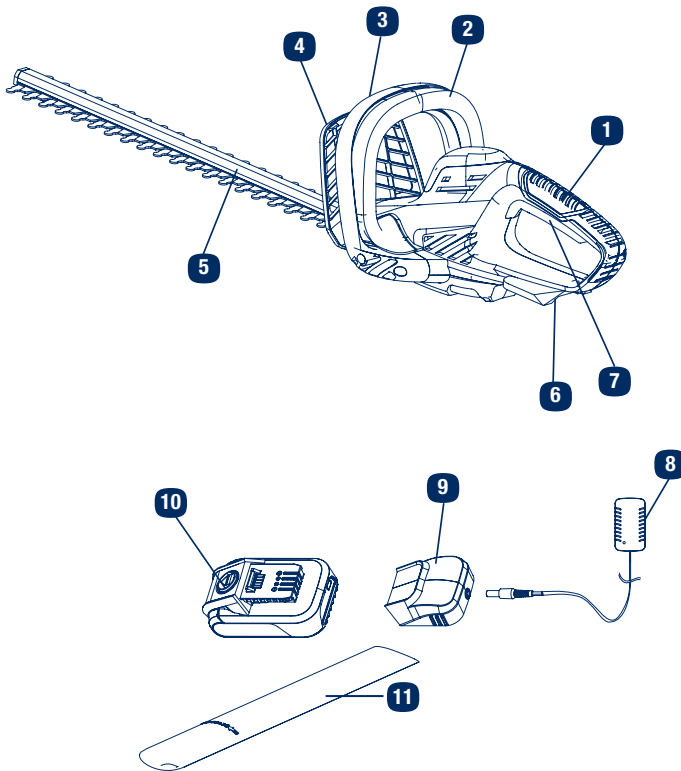

If there are any parts missing, please call the customer helpline on **0345 605 2067**

# ASSEMBLY

## 1 Unpacking

- i. Unpack all parts and lay them on a flat, stable surface.
- ii. Remove all packing materials and shipping devices if applicable.
- iii. Make sure the delivery contents are complete and free of any damage. If you find that parts are missing or show damage, do not use the product but contact the aftersales service within 28 days of purchase. Using an incomplete or damaged product represents a hazard to people and property.
- iv. Ensure that you have all the accessories and tools needed for assembly and operation. This also includes suitable personal protective equipment.

## 2 Check battery capacity

Push the power indicator button (A), the remaining percentage of battery capacity will show on screen.

**FU** means 100% fully charged.

### Insert the battery to product

- i. Keep the battery pack in line with the holder on the device.
- ii. Push it forward until it reaches the bottom. Before starting make sure the battery pack is firmly locked in place.

### Remove the battery from product

- i. Press the battery pack release button (B) downward,
- ii. Pull the battery pack towards operator, then remove it.

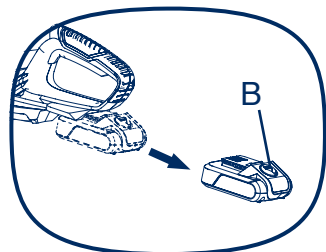
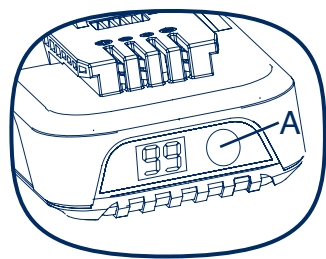



**Attention!** The battery cannot be charged immediately after use, it should cool off for a period of time. The LED lights switching from green to red means it can be charged.

### 3 Charging the battery



**NOTE:** This battery pack has been shipped in a low charge condition. It should be fully charged before first use. Make sure the main voltage is the same as rating label which located on the charger.

#### **WARNING!**

The charger and battery pack are specifically designed to work together so do not attempt to use any other devices. Never insert or allow metallic objects into your charger or battery pack connections because an electrical failure and hazard will occur. The battery needs to be charged before first use and whenever it fails to produce sufficient power on jobs that were easily done before.

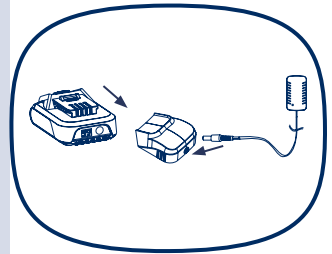

# ASSEMBLY

---

This product comes with a lithium ion battery pack. Lithium ion batteries don't lose charge when not in use, and don't lose charging capacity overtime. Never the less it is best practice to charge the battery when empty or insufficient to do the job.

## **Connect charger with charger base, and then plug the charger into mains.**

1. Plug the charger into an appropriate AC power outlet. The LED lights green to tell you that the charger is ready for use.
  2. Slide the charger base (9) into the battery pack(10), make sure the charger base is fully seated in the battery pack. The LED lights up red to tell you that the battery pack is on charge.
  3. The battery pack will be fully charged in 1 hour. And the LED lights up green again to tell you that the battery pack is fully charged.
- 
- 

## **Important charging notes**

Longest life and best performance can be obtained if the battery pack is charged at room temperature between 18-24°C. Do not charge the battery pack in a very low or very high air temperature. This is important and will prevent serious damage to the battery pack.

- When using your tool continuously, the batteries in your battery pack will become hot. You should let a hot battery pack cool down for approximately 30 minutes before attempting to recharge.
  - The charger and battery pack may become warm to touch while charging. This is a normal condition, and does not indicate a problem.
  - Use the charger in normal room temperatures whenever possible. To prevent overheating, do not cover the charger and do not charge battery packs in direct sunlight or near heat sources.
  - If the battery pack does not charge properly;  
(1).Check the main socket by plugging in a lamp or other
-

appliance.

(2). Move the charger and battery pack to a location where the surrounding air temperature is approximately 18-24°C.

(3). If charging problems persist, take or send the tool, battery pack and charger to your local service center.

- The battery pack should be recharged when it fails to produce sufficient power on jobs which were easily done previously. DO NOT CONTINUE to use under these conditions. Follow the charging procedure. You may also charge a partially used pack whenever you desire with no adverse effect on the battery pack.
- Under certain conditions, with the charger plugged in to the power supply, the exposed charging contacts inside the charger can be shorted by foreign material. Foreign materials of a conductive nature such as, but no limited to, steel wool, aluminum foil, or any buildup of metallic particles should be kept away from charger cavities. Always unplug the charger from the power supply when there is no battery pack in the cavity. Unplug charger before attempting to clean.
- Do not immerse charger in water or any other liquid.



## WARNING!

Don't allow any liquid to get inside charger. Electric shock may result. To facilitate the cooling of the battery pack after use, avoid placing the charger or battery pack in a warm environment such as in a metal shed, or an un-insulated trailer.



## CAUTION!

Never attempt to open the battery pack for any reason. If the plastic housing of the battery pack breaks or cracks, return to a service center for recycling; do not put it into further use.

# OPERATION

---

## General operation

- i. Check the product, its battery pack and charger as well as accessories for damage before each use. Do not use the product if it is damaged or shows wear.
  - ii. Double check that accessories are properly fixed.
  - iii. Always hold the product on its handles. Keep the handles dry to ensure safe support.
- 

## Switching on/off

**NOTE:** Hold the hedge trimmer away from yourself using both hands. Stand in a secure and stable position.

### To switch on

Pull up the trigger switch of the rear handle and, with your other hand, pull the safety switch simultaneously.

### To switch off

Release the trigger switch or the safety switch.

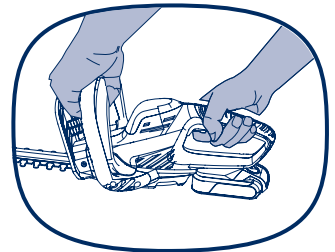

---

## Trimming times

Green leaf hedges	June to October
Evergreens	April and August
Conifers and other fast growing shrubs	every 6 - 8 weeks

---

# OPERATION

**NOTE:** Only operate the product during reasonable hours – not early in the morning, late at night or on weekends/ public holidays when people might be disturbed. Please check local restrictions.

## Trimming

- i. Cut and remove branches exceeding the cutting capacity of this product using a proper pruner before operation.
- ii. Move the cutting device lightly through the surface to be cut in a sweeping motion following the shape of the hedge or shrub.
- iii. A slight tilt downwards of the cutting device in the direction of motion is recommended for optimum cutting performance.
- iv. Do not rush and do not attempt to cut too much with one stroke of the cutting device.
- v. First cut both sides from the bottom cutting upwards to the top. This will prevent any of the trimmings falling into the path of the area still to be cut.



- vi. After cutting the sides proceed to the top. Try to keep the cutting device angled at approximately 15° to the cutting surface.

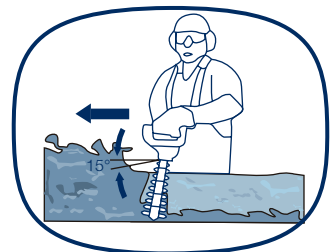

# OPERATION

---

- vii. Cut in a number of stages if the area being cut is particularly long to achieve a better result; smaller trimmings will allow for easy composting.

**NOTE:** When shaping it is advisable to achieve a trapezoidal shape. A trapezoidal cut corresponds to the natural growth of plants and results in optimal hedge growth, as it will expose more light to the lower end of the hedge.

---



# MAINTENANCE

---

This product does not contain any parts that can be repaired by the consumer. Contact an authorised service centre or a similarly qualified person to have it checked and repaired.



**WARNING! Always switch the product off, Pull out the battery pack and let the product cool down before performing inspection, maintenance and cleaning work!**

- Regular and proper cleaning will help ensure safe use and prolong the life of the product.
- Inspect the product before each use for worn and damaged parts. Do not operate it if you find broken and worn parts.
- Lubricate the internal surfaces of the blades with gear grease, after each use.

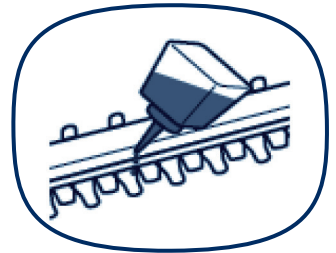

---

## General cleaning

- i. Switch the product off, disconnect it from the power supply and let it cool down.
- ii. Check, clean and store the product as described below.
- iii. Clean the product with a damp cloth and pH-neutral soap. Use a brush for areas that are hard to reach.
- iv. In particular clean the air vents after every use with a cloth and brush.
- v. Remove stubborn dirt with high pressure air (max. 3 bar).

**NOTE: Do not use chemical, alkaline, abrasive or other aggressive detergents or disinfectants to clean this product as they might be harmful to its surfaces.**

---

# MAINTENANCE

---

## Cleaning the blades



**WARNING! Wear safety gloves when working on blades and close to it! Use appropriate tools to remove debris, e.g. a brush or wooden stick! Never use your bare hands!**

**Always use original spare parts for replacement.**

- i. Keep the blades clean and free of debris. Remove trimmings.
  - ii. Apply a small amount of suitable lubricant, like gear grease, on the cutting device to retain a good cutting performance.
- 
- 

## Repair

This product does not contain any parts that can be repaired by the consumer. Contact the after sales support if you have any queries.

---

---

## Storage

- i. Clean the product as described above.
  - ii. Attach the blade cover.
  - iii. Store the product and its accessories in a dry, frost-free place.
  - iv. Always store the product in a place that is inaccessible to children. The ideal storage temperature is between 10 - 30°C.
  - v. We recommend using the original package for storage or covering the product with a suitable cloth or enclosure to protect it against dust.
- 
-

# MAINTENANCE

---

## Transportation

- i. Switch the product off and disconnect from power supply.
  - ii. Attach the blade cover.
  - iii. Always carry the product by its handles/gripping surfaces.
  - iv. Protect the product from any heavy impact or strong vibrations which may occur during transportation in vehicles.
  - v. Secure the product to prevent it from slipping or falling over.
- 
- 

## Recycling and disposal

The product comes in a package that protects it against damage during shipping. Keep the packaging until you are sure that all parts have been delivered and the product is functioning properly. Recycle the packaging afterwards.

Old products are potentially recyclable and do not, therefore, belong in your household waste. You are requested to assist us and our contribution to saving resources and protecting the environment by handing in this product at an equipped collection centre.



# TECHNICAL DATA

<b>Model Number</b>	<b>HT04</b>
Nominal voltage of product with battery	18V d.c.
No load speed	1300 /min
Cutting length	510 mm
Tooth gap	16 mm
A weighted sound pressure	79dB(A) $K_{PA}$ : 3dB(A)
A weighted sound power	87.4dB(A) $K_{WA}$ : 3dB(A)
The guaranteed sound power level:	90dB(A)
Net weight	2.4 kg
Vibrations	2 m/s <sup>2</sup> K=1.5 m/s <sup>2</sup>
<b>Charger</b>	
Model no.	SMVCH001212000B
Input voltage & current	230-240V~ 50/60Hz, 50W
Output voltage & current	21V d.c 2A
Charger time	Approx.60min
Protection class	Class II
<b>Battery pack</b>	
Model no.	B0P-SP02-20-15A
Battery type	Lithium-Ion
Battery capacity	1.5Ah
Battery pack voltage	18V d.c.

# TECHNICAL DATA

The sound values have been determined according to noise test code given in EN 69745-1, using the basic standards EN ISO 11094 and EN ISO 3744.

The sound intensity level for the operator may exceed 80dB(A) and ear protection measures are necessary.

That the declared vibration value has been measured in accordance with a standard test method (according to EN 60745-1) and may be used for comparing one tool with another. The declared vibration value may also be used in a preliminary assessment of exposure.

**WARNING!** The vibration emission during actual use of the power tool can differ from the declared total value depending on the ways in which the tool is used.

Of the need to identify safety measures to protect the operator that are based on an estimation of exposure in the actual conditions of use( taking account of all parts of the operating cycle such as the times when the tool is switched off and when it is running idle in addition to the trigger time).

Noise and vibration values were determined according to the standards and stipulations mentioned in the declaration of conformity. Technical and optical changes can be carried out in the course of further development without notice. All dimensions, references and information of this instruction manual are therefore without guarantee. Legal claims, which are made on the basis of the instruction manual, cannot thus be considered as valid.

Part number	Accessories
CHT-13-1	Blade sheath
CGT-40	Safety guard
CGT-50	Charger
01704ZA	Battery Pack

# TROUBLESHOOTING

Suspected malfunctions are often due to causes that the user can fix themselves. Therefore, check the product using this section. In most cases the problem can be solved quickly by user.



**WARNING! Only perform the steps described within these instructions! all further inspection, maintenance and repair work must be performed by an authorised service centre or a similarly qualified specialist if you cannot solve the problem yourself!**

**Gloves and appropriate protective clothing must be worn when performing these instructions.**

Fault	Possible Cause	Solution
Product is not running.	<ul style="list-style-type: none"><li>- Battery discharged</li><li>- Battery pack does not sit in its place correctly</li><li>- Device defective</li></ul>	<ul style="list-style-type: none"><li>- Charge rechargeable battery</li><li>- Install the battery pack once again</li><li>- Contact service center</li></ul>
Unsatisfactory cutting result	<ul style="list-style-type: none"><li>- The branches exceeding the tooth gap of the blades</li><li>- Low battery power</li></ul>	<ul style="list-style-type: none"><li>- Only cut branches within the limits</li><li>- Charge the battery</li><li>- Contact service center</li></ul>
Excessive vibration/ noise	<ul style="list-style-type: none"><li>- Some bolts/nuts may have loosened</li></ul>	<ul style="list-style-type: none"><li>- Contact service center</li></ul>

# WARRANTY

If your device develops a fault, please don't hesitate to contact our customer service department on 0345 605 2067, the majority of problems can be solved directly on the phone.

1. These warranty terms cover additional warranty rights and do not affect your statutory warranty rights. All our products are covered by a 3 year manufacturer warranty.
2. Claims must be accompanied by proof of purchase. This must be in the form of a Sales receipt or bank statement and must show that the product has been purchased within the warranty period as described under point 1, from the retailer that it was originally bought from. Please keep your receipt safe or staple it to the back of this manual for future reference.
3. Our warranty covers problems caused by material or manufacturing defects, and will result in the repair of these defects or replacement of the device with a like for like or similar article.
4. Our devices have not been designed for commercial, trade or industrial applications, any signs of use of the equipment in these application or equivalent activities, invalidates the warranty.
5. The following are also excluded from our warranty:
  - A. Faults due to accidents, customer misuse or unauthorized repairs
  - B. Consumable Parts such as batteries, chargers, blades, quick release locks, extension cables, wheels, grass bags and other accessories that are compatible with the product.
  - C. Failure due to lack of routine maintenance.
  - D. Failure as a result of not using the equipment in accordance with the manual and safety instructions
  - E. The adjustment of cables, drive gears, or blades.

Warranty claims should be submitted before the end of the warranty period, see point 1, but a paid service exists for repairs commissioned after this period. The original warranty period remains applicable to the device even if repairs are carried out or parts are replaced.

In such cases, the work performed or parts fitted will not result in an extension of the warranty period, and no new warranty will become active for the work performed or parts fitted.

If you have any problems or questions concerning your garden power tool, please contact our after sales service at 0345 605 2067.

