

Pazzaz

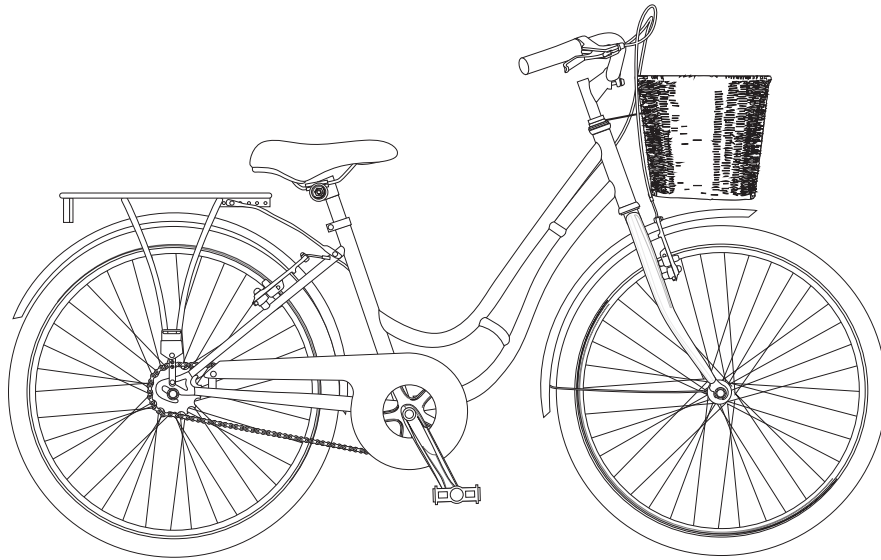

QUICK ASSEMBLY GUIDE

CONTENTS

FITTING THE HANDLEBAR.....	<i>page 3</i>	FITTING THE BASKET.....	<i>page 8</i>
FITTING THE SADDLE.....	<i>page 4</i>	FITTING THE PEDALS	<i>page 9</i>
FITTING THE FRONT MUDGUARD.....	<i>page 5</i>	FITTING THE REFLECTORS & BELL.....	<i>page 10</i>
FITTING THE FRONT WHEEL	<i>page 6</i>	FINAL CHECKS.....	<i>page 11</i>

WARNINGS

- Always check that brakes work before each use - failure to set brakes correctly may result in serious injury or even death.
- Ensure all nuts / bolts / screws are securely tightened and checked before use. Recommended torques (tightness levels) are available in the owners manual.
- Check bike regularly for signs of damage. Do not use again until repaired.
- Keep your bike in good condition by cleaning off dirt, keeping it well maintained and storing in a dry place.
- Always wear a helmet that meets the latest safety standards and make sure you follow the manufacturer's instructions.



**IF YOU NEED ASSISTANCE WITH ASSEMBLY PLEASE CALL
OUR CUSTOMER HELPLINE ON 0161 813 1745**

1.- FITTING THE HANDLEBAR

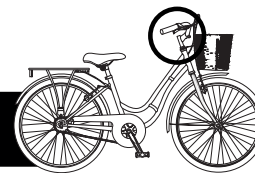

TOOLS NEEDED



ALLEN KEY

- A** Insert the handlebar into the frame. If necessary loosen the stem bolt at the top of the handlebars and stem to allow the wedge nut to move freely. Make sure the minimum insertion mark is not visible once this is fitted. **The handlebar must be inserted beyond this point.**

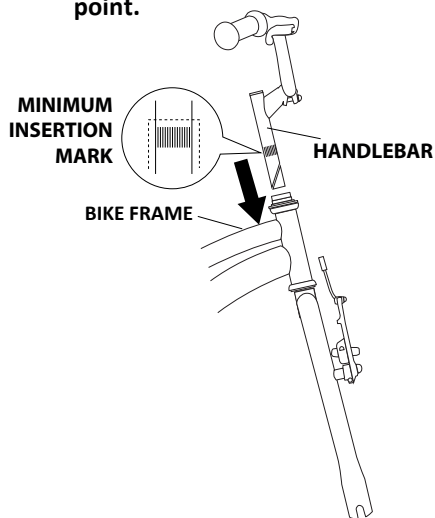

- B** The handlebar must be straight. Align this with the fork by looking downwards at it. **The brakes must be facing the front of the bike.** Use the allen key to tighten the bolt on top of the handlebar stem. Do not fully tighten until the end as you may need to adjust the height.

TOP VIEW

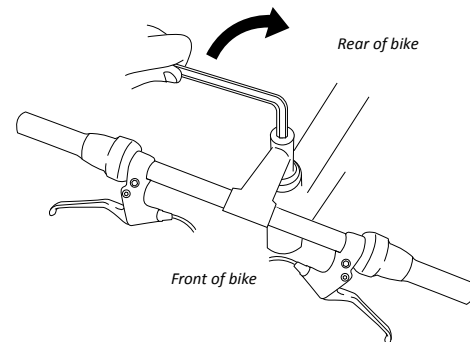
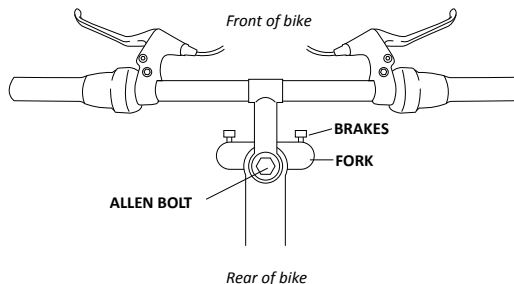

IF YOU ARE EXPERIENCING ANY PROBLEMS PLEASE CALL 0161 813 1745 BEFORE RETURNING BIKE TO STORE

2.- FITTING THE SADDLE

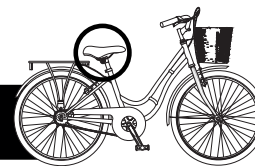

TOOLS NEEDED



ALLEN KEY

- A** Insert saddle into frame. Make sure the minimum insertion mark is not visible once this is fitted. **The saddle must be inserted beyond this point**

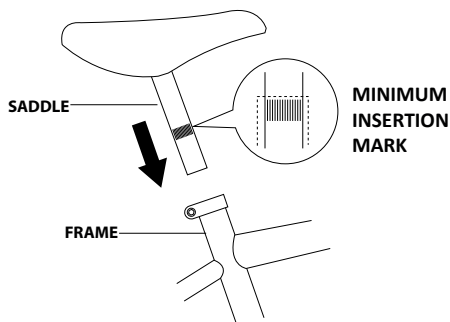

- B** Using the allen key provided, lock the seat in position by turning bolt in a clockwise direction. Do not fully tighten until the end as you may need to adjust the height.

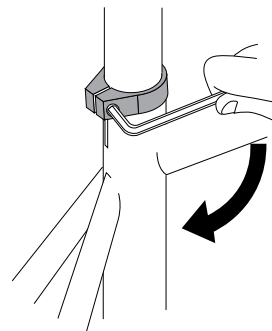

IF YOU ARE EXPERIENCING ANY PROBLEMS PLEASE CALL 0161 813 1745 BEFORE RETURNING BIKE TO STORE

3.- FITTING THE FRONT MUDGUARD

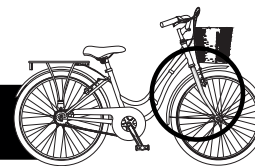

TOOLS NEEDED

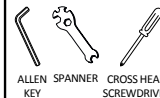

A First, remove the nut from the bolt in the top of the fork using the spanner provided, leave the bolt in place through the fork. Then remove the two screws from the feet of the fork using a crosshead screwdriver

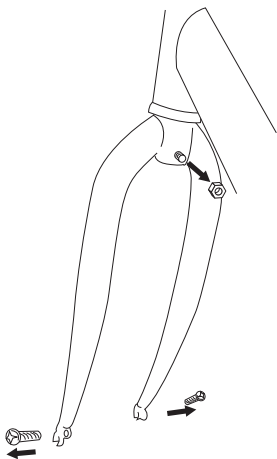

B You can then locate the mudguard in place

- i* First feed the mudguard through the back of the fork as shown.
- ii* Locate the mudguard on the bolt you left in the fork as shown and screw the nut on clockwise until it is finger tight. You can then screw the mudguard to the feet of the fork by replacing screws through the mudguard brackets and into the fork, tightening them by turning clockwise with a crosshead screwdriver. Tighten the nut on the top of the fork turning clockwise using the spanner provided.

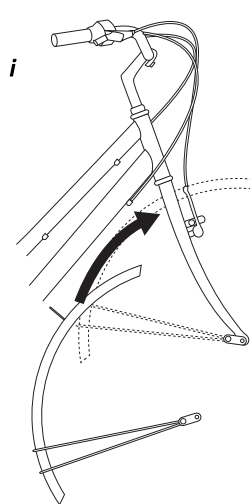

IF YOU ARE EXPERIENCING ANY PROBLEMS PLEASE CALL 0161 813 1745 BEFORE RETURNING BIKE TO STORE

4.- FITTING THE FRONT WHEEL

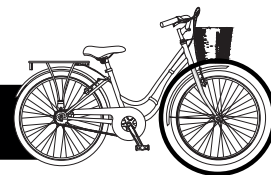

TOOLS NEEDED



SPANNER

A Before fitting the front wheel, you must open the brake arms by releasing the brake cable:

- i* Pull rubber cable protector to the right so you can see the brake cable inside it. Squeeze brake arms together.
- ii* Pull the noodle out by moving it left then up and out of the metal housing

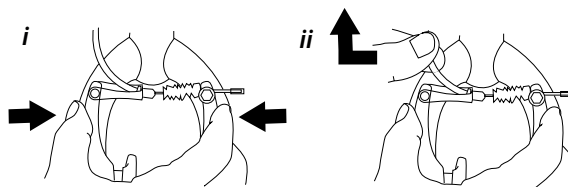

B Turn the bike upside down. Remove the nuts on the front wheel axle by turning anti-clockwise and remove the locking washers. Then sit the wheel in the fork as shown.

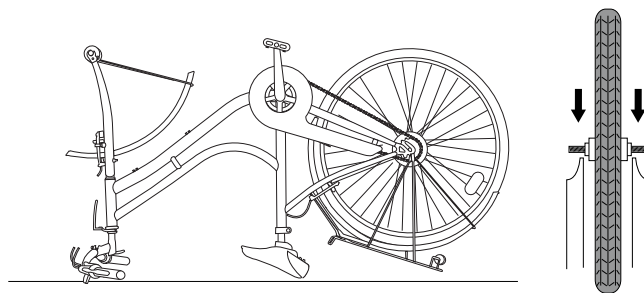

IF YOU ARE EXPERIENCING ANY PROBLEMS PLEASE CALL 0161 813 1745 BEFORE RETURNING BIKE TO STORE

- C** We need to install the basket bracket before we can secure the wheel in place.
- i* With the wheel sat in the fork, insert the locking washers on to the axles, securing the pin in place as shown.
 - ii* Finally, tighten all the fixings with the tools provided.
Do not forget to tighten wheel nuts using spanner provided

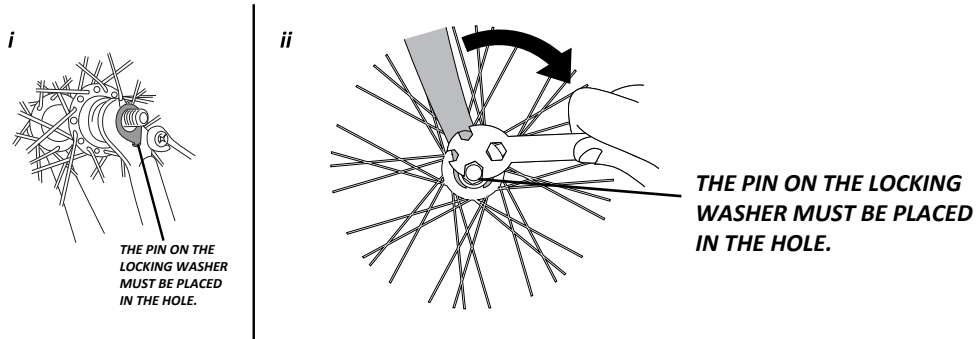

- E** Once the wheel is in place and tight, turn the bike the right way up
- i* Squeeze the brake arms together
 - ii* Slot the brake cable noodle into the slot as shown

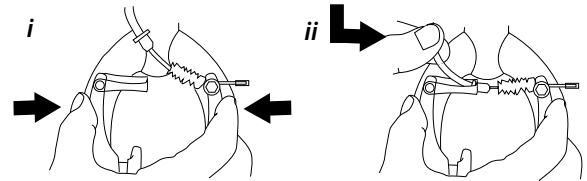

**CORRECT BRAKE & WHEEL FITTING IS VERY IMPORTANT FOR YOUR SAFETY
IF YOU HAVE ANY PROBLEMS THERE IS MORE INFORMATION IN THE USER MANUAL
FAILURE TO CORRECTLY SET THE BRAKES MAY RESULT IN SERIOUS INJURY**

IF YOU ARE EXPERIENCING ANY PROBLEMS PLEASE CALL 0161 813 1745 BEFORE RETURNING BIKE TO STORE

5.- FITTING THE BASKET

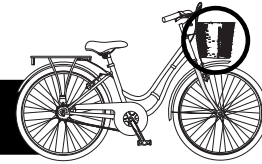

TOOLS NEEDED



SPANNER

- A** Make sure the stem basket bracket is facing the front and make sure the cables don't get in the way.

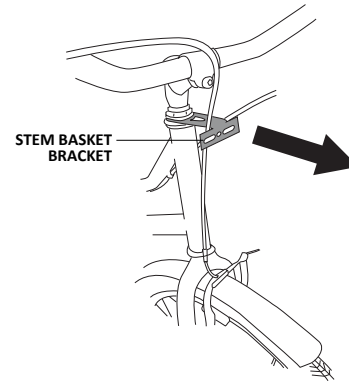

- B** Now we need to fix the basket to the frame of the bike

- i Line the holes in the basket plate and the frame bracket up and insert the screws / washers / fixing plate as shown.
- ii From behind the frame bracket, place the washers on the screws and screw the nuts on clockwise finger tight.

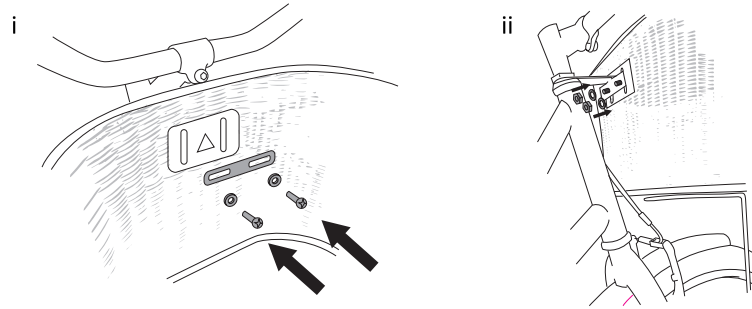

IF YOU ARE EXPERIENCING ANY PROBLEMS PLEASE CALL 0161 813 1745 BEFORE RETURNING BIKE TO STORE

6.- FITTING THE PEDALS

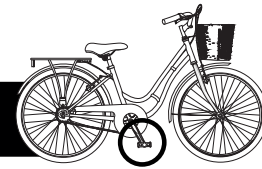

TOOLS NEEDED



SPANNER

To fit the pedals correctly, you must position them the correct way around and screw them on in the right direction:

- i* Stickers indicate the left and right pedal. If these have dropped off, look at the end of the thread where it is imprinted.
- ii* The correct pedal needs to be attached to the matching side of the bike i.e. left pedal to left side and right pedal to right side.
- iii* **IMPORTANT!** Pedals need screwing in opposite directions so they don't fall off in use.
Left pedal is screwed in anti-clockwise / Right pedal is screwed in clockwise. Tighten pedals with spanner provided.

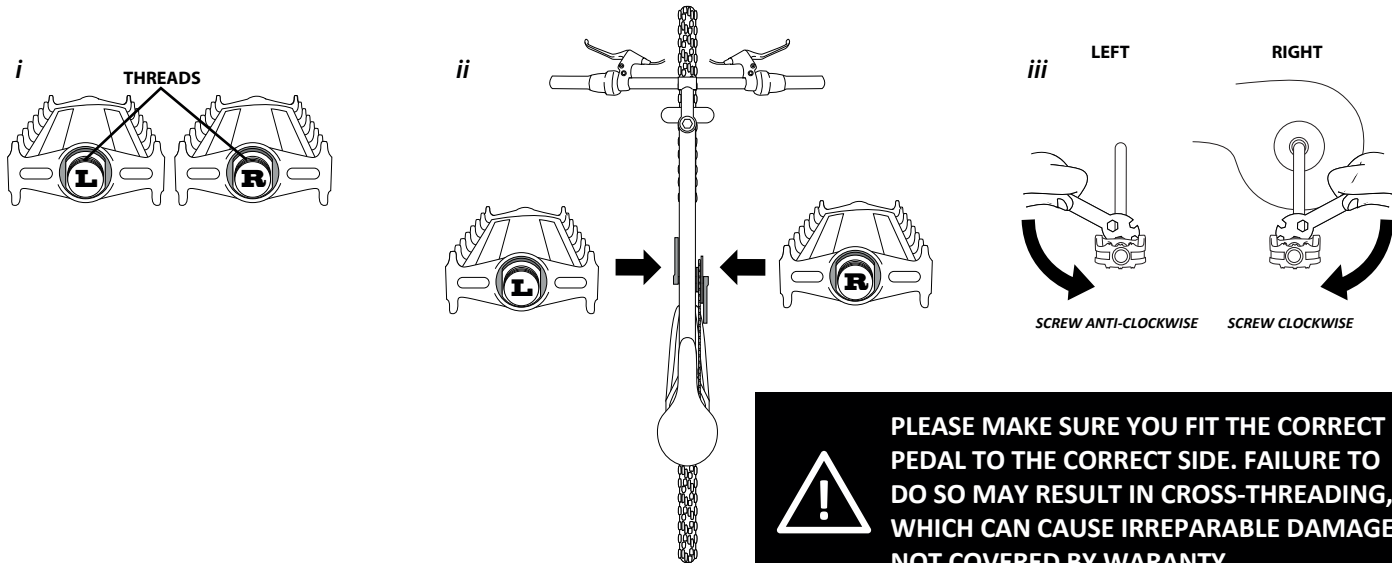

PLEASE MAKE SURE YOU FIT THE CORRECT PEDAL TO THE CORRECT SIDE. FAILURE TO DO SO MAY RESULT IN CROSS-THREADING, WHICH CAN CAUSE IRREPARABLE DAMAGE NOT COVERED BY WARRANTY

7.- FITTING THE REFLECTORS & BELL

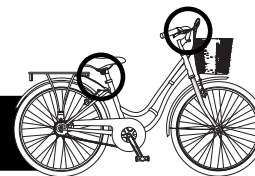

TOOLS NEEDED



CROSS HEAD
SCREWDRIVER

- A** First fully release the securing screws as shown (anti-clockwise)

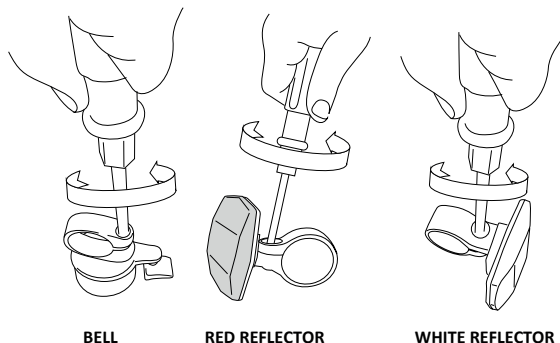

- B** Wrap the bell around the handlebar as shown, remembering to put it in a place where you can reach it easily whilst riding. Then wrap the white reflector around the handlebar near the centre, and wrap the red reflector in the same way around the saddle post.

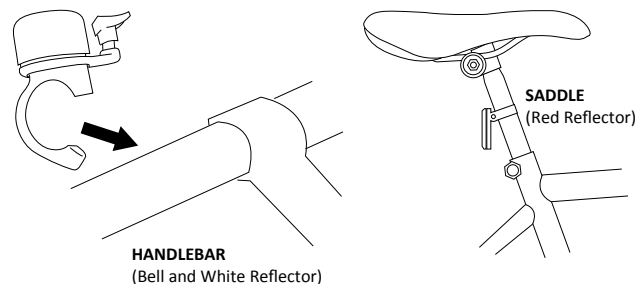

- C** Once these are in place, replace the screws and tighten by turning clockwise using a cross-head screwdriver

8.- FINAL CHECKS

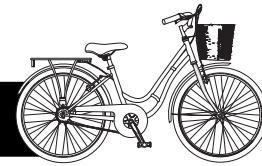

- A** You can now ensure your saddle and handlebars are at a comfortable riding position, and fully tighten. **Always be aware of the minimum insertion mark and make sure these are inserted beyond this point.**
- B** Check tyre pressures regularly. Recommended tyre pressures are clearly marked on the side of the tyre.
- C** Check that all bolts and fixings are tight and secure. You should do this before every ride.
- D** Check functionality of brakes before every ride, you will find out more about this in the user manual included.



IMPORTANT: ENSURE ALL NUTS / BOLTS / SCREWS ARE TIGHT
RECOMMENDED TORQUES IN OWNER'S MANUAL APPENDIX
PLEASE READ OWNER'S MANUAL BEFORE RIDING THIS BIKE
ALWAYS CHECK BRAKE FUNCTIONALITY BEFORE RIDING

