



USER GUIDE

ARCTIC AIR™

Personal space cooler



Thank you for purchasing Arctic Air™ from JML.
Please read these instructions in full and keep them safe for future reference.

Your Arctic Air™

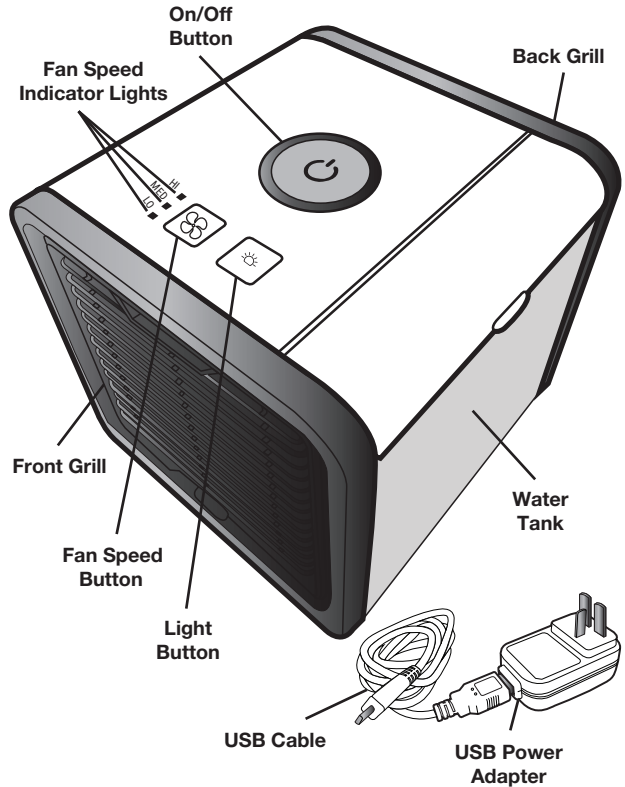

Information

INDOOR USE ONLY

Model no: 17013-B

Adaptor: SW-050150BS

For adaptor: 100-240V, 50/60Hz, 0.2A, class II

For main unit: DC 5V, 1.5A, 10W

Without adaptor:

For main unit: DC 5V, 2.0A, class III

(Note for USB input: DC5V, 1.5A or 2.0A)

Safety Warnings & Advice

PLEASE READ THIS ENTIRE MANUAL BEFORE USE AND SAVE THESE INSTRUCTIONS FOR FUTURE REFERENCE

- Indoor use only.
- Do not carry Arctic Air™ when filled with water. Some water may remain in the unit even if the tank is empty.
- Use only clean or distilled water.
- Please read and follow regular maintenance as recommended in the “Maintenance” section of this guide.
- If a leak or spill occurs, unplug Arctic Air™ and let it dry for 24 hours. Then, use as normal.
- Do not place in direct sunlight for extended periods of time.
- When not using Arctic Air™ for extended periods of time, empty the water tank, turn the unit on, and set to highest fan speed for at least 4 hours. This will dry out the filter and inside of your unit.
- Only use the original power adapter and cord supplied.
- Do not touch the power supply or power cord with wet hands.
- Unplug Arctic Air™ when cleaning, removing/replacing filter, or moving the device.
- Do not place Arctic Air™ near a heater or any electrical equipment.
- Do not place the device in passageways or high traffic areas where there is a possibility of tripping or knocking it over.
- Do not allow any foreign objects inside Arctic Air™.
- Do not place items on top of Arctic Air™.
- Do not block the front and back grills of the device.
- Do not turn the device upside down.
- Do not submerge Arctic Air™ under water or other liquids.
- Do not place Arctic Air™ near open flames or fire sources.
- The manufacturer does not bear any responsibility for any damage from failure to comply with this product guide.

Safety Warnings & Advice

- A replaceable filter is designed specifically for this product. If your cartridge has been broken or damaged, you can purchase a replacement.
- Arctic Air™ must be kept on a level surface during use, tilting the unit may cause water to leak out of the base.
- Check the internal reservoir before refilling – adding water too early will cause the reservoir to overflow and water will leak from the base.
- If moving Arctic Air™ unplug the unit and take care not to spill any water from the reservoir. If the reservoir is full empty before moving.
- For best results, use very cold water – the cooler the water used to fill Arctic Air™, the cooler the air that it produces.
- Children should be supervised to ensure that they do not play with the appliance.
- This appliance can be used by children aged from 8 years and above and persons with reduced physical, sensory or mental capabilities or lack of experience and knowledge if they have been given supervision or instruction concerning use of the appliance in a safe way and understand the hazards involved. Children should not play with the appliance. Cleaning and user maintenance shall not be made by children without supervision.
- If the supply cord is damaged, it must be replaced by the manufacturer, its service agent or similarly qualified persons in order to avoid a hazard.

Safety Warnings & Advice



This marking indicates that this product should not be disposed with other household waste throughout the EU. To prevent possible harm to the environment or human health from uncontrolled waste disposal, recycle it responsibly to promote the sustainable reuse of material resources. To return your used device, please use the return and collection systems or contact the retailer where the product was purchased. They can take this product for environmentally safe recycling.

Maintenance

We recommend cleaning the water tank and inside of the unit once weekly.

Use only a non-abrasive cloth and mild dish soap when needed.

Unplug the unit before cleaning.

For best continued results, we recommend changing the filter every 6 months.

Setup

1. Place Arctic Air™ on a flat surface. **(See Fig 1)**
2. Open the water tank door and fill with water. **(See Fig 2)** We recommend a pitcher or measuring cup.

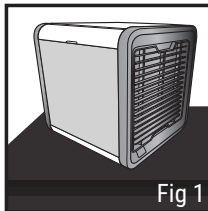

Fig 1

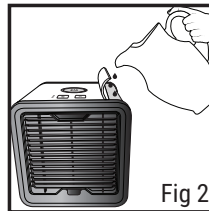

Fig 2

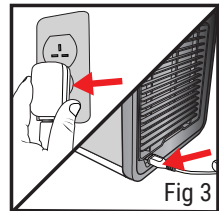



Fig 3

3. Plug USB Power Adapter into an outlet. Then, insert larger USB end of cable into the adapter and the smaller end into the power port on the back of Arctic Air™. **(See Fig 3)**

NOTE: You can also plug the larger USB end into a computer to power Arctic Air™. The power should be SELV: (DC 5V, 1.5 or 2.0A)

Usage

1. Press Power Button to power on Arctic Air™. **(See Fig 4)**
2. Set the Fan speed by pressing  button. You can choose from Low, Medium, and High Mode. The indicator lights next to the button show you which mode Arctic Air™ is currently running at. **(See Fig 5)**
3. Choose your light colour by pressing  button. You can choose between solid colours or a colour-cycle mode. **(See Fig 6)**

COLOUR ORDER: Blue, Red, White, Teal, Purple, Yellow, Green, Colour Cycle

4. When you're done, press the Power Button again to turn off your Arctic Air™.

NOTE: We recommend running Arctic Air™ on HIGH mode for at least 5 minutes before powering off to allow for drying.

LOW WATER: When the water level is low, the water tank will blink 3 times every 60 seconds in AMBER colour. When the tank is filled again, the light will function as normal again.

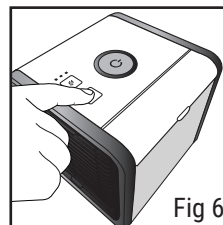
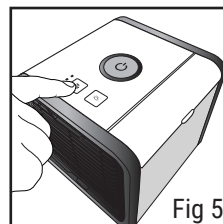
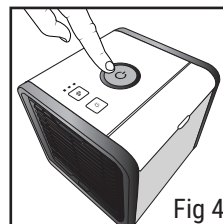

Tips



- Place Arctic Air™ on a raised surface such as a table, desk or counter top. This is the best way to cool your personal area faster.
- Let the filter absorb water for at least 3 minutes after filling the tank and before use. Doing so will get you the coolest air quicker.
- Try to stay within a few feet of Arctic Air™. You'll feel the most benefit when sitting directly in front.
- Arctic Air™ will run for up to 8 hours on a single fill on Low fan mode. Even if the water tank is empty, the filter is still damp and Arctic Air™ is still cooling.

Emptying the water from Arctic Air™

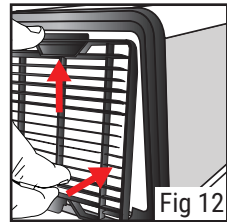
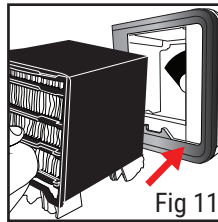
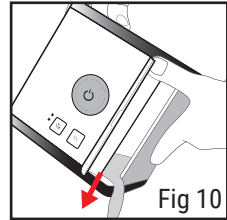
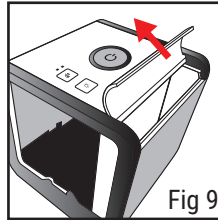
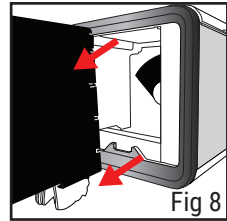
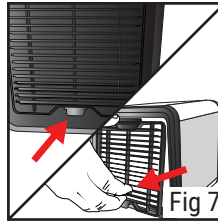
1. Gently press in the release tab on the bottom of the front grill and pull the grill down, and away from the unit. Place aside. **(See Fig 7)**
2. Grab onto the filter, lift up and carefully slide it out of the unit completely. **(See Fig 8)**
3. Open the water tank. **(See Fig 9)**
4. Keep the flap up and tip the Arctic Air™ forward slowly to empty the water from the water tank and internal water reservoir. **(See Fig 10)**
5. Carefully replace the filter back into the Arctic Air™ in the direction as shown by the markings on top of the filter. **(See Fig 11)**
6. Insert the top tab of the front grill into the slot, and press the release tab back into place. **(See Fig 12)**
7. Use a dry cloth or kitchen towel to wipe off any excess water on the wall or base of Arctic Air™.



Changing the filter

The filter should be changed every 6 months, or when you feel Arctic Air™ is not functioning as it should be. The water tank will light up AMBER until the filter is reset. To reset the filter, hold the  and  button for 3 seconds until the tank is not AMBER any more and replace the filter as described above.

To purchase a replacement filter visit www.jmldirect.com, or call **UK: 0800 781 7831 (Freephone)**
/ **ROI: 041-978 0003 (Local rate)** or email info@JMLgroup.co.uk

Warning! When you remove the front grill, the fan and power will turn off and the water tank LED will blink red until the grill is put back in place. This is a safety function.

ARCTIC AIR™

Personal space cooler



Distributed by JML

JML, Unit 1 Eastside, Port of Tyne, South Shields, NE33 5SP
Customer Services: UK: 0800 781 7831 (Freephone) • ROI: 041-978 0003 (Local rate)
Email: info@JMLgroup.co.uk • Web: www.JMLdirect.com

©JohnMillsLtd/GS/04.18/TV/B • Made in China

