

Introduction

Contents

Index



Getting Ready



Camera Basics



Shooting



Playback



Wireless Features



Other Settings



Preliminary Notes and Legal Information



- Take and review some test shots initially to make sure the images were recorded correctly. Please note that Canon Inc., its subsidiaries and affiliates, and its distributors are not liable for any consequential damages arising from any malfunction of a camera or accessory, including memory cards, that result in the failure of an image to be recorded or to be recorded in a way that is machine readable.
- The user's unauthorized photographing or recording (video and/or sound) of people or copyrighted materials may invade the privacy of such people and/or may violate others' legal rights, including copyright and other intellectual property rights. Note that restrictions may apply even when such photographing or recording is intended solely for personal use.
- For information on camera warranty or Customer Support, please refer to the warranty information provided with your camera User Manual Kit.
- Although the screen is produced under extremely high-precision manufacturing conditions and more than 99.99% of the pixels meet design specifications, in rare cases some pixels may be defective or may appear as red or black dots. This does not indicate camera damage or affect recorded images.
- When the camera is used over an extended period, it may become warm. This does not indicate damage.



Introduction

Top Page

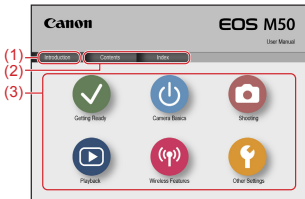

- (1) Jump to this page
This section introduces manual navigation and conventions.
- (2) Jump to the table of contents and index pages
- (3) Jump to the first page of a section, by clicking one of the six sections



Introduction

Portal Pages



Portal pages are gateways to each section.

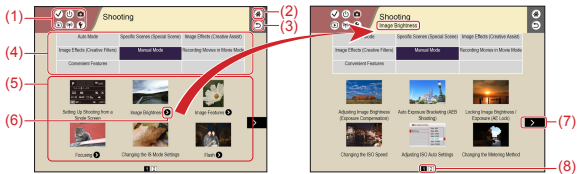

- (1) Section icons
Click an icon to jump to the section's portal page.
- (2) Jump to the first page
- (3) Return to the previous page
- (4) Section themes
Topics in the selected theme are shown in (5). Note that some portal pages do not include themes.





Introduction

Portal Pages



- (5) Topics in the selected theme. Click a topic title to jump to the topic page.
- (6) Indicates multiple topics
- (7) Indicates that the information continues on the next page
- (8) Identifies the current page among multiple portal pages







Introduction

Topic Pages





(1)  Adjusting Image Brightness (Exposure Compensation)   (2) (3)



Set toward - 0 Set toward +

Standard exposure is adjustable in 1/3-stop increments, in a range of -3 to +3.





1 Set the shooting mode

P mode → button

2 Set up the camera

3 Compose the shot and shoot

(1)  Erasing Multiple Images at Once   (2) (3)

You can choose multiple images to erase at once. Be careful when erasing images, because they cannot be recovered.

(4)      (5) (6)

• Select and erase images. Choose an image → MENU button → [OK]

• Select range. Choose the first image → choose the last image → MENU button → [OK]

• All images in folder. Choose a folder → [OK]

- (1) Section icons
Click an icon to jump to the section's portal page.
- (2) Jump to the first page
- (3) Return to the previous page
- (4) Indicates that the information is continued from the previous page
- (5) Indicates that the information continues on the next page
- (6) Numbers in some figures and illustrations correspond to numbers in the steps



Introduction

Manual Conventions



- Instructions in this manual may include icons representing camera buttons and dials.
- The following camera controls are represented by icons.

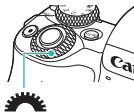

- On-screen icons and text are indicated in brackets.
- Instructions in this manual apply to the camera under default settings.
- For convenience, all lenses and mount adapters are simply referred to as “lenses” and “mount adapters,” whether they are included or sold separately.
- Illustrations in this manual show the camera with the EF-M15-45mm f/3.5-6.3 IS STM lens attached as an example.
- For convenience, all supported memory cards are simply referred to as the “memory card.”



Contents



Preliminary Notes and Legal Information

Introduction

Contents

Safety Instructions

Getting Ready

Attaching the Strap

Charging the Battery Pack

Preparing a Memory Card

Inserting/Removing the Battery Pack and Memory Card

Setting the Date, Time, and Time Zone

Setting the Display Language

Attaching a Lens

Detaching a Lens

Attaching EF and EF-S Lenses

Detaching EF and EF-S Lenses

Using a Tripod with EF or EF-S Lenses

Using EF or EF-S Lens Image Stabilization

Holding the Camera



Contents



Camera Basics

- Trying the Camera Out
- Part Names
- On/Off
- Shutter Button
- Viewfinder
- Shooting Modes
- Adjusting the Screen Angle
- Frames on the Shooting Screen
- Shooting Display Options
- Playback Display Options
- Using the Quick Control Screen
- Using the Menu Screen
- Entering Characters
- Indicator Display
- Touch Operations

Shooting

- Auto Mode
- Specific Scenes (Special Scene)



Contents



Image Effects (Creative Assist)

Image Effects (Creative Filters)

Manual Mode

Recording Movies in Movie Mode

Convenient Features

Playback

Viewing

Finding

Managing

Erasing Images

Editing Stills

Applying Your Favorite Effects (Creative Assist)

Processing RAW Images with the Camera

Editing Movies

Wireless Features

Available Wireless Features

Preparing to Use Wireless Features

Connecting to Bluetooth Enabled Smartphones via Wi-Fi

Connecting to NFC-Compatible Android Smartphones via Wi-Fi

Connecting to Smartphones via Wi-Fi with the Wi-Fi Button



Contents



Other Settings

- Adjusting Screens/Messages to Match Your Skill Level
- Selecting and Creating Folders
- Changing File Numbering
- Auto Rotation of Vertical Images
- Formatting Memory Cards
- Low-Level Formatting
- Using Eco Mode
- Adjusting Power-Saving Features
- Changing the Display Language
- Adjusting Screen Brightness
- Reducing Red-Eye
- Changing the Image Display Period after Shots
- Changing the Video System
- Customizing Shooting Information Display
- Customizing Playback Information Display
- Muting Camera Sounds
- Muting Audio Feedback
- Adjusting the Touch-Screen Panel



Contents



- Activating Sensor Cleaning
- Cleaning the Sensor Manually
- Restoring Default Camera Settings
- Setting Copyright Information to Record in Images
- Deleting All Copyright Information
- Checking Certification Logos

Index

- Precautions for Wireless Features
- Trademarks and Licensing
- Disclaimer



Safety Instructions



Be sure to read these instructions in order to operate the product safely.
Follow these instructions to prevent injury or harm to the operator of the product or others.



WARNING

Denotes the risk of serious injury or death.

- **Keep the product out of the reach of young children.**

A strap wrapped around a person's neck may result in strangulation.

The hot shoe cap is dangerous if swallowed. If swallowed, seek immediate medical assistance.

- **Use only power sources specified in this instruction manual for use with the product.**
- **Do not disassemble or modify the product.**
- **Do not expose the product to strong shocks or vibration.**
- **Do not touch any exposed internal parts.**
- **Stop using the product in any case of unusual circumstances such as the presence of smoke or a strange smell.**
- **Do not use organic solvents such as alcohol, benzine or paint thinner to clean the product.**
- **Do not get the product wet.**
- **Do not insert foreign objects or liquids into the product.**
- **Do not use the product where flammable gases may be present.**

This may cause electric shock, explosion or fire.





Safety Instructions



- For products featuring a viewfinder, do not look through the viewfinder at strong light sources such as the sun on a bright day or lasers and other strong artificial light sources.

This may harm your vision.

- **Observe the following instructions when using commercially available batteries or provided battery packs.**
 - Use batteries/battery packs only with their specified product.
 - Do not heat batteries/battery packs or expose them to fire.
 - Do not charge batteries/battery packs using non-authorized battery chargers.
 - Do not expose the terminals to dirt or let them come into contact with metallic pins or other metal objects.
 - Do not use leaking batteries/battery packs.
 - When disposing of batteries/battery packs, insulate the terminals with tape or other means.

Failure to do so may cause electric shock, explosion or fire.

If a battery/battery pack leaks and the material contacts your skin or clothing, flush the exposed area thoroughly with running water. In case of eye contact, flush thoroughly with copious amounts of clean running water and seek immediate medical assistance.





Safety Instructions



- **Observe the following instructions when using a battery charger or AC adapter.**
 - Periodically remove any dust buildup from the power plug and power outlet using a dry cloth.
 - Do not plug in or unplug the product with wet hands.
 - Do not use the product if the power plug is not fully inserted into the power outlet.
 - Do not expose the power plug and terminals to dirt or let them come into contact with metallic pins or other metal objects.
- **Do not touch the battery charger or AC adapter connected to a power outlet during lightning storms.**
- **Do not place heavy objects on the power cord. Do not damage, break or modify the power cord.**
- **Do not wrap the product in cloth or other materials when in use or shortly after use when the product is still warm in temperature.**
- **Do not leave the product connected to a power source for long periods of time.**

This may cause electric shock, explosion or fire.

- **Do not allow the product to maintain contact with the same area of skin for extended periods of time during use.**

This may result in low-temperature contact burns, including skin redness and blistering, even if the product does not feel hot. The use of a tripod or similar equipment is recommended when using the product in hot places and for people with circulation problems or less sensitive skin.





Safety Instructions



- **Follow any indications to turn off the product in places where its use is forbidden.**

Not doing so may cause other equipment to malfunction due to the effect of electromagnetic waves and even result in accidents.



CAUTION

Denotes the risk of injury.

- **Do not fire the flash near the eyes.**

It may hurt the eyes.

- **Strap is intended for use on the body only. Hanging the strap with any product attached on a hook or other object may damage the product. Also, do not shake the product or expose the product to strong impacts.**
- **Do not apply strong pressure on the lens or allow an object to hit it.**

This may cause injury or damage to the product.

- **Flash emits high temperatures when fired. Keep fingers, any other part of your body, and objects away from the flash unit while taking pictures.**

This may cause burns or malfunction of the flash.

- **Do not leave the product in places exposed to extremely high or low temperatures.**

The product may become extremely hot/cold and cause burns or injury when touched.





Safety Instructions



CAUTION

Denotes the possibility of property damage.

- **Do not aim the camera at intense light sources, such as the sun on a clear day or an intense artificial light source.**

Doing so may damage the image sensor or other internal components.

- **When using the camera on a sandy beach or at a windy location, be careful not to allow dust or sand to enter the camera.**
- **Wipe off any dust, grime, or other foreign matter on the flash with a cotton swab or cloth.**

The heat emitted from the flash may cause foreign matter to smoke or the product to malfunction.

- **Remove and store the battery pack/batteries when you are not using the product.**

Any battery leakage that occurs may cause product damage.

- **Before you discard the battery pack/batteries, cover the terminals with tape or other insulators.**

Contacting other metal materials may lead to fire or explosions.

- **Unplug any battery charger used with the product when not in use. Do not cover with a cloth or other objects when in use.**

Leaving the unit plugged in for a long period of time may cause it to overheat and distort, resulting in fire.



Safety Instructions



- **Do not leave any dedicated battery packs near pets.**

Pets biting the battery pack could cause leakage, overheating, or explosion, resulting in product damage or fire.

- **If your product uses multiple batteries, do not use batteries that have different levels of charge together, and do not use old and new batteries together. Do not insert the batteries with the + and – terminals reversed.**

This may cause the product to malfunction.





Getting Ready

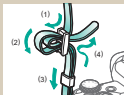

Attaching the Strap

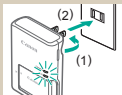

Charging the Battery Pack



Preparing a Memory Card



Inserting/Removing the Battery Pack and Memory Card

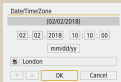

Setting the Date, Time, and Time Zone



Setting the Display Language



Attaching a Lens



Detaching a Lens



Attaching EF and EF-S Lenses





Getting Ready



Detaching EF and EF-S Lenses



Using a Tripod with EF or EF-S Lenses



Using EF or EF-S Lens Image Stabilization



Holding the Camera





Attaching the Strap

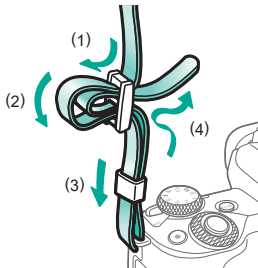



Charging the Battery Pack



1

Remove the battery cover



2

Insert the battery pack

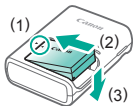

3

Charge the battery pack

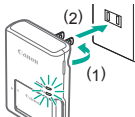

- Charging: Orange
- Fully charged: Green





Charging the Battery Pack



4

Remove the
battery pack

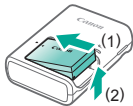



Preparing a Memory Card



Use the following memory cards (sold separately), in any capacity.

- SD memory cards*¹
- SDHC memory cards*^{1*2}
- SDXC memory cards*^{1*2}



- *1 Cards conforming to SD standards. However, not all memory cards have been verified to work with the camera.
- *2 UHS-I memory cards are also supported.



Inserting/Removing the Battery Pack and Memory Card



1

Open the memory card/battery cover

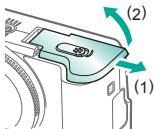

2

When inserting the battery pack:

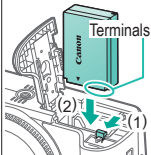

When removing the battery pack:

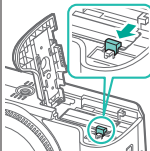

3

When inserting the memory card:

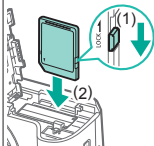



Inserting/Removing the Battery Pack and Memory Card



When removing
the memory card:

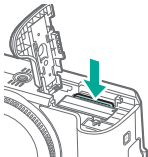

4

Close the memory
card/battery cover

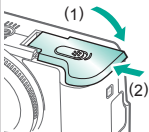



Setting the Date, Time, and Time Zone



1

Turn the camera on

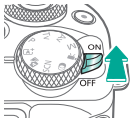

2

Access the menu screen



• MENU button

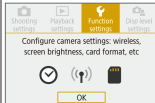

• [Left/Right] buttons → [Key] button
→ [SET] button

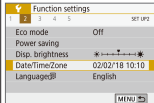

• [Key] → [Up/Down] buttons → [Date/Time/Zone] → [SET] button





Setting the Date, Time, and Time Zone



3

Set the time zone

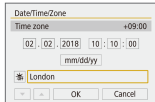

- ◀▶ buttons to choose an option →
- button

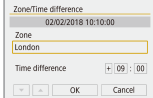

- button

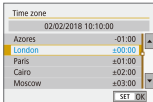

- ▲/▼ buttons to navigate →
- button →
- ◀▶ buttons to choose [OK] →
- button

4

Set the date and time

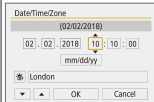

- ◀▶ buttons to navigate →
- button →
- ▲/▼ buttons to adjust →
- button





Setting the Date, Time, and Time Zone

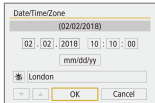

-  buttons to choose [OK] →
-  button





Setting the Display Language



1

Access the menu screen

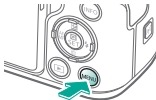

● MENU button

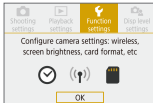

● ◀▶ buttons → [F] → [SET] button

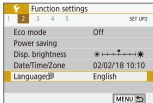

● [F2] → ▲/▼ buttons → [Language] [3]

2

Set the display language



● ▲/▼/◀▶ buttons to choose an option



Attaching a Lens



1

Make sure the camera is off

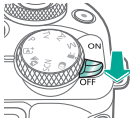

2

Remove the lens cap and body cap

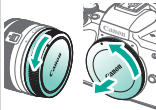

3

Attach the lens

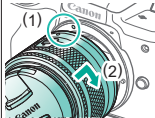

4

Remove the front lens cap

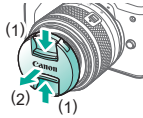



Attaching a Lens



5

Prepare to shoot

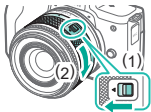

- Press (1) as you turn (2) slightly, and then release (1).
- Turn (2) a little more until it clicks.



- Zoom in or out before focusing.





Detaching a Lens



1

Make sure the camera is off

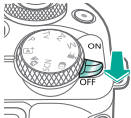

2

Detach the lens



- Press (1) as you turn the lens toward (2) until it stops.
- Remove it in the direction shown (3).

3

Attach the lens cap and body cap





Attaching EF and EF-S Lenses



1

Make sure the camera is off

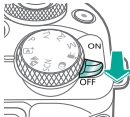

2

Remove the lens cap and body cap

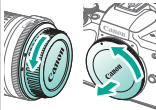

3

Attach an optional adapter to the lens

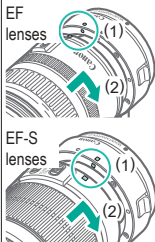

4

Attach the adapter to the camera

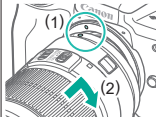



Detaching EF and EF-S Lenses



1

Make sure the camera is off

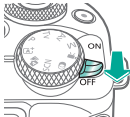

2

Detach the adapter

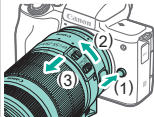

- Press (1) as you turn the adapter toward (2) until it stops.
- Remove it in the direction shown (3).

3

Detach the lens



- Slide (1) as you turn the lens toward (2) until it stops.
- Remove it in the direction shown (3).

4

Attach the lens cap and body cap

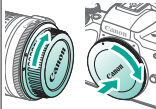



Using a Tripod with EF or EF-S Lenses



1

Attach the tripod mount to the adapter

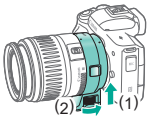

2

Attach the tripod to the tripod mount socket

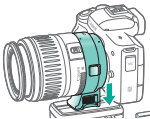



Using EF or EF-S Lens Image Stabilization

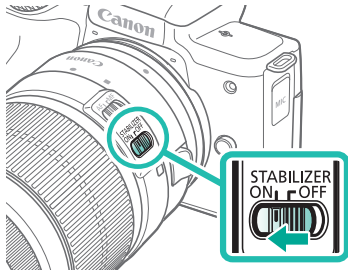



Holding the Camera

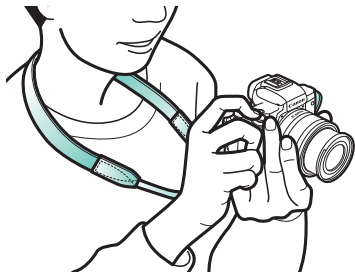



Camera Basics



Trying the Camera Out ▶



Part Names

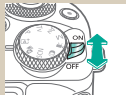

On/Off



Shutter Button



Viewfinder



Shooting Modes



Adjusting the Screen Angle



Frames on the Shooting Screen



Shooting Display Options





Camera Basics



Playback Display Options



Using the Quick Control Screen

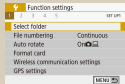

Using the Menu Screen



Entering Characters



Indicator Display



Touch Operations





Camera Basics

Trying the Camera Out



Shooting Stills (Scene Intelligent Auto)



Recording Movies (Scene Intelligent Auto)



Viewing Stills



Viewing Movies



Erasing Images



Trying the Camera Out

Shooting Stills (Scene Intelligent Auto)



- For fully automatic selection of the optimal settings for specific scenes, simply let the camera determine the subject and shooting conditions.
- Frames are displayed around faces and subjects that have been detected, indicating that they are in focus.

1

Turn the camera on

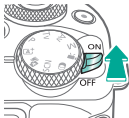

2

Set the mode



- Set the shooting mode → button



- (1) Scene icon
- (2) Remaining number of shots
- (3) Remaining recording time





Trying the Camera Out

Shooting Stills (Scene Intelligent Auto)



- For fully automatic selection of the optimal settings for specific scenes, simply let the camera determine the subject and shooting conditions.
- Frames are displayed around faces and subjects that have been detected, indicating that they are in focus.

3

Zoom in or out, as needed



4

Focus

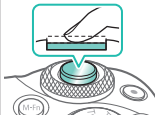

- Press the shutter button lightly.
- The camera beeps twice after focusing.



- An AF point is displayed around positions in focus.



Trying the Camera Out

Shooting Stills (Scene Intelligent Auto)



- For fully automatic selection of the optimal settings for specific scenes, simply let the camera determine the subject and shooting conditions.
- Frames are displayed around faces and subjects that have been detected, indicating that they are in focus.

5

Raise the flash as needed



6

Shoot



- After you shoot, the image is displayed for about two seconds.

- Even while the shot is displayed, you can take another shot by pressing the shutter button again.



Trying the Camera Out

Recording Movies (Scene Intelligent Auto)



- For fully automatic selection of the optimal settings for specific scenes, simply let the camera determine the subject and shooting conditions.
- Frames are displayed around faces and subjects that have been detected, indicating that they are in focus.

1

Turn the camera on

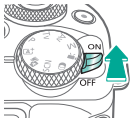

2

Set the mode



- Set the shooting mode →  button



- (1) Scene icon
- (2) Remaining number of shots
- (3) Remaining recording time





Trying the Camera Out

Recording Movies (Scene Intelligent Auto)



- For fully automatic selection of the optimal settings for specific scenes, simply let the camera determine the subject and shooting conditions.
- Frames are displayed around faces and subjects that have been detected, indicating that they are in focus.

3

Zoom in or out, as needed



4

Start recording



- Frames are displayed around any detected faces that are in focus.



Trying the Camera Out

Recording Movies (Scene Intelligent Auto)



- For fully automatic selection of the optimal settings for specific scenes, simply let the camera determine the subject and shooting conditions.
- Frames are displayed around faces and subjects that have been detected, indicating that they are in focus.

5

Stop recording





Trying the Camera Out

Viewing Stills



1

Set display to playback

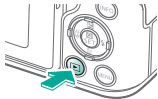

2

Browse your images



- ◀ button: Previous image
- ▶ button: Next image



Trying the Camera Out

Viewing Movies



1

Set display to playback

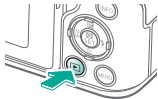

2

Browse your images



- ◀ button: Previous image
- ▶ button: Next image



- Movies are labeled with [▶] [📺].

3

Play the movie



- ▲ button: Display movie playback panel





Trying the Camera Out

Viewing Movies



4

Adjust the volume



● ◀▶ buttons → [▶]





Trying the Camera Out

Erasing Images



1

Set display to playback

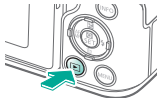

2

Browse your images



- ◀ button: Previous image
- ▶ button: Next image

3

Erase





- ◀▶ buttons → [Erase]

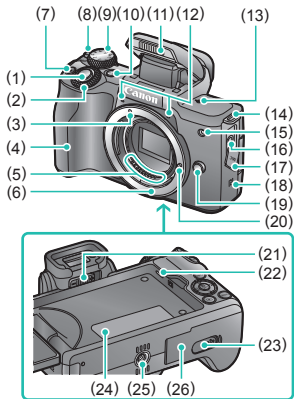

Part Names

Front



No.	Name	Symbol in This Manual
(1)	Shutter button	
(2)	Main dial	
(3)	EF-M lens mount index	
(4)	Grip	
(5)	Contacts	
(6)	Lens mount	
(7)	Movie button	
(8)	ON/OFF switch	
(9)	Mode dial	





Part Names

Front

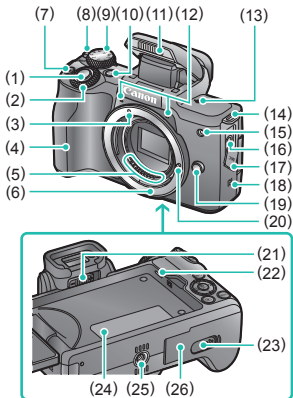

No.	Name	Symbol in This Manual
(10)	Multi-function button	M-Fn
(11)	Flash	
(12)	Microphone	
(13)	Focal plane mark	
(14)	Strap mount	
(15)	Lamp	
(16)	External microphone IN terminal	
(17)	Terminal cover	
(18)	N-Mark	





Part Names

Front

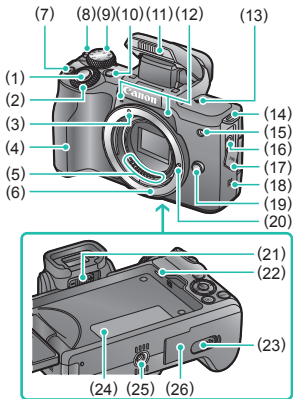

No.	Name	Symbol in This Manual
(19)	Lens release button	
(20)	Lens lock pin	
(21)	Dioptric adjustment knob	
(22)	Speaker	
(23)	DC coupler terminal cover	
(24)	Serial number (Body number)	
(25)	Tripod socket	
(26)	Memory card/battery cover	





Part Names

Back

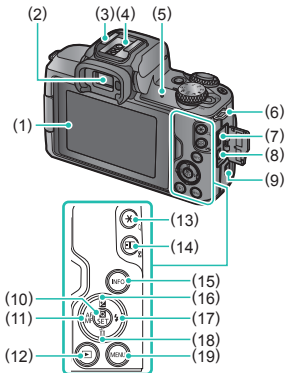

No.	Name	Symbol in This Manual
(1)	Screen / Touch-screen panel	
(2)	Viewfinder	
(3)	Hot shoe	
(4)	Flash-sync contacts	
(5)	Indicator	
(6)	Strap mount	
(7)	Digital terminal	
(8)	HDMI™ terminal	
(9)	Wi-Fi button	





Part Names

Back

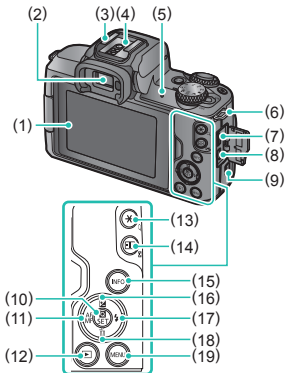

No.	Name	Symbol in This Manual
(10)	Quick Control / Set button	
(11)	Auto focus / Manual focus / Left button	
(12)	Playback button	
(13)	AE lock button Playback: Magnify	
(14)	AF point selection button Playback: Index	
(15)	Information button	INFO
(16)	Exposure compensation / Up button	





Part Names

Back

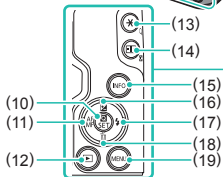
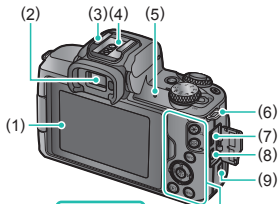

No.	Name	Symbol in This Manual
(17)	Flash / Right button	▶
(18)	Single-image erase / Down button	▼
(19)	Menu button	MENU





Part Names

Lens

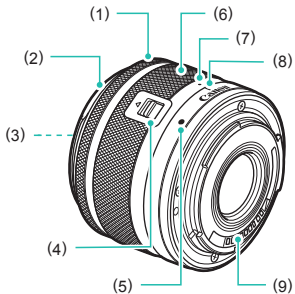

No.	Name
(1)	Focusing ring
(2)	Hood mount
(3)	Filter-mounting thread
(4)	Lens retraction switch
(5)	Lens mount index
(6)	Zoom ring
(7)	Lens retraction index
(8)	Zoom position index
(9)	Contacts





On/Off

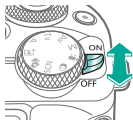

- Turn on: [ON]
- Turn off: [OFF]



Shutter Button



1

Press halfway
(Press lightly to
focus)

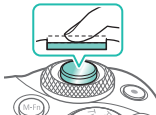

- The camera beeps twice.

2

Press all the way
down
(From the halfway
position, press fully
to shoot)



- The camera shoots.



Viewfinder



1

Switch display modes

- To use the viewfinder, activate it by holding it near your eye.

2

Adjust the diopter



- Adjust it with the screen open.



Shooting Modes



Use the mode dial to access each shooting mode.

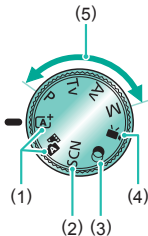

No.	Mode	Function	Symbol in This Manual
(1)	Scene Intelligent Auto Mode / Hybrid Auto Mode	Fully automatic shooting, with camera-determined settings.	
(2)	Special Scene Mode	Shooting with optimal settings for specific scenes.	SCN
(3)	Creative Filters Mode	Shooting with a variety of added effects.	





Shooting Modes



Use the mode dial to access each shooting mode.



No.	Mode	Function	Symbol in This Manual
(4)	Movie Recording Mode	For movie recording.	
(5)	P, Tv, Av, and M Modes	Shooting a variety of ways, with your preferred settings.	P/Tv/ Av/M



Adjusting the Screen Angle

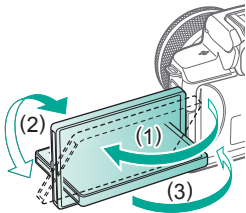

- Toward (1): The screen opens to about 180°.
- Toward (2): The screen swivels about 180°.
- (3): Tilt the screen toward the front to close it.



Frames on the Shooting Screen



White frame



- Displayed around the subject or person's face detected as the main subject.

Green frame



- Displayed after the camera focuses when you press the shutter button halfway.

Blue frame



- Displayed as the camera continues to focus on moving subjects. Displayed as long as you press the shutter button halfway.

Orange frame



- Displayed if the camera cannot focus when you press the shutter button halfway.



Shooting Display Options



Shooting information 1



Shooting information 2



Histogram



No information display



INFO. Quick Control screen

1

Switch display modes





Playback Display Options



No information display



Information display 1 (summary)



Information display 2 (details)



Information display 3 (details)

1

Switch the display modes





Using the Quick Control Screen



1

Access the setting screen

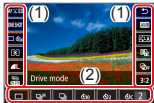

- (1) Setting items
- (2) Setting options

2

Choose the setting item



3

Choose the setting option





Using the Quick Control Screen



- To set items labeled [**INFO**], press the **INFO** button.
- To set items labeled [**MENU**], press the **MENU** button.

- To set items labeled [], turn the dial.



4

Confirm your choice and exit





Using the Menu Screen

(When set to [Camera icon] → [Menu display] → [Guided])



1

Access the menu screen

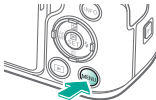

2

Choose a main tab

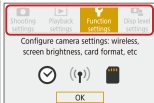



Using the Menu Screen

(When set to [📷] → [Menu display] → [Guided])

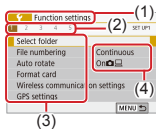

- (1) Main tab
- (2) Sub-tab
- (3) Setting items
- (4) Setting options

3

Choose a sub-tab



4

Choose the setting item



- Some items are selected with the ▲/▼ buttons on a different screen, after you press the  button initially.





Using the Menu Screen

(When set to [📷] → [Menu display] → [Guided])



5

Choose the setting option



6

Confirm your choice and exit



7

Return to the shooting screen



- Press the **MENU** button to return to the screen in step 2, and press it again to return to the shooting screen.





Entering Characters



Entering characters

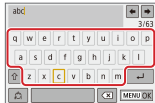

- Touch a character to enter it.

Moving the cursor



- Touch [←]/[→].

Switching input modes



- [↑]: Switch to uppercase
- [1]: Switch to numbers or symbols

Deleting characters



- Touch [X].





Entering Characters



Entering line breaks



- Touch [↵].

Confirming input

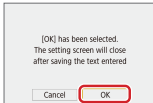

- Touch **[MENU]**, and then touch **[OK]**.

Returning to the previous screen





Indicator Display



Indicator display varies depending on the camera status.

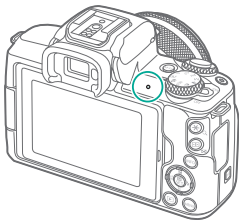

Color	Status	Camera Status
Green	On	<ul style="list-style-type: none">● Recording stills to the memory card, or reading stills from the card
	Slow blinking	<ul style="list-style-type: none">● Connected to a computer● Display off
	Blinking	<ul style="list-style-type: none">● Recording movies to the memory card, or reading movies from the card● Transmitting via Wi-Fi



Camera Basics

Touch Operations



Quick Control Screen

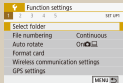

MENU



Playback



Touch Operations

Quick Control Screen



Accessing the setting screen



- Touch **[Q]**.

Setting up the camera

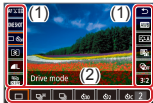

- Touch a setting item (1)
→ option (2).

Switching screens



- For items labeled **[INFO]**, touch **[INFO]**.
- For items labeled **[MENU]**, touch **[MENU]**.
- For items labeled **[INFO]**, touch **[INFO]**.

Returning to the previous screen



- Touch **[↶]**.





Touch Operations

Quick Control Screen



Adjusting amounts
on bars



- Touch or drag the bar.





Touch Operations

MENU



Setting up the camera

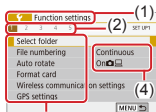

(3)

- Touch a main tab (1)
→ sub tab (2) →
setting item (3) →
option (4).

Returning to the previous screen

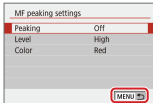

- Touch **[MENU]**.

Adding/removing check marks

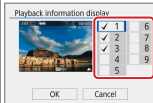

- Touch a check box.

Instead of pressing the **INFO** button

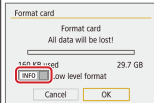

- Touch **[INFO]**.





Touch Operations MENU



Instead of pressing
the **MENU** button



- Touch **[MENU]**.

Instead of pressing
the **SET** button

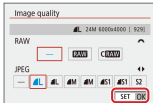

- Touch **[SET]**.





Touch Operations

Playback



Viewing images individually



- Next image: Drag left
- Previous image: Drag right

Playing movies



- Play: Touch [▶]

Operations during movies



- Stop: Touch the screen
- Resume: Touch [▶]
- Adjust volume: Touch [🔊]

Switching to index display





Touch Operations

Playback



Displaying fewer images



Magnifying images



- Quickly touch twice.



Reducing magnified images



- Restore original size:
Touch 





Shooting



Auto Mode	Specific Scenes (Special Scene)	Image Effects (Creative Assist)
Image Effects (Creative Filters)	Manual Mode	Recording Movies in Movie Mode
Convenient Features		



Shooting Stills (Scene Intelligent Auto)



Recording Movies (Scene Intelligent Auto)



Hybrid Auto Mode



Hybrid Auto Mode



You can make a short movie of the day just by shooting stills. The camera records 2 – 4-second clips of scenes before each shot, which are later combined in a digest movie.

1

Set the shooting mode



2

Compose the shot and shoot





Shooting



Auto Mode	Specific Scenes (Special Scene)	Image Effects (Creative Assist)
Image Effects (Creative Filters)	Manual Mode	Recording Movies in Movie Mode
Convenient Features		



 Self Portrait



 Portrait



 Smooth skin

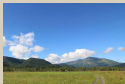

 Landscape



 Sports



 Close-up





Shooting



Auto Mode	Specific Scenes (Special Scene)	Image Effects (Creative Assist)
Image Effects (Creative Filters)	Manual Mode	Recording Movies in Movie Mode
Convenient Features		



 Food



 Panning



 Handheld Night Scene



 HDR Backlight Control



 Silent Mode



Specific Scenes (Special Scene)



 Portrait

Capture subjects that stand out against a blurred background, with smooth skin tone and soft-looking hair.

1

Set the shooting mode



- **SCN** mode →  button

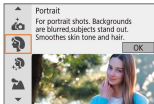

- ▲/▼ buttons →  →  button

2

Shoot





Specific Scenes (Special Scene)



 Self Portrait

For self-portraits, customizable image processing includes skin smoothing as well as brightness and background adjustment to make yourself stand out.



 Smooth skin

Processes images to make skin look smoother.



 Landscape

Capture wide-open landscapes or similar scenery in sharp focus from near to far, with blue skies and greenery reproduced vividly.





Specific Scenes (Special Scene)



 Sports

Shoot continuously as the camera keeps moving subjects in focus.



 Close-up

Take close-ups of flowers or other small objects to show them enlarged in your shots.



 Food

Adjust color tones to make food look fresh and vibrant.





Specific Scenes (Special Scene)



 Handheld Night Scene

Take beautiful shots of evening scenes or portraits with evening scenery in the background.



 HDR Backlight Control

Three consecutive images are captured at different brightness levels each time you shoot, and the camera combines image areas with optimal brightness to create a single image. This mode can reduce the washed-out highlights and loss of detail in shadows that tend to occur in shots with mixed bright and dark image areas.



 Silent Mode

Shoot quiet scenes without making shutter sounds or other operating sounds.





Capturing Subjects Against Flowing Backgrounds



 Panning

By panning, you can blur the background to convey a sense of speed.

Attach a lens compatible with  mode to reduce subject blurring and keep subjects clear and sharp.

1

Set the shooting mode



- **SCN** mode →  button

2

Shoot



- ▲/▼ buttons →  →  button



- Before shooting, press the shutter button halfway as you move the camera so that it follows the subject.





Capturing Subjects Against Flowing Backgrounds



 Panning

By panning, you can blur the background to convey a sense of speed.

Attach a lens compatible with  mode to reduce subject blurring and keep subjects clear and sharp.



- Keep the moving subject in the frame displayed, and press the shutter button all the way down.
- Even after you have pressed the shutter button fully, continue moving the camera to follow the subject.



Shooting



Auto Mode	Specific Scenes (Special Scene)	Image Effects (Creative Assist)
Image Effects (Creative Filters)	Manual Mode	Recording Movies in Movie Mode
Convenient Features		



Shooting with Your Favorite Effects



Shooting with Your Favorite Effects



Shoot with your preferred effects in **A+** mode by adjusting background blur, brightness, or other options. Easy to set up, by choosing from presets saved on the camera.

1

Set the shooting mode



- **A+** mode →
● **SET** button

2

Access the setting screen



- **Q** button →
● **SET** button

3

Choose the setting item



- **Q** button →
● **SET** button





Shooting with Your Favorite Effects



Shoot with your preferred effects in **A+** mode by adjusting background blur, brightness, or other options.
Easy to set up, by choosing from presets saved on the camera.

4

Shoot





Shooting



Auto Mode	Specific Scenes (Special Scene)	Image Effects (Creative Assist)
Image Effects (Creative Filters)	Manual Mode	Recording Movies in Movie Mode
Convenient Features		



 Grainy B/W



 Soft focus



 Fish-eye effect



 Water painting effect



 Toy camera effect



 Miniature effect





Shooting



Auto Mode	Specific Scenes (Special Scene)	Image Effects (Creative Assist)
Image Effects (Creative Filters)	Manual Mode	Recording Movies in Movie Mode
Convenient Features		



 HDR art standard



 HDR art vivid



 HDR art bold



 HDR art embossed



Image Effects (Creative Filters)



 Grainy B/W

Take monochrome pictures with a gritty, rough feeling.



1

Set the shooting mode



- mode →
-  button



- ▲/▼ buttons →
-  →  button

2

Adjust the effect level





Image Effects (Creative Filters)



 Grainy B/W

Take monochrome pictures with a gritty, rough feeling.

3

Shoot

- ▲/▼ buttons →
[Filter effect level] →
- ◀▶ buttons →
-  button





Image Effects (Creative Filters)



 Soft focus

Shoot images as if a soft focus filter were attached to the camera.



 Fish-eye effect

Shoot with the distorting effect of a fish-eye lens.

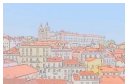

 Water painting effect

Soften colors, for photos resembling watercolor paintings.





Image Effects (Creative Filters)



 Toy camera effect

Shoot images resemble shots from a toy camera, with vignetting (darker, blurred image corners) and modified color overall.



 HDR art standard

Add an effect to make shots resemble low-contrast paintings with flat tones.



 HDR art vivid

Add an effect to make shots resemble vivid illustrations.





Image Effects (Creative Filters)



 HDR art bold

Add an effect to make shots resemble oil paintings, with bold edges.



 HDR art embossed

Add an effect to make shots resemble old, faded photos with bold edges and dark ambiance.





Creative Filters (Miniature Effect)



 Miniature effect

Creates the effect of a miniature model, by blurring image areas outside a selected area.



1

Set the shooting mode



●  mode →
●  button



●  buttons →
●  →  button





Creative Filters (Miniature Effect)



 Miniature effect

Creates the effect of a miniature model, by blurring image areas outside a selected area.

2

Choose the position to keep in focus and the area not to blur



● Move the frame:

 button →
▲/▼ buttons





Creative Filters (Miniature Effect)



 Miniature effect

Creates the effect of a miniature model, by blurring image areas outside a selected area.

3

Return to the shooting screen



4

Shoot



● Move the AF point:

 button →

 buttons



Shooting



Auto Mode	Specific Scenes (Special Scene)	Image Effects (Creative Assist)
Image Effects (Creative Filters)	Manual Mode	Recording Movies in Movie Mode
Convenient Features		



Setting Up Shooting from a Single Screen



Focusing >



Image Brightness >



Changing the IS Mode Settings



Image Features >



Flash >





Shooting



Auto Mode	Specific Scenes (Special Scene)	Image Effects (Creative Assist)
Image Effects (Creative Filters)	Manual Mode	Recording Movies in Movie Mode
Convenient Features		



Specific Shutter Speeds and Apertures >



Customizing the Camera >





Setting Up Shooting from a Single Screen



The INFO. Quick Control screen provides convenient, single-screen access to a variety of shooting settings.

1

Set the shooting mode



- P mode →
●  button

2

Access the INFO.
Quick Control
screen



- Press the **INFO** button a few times.



-  button

3

Choose a function





Setting Up Shooting from a Single Screen



The INFO. Quick Control screen provides convenient, single-screen access to a variety of shooting settings.

4

Set up the camera

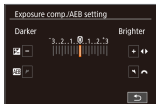



•  buttons or
 dial to adjust



•  buttons or
INFO button to adjust



•  buttons or 
button to adjust





Setting Up Shooting from a Single Screen



The INFO. Quick Control screen provides convenient, single-screen access to a variety of shooting settings.

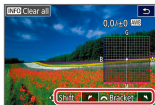

● ▲/▼/◀/▶ buttons
or ⚙ dial to
adjust



Shooting

Image Brightness



Auto Mode	Specific Scenes (Special Scene)	Image Effects (Creative Assist)
Image Effects (Creative Filters)	Manual Mode	Recording Movies in Movie Mode
Convenient Features		



Adjusting Image Brightness
(Exposure Compensation)



Auto Exposure Bracketing
(AEB Shooting)



Locking Image Brightness /
Exposure (AE Lock)



Changing the ISO Speed

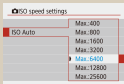

Adjusting ISO Auto Settings



Changing the Metering Method





Shooting

Image Brightness



Auto Mode	Specific Scenes (Special Scene)	Image Effects (Creative Assist)
Image Effects (Creative Filters)	Manual Mode	Recording Movies in Movie Mode
Convenient Features		



Auto Correction of Brightness and Contrast (Auto Lighting Optimizer)



Shooting Bright Subjects (Highlight Tone Priority)



Deactivating Exposure Simulation





Adjusting Image Brightness (Exposure Compensation)



Set toward -



±0



Set toward +

Standard exposure is adjustable in 1/3-stop increments, in a range of -3 to +3.

1

Set the shooting mode



- **P** mode →
Ⓢ button

2

Set up the camera



- ⚙ dial

3

Compose the shot and shoot





Auto Exposure Bracketing (AEB Shooting)



Underexposure



Overexposure

Three images are captured at different exposure levels each time you shoot. Bracketing width is adjustable in 1/3-stop increments in a range of ± 2 stops, centered on the exposure compensation level.

1

Set the shooting mode



- **P** mode →
[SET] button

2

Access the menu screen



- **MENU** button →
[CAMERA] → [SET] button

3

Set up the camera

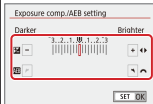

- [CAMERA] → [Expo. comp./AEB]
- Exposure compensation: ◀▶ buttons
- AEB: ⚙ dial



Locking Image Brightness / Exposure (AE Lock)



Without AE lock



AE lock

Before shooting, you can lock the exposure, or you can specify focus and exposure separately.

1

Set the shooting mode



- **P** mode →
[P] button

2

Lock the exposure



- [*****] is displayed, and the exposure is locked.

3

Compose the shot and shoot





Changing the ISO Speed



Low



High

Choose [AUTO] to have the ISO speed set automatically to match the shooting mode and scene, or adjust the ISO speed manually to suit how you are shooting. Higher values increase ISO speed while lower values decrease it.

1

Set the shooting mode



- **P** mode →

2

Access the ISO speed bar



- Touch **[ISO]AUTO**.

3

Set up the camera



- buttons



Adjusting ISO Auto Settings



Maximum set low



Maximum set high

You can limit the maximum ISO speed set automatically.

1

Set the shooting mode



- **P** mode →
[SET] button

2

Access the menu screen



- **MENU** button →
[CAMERA] → [SET] button

3

Set up the camera

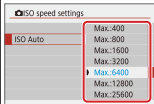

- [CAMERA] → [CAMERA] ISO speed settings] → [ISO Auto] → choose an option



Changing the Metering Method



Choose how the camera determines brightness.

1

Set the shooting mode



- **P** mode →
Ⓢ button

2

Access the setting screen



3

Set up the camera



-  → choose an option



Auto Correction of Brightness and Contrast (Auto Lighting Optimizer)



Off
Disable



Low



Standard



High

1

Set the shooting mode



- **P** mode →
● button

2

Access the setting screen



3

Set up the camera



- → choose an option



Shooting Bright Subjects (Highlight Tone Priority)



Improve gradation in bright image areas to avoid loss of detail in subject highlights.

1

Set the shooting mode



- **P** mode →
[SET] button

2

Access the menu screen



- **MENU** button →
[CAMERA] → [SET] button

3

Set up the camera

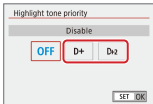

- [CAMERA 2] → [Highlight tone priority] →
choose an option



Deactivating Exposure Simulation



Images are displayed at a brightness simulating the actual brightness as captured. For this reason, screen brightness is also adjusted in response to changes in exposure compensation. This feature can be disabled to keep the screen at a brightness convenient for shooting, unaffected by exposure compensation.

1

Set the shooting mode



- **P** mode →
[SET] button

2

Access the menu screen



- **MENU** button →
[CAMERA] → [SET] button

3

Set up the camera

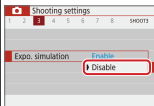

- [CAMERA 3] →
[Expo. simulation] →
[Disable]



Shooting

Image Features



Auto Mode	Specific Scenes (Special Scene)	Image Effects (Creative Assist)
Image Effects (Creative Filters)	Manual Mode	Recording Movies in Movie Mode
Convenient Features		



Choosing Color Tones
(Picture Style)



Capturing Natural Colors
(White Balance)



Customizing Picture Styles



Custom White Balance



Saving Customized Picture
Styles



Manually Correcting White
Balance





Shooting

Image Features



Auto Mode	Specific Scenes (Special Scene)	Image Effects (Creative Assist)
Image Effects (Creative Filters)	Manual Mode	Recording Movies in Movie Mode
Convenient Features		



Manually Setting White Balance
Color Temperature



Correcting Lens Aberrations

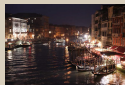

Reducing Noise in High-ISO
Shooting



Using Multi Shot Noise
Reduction



Reducing Noise at Slow Shutter
Speeds



Choosing Color Tones (Picture Style)



Standard



Landscape

Choose color settings that express scenes or subjects well.

1

Set the shooting mode



- **P** mode →
 button

2

Access the setting screen



3

Set up the camera



-  → choose an option



Customizing Picture Styles



Customize parameters of Picture Styles, such as contrast or saturation.

1

Set the shooting mode



- **P** mode →
SET button

2

Access the setting screen



3

Set up the camera



-  →
choose an option →
INFO button





Customizing Picture Styles



Customize parameters of Picture Styles, such as contrast or saturation.

- Choose an item:

▲/▼ buttons

- Customize:

◀▶ buttons





Saving Customized Picture Styles



Save presets (such as or) that you have customized as new styles. You can create several Picture Styles with different settings for parameters such as sharpness or contrast.

1

Set the shooting mode



- **P** mode →

2

Access the setting screen



3

Set up the camera





- → choose a user-defined style no.
→ **INFO** button





Saving Customized Picture Styles



Save presets (such as  or ) that you have customized as new styles. You can create several Picture Styles with different settings for parameters such as sharpness or contrast.

- Choose an item:

▲/▼ buttons

- Customize:

◀▶ buttons





Capturing Natural Colors (White Balance)



Daylight



Cloudy



Tungsten light

By adjusting white balance (WB), you can make image colors look more natural for the scene you are shooting.

1

Set the shooting mode



- **P** mode →
[P] button

2

Access the setting screen



3

Set up the camera



- [WB] → choose an option



Custom White Balance



Loading white

For image colors that look natural under the light in your shot, adjust white balance to suit the light source where you are shooting. Set the white balance under the same light source that will illuminate your shot.

1

Set the shooting mode



- **P** mode →  button

2

Shoot a white object



- Use a plain white object that fills the screen.



- Focus and shoot.

3

Access the menu screen



- **MENU** button →  →  button





Custom White Balance



Loading white

For image colors that look natural under the light in your shot, adjust white balance to suit the light source where you are shooting. Set the white balance under the same light source that will illuminate your shot.

4

Load the white data

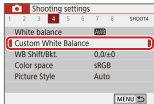

- [CAMERA] → [Custom White Balance]



- Select your image from step 2 →
[SET] button → [OK] →
[SET] button

5

Return to the shooting screen





Custom White Balance



Loading white

For image colors that look natural under the light in your shot, adjust white balance to suit the light source where you are shooting. Set the white balance under the same light source that will illuminate your shot.

6

Access the setting screen



7

Set up the camera

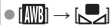



Manually Correcting White Balance



Daylight shot



Corrected

You can manually correct white balance. This adjustment can match the effect of using a commercially available color temperature conversion filter or color-compensating filter.

1

Set the shooting mode



- **P** mode →
SET button

2

Access the setting screen



3

Set up the camera



- **[AWB]** → choose an option →
INFO button

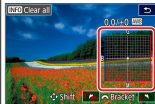

- Adjust:
▲/▼/◀▶ buttons
→ **MENU** button



Manually Setting White Balance Color Temperature



A value can be set representing the white balance color temperature.

1

Set the shooting mode



- **P** mode →
[SET] button

2

Access the setting screen



3

Set up the camera



- [AWB] →
[K] 5200 →
[] button





Manually Setting White Balance Color Temperature



A value can be set representing the white balance color temperature.

- Choose a color temperature:



buttons →

MENU button



Correcting Lens Aberrations



Example: Peripheral illumination correction
→ Disable



Example: Peripheral illumination correction
→ Enable

Correct a variety of image issues from lens characteristics.

1

Set the shooting mode



- **P** mode → [SET] button

2

Access the menu screen



- **MENU** button → [CAMERA] → [SET] button

3

Set up the camera

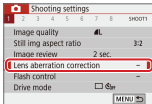

- [CAMERA 1] → [Lens aberration correction]

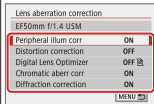

- Choose an item without [MENU]





Correcting Lens Aberrations



Example: Peripheral illumination correction

→ Disable



Example: Peripheral illumination correction

→ Enable

Correct a variety of image issues from lens characteristics.

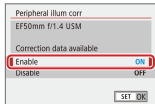



Reducing Noise in High-ISO Shooting



You can choose from 3 levels of noise reduction: [Standard], [High], [Low]. This function is especially effective when shooting at high ISO speeds.

1

Set the shooting mode



- **P** mode →
[SET] button

2

Access the menu screen



- **MENU** button →
[CAMERA] → [SET] button

3

Set up the camera

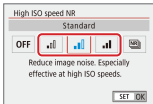

- [CAMERA] → [High ISO speed NR] → choose an option



Using Multi Shot Noise Reduction



Automatically combine four images captured at once to reduce noise. Compared to setting [High ISO speed NR] to [High], this feature minimizes loss of image quality while reducing noise.

1

Set the shooting mode



- **P** mode →
[SET] button

2

Access the menu screen



- **MENU** button →
[CAMERA] → [SET] button

3

Set up the camera



- [CAMERA] → [High ISO speed NR] → [NR]



Reducing Noise at Slow Shutter Speeds



Reduce noise from long exposures at shutter speeds of one second or slower.

1

Set the shooting mode



- **P** mode →
[SET] button

2

Access the menu screen



- **MENU** button →
[CAMERA] → [SET] button

3

Set up the camera

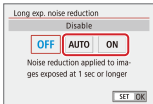

- [CAMERA] → [Long exp. noise reduction] →
choose an option



Shooting

Focusing



Auto Mode	Specific Scenes (Special Scene)	Image Effects (Creative Assist)
Image Effects (Creative Filters)	Manual Mode	Recording Movies in Movie Mode
Convenient Features		



Shooting in Manual Focus Mode



Fine-Tuning the Focus



Easily Identifying the Focus Area (MF Peaking)



Choosing the AF Method



Magnifying Display to Check the Focus



Shooting with Subject Eyes in Focus





Shooting

Focusing



Auto Mode	Specific Scenes (Special Scene)	Image Effects (Creative Assist)
Image Effects (Creative Filters)	Manual Mode	Recording Movies in Movie Mode
Convenient Features		



Shooting with Servo AF



Changing the Focus Setting



Choosing Subjects by Touch





Shooting in Manual Focus Mode



When focusing is not possible in AF mode, use manual focus. To make focusing easier, magnify the display.

1

Set the shooting mode



- **P** mode →
[SET] button

2

Choose [MF]



- EF-M lenses:
◀ button → [Manual focus]

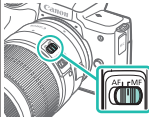

- Other lenses: set
switch to MF

3

Activate magnification



- [Magnification] button →
[Magnification] dial





Shooting in Manual Focus Mode



When focusing is not possible in AF mode, use manual focus. To make focusing easier, magnify the display.

4

Display an area to focus on

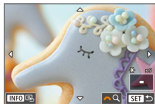

- ▲/▼/◀▶ buttons
- Center display again:
INFO button

5

Focus



6

Shoot





Fine-Tuning the Focus



Autofocus



Focusing ring

After autofocusing when using a lens compatible with this feature, you can fine-tune the focus by turning the focusing ring.

1

Set the shooting mode



- **P** mode →
[SET] button

2

Access the menu screen



- **MENU** button →
[CAMERA] → [SET] button

3

Set up the camera

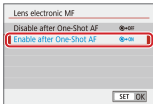

- [CAMERA] → [Lens electronic MF] →
[Enable after One-Shot AF]





Fine-Tuning the Focus



Autofocus



Focusing ring

After autofocusing when using a lens compatible with this feature, you can fine-tune the focus by turning the focusing ring.

4

Focus

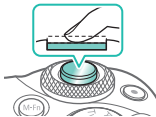

- Hold the shutter button halfway down.

5

Shoot





Easily Identifying the Focus Area (MF Peaking)



MF peaking off



MF peaking on

Edges of subjects in focus are displayed in color to make manual focusing easier. You can adjust the colors and the sensitivity (level) of edge detection as needed.

1

Set the shooting mode



- **P** mode →
[SET] button

2

Access the menu screen



- **MENU** button →
[CAMERA] → [SET] button

3

Set up the camera

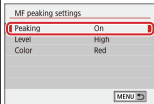

- [CAMERA] → [MF peaking settings] → [Peaking] → [On]

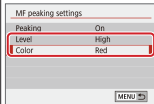

- Choose an item.



Choosing the AF Method



+Tracking



Zone AF



1-point AF

Change the auto focus (AF) mode to suit shooting conditions.

1

Set the shooting mode



- **P** mode →
SET button

2

Access the setting screen



3

Set up the camera



- **[AF □]** → choose an option



Magnifying Display to Check the Focus



Display can be magnified to check the focus when the AF method is set to [AF ()] or [AF □].

1

Set the shooting mode



● **P** mode →
SET button

2

Activate magnification



3

Zoom in or out, as needed

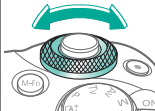



Magnifying Display to Check the Focus



Display can be magnified to check the focus when the AF method is set to [AF ()] or [AF □].

4

Choose an area to focus on



- Press the ▲/▼/◀▶ buttons to display an area to focus on.

- To center the display again, press the **INFO** button.



Shooting with Subject Eyes in Focus



In close-ups of people's faces, you can shoot with the subject's eyes in focus.

1

Set the shooting mode



- **P** mode →
[SET] button

2

Access the menu screen



- **MENU** button →
[CAMERA] → [SET] button

3

Set up the camera

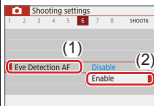

- [CAMERA] →
[Eye Detection AF]
→ [Enable]

4

Aim the camera at the subject





Shooting with Subject Eyes in Focus



In close-ups of people's faces, you can shoot with the subject's eyes in focus.

5

Shoot





Shooting with Servo AF



This mode helps avoid missing shots of subjects in motion, because the camera continues to focus on the subject and adjust the exposure as long as you press the shutter button halfway.

1

Set the shooting mode



- **P** mode →
[SET] button

2

Access the setting screen



3

Set up the camera



- [ONE SHOT] →
[SERVO]

4

Focus

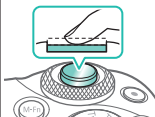



Shooting with Servo AF



This mode helps avoid missing shots of subjects in motion, because the camera continues to focus on the subject and adjust the exposure as long as you press the shutter button halfway.

5

Shoot





Changing the Focus Setting



Enable: Focus on moving subjects



Disable: Focus on stationary subjects

You can change default camera operation of constantly focusing on subjects it is aimed at, even when the shutter button is not pressed. Instead, you can limit camera focusing to the moment you press the shutter button halfway.

1

Set the shooting mode



- **P** mode →
[SET] button

2

Access the menu screen



- **MENU** button →
[CAMERA] → [SET] button

3

Set up the camera

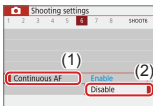

- [CAMERA 6] →
[Continuous AF] →
[Disable]



Choosing Subjects by Touch



AF □



AF ☺

You can choose subjects by touching a person's face or other things displayed on the screen.

1

Choose a subject



2

Shoot





Changing the IS Mode Settings



On



Off

Configure image stabilization via the camera menu when using an EF-M lens with image stabilization.

1

Set the shooting mode



- **P** mode →
[SET] button

2

Access the menu screen



- **MENU** button →
[CAMERA] → [SET] button

3

Set up the camera

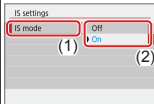

- [CAMERA] →
[IS settings] →
[IS mode] → choose
an option



Shooting

Flash



Auto Mode	Specific Scenes (Special Scene)	Image Effects (Creative Assist)
Image Effects (Creative Filters)	Manual Mode	Recording Movies in Movie Mode
Convenient Features		



Changing the Flash Mode



Adjusting the Flash Exposure Compensation



Shooting with the FE Lock



Changing the Flash Timing

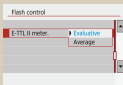

Changing the Flash Metering Mode



Adjusting the Flash Output



Changing the Flash Mode



You can change the flash mode to match the shooting scene.

1

Choose the flash mode



- ▶ button → choose an option



Adjusting the Flash Exposure Compensation



Set toward -



Set toward +

Just as with regular exposure compensation, you can adjust the flash exposure from -2 to +2 stops, in 1/3-stop increments.

1

Set the shooting mode

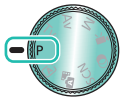

- **P** mode →
● button

2

Raise the flash



3

Set up the camera



- button → →
● **MENU** button

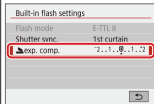

- [exp. comp.]





Adjusting the Flash Exposure Compensation



Set toward -



Set toward +

Just as with regular exposure compensation, you can adjust the flash exposure from -2 to $+2$ stops, in $1/3$ -stop increments.

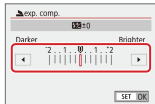

- Adjust as needed.



Shooting with the FE Lock



FE lock



Without FE lock
(overexposed)

Just as with the AE lock, you can lock the exposure for flash shots.

1

Set the shooting mode



- **P** mode →
[SET] button

2

Raise the flash



3

Choose the flash mode



- [▶] button → [⚡]

4

Lock the flash exposure



- [~~*~~⚡] is displayed, and the exposure is locked.





Shooting with the FE Lock



FE lock



Without FE lock
(overexposed)

Just as with the AE lock, you can lock the exposure for flash shots.

5

Compose the shot
and shoot





Changing the Flash Timing



1st-curtain flash



2nd-curtain flash

Change the timing of the flash and shutter release.

1

Set the shooting mode



- **P** mode →
[SET] button

2

Access the menu screen



- **MENU** button →
[CAMERA] → [SET] button

3

Set up the camera

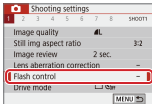

- [CAMERA 1] →
[Flash control]

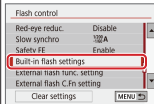

- [Built-in flash settings]





Changing the Flash Timing



1st-curtain flash



2nd-curtain flash

Change the timing of the flash and shutter release.

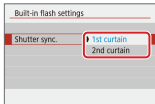

- [Shutter sync.]
→ choose an option



Changing the Flash Metering Mode

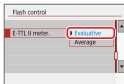

Evaluative

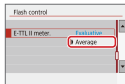

Average

[Evaluative] flash metering, which enables standard flash exposure, can be changed to average flash metering across the metering area, as when using an externally metered flash.

1

Set the shooting mode



- **P** mode →
[SET] button

2

Access the menu screen



- **MENU** button →
[CAMERA] → [SET] button

3

Set up the camera

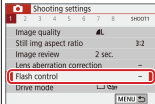

- [CAMERA] →
[Flash control]

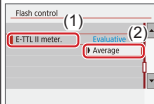

- [E-TTL II meter.] →
[Average]



Adjusting the Flash Output



Flash output:
Minimum



Flash output:
Maximum

Choose from the three flash levels in **Tv/Av/M** modes.

1

Set the shooting mode

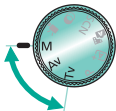

- **Tv/Av/M** modes → button

2

Access the menu screen



- **MENU** button → → button

3

Set up the camera

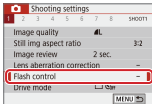

- [1] → [Flash control]

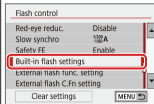

- [Built-in flash settings]





Adjusting the Flash Output



Flash output:
Minimum



Flash output:
Maximum

Choose from the three flash levels in **Tv/Av/M** modes.

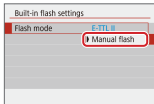

- [Flash mode] →
[Manual flash]

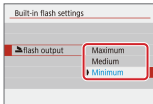

- [flash output] →
choose an option



Shooting

Specific Shutter Speeds and Apertures



Auto Mode	Specific Scenes (Special Scene)	Image Effects (Creative Assist)
Image Effects (Creative Filters)	Manual Mode	Recording Movies in Movie Mode
Convenient Features		



Specific Shutter Speeds
(Tv Mode)



Specific Aperture Values
(Av Mode)



Specific Shutter Speeds and
Aperture Values (M Mode)



Shooting Long Exposures
(Bulb)



Recording Movies at Specific
Shutter Speeds and Aperture Values



Specific Shutter Speeds (Tv Mode)



Slow



Fast

Set the shutter speed before shooting.
The camera automatically adjusts the aperture value to suit your shutter speed.

1

Set the shooting mode



- **Tv** mode →
Ⓢ button

2

Set the shutter speed



-  dial

3

Shoot





Specific Aperture Values (Av Mode)



Small



Large

Set the aperture value before shooting.
The camera automatically adjusts the shutter speed to suit your aperture value.

1

Set the shooting mode



- Av mode →
SET button

2

Set the aperture value



- dial

3

Shoot





Specific Shutter Speeds and Aperture Values (M Mode)



Set the shutter speed, aperture value, and ISO speed before shooting to obtain the desired exposure.

1

Set the shooting mode



- **M** mode →
[SET] button

2

Set the ISO speed



- Touch [ISO AUTO] →
[Left/Right] buttons

3

Set the shutter speed and aperture value



- Set the shutter speed:
[Gear] dial
- Set the aperture value:
[Up] button →
[Gear] dial





Specific Shutter Speeds and Aperture Values (M Mode)



Set the shutter speed, aperture value, and ISO speed before shooting to obtain the desired exposure.

4

Shoot





Shooting Long Exposures (Bulb)



With bulb exposures, shots are exposed for as long as you hold down the shutter button all the way down.

1

Set the shooting mode



- **M** mode →
●  button

2

Set up the camera



-  dial → [BULB]

3

Shoot





Recording Movies at Specific Shutter Speeds and Aperture Values



Manual movie

Set the shutter speed, aperture value, and ISO speed before recording.

1

Set the shooting mode

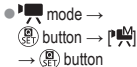

2

Set the ISO speed



● Touch [ISO AUTO]

3

Set the shutter speed and aperture value





Recording Movies at Specific Shutter Speeds and Aperture Values



Manual movie

Set the shutter speed, aperture value, and ISO speed before recording.

4

Start recording

- Set the shutter speed:



dial

- Set the aperture value: ▲ button →



dial





Shooting

Customizing the Camera



Auto Mode	Specific Scenes (Special Scene)	Image Effects (Creative Assist)
Image Effects (Creative Filters)	Manual Mode	Recording Movies in Movie Mode
Convenient Features		

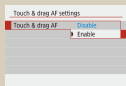

Configuring Touch & Drag AF

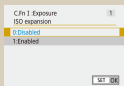

Configuring Custom Functions



Assigning Functions to Buttons



Configuring Touch & Drag AF



With Touch & Drag AF, you can move the AF point by touching or dragging the screen while looking through the viewfinder.

1

Set the shooting mode



- **P** mode →
[SET] button

2

Access the menu screen



- **MENU** button →
[CAMERA] → [SET] button

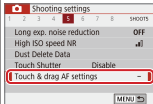

- [CAMERA] → [Touch & drag AF settings]

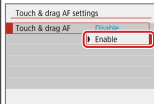

- [Touch & drag AF] → [Enable]



Configuring Custom Functions



Configure custom functions on the [F5] tab of the menu to customize how the camera works to suit your shooting preferences.

You can also assign commonly used functions to specific buttons.

1

Set the shooting mode



- P mode →
[SET] button

2

Access the menu screen



- MENU button →
[F5] → [SET] button

3

Set up the camera

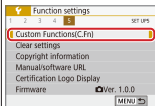

- [F5] → [Custom Functions(C.Fn)] →
choose an item

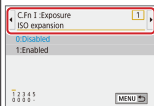

- Choose a function.





Configuring Custom Functions



Configure custom functions on the [Fn5] tab of the menu to customize how the camera works to suit your shooting preferences.

You can also assign commonly used functions to specific buttons.

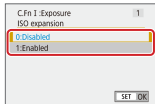

- Choose an option.



Assigning Functions to Buttons



Reassign functions of buttons, such as the shutter button, or assign common functions to the **M-Fn** button.

1

Set the shooting mode



- **P** mode →
[SET] button

2

Access the menu screen



- **MENU** button →
[Y] → [SET] button



- [Y5] → [Custom Functions(C.Fn)] → [Custom Controls]

3

Choose the control to assign

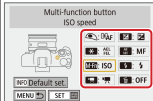

- Choose a button or dial to assign.





Assigning Functions to Buttons



Reassign functions of buttons, such as the shutter button, or assign common functions to the **M-Fn** button.

4

Choose the function to assign





Shooting



Auto Mode	Specific Scenes (Special Scene)	Image Effects (Creative Assist)
Image Effects (Creative Filters)	Manual Mode	Recording Movies in Movie Mode
Convenient Features		



Recording Movies



Locking Movie Brightness



Adjusting Movie Brightness



Disabling Auto Slow Shutter



Recording Time-Lapse Movies



Miniature Model Effect in Movies (Miniature Effect Movie)





Shooting



Auto Mode	Specific Scenes (Special Scene)	Image Effects (Creative Assist)
Image Effects (Creative Filters)	Manual Mode	Recording Movies in Movie Mode
Convenient Features		



Adjusting the Recording Volume



Deactivating the Wind Filter



Using the Attenuator



Correcting Camera Shake when Recording Movies



Recording Movies





Record movies in  mode using a variety of effects and features.

1

Set the shooting mode



-  mode →
-  button → choose
- a mode →  button

2

Start recording



3

Stop recording

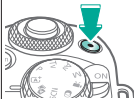



Locking Movie Brightness



You can lock the exposure while recording.

1

Set the shooting mode



- mode →
- button →
- button

2

Lock the exposure



- is displayed, and the exposure is locked.

3

Start recording





Adjusting Movie Brightness



Set toward -



Set toward +

With auto exposure, you can adjust exposure within a range of -3 to +3 stops.

1

Set the shooting mode



- mode →
- button → choose a mode → button

2

Adjust the exposure



- Set the exposure:
 - button →
 - dial

3

Start recording

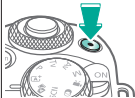



Disabling Auto Slow Shutter



Auto slow shutter can be disabled if movement in movies is rough. However, under low light, movies may look dark.

1

Set the shooting mode



- ▶ [video mode] →
- [SET] button → choose a mode → [SET] button

2

Access the menu screen



- [MENU] button → [camera icon] → [SET] button

3

Set up the camera

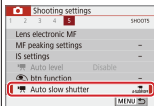

- [camera icon] [5] → [video mode] Auto slow shutter]



- [A-SLOW OFF]



Recording Time-Lapse Movies



Time-lapse movies combine images that are shot automatically at a specified interval. Any gradual changes of the subject (such as changes in a landscape) are played back in fast motion.

1

Set the shooting mode



- ▶ mode →
- Ⓜ button → choose a mode → Ⓜ button

2

Access the menu screen



- **MENU** button →
- 📷 → Ⓜ button

3

Set up the camera

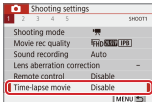

- [📷1] →
- [Time-lapse movie]

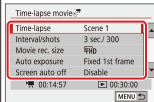

- [Time-lapse] →
- choose a scene → adjust as needed





Recording Time-Lapse Movies



Time-lapse movies combine images that are shot automatically at a specified interval. Any gradual changes of the subject (such as changes in a landscape) are played back in fast motion.

4

Return to the shooting screen



5

Secure the camera and start recording





Miniature Model Effect in Movies (Miniature Effect Movie)







 Miniature effect movie

Creates the effect of a miniature model in movies, by blurring image areas outside a selected area.

1

Set the shooting mode

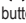

-  mode → 
-  button → choose a mode →  button

2

Access the setting screen



3

Set up the camera



-  [OFF] → choose an option





Miniature Model Effect in Movies (Miniature Effect Movie)



 Miniature effect movie

Creates the effect of a miniature model in movies, by blurring image areas outside a selected area.



- Move the frame:



- Move the AF point:



4

Return to the shooting screen



5

Start recording





Adjusting the Recording Volume



Adjusting the recording volume

When set to [Auto], the recording level (volume) is automatically adjusted during recording. If you prefer to adjust the level manually to suit the scene, change it to [Manual].

1

Set the shooting mode



- [Video camera] mode →
- [SET] button → choose a mode → [SET] button

2

Access the menu screen



- [MENU] button →
- [Camera icon] → [SET] button

3

Set up the camera

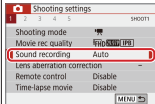

- [Camera icon 1] → [Sound recording]

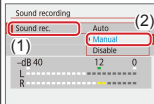

- [Sound rec.] → [Manual]





Adjusting the Recording Volume



Adjusting the recording
volume

When set to [Auto], the recording level (volume) is automatically adjusted during recording. If you prefer to adjust the level manually to suit the scene, change it to [Manual].

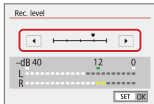

- [Rec. level] →
- buttons



Deactivating the Wind Filter



Noise from windy recording sites can be reduced with the wind filter. If there is no wind, recordings may sound unnatural when this option is used. In this case, set [Wind filter] to [Disable].

1

Set the shooting mode



- ▶ mode →
- Ⓜ button → choose a mode → Ⓜ button

2

Access the menu screen



- MENU button →
- Ⓜ → Ⓜ button

3

Set up the camera

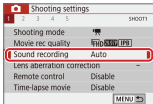

- [CAMERA 1] →
- [Sound recording]

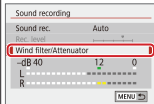

- [Wind filter/Attenuator]





Deactivating the Wind Filter



Noise from windy recording sites can be reduced with the wind filter. If there is no wind, recordings may sound unnatural when this option is used. In this case, set [Wind filter] to [Disable].

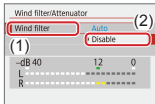

- [Wind filter] →
[Disable]



Using the Attenuator



Recording in noisy places

The attenuator can prevent audio distortion at noisy recording sites. Three options are available: [Enable], [Disable], or [Auto] for automatic activation/deactivation as needed.

1

Set the shooting mode



- [Microphone icon] mode →
- [SET] button → choose a mode → [SET] button

2

Access the menu screen



- **MENU** button →
- [Camera icon] → [SET] button

3

Set up the camera

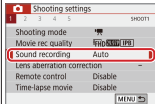

- [Camera 1] → [Sound recording]

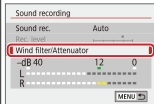

- [Wind filter/Attenuator]





Using the Attenuator



Recording in noisy places

The attenuator can prevent audio distortion at noisy recording sites. Three options are available: [Enable], [Disable], or [Auto] for automatic activation/deactivation as needed.

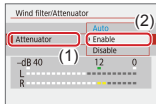

- [Attenuator] →
[Enable]



Correcting Camera Shake when Recording Movies



Enable



Disable

In-camera image stabilization corrects camera shake when you record movies. Camera shake can be corrected even without a lens that is equipped with image stabilization.

1

Set the shooting mode



- [Movie mode] → [SET] button → choose a mode → [SET] button

2

Access the menu screen



- [MENU] button → [Camera icon] → [SET] button

3

Set up the camera

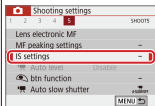

- [Camera icon] [5] → [IS settings]

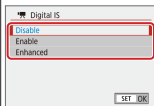

- [Camera icon] [Digital IS] → choose an option



Shooting



Auto Mode	Specific Scenes (Special Scene)	Image Effects (Creative Assist)
Image Effects (Creative Filters)	Manual Mode	Recording Movies in Movie Mode
Convenient Features		



Continuous Shooting



Using the Self-Timer



Shooting by Touching the Screen (Touch Shutter)



Changing Image Quality



Capturing in RAW Format

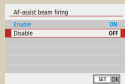

Preventing the AF-Assist Beam from Firing





Shooting



Auto Mode	Specific Scenes (Special Scene)	Image Effects (Creative Assist)
Image Effects (Creative Filters)	Manual Mode	Recording Movies in Movie Mode
Convenient Features		



Changing the Aspect Ratio



Changing Movie Recording Size

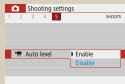

Using Auto Level



Continuous Shooting



Hold the shutter button all the way down to shoot continuously.

1

Set the shooting mode



- **P** mode →
[P] button

2

Access the setting screen



3

Set up the camera



- [Off] →
[H]/[L]

4

Shoot



- Keep holding the shutter button all the way down.



Using the Self-Timer



With the self-timer, you can include yourself in group photos or other timed shots. The camera will shoot about 10 seconds after you press the shutter button all the way down.

1

Set the shooting mode



- **P** mode →
[SET] button

2

Access the setting screen



3

Set up the camera



- [Off] → [10]

4

Shoot





Shooting by Touching the Screen (Touch Shutter)



With this option, instead of pressing the shutter button, you can simply touch the screen and release your finger to shoot. The camera focuses on subjects and adjusts image brightness automatically.

1

Set up the camera



- Touch [OFF] and change it to [Touch Shutter].

2

Shoot





Changing Image Quality



	24.0 megapixels/ high quality		Approx. 10.6 megapixels/high quality		Approx. 5.9 megapixels/high quality		Approx. 3.8 megapixels/ normal quality
	24.0 megapixels/ normal quality		Approx. 10.6 megapixels/ normal quality		Approx. 5.9 megapixels/ normal quality		

1

Set the shooting mode



- **P** mode →
 button

2

Access the setting screen



3

Set up the camera

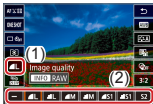

- → choose an option



Capturing in RAW Format



The camera can capture images in JPEG and RAW format. RAW images are “raw” data, before processing to create JPEGs.

1

Set the shooting mode



- **P** mode →
[SET] button

2

Access the setting screen



3

Set up the camera

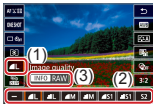

- [L] → choose
JPEG image quality
→ **INFO** button



- Choose the method
of shooting in RAW.



Preventing the AF-Assist Beam from Firing



The lamp lights up to help you focus when you press the shutter button halfway in low-light conditions. This lamp can be deactivated.

1

Set the shooting mode



- **P** mode →
[SET] button

2

Access the menu screen



- **MENU** button →
[CAMERA] → [SET] button

3

Set up the camera

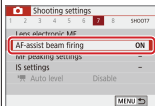

- [CAMERA] → [AF-assist beam firing]

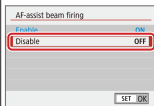

- [Disable]



Changing the Aspect Ratio



3:2



4:3



16:9



1:1

1

Set the shooting mode



- **P** mode →
SET button

2

Access the setting screen



3

Choose the setting item



- **[3:2]** → choose an option



Changing Movie Recording Size



Adjust the movie recording size. The frame rate indicates how many frames are recorded per second, and your options depend on the NTSC or PAL setting.

1

Set the shooting mode



- mode →
- button → choose a mode → button

2

Access the setting screen



3

Set up the camera



- (1) → choose an option



Using Auto Level



Auto leveling helps keep movies straight as you record them.

1

Set the shooting mode



- [video mode] →
- [MENU] button → choose a mode → [MENU] button

2

Access the menu screen



- [MENU] button →
- [camera icon] → [MENU] button

3

Set up the camera

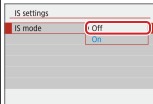

- [camera icon] [5] →
- [IS settings] →
- [IS mode] → [Off]

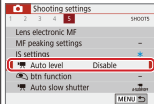

- [camera icon] [5] →
- [video mode] [Auto level]





Using Auto Level



Auto leveling helps keep movies straight as you record them.

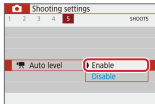

● [Enable]



Playback



Viewing	Finding	Managing
Erasing Images	Editing Stills	Applying Your Favorite Effects (Creative Assist)
Processing RAW Images with the Camera	Editing Movies	



Viewing Stills



Magnifying Images



Viewing Slideshows



Viewing Movies

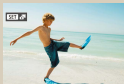

Viewing Digest Movies



Viewing Stills



After shooting images, you can view them on the screen.

1

Set display to
playback

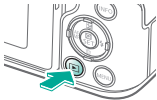

2

Browse your
images





Magnifying Images



Images you play back can be magnified.

1

Set display to playback

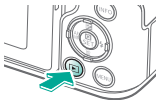

2

Browse your images



3

Magnify or reduce the image displayed



- Magnify: * button
- Magnify further: keep holding the * button
- Single-image display:  button







Magnifying Images



Images you play back can be magnified.







- Reduce:  button
- Reduce further: keep holding the  button

4

Move the area shown, as needed



- Move:     buttons
- Single-image display:  button



Viewing Slideshows



Automatically play back images from a memory card.

1

Set display to playback

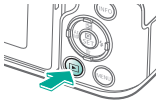

2

Access the menu screen



- **MENU** button → →

3

Set up the camera

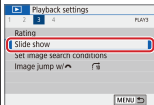

- [3] → [Slide show]

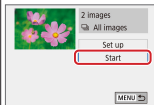

- [Start]



Viewing Movies



After recording movies, you can view them on the screen.

1

Set display to playback

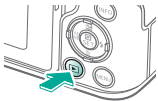

2

Browse your images



- Movies are labeled with [ ].

3

Play the movie



- ▲ button: Display movie playback panel





Viewing Movies



After recording movies, you can view them on the screen.

4

Adjust the volume



• ◀▶ buttons → [▶]



- Increase the volume:
▲ button
- Decrease the volume:
▼ button



Viewing Digest Movies



A short movie of scenes that include your shots in **A** mode is created automatically. Playing a digest movie shows the scenes captured that day.

1

Set display to playback

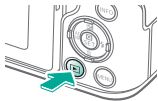

2

Browse your images



- Digest movies are labeled with **[SET]**

3

Play the movie





Viewing Digest Movies



A short movie of scenes that include your shots in **A^S** mode is created automatically. Playing a digest movie shows the scenes captured that day.

4

Adjust the volume



- Increase the volume:
▲ button
- Decrease the volume:
▼ button





Playback



Viewing	Finding	Managing
Erasing Images	Editing Stills	Applying Your Favorite Effects (Creative Assist)
Processing RAW Images with the Camera	Editing Movies	



Finding Images in an Index



Finding Images Matching
Specified Conditions



Finding Images with the
Main Dial



Finding Images in an Index



By displaying multiple images in an index, you can quickly find the images you are looking for.

1

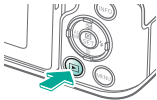

Set display to playback



2

Display images in an index



- Display multiple images:  button
- Increase the images per screen: press the  button repeatedly

3

Find the images



-  buttons



Finding Images Matching Specified Conditions



Find desired images quickly on a memory card full of images by filtering image display according to your specified conditions.

1

Set display to playback

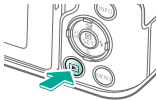

2

Access the setting screen



3

Find the images



● ▲/▼ buttons to navigate → ◀▶ buttons to adjust





Finding Images Matching Specified Conditions



Find desired images quickly on a memory card full of images by filtering image display according to your specified conditions.



- Matching images are displayed in yellow frames.



Finding Images with the Main Dial



Use the main dial to find and jump between desired images quickly according to your specified conditions.

1

Access the menu screen





- **MENU** button →  →  button

2

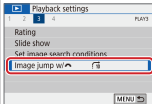
Specify a search condition



-  [3] → [Image jump w/ 

3

Set display to playback

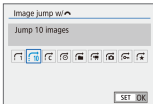
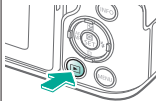

- Choose an option.





Finding Images with the Main Dial



Use the main dial to find and jump between desired images quickly according to your specified conditions.

4

Find the images

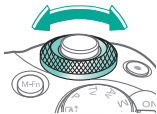



Playback



Viewing	Finding	Managing
Erasing Images	Editing Stills	Applying Your Favorite Effects (Creative Assist)
Processing RAW Images with the Camera	Editing Movies	

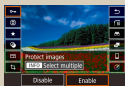

Protecting Individual Images

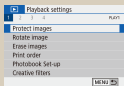

Protecting Multiple Images



Rating Images



Protecting Individual Images



Individual images can be protected to prevent accidental erasure of important images.

1

Set display to playback

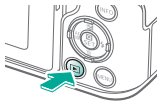

2

Browse your images



3

Access the setting screen



4

Protect



● [Key] → [Enable]



Protecting Multiple Images



Images can be protected either with [KEY] on the setting screen or with [Protect images] in the [PLAY] menu.

[Protect images] can be used for individual images, ranges of images, or entire folders or memory cards.

1

Access the menu screen



- MENU button → [PLAY] → [SET] button

2

Set up the camera

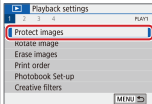

- [PLAY]1 → [Protect images]

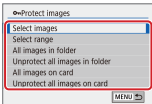

- Choose a selection method.



- Select images:
Choose an image → [SET] button





Protecting Multiple Images



Images can be protected either with [KEY] on the setting screen or with [Protect images] in the [▶] menu. [Protect images] can be used for individual images, ranges of images, or entire folders or memory cards.



- Select range: Choose the first image → choose the last image

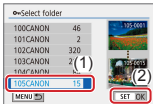

- All images in folder: Choose a folder → [OK]



- All images on card: [OK]



Rating Images



Organize images by rating them on a scale of 1 – 6.

1

Set display to playback

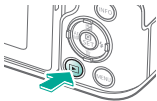

2

Browse your images



3

Access the setting screen



4

Set up the camera



● [**★**] → choose an option



Playback



Viewing	Finding	Managing
Erasing Images	Editing Stills	Applying Your Favorite Effects (Creative Assist)
Processing RAW Images with the Camera	Editing Movies	



Erasing Individual Images



Erasing Multiple Images
at Once



Erasing Individual Images



You can choose and erase unneeded images one by one. Be careful when erasing images, because they cannot be recovered.

1

Set display to playback

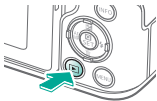

2

Browse your images



3

Erase



● [Erase]



Erasing Multiple Images at Once



You can choose multiple images to erase at once. Be careful when erasing images, because they cannot be recovered.

1

Access the menu screen



- **MENU** button →
[PLAY] → [SET] button

2

Set up the camera

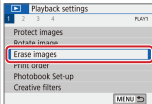

- [PLAY] 1 → [Erase images]

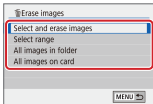

- Choose a selection method.





Erasing Multiple Images at Once



You can choose multiple images to erase at once. Be careful when erasing images, because they cannot be recovered.

- Select and erase images: Choose an image → **MENU** button → [OK]



- Select range: Choose the first image → choose the last image → **MENU** button → [OK]

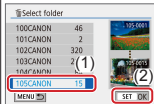

- All images in folder: Choose a folder → [OK]



Erasing Multiple Images at Once



You can choose multiple images to erase at once. Be careful when erasing images, because they cannot be recovered.

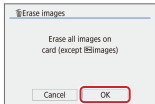

- All images on card:
[OK]



Playback



Viewing	Finding	Managing
Erasing Images	Editing Stills	Applying Your Favorite Effects (Creative Assist)
Processing RAW Images with the Camera	Editing Movies	



Applying Filter Effects
(Creative Filters)



Rotating Images



Correcting Red-Eye



Cropping



Resizing Images



Applying Filter Effects (Creative Filters)



Apply effects equivalent to shooting in [L/👤/📷/📱] modes to images and save them as separate images.

1

Set display to playback

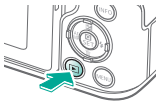

2

Browse your images



3

Access the setting screen



4

Set up the camera

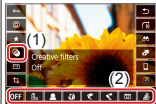

● [📷] → choose an option





Applying Filter Effects (Creative Filters)



Apply effects equivalent to shooting in [L/👤/👤/👤/👤] modes to images and save them as separate images.

5

Save



- Adjust the effect level:
◀▶ buttons

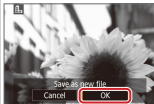

- (SET) button → [OK]



Rotating Images



Change the orientation of images and save them.

1

Set display to playback

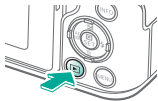

2

Browse your images



3

Access the setting screen



4

Rotate the image



- → choose an option



Correcting Red-Eye



Automatically corrects images affected by red-eye. You can save the corrected image as a separate file.

1

Access the menu screen



- **MENU** button → → button

2

Correct red-eye

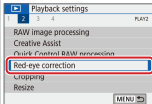

- [2] → [Red-eye correction]

3

Save



- Choose an image: buttons
- Correct: button
- [OK]



Cropping



You can specify a portion of an image to save as a separate image file.

1

Set display to playback

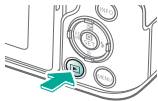

2

Browse your images



3

Access the setting screen



4

Crop the image





Cropping





You can specify a portion of an image to save as a separate image file.



- Move to another setting item:
 dial

- Resize or move the cropping frame, straighten the image, or change the aspect ratio.

- Resizing the frame
Reduce:  button
Enlarge:  button

- Move the frame:
 buttons



- Straighten the image:
 →  dial





Cropping





You can specify a portion of an image to save as a separate image file.





- Change the aspect ratio:  →  button



- Preview the image:  →  button



- Save as a new image:  →  button → [OK]



Resizing Images



Save a smaller version of an image, with fewer pixels.

1

Set display to playback

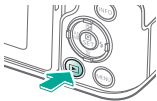

2

Browse your images



3

Access the setting screen



4

Resize



- → choose an option → button → [OK]



Playback



Viewing	Finding	Managing
Erasing Images	Editing Stills	Applying Your Favorite Effects (Creative Assist)
Processing RAW Images with the Camera	Editing Movies	



Applying Your Favorite Effects
(Creative Assist)



Applying Your Favorite Effects (Creative Assist)



Apply effects that you like to RAW images and save as new JPEGs.

1

Set display to
playback

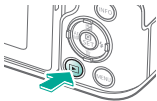

2

Choose a RAW
image



3

Access the setting
screen



4

Choose the setting
item





Applying Your Favorite Effects (Creative Assist)



Apply effects that you like to RAW images and save as new JPEGs.

5

Set up the camera



- ◀▶ buttons to choose an item



- ◀▶ buttons to set

6

Save



- [Grid] button → [OK]



Playback



Viewing	Finding	Managing
Erasing Images	Editing Stills	Applying Your Favorite Effects (Creative Assist)
Processing RAW Images with the Camera	Editing Movies	



Processing RAW Images



Processing RAW Images



Process images captured in RAW format on the camera. The original RAW image is retained, and a copy is saved as a JPEG.

Available when the mode dial is set to **P/Tv/Av/M**.

1

Access the menu screen



- **MENU** button →  →  button

2

Set up the camera

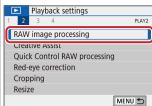

-  [2] → [RAW image processing]

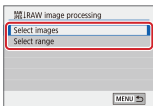

- Choose a selection method.



- Choose an image →  → **MENU** button





Processing RAW Images



Process images captured in RAW format on the camera. The original RAW image is retained, and a copy is saved as a JPEG.

Available when the mode dial is set to **P/Tv/Av/M**.

3

Check



- [Use shot settings] → [OK]

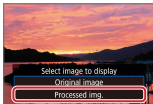

- [Processed img.]



Playback



Viewing	Finding	Managing
Erasing Images	Editing Stills	Applying Your Favorite Effects (Creative Assist)
Processing RAW Images with the Camera	Editing Movies	



Removing the Beginning/End
of Movies



Reducing File Sizes



Editing Digest Movies



Removing the Beginning/End of Movies



You can remove unneeded portions from the beginning and end of movies. Note that digest movies cannot be removed.

1

Set display to playback

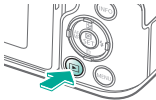

2

Browse your movies



- Choose a movie → ▲ button

3

Edit the movie



- Movie playback panel → [Edit]

4

Specify a portion to remove



- Cut beginning: [Beginning]
- Cut end: [End]





Removing the Beginning/End of Movies



You can remove unneeded portions from the beginning and end of movies. Note that digest movies cannot be removed.

5 Check



- ◀▶ buttons → decide the part to remove → SET button



- ▶▶

6 Save



- [New file] → choose an option



- Choose an option.



Reducing File Sizes



Movie file sizes can be reduced by compressing movies.

1

Set display to playback

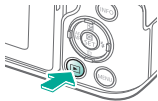

2

Browse your movies

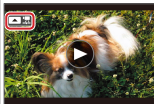

- Choose a movie → ▲ button

3

Edit the movie



- Movie playback panel → [PC] → [⌘]

4

Save



- [New file]





Reducing File Sizes



Movie file sizes can be reduced by compressing movies.



- [Compress & sav.]



Editing Digest Movies



Individual chapters (clips) recorded in **A** mode can be erased, as needed. Be careful when erasing clips, because they cannot be recovered.

1

Set display to playback

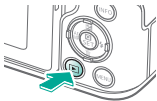

2

Browse your images



- Digest movies are labeled with **[SET]**.

3

Access the setting screen





Editing Digest Movies



Individual chapters (clips) recorded in **A** mode can be erased, as needed. Be careful when erasing clips, because they cannot be recovered.

4

Start and then pause playback

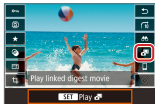

- [A] → [SET] button
→ [SET] button during playback

5

Select the clip to erase



6

Choose [Erase]



7

Erase



- [OK]



Wireless Features



Available Wireless Features

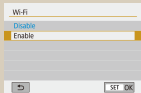

Preparing to Use Wireless Features



Connecting to Bluetooth Enabled Smartphones via Wi-Fi



Connecting to NFC-Compatible Android Smartphones via Wi-Fi



Connecting to Smartphones via Wi-Fi with the Wi-Fi Button



Available Wireless Features



Connecting to smartphones

Control the camera remotely and browse images on the camera over a Wi-Fi connection by using the dedicated Camera Connect app on smartphones or tablets.

You can also geotag images and use other features when connected by Bluetooth^{®*} and Wi-Fi.

* Bluetooth low energy technology (hereafter referred to as "Bluetooth")

Connecting to computers

Control the camera remotely from a computer connected via Wi-Fi by using EOS Utility, software used with EOS cameras. With Image Transfer Utility 2, images on the camera can also be sent to a computer automatically.

Connecting to printers

Print images over a Wi-Fi connection from printers compatible with PictBridge (wireless LAN) technology.

Connecting to Web services

Share images with friends or family on social media or the CANON iMAGE GATEWAY online photo service for Canon customers after you complete member registration (free of charge).



Preparing to Use Wireless Features



1

Turn the camera on

2

Set up a Wi-Fi connection

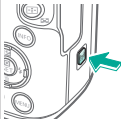

● (Wi-Fi) button

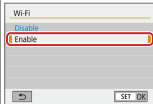

● [Wi-Fi] → [Enable]

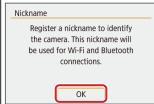

● (SET) button





Preparing to Use Wireless Features



- **MENU** button → [OK]

3

Exit the Wi-Fi settings

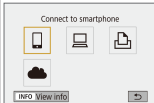

- Press the ((⌂)) button to dismiss this screen.

4

Install Camera Connect



- Download and install Camera Connect from the App Store/Google Play.



Connecting to Bluetooth Enabled Smartphones via Wi-Fi



1

Get ready



- See “Preparing to Use Wireless Features” (or when finished, go to the next step).

2

Pair with the smartphone



- **MENU** button → [F1] → [F1] → [Wireless communication settings]

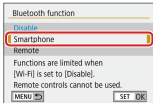

- [Bluetooth function] → [Bluetooth function] again → [Smartphone] → [SET] button

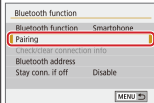

- [Pairing] → [Do not display]





Connecting to Bluetooth Enabled Smartphones via Wi-Fi



- On the smartphone, turn on Bluetooth and start Camera Connect.
- Touch the nickname of the camera for pairing.

- In iOS, also touch [Pair].

3

Use the camera to complete pairing

- On the pairing confirmation screen, choose [OK].
- On the pairing notification screen, press the  button.

4

Connect via Wi-Fi and use Camera Connect





Connecting to Bluetooth Enabled Smartphones via Wi-Fi



In Android



- Choose a function other than [Bluetooth remote controller].
- After the devices are connected via Wi-Fi, a screen for the selected function is displayed.

In iOS



- Choose a function other than [Bluetooth remote controller].
- Touch the button displayed on the smartphone to copy the password, as instructed.

- In the Wi-Fi settings displayed, choose the SSID of the camera to connect to.
- Touch the password field and paste the password to establish a connection.
- Display the Camera Connect screen.

- In a moment, a Wi-Fi connection is established, and a screen for the selected function is displayed on the smartphone.





Connecting to Bluetooth Enabled Smartphones via Wi-Fi



5

End the connection

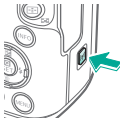

- ((P)) button → [Disconnect,exit] → [OK]

To reconnect



- To reconnect, simply touch the desired operation in Camera Connect.

To send images from the camera to a smartphone

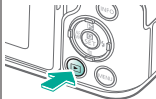

- During image playback, press the [SET] button.



- [Smartphone icon] → [SET] button → [SET] button





Connecting to Bluetooth Enabled Smartphones via Wi-Fi



- On the screen displayed, choose images and how to send them.





Connecting to NFC-Compatible Android Smartphones via Wi-Fi



1

Get ready

- See “Preparing to Use Wireless Features” (or when finished, go to the next step).

2

Establish the connection

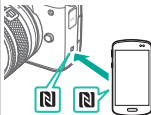

- Touch the **N** marks together.
- Camera Connect starts up on the smartphone, and the devices are connected automatically.

3

Establish a Wi-Fi connection



- [OK] → button
- [Wi-Fi on] is displayed on the camera.

4

Use Camera Connect



- Use Camera Connect to shoot remotely, browse images on the camera, or save them to the smartphone.





Connecting to NFC-Compatible Android Smartphones via Wi-Fi



5

End the connection

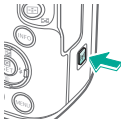

- When the [Wi-Fi on] screen is not displayed on the camera, ((P)) button → [Disconnect,exit] → [OK]

To reconnect

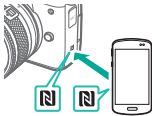

- Turn on the camera and smartphone and touch the **N** marks together.
- Once the devices are connected, you can use Camera Connect.

To send images from the camera to a smartphone

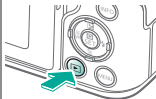

- During image playback, press the **SET** button.

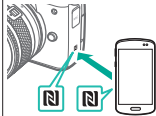

- Touch the **N** marks together.





Connecting to NFC-Compatible Android Smartphones via Wi-Fi



- Once the devices are connected, press the  button, and on the screen displayed, choose images and how to send them.





Connecting to Smartphones via Wi-Fi with the Wi-Fi Button



1

Get ready

- See “Preparing to Use Wireless Features” (or when finished, go to the next step).

2

Connect via Wi-Fi

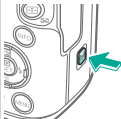

- button

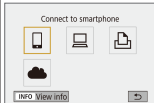

- → button



- [Register a device for connection] →
[Do not display] →
 button





Connecting to Smartphones via Wi-Fi with the Wi-Fi Button

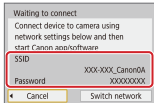

- Check the SSID and password.



- On the smartphone, find Wi-Fi networks and choose the one with the camera's SSID.

- On the smartphone, enter the password displayed on the camera.
- After confirming the Wi-Fi connection, start Camera Connect and choose the camera to connect to.



- On the camera: [OK] →  button





Connecting to Smartphones via Wi-Fi with the Wi-Fi Button



3

End the connection

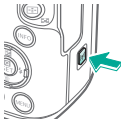

- ((P)) button → [Disconnect,exit] → [OK]

To reconnect



- Start Camera Connect.
- Touch [Easy Connection Guide] and choose a camera to connect to.

- To connect, follow the instructions shown in the guide.

To send images from the camera to a smartphone

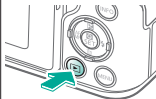

- During image playback, press the (SET) button.





Connecting to Smartphones via Wi-Fi with the Wi-Fi Button



-  →  button →  button

- On the screen displayed, choose images and how to send them.





Other Settings

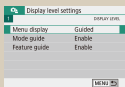

Adjusting Screens/Messages to Match Your Skill Level



Selecting and Creating Folders

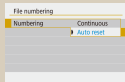

Changing File Numbering



Auto Rotation of Vertical Images

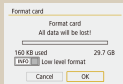

Formatting Memory Cards

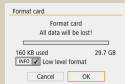

Low-Level Formatting

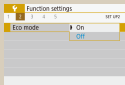

Using Eco Mode

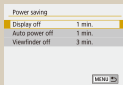

Adjusting Power-Saving Features



Changing the Display Language





Other Settings

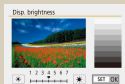

Adjusting Screen Brightness

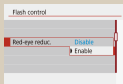

Reducing Red-Eye

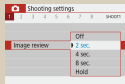

Changing the Image Display Period after Shots

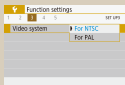

Changing the Video System

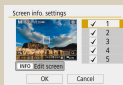

Customizing Shooting Information Display

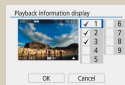

Customizing Playback Information Display

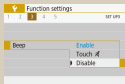

Muting Camera Sounds



Muting Audio Feedback

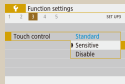

Adjusting the Touch-Screen Panel



Other Settings

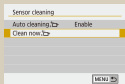

Activating Sensor Cleaning



Cleaning the Sensor Manually

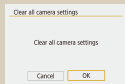

Restoring Default Camera Settings



Setting Copyright Information to Record in Images



Deleting All Copyright Information

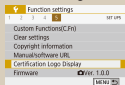

Checking Certification Logos



Adjusting Screens/Messages to Match Your Skill Level



You can adjust how information is presented to suit your ability or preference. You can also hide the guidance normally displayed when you switch shooting modes or choose setting items.

1

Access the menu screen



● **MENU** button

2

Set up the camera



● [Camera icon] → [SET] button

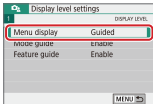

● Choose an item → choose an option



Selecting and Creating Folders



You can select or create folders where images are saved. New folders can be created by selecting [Create folder] on the folder selection screen.

1

Access the menu screen



- **MENU** button →
[MENU] → [SET] button

2

Access the folder selection screen

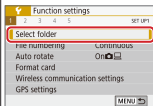

- [F1] → [Select folder]

3

Set up the camera

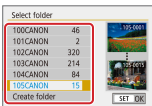

- Select folders: simply select a folder
- Create folders: [Create folder] → [OK]



Changing File Numbering



Your shots are automatically numbered in sequential order (0001 – 9999) and saved in folders that store up to 9,999 images each. You can change how the camera assigns file numbers.

1

Access the menu screen



- **MENU** button →
[Wrench] → [SET] button

2

Set up the camera

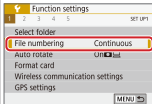

- [Wrench] → [File numbering]

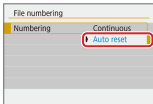

- [Auto reset]



Auto Rotation of Vertical Images



Specify whether images shot in vertical orientation are rotated automatically for larger display on the camera or a computer.

1

Access the menu screen



- **MENU** button →
[F] → [SET] button

2

Set up the camera

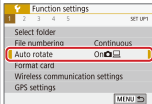

- [F1] → [Auto rotate]

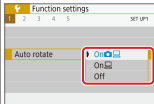

- Choose an option.



Formatting Memory Cards



Before using a new memory card or a card formatted in another device, you should format the card with this camera.

Formatting erases all data on a memory card, which cannot be recovered.

1

Access the menu screen



- **MENU** button →
[Wrench icon] → [SET] button

2

Set up the camera

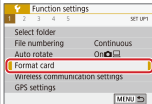

- [Wrench icon] → [Format card]

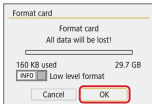

- [OK]



Low-Level Formatting



Perform low-level formatting if the camera is not working correctly, reading/writing of images on the memory card is slower, continuous shooting is slower, or movie recording suddenly stops.

Low-level formatting erases all data on a memory card, which cannot be recovered.

1

Access the menu screen



- **MENU** button →
[Wrench] → [SET] button

2

Set up the camera

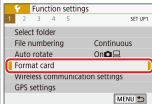

- [Wrench] →
[Format card]

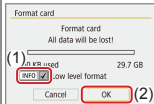

- **INFO** button to
select (✓) → [OK]



Using Eco Mode



This function allows you to conserve battery power in shooting mode. When the camera is not in use, the screen darkens to save battery life.

1

Access the menu screen

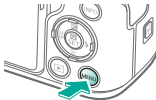

- **MENU** button →
[Y] → [SET] button

2

Choose the setting item

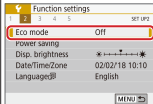

- [Y/2] → [Eco mode]

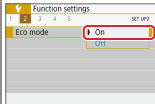

- [On]



Adjusting Power-Saving Features



Adjust the timing of automatic deactivation of the camera, screen, and viewfinder (Auto power off, Display off, and Viewfinder off).

1

Access the menu screen



- **MENU** button →
[F2] → [SET] button

2

Set up the camera

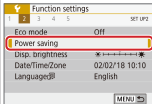

- [F2] → [Power saving]

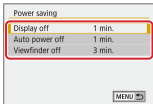

- Choose an item.

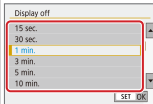

- Choose an option.



Changing the Display Language



Change the display language as needed.

1

Access the menu screen



- **MENU** button →
[KEY] → [SET] button

2

Choose the setting item

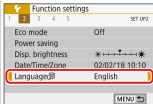

- [KEY] →
[Language] button

3

Set up the camera



- Choose a language
→ [SET] button



Adjusting Screen Brightness



Viewfinder and screen brightness can be adjusted separately.
Viewfinder brightness can be set when the viewfinder is active.

1

Access the menu screen



- **MENU** button →
[Y] → [SET] button

2

Set up the camera

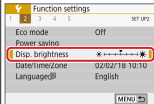

- [Y2] → [Disp. brightness]

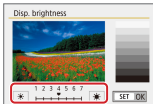

- Brighter: ► button
- Darker: ◀ button



Reducing Red-Eye



To help prevent red-eye, the camera can illuminate the red-eye reduction lamp before firing the flash in low-light shots.

1

Access the menu screen



- **MENU** button →
 → 

2

Set up the camera

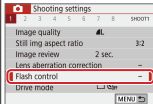

-  [1] → [Flash control]

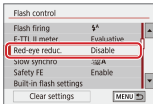

- [Red-eye reduc.]

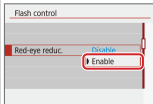

- [Enable]



Changing the Image Display Period after Shots



1

Access the menu screen



- **MENU** button →
 → 

2

Set up the camera

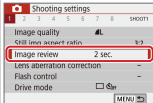

-  [1] → [Image review]

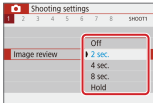

- Choose an option.



Changing the Video System



Set the video system of any television used for display. This setting determines the image quality (frame rate) available for movies.

1

Access the menu screen

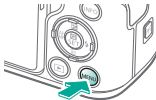

- **MENU** button →
[KEY] → [SET] button

2

Set up the camera

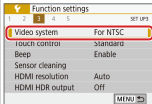

- [KEY] →
[Video system]

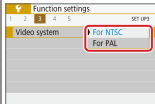

- Choose an option.



Customizing Shooting Information Display



A grid can be shown on the shooting screen. You can also choose the type of histogram shown when the **INFO** button is pressed.

1

Access the menu screen



- **MENU** button →
[Y] → [SET] button

2

Set up the camera

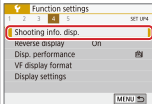

- [Y/4] →
[Shooting info. disp.]

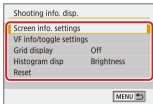

- Choose an item.

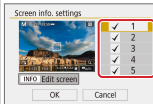

- Choose an option →
[OK]



Customizing Playback Information Display



The shooting information displayed changes each time you press the **INFO** button when display is set to playback. You can customize the information displayed.

1

Access the menu screen



- **MENU** button → [] → [] button

2

Set up the camera

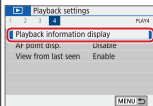

- [] → [Playback information display]

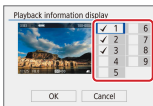

- Choose an option → [OK]



Muting Camera Sounds



Prevent the camera from playing sounds when you press the shutter button halfway or activate the self-timer.

1

Access the menu screen



- **MENU** button →
[Y] → [SET] button

2

Set up the camera

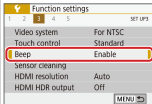

- [Y] → [Beep]

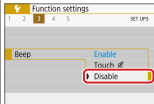

- [Disable]



Muting Audio Feedback



Prevent the camera from playing sounds as feedback after camera operations, such as pressing buttons or touching the screen.

1

Access the menu screen



- **MENU** button →
[Y] → [SET] button

2

Set up the camera

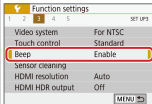

- [Y] → [Beep]

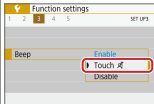

- [Touch]



Adjusting the Touch-Screen Panel



Sensitivity of the touch-screen panel can be increased, so that the camera responds to a lighter touch.

1

Access the menu screen



- **MENU** button →
[KEY] → [SET] button

2

Set up the camera

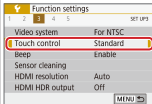

- [KEY] →
[Touch control]

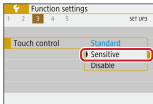

- [Sensitive]



Activating Sensor Cleaning



The image sensor is automatically cleaned to remove dust whenever you turn the camera on or off, or when the camera shuts off in Power saving mode. You can activate cleaning as needed.

1

Access the menu screen



- **MENU** button →
[F] → [SET] button

2

Set up the camera

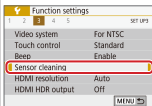

- [F3] → [Sensor cleaning]

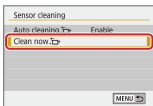

- [Clean now] →

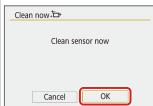

- [OK]



Cleaning the Sensor Manually



Any dust that remains after automatic cleaning can also be removed by using an optional blower or other specialized tool.

The surface of the image sensor is extremely delicate. If the sensor must be cleaned manually, we recommend requesting service from a Customer Support Help Desk.

1

Make sure the camera is off

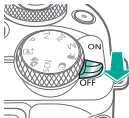

2

Detach the lens



3

Clean the sensor





Restoring Default Camera Settings



Restore default camera settings in **P/Tv/Av/M** modes.

You can also clear custom functions (except [Custom Controls] settings) by using [Clear all Custom Func. (C.Fn)].

1

Access the menu screen



- **MENU** button →
[F] → [SET] button

2

Set up the camera

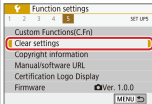

- [F5] → [Clear settings]

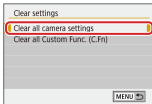

- [Clear all camera settings]

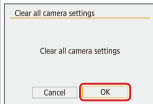

- [OK]



Setting Copyright Information to Record in Images



To record the author's name and copyright details in images, set this information beforehand.

1

Access the menu screen



- **MENU** button →
[F] → [SET] button

2

Set up the camera

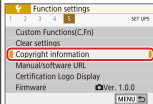

- [F]5 → [Copyright information]



- Choose an item.



- Enter a name →
MENU button →
[OK]



Deleting All Copyright Information



You can delete both the author's name and copyright details at the same time.

1

Access the menu screen

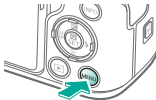

- **MENU** button →
[F] → [SET] button

2

Set up the camera

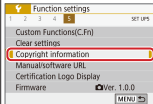

- [F5] → [Copyright information]



- [Delete copyright information] → [OK]



Checking Certification Logos



Some logos for certification requirements met by the camera can be viewed on the screen. Other certification logos appear in this manual, on the camera packaging, or on the camera body.

1

Access the menu screen



- **MENU** button →
[Wrench] → [SET] button

2

Check

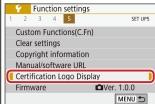

- [Wrench]5 → [Certification Logo Display]



Numbers

1-point AF 148

A

AEB shooting 114

AE lock 115

AF points 148

AF-point zoom 143

Aspect ratio 208

Auto Lighting Optimizer 119

Auto mode (shooting mode) 42

Av (shooting mode) 171

B

Battery pack

Charging 22

Eco mode 284

Black and white images 98

Bulb exposure 174

C

Camera

Resetting 298

Camera Connect 261

CANON IMAGE GATEWAY 260

Charging 22

Chromatic aberration correction 136

Cleaning (image sensor) 296, 297

Close-up (shooting mode) 87, 89

Color temperature 133, 134

Color (white balance) 129

Compression 205

Creative Assist (shooting mode) 94

Creative filters 238



Index



Cropping 242

Custom white balance 130

D

Date/time/zone

Settings 27

Display language 30

Display period 289

E

Eco mode 284

Editing

Cropping 242

Red-eye correction 241

Resizing images 245

Erasing 233, 234

Exposure

AE lock 115

Compensation 113

FE lock 162

Eye Detection AF 151

F

Face+Tracking 148

Favorites 231

FE lock 162

File numbering 280

Fish-eye effect (shooting mode) 98, 100

Flash

FE lock 162

Flash exposure compensation 160

Flash metering 166

Flash output 167



Index



Flash timing 164

Mode 159

Flash exposure compensation 160

Focusing

AF points 148

MF peaking 147

Servo AF 153

Focus range

Manual focus 143

Food (shooting mode) 87, 89

G

Grainy B/W (shooting mode) 98

Grid lines 291

H

Handheld night scene

(shooting mode) 87, 90

HDR art bold (shooting mode) 98, 102

HDR art embossed (shooting mode) 98, 102

HDR art standard (shooting mode) 98, 101

HDR art vivid (shooting mode) 98, 101

HDR Backlight Control

(shooting mode) 87, 90

High ISO speed noise reduction 138

Hybrid Auto (shooting mode) 84

I

Image dust prevention 296, 297

Images

Display period 289

Erasing 233, 234



Index



Image stabilization 157

Index display 222

Indicator 75

ISO speed 116

J

Jump display 225

L

Lamp 207, 288

Landscape (shooting mode) 87, 88

Lens

- Attaching 31, 34

- Detaching 33, 35

- Lock release 33, 35

Long exposure 174

Long exposure noise reduction 140

M

Macro photography 89

Magnified display 214

Manual focus 143

Memory cards 24

Menu

- Basic operations 70

- Touch operations 79

Metering method 118

MF (Manual focusing) 143

M-Fn button 53, 181

MF peaking 147

Miniature effect movie (shooting mode) 191

Miniature effect (shooting mode) 103



Index



Movies

Editing 253, 255, 257

Image quality

(pixel count/frame rate) 209

M (shooting mode) 172

Multi-function button 53, 181

Multi Shot Noise Reduction 139

N

Noise reduction

High ISO speed 138, 139

Long exposure 140

P

Panning 91

Part names 52

Peripheral illumination correction 136

Picture Style 124, 125, 127

Pixel count (image size) 205

Playback

Digest movies 219

Image search 223

Index display 222

Jump display 225

Magnified display 214

Movies 217

Slideshows 216

Stills 213

Touch operations 81

Portrait (shooting mode) 87

Protect images 228, 229

Protecting 228, 229

P (shooting mode) 113



Q

Quick Control screen

 Basic operations 68

 Touch operations 77

R

Rating 231

RAW 206

RAW image processing 250

Red-eye correction 241

Resetting 298

Resizing images 245

Rotating 240

S

Saturation 125

Screen

 Display language 30

Searching 223

Self portrait (shooting mode) 87, 88

Self-timer

 Using the self-timer 203

Sending images to

 a smartphone 263, 268, 271

Sensor cleaning 296

Servo AF 153

Silent Mode (shooting mode) 87, 90

Slideshows 216

Smooth skin (shooting mode) 87, 88

Soft focus (shooting mode) 98, 100

Sounds 293, 294

Sports (shooting mode) 87, 89

Strap 21



T

- Time-lapse movie (shooting mode) 189
- Tone priority 120
- Touch Shutter 204
- Toy camera effect (shooting mode) 98, 101
- Tv (shooting mode) 170

W

- Water painting effect
(shooting mode) 98, 100
- White balance (color) 129
- Wind filter 195
- Wireless features 260

Z

- Zone AF 148
- Zoom 43, 46



Precautions for Wireless Features



- Before goods or technologies in the camera regulated by the Foreign Exchange and Foreign Trade Act are exported (which includes bringing them outside Japan or showing them to non-residents in Japan), export or service transaction permission may be required from the Japanese government.
- Because this product includes American encryption items, it falls under U.S. Export Administration Regulations, and cannot be exported to or brought into a country under U.S. trade embargo.
- Be sure to make notes of the Wi-Fi settings you use.
- The wireless settings saved to this product may change or be erased due to incorrect operation of the product, the effects of radio waves or static electricity, or accident or malfunction.
- Please note that Canon accepts no responsibility for direct or indirect damages or loss of earnings resulting from a degradation or disappearance of content.
- When transferring ownership, disposing of the product, or sending it for repair, restore the default wireless settings by erasing any settings you have entered.
- Canon will not make compensation for damages resulting from loss or theft of the product.
- Canon accepts no responsibility for damages or loss resulting from unauthorized access or use of target devices registered on this product due to loss or theft of the product.
- Be sure to use the product as directed in this manual.





Precautions for Wireless Features



- Be sure to use the wireless function of this product within the guidelines noted in this manual. Canon accepts no responsibility for damages or loss if the function and product are used in ways other than as described in this manual.





Trademarks and Licensing



- Microsoft and Windows are trademarks or registered trademarks of Microsoft Corporation in the United States and/or other countries.
- Macintosh and Mac OS are trademarks of Apple Inc., registered in the U.S. and other countries.
- App Store, iPhone, and iPad are trademarks of Apple Inc.
- The SDXC logo is a trademark of SD-3C, LLC.
- HDMI, the HDMI logo and High-Definition Multimedia Interface are trademarks or registered trademarks of HDMI Licensing LLC.
- Wi-Fi[®], Wi-Fi Alliance[®], WPA[™], WPA2[™] and Wi-Fi Protected Setup[™] are trademarks or registered trademarks of the Wi-Fi Alliance.
- The Bluetooth[®] word mark and logos are registered trademarks owned by Bluetooth SIG, Inc. and any use of such marks by Canon Inc. is under license. Other trademarks and trade names are those of their respective owners.
- The N-Mark is a trademark or registered trademark of NFC Forum, Inc. in the United States and in other countries.
- All other trademarks are the property of their respective owners.
- This device incorporates exFAT technology licensed from Microsoft.





Trademarks and Licensing



- This product is licensed under AT&T patents for the MPEG-4 standard and may be used for encoding MPEG-4 compliant video and/or decoding MPEG-4 compliant video that was encoded only (1) for a personal and non-commercial purpose or (2) by a video provider licensed under the AT&T patents to provide MPEG-4 compliant video. No license is granted or implied for any other use for MPEG-4 standard.





Disclaimer



- Unauthorized reproduction of this guide is prohibited.
- All measurements based on Canon testing standards.
- Information subject to change without notice, as are product specifications and appearance.
- Illustrations and screenshots in this guide may differ slightly from the actual equipment.
- The above items notwithstanding, Canon cannot be held liable for any loss arising from the use of this product.

Canon