

# Nilfisk

D 130.4 X-TRA

D 140.4 X-TRA

D-PG 130.4 X-TRA

D-PG 140.4 X-TRA

Instructions for use



EN	User Manual .....	3 - 19
DA	Instruktionsbog .....	20 - 36
NO	Instruksjonsbok.....	37 - 53
SV	Instruktionsbok.....	54 - 70
FI	Käyttöohje.....	71 - 87
DE	Betriebsanleitung.....	88 - 105
FR	Instructions d'utilisation.....	106 - 125
NL	Gebruiksaanwijzing.....	126 - 143
IT	Istruzioni sull'uso .....	144 - 161
ES	Instrucciones de manejo.....	162 - 178
PT	Instruções de operação .....	179 - 196
EL	Οδηγίες χρήσης .....	197 - 215
TR	Kullanım Kılavuzu .....	216 - 234
CS	Návod k obsluze .....	235 - 251
HU	Használati útmutató .....	252 - 268
PL	Instrukcja użycia .....	269 - 286
HR	Priručnik za korisnike.....	287 - 303
SL	SL Navodila za uporabo.....	304 - 320
SK	Návod na používanie .....	321 - 338
LV	Lietošanas instrukcijae .....	339 - 355
LT	Naudojimosi instrukcija .....	356 - 372
ET	Kasutamishend .....	373 - 389
RU	Руководство.....	390 - 409
ZH	操作说明 .....	410 - 424

## Contents

<b>1</b>	<b>Introduction</b> .....	<b>4</b>
	1.1 Symbols used to mark instruction.....	4
<b>2</b>	<b>Safety precautions and working techniques</b> .....	<b>4</b>
<b>3</b>	<b>Before you start using your high pressure washer</b> .....	<b>10</b>
	3.1 Mounting of trolley handle, hose hook and hose reel .....	10
	3.2 Mounting of quick coupling .....	10
	3.3 Telescopic handle .....	10
	3.4 Mounting of Battery (Cell battery – CR 2032) – Only for models with Wireless regulation .....	11
<b>4</b>	<b>Operating your high pressure washer</b> .....	<b>11</b>
	4.1 Connection of high pressure hose .....	11
	4.2 Mounting of spray lance and Click&Clean nozzles .....	11
	4.3 Water Connection .....	11
	4.4 Starting the high pressure washer .....	12
	4.5 Pressure regulation on the TORNADO® PR-nozzle.....	13
	4.6 Stationary use.....	13
	4.7 Pairing the machine (Models with wireless regulation).....	13
	4.8 Using wireless regulation (Models with wireless regulation).....	13
<b>5</b>	<b>Fields of application and working methods</b> .....	<b>13</b>
	5.1 General.....	13
	5.2 Typical fields of application .....	14
<b>6</b>	<b>After using the pressure washer</b> .....	<b>15</b>
	6.1 Stopping the high pressure washer .....	15
<b>7</b>	<b>Maintenance</b> .....	<b>15</b>
<b>8</b>	<b>Troubleshooting</b> .....	<b>16</b>
<b>9</b>	<b>Accessories and detergents</b> .....	<b>17</b>
<b>10</b>	<b>Warranty Conditions</b> .....	<b>17</b>
<b>11</b>	<b>Main technical Data</b> .....	<b>18</b>
<b>12</b>	<b>Declaration of Conformity</b> .....	<b>19</b>

# 1 Introduction

## 1.1 Symbols used to mark instruction

All pictograms attached to the high pressure washer and its components are shown and explained in this manual.



Safety instructions marked with this symbol must be observed to prevent personal injury or serious damage to property.



Caution where there is a risk of damaging the machine or its individual components.



This symbol indicates tips and instructions to simplify work and to ensure a safe operation of the high pressure washer.

## 2 Safety precautions and working techniques



Before starting up your machine for the first time, this instruction manual must be read through carefully. Save the instructions for later use.



### WARNING!

- Inhalation of aerosols can be hazardous to health. Where applicable use a device in order to avoid or reduce aerosols production, e.g., a shield covering the nozzle. For protection against aerosols use a respiratory mask of class FFP 2 or higher.
- The high water pressure generated by the machine and the power connection are particular sources of danger.
- Machines shall not be used by children or untrained personnel. Children should be supervised to ensure that they do not play with the machine.
- Do not use the machine within range of persons unless they wear protective clothing.
- Before starting up your machine please check it carefully for any defects. If you find any, do not start up your machine, contact your Nilfisk distributor. The insulation of the electric cable should be faultless and without any cracks. If the electric cable is damaged, an authorized Nilfisk distributor should replace it.
- Always unplug the power plug before cleaning or maintenance and when replacing parts or converting the machine to another function.

- Observe the national safety regulations issued, for example, by the employers liability insurance association, social security institutions, occupational safety and health authorities or other organizations.



### **Accessories and spare parts**

- To ensure the machine safety only use original spare parts from Nilfisk or approved by Nilfisk.
- High pressure hoses, fittings and couplings are important for the safety of the machine. Only use hoses, fittings and couplings recommended by Nilfisk.



### **Physical, sensory or mental conditions**

- This machine is not intended for use by persons (including children) with reduced physical, sensory or mental capabilities or lack of experience and knowledge. If the machine is used by people with reduced physical, sensory or mental capabilities or lack of experience and knowledge they shall have been given supervision or instruction concerning use of the machine in a safe way and understand the hazards involved.



### **Applications**

This machine has been developed for domestic use such as:

- Car, motorbike, boat, caravan, trailer, patio/drive/flagstones, woodwork, brickwork, barbecue, garden furniture, lawn mower.

Any other use is considered as improper use. Nilfisk accepts no liability for any damage resulting from such use. The risk for such use is borne solely by the user. Proper use also includes proper operation, servicing and repairs as specified in this instruction.

### **Clothing and equipment**

Always take action to protect yourself when operating the machine.

- Wear shoes with non-slip soles.
- Wear goggles, ear protection and protective clothes

EN

during operation.

DA



### Transporting the high pressure washer

- When transporting the machine in or on a vehicle, it must be secured, e.g. with straps, so that it cannot slip or tip over.
- Nilfisk recommends that the machine is positioned horizontally on the backside, when transported in or on a vehicle.

NO

SV

FI

DE

FR



### Detergents

- This machine has been designed for use with cleaning agents supplied or recommended by Nilfisk. The use of other cleaning agents or chemicals may adversely affect the function of the machine.

NL

IT

ES



### Before starting the work Inspecting the machine

- Do not use the machine if a supply cord or important parts of the machine are damaged, e.g., safety device, high pressure hose, and spray handle and spray attachments.
- The trigger of the spray handle must move easily and automatically return to its starting position when released.
- Always keep high pressure hose and spray attachment in good condition (clean, moving easily) and correctly assembled.

PT

EL

TR

CS

HU

PL

HR

SL

### Electrical connection



## WARNING!

Minimize the risk for electrical shock:

- Voltage and frequency of the machine (see rating plate) must match the voltage of and frequency of the mains supply.
- Only connect the machine to electrical installation made by a certified electrician and comply with IEC 60364-1.
- It is recommended that the electrical supply to the

SK

LV

LT

ET

RU

ZH

machine should include a residual current device that will interrupt the supply if the leakage current to earth exceeds 30 mA for 30 ms.

- Inadequate extension cables can be dangerous. If an extension cable is used, it shall be suitable for outdoor use, and the connection has to be kept dry and off the ground.
- Nilfisk recommends use of an extension cable drum when cable extension is needed which keeps the socket at least 60 mm above the ground.
- If the electric cable is damaged, it must be replaced by an authorized Nilfisk distributor or similar qualified person in order to avoid a hazard.



### Water connection

- This high pressure washer is only allowed to be connected with the drinking water mains, when an appropriate backflow preventer has been installed, Type BA according to EN 60335-2-79.
- The backflow preventer can be ordered under number 106411177.
- As soon as drinking water has flown through the backflow preventer, it is no longer regarded as drinking water.
- Operation by suction (e.g. a rainwater vessel) is carried out without a backflow preventer – see “**Connecting to a pressureless water supply**”. The machine can be connected to water mains with a max. inlet-pressure of 1 MPa/10 bars and max. 60°C.

### Safety devices

#### Locking device on spray handle:

- The spray handle features a locking device. When the pawl is activated, the spray handle cannot be operated.

#### Thermal sensor:

- A thermal sensor protects the motor against overloading. The machine will restart after a few minutes when the thermal sensor has cooled.

EN

DA

NO

SV

FI

DE

FR

NL

IT

ES

PT

EL

TR

CS

HU

PL

HR

SL

SK

LV

LT

ET

RU

ZH

## Pressure safety device:

- An integrated hydraulic safety valve protects the system from excessive pressure.

## During work



### WARNING!

- It is not allowed to clean asbestos-containing surfaces with high pressure.
- Risk of explosion – Do not spray flammable liquids.
- Never draw in fluids containing solvents (e.g., gasoline, heating oil, paint thinner or acetone) These substances damage the materials used in the machine. Their spray is highly combustible, explosive and poisonous.
- Never direct the water jet at yourself, other persons, not even to clean clothing or footwear - **risk of injury**.
- Never direct the water jet at pets or other animals.
- Never direct the water jet at live electrical equipment or the machine itself - **danger of short-circuiting**.
- The spray lance is affected by a kickback force less than 20N and a sudden torque when activating the trigger of the spray handle during operation.
- This high pressure washer machine must not be operated at temperatures below 0°C.
- Never start up a frozen machine. Frost damages are not covered by the guarantee!
- Always ensure firm and safe footing.
- The machine shall be operated in an upright position.
- If the machine is left or not used for 5 minutes, it must be switched off on the start/stop switch "O" (1).

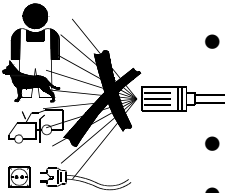

## After finishing the work



### WARNING!

- Always switch off the machine and unplug the power plug from the socket after work and when leaving the machine unattended.
- Disconnect water inlet hose between machine and water supply.



- Always empty pump, hose and accessories of water after use of the machine and prior to storing.

EN

DA

NO

SV

FI

DE

FR

NL

IT

ES

PT

EL

TR

CS

HU

PL

HR

SL

SK

LV

LT

ET

RU

ZH

## Maintenance and repairs



### WARNING!

- Always disconnect the electrical plug from the socket prior to maintenance, cleaning and repair.
- Any repair should always be made in Nilfisk authorized workshop with original Nilfisk spare parts.
- Do not attempt any maintenance not described in the instructions.
- If the machine refuses to start, stops, pulsates, pressure fluctuates, motor busses, fuse blows or no water comes out, check the trouble shooting diagram in these instructions. In case other problems occur, please contact your local Nilfisk distributor.

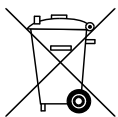

### Recycling the high pressure washer

Make the old machine unusable immediately.

- Unplug the machine.
- Cut the electric cable.
- The battery must be removed from the appliance before it is scrapped; the battery is to be disposed of safely.

Do not discard electrical appliances with household waste. As specified in WEEE Directive 2012/19/EC on old electrical and electronic appliances, used electrical goods must be collected separately and recycled ecologically. Contact your local authorities or your nearest dealer for further information.

## 3 Before you start using your high pressure washer

A



See the pictorial quick reference guide – unpacking.

Illustration shows the operation elements and how to prepare your machine for use.

### Operation elements

1. Start/stop switch
2. Water inlet with filter
3. High pressure connection (models without hose reel)
4. High pressure hose (models without hose reel)
5. Electric cable
6. Click&Clean spray lance
7. Spray handle with lock (7a)
8. Click&Clean Tornado nozzle
9. Click&Clean Tornado PR nozzle
10. Click&Clean Powerspeed nozzle
11. Foam sprayer
12. Nozzle cleaning tool
13. Hose reel
14. Model tag
15. Trolley handle (telescopic handle)
16. Hose hook (models without hose reel)
17. Hexagon key for handle and bracket mounting and lid for battery
18. Button for telescopic handle
19. Turnable cable hook
20. Quick coupling

### 3.1 Mounting of trolley handle, hose hook and hose reel

#### Mounting of trolley handle and hose hook (standard models)

- A1** Push down the trolley handle (15) over the two metal tubes. Make sure that the handle is mounted as illustrated. Mount screws with nuts (make sure that the screws go through handle as well as tube).
- A2** Mount the hose hook (16) on the handle (2 screws).

#### Mounting of hose reel handle (models with hose reel)

- A3** Click the hose reel handle on to the trolley handle (no screws).

### 3.2 Mounting of quick coupling

- A4** When mounting the quick coupling for the first time, check that the factory fitted filter is positioned in the water inlet pipe.
- A5** Screw the quick coupling tight on to the water inlet (2).

#### IMPORTANT!



The inlet filter must always be fitted in the water inlet pipe to filter out sand, limestone and other impurities as these will damage the pump valves. The filter is factory fitted.

If the filter is removed this will invalidate the guarantee.

### 3.3 Telescopic handle

- A6** The machine features a telescopic handle. To raise or lower the handle, press the button (18) and move the handle upwards or downwards. When a click is heard, the handle is in right position.

### 3.4 Mounting of Battery (Cell battery – CR 2032) – Only for models with Wireless regulation

- A7** Unscrew (1) the lid (2) to access the battery compartment in the wireless spray handle. Gently push the battery (3) into the battery holder (4), + sign facing upwards as illustrated.  
Mount the lid (1) to the battery compartment (2). Make sure that the lid gasket (3) is still placed properly in the groove at the spray handle.
- A8** When the battery is mounted correctly, the orange LED (1) will flash for two minutes or until the spray handle has been paired with the machine. If pairing is not executed within 2 min., the spray handle enters into stand-by mode (battery saving) -> for pairing see section 4.7.
- If in standby mode and no pairing is in place, then the pairing process can be revitalized by pressing the up/down keys to activate the spray handle. Orange LED will then flash until pairing is completed or resuming standby mode.



#### IMPORTANT!

When the battery runs out and you insert a new battery, the old battery must be disposed of safely.

## 4 Operating your high pressure washer

**B**



See the pictorial quick reference guide – operating your high pressure washer.

### 4.1 Connection of high pressure hose

- B1** Attach the high pressure hose (4) to the spray handle (7). Detach the high pressure hose by pressing the pawl (A).
- B2** Mount the high pressure hose on the outlet (3) (models without hose reel).

### 4.2 Mounting of spray lance and Click&Clean nozzles

- B3** Push the spray lance (6) into the spray handle (7), twist and release.



#### NOTE!

The spray lance has a built-in low pressure nozzle that can be used for flushing away dirt.

- B4** When attaching the nozzles (8, 9,10), press the nozzles into the spray lance.



#### IMPORTANT!

When attaching the click & Clean nozzles, the pawl on the side of the spray lance should come out again. The nozzle should stay in position when pulling it.

- B5** Push the foam sprayer (11) into the spray lance (6).



#### NOTE!

The foam sprayer features a swivel lock, which must be positioned in the hole in the Click & Clean spray lance. Press the pawl to detach the Click & clean nozzles and the foam sprayer.



#### IMPORTANT!

Before starting the cleaning job, check that the machine is in an upright position and placed on an even surface. Do not place the machine in long grass!

EN

### 4.3 Water Connection



#### IMPORTANT!

#### Connecting to pressurized water supply

The inlet water max. pressure is 1 MPa/10 bar and the max. temperature is 60°C – see rating plate. An ordinary ½" garden hose of min. 10 m and max. 25 m will be suitable.

**B6** Check that the filter is fitted in the water inlet pipe and that it is not clogged up.

**B7** Connect the water hose to the water supply by means of the quick connector. Turn on the water.



Connection to the drinking water mains according to national and local regulations.



Let the water run through the water hose before connecting it to the machine to prevent sand and dirt from penetrating the machine.

**B8** Turn off the water and connect the water hose by means of the quick coupling to the water inlet.



#### Connecting to pressure less water supply

The machine can also operate in suction mode, meaning that you can connect the machine to e.g. rainwater vessels, rivers, lakes and cisterns etc. When taking in water from non drinking water mains the backflow preventer is not needed.

When connecting the machine to operate from pressure less water supplies – always use additional filtering to secure that impurities are not sucked in. Hose length should be max. 3 meter and of minimum ½".



To meet these requirements, Nilfisk recommends that you use the original Nilfisk suction hose kit.

The Machine is designed for suction up to 100 cm above water surface.

- Position the machine at max. 1.0 meter above the water surface. Detach the high pressure hose from the outlet.
- Ensure that the inlet filter is in position and attach the suction hose kit, secure tight connection to the inlet.
- Turn on the machine, turning the start/stop switch (1) to position "I".
- Wait until a steady jet exits the outlet.
- Switch off the machine and attach high pressure hose (4), spray handle, lance and nozzle.
- Start the machine again and activate the spray handle.



PL

### 4.4 Starting the high pressure washer

#### IMPORTANT!

#### Connecting to mains power supply

The voltage and frequency of the machine (see model tag (14)) must match the voltage and frequency of the power supply.

Connecting the high pressure washer to a supply system, the max allowed impedance is = 0,29+j0,18Ω (Zmax). Consult with the supply authority that the equipment is connected only to a supply of that impedance or less.

**B9** Insert the power plug into power supply socket.

**B10** Turn on the water.

**B11** Release the trigger lock (7a). Remember to unplug, turn off the high pressure washer and lock the trigger, when leaving the high pressure washer unattended

**B12** Activate the trigger of the spray handle and let the water run until all air has escaped from the water hose.

**B13** Turn on the machine, turning the start/stop switch to position "I".

**B14** Activate the trigger of the spray handle. When releasing the trigger of the spray handle, the machine automatically stops. The machine will start again when you reactivate the trigger of the spray handle.



RU

ZH

## 4.5 Pressure regulation on the TORNADO® PR-nozzle

**B15** The pressure can be regulated on the TORNADO® PR nozzle.

## 4.6 Stationary use

**B16** If mounting a special wall hook (not standard), the pressure washer can be used as a stationary solution meaning that it can be operated while hanging on the wall. Only mount the wall hook on a sturdy wall. Adjust the length of the screws and size of rawlplugs to the type of wall.

**B17** On the wall hook Multi Brush (a) foam sprayer (b), Click & Clean brush (c) and Click & Clean nozzles (d) can be stored.



### IMPORTANT!

The bearing capacity of the wall hook is max. 30 kg.

## 4.7 Pairing the machine (Models with wireless regulation)

**B18** Before using the machine with wireless regulation, the spray handle must be electrically paired to the machine. When the battery has been mounted - ref. section 3.4, and the spray handle is in pairing mode (orange LED is flashing (1) then turn on (2) the machine. The orange LED is now turned off and the spray handle is operational.

## 4.8 Using wireless regulation (Models with wireless regulation)

**B19** The water pressure and use of energy is regulated by clicking the arrows (1) on the spray handle. The power can be regulated stepwise by pushing and releasing each button. It can also be regulated continuously by pushing and holding down each button. If so, the power will be increased/ decreased until max/ min is reached. The green LED illustrating the power level (2) is only lighting when pressing the up/down keys (1).

- Other wireless units (eg. microwave ovens, baby monitors, neighbours' wireless devices) that operate in the 2.4 GHz band can have a reduced effect on the wireless range between spray handle and machine.

# 5 Fields of application and working methods

## 5.1 General

Efficient high pressure cleaning is achieved by following a few guidelines, combined with your own personal experience of specific cleaning tasks. Accessories and detergents, when correctly chosen, can increase the efficiency of your pressure washer. Here is some basic information about cleaning.

### 5.1.1 Detergent and foam

Foam or detergent should be applied onto dry surfaces so that the chemical product is in direct contact with the dirt. Detergents are applied from bottom to top, for example on a car body-work, in order to avoid "super clean" areas, where the detergent collects in higher concentration and streams downwards. Let the detergent work for several minutes before rinsing but never let it dry on the surface being cleaned. **Note:** It is important that the detergents do not dry up. Otherwise the surface that has to be cleaned can be damaged.

### 5.1.2 Mechanical effect

In order to break down tough layers of dirt, additional mechanical effect may be required. Special wash brushes offer this supplementary effect that cuts through dirt (especially by car washing).

## 5.2 Typical fields of application

Below you will find a description of a lot of cleaning tasks which can be solved by a pressure washer from Nilfisk in association with accessories and detergents.

Task	Accessories 'Click & Clean'	Cleaning method
<b>Car</b>	Car nozzle, auto brush, underchassis nozzle, Foam sprayer, Car Combi Cleaner	<ol style="list-style-type: none"> <li>1. Apply Car Combi Cleaner with the foam sprayer. Always start from the bottom and work upwards. Let Car Combi Cleaner act for at least 5 min.</li> <li>2. Wash the car with the car nozzle, which has been optimized for quick and gentle cleaning of enamelled surfaces (the jet is wider and not so sharp). Start at the front of the car and work backwards to avoid water from penetrating by the door mouldings.</li> <li>3. Use the brush for removal of traffic film which is not removed by the nozzle. If the car is very dirty, apply Car Combi Cleaner again.</li> <li>4. Attach the undercarriage nozzle and clean undercarriage and wheel arches.</li> <li>5. Remove water from the surface of the car with the scraper on the car brush. <b>Make sure</b> that all grains of sand etc. have been removed before using the scraper. Wipe with a wash leather where the scraper cannot reach.</li> </ol>
<b>Rims, aluminium</b>	Multi Brush with Rim brush head, auto nozzle, foam sprayer, Car Combi Cleaner	<p>Apply Car Combi Cleaner with the foam sprayer or the Multibrush with detergent tank. Let it act for approx. 5 min.. Wash with rim brush head.</p> <p><b>Be careful!</b> The high pressure jet may damage the tyres.</p>
<b>Flagstones, concrete floors and other hard surfaces</b>	Powerspeed® nozzle, Stone & Wood Cleaner, Patio Cleaner	<p>Wash towards outlets or the like. On surfaces with foulings you may start by applying Stone &amp; Wood Cleaner with the foam sprayer. Wash before the soap dries. Another more effective and quicker method is to use the Patio Cleaner. Thus you will also avoid splashes.</p>
<b>Garden furniture, wood</b>	Multi Brush with Garden brush head (with or without detergent tank) Stone & Wood Cleaner Foam sprayer	<p>Apply Stone &amp; Wood Cleaner with foam sprayer or Multi Brush with Garden brush head and wash before the soap dries.</p> <p><b>NOTE:</b> Use the Multi Brush with Garden brush head to clean off the dirt.</p>
<b>Brickwork, Wood work</b>	Powerspeed® nozzle, Stone & Wood Cleaner, Patio Cleaner	<p>Same method as for flagstones, but <b>be careful</b> - bad joints and wood may be damaged by high pressure. You may choose only to use the Tornado® nozzle. Adjust the distance (pressure) to the quality of the joints and the wood. Patio Cleaner can also be used on vertical surfaces.</p>
<b>Gutter</b>	Underchassis spray lance	<p>Wash the gutter with the nozzle. Always wash towards downpipes. <b>Beware</b> not to spray under the roofing.</p>
<b>Cleaning of drain pipes, outlets, down pipes etc.</b>	Tube cleaner	<p>Push the tube cleaner approx. ½ m (to mark) into a tube or drain and activate the trigger of the spray handle. The nozzle opening turning backwards will pull the cleaner through the tube. The nozzle will break down the „plug“ and flush the dirt backwards.</p>
<b>Rust, paint</b>	Water/sandblasting equipment	<p>Mount the water/sand blasting equipment and rust and paint is efficiently and quickly removed. Beware not to damage the surface to be sandblasted.</p>
<b>Greenhouse</b>	Tornado® PR nozzle brush, Stone & Wood Cleaner	<p>Wash with high pressure and maybe a brush. You may use Stone &amp; Wood Cleaner to remove moss and algae.</p>
<b>Garden tools, lawn mower</b>	Tornado® PR nozzle, Powerspeed® nozzle, multiangle adaptor, Metal Cleaner	<p>Rinse the worst dirt off with the nozzle. Apply Metal Cleaner with the foam sprayer and let it act for approx. 5 min. Wash with the nozzle. You may use the multiangle adaptor for hard to get at areas to avoid splashing.</p>

## 6 After using the pressure washer



See the pictorial quick reference guide – storing the high pressure washer.



The high pressure washer should be stored in a frost free room! Should the machine be a mistake be frozen, it will be necessary to check it for damages.

### 6.1 Stopping the high pressure washer

- C1** Shut off the water supply and activate the trigger of the spray handle and let the machine run until no more water runs out of the nozzle. This will wash out water hose, high pressure hose, spray lance and nozzles.
- C2** Stop the machine, turning the start/stop switch to position "0".
- C3** Unplug the machine from the power supply socket.



#### IMPORTANT!

To avoid accidents, the electric cable and the high pressure hose should always be wound up carefully.

- C4** Wind up the electric cable on the dedicated cable hook (19). The upper hook can be turned to release the electric cable. The upper hook has a built-in clip (1) for good holding of the electrical cable.
- C5** The high pressure washer comes in two models: A) with hook for storage of high pressure hose (16) - B) with a hose reel (13).
- C6** Rinse the spray lance, nozzles and the foam sprayer after use.
- C7** Place spray handle (f), lance (a), nozzles (b), foam sprayer (c) in the holders on the high pressure washer. The nozzle cleaning tool (d) and a Click & Clean brush (e) can also be stored on the product.

## 7 Maintenance



See the pictorial quick reference guide - maintenance.



To ensure a long and problem free working life of the high pressure washer, please take the following advices:

- Wash out water hose, high pressure hose, spray lance and accessory before mounting
- Clean the connectors of dust and sand
- Rinse the detergent bottle and the detergent nozzle
- Clean the nozzle
- Keep the water inlet filter clean and unclogged

#### Cleaning of the water inlet filter

**D1** Clean the water inlet filter regularly once a month or more frequently according to use. Carefully loosen the filter with a screwdriver and clean it. Check that it is intact before remounting it.

#### Cleaning of nozzle

A clogging up in the nozzle causes a pump pressure which is too high, why cleaning is required immediately.



#### IMPORTANT!

The nozzle cleaning tool (12) should only be used when the nozzle is detached and the machine is stopped!

- D2** Stop the machine and disconnect the nozzle. Clean the nozzle.

EN

DA

NO

SV

FI

DE

FR

NL

IT

ES

PT

EL

TR

CS

HU

PL

HR

SL

SK

LV

LT

ET

RU

ZH

**D3** Flush the nozzle backwards with water.

### Cleaning of machine vents

**D4** The machine should be kept clean so as to let cooling air pass freely through the machine vents.

### Greasing of O-rings

**D5** To ensure an easy connection and that O-rings do not dry up the couplings should be greased regularly.

## 8 Troubleshooting

To avoid unnecessary disappointments, you should check the following before contacting the Nilfisk service organization.

Symptom	Cause	Recommended action
<b>Machine refuses to start</b>	Machine not plugged in Defective socket Fuse has blown Defective extension cable	Plug in machine Try another socket. Replace fuse. Switch off other machines. Try without the extension cable.
<b>Fluctuating pressure</b>	Pump sucking air  Valves dirty, worn out or stuck  Pump seals worn out	Check that hoses and connections are airtight. Clean and replace or refer to local Nilfisk-distributor. Clean and replace or refer to local Nilfisk-distributor.
<b>Machine stops</b>	Fuse has blown Incorrect mains voltage  Thermal sensor activated  Nozzle partially blocked	Replace fuse. Switch off other machines. Check that the mains voltage corresponds to specification on the model tag. Leave the washer for 5 minutes to cool down. Clean the nozzle (see section 7)
<b>Fuse blows</b>	Fuse too small	Change to an installation higher than the amp. consumption of the machine. You may try without the extension cable.
<b>Machine pulsating</b>	Air in inlet hose/pump  Inadequate supply of mains water  Nozzle partially blocked Water filter blocked Hose kinked	Allow machine to run with open trigger until regular working pressure resumes. Check that the water supply corresponds to specifications required (see model tag) NB! Avoid using long, thin hoses (min. 1/2") Clean the nozzle (see section 7) Clean the filter (see section 7) Straighten out hose.
<b>Machine often starts and stops by itself</b>	Pump/spray handle is leaking	Contact your nearest Nilfisk Service Centre.
<b>Machine starts, but no water comes out</b>	Pump/hoses or accessory frozen No water supply Water filter blocked Nozzle blocked	Wait for pump/hoses or accessory to thaw.  Connect inlet water. Clean the filter (see section 7) Clean the nozzle (see section 7)



Only Wireless models:

EN

Symptom	Cause	Recommended action
<b>The orange LED is not flashing while ready for pairing</b>	The spray handle is in stand-by mode	Press the up/down keys to activate the spray handle. The orange LED will then flash and pairing can be made within 2 min.
	Battery mounted incorrectly or no power on battery	Dismount the lid and make sure that the battery is mounted correctly or replace the battery
<b>The orange LED will light uninterrupted for 3 Sec and repeated when pressing up/down button</b>	Low battery	Replace the battery
<b>The green LED is not lighting when pressing the up/down keys</b>	There is no communication between spray handle and machine	Point the spray handle towards the machine or move closer to the machine

In case problems other than the above occur, please contact your local Nilfisk distributor. Local Nilfisk distributors are listed on the back cover of this instruction.

Customer Service at Penrith – 01768 868995

## 9 Accessories and detergents

Only use original accessories and detergents. For further information, see [www.nilfisk.com](http://www.nilfisk.com).

## 10 Warranty Conditions

Nilfisk guarantees high pressure washers for domestic use for 2 years. If your high pressure washer or accessories are handed in for repair, a copy of the receipt must be enclosed.

Guarantee repairs are being made on the following conditions:

- that defects are attributable to flaws or defects in materials or workmanship. (wear and tear as well as misuse are not covered by the guarantee).
- that the directions of this instruction manual have been thoroughly observed.
- that repair has not been carried out or attempted by other than Nilfisk-trained service staff.
- that only original accessories have been applied.
- that the product has not been exposed to abuse such as knocks, bumps or frost.
- that only water without any impurities has been used.
- that the high pressure washer has not been used for rental nor used commercially in any other way.

Repairs under this guarantee include replacement of defective parts, exclusive of packing and postage/courier. Besides, we refer to your national law of sale.

The machine should be forwarded to one of the service centres of the Nilfisk organisation with description/specification of the fault.

Repairs not covered by the guarantee conditions will be invoiced. (I.e. malfunctions due to **Causes** mentioned in section **Troubleshooting Chart** of the instruction manual).

DA

NO

SV

FI

DE

FR

NL

IT

ES

PT

EL

TR

CS

HU

PL

HR

SL

SK

LV

LT

ET

RU

ZH

EN

# 11 Main technical Data

DA

NO

SV

FI

DE

FR

NL

IT

ES

PT

EL

TR

CS

HU

PL

HR

SL

SK

LV

LT

ET

RU

ZH

Type		D 130.4 X-TRA D-PG 130.4 X-TRA	D 140.4 X-TRA D-PG 140.4 X-TRA
<b>Electric specifications</b>			
Rated voltage	V	230-240	230-240
Rated frequency	Hz	50	50
Rated power consumption	kW	2.1	2.4
Current	A	9.5	10
Protection class	Class I/ Class II	Class I	Class I
Protection degree	IP xx	IPX5	IPX5
<b>Hydraulic specifications</b>			
Rated pressure	MPa/bar	12.5/125	13.5/135
Max. pressure	MPa/bar	13.0/130	14.0/140
Rated water flow	l/min/l/h	7.5/450	7.0/420
Max. water flow	l/min/l/h	9.2/550	9.2/550
Max. water inlet pressure	Mpa/bar	1/10	1/10
Max. water inlet temperature	°C	60	60
Max. water inlet temp. suction mode	°C	20	20
<b>Weight</b>			
Weight	kg	13.0 (D 130.4 X-TRA) 13.8 (D-PG 130.4 X-TRA)	13.0 (D 140.4 X-TRA) 13.8 (D-PG 140.4 X-TRA)
<b>Hand-arm vibration according to ISO 5349-1: Standard nozzle</b>			
Hand-arm vibration according to ISO 5349-1: Standard nozzle	m/s <sup>2</sup>	< 2.5 ±1	< 2.5 ±1
Sound pressure level LpA in accordance with ISO 3744	dB(A)	77.2 ±2	77.2 ±2
Guaranteed sound power level LWA in accordance with 2000/14/EC	dB(A)	92	92

We reserve the right to make alterations.

# 12 Declaration of Conformity

We,

Nilfisk A/S  
Kornmarksvej 1  
DK-2605 Broendby  
DENMARK

Hereby solely declare, that the product:

Product	Description	Type
HPW - Consumer HPW - Consumer w/wireless remote*	220-240 V 1~, 50/60 Hz – IPX5	Nilfisk D 130.4 X-TRA / D 140.4 X-TRA / D-PG 130.4 X-TRA / D-PG 140.4 X-TRA and accessory variants of above-mentioned types

Is in compliance with the following standards:

Id and Version	Title
EN 60335-1:2012	Household and similar electrical appliances - Safety - Part 1: General requirements
EN 60335-2-79:2012	Household and similar electrical appliances - Safety - Part 2-79: Particular requirements for high pressure cleaners and steam cleaners
EN 55014-1:2006+A1:2009 +A2:2011	Electromagnetic compatibility - Requirements for household appliances, electric tools and similar apparatus - Part 1: Emission
EN 55014-2:1997+A1:2001 +A2:2008	Electromagnetic compatibility - Requirements for household appliances, electric tools and similar apparatus - Part 2: Immunity - Product family standard
EN 61000-3-2:2014 (Class B)	Electromagnetic compatibility (EMC) - Part 3-2: Limits - Limits for harmonic current emissions (equipment input current $\leq 16$ A per phase)
EN 61000-3-11:2000	Electromagnetic compatibility (EMC) - Part 3-11: Limits - Limitation of voltage changes, voltage fluctuations and flicker in public low-voltage supply systems, for equipment with rated current $\leq 75$ A per phase and subject to conditional connection
EN 50581:2012	Technical documentation for the assessment of electrical and electronic products with respect to the restriction of hazardous substances
*EN 300 440-2 V1.4.1	ERM; Short range devices; Radio equipment to be used in the 1 GHz to 40 GHz frequency range; Part 2: Harmonized EN covering the essential requirements of article 3.2 of the R&TTE Directive
*EN 301 489-1 V1.9.2	EMC standard for radio equipment and services; Part 1: Common technical requirements
*EN 301 489-3 V1.6.1	EMC standard for radio equipment and services; Part 3: Specific conditions for Short-Range Devices (SRD) operating on frequencies between 9 kHz and 246 GHz

Following the provisions of:

Machinery Directive 2006/42/EC  
EMC Directive 2004/108/EC  
RoHS Directive 2011/65/EC  
Noise Emission Directive 2000/14/EC – Conformity assessment procedure according to Annex V.  
Measured noise level: 77 dB(A); Guaranteed noise level: 92 dB(A)  
\* R&TTE Directive 1999/5/EC

Hadsund 27-07-2015 Anton Sørensen  
Senior Vice President – Global R&D



Place	Date	Name, Title	Signature



# A

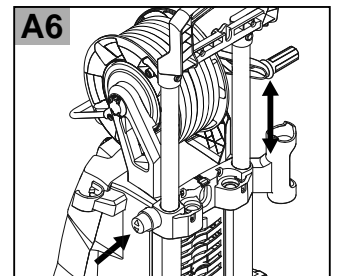
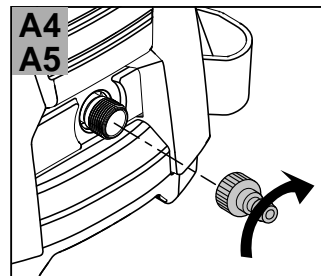
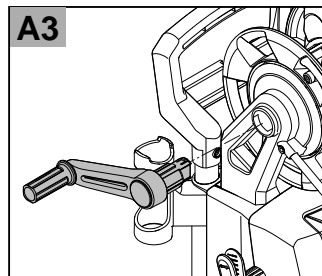
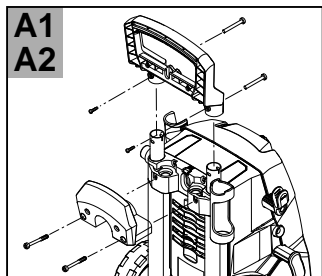
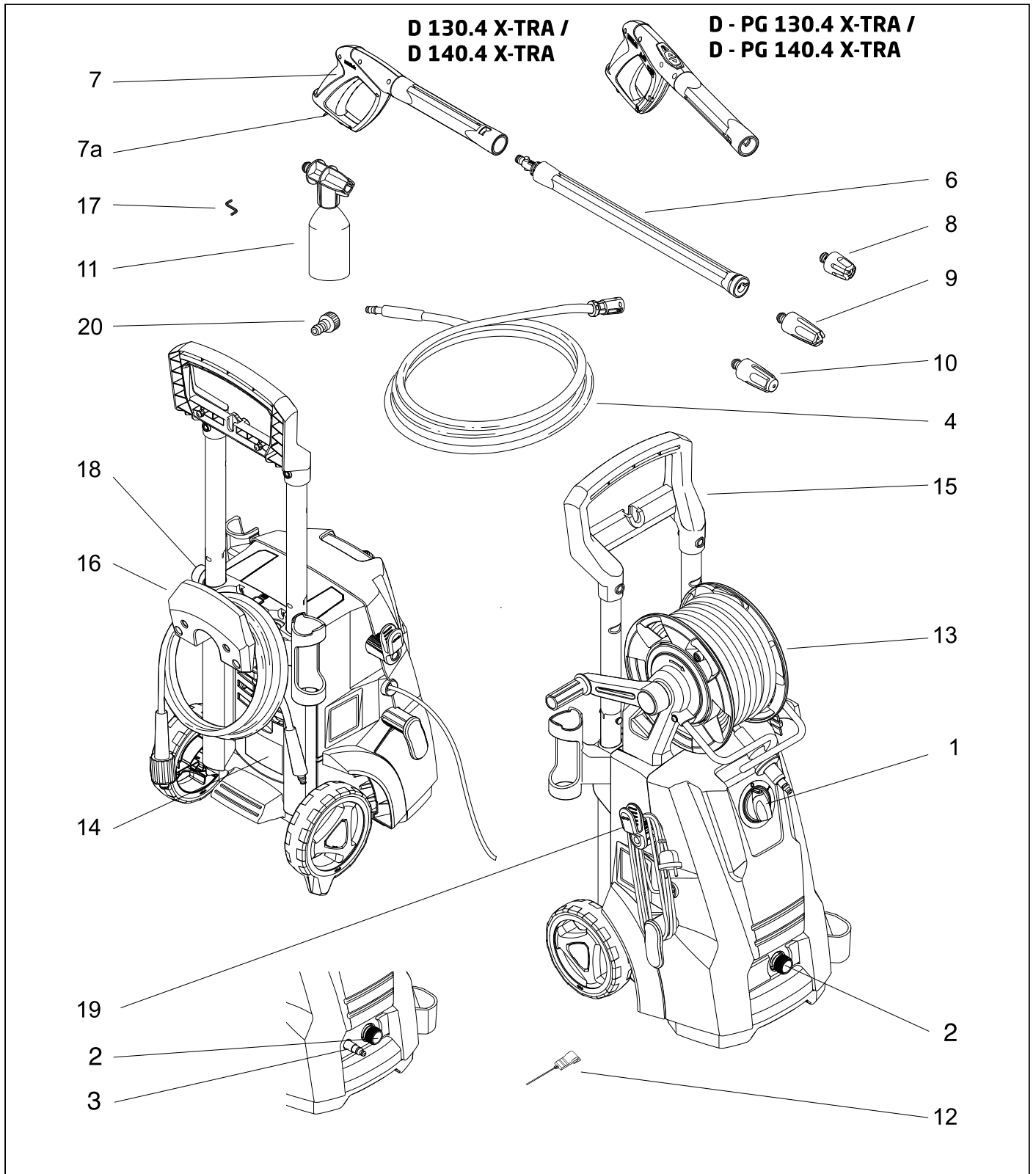
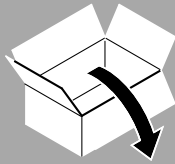

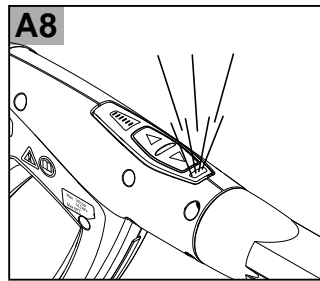
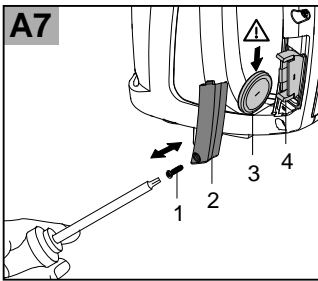

**B**

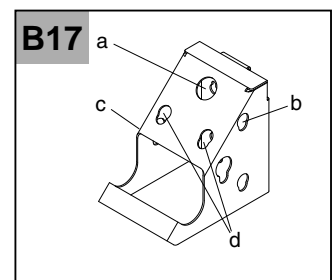
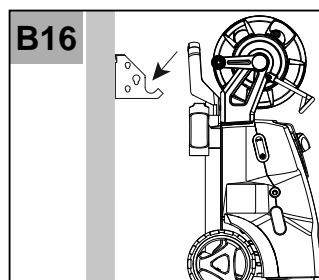
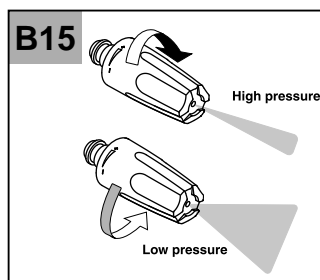
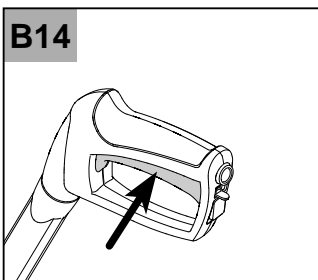
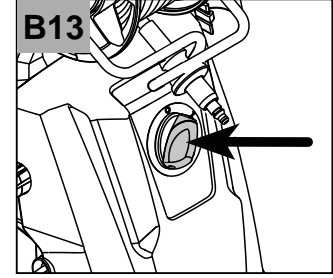
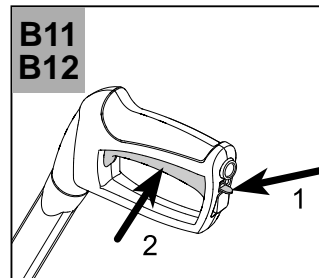
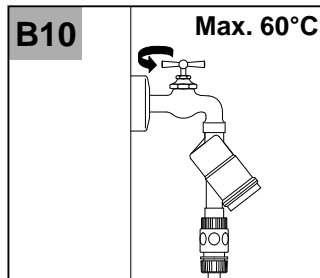
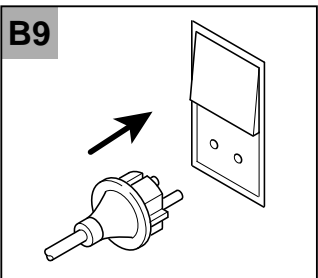
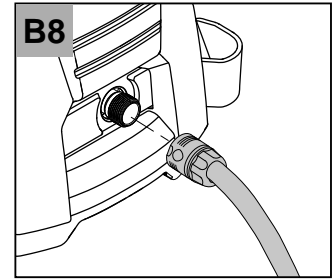
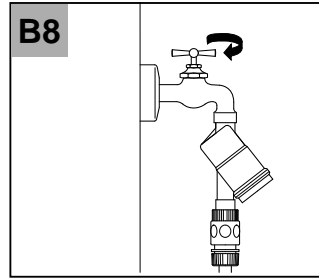
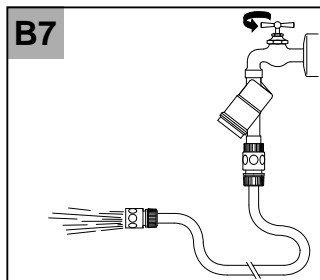
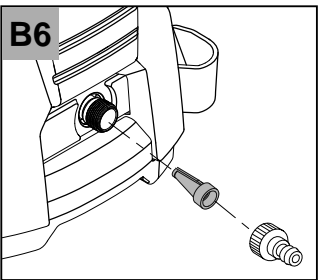
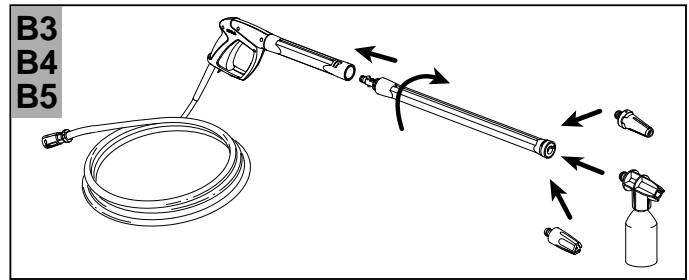
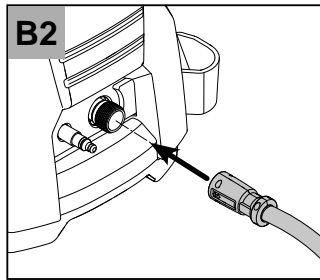
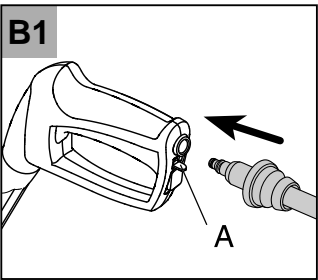

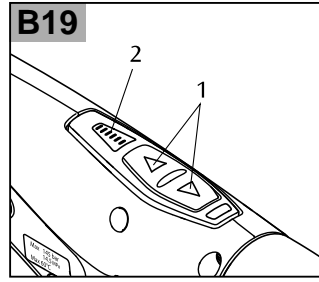
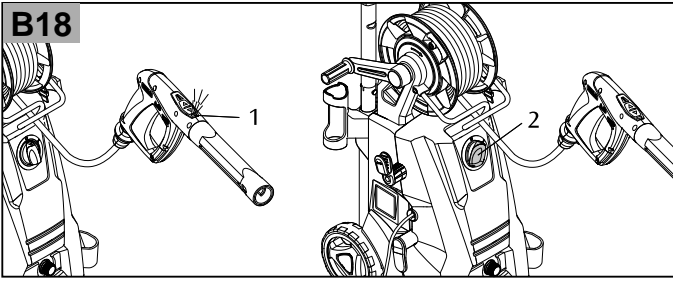

# C

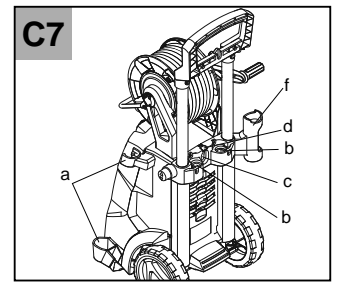
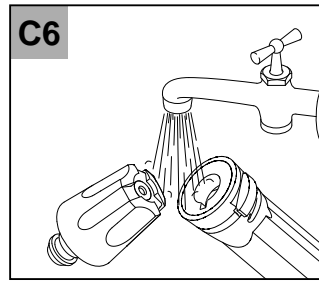
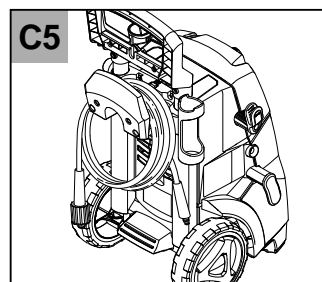
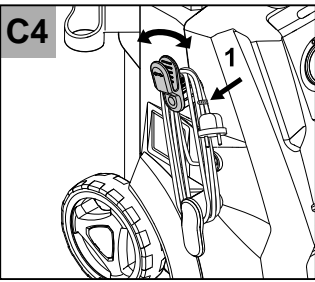
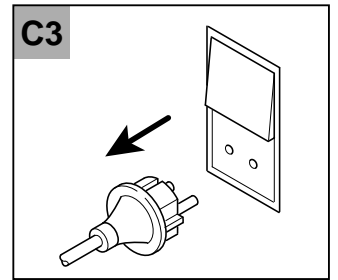
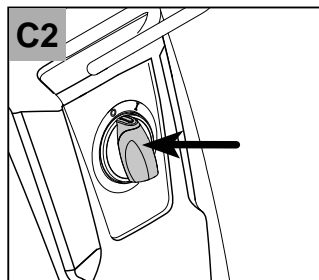
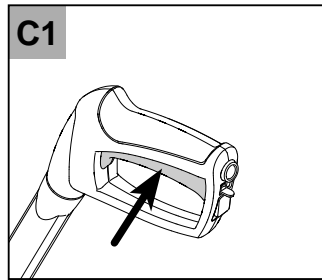
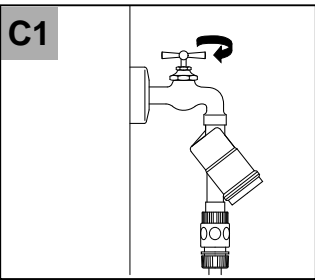
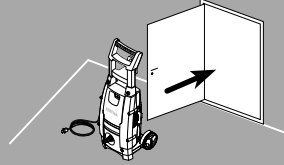

# D

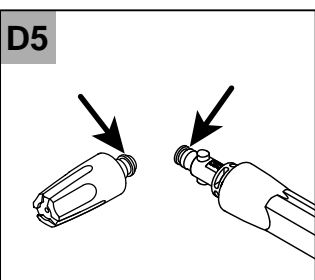
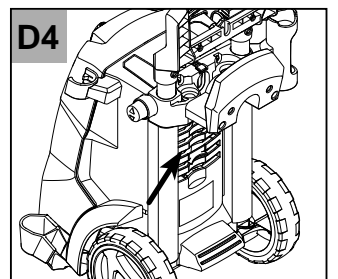
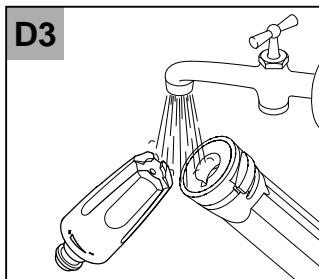
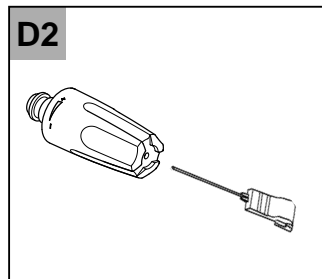
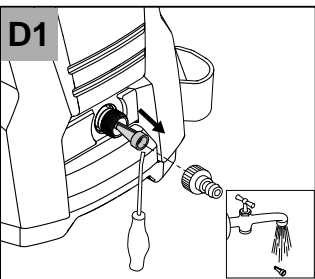



<http://www.nilfisk.com>

## HEAD QUARTER

### DENMARK

Nilfisk A/S  
Banemarksvej 58  
DK-2605 Broendby  
Tel.: (+45) 4323 8100  
Website: [www.nilfisk.com](http://www.nilfisk.com)

## SALES COMPANIES

### ARGENTINA

Nilfisk srl.  
Edificio Central Park  
Herrera 1855, 6th floor/604  
Ciudad de Buenos Aires  
Tel.: (+54) 11 6091 1571  
Website: [www.nilfisk.com.ar](http://www.nilfisk.com.ar)

### AUSTRALIA

Nilfisk Pty Ltd  
Unit 1/13 Bessemer Street  
Blacktown NSW 2148  
Tel.: (+61) 2 98348100  
Website: [www.nilfisk.com.au](http://www.nilfisk.com.au)

### AUSTRIA

Nilfisk GmbH  
Metzgerstrasse 68  
5101 Bergheim bei Salzburg  
Tel.: (+43) 662 456 400 90  
Website: [www.nilfisk.at](http://www.nilfisk.at)

### BELGIUM

Nilfisk n.v.s.a.  
Riverside Business Park  
Boulevard Internationalelaan 55  
Bâtiment C3/C4 Gebouw  
Bruxelles 1070  
Tel.: (+32) 14 67 60 50  
Website: [www.nilfisk.be](http://www.nilfisk.be)

### BRAZIL

Nilfisk do Brasil  
Av. Eng. Luis Carlos Berrini, 550  
40 Andar, Sala 03  
SP - 04571-000 Sao Paulo  
Tel.: (+11) 3959-0300 / 3945-4744  
Website: [www.nilfisk.com.br](http://www.nilfisk.com.br)

### CANADA

Nilfisk Canada Company  
240 Superior Boulevard  
Mississauga, Ontario L5T 2L2  
Tel.: (+1) 800-668-8400  
Website: [www.nilfisk.ca](http://www.nilfisk.ca)

### CHILE

Nilfisk S.A. (Comercial KCS Ltda)  
Salar de Llamara 822  
8320000 Santiago  
Tel.: (+56) 2684 5000  
Website: [www.nilfisk.cl](http://www.nilfisk.cl)

### CHINA

Nilfisk  
4189 Yindu Road  
Xinzhuang Industrial Park  
201108 Shanghai  
Tel.: (+86) 21 3323 20000  
Website: [www.nilfisk-cs.com](http://www.nilfisk-cs.com)

### CZECH REPUBLIC

Nilfisk s.r.o.  
VGP Park Horní Počernice  
Do Čertous 1/2658  
193 00 Praha 9  
Tel.: (+420) 244 090 912  
Website: [www.nilfisk.cz](http://www.nilfisk.cz)

### DENMARK

Nilfisk Danmark A/S  
Industrivej 1  
Hadsund, DK-9560  
Tel.: 72 18 21 20  
Website: [www.nilfisk.dk](http://www.nilfisk.dk)

### FINLAND

Nilfisk Oy Ab  
Koskelontie 23 E  
02920 Espoo  
Tel.: (+358) 207 890 600  
Website: [www.nilfisk.fi](http://www.nilfisk.fi)

### FRANCE

Nilfisk SAS  
26 Avenue de la Baltique  
Villebon sur Yvette  
91978 Courtabouef Cedex  
Tel.: (+33) 169 59 87 00  
Website: [www.nilfisk.fr](http://www.nilfisk.fr)

### GERMANY

Nilfisk GmbH  
Guido-Oberdorfer-Straße 2-10  
89287 Bellenberg

Tel.: (+49) (0)7306/72-444  
Website: [www.nilfisk.de](http://www.nilfisk.de)

### GREECE

Nilfisk A.E.  
Αναπαύσεως 29  
Κορωπί T.K. 194 00  
Tel.: (30) 210 9119 600  
Website: [www.nilfisk.gr](http://www.nilfisk.gr)

### HOLLAND

Nilfisk B.V.  
Versterkerstraat 5  
1322 AN Almere  
Tel.: (+31) 036 5460760  
Website: [www.nilfisk.nl](http://www.nilfisk.nl)

### HONG KONG

Nilfisk Ltd.  
2001 HK Worsted Mills  
Industrial Building  
31-39, Wo Tong Tsui St.  
Kwai Chung, N.T.  
Tel.: (+852) 2427 5951  
Website: [nilfisk.com](http://nilfisk.com)

### HUNGARY

Nilfisk Kft.  
II. Rákóczi Ferenc út 10  
2310 Szigetszentmiklós-Lakihegy  
Tel.: (+36) 24 475 550  
Website: [www.nilfisk.hu](http://www.nilfisk.hu)

### INDIA

Nilfisk India Limited  
Pramukh Plaza, 'B' Wing, 4th floor, Unit No. 403  
Cardinal Gracious Road, Chakala  
Andheri (East) Mumbai 400 099  
Tel.: (+91) 22 6118 8188  
Website: [www.nilfisk.in](http://www.nilfisk.in)

### IRELAND

Nilfisk  
1 Stokes Place  
St. Stephen's Green  
Dublin 2  
Tel.: (+35) 3 12 94 38 38  
Website: [www.nilfisk.ie](http://www.nilfisk.ie)

### ITALY

Nilfisk SpA  
Strada Comunale della Braglia, 18  
26862 Guardamiglio (LO)  
Tel.: (+39) (0) 377 414021  
Website: [www.nilfisk.it](http://www.nilfisk.it)

### JAPAN

Nilfisk Inc.  
1-6-6 Kita-shinyokohama, Kouhoku-ku  
Yokohama, 223-0059  
Tel.: (+81) 45548 2571  
Website: [www.nilfisk.com](http://www.nilfisk.com)

### MALAYSIA

Nilfisk Sdn Bhd  
Sd 33, Jalan KIP 10  
Taman Perindustrian KIP  
Sri Damansara  
52200 Kuala Lumpur  
Tel.: (60) 3603 627 43 120  
Website: [www.nilfisk.com](http://www.nilfisk.com)

### MEXICO

Nilfisk de Mexico, S. de R.L. de C.V.  
Pirineos #515 Int.  
60-70 Microparque  
Industrial WSantiago  
76120 Queretaro  
Tel.: (+52) (442) 427 77 00  
Website: [www.nilfisk.com](http://www.nilfisk.com)

### NEW ZEALAND

Nilfisk Limited  
Danish House  
6 Rockridge Avenue  
Penrose, Auckland 1061  
Tel.: (+64) 9526 3890  
Website: [www.nilfisk.com.au](http://www.nilfisk.com.au)

### NORWAY

Nilfisk AS  
Bjørnerudveien 24  
1266 Oslo  
Tel.: (+47) 22 75 17 80  
Website: [www.nilfisk.no](http://www.nilfisk.no)

### PERU

Nilfisk S.A.C.  
Calle Boulevard 162, Of. 703, Lima 33- Perú  
Lima  
Tel.: (511) 435-6840  
Website: [www.nilfisk.com](http://www.nilfisk.com)

### POLAND

Nilfisk Sp. Z.O.O.  
Millenium Logistic Park  
ul. 3 Maja 8, Bud. B4  
05-800 Pruszków  
Tel.: (+48) 22 738 3750  
Website: [www.nilfisk.pl](http://www.nilfisk.pl)

### PORTUGAL

Nilfisk Lda.  
Sintra Business Park  
Zona Industrial Da Abrunheira  
Edificio 1, 1° A

P2710-089 Sintra  
Tel.: (+351) 21 911 2670  
Website: [www.nilfisk.pt](http://www.nilfisk.pt)

### RUSSIA

Nilfisk LLC  
Vyatskaya str. 27, bld. 7/1st  
127015 Moscow  
Tel.: (+7) 495 783 9602  
Website: [www.nilfisk.ru](http://www.nilfisk.ru)

### SINGAPORE

Den-Sin  
22 Tuas Avenue 2  
639453 Singapore  
Tel.: (+65) 6268 1006  
Website: [www.densin.com](http://www.densin.com)

### SLOVAKIA

Nilfisk s.r.o.  
Bancikovej 1/A  
SK-821 03 Bratislava  
Tel.: (+421) 910 222 928  
Website: [www.nilfisk.sk](http://www.nilfisk.sk)

### SOUTH AFRICA

WAP South Africa  
12 Newton Street  
Spartan 1630  
Tel.: (+27) 11 975 7060  
Website: [www.wap.com.za](http://www.wap.com.za)

### SOUTH KOREA

Nilfisk Korea  
3F Duksoo B/D, 317-15  
Sungsoo-Dong 2Ga  
Sungdong-Gu, Seoul  
Tel.: (+82) 2497 8636  
Website: [www.nilfisk.co.kr](http://www.nilfisk.co.kr)

### SPAIN

Nilfisk S.A.  
Torre d'Ara,  
Passeig del Rengle, 5 Plta. 10ª  
08302 Mataró  
Tel.: (34) 93 741 2400  
Website: [www.nilfisk.es](http://www.nilfisk.es)

### SWEDEN

Nilfisk AB  
Täljegårdsgatan 4  
431 53 Mölndal  
Tel.: (+46) 31 706 73 00  
Website: [www.nilfisk.se](http://www.nilfisk.se)

### SWITZERLAND

Nilfisk AG  
Ringstrasse 19  
Kircheberg/Industri Stelz  
9500 Wil  
Tel.: (+41) 71 92 38 444  
Website: [www.nilfisk.ch](http://www.nilfisk.ch)

### TAIWAN

Nilfisk Ltd  
Taiwan Branch (H.K)  
No. 5, Wan Fang Road  
Taipei  
Tel.: (+88) 6227 00 22 68  
Website: [www.nilfisk.tw](http://www.nilfisk.tw)

### THAILAND

Nilfisk Co. Ltd.  
89 Soi Chochechai-Ruammitr  
Viphavadee-Rangsit Road  
Ladyao, Jatuchak, Bangkok 10900  
Tel.: (+66) 2275 5630  
Website: [www.nilfisk.co.th](http://www.nilfisk.co.th)

### TURKEY

Nilfisk A.S.  
Serifali Mh. Bayraktar Bulv. Sehitt Sk. No:7  
Ümraniye, 34775 Istanbul  
Tel.: +90 216 466 94 94  
Website: [www.nilfisk.com.tr](http://www.nilfisk.com.tr)

### UNITED ARAB EMIRATES

Nilfisk Middle East Branch  
SAIF-Zone  
P.O. Box 122298  
Sharjah  
Tel.: (+971) (0) 655-78813  
Website: [www.nilfisk.com](http://www.nilfisk.com)

### UNITED KINGDOM

Nilfisk Ltd.  
Nilfisk House, Bowerbank Way  
Gilwilly Industrial Estate, Penrith  
Cumbria CA11 9BQ  
Tel.: (+44) (0) 1768 868995  
Website: [www.nilfisk.co.uk](http://www.nilfisk.co.uk)

### UNITED STATES

Nilfisk Inc.  
14600 21st Avenue North  
Plymouth, MN-55447  
Tel.: (+1) 800-989-2235  
Website: [www.nilfisk.com](http://www.nilfisk.com)

### VIETNAM

Nilfisk Vietnam  
No. 51 Doc Ngu Str.  
P. Vinh Phúc, Q.Ba Dinh  
Hanoi  
Tel.: (+84) 761 5642  
Website: [www.nilfisk.com](http://www.nilfisk.com)