

Replacing the atomiser head

- The atomiser head should be changed regularly in line with frequency of use (typically every 2 weeks) – you can [visit govype.com](http://govype.com) to purchase a new pack of eBox atomiser heads.
- You should also replace your atomiser head if you notice a deterioration in the taste or quality of the vapour from your Vype eBox.
- To replace your atomiser head, first ensure that your tank is empty of any eLiquid. **See ‘How to clean your eBox tank’.**
- Remove the base of the tank (the airflow controller section) and the tank lid from the tank itself, taking care not to get eLiquid on your hands.
- Remove the atomiser head from the tank.
- Insert a new atomiser head into the base of the tank. **See illustration**
- Ensure the atomiser head is fully aligned and properly fitted before reassembling the base of the tank and the tank lid.



Important product use information

- To avoid the risk of fire, injury and/or damage to your Vype eBox or other property, only charge your Vype eBox battery with the equipment provided in your Vype eBox kit or with compatible Vype charging accessories (available at govype.com).
- Never leave your battery unattended whilst on charge.

- Never keep loose batteries in your pocket, particularly next to keys or coins.
- Do not use e-cigarettes when you, or anyone in the vicinity, is using oxygen.
- Vype eTank is recommended for Vype eLiquids. Vapour quality and satisfaction may vary if used other than as recommended.
- Vype eBox is tested in conjunction with Vype eLiquids.
- The eBox tank is made from glass so should be treated carefully as it may break if dropped.
- Only use Vype atomiser heads and Vype tanks with your Vype eBox.
- Rating input of USB charging cable: Input voltage DC 5V. Output voltage DC 4.2V 500mA.

- The build-up of dirt inside your Vype eBox device may reduce performance and disrupt normal charging. To prevent this, check and, if necessary, wipe the battery connector clean with a dry cloth.
- Do not use your Vype eBox if the coil within the atomiser head has become flooded. If this occurs, clean your tank and replace the atomiser head.
- Do not leave your Vype eBox in direct sunlight or near sources of heat.
- Keep Vype products dry when in storage and during use. Precipitation, humidity or moisture can corrode electronic circuits.
- Your Vype eBox is only suitable for operation at room temperature. If it is operated other than at room temperature it may be

damaged or stop working.

- The recommended storage temperature for Vype products is room temperature. Do not store above 40 degrees Celsius.
- Protection provided by the equipment may be impaired if used in a manner not specified by the manufacturer.
- If you have any queries or doubts about the use of your eBox or any other Vype products, please contact the Vype Customer Care Team – see the reverse for details.

Disposal and recycling of Vype products

Electrical and electronic goods and batteries should not be disposed of as part of regular household waste, but should be separately collected for

recovery and recycling. We are committed to minimising our impact on the environment – please see our website, govype.com, for more information on how to dispose of your Vype products and details of our recycling programme and how to return used products to us.

About Vype eBox battery

Vype eBox contains a lithium-ion battery.

We characterise the propylene glycol (PG) and the vegetable glycerine (VG) in Vype eLiquids as Low, Medium or High to indicate the level in the eLiquid formulation as a percentage of the total eLiquid formulation. See below for the applicable range for each level.

Vype eLiquid VG and PG content reference	
Low	1% – 35%
Medium	36% – 59%
High	60% – 90%

For more information about Vype products, please see our website, govype.com.

THIS PRODUCT CONTAINS NICOTINE WHICH IS A HIGHLY ADDICTIVE SUBSTANCE. NOT RECOMMENDED FOR NON-SMOKERS. THIS PRODUCT MAY BE HAZARDOUS TO HEALTH. *except zero nicotine products

KEEP OUT OF REACH OF CHILDREN. KEEP OUT OF REACH OF ANIMALS.

IF SWALLOWED: Rinse mouth.
IF ON SKIN: Wash with plenty of soap and water. Call a **POISON CENTRE** or doctor/physician if you feel unwell.

THIS PRODUCT IS NOT SUITABLE FOR USE BY:
- Persons under the age of 18.
- Persons who are allergic/sensitive to nicotine.
- Pregnant or breast-feeding women.
- Persons who should avoid using tobacco or nicotine products for medical reasons.
- Persons with an unstable heart condition, severe hypertension or diabetes.

IMPORTANT SAFETY INFORMATION:
Immediately stop use of this product and seek medical advice if you experience any of the following: Development of an irregular heartbeat; allergic reaction such as rash, itching or swelling of the tongue, mouth or throat; feeling faint; nausea; headache; or any other unusual or adverse effect.



Vype Customer Care, Distributed by British American Tobacco UK Limited, One Eton Street, Richmond upon Thames, London, TW9 1EF, UK
T: +44 (0) 800 1337 350

eLiquid made in Italy. eBox device, tank, atomiser and USB charging cable made in China.



WY_UK_EB0_STK_LFT01

Model Number: ebb1

eBox kit User Guide

Quick Start:
Step one:
Fill the tank.



Step two:
Turn on the device.



Step three:
Click activation button 3 times and adjust wattage and airflow.



Step four:
Vape (if atomiser is new allow 10 minutes for priming before use).



Know your Vype eBox

Clearomiser



lid and mouthpiece



atomiser head



tank

airflow controller

Battery



activation button

power controllers



connected to the battery, the resistance Ω will show '-. —'.



- Ensure the eBox tank contains eLiquid above the minimum fill level.
- For optimal performance, your eBox battery should be fully charged before it is used for the first time.
- Securely attach the eBox clearomiser to the eBox battery. Always ensure you grip the knurled section on the clearomiser when attaching it or removing it from the battery.

- If no clearomiser is

How to fill your eBox tank

- Peel off the tamper-evident band from your Vype eLiquid bottle. Do not use if the band is not intact.
- To open the eLiquid bottle, gently press the two pressure points on the side of the lid and lift the lid.
- Remove the clearomiser from the battery, then unscrew the lid from your tank (with the mouthpiece attached to the tank lid).
- Gently press on the soft spot located on one side of the eLiquid bottle and gently pour the eLiquid down the side of the tank. **Important: Do not pour any eLiquid down the centre of the atomiser head.**
- To avoid any leakage, ensure that your tank is not overfilled – only fill to the maximum fill level which is marked on the tank window.

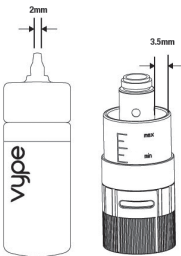
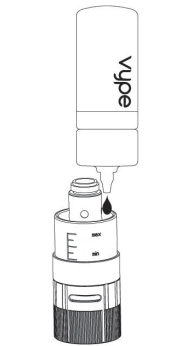

- Once the eLiquid is in the tank, screw the lid back onto the tank and ensure that it is securely attached. Do not overtighten the lid.

- Reattach the clearomiser to the battery.

- Ensure the eLiquid bottle lid is properly closed after use to avoid leakage or spillage.

- You should refill your eBox tank before your eLiquid drops below the minimum fill level which is marked on the tank window.

- If the atomiser head is new, please allow 10 minutes for eLiquid priming before use.

How to use your eBox step by step

- Turn the eBox on by moving the switch at the bottom of the battery to the 'on' setting. See step 2 on quick

start guide. Once on, press any button and the screen will display the following information.

OFF
CLICK 3x ON

- To activate the eBox once on, rapidly click the activation button 3 times. The screen will then display the battery level, wattage, coil resistance and voltage.

4.0w
2.25 Ω
3.01V

Adjust the wattage

- To adjust the wattage level (the power of your device), press either the '+' or the '-' button for 2 seconds. The wattage level on the screen will flash, then press the '+' or the '-' button to adjust to the desired wattage level. Wattage can be set between 4 and

12W in steps of 0.1W. This setting can be saved by pressing the activation button.

4.0w
2.25 Ω
3.01V

See illustration

Adjust the airflow

- You can adjust the airflow of your eBox device to suit your personal preference.
- To adjust, turn the airflow controller to the desired airflow setting. See step 3 on the quick start guide.
- Please ensure that you do not cover the airflow opening during use.

Starting and ending your vaping session

- To begin your vaping experience, press and hold down the activation button and puff. The screen will display the duration of your vape.

See illustration

0.8 s
2.25 Ω
3.01V

- After 3 seconds, the screen will turn off. To display information again, press any button.

- When not in use, your eBox should be locked by rapidly clicking the activation button 3 times.

- Turn the eBox off by moving the switch at the bottom of the battery to the 'off' setting.

How to charge your eBox battery

- The battery symbol on the screen displays the battery level.
- When the battery level is low, the battery symbol on the screen will appear

4.0w
2.25 Ω
3.01V

empty and flash.

See illustration

4.0w
2.25 Ω
3.01V

- To charge your eBox, take the USB charging cable (supplied with the eBox kit) and gently insert into the charging port located on the bottom right of the eBox battery.

- Connect the other end of the USB charging cable to the USB port of a computer, Vype wall plug or Vype car charger. For the output of the Vype wall plug or Vype car charger, ensure the charge supply is 5V DC and a minimum of 1 Amp (1000mA).

- The eBox battery can be charged when the eBox is turned on or off. When charging, the screen will show the charging symbol when any button is pressed.

See illustration

4.0w
2.25 Ω
3.01V

- When the eBox is fully charged, the USB charging cable will automatically stop charging the device. The screen will display a white fully charged battery symbol when any button is pressed. The eBox battery should then be disconnected from the USB charging cable.

- It should take no longer than 4 hours to fully charge your eBox battery.

How to clean your eBox tank

- Ensure that your clearomiser is detached from the battery.
- Remove the mouthpiece

from the tank lid.

- Remove the tank lid from the tank and carefully dispose of any remaining eLiquid in the tank.
- Remove the base of the tank (the airflow controller section), taking care not to get eLiquid on your hands.
- Remove the atomiser head from the tank. Tweezers or gloves help avoid any contact with the eLiquid.
- **Do not wash the atomiser head.**
- Carefully wash and rinse remaining components and your hands with warm water and wipe with a dry cloth.
- During washing and rinsing, do not change the water temperature rapidly as temperature change can cause glass to crack.
- Once the tank is cleaned and wiped dry, replace

the existing atomiser head or place a new atomiser head into the base of the tank.



See illustration

- Ensure the atomiser head is fully aligned and properly fitted before reassembling the base of the tank, the tank lid and the mouthpiece. Ensure any o-rings that have been removed for washing have been reassembled prior to use.
- When cleaning your tank, ensure you keep your eBox battery away from water (the battery part of the device should only be cleaned by wiping it with a dry cloth).
- Ensure the threads and connections on your tank are clean to maintain a good connection between the battery and the tank.