

cookworks

1.5 Litre Blender

Model No. BL9295G-GS



Care & Instruction Manual

For household and indoor use only

Please read these instructions before use and retain for future reference



Electrical safety

- You should only plug the appliance into a 220V-240V AC, 50Hz supply. Connecting it to other power sources may damage the appliance and will invalidate the guarantee.
- Switch off and unplug when not in use and before assembling, cleaning or dismantling the appliance.
- This appliance shall not be used by children. Keep the appliance and its cord out of reach of children.
- This appliance can be used by persons with reduced physical, sensory or mental capabilities or lack of experience and knowledge if they have been given supervision or instruction concerning use of the appliance in a safe way and understand the hazards involved.
- Children shall not play with the appliance.
- Keep motor housing, cable, and plug dry and away from areas where it is likely to get splashed. Never immerse in water.
- Do not cover or block the ventilation holes.
- Do not pull on the cable to disconnect from the mains supply.
- Do not operate the appliance if damaged or after it malfunctions. In the event the supply cord is damaged, in order to avoid a hazard it must only be replaced by a qualified service engineer, with a suitably approved part.
- This appliance must be positioned so that the plug is accessible and the plug socket is within easy reach of the power cord.

Warning!

- This appliance is intended exclusively for use in domestic households. It is not suitable for commercial use.
- Always unplug the motor housing of the blender if unattended and before assembling, disassembling or cleaning.
- Only use with the parts supplied and fully assembled.
- Never place hands or utensils inside the jug whilst the blender is in use. Only use a scraper when the blender is not in operation.
- Do not cover the blender and allow the motor housing to cool fully before storing.
- Never use hot liquids in the blender jug, always allow liquids to cool to room temperature before blending.
- Do not fill above maximum level marked (1500ml) or use without the lid and stopper in place as the contents may be ejected when the blender is started.
- Do not leave unattended during use.
- The blender blades are sharp, take care when emptying the jug and cleaning.
- This appliance can cause personal injury if misused.

Parts

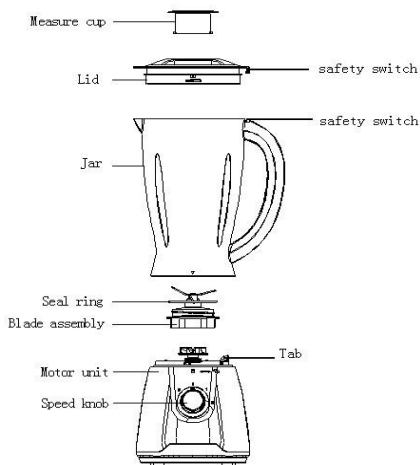

IMPORTANT:

Your blender is equipped with a safety feature, where the blades will not operate unless the base of the jug and motor housing are fully locked and the lid correctly fitted.

ASSEMBLY

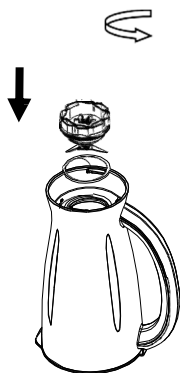

Fig.1

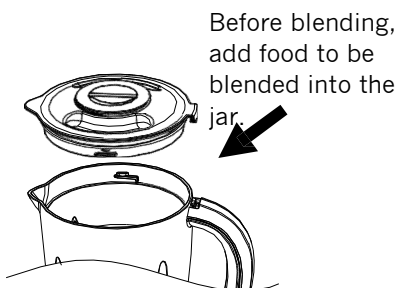

Fig.2

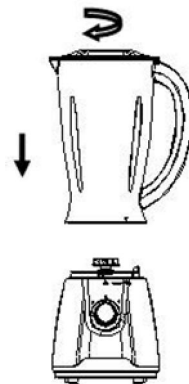

Fig.3

1. Fit the seal onto the underside of the jug and fit the blade assembly as shown (fig 1.). Turn the blade assembly anti-clockwise to secure.
2. Fit the lid onto the top of the jug (fig 2). To fit the stopper, align the lugs on the side of the stopper with the notches in the lid; insert the stopper and twist clockwise to secure.
3. Align the lugs on the side of the jug with the notches in the motor assembly and fit the jug onto the motor housing (fig.3).

TO USE

1. Clean thoroughly before use.
2. Place the blender base on a stable surface, check that the speed control knob is in the OFF(0) position, fully unwind the cable and plug in.

3. Ensure all ingredients are close to room temperature. **Never use hot ingredients as this can cause the glass jug to shatter.**
4. Place the ingredients into the glass jug and check that the level is not above the maximum level marked (1500ml).
5. Fit the lid, secure the stopper and place the jug onto the motor housing.
6. Using the speed control knob, select the appropriate blender speed for your ingredients. A slower mix will be obtained by selecting the lowest speed setting (1) and a faster mix by selecting the higher setting(2).
7. Mix for a **maximum** of 3 minutes. If further mixing is required, wait until the blender has cooled to room temperature before restarting.
8. Switch off; allow the blade to stop spinning before checking the consistency of the mix. If satisfactory, remove the jug.
9. To use blender on pulse, turn and hold the speed switch to the 'P' position for short intervals. The blender will operate at full speed, when the desired mix is achieved, release the switch.
10. To stop or interrupt the blending process switch the appliance off by turning the speed control knob to OFF(0) or by turning off at the mains.

Notes:

- Do not run the blender with the container empty or with solids only.
- **Do not use without the seal fitted.**
- For some types of mixes it may be necessary to fill above the minimum (250ml) to obtain the most efficient mixing.
- The stopper is graduated and may be used as a measuring cup.

CLEANING

Clean the blender after each use.

1. Switch off and unplug.
2. The jug, lid and stopper may be washed in hot water with a little washing up liquid taking care not to handle the blades. Rinse and wipe dry. **Not suitable for dishwashers.**
3. To separate the blade assembly from the glass jug, firmly grasp the base assembly on the underside of the jug and twist the

assembly clockwise to remove. Lift off the silicon washer. Please note the blade assembly may be difficult to remove the first time.

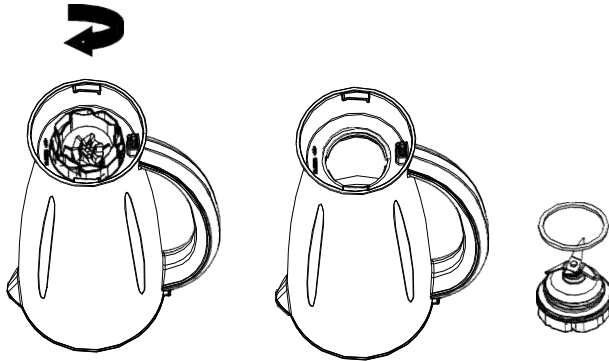

4. Wipe the outside of the motor housing with a damp cloth; do not use detergent or abrasives as these may scratch the surface.
5. Never immerse the motor housing, cable or plug in water.

Note:

- Please note the blade cannot be removed from the base of the jug.

Technical specification

Rated voltage	220-240V AC 50/60Hz
Power consumption	500W
Maximum work time	3 minutes
Class rating	2 (double insulated)
BS 1362 fuse	5A
Capacity	1.5 Litre





PRODUCT GUARANTEE

This product is guaranteed against manufacturing defects for a period of



Year

This product is guaranteed for twelve months from the date of original purchase.

Any defect that arises due to faulty materials or workmanship will either be replaced, refunded or repaired free of charge where possible during this period by the dealer from whom you purchased the unit.

The guarantee is subject to the following provisions:

- The guarantee does not cover accidental damage, misuse, cabinet parts, knobs or consumable items.
- The product must be correctly installed and operated in accordance with the instructions contained in this manual. A replacement copy of this instruction manual can be obtained from www.argos-support.co.uk
- It must be used solely for domestic purpose.
- The guarantee will be rendered invalid if the product is re-sold or has been damaged by inexpert repair.
- Specifications are subject to change without notice.
- The manufacturer disclaims any liability for the incidental or consequential damages.
- The guarantee is in addition to, and does not diminish your statutory or legal rights.

Guarantor: Argos Ltd
489 - 499 Avebury Boulevard
Central Milton Keynes
MK9 2NW
www.argos-support.co.uk