

说明书技术要求				
选择项打 <input checked="" type="checkbox"/>				
编 码	16164000A01062	制作	朱素英	
工厂型号/客户型号	MJ-FP60D1/MJ-FP60D1			
客户名称	Cookworks			
环 保	<input checked="" type="checkbox"/> 环保	<input type="checkbox"/> 不环保		
印刷颜色	<input checked="" type="checkbox"/> 单色	<input type="checkbox"/> 双色	<input type="checkbox"/> 三色	<input type="checkbox"/> 四色
专 色	<input checked="" type="checkbox"/> 无	<input type="checkbox"/> 有 (<input type="checkbox"/> 1个 <input type="checkbox"/> 2个 <input type="checkbox"/> 3个)		
尺寸规格 (单位 : mm)	145X210mm			
钉装或胶装	<input checked="" type="checkbox"/> 钉装		<input type="checkbox"/> 胶装	
材 质	100克双胶			
其他要求	A2: 注意, 说明书按照1:1排版, 部分字体高度有严格要求, 制作过程中不要更改字体大小			
变更记录	A1:20160406			
	A2:2016.07.18调整字体大小, 补充技术要求(孙利华)			

COOKWORKS

FOOD PROCESSOR INSTRUCTION MANUAL Model No.:MJ-FP60D1



Read all the instructions carefully before using and please retain this instruction manual for further reference.

IMPORTANT NOTE

- Please read through and understand the below important note before using the product.

Do not try to remove the bowl and lid as one unit, as this could damage the appliance.

- **WARNING:** always first fit the bowl to the motor unit in prior to fitting the lid to the top of the bowl. The safety switch trigger pin at the base of the bowl can be damaged if you fail to do so.
- If the bowl and the lid are not securely locked the appliance will not operate. This is a safety feature.
- The bowl must be fitted to the motor body with the bowl handle at the right hand side only. The safety switch cannot be triggered if you fit the bowl from left hand side, Follow the lock and unlock indicator on the motor unit.

IMPORTANT SAFEGUARDS

When using electrical appliances, basic safety precautions should always be followed, including the following:

- This appliance can be used by children aged from 8 years and above and persons with reduced physical, sensory or mental capabilities or lack of experience and knowledge if they have been given supervision or instruction concerning use of the appliance in a safe way and understand the hazards involved.
- Children shall not play with the appliance. Cleaning and user maintenance shall not be made by children without supervision.
- This appliance is not intended for use by persons (including children) with reduced physical, sensory or mental capabilities, or lack of experience and knowledge, unless they have been given supervision or instruction concerning use of the appliance by a person responsible for their safety.
- Children should be supervised to ensure that they do not play with the appliance.
- If the supply cord is damaged, it must be replaced by the manufacturer, its service agent or similarly qualified persons in order to avoid a hazard.
- This appliance is intended to be used in household and similar applications such as:
 - staff kitchen areas in shops, offices and other working environments;
 - farm houses;
 - by clients in hotels, motels and other residential type environments;
 - bed and breakfast type environments.
- Switch off the appliance and disconnect from supply before changing accessories or approaching parts that move in use.
- Be careful when handling the sharp cutting blades, emptying the bowl and during cleaning the appliances.
- Be careful if hot liquid is poured into the food processor or blender as it can be ejected out of the appliance due to a sudden steaming.

KNOW YOUR APPLIANCE

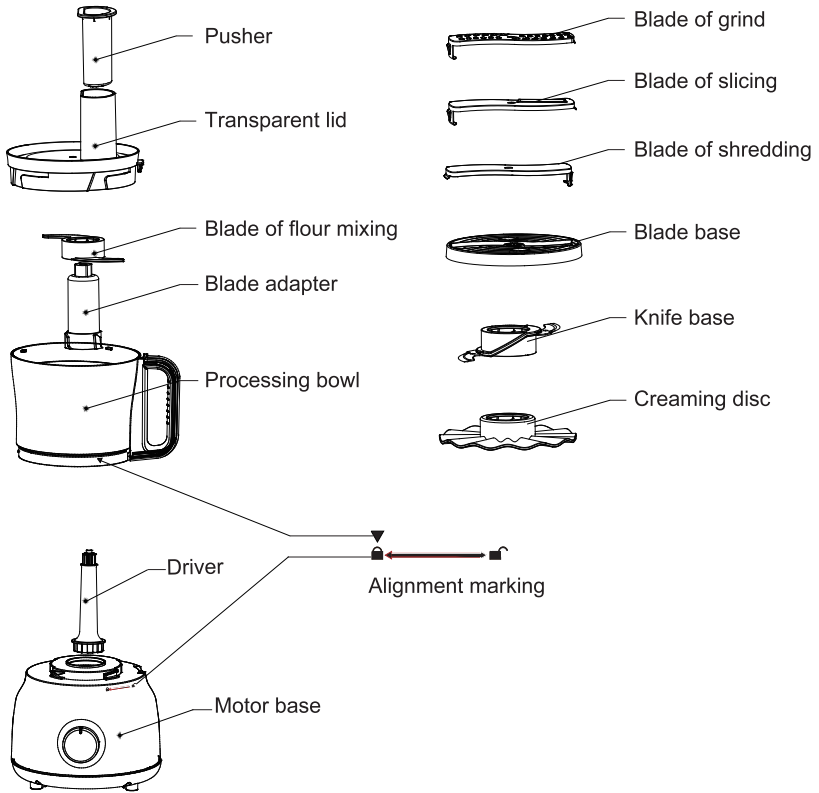

BEFORE USING FOR THE FIRST TIME

- Check that the voltage of the appliance corresponds to the voltage at your house.
- Wash the bowl in warm soapy water and rinse well.
- The bowl assembly should be firmly in place on motor base.

SAFETY LOCK SYSTEM

This appliance is equipped with a safety lock system which will prevent the motor starting without proper installation of the bowl and its lid.

To activate the system, you have to carry out the following:

- Put the plastic bowl onto the base with the handle at right hand side.
- **TURN THE BOWL UNTIL THE ALIGNMENT MARKING ON THE BASE AND BOWL ARE IN LINE.**
(see Know Your Appliance on page 3)
The lid has an activator to trigger the safety lock system.
The lid must be fitted onto the bowl and turn until it clicks into position.

The food processor can only be operated with the bowl handle fitted at the right hand side. The unit does not operate if the bowl was fitted at left hand side.
(see right diagram)

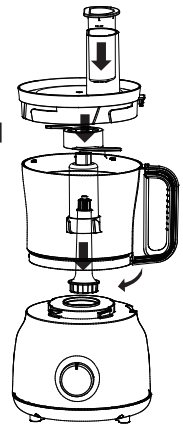

USEFUL INFORMATION

- **DO NOT OPERATE PROCESSOR LONGER THAN 80 SECONDS AT ONE TIME. STOP AND COOL FOR 3 MINUTES THEN RESUME.**
- The lid should be in place when operating.
- Do not use the bowl for storing beverages or foods.
- This appliance is equipped with a protective device. While the internal temperature is too high, it will switch itself off. Wait at least 15 minutes for the protection system to reset before attempting to restart the unit.
- The bowl capacity is 1500ML (for liquid) / 1500ML (for dry).

OPERATION GUIDE FOR FOOD PROCESSOR

1. Position the driver on motor base.
2. Position the processing bowl into the driver and turn clockwise to seat firmly on motor base.
3. Place blade adaptor onto the driver.
4. Place chopper onto the blade adaptor.
5. Turn the chopper to the right position.
6. Place cover on bowl, turn clockwise until cover interlocks on bowl.
7. Place pusher into feeding chute

Processed Food	Measurement Per batch
Chocolate	≤100g
Cheese	≤200g
meat	≤500g
Tea or Spice	50~100g
Fruit & Vegetable	100~300g
Onion	≤500g

Tips and Warning

Always keep the chopper inside the bowl before feeding food.

Use pulse function for several times to avoid cutting too fine. Do not run for too long while cutting hard cheese or chocolate. Otherwise these materials will overheat and begin to melt.

CLEANING

- The pulse button allows you to clean the bowl and the blade easily, rapidly and in complete safety.
- Pour a little lukewarm water into the bowl.
- Turn to pulse function for a few seconds.
- Remove the bowl and rinse under running water.
- Wipe and clean the motor housing with a damp cloth. Never immerse in water.

STORING

The appliance should not be stored while hot or plugged in. When not in use, allow the appliance to cool, then put it back into the box and store out of reach of children in safe, dry place.

CONNECTION TO POWER

- Before connecting, check that the voltage indicated on the appliance (bottom of the appliance) corresponds with the main voltage in your home. If this is not the case, consult your dealer and do not use.
- This appliance may be fitted with a non-rewirable plug. If you need to change the fuse in a non-rewirable plug, the fuse cover must be refitted. If the fuse cover is lost or damaged, the plug must not be used until a replacement is obtained (available from the appliance manufacturer).
- If the plug has to be changed because it is not suitable for your socket, or becomes damaged, it should be cut off and appropriate plug fitted following the wiring instructions. The plug removed must be disposed of safely as insertion into a mains socket is likely to cause an electrical hazard.
- This equipment must be disconnected from the mains when not in use. Do not allow this unit to be exposed to rain or moisture.

For your own safety read the following instructions carefully before attempting to connect this unit to the mains.

You should only plug the appliance into a 220-240V AC, 50Hz supply. Connecting it to other power sources may damage the appliance.

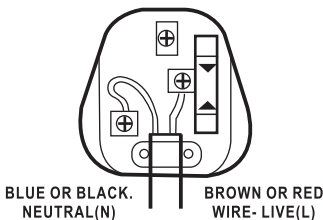

The wires in this mains lead are coloured in accordance with the following code:

BLUE = NEUTRAL
BROWN = LIVE

IMPORTANT

The colours of the wires in the mains lead of this appliance may not correspond with the coloured markings identifying the terminals in your plug, proceed as follows:



Caution
To prevent electric shock disconnect from the mains before removing the cover

The blue wire must be connected to the terminal marked with the letter N or coloured black.

The brown wire must be connected to the terminal marked with the letter L or coloured red.

If a 13 Amp (BS1363) fused plug is used it must be fitted with a 13A fuse conforming to BS1362 and be ASTA approved.

If in doubt contact a qualified electrician

DISPOSAL INFORMATION



DISPOSAL: Do not dispose this product as unsorted municipal waste. Collection of such waste separately for special treatment is necessary

This appliance is labeled in compliance with European directive 2002/96/EC for Waste Electrical and Electronic Equipment(WEEE). By ensuring that this appliance is disposed of correctly, you will help prevent any possible damage to the environment and to human health, which might otherwise be caused if it were disposed of in the wrong way.

The symbol on the product indicates that it may not be treated as normal household waste. It should be taken to a collection point for the recycling of electrical and electronic goods.

This appliance requires specialist waste disposal. For further information regarding the treatment, recover and recycling of this product please contact your local council, your household waste disposal service, or the shop where you purchased it.

For more detailed information about treatment, recovery and recycling of this product, please contact your local city office, your household waste disposal service or the shop where you purchased the product.



PRODUCT GUARANTEE

This product is guaranteed against manufacturing defects for a period of



Year

This product is guaranteed for twelve months from the date of original purchase.

Any defect that arises due to faulty materials or workmanship will either be replaced, refunded or repaired free of charge where possible during this period by the dealer from whom you purchased the unit.

The guarantee is subject to the following provisions:

- The guarantee does not cover accidental damage, misuse, cabinet parts, knobs or consumable items.
- The product must be correctly installed and operated in accordance with the instructions contained in this manual. A replacement copy of this instruction manual can be obtained from www.argos-support.co.uk
- It must be used solely for domestic purpose.
- The guarantee will be rendered invalid if the product is re-sold or has been damaged by inexpert repair.
- Specifications are subject to change without notice.
- The manufacturer disclaims any liability for the incidental or consequential damages.
- The guarantee is in addition to, and does not diminish your statutory or legal rights.

Guarantor: Argos Ltd
489 - 499 Avebury Boulevard
Central Milton Keynes
MK9 2NW
www.argos-support.co.uk