

RN303100MUK Rev1

morphy richards®

smart ideas for your home



Steam Iron

Please read and keep these instructions for future use

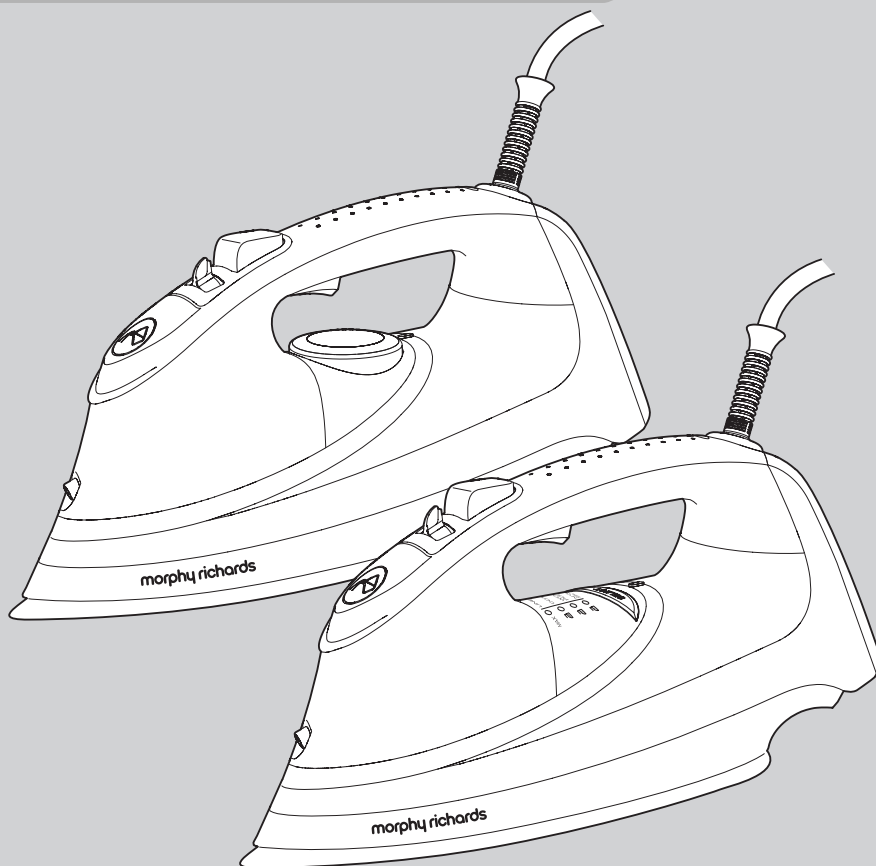

IMPORTANT: To prevent limescale problems which would not be covered by the guarantee, we recommend the use of distilled or demineralised water (available from most large supermarkets).

For competitions, product hints and tips and more join us at



www.morphyrichards.co.uk/blog



www.facebook.com/morphyrichardsuk



[@loveyourmorphy](https://twitter.com/loveyourmorphy)

www.morphyrichards.com

* Register online for your 3 year guarantee. See the back of this instruction book for details. (UK and Ireland customers only)

Important safety instructions

- This appliance can be used by children aged from 8 years and above and persons with reduced physical, sensory or mental capabilities or lack of experience or knowledge if they have been given supervision or instruction concerning use of the appliance in a safe way and understand the hazards involved. Cleaning and user maintenance shall not be made by children without supervision.
- Children shall not play with the appliance.
- Keep the iron and its cord out of reach of children less than 8 years of age at all times.
- The iron must not be left unattended while it is connected to the supply mains.
- The plug must be removed from the socket before filling the iron with water.
- The iron must be used and rested on a stable surface.
- When placing the iron on its heel, ensure that the surface on which the heel is placed is stable.
- The iron is not to be used if it has been dropped, if there are visible signs of damage or it is leaking.
- The filling aperture must not be opened during use.



CAUTION - HOT: Burns can occur from touching hot parts, hot water or steam.

- **WARNING:** To avoid electric shock, do not immerse the appliance in water / liquid.
- **WARNING:** Misuse of the appliance could cause personal injury.

Electrical requirements and mains cable

- Check that the voltage on the rating plate of your appliance corresponds with your house electricity supply which must be A.C. (Alternating current).
- Do not operate with a damaged supply cord or grommet, it must be replaced by the manufacturer, its service agent or similarly qualified person in order to avoid a hazard.
- Do not let the mains lead come into contact with the hot soleplate of the iron.
- Should the fuse in the mains plug require changing, a 13 amp BS1362 fuse must be fitted.
- **WARNING:** This appliance must be earthed.

PLEASE READ ALL INSTRUCTIONS AND KEEP FOR REFERENCE

Steam iron overview

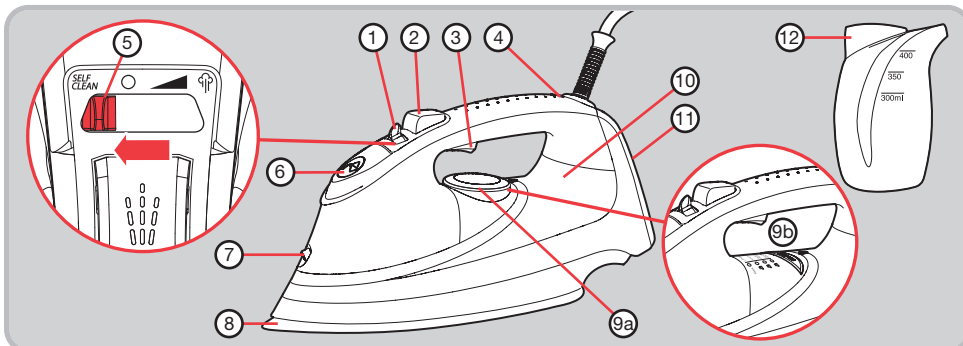

- | | | |
|---|---|---|
| (1) Variable steam switch | (8) Soleplate | (10) Water tank |
| (2) Water spray button | (9a) Temperature dial with illuminated temperature indication (certain models only) | (11) Iron heel |
| (3) Steam boost trigger | (9b) Electronic temperature control panel with illuminated temperature indication (certain models only) | (12) Filling beaker (certain models only) |
| (4) Auto shut-off indicator (certain models only) | | |
| (5) Self clean position | | |
| (6) Filling hole with cap | | |
| (7) Spray nozzle | | |

Temperature guide

Heat setting markings on the temperature dial of all Morphy Richards irons match those of the International Textile Care Labelling Code

Symbol	(120°C Max) Cool	(160°C Max) Warm	(210°C Max) Hot	MAX setting
Control dial positions	Do not iron	•	••	•••
Steam level setting (see step 4 of 'Using the iron for steam ironing' on page 4)	No steam (see 'Dry ironing' on page 5)	Low	Medium	High
Fabric	Nylon, Acetates, synthetic fabrics	Wool, Polyester mixtures	Cotton, Linen Rayon, Rayon mixtures	Linen
Ironing	Iron on wrong side, if moisture required, use damp cloth (not Acetate)		Fabrics requiring this setting usually require steam pressing.	
With water in tank	← Dry and spray		← Steam/shot of steam →	
Without water in tank	← Dry ironing →			

Before use

Remove the protective cover from the soleplate (8).

Using the iron for steam ironing

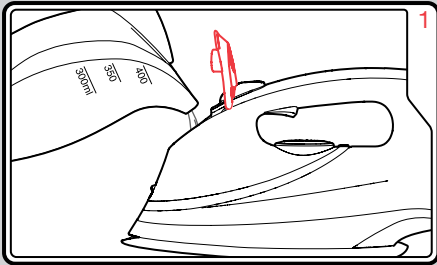

Make sure the iron is not plugged in. Set the variable steam switch (1) to 'O'. Fill the water tank (10) via the filling hole (6). Fill with the iron in a horizontal position to the MAX graphic on the side of the water tank.

IN HARD WATER AREAS, WE RECOMMEND THE USE OF DISTILLED OR DEMINERALISED WATER.

Never use battery topping up fluid or water containing any substances like starch, sugar, fragrant additives or defrosted water from a refrigerator.

NOTE: Please see point 2 of 'Exclusions' on page 8.

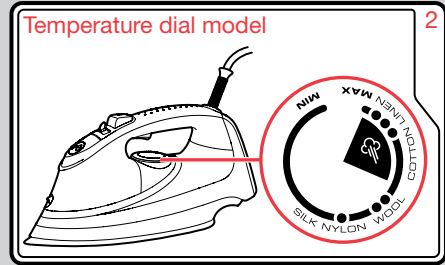

Plug in the iron and switch on at the mains.

Set the temperature dial (9a) (certain models only) to the temperature required (see 'Temperature Guide' on page 3).

The temperature illumination in the dial will illuminate until the required temperature is reached, then it will turn off.

Tip: We recommend the temperature indicator light is allowed to illuminate and extinguish twice for the temperature to stabilise before you begin ironing.

The temperature indicator light will switch on and off whilst you are ironing, as the iron regulates the temperature.

Tip: Begin with cool fabrics and work up to higher settings. An iron heats up quicker than it cools down so this will save you time and energy.

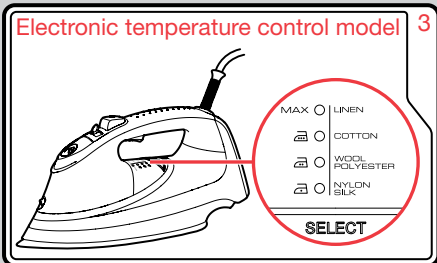

Set the electronic temperature control panel (9b) (certain models only) to the temperature required (see 'Temperature Guide' on page 3).

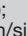
The iron will default to  (cotton) when the iron is plugged in. Press the 'SELECT' button to toggle the temperature:

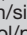
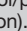
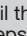
one press for MAX setting (linen);
two presses for  setting (nylon/silk);
three presses for  setting (wool/polyester);
four presses for  setting (cotton).

The appropriate light flashes until the temperature is reached, and then the iron beeps.

For further information, see tips in step 2, above.

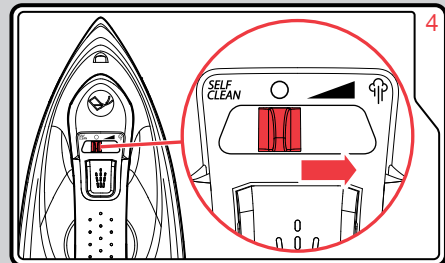

Vary the steam output using the variable steam switch (1), as shown above.

Only use the steam function on heavy fabrics and when the temperature dial (9a) (certain models only) is set within the shaded area,

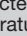

or the  or  or MAX setting is selected on the electronic temperature control panel (9b) (certain models only).



Using the iron for steam ironing (continued)

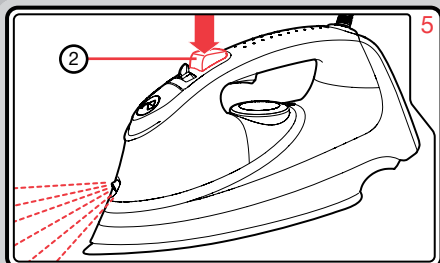

For stubborn creases, use the water spray button (2).

If using for the first time, you may need to press this a few times to prime the pump.

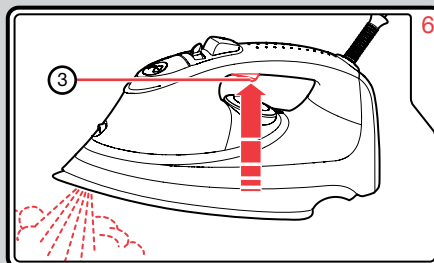

Steam boost

Press the steam boost trigger (3) for an extra steam burst for stubborn creases / heavy fabrics.

NOTE: If you need to use the steam boost whilst dry ironing, check the temperature is set within the steam range (see step 4, on page 4).

NOTE: For optimum steam quality, do not operate the shot more than three times in succession.

Features of your iron

Dry ironing

Your iron can be used for dry ironing. Set the variable steam switch (1) to 'O' and set the temperature as desired (see 'Temperature Guide' on page 3).

You won't need water in the tank unless using the water spray or steam boost features.

Vertical steam

Vertical steam is useful for removing creases from hanging clothes, curtains, etc. Hold the iron between 1cm and 2cm away from the item and press the steam boost trigger (3).

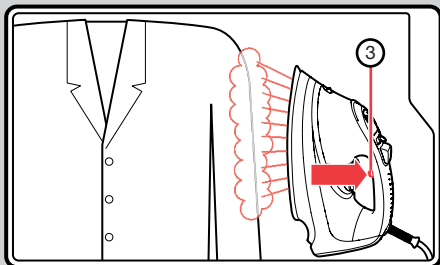

Anti-drip system (certain models only)

This prevents water escaping from the soleplate (8) when the iron is too cold.

During use, the anti-drip system may emit a loud click, particularly during heat-up or whilst cooling down. This is perfectly normal and indicates that the system is functioning correctly.

Anti-scale system (certain models only)

This system reduces scale deposits and helps prolong the life of the iron.

Auto shut-off (certain models only)

The iron will automatically shut down if stationary in the horizontal position for 1 minute, or in the vertical position for 8 minutes.

When auto shut-off is activated, a beep will be heard and the indicator light (4) will flash.

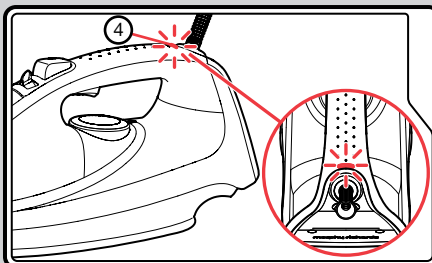

Gently move the iron and it will reheat. Wait for the iron to heat-up and continue ironing.

Maintenance

To clean a coated soleplate

Do not use scouring powder or solution as this could cause damage to the coating.

If any man-made fibres fuse to the soleplate (8), set the iron at the MAX position and pass it over a clean piece of cotton to draw the deposit off the surface.

To clean the exterior

Allow the unit to cool and wipe over with a damp cloth and mild detergent, then wipe dry.

Emptying and storing

When you have finished ironing, unplug and empty all water from your iron and set the steam switch at the 'O' position. When cool, store the iron on its heel with the cord wrapped loosely around the heel.

NOTE: Please see point 3 of 'Exclusions' on page 8.

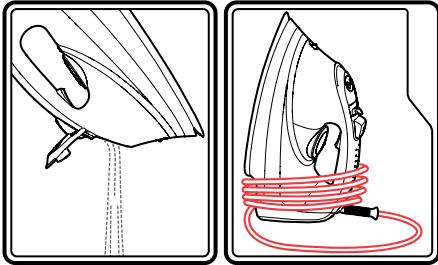

Self clean

Your iron has a built in cleaning system designed to keep the water valve, steam chamber and steam vents clear of lint and loose mineral deposits.

- 1 Half fill the iron with water.
- 2 Place the iron on its heel (11).
- 3 Move the variable steam switch (1) to the 'O' position.

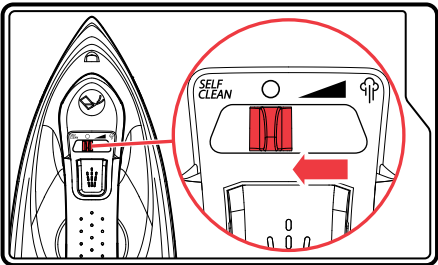

- 4 Connect to a mains supply outlet.
- 5 Set the temperature to 'MAX'.
- 6 Leave the iron switched on, rested on its heel (11) until the temperature indicator light goes out.

WARNING: Keep hands and body away from the hot soleplate.

- 7 Disconnect the iron from the mains supply outlet.
- 8 Whilst the iron is still very hot, hold the iron **horizontally** over a sink.

CAUTION: The soleplate will still be hot, so ensure the power cord and plug are kept away from it and the sink.

- 9 Push the variable steam switch (1) fully to the left and hold in the self clean position (5).

WARNING: Steam and boiling hot water will drain from the holes in the soleplate. Keep hands and body away from the hot water. This washes away the scale and minerals that have built up inside the steam chamber.

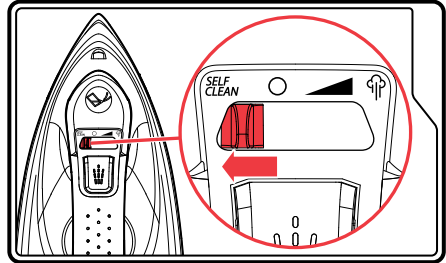

- 10 Whilst still holding the variable steam switch (1) in the self clean position (5), gently move the iron back and forth until the water tank is empty.
- 11 When cleaning is complete, move the variable steam switch back to the 'O' position.
- 12 Rest your steam iron back on its heel and allow to fully cool down.
- 13 Wipe the soleplate (8) with a cold, damp cloth.

After this cleaning operation, empty out any remaining water.

IMPORTANT: Do not attempt to descale the soleplate with descaling products.

Contact us

Helpline

If you are having a problem with your appliance, please call our Helpline, as we are more likely to be able to help than the store you purchased the item from. Please have the product name, model number and serial number to hand when you call to help us deal with your enquiry quicker.

UK Helpline: **0344 871 0944**

IRE Helpline: **1800 409 119**

Spares: **0344 873 0710**

Talk to us

If you have any questions or comments, or want some great tips to help you get the most out of your products, join us online:

Blog: www.morphyrichards.co.uk/blog

Facebook: www.facebook.com/morphyrichardsuk

Twitter: [@loveyourmorphy](https://twitter.com/loveyourmorphy)

Website: www.morphyrichards.com

Notes

<hr/> <hr/> <hr/> <hr/> <hr/> <hr/> <hr/> <hr/> <hr/> <hr/> <hr/> <hr/> <hr/> <hr/> <hr/> <hr/> <hr/> <hr/> <hr/> <hr/> <hr/> <hr/> <hr/>	<hr/> <hr/> <hr/> <hr/> <hr/> <hr/> <hr/> <hr/> <hr/> <hr/> <hr/> <hr/> <hr/> <hr/> <hr/> <hr/> <hr/> <hr/> <hr/> <hr/> <hr/> <hr/> <hr/>
---	---



RN303100MUK Rev1 12/15

Registering your 3 year guarantee

Your standard 1 year guarantee is extended for an additional 2 years when you register the product within 28 days of purchase with Morphy Richards. If you do not register the product with Morphy Richards within 28 days, your product is guaranteed for 1 year. To validate your 3 year guarantee register with us online at

www.morphyrichards.co.uk

Or call our customer registration line, quoting model and serial number, these numbers can be found on the base of the product.

UK 0344 871 0242

IRE 1800 409 119

N.B. Each qualifying product needs to be registered with Morphy Richards individually.

Please note that the 3 year guarantee is only available in the UK and Ireland. Please refer to the 1 year guarantee for more information.

Your 1 year guarantee

It is important to retain the retailer's receipt as proof of purchase. Staple your receipt to this back cover for future reference.

Please quote the following information if the product develops a fault. These numbers can be found on the base of the product.

Model no.

Serial no.

All Morphy Richards products are individually tested before leaving the factory. In the unlikely event of any appliance proving to be faulty within 28 days of purchase, it should be returned to the place of purchase for it to be replaced.

If the fault develops after 28 days and within 12 months of original purchase, you should contact the Helpline number quoting Model number and Serial number on the product, or write to Morphy Richards at the address shown.

You may be asked to return a copy of proof of purchase.

Subject to the exclusions set out below (see Exclusions), the faulty appliance will then be repaired or replaced as appropriate and dispatched usually within 7 working days of receipt.

If, for any reason, this item is replaced or repaired during the 1 year guarantee period, the guarantee on the new item will be calculated from original purchase date. Therefore it is vital to retain your original till receipt or invoice to indicate the date of initial purchase.

To qualify for the 1 year guarantee, the appliance must have been used according to the instructions supplied. For example, water should be emptied after each use.

Exclusions

Morphy Richards shall not be liable to replace or repair the goods under the terms of the guarantee where:

- 1 The fault has been caused or is attributable to accidental use, misuse, negligent use or used contrary to the manufacturer's recommendations or where the fault has been caused by power surges or damage caused in transit.
 - 2 The fault is caused by limescale build-up.
 - 3 The cables are damaged due to wrapping too tightly or excessive kinking.
 - 4 The appliance has been used on a voltage supply other than that stamped on the products.
 - 5 Repairs have been attempted by persons other than our service staff (or authorised dealer).
 - 6 The appliance has been used for hire purposes or non domestic use.
 - 7 The appliance is second hand.
 - 8 Morphy Richards reserves the right not to carry out any type of servicing under the guarantee at its discretion.
- This guarantee does not confer any rights other than those expressly set out above and does not cover any claims for consequential loss or damage. This guarantee is offered as an additional benefit and does not affect your statutory rights as a consumer. Morphy Richards products are intended for household use only. See usage limitations within the location safety instructions.

Disclaimer

Morphy Richards has a policy of continuous improvement in product quality and design. The company, therefore reserves the right to change the specification of its models at any time.



For electrical products sold within the European Community. At the end of the electrical products useful life, it should not be disposed of with household waste.

Please recycle where facilities exist. Check with your Local Authority or retailer for recycling advice in your country

**IF YOU ARE HAVING A PROBLEM
WITH ONE OF OUR PRODUCTS,
CALL OUR HELPLINE:**

**UK: 0344 871 0944
EIRE: 1800 409 119
SPARES: 0344 873 0710**

morphy richards

The After Sales Division
Morphy Richards Ltd
Mexborough,
South Yorkshire,
England, S64 8AJ

www.morphyrichards.com

