



WAHL (UK) LTD
STERLING HOUSE
CLIPPER CLOSE
RAMSGATE
KENT, CT12 5GG

CUSTOMER SERVICES T: 01227 740066
www.wahl.co.uk

Form No. ZB621
Rev1 07-18

PET NAIL GRINDER INSTRUCTIONS

IMPORTANT SAFEGUARDS

When using an electrical appliance, basic precautions should always be followed, including the following:

DANGER – To reduce the risk of death or injury by electric shock:-

1. Do not reach for nail grinder if it has fallen into water.
 2. This appliance can be used by children aged from 14 years and above and persons with reduced physical, sensory or mental capabilities or lack of experience and knowledge if they have been given instruction or supervision, by a person responsible for their safety, concerning the use of the appliance in a safe way and understanding the hazards involved. Children should not play with the appliance. Cleaning and user maintenance should not be carried out by children under the age of 14 years.
 3. Do not place or store the nail grinder where it can fall or be pulled into a bath or sink. Do not place in or drop into water or any other liquid.
- WARNING** – To reduce the risk of burns, electric shock or injury to persons:
1. Close supervision is necessary when the nail grinder is used by, or near children or individuals with certain disabilities.
 2. Use this appliance only for its intended use as described in this manual. Do not use attachments not recommended by the manufacturer.
 3. Never operate the nail grinder if it is not working properly or if it has been dropped or damaged, or if it has been in contact with water. In these circumstances return to an authorised service centre for examination or repair.
 4. Never drop this appliance or insert any object into any opening.
 5. Do not use the appliance outdoors or operate where aerosol (spray) or other flammable products are being used or where oxygen is being administered.
 6. Do not touch grinding drum or attachment after use. These may be hot and cause burns to the skin.
 7. Clean the nail grinder's air vents with compressed air on a regular

Please read all instructions carefully to familiarise yourself with the Wahl Classic Nail Grinder before using.
Save these instructions for further reference.

For any further assistance or information visit
W: www.wahl.co.uk
E: customer.services@wahl.co.uk

DESCRIPTION OF PARTS



KIT INCLUDES:

1. Nail Grinder
 2. Safety Cap
 3. 2 Large Sanding Drums
 4. 5 Large Sanding Bands
 5. Battery Cover
- Instruction booklet

Requires 2 C Batteries (not included).

basis. Material may accumulate inside the grinder and cause electrical failure.

8. Always use safety glasses when using the nail grinder. Do not wear loose jewellery or clothing when in use. Keep long hair pulled back and clear of the appliance.
9. Do not allow the animal to lick or touch the nail grinder during use.
10. To prevent damage to the pet nail DO NOT hold the sanding band in one place on the nail or apply excessive pressure to the nail whilst grinding.
11. Make sure attachments are securely in place before use. Before each use check that the sanding drum is sufficiently expanded to secure the sanding band during use. If the sanding band is loose during operation it may be ejected from the grinder and cause injury.
12. **WARNING:** During use do not place or leave this appliance where it may be damaged by the animal or exposed to the weather.

OPERATING INSTRUCTIONS:
SAVE THESE INSTRUCTIONS FOR FUTURE REFERENCE.
THIS PRODUCT IS INTENDED FOR HOME USE ONLY.

NAIL ANATOMY:

Before you begin trimming your pet's nails, you will need to identify the 'quick' in the nail. The diagram (Fig. 1) will help you understand the basic nail anatomy. The outer nail is hard and has no nerve endings and protects the inner soft part of the nail, known as the 'quick'. The quick contains nerve endings, tiny blood vessels and is very sensitive should you accidentally cut or grind into it.

With lighter coloured nails the quick can usually be seen which will make it easier to avoid when grinding. Dark coloured nails may not allow you to see where the quick is. While grinding, keep checking the nail and watch for a dark spot in the middle of the grinding area. This spot will indicate the start of the quick and once visible you should stop grinding immediately.

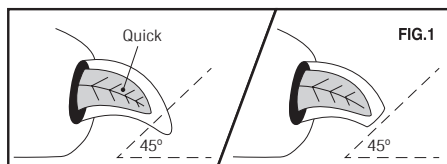

SAFETY CAP:

This product includes a safety cap which is designed to reduce the risks when using this appliance.

We recommend that you always screw the safety cap into place before use. This will:

- Reduce the risk of injury from the high velocity spinning grinding drum.
- Reduce the risk of pet hair, clothing or other items becoming caught around the spindle or drum.
- Manage the positioning of the nail when it comes into contact with the drum.

HOW TO TRIM:

Keep your pet's nails well-trimmed for greater comfort and well-being.

1. Ensure the pet is relaxed and comfortable.
2. Have the pet sitting on the floor or on your lap.
3. Hold the paw firmly and using your thumb, apply light to moderate pressure to the animal's pads in order to separate their toes.
4. The 'on/off' switch is located on the front of the grinder. When ready to proceed turn the grinder 'on'.
5. Place the pet's nail through one of the holes on the safety cap until it comes into contact with the sanding band.
6. For best results start grinding from the bottom of the nail, slowly moving toward the tip. Apply consistent pressure, moving the grinder from side to side of each nail.
7. CAUTION – Do not over-grind or apply excessive pressure to the nail. (See Fig. 1 'Nail Anatomy' for further information to safely grind your pet's nails).
8. To avoid tangling of hair on long-haired animals, push hair away from pet's claws before applying the grinder. (Tip – Use a small nylon stocking or sock over the pet's paw and push the nails through a hole at the end to ensure only the nails are exposed). If the pet's hair becomes wrapped around the grinding tool this will cause pain and may require cutting.
9. For larger claws, position the front paw forward in order to grind nails.
10. For smaller claws, hold the paw up and position it below their body. Pay extra attention not to entangle the hair.

WHAT TO DO IF YOU ACCIDENTALLY HIT THE QUICK:

If unfortunately, you happen to cut into the quick of the nail and the nail starts to bleed, don't allow your dog to wrench away from you and run around. Hold him firmly and reassure him. You will need to apply styptic powder or corn starch onto the end of the nail. Maintain your original grasp on the paw and press the powder to the end of the nail until the bleeding stops. You may have to keep packing powder for two to three minutes, but the longer you are able to apply steady pressure, the more effectively you will stop

the bleeding. Be aware that this will be extremely painful for the dog and he may resist. Don't be concerned if your dog wants to lick the wound after the initial bleeding stops. Do keep him from running about for at least 15 minutes. Bleeding should stop within 10 – 15 minutes of applying pressure and powder. If the nail is still bleeding freely after 30 minutes of applying pressure and powder then you should seek veterinary advice.

CHANGING THE SANDING BAND:

(You will require a small crosshead screwdriver).

1. Select either the 60 or 100 grit sanding band. (60 grit medium sanding band for quick and efficient grinding down of your pet's nails, or 100 grit fine sanding band for smoothing uneven, rough nails.)
2. Ensure the grinder is in the 'OFF' or '0' position before changing the attachments.
3. Unscrew the safety guard.
4. Hold the grinding drum firmly and loosen the single screw on the top of the grinding drum by turning the screw anti-clockwise with a crosshead screw driver. This will reduce the size of the drum allowing the sanding band to become loose.
5. Slide off the sanding band and replace with a new sanding band.
6. When the new sanding band is in place tighten the screw turning it clockwise with the screwdriver to increase the drum size to hold the new sanding band in place.
7. Replace the safety guard.

CHANGING THE SANDING DRUM

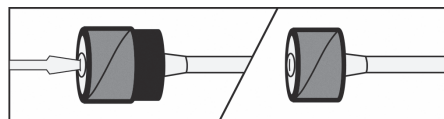

1. Ensure the grinder is in the 'OFF' or '0' position before changing the attachments.
2. Unscrew the protective cap.
3. Hold the sanding drum firmly with one hand and hold the body of the grinder with the other hand.
4. Firmly, but gently, pull the sanding drum away from the grinder.
5. Replace the drum by placing the hole in the plastic tube at the base of the drum onto the metal spindle in the grinder.
6. Firmly, but gently, push the two pieces together.
7. Screw on the protective cap.

MAINTENANCE:

- After each use remove any debris and dust from the grinder by using a soft brush.
- To clean the housing use a soft, dry cloth.
- For maximum efficiency ensure the grinding attachments and sanding bands are properly replaced when worn.
- Periodically examine the tool for any wear or damage.

To order replacement accessories please visit wahlstore.co.uk.

CHANGING THE BATTERIES:

1. When the battery is low the speed of the unit will be slower and the resistance of the spinning drum will be reduced. This means it is time to change the batteries.
2. Ensure the grinder is in the 'OFF' or '0' position before changing the batteries.
3. The battery cover is located on the bottom of the grinder. Hold the unit with one hand and unscrew the bottom cap (battery cover) with the other hand.
4. Place 2 x C Alkaline batteries into the shaft of the grinder and replace the bottom cap by screwing in all the way.

BATTERY DISPOSAL

BATTERY REMOVAL AND DISPOSAL

Do not dispose of this product or the battery in the normal household waste.

At the end of your products life the battery must be removed and recycled/disposed of correctly and not disposed of with the product.

Batteries should be disposed of at an official collection point in an environmentally safe way or taken to a local collection facility where they will be dealt with safely and sent for the appropriate recycling.

DISPOSAL

Handle with care! Environmental damage in the case of incorrect disposal.

Correct disposal will ensure environmental protection and prevent any potentially harmful impacts on people and the environment.

Adhere to the relevant legal requirements when disposing of the appliance. Information on the disposal of electrical and electronic appliances in the European Community:

Within the European Community, national regulations are specified for the disposal of electrical appliances, based on EU Waste Electrical and Electronic Equipment Directive 2002/96/EC (WEEE). In accordance with this, the appliance can no longer be disposed of with the local or domestic waste.

The appliance will be accepted free of charge by local collection points or recycling centres.

GUARANTEE

This product is guaranteed against defects in material and workmanship for a period of 2 years from the date of original purchase or receipt as a gift.

Should this product become defective during the guarantee period, return it to the store of purchase together with your proof of purchase for repair or replacement.

Alternatively within the guarantee period you can return the product to Wahl (UK) Ltd who will repair any such defect or elect to replace the product or any part of it, without charge, provided there is proof of purchase. Should a replacement be offered this will not extend the original guarantee period.

The guarantee becomes invalid in the case of misuse, alteration or repair by unauthorised persons.

This guarantee does not include sanding bands or sanding drums which are consumable parts.

This product is designed for domestic use only and any use within a professional environment will invalidate the guarantee.

This guarantee in no way affects your rights under law in the United Kingdom.