

# WORX®

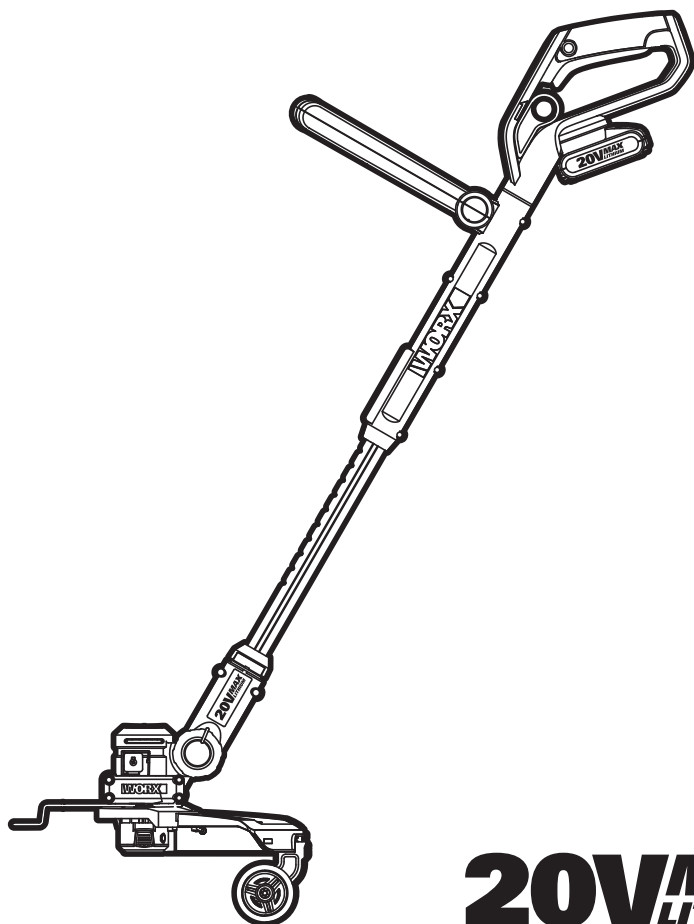

**20V<sup>MAX</sup>**  
**LITHIUM**

## **SAFETY AND OPERATING MANUAL**

### **ORIGINAL INSTRUCTIONS**

**3 in 1: Trimmer / Edger / Mini mower**  
**WG169E WG169E.2 WG169E.5 WG169E.9**



# PRODUCT SAFETY

## GENERAL SAFETY

### WARNINGS



**WARNING: Read all safety warnings and all instructions.**

Failure to follow the warnings and instructions may result in electric shock, fire and/or serious injury.

#### **Save all warnings and instructions for future reference.**

The appliance is only to be used with the power supply unit provided with the appliance.

#### **IMPORTANT**

#### **READ CAREFULLY BEFORE USE**

#### **KEEP FOR FUTURE REFERENCE**

#### **Safe operating practices**

##### **1. TRAINING**

- a) Read the instructions carefully. Be familiar with the controls and the correct use of the machine.
- b) Never allow children, persons with reduced physical, sensory or mental capabilities or lack of experience and knowledge or people unfamiliar with these instructions to use the machine, local regulations may restrict the age of the operator.
- c) Keep in mind that the operator or user is responsible for accidents or hazards occurring to other people or their property.

##### **2. PREPARATION**

- a) Before use, always visually inspect the machine for damaged, missing or misplaced guards or shields.
- b) Never operate the machine while people, especially children, or pets are nearby.

##### **3. OPERATION**

- a) Wear eye protection, long trousers and stout shoes at all times while operating the machine.
- b) Avoid using the machine in bad weather conditions especially when there is a risk of lightning.
- c) Use the machine only in daylight or good artificial light.

- d) Never operate the machine with damaged guards or shields or without guards or shields in place.
- e) Switch on the motor only when the hands and feet are away from the cutting means.
- f) Always disconnect the machine from the power supply (e.g. remove the battery pack from the machine)
  - 1) Whenever the machine is left unattended;
  - 2) Before clearing a blockage;
  - 3) Before checking, cleaning or working on the machine;
  - 4) After striking a foreign object;
  - 5) Whenever the machine starts vibrating abnormally.
- g) Take care against injury to feet and hands from the cutting means.
- h) Always ensure that the ventilation openings are kept clear of debris.
- i) Never fit metal cutting elements.
- j) Always be sure of your footing on slopes.
- k) Walk, never run.
- l) Not overreach and keep the balance at all times.
- m) Not to touch moving hazardous parts before removing the battery pack from the machine and the moving hazardous parts have come to a complete stop.

##### **4. MAINTENANCE AND STORAGE**

- a) Disconnect the machine from the power supply (e.g. remove the battery pack from the machine) before carrying out maintenance or cleaning work.
- b) Use only the manufacturer's recommended replacement parts and accessories.
- c) Inspect and maintain the machine regularly. Have the machine repaired only by an authorized repairer.
- d) When not in use, store the machine out of the reach of children.

### **SAFETY WARNINGS FOR BATTERY PACK**

- a) **Do not dismantle, open or shred cells or battery pack.**
- b) **Do not short-circuit a battery pack. Do**

**not store battery packs haphazardly in a box or drawer where they may short-circuit each other or be short-circuited by conductive materials.**

When battery pack is not in use, keep it away from other metal objects, like paper clips, coins, keys, nails, screws or other small metal objects, that can make a connection from one terminal to another. Shorting the battery terminals together may cause burns or a fire.

- c) Do not expose battery pack to heat or fire. Avoid storage in direct sunlight.**
- d) Do not subject battery pack to mechanical shock.**
- e) In the event of battery leaking, do not allow the liquid to come into contact with the skin or eyes. If contact has been made, wash the affected area with copious amounts of water and seek medical advice.**
- f) Seek medical advice immediately if a cell or battery pack has been swallowed.**
- g) Keep battery pack clean and dry.**
- h) Wipe the battery pack terminals with a clean dry cloth if they become dirty.**
- i) Battery pack needs to be charged before use. Always refer to this instruction and use the correct charging procedure.**
- j) Do not maintain battery pack on charge when not in use.**
- k) After extended periods of storage, it may be necessary to charge and discharge the battery pack several times to obtain maximum performance.**
- l) Battery pack gives its best performance when it is operated at normal room temperature (20°C ± 5°C).**
- m) When disposing of battery packs, keep battery packs of different electrochemical systems separate from each other.**
- n) Recharge only with the charger specified by WORX. Do not use any charger other than that specifically provided for use with the equipment.**

A charger that is suitable for one type of battery pack may create a risk of fire when used with another battery pack.

- o) Do not use any battery pack which is not designed for use with the equipment.**
- p) Keep battery pack out of the reach of children.**
- q) Retain the original product literature for future reference.**
- r) Remove the battery from the equipment when not in use.**
- s) Dispose of properly.**

# SYMBOLS



Read operator's manual



Keep bystanders away



Wear eye and ear protection



Do not expose to rain



Do not burn



Batteries may enter water cycle if disposed improperly, which can be hazardous for ecosystem. Do not dispose of waste batteries as unsorted municipal waste.



Li-Ion



Li-Ion battery. This product has been marked with a symbol relating to 'separate collection' for all battery packs and battery pack. It will then be recycled or dismantled in order to reduce the impact on the environment. Battery packs can be hazardous for the environment and for human health since they contain hazardous substances.



Waste electrical products must not be disposed of with household waste. Please recycle where facilities exist. Check with your local authorities or retailer for recycling advice.

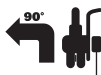

Edging



Trimming

**xINR18/65-y:** Cylindrical lithium Ion battery cells with max diameter of 18mm and max height of 65mm; "x" represents a number cells serial connected, blank if 1; "-y" represents a number of cells paralleled connected, blank if 1.

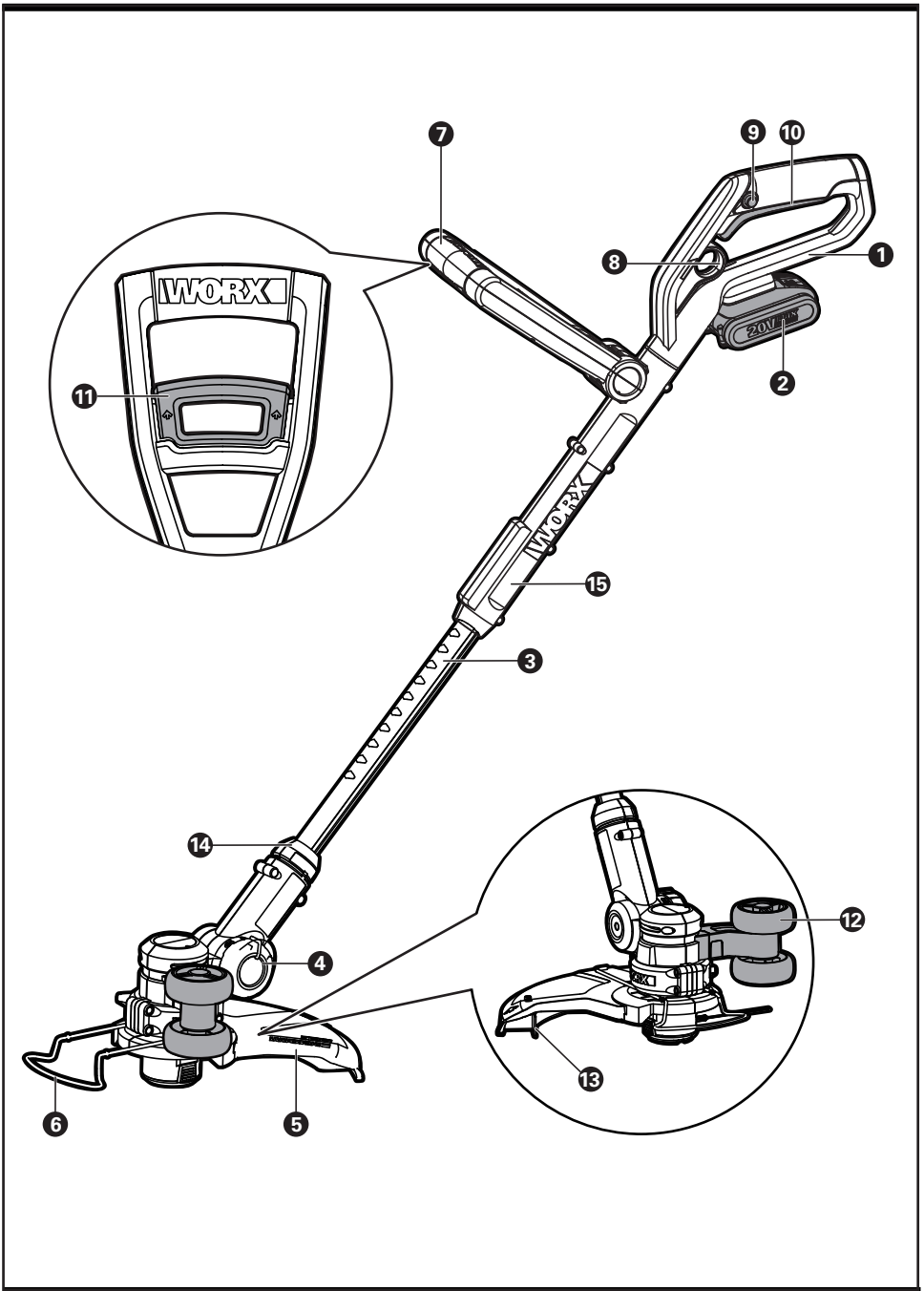

**3 in 1: Trimmer / Edger / Mini mower  
WG169E WG169E.2 WG169E.5 WG169E.9**

- 
- 1. REAR HANDLE**

---

  - 2. BATTERY PACK**

---

  - 3. TELESCOPIC SHAFT**

---

  - 4. PIVOT HEAD LOCKING KNOB**

---

  - 5. SAFETY GUARD**

---

  - 6. FLOWER GUARD/EDGER GUIDE**

---

  - 7. AUXILIARY HANDLE**

---

  - 8. TELESCOPIC SHAFT ADJUSTMENT TRIGGER**

---

  - 9. LOCK OFF BUTTON**

---

  - 10. ON/OFF SWITCH**

---

  - 11. AUXILIARY HANDLE LOCKING LEVER**

---

  - 12. EDGER/TRIMMING SUPPORT WHEELS**

---

  - 13. LINE CUTTER**

---

  - 14. LOWER SHAFT COUPLING**

---

  - 15. UPPER SHAFT**

---

  - 16. MOTOR HOUSING OF TRIMMER HEAD (See Fig. H2)**

---

  - 17. LINE FEED BUTTON (See Fig. K1)**

---

  - 18. SPOOL CAP COVER (See Fig. K2)**

---

  - 19. CAP RELEASE LATCH (See Fig. K2)**

---

  - 20. SPOOL (See Fig. K2)**

---

  - 21. CUTTING HEAD (See Fig. K2)**

---

  - 22. EYELET (See Fig. K2)**
- 

**Not all the accessories illustrated or described are included in standard delivery.**

## TECHNICAL DATA

Type **WG169E WG169E.2 WG169E.5 WG169E.9** (1-designation of machinery, representative of Grass Trimmer)

	<b>WG169E / WG169E.2</b>	<b>WG169E.5</b>	<b>WG169E.9</b>
Voltage	20V $\overline{\text{---}}$ Max*		
No load speed	7600/min		
Cutting diameter	30cm		
Line diameter	1.65mm		
Charging time	5hr approx.	1hr approx.	/
Machine weight	2.6kg	2.6kg	2.2kg

\* Voltage measured without workload. Initial battery voltage reaches maximum of 20 volts. Nominal voltage is 18 volts.

## NOISE DATA

A weighted sound pressure	$L_{pA} = 78\text{dB(A)}$
$K_{pA}$	3.0dB(A)
A weighted sound power	$L_{wA} = 94\text{dB(A)}$
Wear ear protection	

## VIBRATION INFORMATION

Typical weighted vibration	$a_h = 2.8\text{m/s}^2$
Uncertainty	$K = 1.5\text{m/s}^2$

The declared vibration total value may be used for comparing one tool with another, and may also be used in a preliminary assessment of exposure.

 **WARNING!** The vibration emission value during actual use of the power tool can differ from the declared value depending on the ways in which the tool is used dependant on the following examples and other variations on how the tool is used:

How the tool is used and the materials being cut or drilled.

The tool being in good condition and well maintained.

The use the correct accessory for the tool and ensuring it is sharp and in good condition.

The tightness of the grip on the handles and if any anti vibration accessories are used.

And the tool is being used as intended by its design and these instructions.

**This tool may cause hand-arm vibration syndrome if its use is not adequately managed.**

**3 in 1: Trimmer / Edger / Mini mower  
WG169E WG169E.2 WG169E.5 WG169E.9**





**WARNING!** To be accurate, an estimation of exposure level in the actual conditions of use should also take account of all parts of the operating cycle such as the times when the tool is switched off and when it is running idle but not actually doing the job. This may significantly reduce the exposure level over the total working period.

Helping to minimize your vibration exposure risk.

ALWAYS use sharp chisels, drills and blades.

Maintain this tool in accordance with these instructions and keep well lubricated (where appropriate).

If the tool is to be used regularly then invest in anti vibration accessories.

Avoid using tools in temperatures of 10°C or less.

Plan your work schedule to spread any high vibration tool use across a number of days.

## ACCESSORIES

	<b>WG169E</b>	<b>WG169E.2</b>	<b>WG169E.5</b>	<b>WG169E.9</b>
Charger	1 (WA3760)	1 (WA3760)	1 (WA3860)	/
Battery Pack	1 (WA3551.1)	2 (WA3551.1)	1 (WA3551.1)	/
Edge/Trimming Support Wheel	1	1	1	1
Spool	1 (WA0004)	1 (WA0004)	1 (WA0004)	1 (WA0004)
Safety Guard	1	1	1	1

We recommend that you purchase your accessories from the same store that sold you the tool. Refer to the accessory packaging for further details. Store personnel can assist you and offer advice.

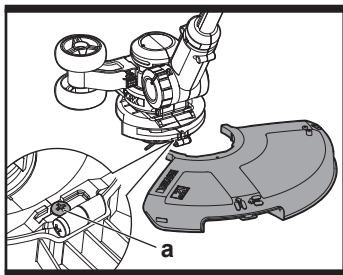

**A**

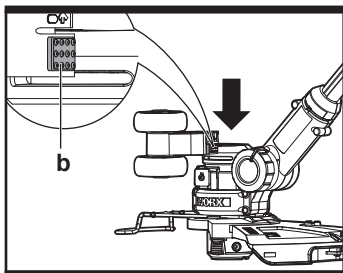

**B1**

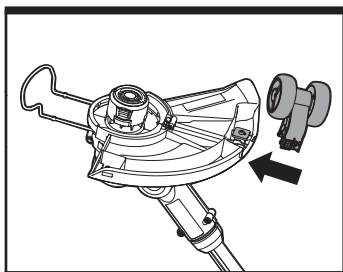

**B2**

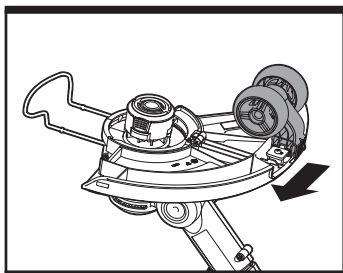

**B3**

## ASSEMBLY

### 1. ASSEMBLY OF THE SAFETY GUARD (See Fig. A)

Remove a screw from the Guard; attach the Safety Guard to the trimmer head. Align the Guard so it slides into the slots located on the trimmer head. Turn the tool over and secure the Safety Guard onto the trimmer head with the screw (a) provided.

### 2. ASSEMBLY OF THE EDGER/TRIMMING SUPPORT WHEELS (See Fig. B1, B2, B3)

With the tool right side up, slide the Edger /Trimming Support Wheels (12) assembly onto the metal plate located on the side of the Cutting Head (See B1) or underneath the Safety Guard(5) (See B2 B3). Make sure the grooves of the Edger /Trimming Support Wheels assembly locks onto the metal plate, you will hear it click into place.

To remove the wheel assembly, press the release button (b) on the wheels and pull the wheels outside.

## OPERATION INSTRUCTIONS

### INTENDED USE

The machine is intended for the cutting of grass and weeds under bushes, as well as on slopes and edges that can not be reached with the lawn mower.

**!** **WARNING!** The charger and Battery Pack are specially designed to work together so do not attempt to use any other devices. Never insert or allow foreign metallic objects into your charger or Battery Pack connections because of electrical failure and other hazards that will occur.

### 1. BEFORE USING YOUR CORDLESS GRASS TRIMMER

Your Battery Pack is **UNCHARGED** and it must be fully charged once before it is used.

The battery charger supplied is matched to the Li-Ion battery for use with this tool. Do not use another battery charger.

### 2. CHARGING YOUR BATTERY PACK

The Li-Ion battery is protected against deep discharging. When the battery is empty, the trimmer will switch off by means of a protective circuit: The trimmer head will stop rotating.

**NOTE:** In a warm environment or after heavy use, the Battery Pack may become too hot to permit charging.

Allow time for the battery to cool down before recharging.

### 3. TO REMOVE OR INSTALL BATTERY PACK (See Fig. C)

Depress the battery release button to remove Battery Pack (2) from your trimmer. After recharging, insert the Battery Pack onto trimmer's battery bracket. A simple push and slight pressure will be sufficient.

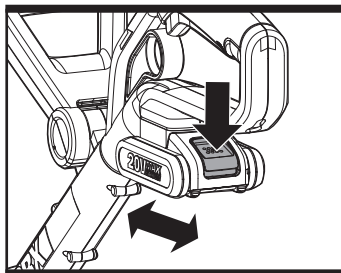

C

### 4. SAFETY ON/OFF SWITCH (See Fig. D)

The safety switch is locked off to prevent accidental starting. Depress the Lock Off Button (9) then depress the On/Off Switch (10) and release Lock Off Button. Your trimmer is now on. To switch off, just release the on/off switch.

**WARNING!** The cutting head continues to rotate after the trimmer has been switched off; wait until it has completely stopped then lay down the tool.

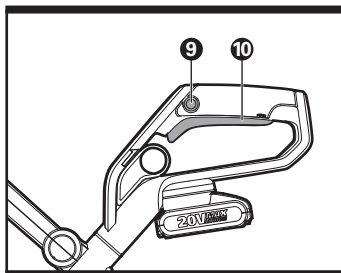

D

### 5. ADJUSTMENT OF THE TELESCOPIC SHAFT (See Fig. E)

Step one foot on the Safety Guard, then use one hand to pull up the Telescopic Shaft Adjustment Trigger (8), adjust the length of the Telescopic Shaft to the most comfortable length. Release the Telescopic Shaft. Adjustment Trigger to lock in position.

### 6. MAIN HANDLE ROTATION (See Fig. F1, F2)

First, hold down the lower housing with your foot and pull upward on the Upper Shaft (15). Then rotate the Upper Shaft clockwise 90 degrees (See Fig. F1) and release; the Shaft will be locked in position automatically (See Fig. F2).

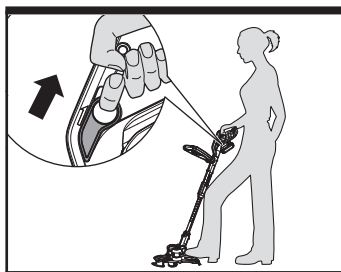

E

### 7. ADJUSTMENT OF AUXILIARY HANDLE

Pull up the Auxiliary Handle Locking Lever (11). Hold the Locking Lever and rotate the Auxiliary Handle to the most comfortable and balanced position (See Fig. G). Release the lever, your Auxiliary Handle has been locked.

### 8. ADJUSTMENT OF THE TRIMMER HEAD ANGLE TO THE SHAFT (See Fig. H1, H2 & H3)

(See Fig. H1, H2 & H3)

**WARNING!** Make Sure the Safety Switch is Locked Off to Prevent Accidental Starting.

To adjust the Upper Shaft angle or convert the tool from

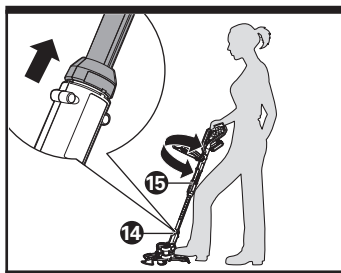

F1

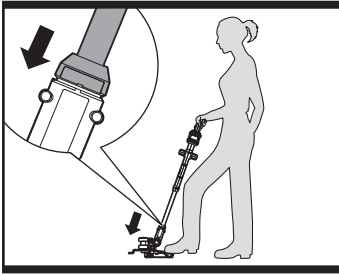

F2

trimming mode and edging mode, unlock the Pivot Head Locking Knob by hand, and using adequate force, pull the trimmer head into the desired position, then lock the Pivot Head Locking Knob.

### 9. FLOWER GUARD/EDGER GUIDE

Pull the Flower Guard/Edger Guide out before trimming, as shown in Fig. I1.

When edging, pull Flower Guard/Edger Guide out also, and keep to a side (See Fig. I2).

Before trimming or edging make sure the flower guard is locked firmly in position.

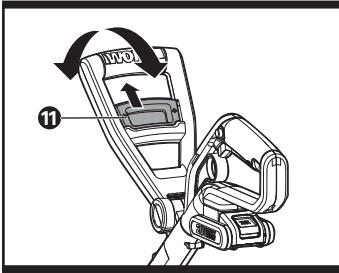

G

## OPERATION

**!** **WARNING:** Always wear the eye protection. Never lean over the trimmer head. Rocks or debris can ricochet or be thrown into eyes and face and cause blindness or other serious injury. When operating unit, check for the following:

Wear eye protection and heavy clothing. Hold front handle with one hand and Auxiliary Handle with the other hand. Keep unit below waist level. Work only from your right to your left to ensure debris is thrown away from you. Without bending over, keep line near and parallel to the ground (perpendicular when edging) and not crowded into material being cut.

**!** **WARNING:** Make sure that line is fed out before operation. Make sure motor is up to full speed before trimming or edging.

**!** **WARNING:** Only use 1.65mm diameter cutting line. Other sizes of line will not feed properly and will result in improper cutting head function or can cause serious injury. Do not use other material such as wire, string, rope, etc. Wire can break off during cutting and become a dangerous projectile that can cause serious injury.

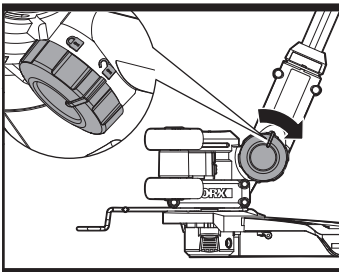

H1

### EDGER/TRIMMING SUPPORT WHEELS

There are three optional positions for the Edger/Trimming Support Wheels to attach when assisting in Trimming and Edging.

#### POSITION 1: USING THE GUIDE WHEELS WHEN TRIMMING IN A FORWARD OR REVERSE DIRECTION (See Fig. J1)

Position the Grass Trimmer in the trimming position. Underneath the Safety Guard there is a metal plate that the Edger/Trimming Support Wheels will attach to. Slide the Support Wheels horizontally onto the metal

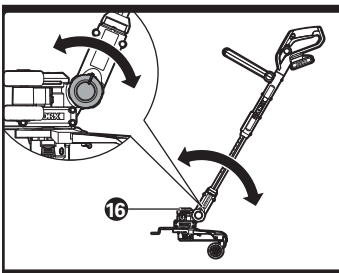

H2

**3 in 1: Trimmer / Edger / Mini mower**  
**WG169E WG169E.2 WG169E.5 WG169E.9**

plate until they lock into position so both the wheels are facing in the forward direction (See Fig. B3). The wheels should provide support when you are trimming in the forward or reverse direction.

### POSITION 2: USING THE GUIDE WHEELS WHEN TRIMMING SIDE TO SIDE

Position the Grass Trimmer in the trimming position. Underneath the Safety Guard there is a metal plate that the Edger/Trimming Support Wheels will attach to. Slide the Support Wheels vertically onto the metal plate until it locks into position (See Fig. B2). The wheels should provide support when you are trimming in a horizontal side to side direction (See Fig. J2).

**NOTE:** you could also use the machine without the guide wheels on guard when trimming.

### POSITION 3: USING THE GUIDE WHEELS WHEN EDGING (See Fig. I2)

 **WARNING:** Make Sure the Safety Switch is Locked Off to Prevent Accidental Starting.

Change the tool from trimming into the edging mode, the Edger /Trimming Support Wheels (12) will attach on the side the trimmer head as shown in Fig. B1, rotate the main handle as described in **“MAIN HANDLE ROTATION”**, then unlock the Pivot Head Locking Knob, and using adequate force, pull the trimmer head into the desired position. Make sure to adjust the trimmer head angle to be in the lowest horizontal setting. Finally, lock the Pivot Head Locking Knob (See Fig. H3) and position the wheel on the ground for the edging mode. While edging, keep the Flower Guard/Edger Guide aligned with the sidewalk edge, this will assist to edge in a straight path. Only the tip of the line will make contact with area being worked on. Do not force the line. The edging wheels help protect the unit and keep the unit from contacting the ground. Take extra caution while edging, as objects can be thrown from the trimmer line.

### AUTOMATIC LINE FEED SYSTEM

When initially switching on the trimmer, a small length of line is fed out. Each time the tool is started from rest it will advance about 6.35mm of trimmer line. A ‘clattering’ noise will be heard when the lines hit the Line Cutter. **DO NOT BE ALARMED** this is quite normal. After about 5 seconds the line will be cut to the correct length and the noise will reduce as the motor

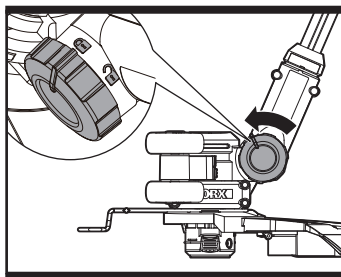

H3

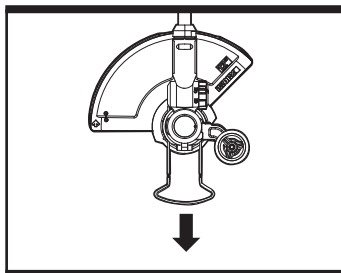

I1

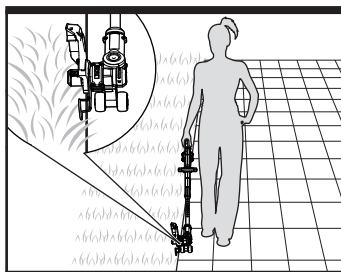

I2

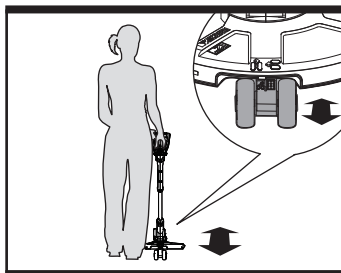

J1

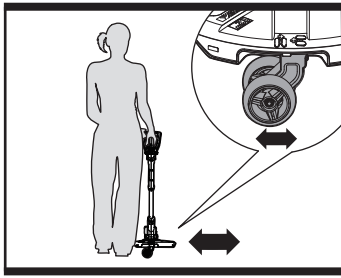

**J2**

gains full speed.

If the noise of the line being cut can't be heard, more line will need to be fed out.

To feed more line, it is first necessary to allow the trimmer to stop completely; it must come to a complete rest, then restart, allowing the motor to reach full speed.

Repeat above until you hear the line hitting against the Line Cutter.

**TO MANUALLY FEED THE LINE**

(See Fig. K1)

Turn off the trimmer and remove the battery.

If required, line can be fed out manually.

To operate, press and release manual Line Feed Button (17), while gently pulling out the line until it is long enough to reach the Line Cutter.

If the line extends past the Line Cutter, too much line has been fed out.

If too much line is fed out, remove the Spool Cap and turn Spool counter-clockwise until the line is at the desired length.

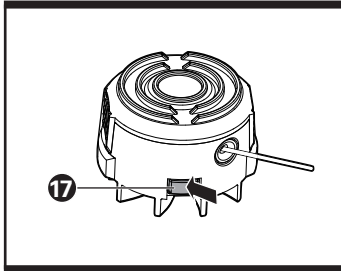

**K1**

**TO REMOVE THE SPOOL CAP COVER**

(See Fig. K2)

Press and hold in the two Cap Release Latches (19) (See Fig. K2).

Pull the Spool Cap Cover (18) away from the Cutting Head (21). Keep the Spool Cap Cover and the inside of the Cutting Head clean from debris. To replace the Spool Cap Cover, press it firmly onto the Spool Holder. Ensure that it is correctly connected by trying to remove it without depressing the two Cap Release Latches.

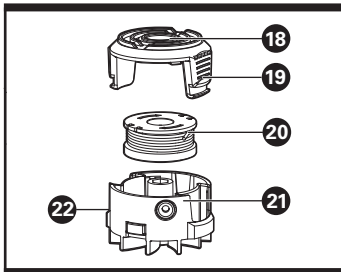

**K2**

**REPLACE THE TRIMMER LINE AND SPOOL (See Fig. K3).**

Turn off the trimmer and remove the battery.

Remove Spool Cap Cover.

Remove the old Spool from Spool Holder. Clear any broken line or cutting debris from the spool area. Pull the line from the new replacement Spool through the eyelet of the Spool Holder. Place new Spool into the holder with the **cut out areas of the Spool facing inward or down. When installed into the Spool Holder, the smooth side of the Spool should be visible.**

Release line from cleat on the Spool.

Refit the Spool Cap Cover.

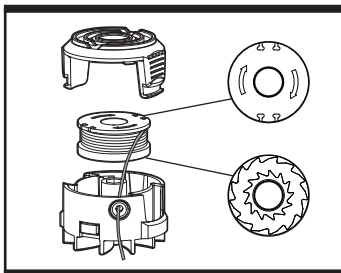

**K3**

## TO MANUALLY WIND LINE

(See Fig. L1-L4)

Take approximately 10ft (3m) of line. Insert 5/8" (15mm) of line into the Spool holes and wind line in the direction of the arrows on the top of the Spool.

Leave approximately 4" (100mm) of line unwound and place into the cleat.

Ensure that the line is neatly coiled on the Spool.

Failure to do so will impair the efficiency of the automatic line feed.

Then fit the Spool as described above in **"Rep lace the trimmer line and Spool"**

## MAINTENANCE

After use, disconnect the battery from the tool and check for damage.

Your power tool requires no additional lubrication or maintenance. There are no user serviceable parts in your power tool. Never use water or chemical cleaners to clean your power tool. Wipe clean with a dry cloth. Always store your power tool in a dry room temperature location. Keep the motor ventilation slots clean. Keep all working controls free of dust.

## ENVIRONMENTAL PROTECTION

 Waste electrical products must not be disposed of with household waste. Please recycle where facilities exist. Check with your local authorities or retailer for recycling advice.

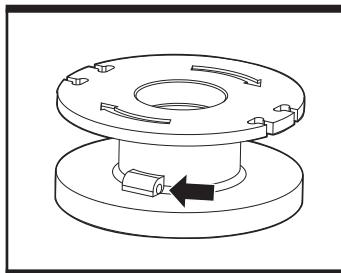

L1

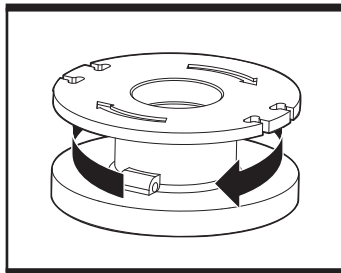

L2

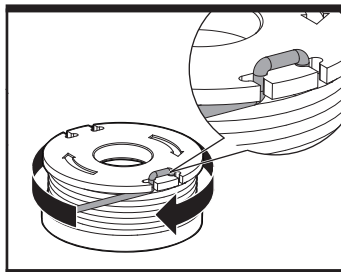

L3

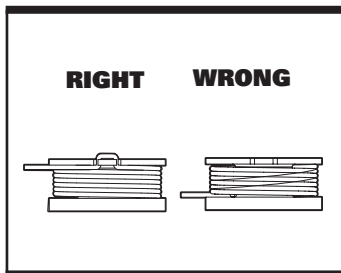

L4

# TROUBLESHOOTING

The following table gives problems and actions that you can perform if your machine does not operate correctly.



**WARNING:** Switch the machine off and remove the battery prior to any troubleshooting.

<b>Problems</b>	<b>Possible Causes</b>	<b>Corrective Action</b>
Trimmer fails to operate.	Battery discharged. Battery too hot/cold. Motor is broken. Internal wiring of machine damaged.	Recharge battery; also see "HOW TO CHARGE YOUR BATTERY " Allow to cool/warm. Contact Service Agent. Contact Service Agent.
Trimmer runs intermittently.	Motor is broken. Battery not fully charged. On/Off switch defective.	Contact Service Agent. Recharge battery. Contact Service Agent.
Excessive vibrations/noise.	Machine defective. Line spool is not wound well.	Contact Service Agent. Rewind the line. See "To fit spool and line assembly."
Cutting time per battery charge too short.	Battery has not been used for long period or only charged for short term. Grass is too high. Battery defective.	Fully charge battery; also see "HOWTO CHARGE YOUR BATTERY " Cut in stages. Replace the battery.
Machine does not cut.	Line broken. Battery not fully charged. Motor is broken (speed is too low). Grass entangled around cutting head.	Replace the line. Recharge battery; also see "HOW TO CHARGE YOUR BATTERY " Contact Service Agent. Remove grass.
Continuous lighting of the battery charge indicator. No charging procedure possible.	Battery not (properly) inserted. Battery contacts contaminated. Battery defective.	Properly insert battery into battery charger. Clean the battery contacts or replace the battery. Replace the battery.
Battery charge indicator does not light up.	Plug of battery charger not plugged in (properly). Socket outlet, mains cable or battery charger defective.	Insert mains plug (fully) into the socket outlet. Check the mains voltage; have the battery charger checked by an authorized after-sales service agent.
Auto feed does not work	Cutting line is not wound well. The line is tangled. Line is used up.	Manually feed the line, if still can not feed out, remove the Spool out and rewind the line. Replace with a new spool of line.

**3 in 1: Trimmer / Edger / Mini mower**  
**WG169E WG169E.2 WG169E.5 WG169E.9**



# DECLARATION OF CONFORMITY

We,  
Positec Power Tools (Europe)Ltd  
PO Box 6242, Newbury, RG14 9LT, UK

Declare that the product,  
Description **Battery-powered Grass Trimmer**  
Type **WG169E WG169E.2 WG169E.5 WG169E.9 (1-designation of machinery, representative of Grass Trimmer)**  
Function **cutting grass and similar soft vegetation and for trimming grass edges**

Complies with the following Directives,  
**2006/42/EC, 2014/30/EU, 2011/65/EU, 2000/14/EC amended by 2005/88/EC**

2000/14/EC amended by 2005/88/EC:  
- Conformity Assessment Procedure as per **Annex VI**  
- Measured Sound Power Level **90.91dB(A)**  
- Declared Guaranteed Sound Power Level **94dB(A)**  
-The notified body involved  
Name: **Intertek Testing & Certification Ltd (notified body 0359)**  
Address: **Davy Avenue, Knowlhill, Milton Keynes, MK5 8NL**

Standards conform to:  
**EN 60335-1, EN 50636-2-91, EN 62233, EN ISO 3744, EN 55014-1, EN 55014-2**

The person authorized to compile the technical file,  
**Name: Russell Nicholson**  
**Address: Positec Power Tools (Europe) Ltd, PO Box 6242, Newbury, RG14 9LT, UK**



Suzhou 2016/04/21  
Allen Ding  
Deputy Chief Engineer,  
Testing & Certification





**LITHIUM ION BATTERY**

**Handle With Care. Do Not Load or  
Transport Package If Damaged.  
A Fire Hazard Could Exist.**

**For more information, call: +86-512-65152811**

**WORX**  
**it's your nature**

**[www.worx.com](http://www.worx.com)**

Copyright © 2016, Positec. All Rights Reserved.  
AR01186101