

**CUSTOMER HELPLINE:  
0845 0613967.**



## STORAGE COFFEE TABLE

Step by Step Assembly Instructions

### Tools Required

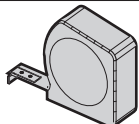

Tape Measure

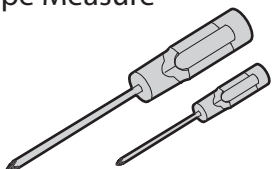

Cross Head Screwdriver  
Small and Large



Hammer

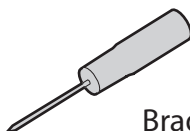

Bradawl

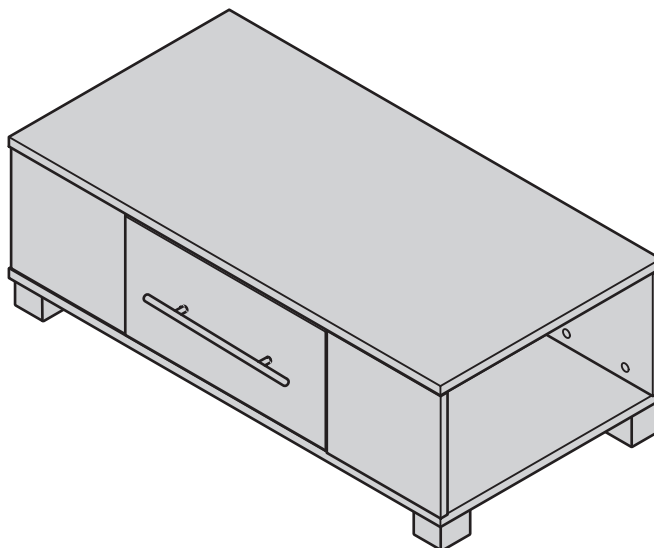

**ASSEMBLY TIME:  
1hr 30min App.  
2 PERSON ASSEMBLY**

**Product code  
051 xx 6001**

**Assembly Instruction  
610 00 6001  
Issue: D**

**Product Dimensions  
HHHxWWWxDDD  
312x940x480mm**

## Help and Advice **IMPORTANT! PLEASE READ**

**IMPORTANT!** Before you start take a few moments to read through this leaflet and then follow the step by step instructions. Do not throw away any of the packaging until you have checked that you have all the component parts and fittings.

Dear Customer,

In the unlikely event of you finding any parts either missing or faulty, it will not be necessary to go to the trouble of returning the complete item.

Simply contact us on CUSTOMER HELPLINE : 0845 0613967 Between 8am - 4.30pm Monday to Thursday and 8am - 2.30p.m Friday.

Please have the following information: Unit Description, Product Code, Product Colour, Place of Purchase, Catalogue Ref. No., Item Code, and have the assembly instructions close to hand.

We do have an answer machine should you contact us out of office hours, so in addition to the above information could you leave your name, address, daytime telephone number and the nature of your call on the answerphone. All calls will be actioned asap.

You can also e-mail your requests to us at: [customer.helpdesk@addspacefl.co.uk](mailto:customer.helpdesk@addspacefl.co.uk)

Alternatively Write to us at: Customer Service Department, Addspace Furniture Limited, Braithwell Way, Hellaby Industrial Estate, Hellaby, Rotherham, South Yorkshire, S66 8 QY.

DESCRIPTION	SIZE	QTY	CODE
TOP	940x480x15	1	4744
BOTTOM	940x480x15	1	4745
LH DIVISION	230x446x15	1	4746
RH DIVISION	230x446x15	1	4747
RAIL	230x248x15	4	4748
DRAWER FRONT	436x224x15	1	4749
DRAWER BOTTOM	420x298x3	1	4751
BACK	450x230x3	1	4750

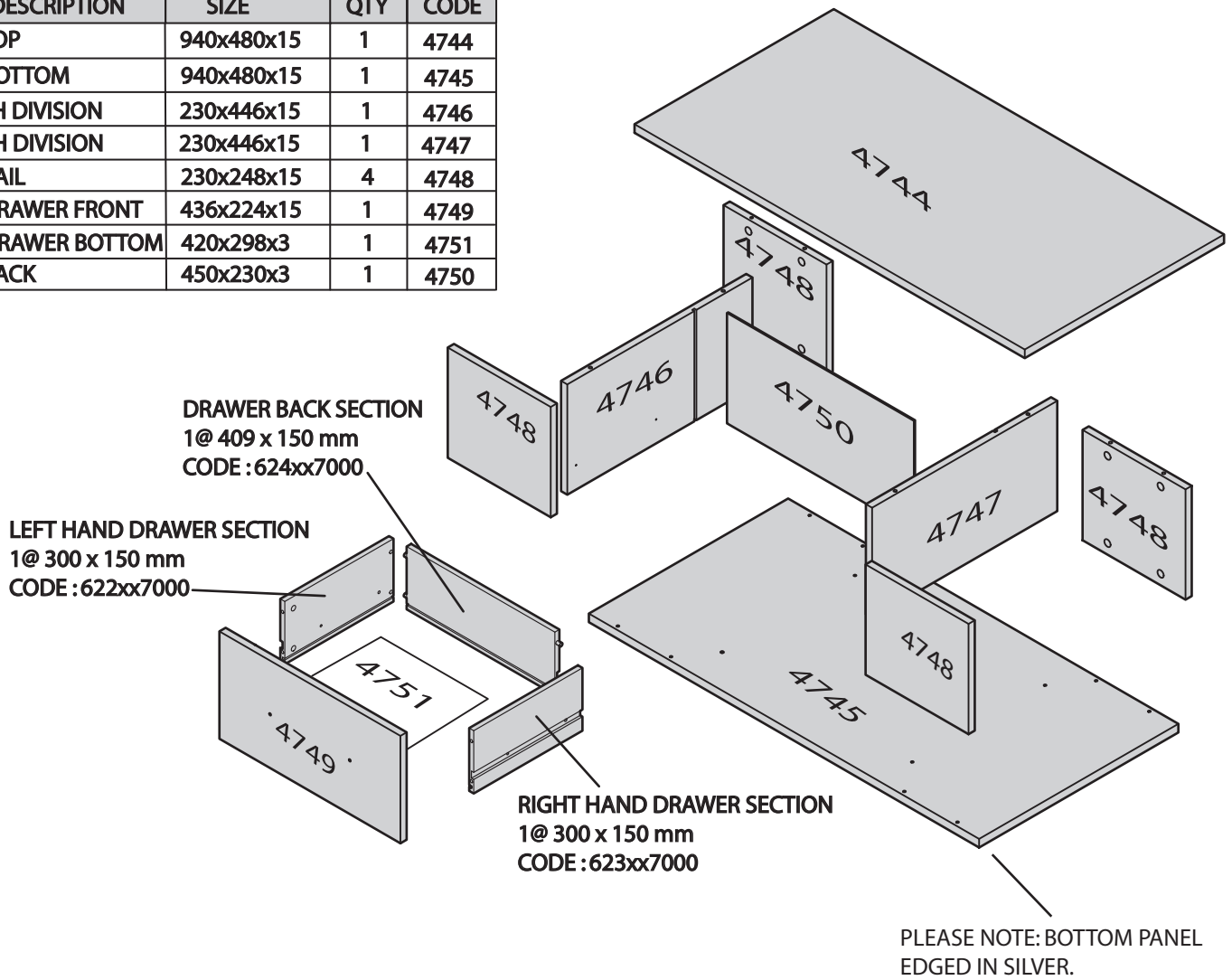

**FITTINGS**

**THE SCREWPACK CONTAINS ITEMS WHICH MAY PROVE DANGEROUS TO CHILDREN ESPECIALLY THOSE UNDER 36 MONTHS. WE THEREFORE RECOMMEND CAUTION IS OBSERVED DURING THE ASSEMBLY OF YOUR UNIT. IF THE UNIT CONTAINS SCREW COVERCAPS, WE SUGGEST THAT THESE ARE GLUED INTO POSITION.**

<p>aa</p> <p>LARGE</p>	<p>bb</p>	<p>cc</p> <p>SMALL</p>	<p>dd</p>	<p>ee</p>
<p>CODE 760001103</p> <p>QTY 16</p>	<p>CODE 760003004</p> <p>QTY 20</p>	<p>CODE 760003005</p> <p>QTY 4</p>	<p>CODE 690001008</p> <p>QTY 6</p>	<p>CODE 760001040</p> <p>QTY 2</p>
<p>ff</p>	<p>gg</p> <p>9mm</p>	<p>hh</p> <p>22mm</p>	<p>mm</p> <p>25mm</p>	<p>nn</p>
<p>CODE 720396000</p> <p>QTY 5</p>	<p>CODE 690001078</p> <p>QTY 2</p>	<p>CODE 690001018</p> <p>QTY 10</p>	<p>CODE 690001021</p> <p>QTY 2</p>	<p>CODE 644396000</p> <p>QTY 1</p>
<p>oo</p>	<p>0 mm 10 20 30 40 50 60</p>			
<p>CODE 770001006</p> <p>QTY 8</p>				

IMPORTANT - NOTE: THICK LINES INDICATE FINISHED EDGES.

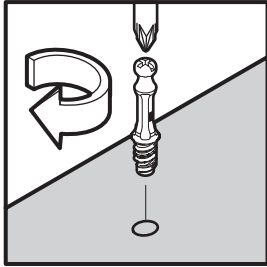

SCREW IN DOWEL UNTIL TIGHTENED.

Fittings you will need in this step:

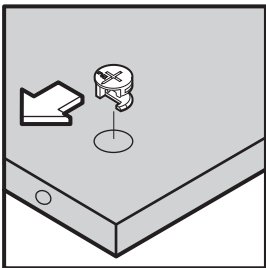
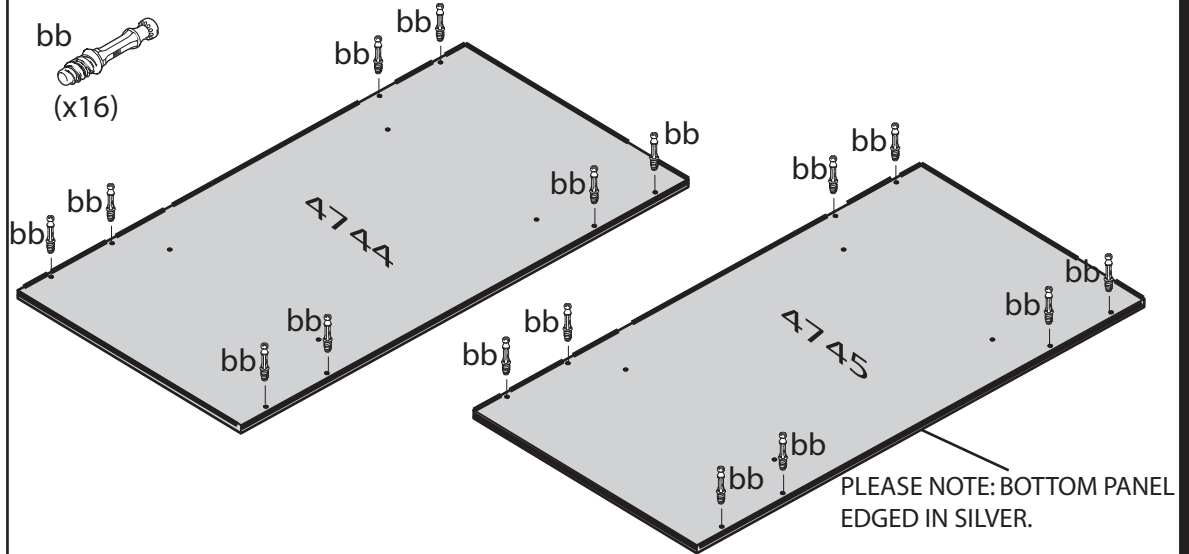

ENSURE CAM ARROW POINTS TOWARDS EDGE WITH HOLE.

LOCATE FITTINGS - CONTINUED...

Fittings you will need in this step:

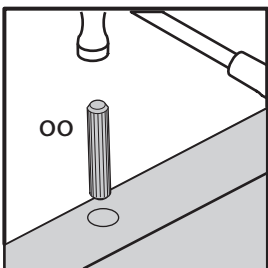
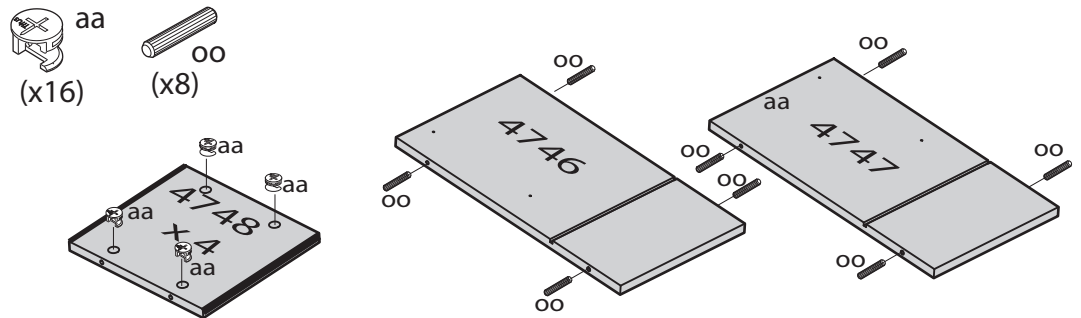

LOCATE FITTINGS - CONTINUED...

Fittings you will need in this step:

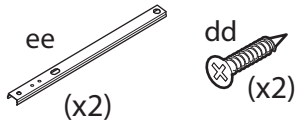

ENSURE PANELS ARE POSITIONED AS SHOWN THEN ALIGN THE DRAWER RUNNER WITH THE FRONT EDGE OF PANEL 4746 & 4747. THE 2ND HOLE FROM THE FRONT WILL LINE UP WITH A PRE-DRILLED HOLE. SECURE USING SCREWS dd.

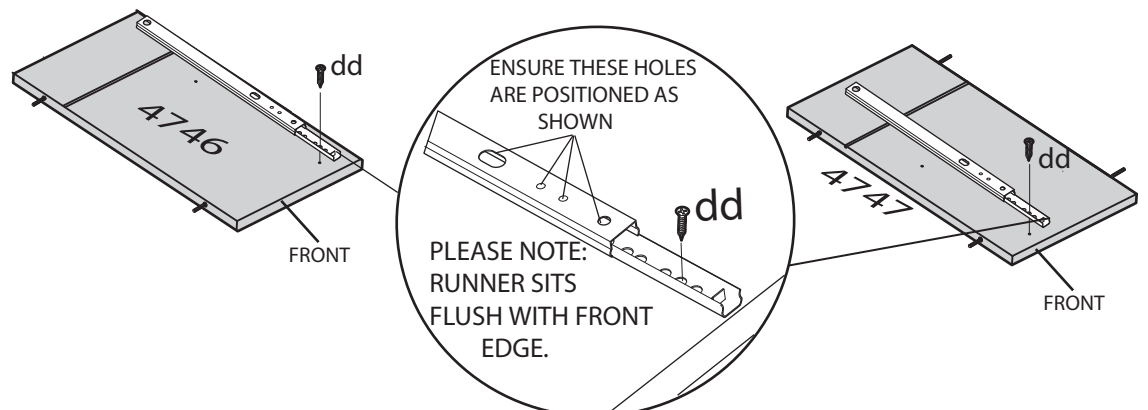

LOCATE FITTINGS - CONTINUED...

NOW SLIDE THE RUNNER FORWARD TO SECURE ANOTHER SCREW. THE

**2ND**

TO LAST HOLE IN THE RUNNER WILL LINE UP WITH THE HOLE IN THE PANEL.

NOW USING A BRADAWL MAKE A HOLE IN THE PANEL THROUGH

**THE 11th**

HOLE IN THE RUNNER AND SECURE USING SCREW dd.

Fittings you will need in this step:

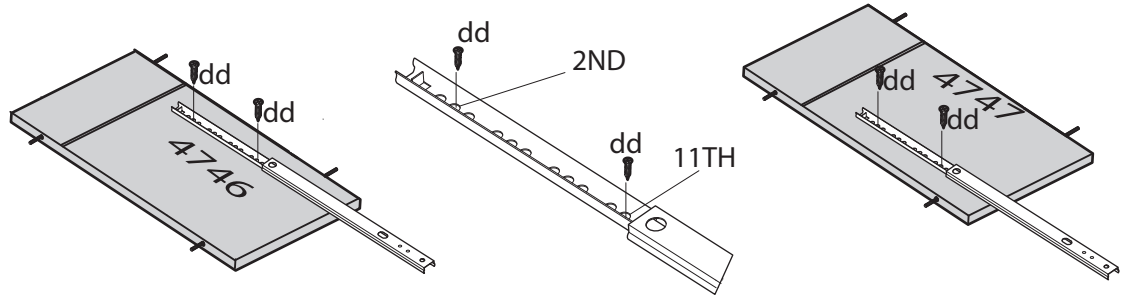

**STEP 2**

**MAKE DRAWER**

Fittings you will need in this step:

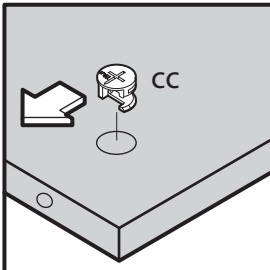
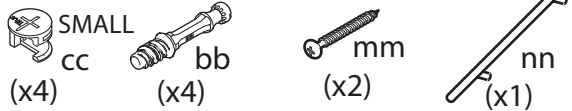

ENSURE CAM ARROW POINTS TOWARDS EDGE WITH HOLE.

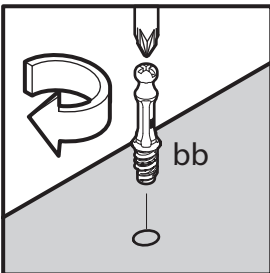

SCREW IN DOWEL UNTIL TIGHTENED.

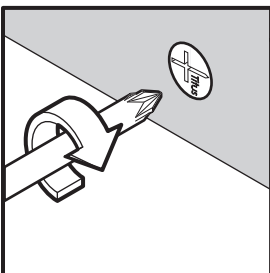

TURN CAM 180 DEGREES TO LOCK.

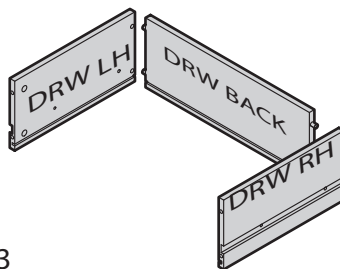
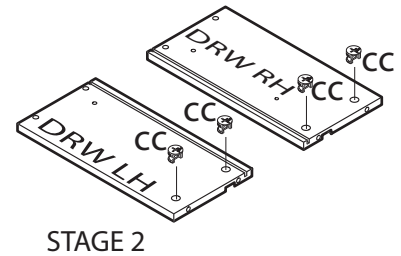
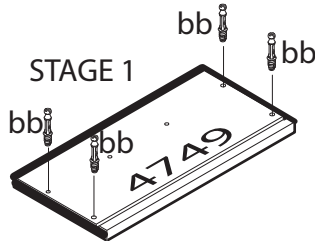

STAGE 3 INSERT WOODEN DOWELS IN DRW BACK INTO HOLES IN DRW LH AND DRW RH.

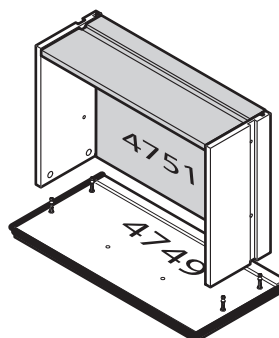
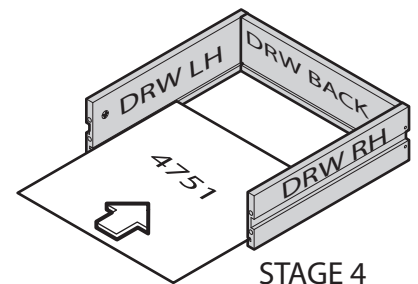

STAGE 5 INSERT CAMS IN DRAWER SECTIONS ONTO DOWELS IN DRAWER FRONT 4749, THEN LOCK.

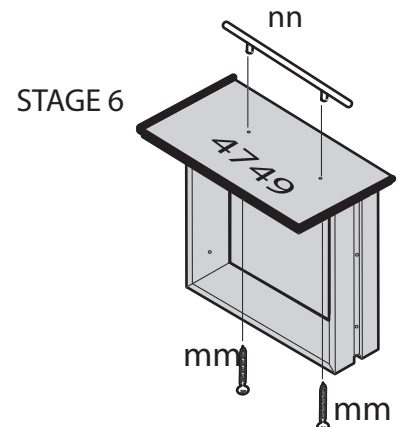

ATTACH DIVISIONS TO TOP PANEL

INSERT WOODEN DOWELS IN PANELS 4746 AND 4747 INTO PANEL 4744.

NOTE: ENSURE THE GROOVES ARE FACING THE CORRECT WAY.

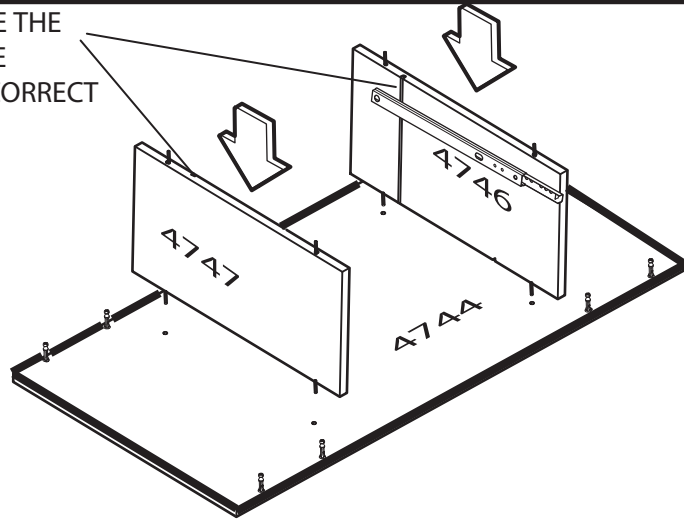

STEP 4

ATTACH RAILS

INSERT CAMS IN PANELS 4748 x 4 ONTO DOWELS IN PANEL 4744. THEN LOCK.

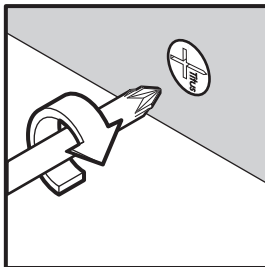

TURN CAM 180 DEGREES TO LOCK.

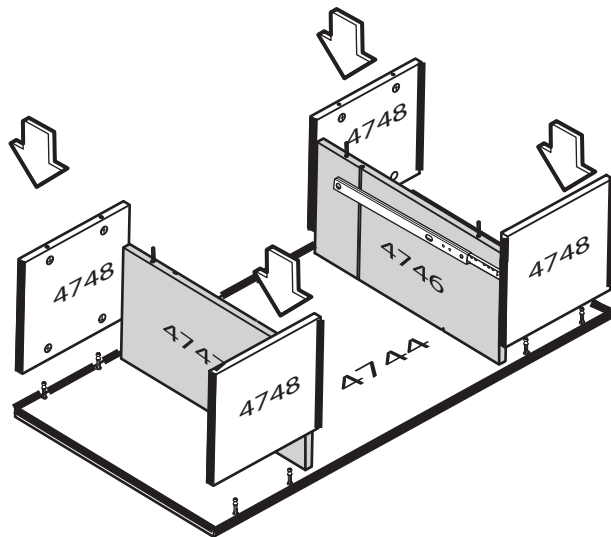

STEP 5

LOCATE 3mm BACK PANEL

SLIDE 3mm BACK PANEL 4750 INTO GROOVES ON PANELS 4746 AND 4747.

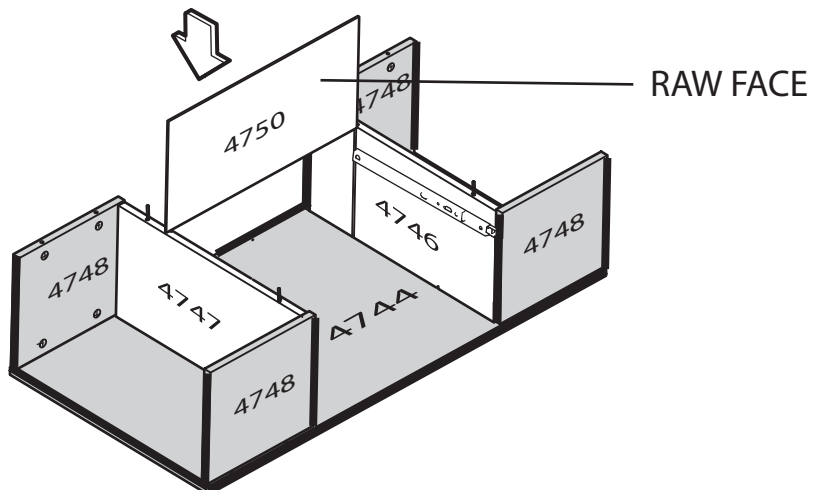

ATTACH BOTTOM PANEL (EDGED IN SILVER )

INSERT DOWELS IN PANEL 4745 INTO CAMS IN PANELS 4748, ENSURING WOODEN DOWELS IN PANELS 4746 AND 4747 GO INTO HOLES IN PANEL 4745. THEN LOCK.

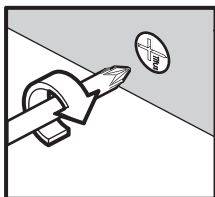

TURN CAM 180 DEGREES TO LOCK.

DUE TO THE UNIT BEEN LOW WE SUGGEST YOU ASSEMBLE THIS SECTION ON A SUITABLY PROTECTED TABLE. 2 PERSONS TO LIFT ONTO TABLE.

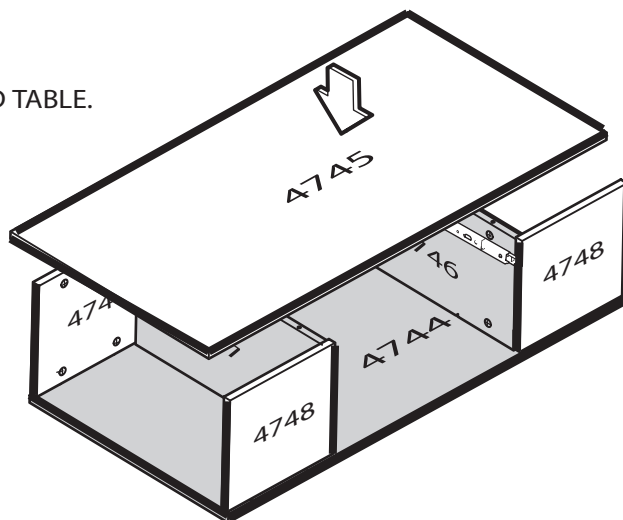

STEP 7

ATTACH FEET TO BOTTOM PANEL(EDGED IN SILVER)

LOCATE FEET TOWARDS THE CORNERS FOR MORE STABILITY. MARK POSITION WITH BRADAWL FIRST. THEN SCREW IN TO PLACE.

LOCATE THE 5th FOOT TO THE CENTRE OF BOTTOM PANEL.

ENSURE YOU SECURE THE FEET TO BOTTOM PANEL THIS IS EDGED IN SILVER.

Fittings you will need in this step:

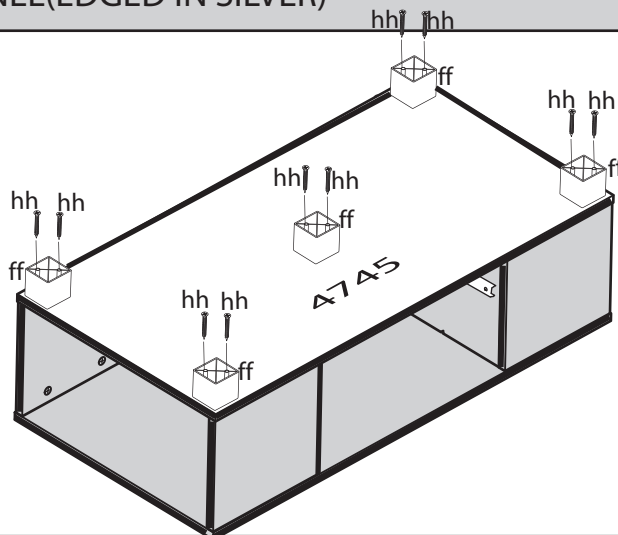
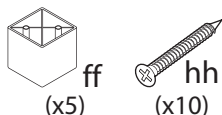

STEP 8

LIFT UNIT ONTO FEET( 2 PERSONS ) THEN LOCATE DRAWER

PULL SLIDING PART OF DRAWER RUNNERS (ee) OUT SO THEY ARE FULLY EXTENDED. THEN PLACE THE COMPLETED DRAWER UNIT ON TO THE RUNNERS SO THAT THE 2ND SMALL HOLE FROM THE FRONT OF THE RUNNER LINES UP WITH THE HOLE IN THE SIDES OF THE DRAWER SECTION. YOU MAY REQUIRE SOME HELP TO DO THIS. THEN FROM THE INSIDE OF THE DRAWER SCREW (gg) THROUGH SO THEY ARE ATTACHED.

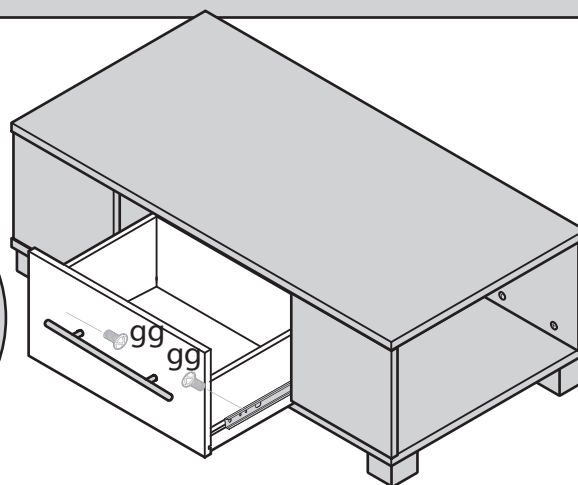
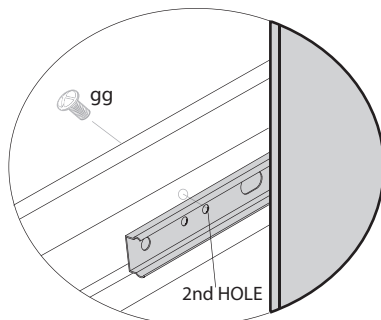

**AFTERCARE INSTRUCTIONS, PLEASE READ.**

**PLEASE NOTE: TO KEEP YOUR UNIT IN PERFECT CONDITION CLEAN ONLY WITH A SOFT DAMP CLOTH. DO NOT USE ANY ABRASIVE CHEMICAL CLEANERS. DO NOT SUBJECT YOUR UNIT TO HEAT OR MOISTURE. I.E BY PLACING HOT OR DAMP CUPS ETC ON ANY OF THE SURFACES. WE RECOMMEND THAT THE UNIT IS LIFTED AND NOT DRAGGED.**