

FITTING THE BLIND TO THE BRACKETS

- 5) Hold the blind at both ends, insert the sidewinder mechanism into the correct bracket (with the metal pin in the vertical position). Slot the endplug into the other bracket and pull the blind forward to ensure it locates fully into the bracket. (Fig 9).

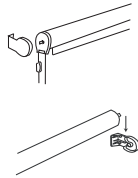

(Fig 9)



Important: All Roller Blind Cord should be secured out of the reach of small children using the relevant safety device.

6) INSTALLING SAFETY DEVICE

- The safety devices (J) should be positioned high enough to be out of reach of small children yet accessible to adults.
- The safety devices should be installed at the maximum distance possible from the control mechanism to prevent the looped cord(s) becoming slack.
- All safety devices for blinds need to be fixed to a solid surface using a screw (G) and fixing suitable for the wall or surface material. These items should not be glued or stuck in place.
- Note: Wall plugs (H) supplied are for solid walls only. The correct type of fixing must be used for your wall, seek professional help if in doubt.
- Warning: Before drilling, check wall for hidden pipes and cables.
- Do not tie cords together. Make sure cords do not twist and create a loop.

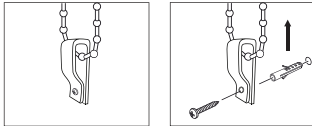

- Important:** Chain should be fully tensioned, and shortened if necessary.
- Failure to fit the safety device as per the instructions provided may result in creating a hazardous situation in terms of the safe operation of the product.

ROLLER BLIND INSTRUCTIONS



Please read all safety warnings and installation information fully before installation.



- Young children can be strangled by loops in pull cords, chains, tapes and inner cords that operate the product.
- To avoid strangulation and entanglement, keep cords out of the reach of young children. Cords may become wrapped around a child's neck.
- Move beds, cots and furniture away from window covering cords.
- Do not tie cords together. Make sure cords do not twist and create a loop.

PARTS SUPPLIED

Ref	Description	Illustration	Qty	Ref	Description	Illustration	Qty
A	Rollerblind		1	F	Fixing screws (19mm)		4
B	Sidewinder mechanism		1	G	Fixing screws (25mm)		1
C	End plug		1	H	Wall plugs (19mm)		5
D	Bottom bar		1	J	Safety device		1
E	Sidewinder bracket		2				

TOOLS REQUIRED (NOT SUPPLIED)

Tape measure
Drill and suitable drill bit
Spirit level

Step ladder
Pencil

Crosshead screwdriver
Fine tooth saw if needed

BEFORE YOU START

- This headrail should not be installed less than 1.5mts from the floor
- Check the pack and make sure you have all of the parts listed above.
- When you are ready to start, make sure that you have the right tools to hand, plenty of space and a clean dry area for assembly.
- Firstly you must decide whether your blind is to be fitted inside the window recess (blind may need to be trimmed to fit) or outside the window recess.
- If the blind is to be fitted outside a window recess, then the brackets will have to be face fixed.
- If the blind is to be fitted inside a window recess, you must decide whether the blind is to be face fixed or top fixed.

FITTING OUTSIDE A WINDOW RECESS

- 1) (Fig1). Leave a 50mm clearance on each side of the window recess, attach the sidewinder brackets to the wall (Fig 2). or the ceiling (Fig 3). using two 19mm screws. If necessary, drill suitable holes and insert the wall plugs. Use a spirit level to ensure the brackets are even.

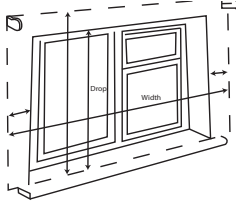

(Fig 1).

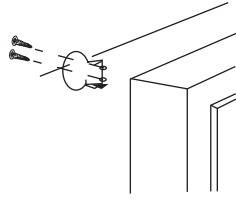

(Fig 2).

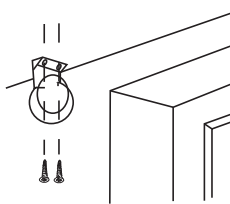

(Fig 3).

FITTING INSIDE A WINDOW RECESS

- 2) Attach the sidewinder to the window frame (Fig 4). to the ceiling (Fig 5)., or to the opposite walls (Fig 6). of the recess using two 19mm screws. If necessary, drill suitable holes and insert the wall plugs. Use a spirit level to ensure the brackets are even.

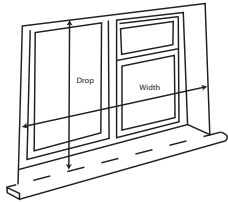

(Fig 4).

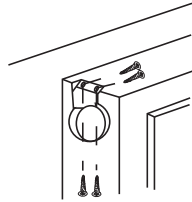

(Fig 5).

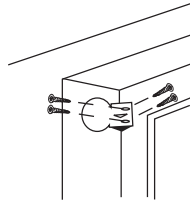

(Fig 6).

TRIMMING TO SIZE

- 3) If your blind fits between the sidewinder brackets got to step 4. Measure the exact width of the window in three different places (top, middle, and bottom). Note the narrowest measurement, subtract 28mm to allow for the sidewinder and the endplug and brackets. This measurement is the finished width of your blind. Subtract the finished width measurement from the current width of the blind. This measurement is the amount that needs to be trimmed off the blind.

Unroll your blind. Remove the fabric from the top bar and slide the bottom bar out. Measure and mark the amount to be cut off and using a hacksaw cut the bars to size. Carefully measure out and draw a straight line for the finished width of the fabric and using a pair of scissors cut to size. Re attach the top bar and slide in the bottom bar. (Fig 7)

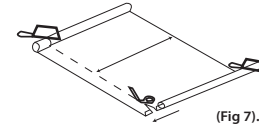

(Fig 7).

FITTING SIDEWINDER AND ENDPLUG

- 4) Before inserting the sidewinder into your chosen end of the roller tube, ensure the pull cord "joining clip" is positioned at the top and rear of the sidewinder. To do this, hold the outer cover of the sidewinder and pull the cord until the "joining clip" is in the required position. (Fig 8).

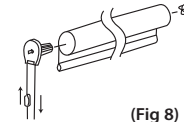

(Fig 8)