

challenge[®]

16 Inch Stand Fan Chrome

INSTRUCTION MANUAL

FD-40M

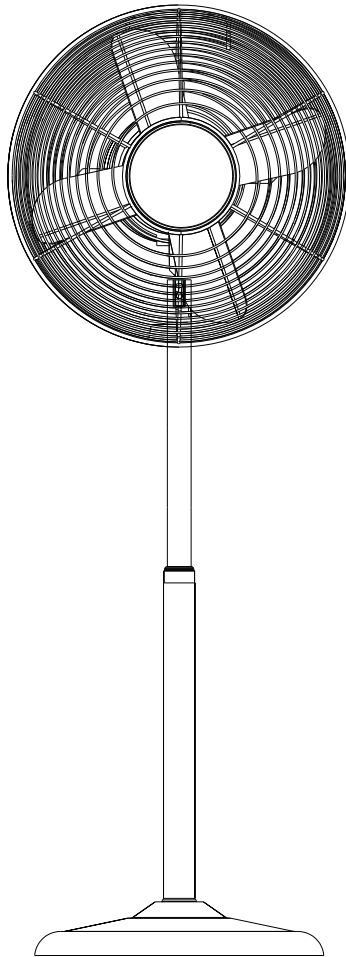

Read all instructions before using this appliance. Carefully retain these instructions for future reference.

Thank you for choosing a Challenge fan. It is a remarkably versatile product which offers a choice of air-circulation for summer comfort. This fan has been designed and manufactured to high standards of engineering and with proper use and care, as described in this leaflet, this appliance will give you years of useful service.

Please read these instructions carefully.

GENERAL CARE AND SAFETY GUIDE

- Use only the voltage specified on the rating plate of the fan.
- Do not cover or restrict airflow to the inlet or exhaust grilles in any manner as the appliance may overheat and become a fire risk.
- NEVER cover the fan : this may cause fire.
- Do not block air inlets or outlets in any manner. Check the openings from time to time for accumulated dust.
- Ensure long shag carpet does not obstruct airflow under the unit.
- Do not place appliance close to a radiant heat source.
- Do not operate in areas where gasoline, paint or other flammable liquids are used or stored.
- Do not insert or allow foreign objects to enter any ventilation or exhaust opening, as this may cause an electric shock, fire or damage to the appliance.
- Do not operate any appliance with a damaged cord, plug or after the appliance malfunctions or has been dropped or damaged in any manner. Return to a qualified electrical person for examination, electrical or mechanical adjustment, service or repair.
- This appliance is intended for household use only and not for commercial or industrial use.
- Use this appliance only as described in this manual. Any other use is not recommended by the manufacturer and may cause fire, electric shock or injury.
- Do not use abrasive cleaning products on this appliance. Clean with a damp cloth (not wet) rinsed in hot soapy water only. Always remove plug from the mains supply before cleaning.
- Do not connect the appliance to the mains voltage until completely assembled and adjusted.
- Switch off and use handles where provided when moving.
- Always operate on a flat horizontal surface.

- Do not remove plug from power socket until the appliance has been switched off.
- Do not remove plug from power socket by pulling flex - always grip plug.
- Always unplug appliance when not in use.
- Do not allow cord to come in contact with heated surfaces during operation.
- Do not run cord under carpeting, throw rugs or runners etc. Arrange cord away from traffic areas so that it will not be tripped over.
- Do not twist, kink or wrap the cord around the appliance, as this may cause the insulation to weaken and split.
- Always ensure that all cord has been removed from any cord storage area.
- Always keep the fan out of the reach of children.
- Children should be supervised to ensure they do not play with the appliance.
- Do not use this appliance in the immediate surrounds of a bath, a shower or a swimming pool or other liquids.
- Do not use this appliance outdoors, or on wet surfaces. Avoid spilling liquid on the appliance.
- Always switch off the fan at the controls and at the power outlet then unplug fan from the power outlet when not in use.
- Important-This fan is intended for floor or desk use only. Do not mount on ceiling or walls.
- If the supply cord is damaged, it must be replaced by the manufacturer, its service agent or a similarly qualified person in order to avoid a hazard.
- Do not operate the fan with wet hands.
- Do not operate the fan near to curtains or any other fabric which could be sucked into the fan unit.
- Ensure that the fan is switched off from the supply mains before removing the guard.
- The appliance is not intended for use by persons (including children) with reduced physical, sensory or mental capabilities, or lack of experience and knowledge, unless they have been given supervision or instruction concerning use of the appliance by a person responsible for their safety.

- This appliance can be used by children aged from 8 years and above and persons with reduced physical, sensory or mental capabilities or lack of experience and knowledge if they have been given supervision or instruction concerning use of the appliance in a safe way and understand the hazards involved.
- Children shall not play with the appliance.
- Cleaning and user maintenance shall not be made by children without supervision.

Description of parts

- 1 Front Guard
- 2 Locking screw
- 3 Fan Blade
- 4 Rear Guard
- 5 Front Guard Nut (x1)
- 6 Telescopic Stand
- 7 Pivot Adjustment Screw
- 8 Tilt Adjustment Screw
- 9 Motor Housing
- 10 On/Off/Speed Control
- 11 Oscillating Control
- 12 Motor Spindle
- 13 Fan Blade Retaining Screw (x1)
- 14 Guard Retaining Clips
- 15 Stand Base
- 16 Weight
- 17 Clamping Washer
- 18 L - Shaped Screw

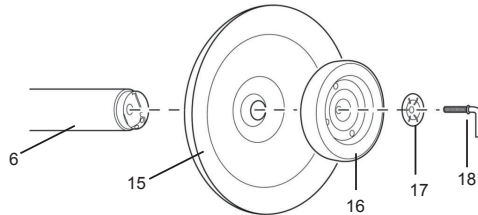
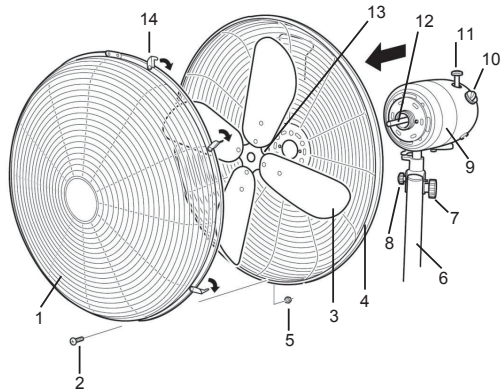

Assemble Your Metal Stand Fan Steps:

1. Attach the Telescopic Stand (6) to the Base (15) by placing the Weight (16) on the underside of the base (15) and the clamping washer (17) in the centre of the weight. Thread the L-Shaped Screw (18) through the assembly and into the thread in the Telescopic stand (6). Tighten firmly but do not overtighten.

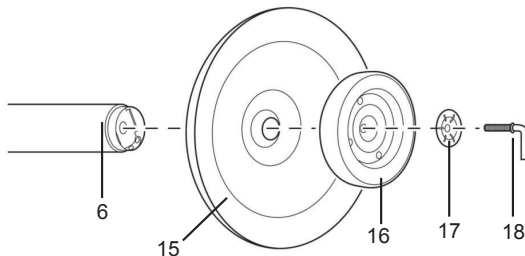

- Next attach the motor housing (9) to the top of the telescopic stand (6). First remove all the screws, etc. (7, 8, 19 & 20) from the motor housing bracket.

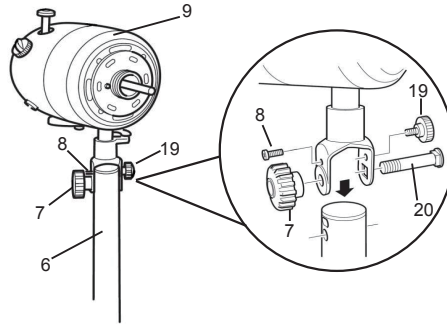

- Place the Motor Housing on the top of the stand and thread the Large Pivot Bolt (20) through the bracket and screw in the Small Retaining Screw (8) and tighten (but do not over tighten).
- Fit the Large Pivot Knob (7) onto the end of the Bolt (20) and the Small Adjusting Knob (19). Hold the fan motor upright and tighten the Large Pivot Knob (7) and the Small Adjusting Knob (19).

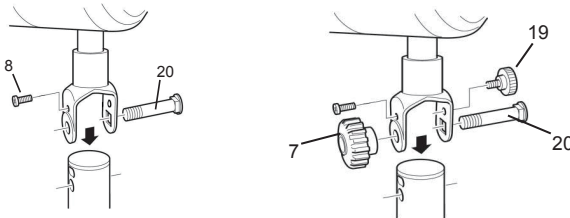

OPERATING INSTRUCTIONS

- Set the fan on a dry, level and sturdy surface.
- Plug the fan into the mains.
- Be sure the voltage of fan conformed to local power condition before using it.

Oscillation, adjusting angle

- Push down the oscillation knob to make the fan head oscillate, and pull-up the oscillation knob to stop the fan head from oscillating.
- Loosen the adjusting angle knob, adjust the fan to the desired angle, to secure tighten the adjusting angle knob.

ON/OFF, Speed Selection

Adjust the desired speed by oscillate the power switch:

0--- Stop I --- Low II--- Medium III--- High

CLEANING AND MAINTENANCE

Your fan requires little maintenance and contains no user serviceable parts. Do not attempt to dismantle the Fan Motor body yourself. The fan is permanently lubricated and will not require additional lubrication.

Important: Do not allow water to run into the interior of the fan, as this causes an electric shock. DRY THE FAN THOROUGHLY with a dry cloth, checking that the fan is completely dry before operating the fan.

Important Safety Instructions

When using electrical appliance, basic precautions should be followed to reduce the risk of fire and personal injury.

- DO NOT connect the appliance to the mains voltage until completely assembled and adjusted
- Before you connect the appliance, check if the voltage specified on the appliance corresponds to the mains voltage in your home.
- To protect against electrical shock, do not immerse until plug or cord in water or spray with liquids
- Never put objects into the grille when the fan is connected to the mains
- Unplug from outlet when not in use, when moving fan from one location to another, before putting on or taking off parts and before cleaning
- It is not advisable to expose people (esp. babies and older people) to a continuous cold air stream for a long time.
- DO NOT use fan in very hot to humid environment, such as bathroom.
- Make sure fan is on a stable surface when operating to avoid a chance of overturning.
- DO NOT use a fan in a window. Raining may cause an electric hazard.
- DO NOT use fan near curtains, plant, windows treatments, etc
- DO NOT operate in the presence of explosive and / or flammable fumes
- DO NOT place fan or any parts near an open flame, cooked or other heating appliance.
- DO NOT operate any appliance with a damaged cord or plug, after the appliance malfunctions or has been dropped or damaged in any manner.
- DO NOT let allow the cord to overhang a table or workshop.
- To disconnect, grip plug and pull from wall outlet NEVER yank on cord.
- Always use on a dry surface.

- This product is intended for household use only and not for commercial or industrial use.
- Disconnect fan before cleaning.
- Never remove the inner pipe stopper or remove the set knob which holds the pipe stopper in place.
- DO NOT let the cord come into contact with hot surfaces.



This marking indicates that this product should not be disposed with other household wastes throughout the EU. To prevent possible harm to the environment or human health from uncontrolled waste disposal, recycle it responsibly to promote the sustainable reuse of material resources.

To return your used device, please use the return and collection systems or contact the retailer where the product was purchased. They can take this product for environmental safe recycling.

CONNECTION TO POWER

Before switching on make sure that the voltage of your electricity supply is the same as that indicated on the rating plate.

MAIN CORD

Wiring Instructions: Should it be necessary to change the plug please note the wires in the mains lead are coloured in accordance with the following code:

BLUE - NEUTRAL

BROWN - LIVE

GREEN AND YELLOW - EARTH

As the colours of the wires in the mains lead of this appliance may not correspond with the coloured markings identifying the terminals in your plug, proceed as follows:

1. The **BLUE** wire is the **NEUTRAL** and must be connected to the terminal which is marked with the letter **N** or coloured **BLACK**.
2. The **BROWN** wire is the **LIVE** and must be connected to The terminal which is marked with the letter **L** or coloured **RED**.
3. The **GREEN/YELLOW** is the **EARTH** and must be connected to the terminal which is marked with the letter **E** or  or coloured **GREEN OR GREEN/YELLOW**.
4. Always ensure that the cord grip is positioned and fastened correctly.

If a **13A (BS 1363)** fused plug is used it must be fitted with a **3A** fuse.

If in doubt consult a qualified electrician.

Wiring for a 13 Amp Plug (BS1363)

Please note. The Earth Terminal is marked with the letter **E** or Earth symbol .

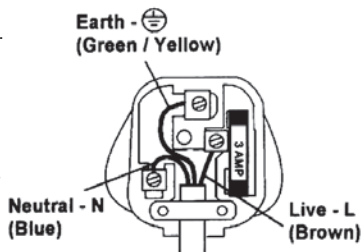

IMPORTANT

As the colours of the wire in the mains lead of this appliance may not correspond with the coloured markings identifying the terminals in your plug, proceed as follows:

The blue wire must be connected to the terminal marked with the letter **N** or coloured black.

The brown wire must be connected to the terminal marked with the letter **L** or coloured red.

The green and yellow wire must be connecting to the terminal marked with the letter **E** or the earth symbol. (.

If a 13 Amp (BS1363/A) plug is used, a 3Amp fuse must be fitted, or if any other type of plug is used, a 3 Amp fuse must be fitted, either in the plug, adaptor, or on the distribution board.



Caution
To prevent electric shock disconnect from the mains
before removing the cover

This unit must be earthed. This equipment must be disconnected from the mains when not in use.
Do not allow this unit to be exposed to rain or moisture.

Technical Specifications

Description	Symbol	Value	Unit
Model no.	--	FD-40M	--
Voltage	--	220-240	VAC
Insulation class	--	Class I	--
Maximum fan flow rate	F	43,02	m ³ /min
Fan power input	P	35,70	W
Service value	SV	1,21	(m ³ /min)/W
Off mode power consumption	P _{off}	0	W
Fan sound power level	L _{WA}	65,30	dB(A)
Maximum air velocity	c	2,95	meters/sec
Measurement standard for service value	IEC 60879:1986 (corr.1992)		
Contact details for obtaining more information	Customer helpline 0345 640 0800		

We apologise for any inconvenience caused by any minor inconsistencies in these instructions, which may occur as a result of product improvements and development.



PRODUCT GUARANTEE

This product is guaranteed against manufacturing defects for a period of



Year

This product is guaranteed for twelve months from the date of original purchase. Any defect that arises due to faulty materials or workmanship will either be replaced, refunded or repaired free of charge where possible during this period by the dealer from whom you purchased the unit.

The guarantee is subject to the following provisions:

- The guarantee does not cover accidental damage, misuse, cabinet parts, knobs or consumable items.
- The product must be correctly installed and operated in accordance with the instructions contained in this manual.
- It must be used solely for domestic purpose.
- The guarantee will be rendered invalid if the product is re-sold or has been damaged by inexpert repair.
- Specifications are subject to change without notice.
- The manufacturer disclaims any liability for the incidental or consequential damages.
- The guarantee is in addition to, and does not diminish your statutory or legal rights.