

VC720027MUK Rev1

# morphy richards®

smart ideas for your home



## Total Clean

### Fresh Upright and Handheld Steam Cleaner



Please read and keep these instructions for future use

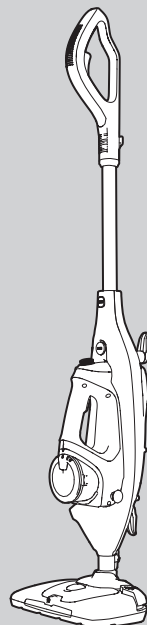

**IMPORTANT:** To prevent limescale problems which would not be covered by the guarantee, use only deionised, demineralised or distilled water (available from most large supermarkets). The anti-scale cartridge will reduce the effects of limescale but must be regularly replaced as advised on page 10.

## SPARES:

All spares, eg. micro-fibre cloths and anti-scale cartridges may be purchased by calling our UK spares line directly on: **0344 873 0710** or logging onto **[www.morphyrichards.com](http://www.morphyrichards.com)**

For competitions, product hints and tips and more join us at



[www.morphyrichards.co.uk/blog](http://www.morphyrichards.co.uk/blog)



[www.facebook.com/morphyrichardsuk](http://www.facebook.com/morphyrichardsuk)



[@loveyourmorphy](https://twitter.com/loveyourmorphy)

**[www.morphyrichards.com](http://www.morphyrichards.com)**

\* Register online for your 2 year guarantee. See back of this instruction book for details. (UK and Ireland customers only)

## Health and Safety

The use of any electrical appliance requires the following common sense safety rules. Please read these instructions carefully before using the product.

- **WARNING: Disconnect from the mains supply before carrying out any routine maintenance.**
- This appliance can be used by persons with reduced physical, sensory or mental capabilities, or lack of experience and knowledge, if they have been given supervision or instruction concerning the use of the appliance in a safe way and understand the hazards involved.
- Children shall not play with the appliance.
- Keep the appliance out of reach of children when it is energized or cooling down.
- The appliance is not to be used if it has been dropped, if there are visible signs of damage or if it is leaking.
- The appliance must not be left unattended while connected to the supply mains.
- If the supply cord is damaged, it must be replaced by the manufacturer, its service agent, or similarly qualified person to avoid a hazard.

### Personal safety

- **WARNING: Never direct steam at electrical components or fittings. If in doubt about the suitability of steam for cleaning an appliance, contact the appliance manufacturer for advice prior to cleaning.**
- **WARNING: Never touch the plug or cable with wet hands.**
- **WARNING: Nozzles and tools will be hot after use. Allow to cool before attempting to remove.**
- **WARNING: Misuse of the appliance could cause injury.**
- **WARNING: Do not discharge the steam towards people or animals. Danger of scalding.**
- **WARNING: Do not use the appliance without the filler cap in place.**
- **WARNING: In the event of a blockage, steam will be released from the steam relief vent.**
- To protect against fire, electric shock and personal injury, do not immerse cord, plug or cleaner in water or other liquid.
- The plug should be removed from the wall socket after use, before cleaning, filling or changing the accessories, or carrying out user maintenance.
- Repairs to electrical appliances are only to be undertaken by trained personnel.
- Unprofessional repairs can be dangerous for users.
- Do not use or keep this product outside.

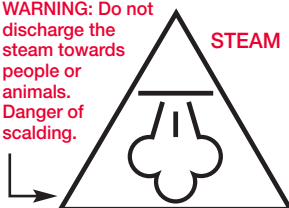

**Mains cable**

- **WARNING: A damaged or severed mains cable fitted with a plug should never be connected to the mains supply. It must be destroyed, as a damaged cable becomes hazardous if connected to a power socket.**
- Do not allow the mains lead to become strained.

**Product safety**

- Do not store the appliance near hot surfaces eg. ovens or heating appliances.
- Never modify the steam cleaner in any way.

- Never operate the steam cleaner without water in the tank. Always top-up with water during extended periods of use.
- Do not use any chemical detergents, perfumes, alcohol or descaler etc in water.
- Use only genuine Morphy Richards spare parts and accessories.
- This steam cleaner is intended for domestic use only. Misuse or use for commercial or any other purpose will render the guarantee invalid.

**Electrical requirements**

- Check that the voltage on the rating plate of your appliance corresponds with your house electricity supply which must be A.C. (Alternating Current).
- **WARNING: This appliance must be earthed.**
- Should the fuse in the mains plug require changing, a 13 amp BS1362 fuse must be fitted.

**Contents**

Health and safety ..... 2

Electrical requirements ..... 3

Product overview / Features ..... 4

Operating the appliance ..... 5

Dual functionality ..... 5

Upright steam cleaning: assembly ..... 5

Using in upright steam cleaning mode ..... 6 & 7

Using the handheld steam cleaner ..... 8

List of attachments for use on the handheld steam cleaner .... 9

Steam relief vent ..... 10

The water tank ..... 10

Anti-scale ..... 10

After use ..... 11

Storage ..... 11

Maintenance ..... 11

Contact us ..... 11

Guarantee ..... 12

## Product overview

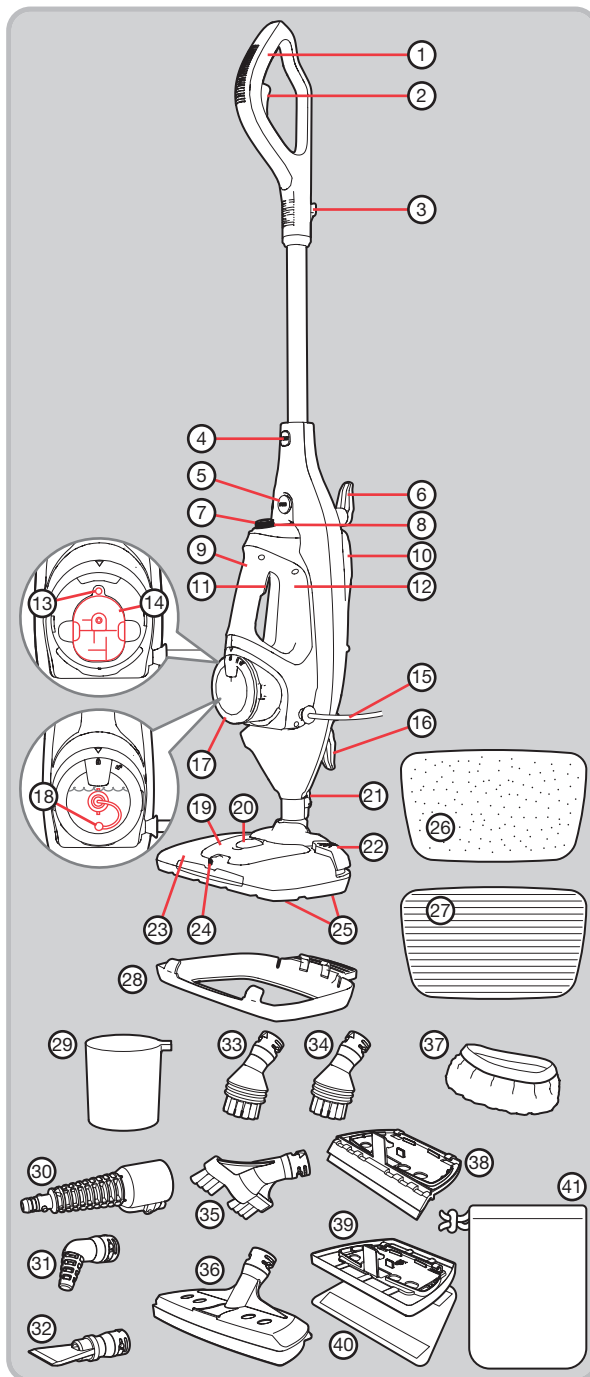

## Features

- (1) Handle
- (2) Steam trigger
- (3) Cord holder
- (4) Handle release button
- (5) Handheld release button
- (6) Upper cord storage hook (rotatable)
- (7) On/off power switch / variable steam control
- (8) Power indicator light
- (9) Handheld handle
- (10) Main body
- (11) Steam trigger (on underside of the handle of the handheld steam cleaner)
- (12) Handheld steam cleaner
- (13) Steam relief vent (behind water tank)
- (14) Anti-scale cartridge (behind water tank)
- (15) Power cord
- (16) Lower cord storage hook (rotatable)
- (17) Water tank
- (18) Water tube with metal ball weight attached
- (19) Floorhead reservoir
- (20) Floorhead reservoir filler cap
- (21) Floorhead release button
- (22) Floorhead spray button
- (23) Floorhead
- (24) Floorhead spray nozzle
- (25) 4x Hook and loop fastener pads
- (26) Micro-fibre hard floor cloth
- (27) Micro-fibre carpet cloth
- (28) Carpet glider
- (29) Filler jug
- (30) Accessory adaptor
- (31) Angled nozzle attachment
- (32) Spatula attachment
- (33) Circular brush attachment
- (34) Circular brass brush attachment
- (35) Long brush attachment
- (36) Utility attachment
- (37) Elasticated utility cloth (attaches to utility attachment)
- (38) Squeegee attachment (attaches to utility attachment)
- (39) Flat cleaning head (attaches to utility attachment)
- (40) Flat cleaning cloth (attaches to flat cleaning head)
- (41) Accessory bag

## Operating the appliance

**IMPORTANT:** Please remember that the steam cleaner operates by emitting steam at an increased temperature of 115°C. Always test on an inconspicuous area first. Never use it on objects or surfaces which cannot resist this temperature, or on surfaces with coatings or polishes, or on delicate materials such as dralon, plastic, natural fur or antique items etc.

If in doubt, check carefully on a part of the material where minor marks will not matter.

**IMPORTANT:** Do not use disinfectant, detergents, cleaning solutions, scented oils or scented water, bleach or vinegar in the main water tank (17). They will cause damage to your product and invalidate your guarantee. We recommend you only use deionised or distilled water, or Morphy Richards water softener bottles, to fill the main water tank of your steam cleaner.

**IMPORTANT:** In the floorhead reservoir (19), a 50:50 water / detergent solution should be used. Do not use bleaches or oils and always check that the detergent you plan to use is suitable for the surface to be cleaned.

## Dual functionality

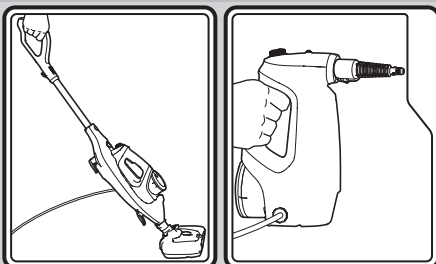

Upright steam cleaning Handheld steam cleaning

Your steam cleaner can easily be configured into two different cleaning modes:

- Upright steam cleaner for floors and carpets.
- Handheld steam cleaner (12) for cleaning vertical or hard to reach surfaces.

Attachments (30-40) can be used on the handheld steam cleaner.

## Upright steam cleaning: assembly

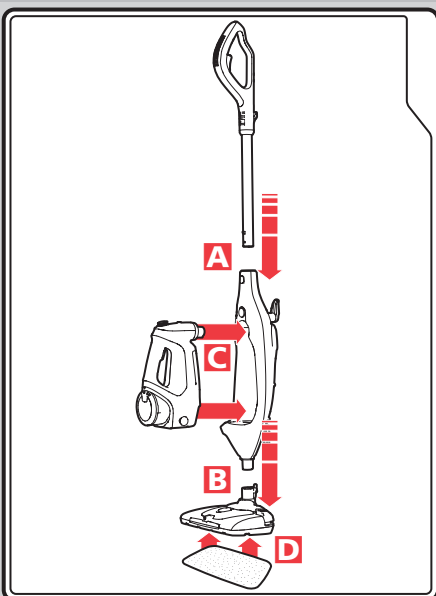

- A** Insert the handle (1) onto the main body (10), ensuring it clicks into place.

NOTE: Attaching the handle is necessary for first time assembly only.

- B** Lower the main body onto the floorhead (23), with the floorhead release button (21) on the neck of the floorhead to the back of the assembly, until it clicks into place.

- C** Insert the steam outlet nozzle at the top end of the handheld steam cleaner (12) into the adaptor at the top of the space in the front of the main body.

Push the handheld steam cleaner firmly into the space in the main body until it clicks into place.

- D** Attach a micro-fibre floor cloth (26/27) to the hook and loop fastener pads (25) on the underside of the floorhead.

## Using in upright steam cleaning mode

**IMPORTANT:** Before use, hardfloors should be thoroughly swept and carpets should be thoroughly dry vacuumed. However, we recommend that the steam cleaner is not used on:

- bare wooden floors or any surfaces where wood is exposed (as it will absorb moisture and may distort).
- damaged hardfloors or hardfloors with gaps present (as it will absorb moisture and may distort).

Also, do not keep the steam cleaner in one place for an extended period, because the continual heat may cause damage to carpets and some hardfloor types such as laminate flooring.

On wood and laminate flooring, do not make the floor overly wet - ALWAYS set the steam to minimum.

Please disconnect and allow the unit to cool before changing cloths and attachments.

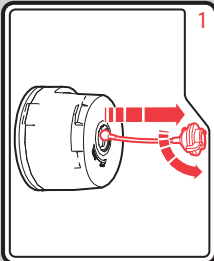
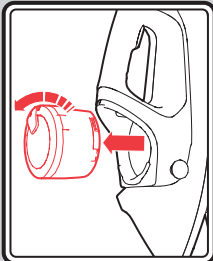

Rotate the water tank (17) anti-clockwise from the 'locked' position to the 'unlocked' position, then remove it from the handheld steam cleaner (12).

Remove the filler cap (with metal ball weight (18) attached) by rotating it anti-clockwise a quarter of a turn, then lift it out.

Before filling, read the Anti-scale chapter on page 10.

Fill the water tank.

Replace the filler cap and turn it clockwise.

Replace the water tank and turn it clockwise to the 'lock' position.

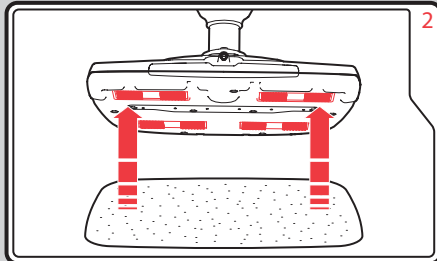

Attach the micro-fibre floor cloth (26/27) to the hook and loop fastener pads (25) on the underside of the floorhead (23).

**NOTE:** The cloth you choose and the floor type to be cleaned may affect how easy it is to push the steam cleaner across your floor surface.

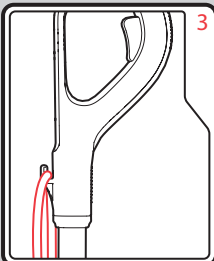
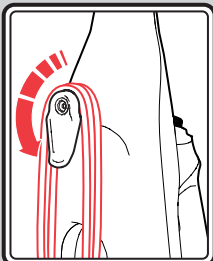

Rotate the upper cord storage hook (6) to quickly release the power cord (15).

Secure the power cord in the cord holder (3).

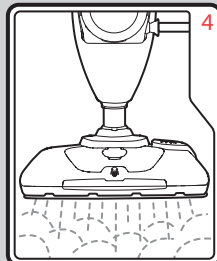
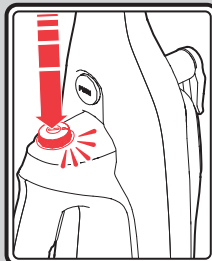

**WARNING:** Before switching ON, ensure the floorhead is located safely away from persons or animals.

Plug in at the mains outlet and switch on the steam cleaner by pressing the on/off power switch/variable steam control (7). The power indicator light (8) will illuminate and steam will be ready to be emitted after around 30 seconds (when the steam trigger (2) is pressed).

## Using in upright steam cleaning mode (continued)

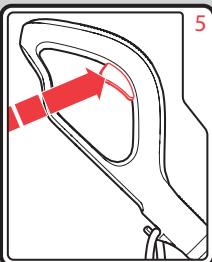
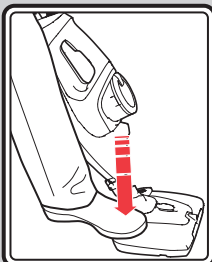

Place the floorhead (23) on the floor. Hold the floorhead to the floor with your foot and tilt the main body (10) back.

To avoid over-saturation of the floor, turn the variable steam control (7) anti-clockwise as far as it will go to set to minimum steam.

Squeeze the steam trigger (2) to release steam from the floorhead. This will take a few seconds. Only operate the steam trigger intermittently to avoid over-saturation of the cloth and floor. The heat and moisture in the cloth should easily clean the floor. Excess steam will result in the floor taking longer to dry. Keep the floorhead moving whilst cleaning.

Never hold the cleaner in one spot for an extended period, see opening paragraph on page 6.

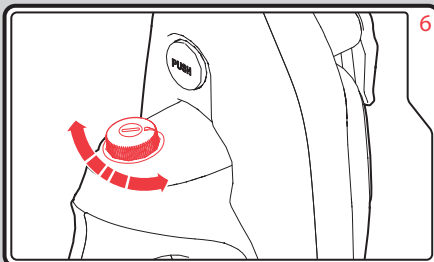

Adjust the variable steam control (7) to the required setting. Turn anti-clockwise for minimum steam, clockwise for maximum steam.

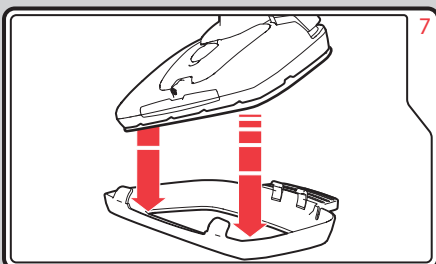

If freshening carpet, rest the floorhead (23) with the micro-fibre carpet cloth (27) attached into the hooks on the front of the carpet glider (28), then firmly push the floorhead down into the rear of the carpet glider to secure it in place. To remove, press your foot down on the tab at the back of the carpet glider and lift the floorhead out.

**NOTE:** The carpet glider is designed to make it easier to move the floorhead across the carpet.

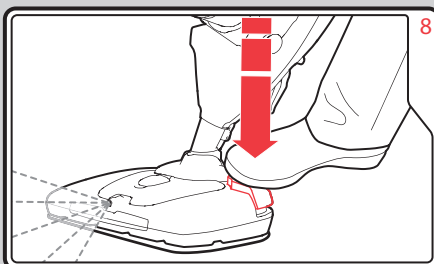

For additional cleaning on floors, the floorhead reservoir (19) may be filled with a maximum of 150ml of a 50:50 water/detergent mixture.

**IMPORTANT:** Check that the detergent is suitable and safe for the floortype being cleaned, always read the detergent supplier's guidance before use.

To distribute the liquid on the floor, press your foot on the floorhead spray button (22) to produce a spray from the floorhead spray nozzle (24).

## Using the handheld steam cleaner

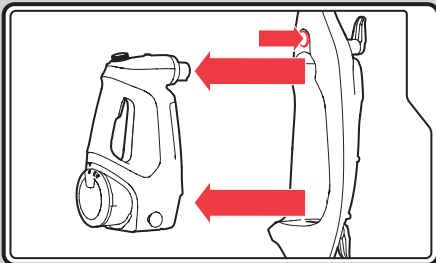

This function is ideal for cleaning vertical surfaces and hard to reach places.

Separate the handheld steam cleaner (12) from the main body (10) by pressing the handheld release button (5) on the front of the main body.

Pull the handheld steam cleaner out of the main body.

Adjust the variable steam control (7) as required. For upholstery and window cleaning, use minimum steam. For the brushes and scraper, use maximum steam.

Operate the steam trigger (11) under the handheld handle (9) to release the steam.

**NOTE:** If the steam trigger is continually held, the steam output will cycle higher and lower, this is normal.

**CAUTION:** After using the handheld steam cleaner, return the unit to the main body. The body of the handheld steam cleaner becomes warm in use, so should not be left on any delicate surfaces.

**WARNING:** After the steam trigger is released, steam will continue to be emitted for a few seconds while the steam reservoir inside the product empties - this is normal. Always keep a safe distance from the nozzle until all steam has stopped. Switch off, unplug and leave to cool before attempting to remove the nozzle or change the attachments as these will be very hot after use.

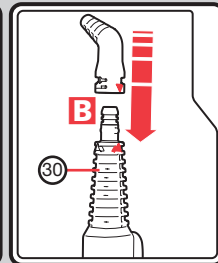
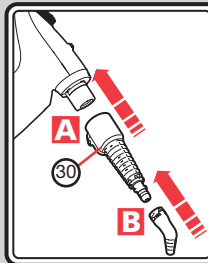

In order to use all of the accessories, the accessory adaptor (30) must firstly be attached onto the handheld steam cleaner (12). This can be done by completing the following:

- A** Slide the adaptor over the nozzle of the handheld steam cleaner with the release catch on the adaptor facing the base of the handheld steam cleaner.

Align the keyway on the handheld steam cleaner with the release catch on the adaptor. Push together and fix into place.

- B** Attach the desired accessory to the end of the adaptor by aligning the arrow on the accessory with the right-hand arrow on the adaptor and twist the accessory until the arrow aligns with the left arrow of the two on the adaptor.

**NOTE:** handheld mode has been designed for one-handed use only.

### Warning

**WARNING:** Switch OFF and unplug before changing attachments. After use, attachments will be very hot, allow to cool before handling.

**WARNING:** Steam can be emitted from the steam relief vent (13) situated behind the water tank on the handheld. Always keep this area clear of people, animals or delicate surfaces. Do not hold the product in this area. When using in the handheld mode, only ever hold the product by the handheld handle (9).

Never block any nozzle eg by holding against a surface being cleaned. If the nozzles are blocked, steam will be released from the steam relief vent.

Limescale build-up inside the boiler could also result in steam being emitted from the steam relief vent. To prevent limescale forming, only ever use water which is demineralised, deionised, distilled or softened (using MorphyRichards water softener bottles).



## List of attachments for use on the handheld steam cleaner

**Accessory adaptor (30)** this attachment is the base attachment for all handheld accessories supplied with the product.

It can also be used alone to clean places or crevices that are not easily accessible.

**Angled nozzle attachment (31)** to clean sanitary ware such as toilet bowls, taps or drain covers. Point it directly at non-permanent stains on carpets or upholstery whilst holding a clean cloth near the stained area to capture any loosened dirt.

**Spatula attachment (32)** to remove stubborn deposits, or to help de-ice the refrigerator or freezer.

**Circular brush attachment (33)** to remove stains on room-temperature surfaces, such as tiles, wheel trims, mirrors and windows.

**Circular brass brush attachment (34)** to remove stubborn stains. Use only on hard metal surfaces, eg. stainless steel.

**Long brush attachment (35)** to remove dirt from grooves and crevices.

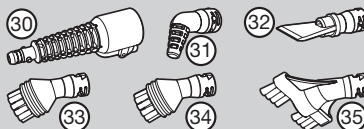

**Utility attachment (36)** once attached to the accessory adaptor (30), the utility attachment is the base attachment for attaching all the following accessories:

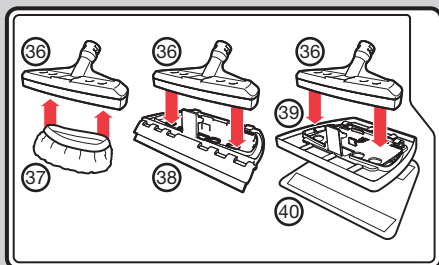

**Elasticated utility cloth (37)** for covering the utility attachment when cleaning upholstery and bedding.

**Squeegee attachment (38)** can be attached to the utility attachment by inserting the hooks at the back of the squeegee attachment into the loops on the back of the utility attachment, then secure the front of the utility attachment into the locking clip on the top of the squeegee attachment (as shown).

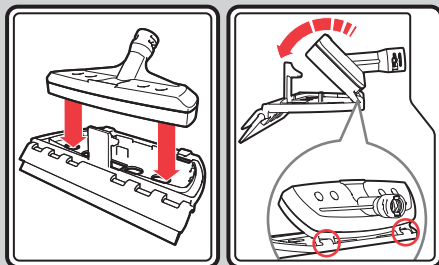

Remove the squeegee after use by holding the locking clip forward. The utility attachment should still be hooked into the loops on the rear of the squeegee attachment, pivot the utility attachment up and unhook from the loops to lift it away.

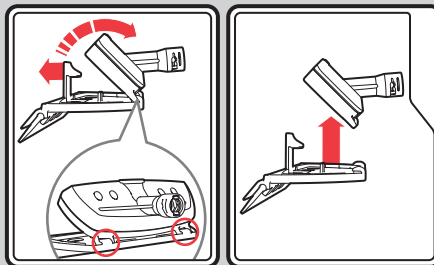

The squeegee attachment is ideal for cleaning tiled or glass areas such as windows or mirror panels. To clean windows, start at the top, press the squeegee to the surface and drag downwards in straight passes from top to bottom. Wipe the rubber blade and the bottom edge of the window dry after each pass. For small window panels, remove the squeegee tool and spray the steam directly onto the surface. Use the squeegee separately to wipe away the moisture.

**WARNING:** Do not use on very cold glass, as the sudden temperature change may crack the glass.

**Flat cleaning head (39) with flat cleaning cloth (40) attached** attaches to the utility attachment (using the same method as attaching and unattaching the squeegee attachment, as shown on the left and above). This accessory is useful for cleaning tiled or glass surfaces, cabinets and worktops in kitchens and bathrooms, plus upholstery, curtains, blinds, pillows and mattresses.

## Steam Relief Vent (13)

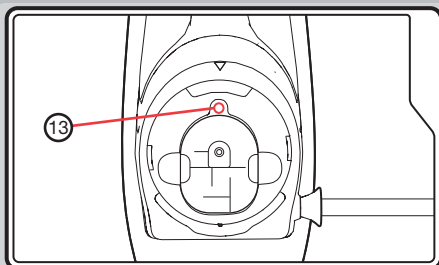

If steam is emitted from this vent, ie. if it is seen escaping from around the water tank on the handheld steam cleaner, switch off, unplug and allow the product to cool. Please contact the consumer care helpline on 0344 871 0944 for further advice.

**WARNING:** Never attempt to use descaler in the product.

**WARNING:** In the event of the steam being blocked from escaping, the steam pressure may be relieved via a vent located behind the water tank on the handheld steam cleaner. Never hold the product in the area of the steam relief vent.

Steam or hot water may be emitted from this vent but only if:

- the cleaning nozzle has been blocked, eg. by accidentally sealing it against a surface.
- the boiler has become blocked due to limescale caused by using hard water.

## The water tank

### The metal ball weight (18)

The metal ball weight inside the water tank is attached to the end of the suction hose. The ball is weighted and designed to freely move around the water tank depending on the position of the product. If the ball does get stuck outside the water level, gently shake the product until it comes free. The ball must remain in the water so steam can be generated whenever the steam trigger is pressed regardless of the orientation of the handheld steam cleaner.

## Anti-scale

### Limescale

Tap water contains minerals which can result in a build-up of limescale in the boiler. This can severely affect the steam output. The anti-scale cartridge (14) treats the water before it enters the boiler to minimise the effects of these minerals, but after a maximum of three months use, it will lose its effectiveness and must be replaced. This should be reduced further in areas of very hard water or if the cleaner is used extensively.

To prevent limescale build-up in the boiler, never fill the steam cleaner's water tank with anything other than deionised, demineralised or distilled water (available from most leading supermarkets). The use of the correct water is an additional precaution that should be taken to ensure the performance of the boiler is maximised.

### Removal of the anti-scale cartridge (14)

1. Remove the water tank (17) as described in step 1 of 'Using in upright steam cleaning mode' on page 6.

You will find the anti-scale cartridge (14) attached to the handheld steam cleaner (12) in the recess where the water tank was located.

2. Grip each side of the anti-scale cartridge (14) and pull forward to remove.

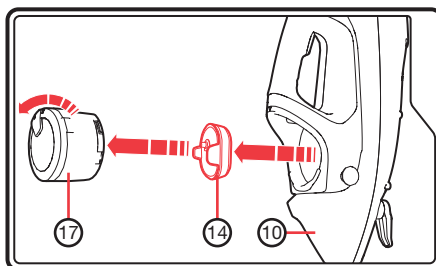

3. Replace with the new anti-scale cartridge, pushing firmly into place. Replacement cartridges can be purchased by calling our UK helpline directly on: 0344 873 0710 or logging onto [www.morphyrichards.com](http://www.morphyrichards.com).
4. The resin crystals within the cartridge are a mild irritant. Do not break open the cartridge.

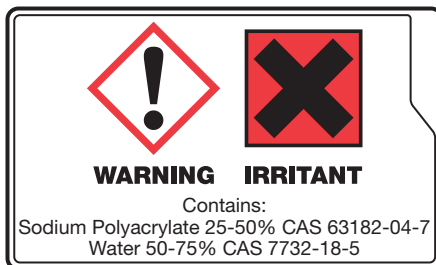

**IRRITANT:** Eye contact: Any material that contacts the eye should be washed out

immediately with water. If easy to do so, remove any contact lenses. Get medical attention if any discomfort continues.

**Skin contact:** Wash skin with soap and water.

**Ingestion:** Immediately rinse mouth and drink plenty of water. Get medical attention if irritation persists.

- Dispose of the used anti-scale cartridge with your household waste.

## After use

Follow the maintenance steps below after every use.

- Switch the cleaner off and unplug from the socket. Leave to cool on a safe (high temperature / moisture resistant) surface, eg. a tiled floor.
- Remove the carpet glider (28) (if used). Remove the micro-fibre floor cloth (26/27) and wash and air dry it (see 'Cleaning the cloths' under the 'Maintenance' section on this page).
- Empty the water tank (17) by removing the filler cap and pouring out the water. Allow the inside of the water tank to dry out before replacing the filler cap.
- Empty the floorhead reservoir (19). To do this, remove the floorhead (23) from the main body (10) by pressing the floorhead release button (21) and pulling the floorhead away. Then, open the floorhead reservoir filler cap (20) and turn the floorhead upside down over a sink, pouring out the water. Allow the inside of the water reservoir to dry out before replacing the filler cap.

## Storage

Remove the micro-fibre floor cloth (26/27) and wash and air dry it (see 'Cleaning the cloths' under the 'Maintenance' section on this page).

Wrap the cord around the two cord storage hooks (6/16), rotating the upper storage hook (6) upwards to secure the power cord (15) in place.

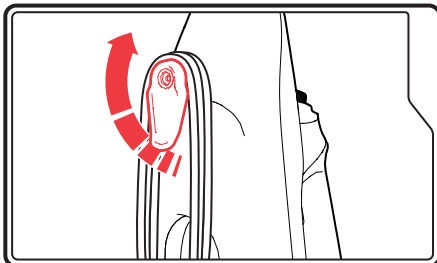

Put all accessories into the accessory bag (41) and hang the bag from the upper cord storage hook.

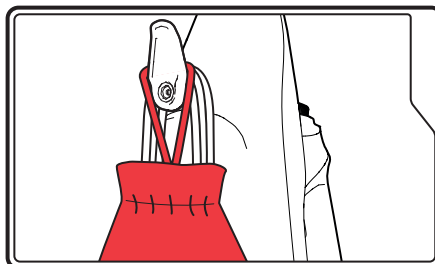

## Maintenance

**WARNING:** Always unplug the Steam cleaner from the mains supply before undertaking any maintenance procedures.

### Overall maintenance

Your cleaner is manufactured to withstand normal day-to-day use, but an occasional wipe over with a damp cloth will help maintain it. Abrasive cleaners should not be used.

### Cleaning the cloths

The micro-fibre floor cloths (26/27), elasticated utility cloth (37) and the flat cleaning cloth (40) can all be machine washed (40°C max). For heavy soiling, soak the cloths in warm water and detergent or a mild stain remover.

**IMPORTANT:** Do not use bleach or fabric softener.

Allow cloths to completely dry before storing.

Replacement cloths can be purchased by calling our UK helpline directly on: 0344 873 0710 or logging onto [www.morphyrichards.com](http://www.morphyrichards.com).

### Maintaining the attachments

Dirt and blockages should be regularly removed from the attachments to help prolong their usage.

## Contact us

### Helpline

If you are having a problem with your appliance, please call our Helpline, as we are more likely to be able to help than the store you purchased the item from.

Please have the product name, model number and serial number to hand when you call to help us deal with your enquiry quicker.

UK Helpline: 0344 871 0944

IRE Helpline: 1800 409 119

Spares: 0344 873 0710

### Talk To Us

If you have any questions or comments, or want some great tips to help you get the most out of your products, join us online:

Blog: [www.morphyrichards.co.uk/blog](http://www.morphyrichards.co.uk/blog)

Facebook: [www.facebook.com/morphyrichardsuk](http://www.facebook.com/morphyrichardsuk)

Twitter: [www.twitter.com/loveyourmorphy](http://www.twitter.com/loveyourmorphy)

Website: [www.morphyrichards.com](http://www.morphyrichards.com)

VC720027MUK Rev1 11/15

## Registering your 2 year guarantee

Your standard 1 year guarantee is extended for an additional 12 months when you register the product within 28 days of purchase with Morphy Richards. If you do not register the product with Morphy Richards within 28 days, your product is guaranteed for 1 year. To validate your 2 year guarantee, register with us online at

[www.morphyrichards.co.uk](http://www.morphyrichards.co.uk)

Or call our customer registration line, quoting model and serial number, these numbers can be found on the base of the product.

**UK 0344 871 0242**

**IRE 1800 409 119**

N.B. Each qualifying product needs to be registered with Morphy Richards individually.

**Please note that the 2 year guarantee is only available in the UK and Ireland.** Please refer to the 1 year guarantee for more information.

## Your 1 year guarantee

To qualify for the 1 year guarantee, the appliance must have been used according to the instructions supplied.

It is important to retain the retailer's receipt as proof of purchase. Staple your receipt to this back cover for future reference.

Please quote the following information if the product develops a fault. These numbers can be found on the base of the product.

Model no.                                  Serial no.

All Morphy Richards products are individually tested before leaving the factory. In the unlikely event of any appliance proving to be faulty within 28 days of purchase, it should be returned to the place of purchase for it to be replaced.

If the fault develops after 28 days and within 12 months (2 years if registered) of original purchase, you should contact the Helpline number quoting Model number and Serial number on the product, or write to Morphy Richards at the address shown.

You may be asked to return a copy of proof of purchase.

Subject to the exclusions set out below (see Exclusions), the faulty appliance will then be repaired or replaced and dispatched usually within 7 working days of receipt.

If you suspect a fault, follow the simple checks detailed below before retrying the appliance or calling the helpline.

- Check the steam outlet is not blocked.
- Check the plug is firmly in the socket.
- Check the socket is working by trying another appliance.
- Check the fuse in the plug.

If, for any reason, this item is replaced during the 1 year guarantee period, the guarantee on the new item will be calculated from original purchase date. Therefore it is vital to retain your original till receipt or invoice to indicate the date of initial purchase.

This appliance is intended for domestic use only. Misuse or use for commercial or any other purpose will render the guarantee invalid.

## Exclusions

Morphy Richards shall not be liable to replace or repair the goods under the terms of the guarantee where:

- 1 The fault has been caused or is attributable to accidental use, misuse, negligent use or used contrary to the manufacturer's recommendations or where the fault has been caused by power surges or damage caused in transit.
  - 2 The appliance has been used on a voltage supply other than that stamped on the products.
  - 3 Repairs have been attempted by persons other than our service staff (or authorised dealer).
  - 4 The appliance has been used for hire purposes or non domestic use.
  - 5 The appliance is second hand.
  - 6 Morphy Richards reserves the right not to carry out any type of servicing under the guarantee at its discretion.
  - 7 The guarantee excludes consumables such as cloths and brushes.
  - 8 Any problems arise as a result of limescale build-up.
- This guarantee does not confer any rights other than those expressly set out above and does not cover any claims for consequential loss or damage. This guarantee is offered as an additional benefit and does not affect your statutory rights as a consumer. Morphy Richards products are intended for household use only. See usage limitations within the location safety instructions.

## Disclaimer

Morphy Richards has a policy of continuous improvement in product quality and design. The company, therefore reserves the right to change the specification of its models at any time.



For electrical products sold within the European Community. At the end of the electrical products useful life, it should not be disposed of with household waste. Please recycle where facilities exist. Check with your Local Authority or retailer for recycling advice in your country.

**IF YOU ARE HAVING A PROBLEM  
WITH ONE OF OUR PRODUCTS,  
CALL OUR HELPLINE:**

**UK: 0344 871 0944  
EIRE: 1800 409 119  
SPARES: 0344 873 0710**

**morphyrichards**

The After Sales Division  
Morphy Richards Ltd  
Mexborough,  
South Yorkshire,  
England, S64 8AJ

[www.morphyrichards.com](http://www.morphyrichards.com)

