

User's
Guide

ORECK®

Magnesium™

Powerful, Lightweight & Durable
Upright Vacuum



Important!
Read this manual carefully, and keep for
future reference.

Enjoy



Thank you for purchasing the Oreck Magnesium™ upright vacuum cleaner. The Oreck Magnesium™ features a 7-year warranty along with an HEPA Odor Fighting Inner Bag. The inner bag is already installed. Simply install the handle and you are ready to enjoy your new Oreck Magnesium Upright Vacuum Cleaner.

Welcome to our **Call. Click.** customer service program. To speak with an Oreck representative call or click using the information below.

Call



USA: **1•800•989•3535**
Canada: **1•888•676•7325**

Click



On the web, point and click at: **www.oreck.com**
or visit www.oreck.com and click locate a store on the top right.

Contents

Safety	3
General Warnings	3
Operation	4
Parts List	4
Assembling the Magnesium Handle	5
Operating the Oreck Magnesium™	5
Changing the HEPA Odor Fighting Inner Bag	6
HEPA Odor Fighting Inner Bag Information	7
General Use & Maintenance	8
Simple Operating Tips	8
The Belt	8
Motor Protection/Vacuum Shutdown	8
Lubrication	8
Brushroll Maintenance	8
Stuffing or Blockage	10
Troubleshooting	11
Parts	11
Accessories & Replacement Parts	11
Warranty	12

SAVE THESE INSTRUCTIONS

Household Use Only

To reduce the risk of electric shock, this equipment has a polarized plug. A polarized plug has one rounded prong that is wider and one straight prong. The rounded end goes into the longest socket slot. This plug will fit in a polarized outlet only one way. If the plug does not fit fully in the outlet, reverse the plug. If it still does not fit, contact qualified personnel to install the proper outlet. Do not alter the plug in any way.

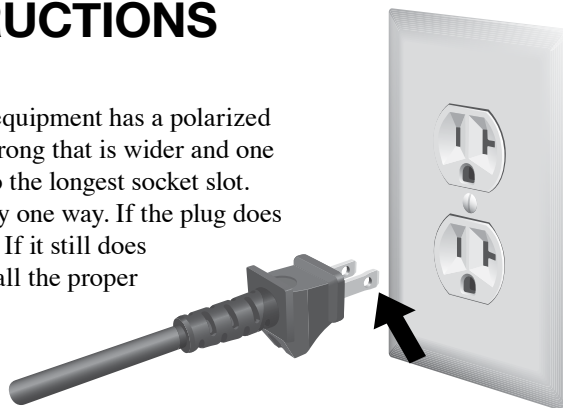

Safety

General Warnings

⚠ IMPORTANT SAFETY INSTRUCTIONS!

When using an electrical appliance, basic precautions should always be followed, including the following:

READ ALL INSTRUCTIONS BEFORE USING THIS VACUUM CLEANER

⚠ WARNING!: To reduce the risk of fire, electric shock, or injury:

- Do not leave appliance unattended when plugged in. Unplug from outlet when not in use and before servicing.
- Do not use outdoors or on wet surfaces.
- Do not operate the unit while in the upright and locked position.
- Do not let the unit run while in any one stationary position for any period of time. Keep the unit moving while in operation.
- Do not allow to be used as a toy. Close attention is necessary when used near children.
- Use only as described in this manual. Use only manufacturer's recommended attachments.
- Do not use with damaged cord or plug. If appliance is not working as it should, has been dropped, damaged, left outdoors, or dropped into water, return it to a service center or call customer service at: **US: 1-800-989-3535 Canada: 1-888-676-7325**
- Do not pull or carry by cord, use cord as a handle, close door on cord, or pull cord around sharp edges or corners.
- Keep cord away from heated surfaces.
- Do not run appliance over cord.
- Do not unplug by pulling on cord. To unplug, grasp the plug, not the cord.
- Do not handle plug or appliance with wet hands.
- Do not put any object into openings. Do not use with any opening blocked; keep free of dust, lint, hair and anything that may reduce air flow.
- Keep hair, loose clothing, fingers and all parts of body away from openings and moving parts.
- Do not use to pick up anything that is burning or smoking, such as cigarettes, matches, or hot ashes.
- Do not use without disposable inner bag assembly in place.
- Turn off all controls before unplugging.
- Use extra care when cleaning on stairs.
- Do not use to pick up flammable or combustible liquids, such as gasoline or lighter fluid, or use in areas where they may be present.
- Do not use appliance in an enclosed space where flammable, explosive or toxic vapors are given off by oil base paint, paint thinner, some mothproofing substances, or in an area where flammable dust is present.
- Do not pick up toxic material such as chlorine bleach, drain cleaner, gasoline, etc. with this appliance.
- Use caution when vacuuming over area rug edges and fringe.
- Product contains chemicals known to the State of California to cause cancer and birth defects or other reproductive harm.

CAUTION!

Wood Floors, Soft (Vinyl, Asphalt Tile, etc.) Floor Surfaces and Polished Floor Finishes

Use floor and floor finish manufacturer's recommended methods of cleaning. The brushroll may also scuff very soft finishes. Do not operate the vacuum while in the upright and locked position. Do not let the vacuum run while in any one stationary position for any period of time. Keep the vacuum moving while in operation.

Operation

Parts List

- 1 Handle with soft comfort grip
- 2 On/Off Switch
- 3 Cord Dump
- 4 Magnesium Handle
- 5 Deflector
- 6 Bag Dock
- 7 Carry Handle
- 8 Zipper
- 9 Main Bumper
- 10 Power Cord
- 11 Lower Tube
- 12 Fan Housing
- 13 Rear Wheels
- 14 Cover
- 15 Outer Bag
- 16 Power Head
- 17 HEPA Odor Fighting Inner Bag



Operation

continued

Assembling the Handle

- 1 Align the four connector tabs at the bottom of the magnesium handle with the four receiving ports at the top of the outer bag and insert until a “snap” is heard.
- 2 Snap cord assembly into the cord clip located on the back of the magnesium handle. Leave excess cord at the power head to allow movement.

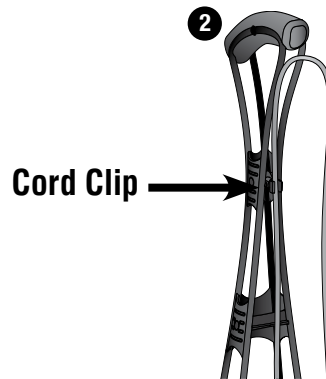
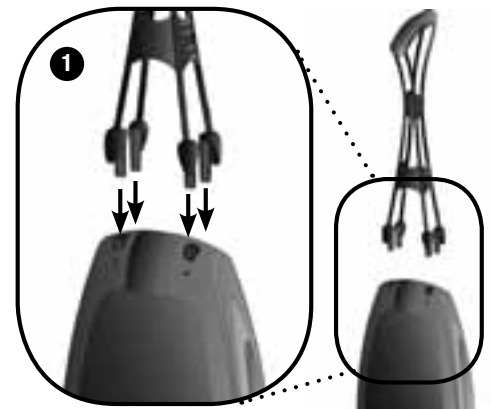

Operating the Oreck Magnesium™

Make sure the disposable inner bag is in place. Do not operate the vacuum without a disposable inner bag. Plug the power cord into an electrical outlet and press the ON/OFF switch on the back of the vacuum when ready to operate. Press the button once to turn the unit on high, press a second time for low speed, and a third time to turn the unit off.

- 3 **Up-Position Lock** - Place foot on power head and lean handle back gently to release lock for vacuum use. Return handle to the full upright position to engage lock.

Note: Do not operate the vacuum while in the upright and locked position. Do not let the vacuum run while in any one stationary position for any period of time. Keep the vacuum moving while in operation.

- 4 **Cord Dump** - To release cord, twist cord dump 1/2 turn. Slide cord off cord dump.

- 5 **Easy Power Cord Storage** - Turn Cord Dump to the up position, wrap power cord around Cord Dump and lower cord bracket located below the Carry handle.

- 6 **Carry Handle** - Carry handle located on back of the vacuum for easy lifting, carrying, and vacuuming stairs.

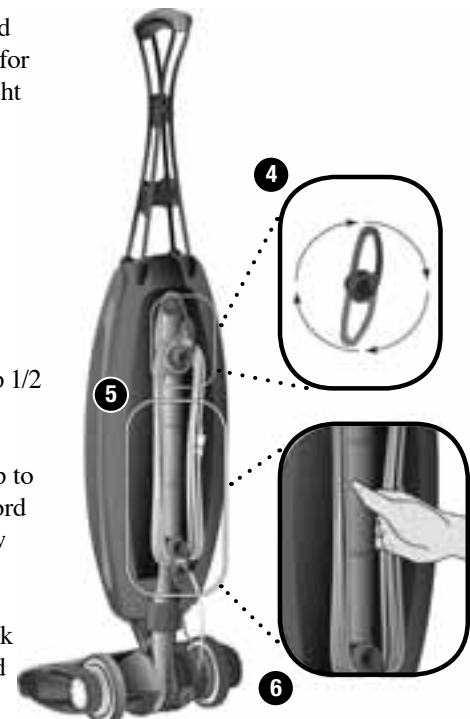

Operation

continued

INNER BAG REMOVAL:

- 1 Unzip outer bag completely.
- 2 Pull tab on bag to release bag dock from connector. Bag dock door will hinge downward.
- 3 Gently pull bag cardboard collar outward from bag dock. Saniseal[®] dust seal will close automatically.



Operation

continued

INNER BAG INSTALLATION:

- 4 Slide the cardboard collar completely onto bag dock door.
- 5 Firmly push bag dock door with both thumbs on indication point until it snaps.

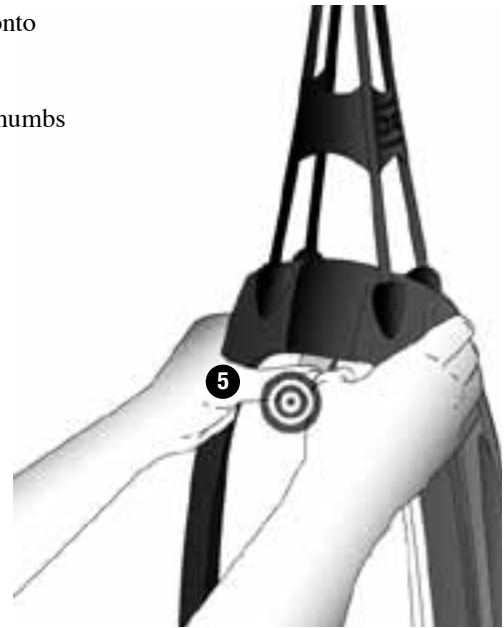
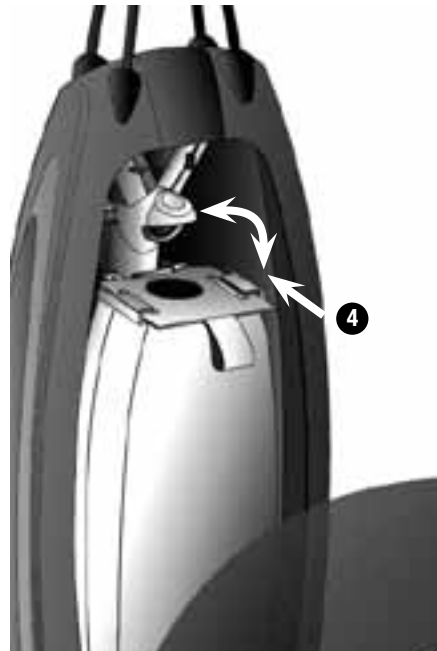

**WHEN REPLACING THE INNER BAG,
DO NOT REMOVE PLASTIC BAG DOCK**

The performance of your new vacuum greatly depends upon care and maintenance. The instructions in this manual will guide you in performing basic care and maintenance. To obtain the most satisfying years of service read the instructions and keep them handy for future reference.

HEPA Odor Fighting Inner Bag

Your Oreck includes an HEPA Odor Fighting Inner Bag. The disposable inner bag plays a very important role in the efficiency of your ORECK vacuum. The purpose of the disposable inner bag is to trap dirt, but at the same time it must be porous enough to allow air to pass through. If the disposable inner bag becomes clogged, no air can pass through the vacuum and cleaning cannot take place, regardless of the vacuum's power.

To keep your upright vacuum operating at maximum efficiency, change the disposable inner bag frequently. **DO NOT FILL ABOVE THE LINE INDICATED ON THE DISPOSABLE INNER BAG.**

Be sure the disposable inner bag is installed properly. **Note:** All disposable inner bags are not the same. Oreck offers HEPA and non-HEPA inner bags. Your Oreck HEPA or non-HEPA inner bags have been designed to be used with the ORECK Upright vacuum. Using bags other than genuine Oreck HEPA or non-HEPA disposable inner bags will affect the cleaning ability of your vacuum and could cause damage to it.

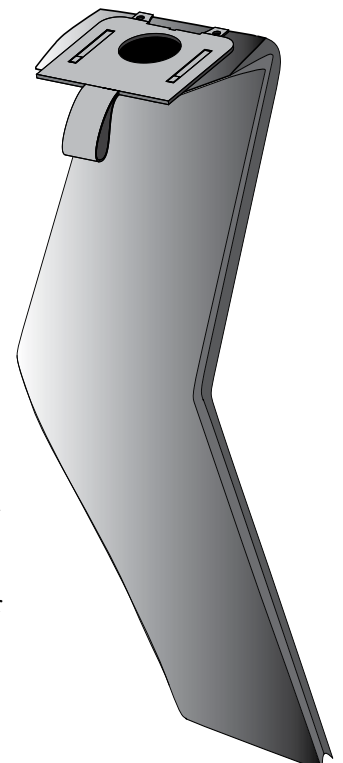

General Use & Maintenance *continued*

Simple Operating Tips:

You'll love the way your Oreck cleans under things, and is SO lightweight and easy to use. The following are a few simple suggestions regarding its operation:

- When inserting a new disposable inner bag, first **puff out** and **OPEN** the bag.
- When the disposable inner bag is full, **replace it**.
- Check the disposable inner bag at least once a month.
- **Do not** run the vacuum over the cord. The revolving brushroll could damage the cord.
- Use caution when vacuuming over area rug edges and fringe.
- If at any time the machine does not pick up properly or makes an unusual noise, **stop operation** and service.
- Although your upright will pick up pins, paper clips, and other small objects, it is recommended that these be removed from the floor before you vacuum. Failure to do so may result in permanent damage to the motor suction fan and its housing.

The Belt

The Oreck Magnesium™ is equipped with the EnduroLife™ Belt, which is designed for long life and doesn't need changing.

Motor Protection/Vacuum Shutdown

If the vacuum becomes overloaded, which could occur by sucking up a large obstruction or on extremely thick carpet, the electronics are designed to shut down the vacuum. If this happens, the vacuum will be turned off and the headlights will flash. To reset the vacuum turn the unit off, wait 5 seconds, and then turn it back on. If it shuts down again there may be a large obstruction in the vacuum. See page 9 for the steps on clearing a blockage.

▲ WARNING: Unplug cord from electrical outlet before servicing.

1. Clear any large obstruction or blockage from the vacuum.
(See Page 9, "Stuffing or Blockage")
2. Once the blockage is cleared, plug the vacuum back in and it will reset.

NOTE: If the vacuum continues to shut down, contact an Oreck Authorized Service Center.

Lubrication

The vacuum motor bearings are factory lubricated and sealed. Further lubrication is not required.

Brushroll Maintenance

At least once a month, check for and remove excessive lint, string or hair from the revolving brushroll. Patented cleaning grooves on the brushroll will allow easier cleaning. Wipe the outside of the vacuum with a damp cloth. Also clean the connector deflector assembly area, base of vacuum and fan housing area. If there is dust in the outer bag, vacuum it or shake it out.

A little preventative maintenance will keep your Upright vacuum looking new and will ensure continued cleaning effectiveness.

Replacing the Brushroll

The brushroll is designed for long life. Should it ever become worn or frayed, it can be replaced by an Oreck Authorized Service Center.

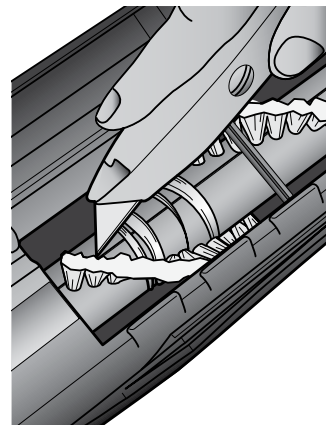

General Use & Maintenance *continued*

Stuffing or Blockage

IMPORTANT: On plush and new carpets, stuffing may occur inside the intake tube and the lower tube assembly. This is due to excessive fuzz and loose cuttings in the carpet. Stuffing could occur for the first few cleanings until all the loose material is removed. Due to the high efficiency of the vacuum, many older carpets will cause stuffing when the vacuum is first used on them. If your vacuum does not pick up properly, or makes unusual noise and the outer bag does not fluff up or balloon open, follow these steps:

⚠ WARNING: Unplug cord from electrical outlet before servicing.

- 1 Check for blockage at the mouth of the intake opening. If there is blockage, remove it with long-nose pliers, a screwdriver or coat hanger.
- 2 Twist lower collar counterclockwise to slide up. Pull tube out of base. Check for blockage. If blockage is in the tube, remove with a coat hanger.
- 3 If tube is not blocked, look into fan housing. Remove debris with long-nose pliers, a screwdriver or coat hanger.

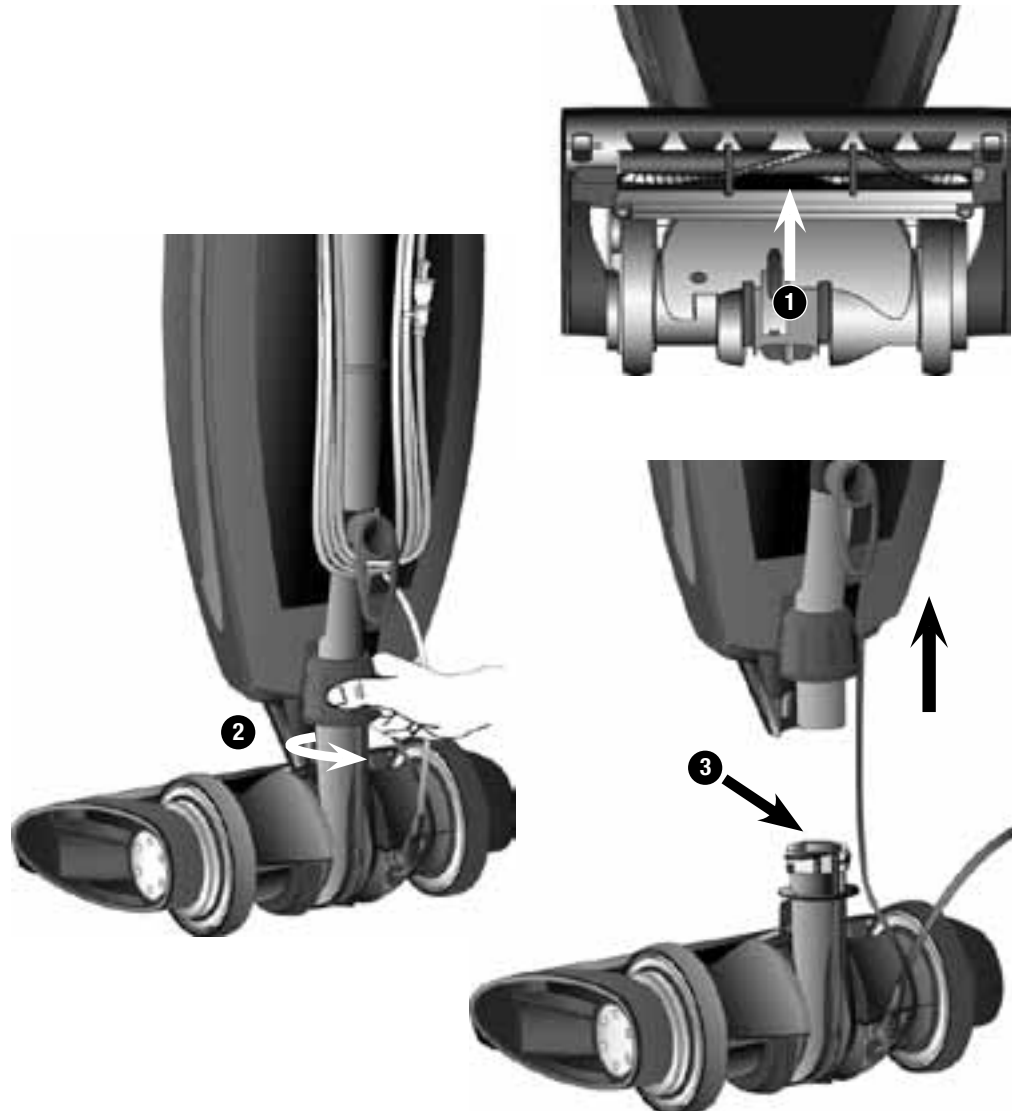

General Use & Maintenance

continued

- 4 Insert tube and push down until the tube is seated. Make sure O-ring is in place against fan housing opening.
- 5 To finish reassembly, replace and tighten collar clockwise until collar locking tabs are locked in place.

Note: Many times blockage occurs due to a full disposable inner bag causing dirt to back down the air flow system. When that happens, the blockage will be at the top of the system, starting in the area where the disposable inner bag connects to the connector assembly. If the above actions do not correct the problem, contact an Oreck authorized service center or call the customer service center.

US: 1-800-989-3535
Canada: 1-888-676-7325

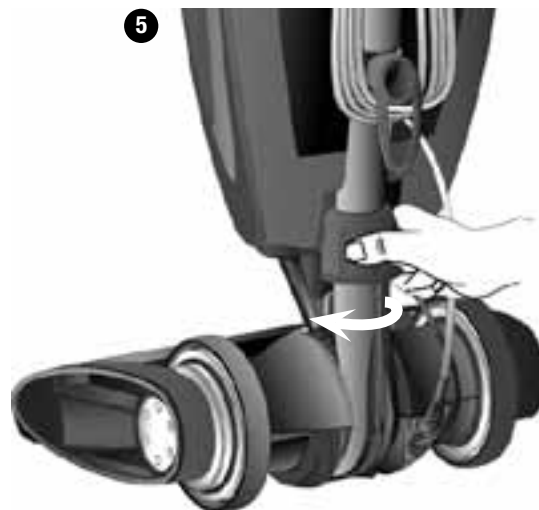

Trouble-shooting

Service problems that appear to be major can often be solved easily. You can be your own troubleshooter by reviewing this guide.

All other servicing should be done by an Oreck authorized service center.

Problem	Check	What to do
Vacuum will not run.	<ul style="list-style-type: none"> • Not plugged in properly. • No electricity in wall outlet. • The Brushroll is blocked. 	<ul style="list-style-type: none"> • Be sure power cord is firmly plugged into wall outlet. • Check electrical source – fuse or circuit breaker. • Clear blockage. Unit will reset (<i>see page 9</i>).
Vacuum does not pick up.	<ul style="list-style-type: none"> • Did the vacuum shutdown on very dense material or large obstruction, and did the lights flash? • Disposable Inner Bag is full. • Nozzle or intake pivot clogged. • Brush is worn. • Bag tube clogged. • Bag pores are clogged with fine dust. • Impeller fan is broken. • Brushroll is not even at both ends. 	<ul style="list-style-type: none"> • See steps on clearing an obstruction on page 9. Turn the unit off and wait 5 seconds and vacuum will reset. You can also unplug unit and vacuum will reset. • Replace Disposable Inner Bag (<i>see page 6</i>). • Clear blockage (<i>see page 9</i>). • Contact Oreck Authorized Service Center. • Clear blockage (<i>see page 9</i>). • Change Disposable Inner Bag (<i>see page 6</i>). • Contact Oreck Authorized Service Center. • Contact Oreck Authorized Service Center.
Vacuum still does not operate properly.	<ul style="list-style-type: none"> • Check all the above points. 	<ul style="list-style-type: none"> • Contact Oreck Authorized Service Center.

Parts

All accessories and replacement parts are sold separately. To order, call our customer service hotline or visit our website. Please have your model number from the data label on the bottom of the unit.

Accessories

Item	Part Number
Crystal Aroma® Carpet and Room Freshener	AROMAI1
Oreck Dry Carpet® Cleaning System	303110S

Replacement Parts

Item	Part Number
HEPA Odor Fighting Inner Bag, 6 Pack (For Magnesium Upright Vacuum Cleaner)	LWPK60H

Customer Service Hotline
USA: 1-800-989-3535
Canada: 1-888-676-7325
Website: www.oreck.com

Warranty



ORECK MANUFACTURING COMPANY: (Oreck Manufacturing Company gives you the following limited warranty for this product only if it was originally purchased for residential use, not resale, from Oreck or an Oreck Authorized Retail Dealer.)

Oreck will repair or replace, free of charge, to the original purchaser, any part that is found to be defective in material or workmanship within seven (7) years of the date of purchase. This limited warranty applies to normal domestic use. Any commercial use of this product will void this limited warranty.

This limited warranty does not cover the replacement of expendable or consumable parts such as carbon motor brushes, edge brushes, brushrolls, disposable inner bags and other parts subject to normal wear unless they are defective in material or workmanship.

This limited warranty does not apply to any part subjected to accident, abuse, commercial use, alteration, misuse, damage caused by an act of God, the use of voltages other than indicated on the serial number displayed on this product or service of this product by other than Oreck or a participating Factory Authorized Service Center. Oreck does not authorize any person or representative to assume or grant any other warranty obligation with the sale of this product.

Oreck's limited warranty is valid only if you retain proof of purchase from Oreck or an Oreck Authorized Retail Dealer for this product. If you purchase this product from any other source, your purchase is "AS IS," which means Oreck grants you no warranty, and that you, not Oreck, assume the entire risk of the quality and performance of this product, including the entire cost of any necessary servicing or repairs of any defects.

Oreck's liability for damages to you for any costs whatsoever arising out of this statement of limited warranty shall be limited to the amount paid for this product at the time of original purchase, and Oreck shall not be liable for any direct, indirect, consequential or incidental damages arising out of the use or inability to use this product. Some states do not allow the exclusion or limitation of incidental or consequential damages, so the above limitation or exclusion may not apply to you.

ALL EXPRESS AND IMPLIED WARRANTIES FOR THIS PRODUCT, INCLUDING IMPLIED WARRANTIES OF MERCHANTABILITY AND FITNESS FOR A PARTICULAR PURPOSE, ARE LIMITED IN DURATION TO THE WARRANTY PERIOD, AND NO WARRANTIES, WHETHER EXPRESS OR IMPLIED, WILL APPLY AFTER THIS PERIOD.

Some states do not allow limitations on the duration of implied warranties, so the above limitation may not apply to you.

This warranty gives you specific legal rights, and you may also have other rights which vary from state to state. If appropriate, see additional information for extended warranty.



© 2011 Oreck Holdings, LLC.

All rights reserved. All marks, text, logo's, product configurations and registered trademarks are owned and used under the authority of Oreck Holdings, LLC.

This product may be manufactured under one or more of the following patents:

US6,539,575; CA2,585,436; MX268228; US6,033,451 A; USRE38,842 E; CA2,335,860; GB1,091,680; EP1,091,680 B1; US7,024,724 B2; US7,258,709 B2; CA2,498,103; MX253069

And include the pending patents also language.

Subject to other patents pending.

83143-01 REV A 07/11 ECN# R-10525