



360° REACH™

Cyclonic Vacuum



1·2·3...

USER GUIDE

DDU03-E01



LET'S GO.™

WARNING

BASIC SAFETY PRECAUTIONS

- This vacuum cleaner is intended for household use only and NOT for commercial or industrial use.
- This vacuum cleaner does not stay upright without constant support, in between uses lie flat on the floor.
- Only use the vacuum cleaner indoors on dry surfaces and keep the area you're cleaning well lit.
- Keep fingers, hair and loose clothing away from moving parts and openings whilst using the vacuum cleaner.
- This vacuum cleaner can be used by children aged from 8 years and above and persons with reduced physical, sensory or mental capabilities or lack of experience and knowledge if they have been given supervision or instruction concerning use of the vacuum cleaner in a safe way and understand the hazards involved. Children shall not play with the vacuum cleaner. Cleaning and user maintenance shall not be made by children without supervision.
- Only Dirt Devil recommended tools should be used with the vacuum cleaner, use of non-branded Dirt Devil accessories/ tools will invalidate your guarantee.

DON'TS

- Don't use the vacuum cleaner if it has been dropped, damage or left outdoors.
- Don't run over the power cord or use vacuum cleaner if the power cord or plug is damaged. Please contact our Customer Care Line on: 0330 026 2626 (Mon-Fri 9:00am-5:00pm).
- Don't handle the plug or use the vacuum cleaner with wet hands.
- Don't pull or carry the vacuum cleaner by the power cord.
- Don't use the power cord as a handle, pull the power cord around corners, sharp edges or close a door over the power cord.
- Don't unplug the vacuum cleaner by pulling on the power cord.
- Don't vacuum up any flammable or combustible materials (lighter fluid, petrol, kerosene etc) or use the vacuum cleaner in an area with explosive vapours or liquid.
- Don't vacuum up hot coals, cigarette butts, matches or smoking hot burning items or use in an area where there may be harmful fluids (chlorine, bleach, and ammonia drain cleaner).
- Don't vacuum up hard or sharp objects such as glass, nails, screws or coins etc.



WARNING



DON'TS CONTINUED...

- Don't attempt to remove blockages with sharp objects as this may cause damage to the vacuum cleaner, remove blockages only as instructed in this guide.
- Don't use the vacuum cleaner with incorrect voltage as this may result in damage or injury to the user. The correct voltage is listed on the ratings label.

DO'S

- Turn off all controls on the vacuum cleaner before disconnecting or connecting the plug from the mains socket.
- Always keep the power cord away from brushes during use.
- Always make sure both the pre-motor/post-motor filters are in place before use.
- Take extra care when using the vacuum cleaner on the stairs.
- Always switch off the vacuum cleaner before disconnecting or connecting the reach wand and accessories.
- Keep all openings clear and free from debris as this may affect the airflow/suction.
- Always replace the fuse in the plug with a British 13amp fuse.
- Always protect the power cable from heated surfaces and open flames.
- Use only CE approved 13amp extension cords, non-approved extension cords may overheat. Care should be taken to arrange the extension cord as it can be a trip hazard.
- Store the vacuum cleaner in a cool, dry area. If the filters have been cleaned as per user the guide instructions ensure they are thoroughly dry before storing away.
- Take extra care when using the vacuum cleaner on the stairs
- Use only CE approved 13amp extension cords, non-approved extension cords may overheat. Care should be taken to arrange the extension cord as it can be a trip hazard.

PLEASE KEEP INSTRUCTIONS FOR FURTHER USE.

HI. WELCOME.

Congrats on purchasing your new 360° REACH™ cyclonic vacuum. Inside, you'll find everything you want to know from tools to how to.

So what are you waiting for? LET'S GO.™



PRODUCT REGISTRATION

Guarantee Registration

Be sure to register your product online at www.DirtDevil.co.uk

Hint: Attach your sales receipt to this User Guide. Verification of date of purchase may be required for warranty service of your Dirt Devil® product.

For quick reference, please record your product information below.

Model #: _____

Serial number : _____

(serial number located on the back or bottom of product)

Find GENUINE Replacement Parts at www.DirtDevil.co.uk

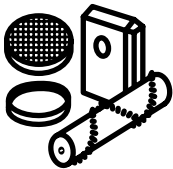

This product uses the following parts:

POST-MOTOR FILTER

PRE-MOTOR FILTER

TABLE OF CONTENTS



1·2·3...

Quick Start Assembly 6

How to 8

Tools 16



Troubleshooting 18



Limited Guarantee 19

QUICK START

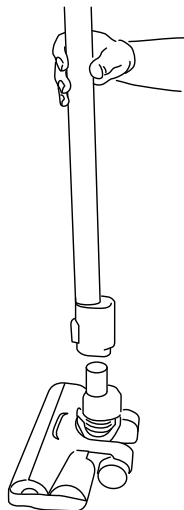

1

Push the reach wand down onto the powered head until it clicks into place.

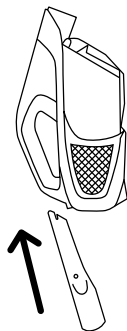

2

Slide the crevice tool into the crevice tool holder inside the handheld handle.

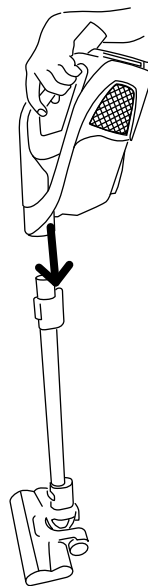

3

Push the handheld down onto the reach wand until it clicks into place.

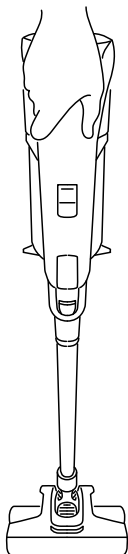

4

Push the handle forward to lock the reach wand and powered head into the upright position.

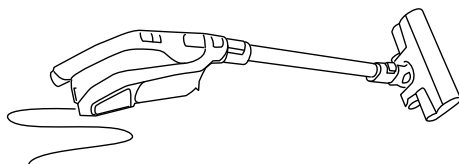

5

The upright stick vacuum cleaner is not free standing, in between uses lie flat on the floor.

**YOUR 360° REACH™
CYCLONIC VACUUM
IS READY TO CLEAN!**

LET'S GO.™



NEED HELP?

Go to www.DirtDevil.co.uk or contact our Customer Service Department at 0330 026 2626 (Mon-Fri 9:00am to 5:00pm)

HOW TO

USE AS A HANDHELD VACUUM CLEANER

1. Press the handheld release clip. Pull and separate the handheld from the reach wand.

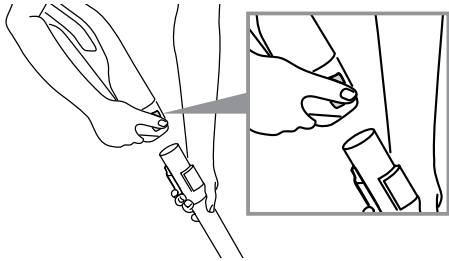

2. The reach wand and powered head are not free standing. Place safely and securely to one side.

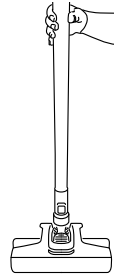

3. Pull and slide the crevice tool out of the crevice tool holder, if you need it.

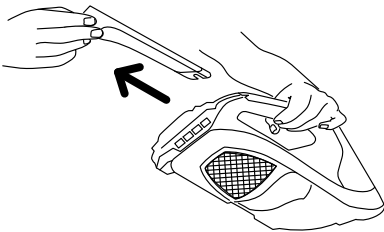

4. Push the crevice or upholstery tool into the handheld until it clicks into place.

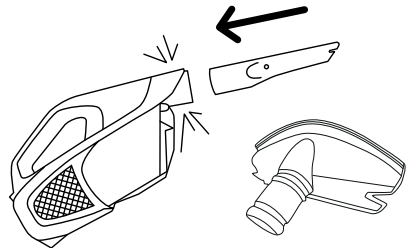

5. Plug into mains and slide the On/Off and brushbar control forward once (I).

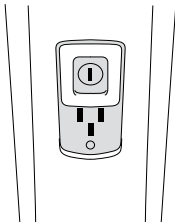

6. The crevice tool can be turned to a desired angle for easier cleaning.

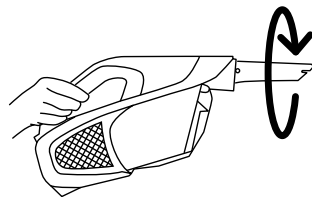

! **IMPORTANT:** Always switch off the vacuum cleaner before attaching/detaching the accessories. Always take extra care when using the vacuum cleaner on the stairs.

HOW TO

⚠ CAUTION

This vacuum cleaner has a constantly rotating brushbar when carpet mode (II) has been selected. When turned on never leave the vacuum cleaner in one spot for an extended period of time as this may damage the floor surface. The power head brush should be ON (II) for carpets and OFF (I) for hard floors.

USE AS A STICK VACUUM CLEANER

1. Plug into the mains and place your foot on the powered head. Pull the handle backwards to recline.

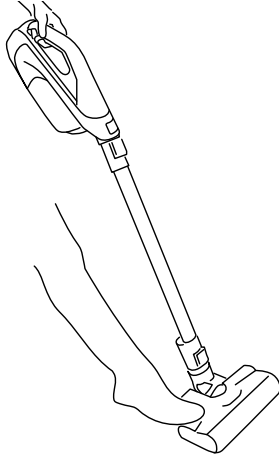

2. Slide the On/Off and brushbar control -
0 = Off
I = The brush on the powered head will NOT spin - for hard floor cleaning
II = The brush will spin and a green light on the powered head will illuminate - for carpet cleaning

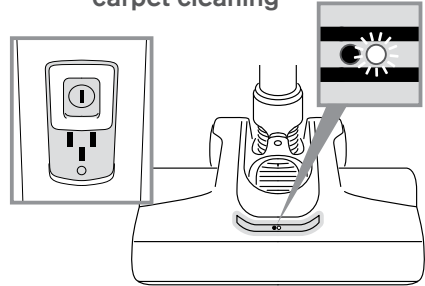

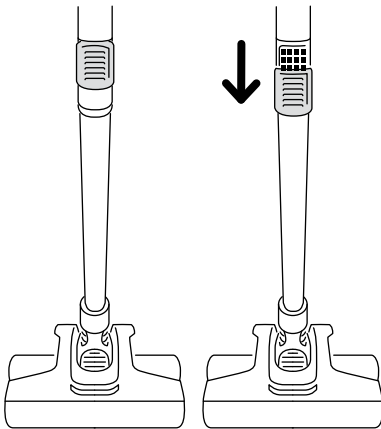

3. Slide the air vent open on the reach wand to reduce suction if required.

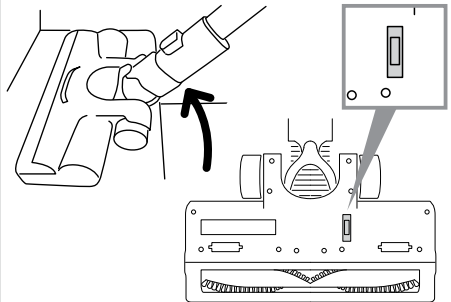

LOCK THE POWERED HEAD INTO POSITION (OPTIONAL)

Position the wand and powered head to the preferred cleaning angle. Push the eco lock towards the neck of the powered head to lock position. This will make the neck of the powered head less flexible.



 **TIP:** For most efficient results, the air vent should be closed.

HOW TO



CAUTION

Unplug and switch off the vacuum cleaner before performing maintenance or troubleshooting checks.

EMPTY AND CLEAN THE DIRT CONTAINER...

1. Press the handheld release clip. Pull and separate the handheld from the reach wand/crevice/ upholstery tool.
2. Place the reach wand and powered head safely and securely to one side, lie flat on the floor.

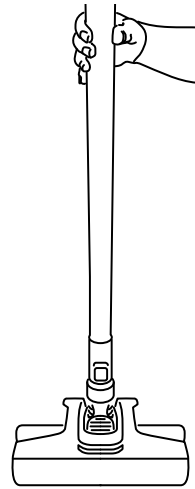
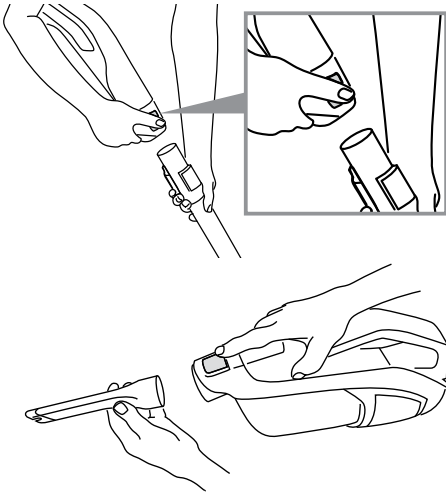

3. Hold the handheld over a bin, press the dirt release button allowing dirt/debris to fall out.

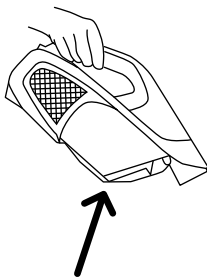

PRESS

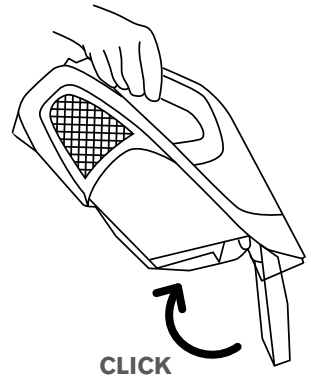

CLICK



TIP: Don't over fill the dirt container to avoid blocking the air flow through the vacuum cleaner and replace filters every 6-9 months.

HOW TO

⚠ CAUTION

For best cleaning results, filters should be tapped over a bin every 4-6 uses to remove dirt and debris and washed every 3 to 6 months.

CLEAN THE PRE-MOTOR FILTERS

1. Press the dirt container release button, pull the dirt container to remove.

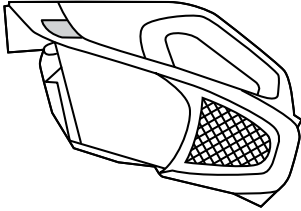

2. Twist clockwise and pull filter frame out.

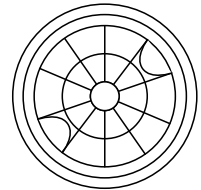
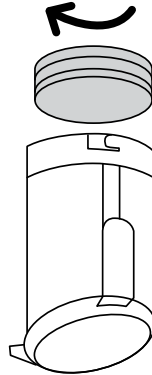

Top view
of Pre-Motor
filter

3. Separate the pre-motor filter. Tap filters over a bin to remove any dirt/debris. Wash the filters under running water (40° max).

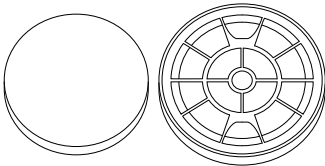

4. Leave for 24hrs or until fully dry before replacing.



5. Line up the pre-motor filter with the tabs in the dirt container. Twist anti-clockwise until the filter locks into place.

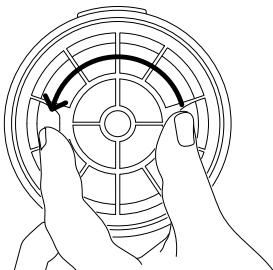

6. Tilt the dirt container and line up onto the handheld. Push the dirt container into handheld until the tab on the dirt container clicks into place.

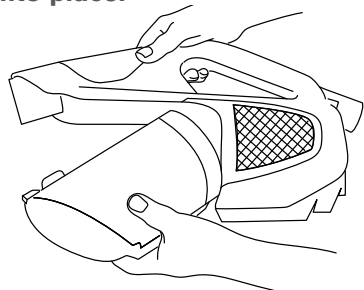

HOW TO

CLEAN THE POST MOTOR FILTER

1. Press the post-motor filter cover release button and rotate out.

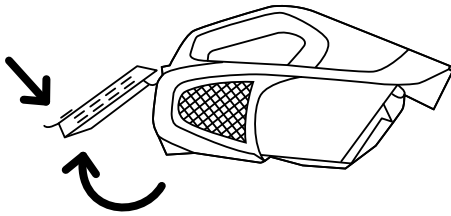

2. Rinse with water from both sides and let dry for 24 hours or until completely dry.

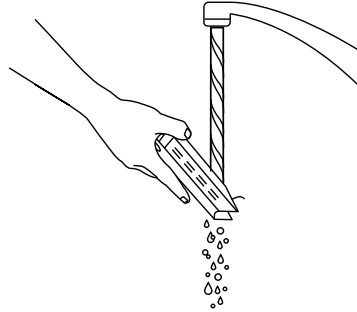

3. Put the dry filter back and click into place.

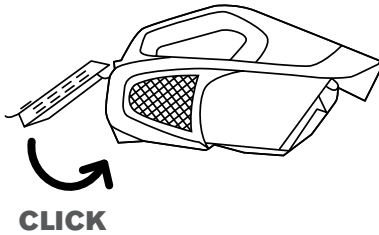

HOW TO

CLEAN THE SHROUD AND SEPARATOR

1. Press the Dirt Cup release button.

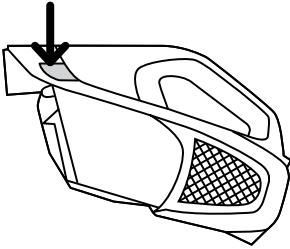

2. Twist clockwise and pull the Filter Frame out.

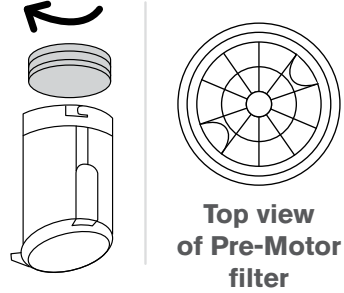

3. Pull out the separator and shroud, wipe it clean.

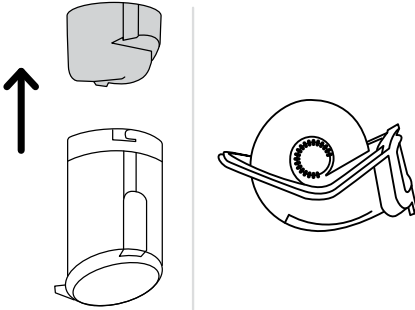

4. Line up the shroud and dirt container correctly. Incorrect fitting of the shroud will reduce suction and may also damage the machine.

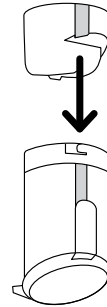

5. Put the filter back in by aligning the tabs and twist anti-clockwise into place.

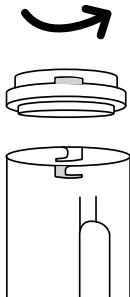

HOW TO

CAUTION

This vacuum cleaner is not free standing and should be disassembled before storing.

REMOVE BLOCKAGES FROM POWERED HEAD

1. Using scissors remove any threads or hair from around the brushbar and clear any dirt or debris from powered head.

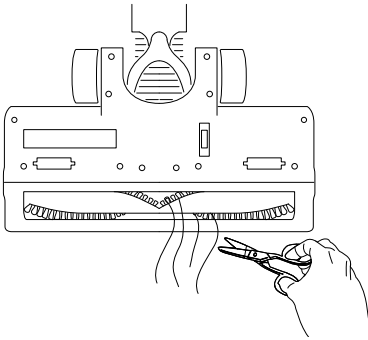

REMOVE BLOCKAGES FROM REACH WAND

1. To test for a blockage in the reach wand, look through the wand to check if it is clear. Use a broom handle or similar blunt object to remove any blockage.

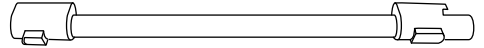

RESET THE POWERED HEAD

1. The red light on the powered head will illuminate to indicate there is a blockage. Switch the vacuum cleaner off and clear the blockage.
2. Reset the powered head by turning the power back on to position II after the blockage has been cleared. The brush will spin and a green light on the powered head will illuminate.

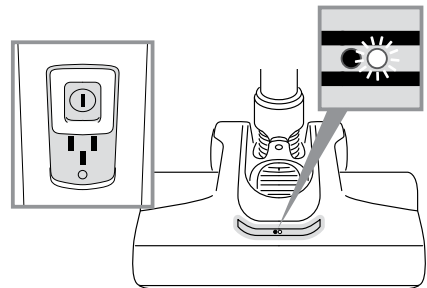
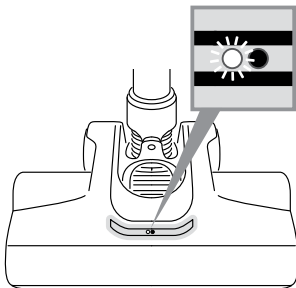

HOW TO

STORE YOUR UPRIGHT STICK VACUUM CLEANER

1. Press the handheld release clip. Pull and separate the handheld from the reach wand.

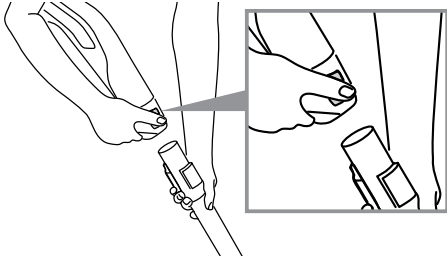

2. Press the powered head release clip and pull to remove the powered head.

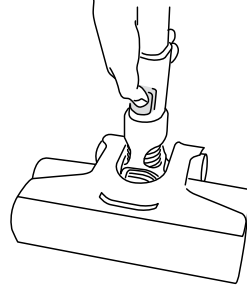

3. Slide the crevice tool into the crevice tool holder inside the handheld handle.

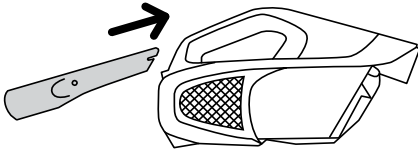

4. Wrap the power cord around the handheld, the crevice tool and tabs on dirt container will hold the power cord in place.

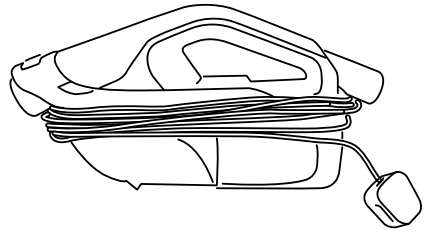

5. Store your vacuum cleaner disassembled in a cool, dry place.

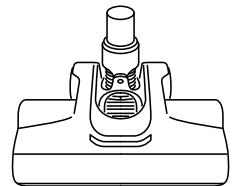
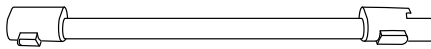
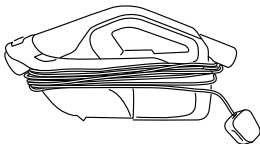

TOOLS

⚠ CAUTION

To avoid injury, particularly to face and head, keep hair, loose clothing, fingers, and all parts of the body away from revolving brush.

1. Press the powered head release clip and pull to remove the powered head.

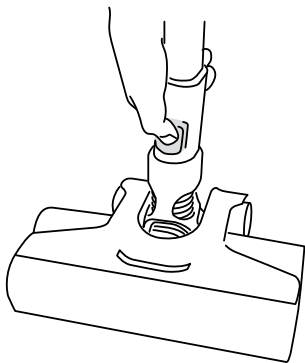

2. Pull and slide the crevice tool out of the crevice tool holder.



3. Push the tool into the reach wand until it clicks into place. The crevice tool can be turned to a desired angle for easier cleaning.

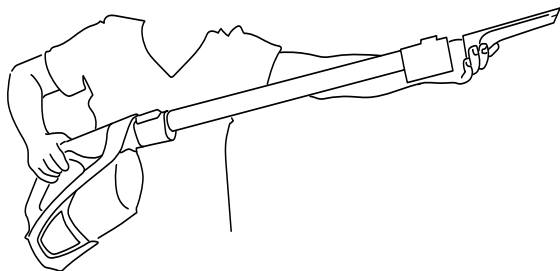

4. Plug into mains and slide the On/Off and brushbar control forward once (I).

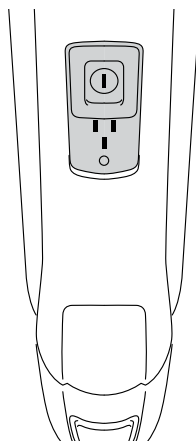

⚠ **IMPORTANT:** Always switch off the vacuum cleaner before attaching/detaching the accessories.

TOOLS

⚠ CAUTION

Not to be used for grooming a pet.

⚠ WARNING

To reduce the risk of personal injury -
Unplug before cleaning or servicing.

5. The reach wand can be used for hard to reach places.

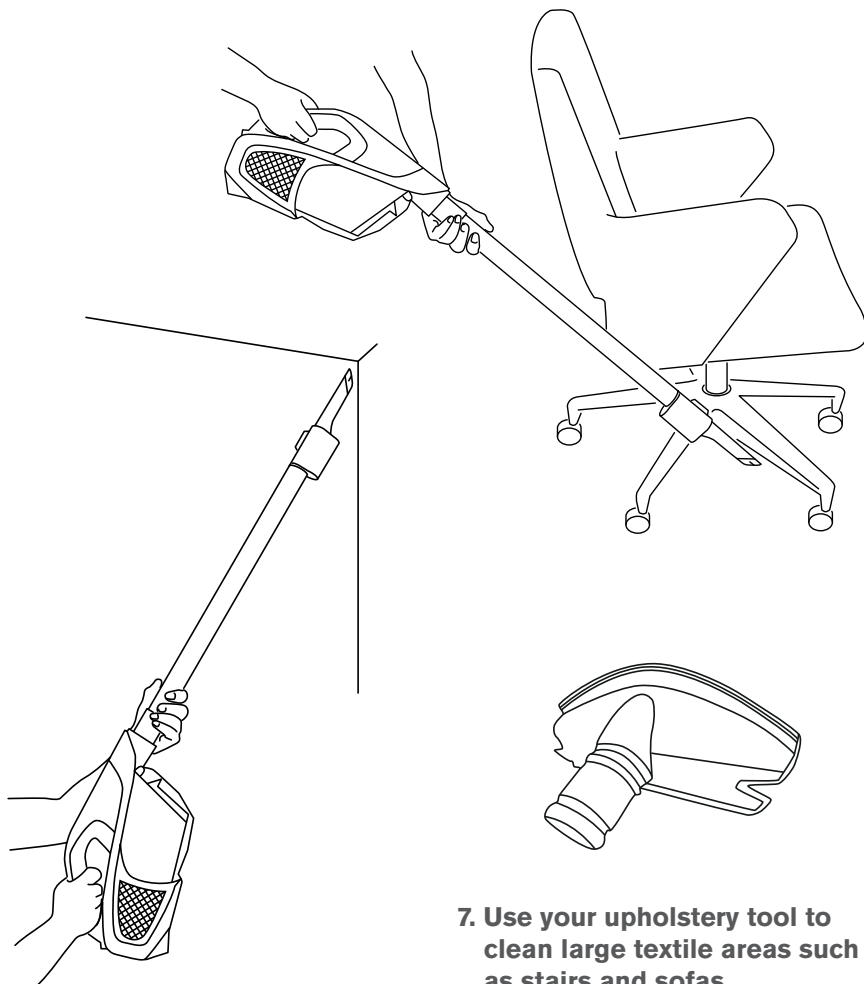

7. Use your upholstery tool to clean large textile areas such as stairs and sofas.

⚠ **IMPORTANT:** The reach wand vacuum cleaner is not free standing; in between uses lie flat on the floor.

TROUBLESHOOTING

PROBLEM	POSSIBLE CAUSE	POSSIBLE SOLUTION
Why does my vacuum cleaner have no power?	The plug may not be fully pushed into the electrical socket.	Check the fuse in the plug if this needs replacing, always replace with a British 13amp fuse.
	The motor thermostat may have tripped.	If this has happened, unplug the vacuum cleaner. Remove and empty the dirt container and check the reach stick for blockages. Clean the filters and allow the vacuum cleaner to cool for approximately 1 hour (if you have washed the filters you will need to wait 24 hours for the filters to fully dry before putting them back into the vacuum cleaner).
Why won't the vacuum cleaner pick up?	The dirt container may not be correctly fitted.	Remove the dirt container from the vacuum cleaner and check it's locked into place.
	The shroud is not correctly fitted.	Go to 'How to clean shroud and separator'.
	The filters may be clogged, clean the filters.	Go to 'How to clean pre and post motor filter'.
	The dirt container may be blocked.	Empty the dirt container. Go to 'How to empty and clean the dirt container'.
	The brush on the powered head has not been activated.	Activate the powered head. Go to 'How to use as a stick vacuum cleaner'.
	There maybe a blockage in the reach wand.	Remove the blockage. Go to 'How to remove a blockage in the reach wand'.
Why won't the Powered head brush turn?	The powered head brush has not been activated.	Activate the powered head. Go to 'How to use as a stick vacuum cleaner'.
	The powered head may be blocked.	Clear blockage. Go to 'How to clean a blockage from the powered head'.
	The powered head has not been re-set.	Reset powered head. Go to 'how to reset the powered head'.
Why is dust escaping from the vacuum?	The filters may be clogged.	Clean filters. Go to 'How to clean pre and post motor filter'.
	The shroud and separator may be clogged.	Clean shroud and separator. Go to 'How to clean shroud and separator'.

GUARANTEE



LIMITED GUARANTEE

It's quick and easy to register for your free 1 year guarantee online at www.DirtDevil.co.uk.

**Please retain your original receipt for proof of purchase.
Please make a note of the serial number and model number of the product before calling.**



**Call our Customer
Service Department at
0330 026 2626**
Monday-Friday 9:00am to 5:00pm.

www.DirtDevil.co.uk

Dirt Devil, 2 Colmore Square, 38 Colmore Circus, Queensway, Birmingham, B4 6BN.



EEC Statement of Compliance: Manufacturer/EEC importer: Vax Ltd trading as Dirt Devil, hereby on our own responsibility, declare that the DDU03-E01 series is manufactured in compliance with the following Directives:
Safety: 2006/95/EC Low Voltage Directive. **EMC:** 2004/108/EC Electromagnetic Compatibility Directive.



Waste electrical products should not be disposed of with household waste. Please recycle where facilities exist. Check with your Local Authority or retailer for recycling advice.