

Nest of Tables

Assembly Instructions - Please keep for future reference

052 xx 6000

483/6524

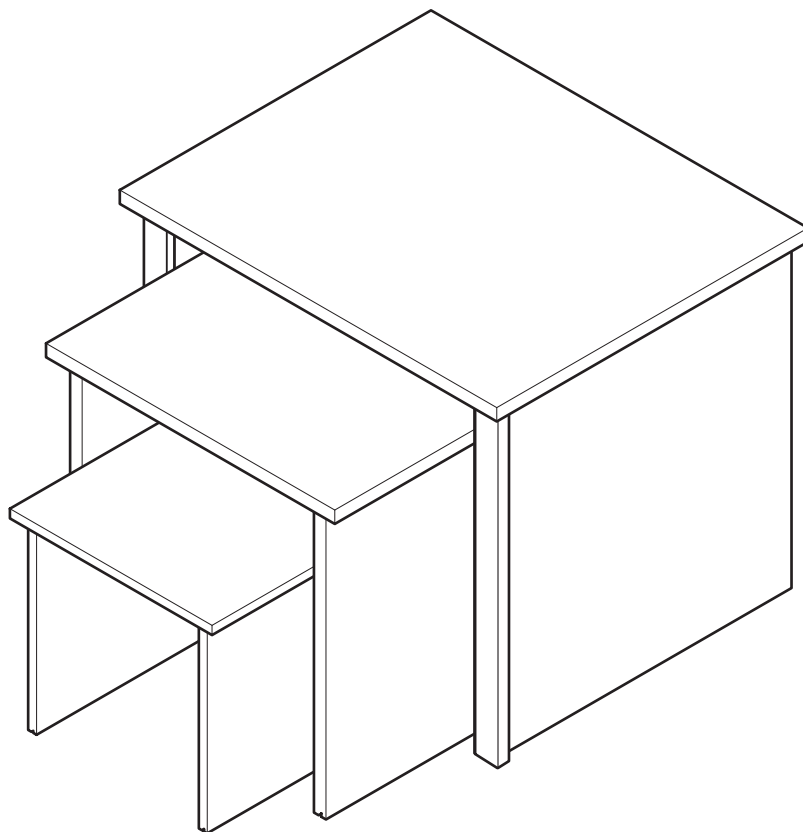

Dimensions

Width - 47cm

Depth - 38.8cm

Height - 40cm

Important - Please read these instructions fully before starting assembly

If you need help or have damaged or missing parts, call the **Customer Helpline: 01709 534123**
Please turn to back page for important information when contacting Customer Helpline.



Safety and Care Advice

Important - Please read these instructions fully before starting assembly

- Check you have all the components and tools listed on pages 2 and 4.
- Remove all fittings from the plastic bags and separate them into their groups.
- Keep children and animals away from the work area, small parts could choke if swallowed.
- Make sure you have enough space to layout the parts before starting.

- Do not stand or put weight on the product, this could cause damage.
- Assemble the item as close to its final position (in the same room) as possible.
- Assemble on a soft level surface to avoid damaging the unit or your floor.
- Parts of the assembly will be easier with 2 people.



• We do not recommend the use of power drill/drivers **for inserting screws**, as this could damage the unit. Only use hand screwdrivers.

• **Do Not dispose of packaging until assembly complete.**

• Dispose of all packaging carefully and responsibly when assembly complete.

Care and maintenance

- To protect the furniture, position the furniture out of direct sunlight and away from direct heat sources such as radiators and fires.
- Do not place the furniture in excessively dry and humid conditions.
- From time to time check that there are no loose screws on this unit.
- Always lift furniture when moving it (do not drag) otherwise the joints may be damaged.

- Do not place hot or cold objects on the surface, always use protective mats to avoid marking the furniture.
- This product should not be discarded with household waste. Take to your local authority waste disposal centre.
- Clean spills up immediately
- Dust surfaces with a soft, dry, lint free cloth.

- More stubborn marks can be removed using a damp (not wet) cloth. Wipe the surface dry immediately using a soft lint free cloth.
- Do not use detergents, abrasive cleaning products or cleaning products that contain ammonia, solvents or silicone as these may damage the surface finish.

Components - Panels



Please check you have all the panels listed below

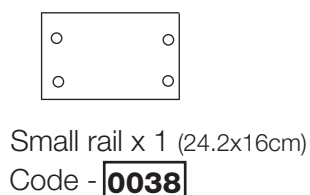
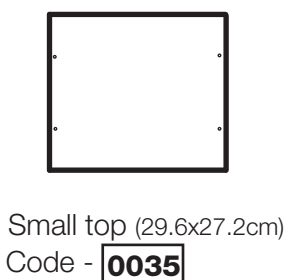
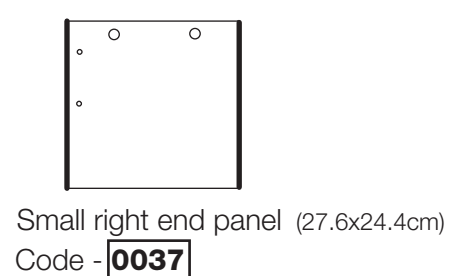
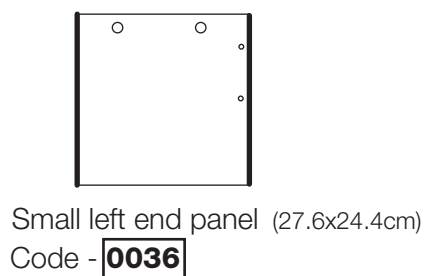
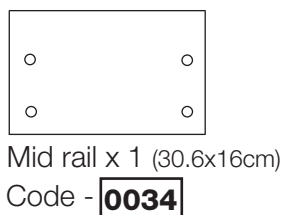
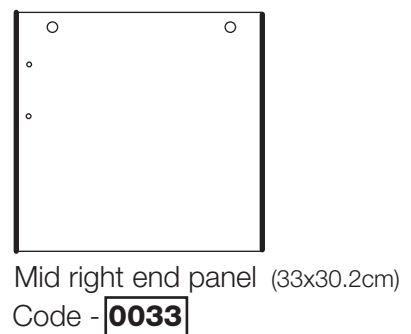
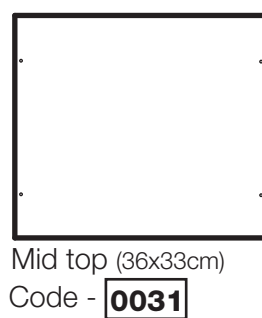
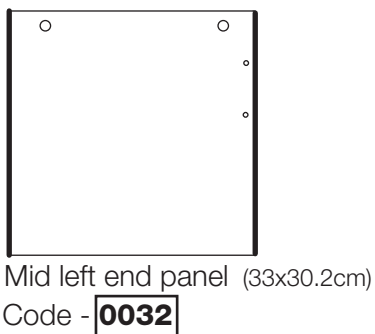
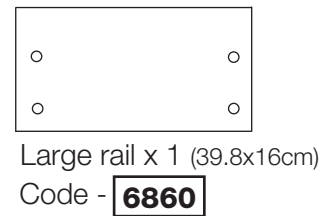
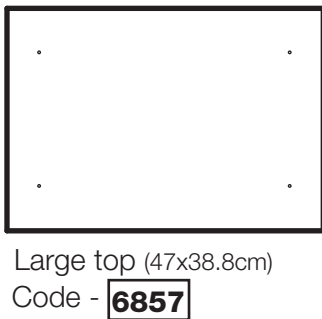
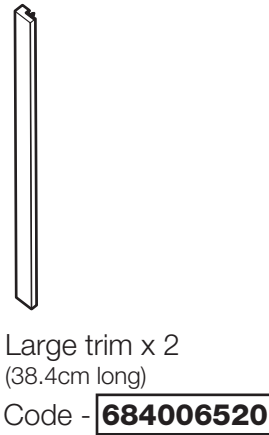
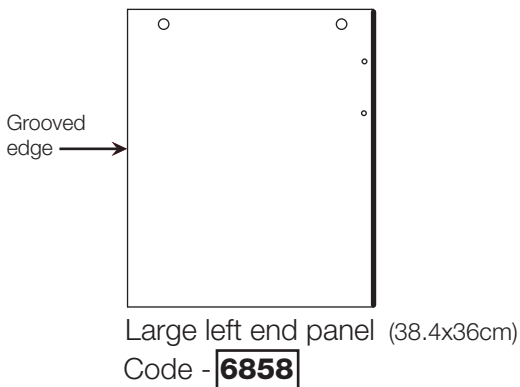

Important - Thick lines  indicate finished edges



Components - Exploded View

 **Important** - Thick lines  indicate finished edges

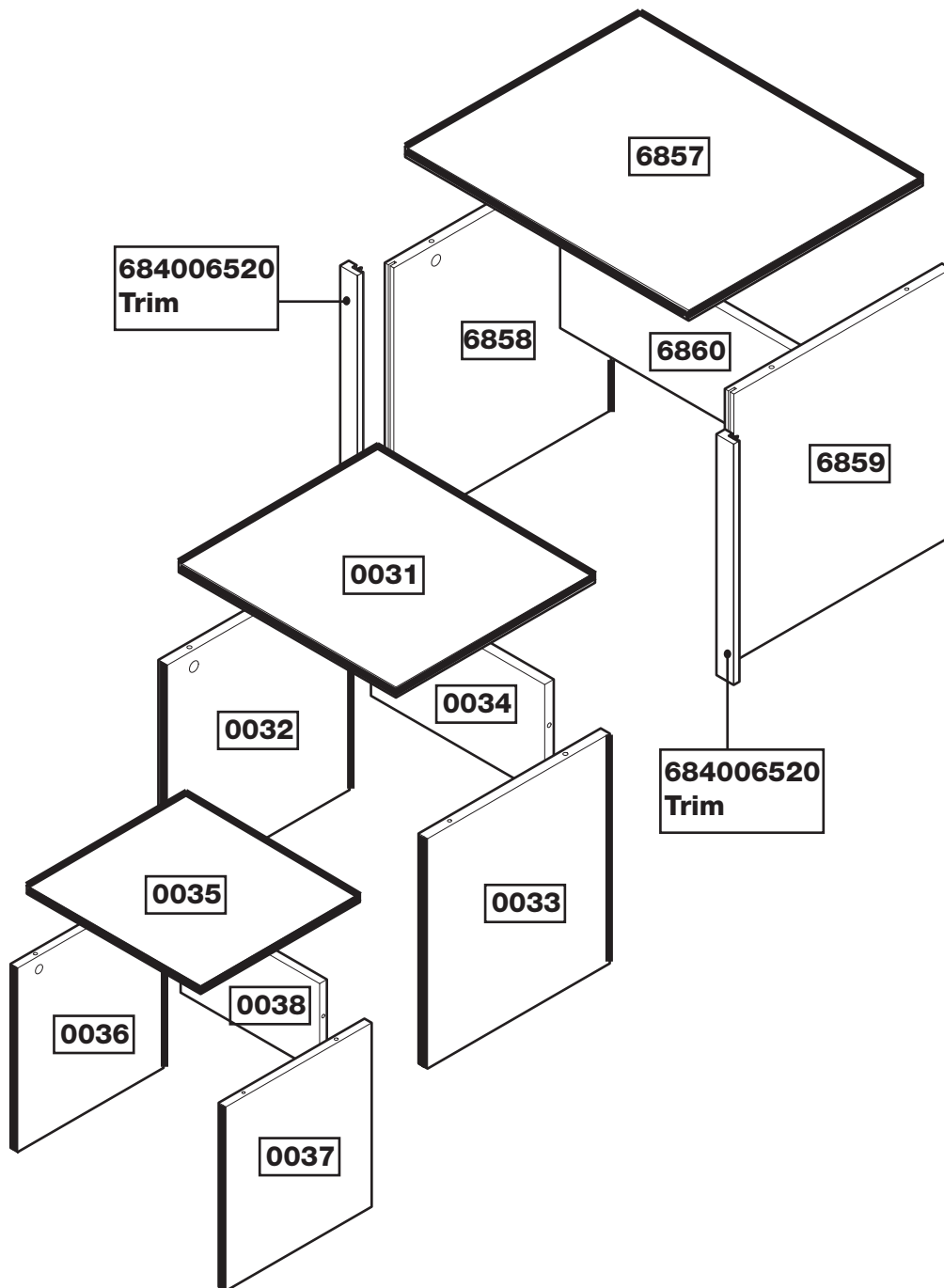

Components-Fittings

If you have damaged or missing components, call the **Customer Helpline: 01709 534123** Please turn to back page for important information when contacting Customer Helpline.

Please check you have all the fittings listed below

Note: The quantities below are the correct amount to complete the assembly, In some case more fittings may be supplied than are required.



A Large cam x 24 - Code 760001103



B Metal dowel x 24 - Code 760003004

Tools required

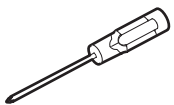

Cross headed screwdriver
(medium & large)

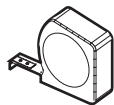

Tape Measure

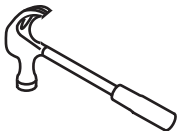

Small Hammer

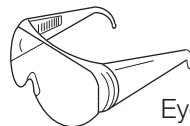

Eye protection
(when using a
hammer)

Ruler - Use this ruler to help correctly identify the screws

0 mm 10 20 30 40 50 60 70 80 90 100 110 120 130 140 150 160 170

Assembly Instructions

Step 1

Fitting dowels to tops

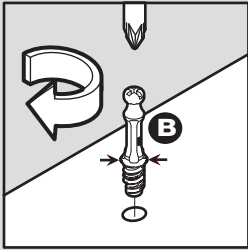

Note: Insert metal dowels **B** as far as shown by arrows.
Do not over tighten.

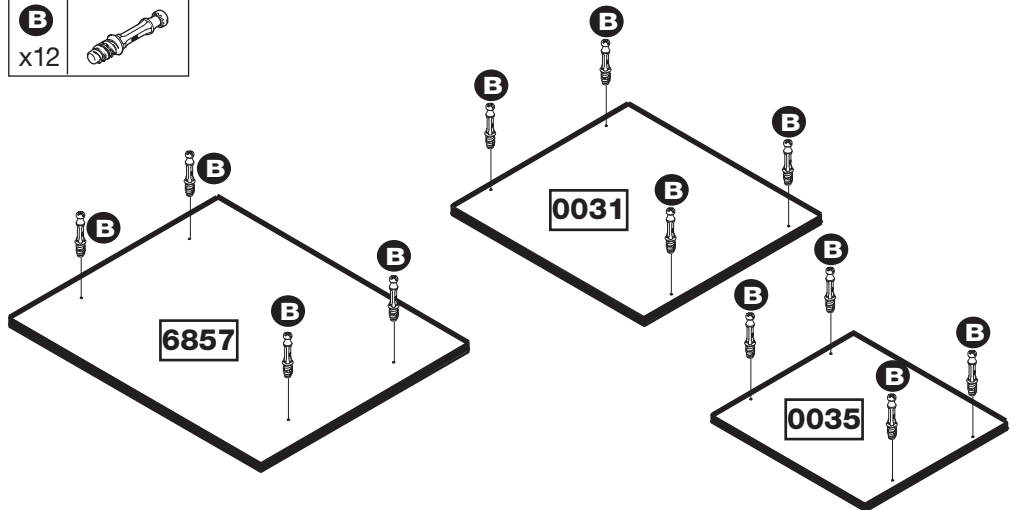

Step 2

Fitting cams to rails

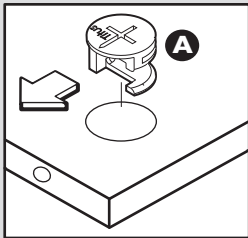

Note: Ensure cam arrow points towards the edge with hole.

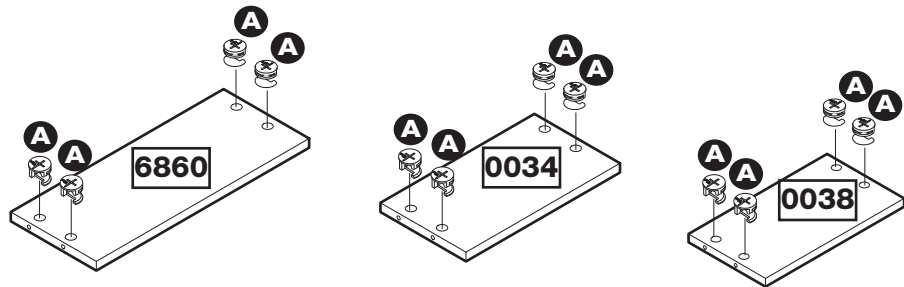
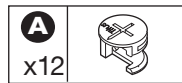

Step 3

Fitting cams and dowels to end panels.

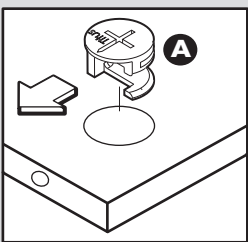

Note: Ensure cam arrow points towards the edge with hole.

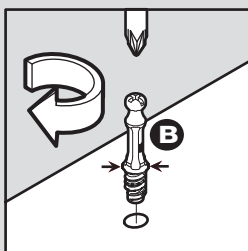

Note: Insert metal dowels **B** as far as shown by arrows.
Do not over tighten.

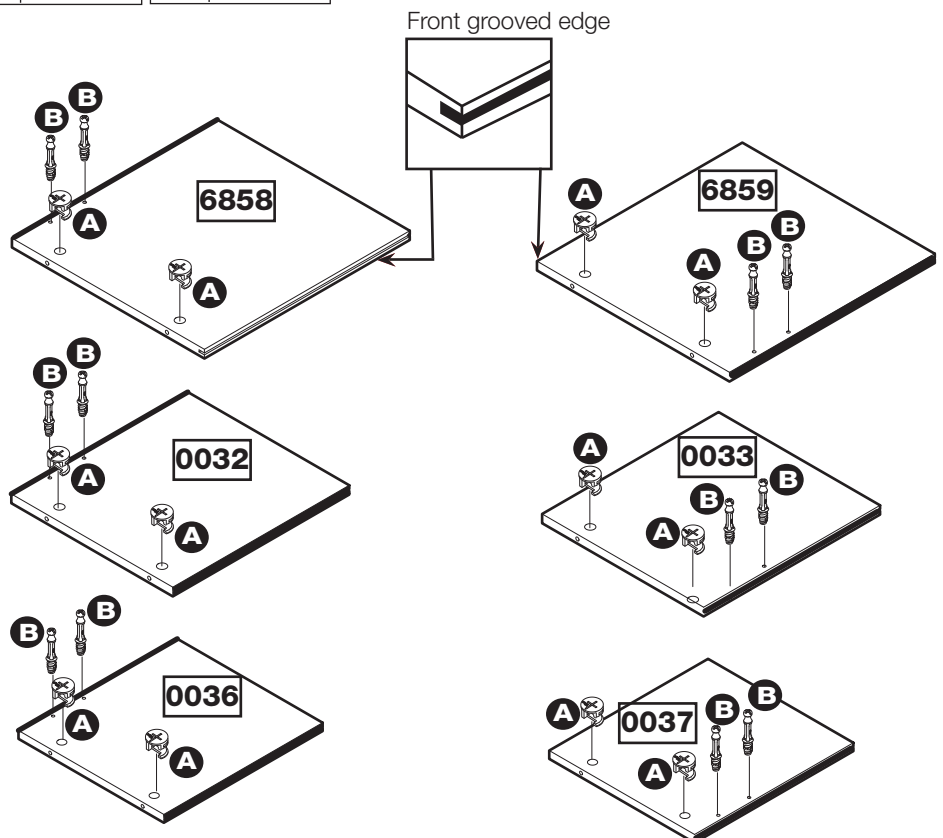

Assembly Instructions

Step 4

Assembly of large table

Insert dowels **B** in left **6858** and right **6859** end panels into cams **A** in rail **6860** then lock. Now insert dowels **B** in top **6857** into cams **A** in left **6858** and right **6859** end panels then lock.

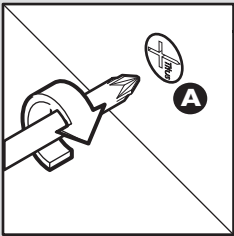

Turn cam 180 degrees to lock

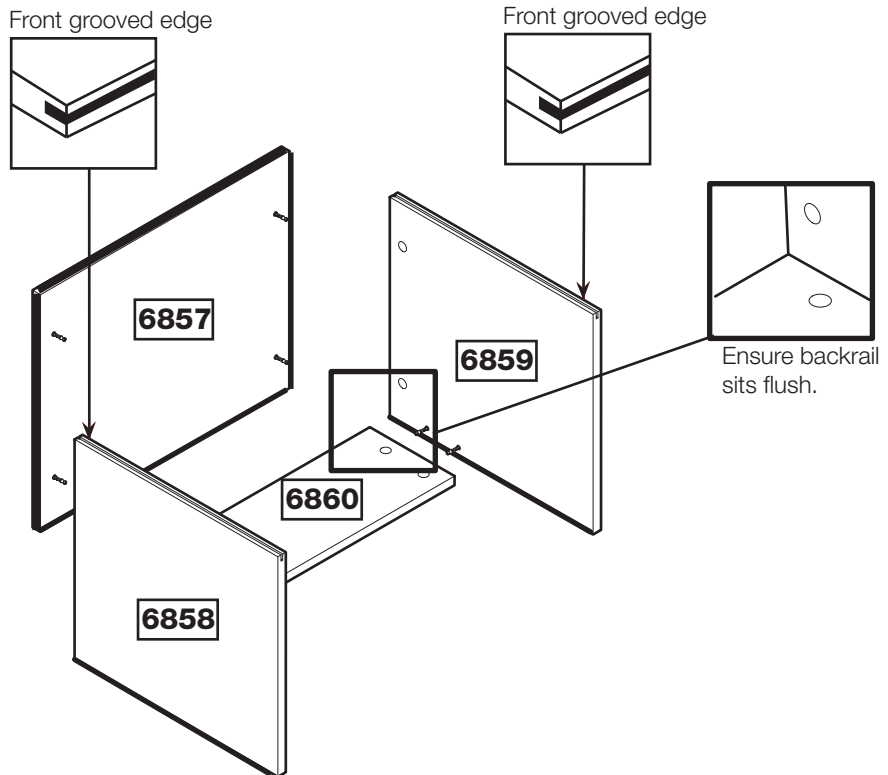

Step 5

Assembly of mid & small table.

Mid table.

Insert dowels **B** in left **0032** and right **0033** end panels into cams **A** in rail **0034** then lock. Now insert dowels **B** in top **0031** into cams **A** in left **0032** and right **0033** end panels then lock.

Turn cam 180 degrees to lock

Small table.

Insert dowels **B** in left **0036** and right **0037** end panels into cams **A** in rail **0038** then lock. Now insert dowels **B** in top **0035** into cams **A** in left **0036** and right **0037** end panels then lock.

Turn cam 180 degrees to lock

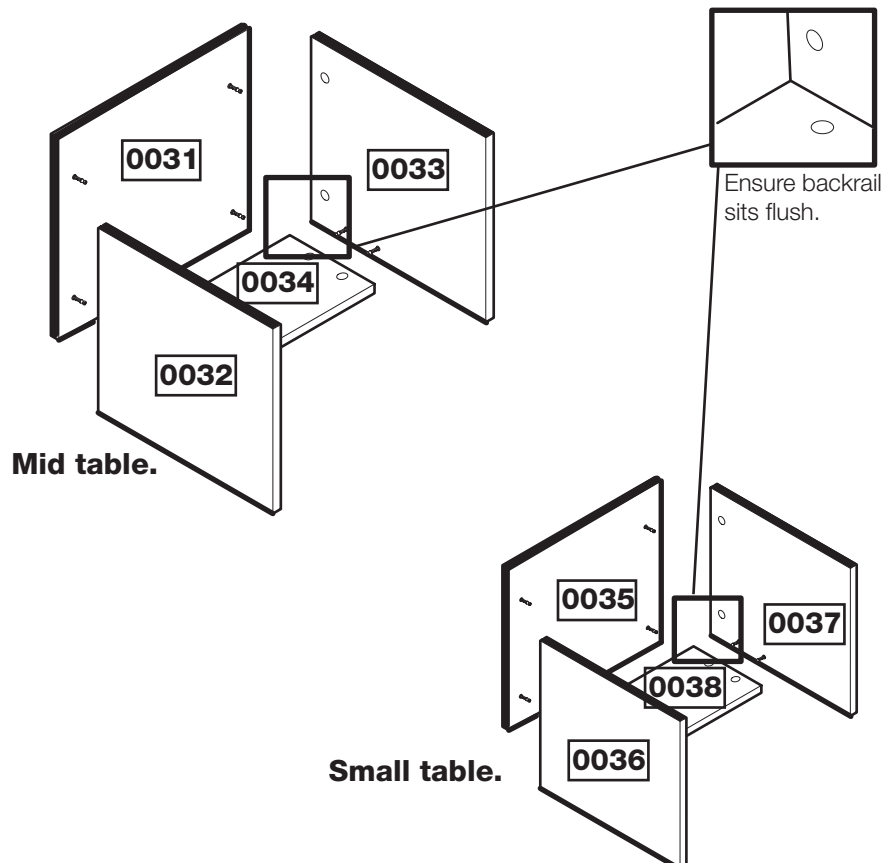

Assembly Instructions

Step 6

Attach silver trim

Remove protective film from silver trim.



Warning:

Lift with care.

Locate the notch on silver trim into groove on ends **6858** and **6859**.

Ensure the silver trims are positioned correctly (DIAG 1).

To insert silver trims use a hammer, place a cardboard packing piece between the hammer and silver trims to protect the silver trims (DIAG 1).

Ensure silver trims are inserted fully (DIAG 2).

Congratulations!
Your unit is complete.

Fittings you will need for this step:

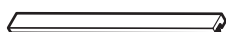

Large silver trims
(x2)

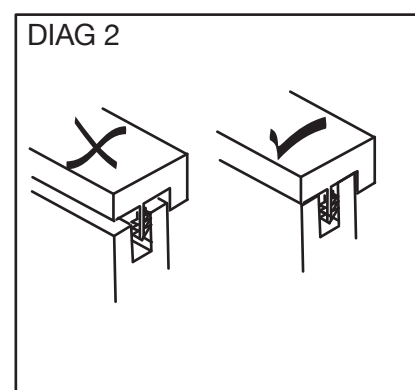
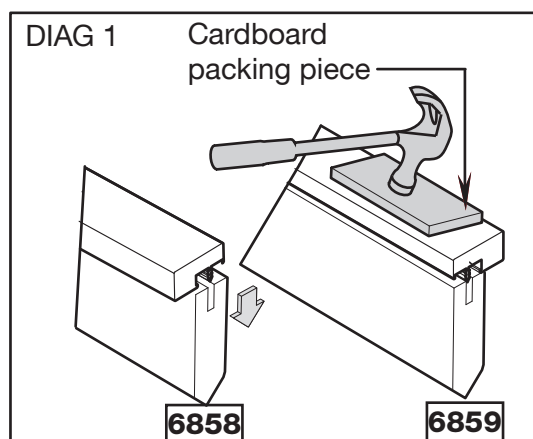
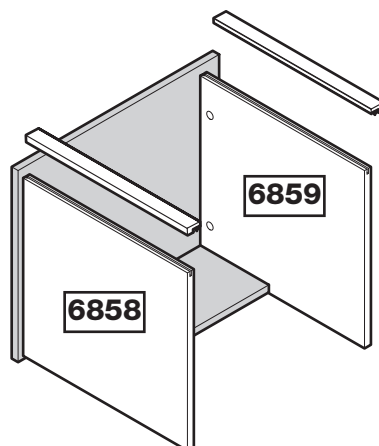

Important Information

If you need help or have damaged or missing parts, call the **Customer Helpline: 01709 534123**

Simply contact us on CUSTOMER HELPLINE : 01709 534123 Between 8am - 4.30pm Monday to Thursday and 8am - 2.30p.m friday. Your statutory rights are not affected.

Please have the following information: Unit Description, Product Code, Product Colour, Place of Purchase, Catalogue Ref. No., Item Code, and have the assembly instructions close to hand.

We do have an answer machine should you contact us out of office hours, so in addition to the above information could you leave your name, address, daytime telephone number and the nature of your call on the answerphone. All calls will be actioned asap.

You can also e-mail your requests to us at: customer.helpdesk@addspacefl.co.uk

Alternatively Write to us at: Customer Service Department, Addspace Furniture Limited, Braithwell Way, Hellaby Industrial Estate, Hellaby, Rotherham, South Yorkshire, S66 8QY.