

BRYCE DINING TABLE

habitat 

207580, 207581, 207582

BRY-TA-AW13-A

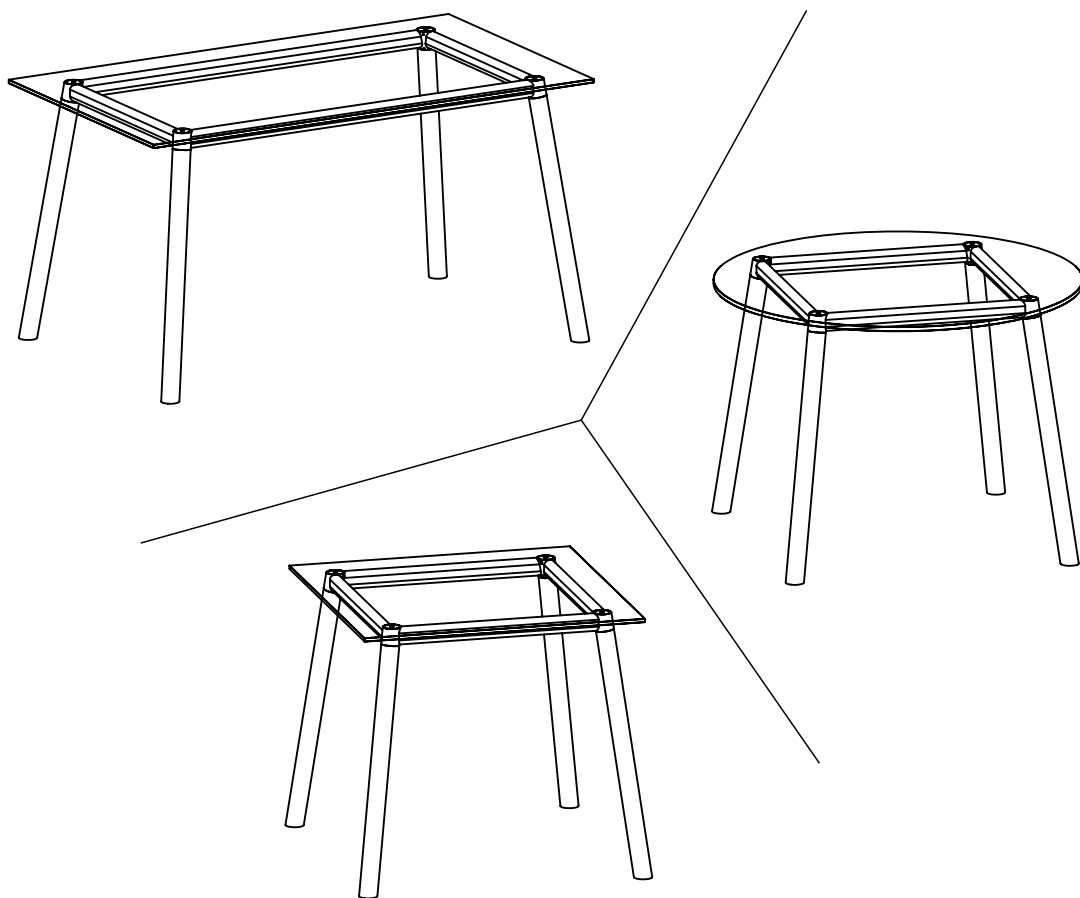

habitat 

Components

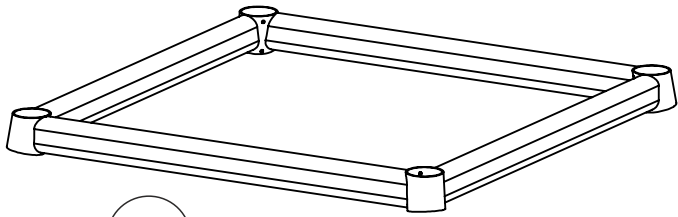

1

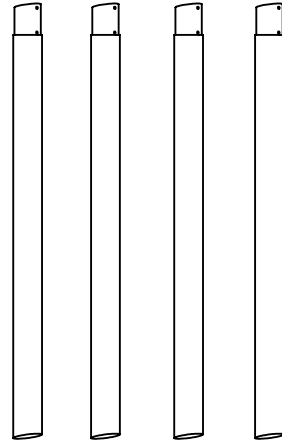

2 x 4

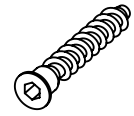

A x 8

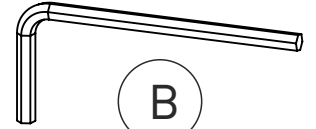

B

TOP GLASS versions

3

tempered glass
thickness 10mm

for square table

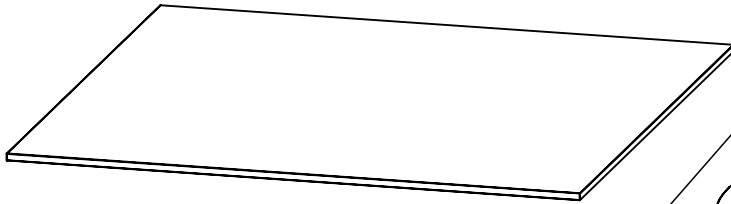

for round table

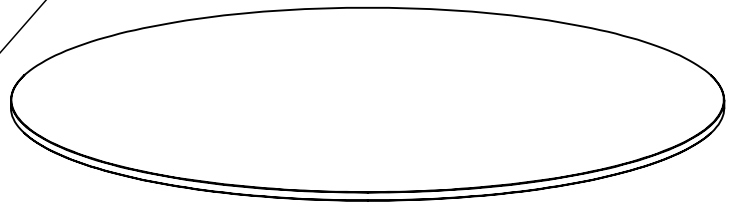

for long table

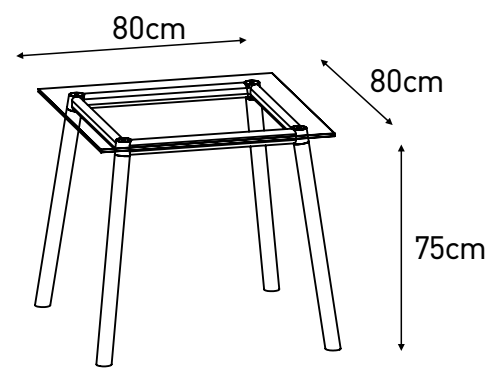
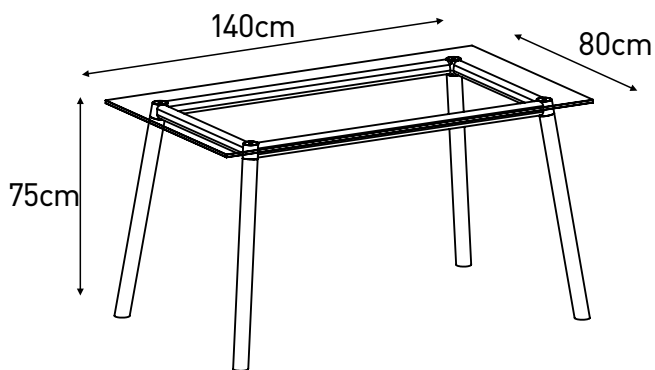
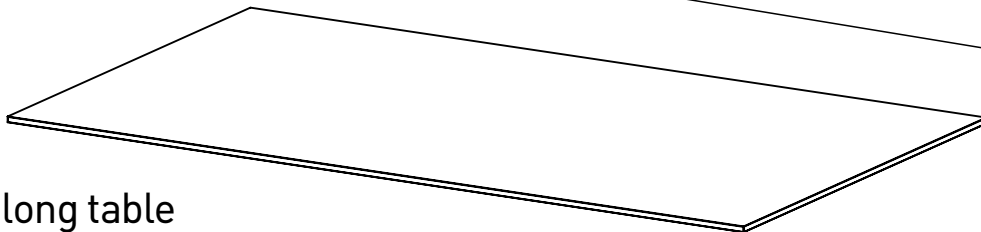

Assembly Instructions - Keep in a safe place for future reference

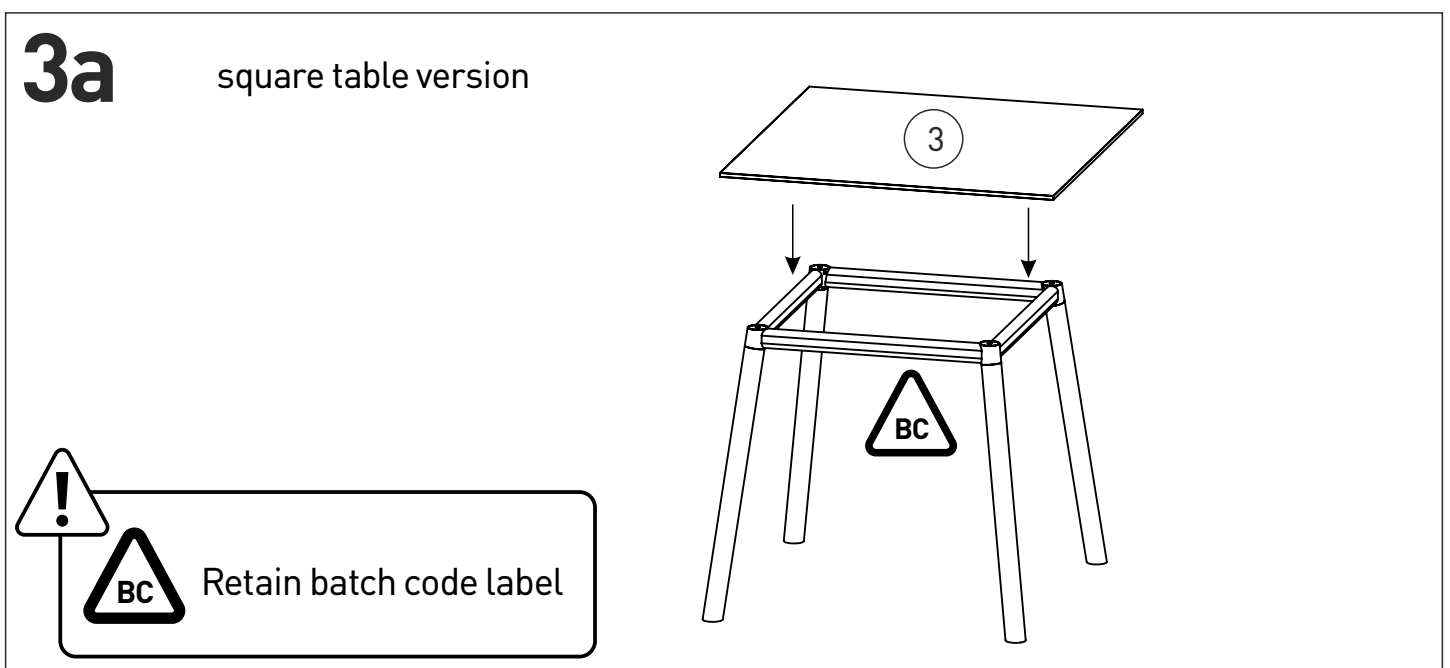
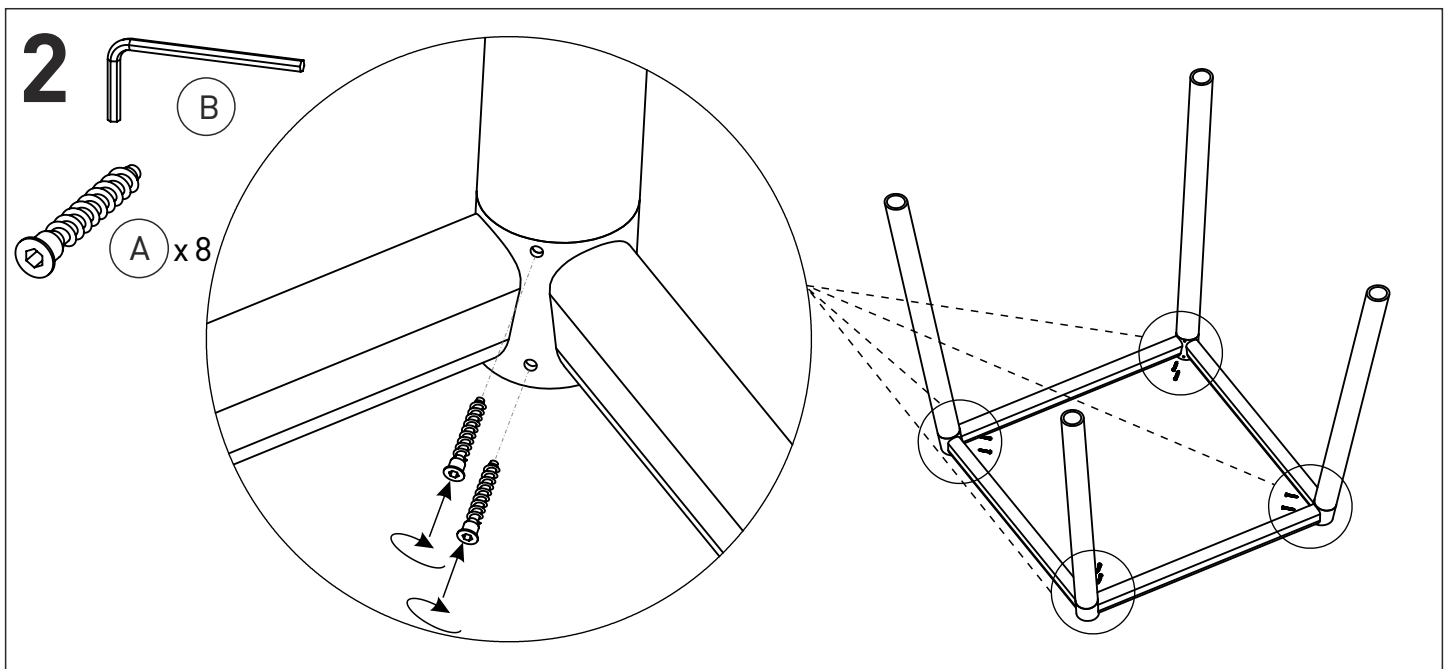
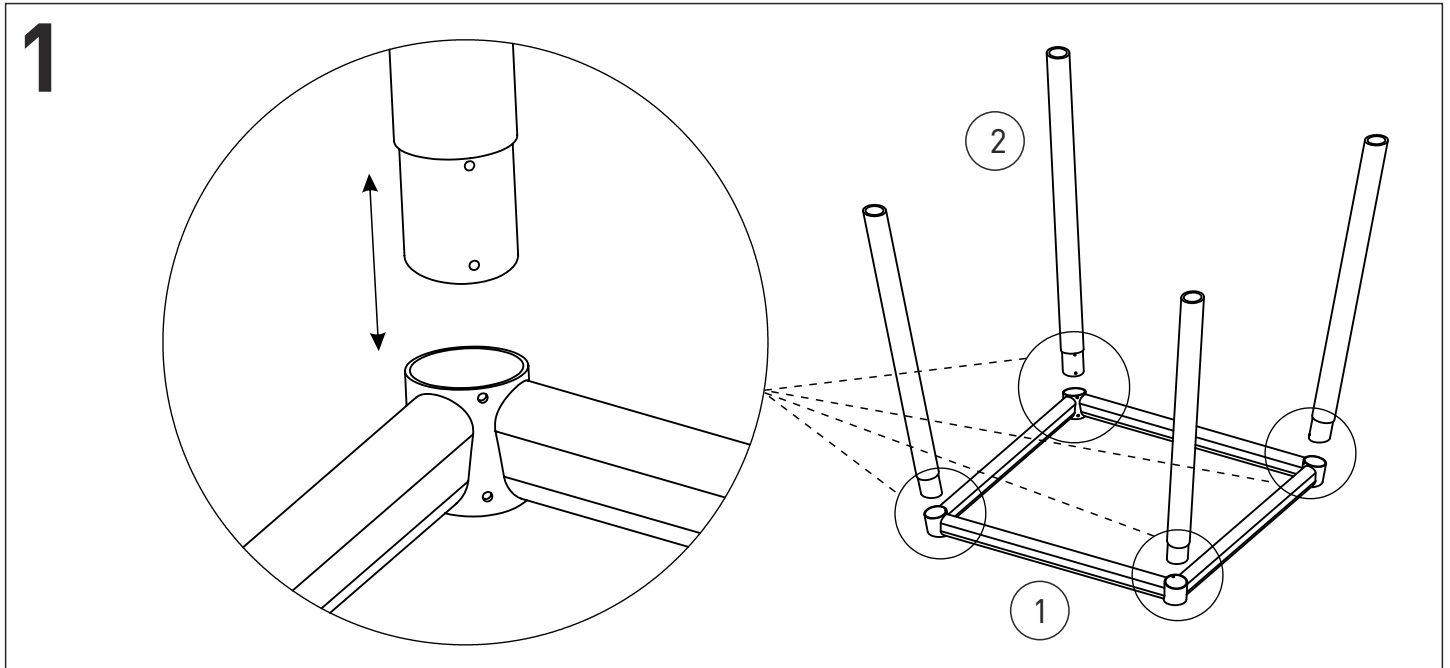

Assembly Instructions - Keep in a safe place for future reference

3b round table version

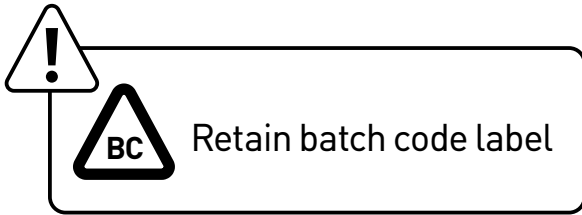
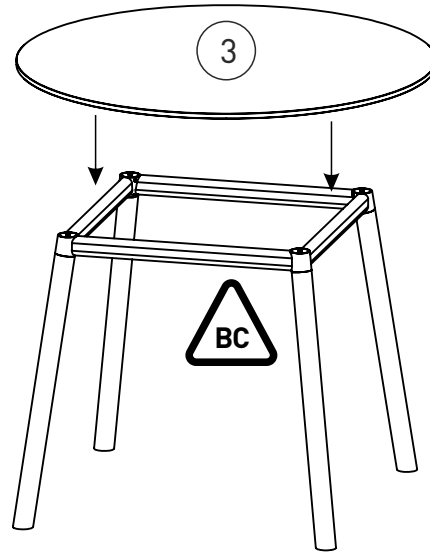

3c long table version

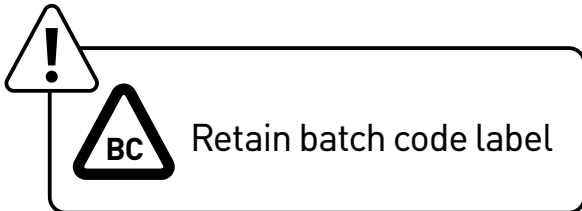
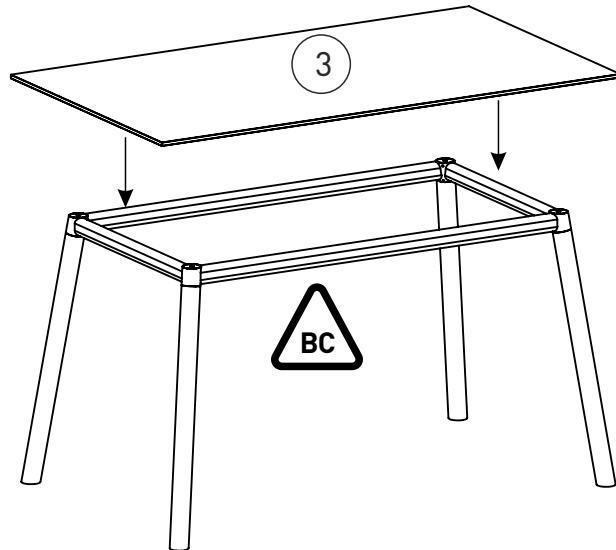

General Care Advice - please read carefully

Wood elements

We would recommend that you protect this furniture from spills - any spillage should be removed immediately to avoid staining by using a damp cloth, then wiping dry the surface with a clean dry duster. Repeat this procedure for periodic cleaning. The use of furniture polishes or sprays is not necessary or recommended.

Wood is a beautiful natural material. It is important to understand its unique properties which should not be mistaken for flaws.

Each piece will have a slightly different grain pattern. Variation in colour, shading and grain between different products and within the same product can occur. This is a normal feature of all natural wood furniture.

- Take care when moving furniture, dragging pieces across the floor will damage the joints.
- Take care to prevent sharp objects e.g. toys, buckles and heels from coming into contact with your furniture, and avoid contact with chemicals e.g. cosmetics or hair products which may permanently mark the surface.
- Avoid exposing your furniture to direct and prolonged periods of sunlight and heat sources as fading or cracking may result.

If your furniture becomes stained, scratched chipped or suffers other damage we would recommend professional help is sought to restore it.

Periodically check that there are no loose screws on the unit.

General Care Advice - please read carefully

Glass panel

Tempered glass has been treated by a special heating and quick cooling process to give it a greater weight capacity and strength. If it breaks it shatters into thousands of small cubes, rather than shards of glass.

When storing the glass top vertically we recommend that it is delicately placed on a soft surface such as carpet or wood (not concrete). This should prevent chipping.

WARNING

Do not sit or stand upon the glass surface(s).

Do not use the glass as chopping surface.

Do not strike the glass with hard or pointed items.

When cleaning glass panels use a damp cloth or leather with washing up liquid or soft soap if necessary, do not use washing powders or any other substance containing abrasives since these substances scratch glass.

If the glass is chipped or broken replace with glass of the type described on this label.

Consult the furniture manufacturer, retailer, or agent with regards to obtaining a manufacturing specification of shape for replacement glass quoting the model number, and batch number or date of manufacture of the table or trolley.

Keep these instructions for further use.

Do not place very hot or very cold items on the glass surface(s) unless adequately thick tablemats are used to prevent such items from coming into contact with the glass.

If for any reason you should have problems with your Habitat product please contact the store from which you purchased your product.

If you have any comments or suggestions regarding this product, assembly instructions or service received, please enquire at your nearest store or contact us on our website at:

www.habitat.co.uk or write to this address:

Habitat Retail Ltd. 489-499 Avebury Boulevard,
Milton Keynes MK9 2NW