

Panasonic®

Operating Instructions Home Theater Audio System

Model No. SC-HTE200

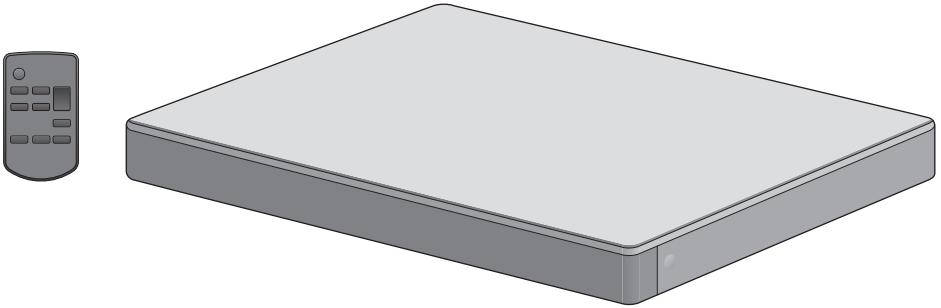

Thank you for purchasing this product.
Please read these instructions carefully before using this product,
and save this manual for future use.

VIERA Link

 **Bluetooth®**

Model number suffix “EB” denotes UK model.

EB EG

SQT0858-1

Safety precautions

WARNING

Unit

- To reduce the risk of fire, electric shock or product damage,
 - Do not expose this unit to rain, moisture, dripping or splashing.
 - Do not place objects filled with liquids, such as vases, on this unit.
 - Use only the recommended accessories.
 - Do not remove covers.
 - Do not repair this unit by yourself. Refer servicing to qualified service personnel.

AC mains lead

- To reduce the risk of fire, electric shock or product damage,
 - Ensure that the power supply voltage corresponds to the voltage printed on this unit.
 - Insert the mains plug fully into the socket outlet.
 - Do not pull, bend, or place heavy items on the lead.
 - Do not handle the plug with wet hands.
 - Hold onto the mains plug body when disconnecting the plug.
 - Do not use a damaged mains plug or socket outlet.
- The mains plug is the disconnecting device. Install this unit so that the mains plug can be unplugged from the socket outlet immediately.

Button-type battery (Lithium battery)

- Risk of fire, explosion and burns. Do not recharge, disassemble, heat above 60 °C or incinerate.
- Keep the Button-Type battery out of the reach of children. Never put Button-Type battery in mouth. If swallowed call your doctor.

CAUTION

Unit

- Do not place sources of naked flames, such as lighted candles, on this unit.
- This unit may receive radio interference caused by mobile telephones during use. If such interference occurs, please increase separation between this unit and the mobile telephone.
- This unit is intended for use in moderate climates.

Placement

- Place this unit on an even surface.
- To reduce the risk of fire, electric shock or product damage,
 - Do not install or place this unit in a bookcase, built-in cabinet or in another confined space. Ensure this unit is well ventilated.
 - Do not obstruct this unit's ventilation openings with newspapers, tablecloths, curtains, and similar items.
 - Do not expose this unit to direct sunlight, high temperatures, high humidity, and excessive vibration.

Button-type battery (Lithium battery)

- Danger of explosion if battery is incorrectly replaced. Replace only with the type recommended by the manufacturer.
- Insert with poles aligned.
- Mishandling of batteries can cause electrolyte leakage and may cause a fire.
 - Remove the battery if you do not intend to use the remote control for a long period of time. Store in a cool, dark place.
 - Do not heat or expose to flame.
 - Do not leave the battery(ies) in a car exposed to direct sunlight for a long period of time with doors and windows closed.
- When disposing of the batteries, please contact your local authorities or dealer and ask for the correct method of disposal.

Caution for AC Mains Lead



(For the AC mains plug of three pins)

For your safety, please read the following text carefully.

This appliance is supplied with a moulded three pin mains plug for your safety and convenience.

A 10-ampere fuse is fitted in this plug.

Should the fuse need to be replaced please ensure that the replacement fuse has a rating of 10-ampere and that it is approved by ASTA or BSI to BS1362.

Check for the ASTA mark  or the BSI mark  on the body of the fuse.

If the plug contains a removable fuse cover you must ensure that it is refitted when the fuse is replaced.

If you lose the fuse cover the plug must not be used until a replacement cover is obtained.

A replacement fuse cover can be purchased from your local dealer.

Before use

Remove the connector cover.

How to replace the fuse

The location of the fuse differ according to the type of AC mains plug (figures A and B). Confirm the AC mains plug fitted and follow the instructions below.

Illustrations may differ from actual AC mains plug.

1. Open the fuse cover with a screwdriver.

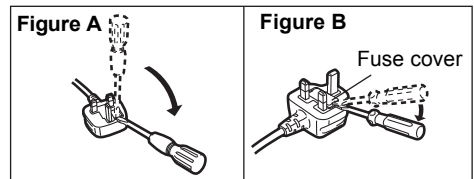

2. Replace the fuse and close or attach the fuse cover.

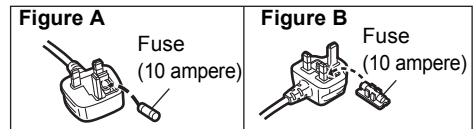

About descriptions in these operating instructions

- Pages to be referred to are indicated as "⇒ ○○".
- Labels on this unit and the remote control are indicated as [○○] in these operating instructions.
- The illustrations shown may differ from your unit.
- These operating instructions are applicable to model SC-HTE200 for variety of regions. Unless otherwise indicated, illustrations in these operating instructions are of the model for the United Kingdom and Ireland.
- Operations in this operating instructions are described mainly with the remote control, but you can perform the operations on the main unit if the controls are the same.

Table of contents

Safety precautions	2
Caution for AC Mains Lead	3

Before use

Supplied items.....	5
This system (SC-HTE200)	5
Accessories	5
Control reference guide.....	6
This system (Front)	6
This system (Rear)	6
Remote control	7

Getting started

Connections	8
Connection with the TV	8
Connection from an HDMI compatible device	9
Connection from an other device (AUX)	10
AC mains lead connection	10
Placement	11
Safety precaution	11
Preventing tipping	12
Bluetooth® connection.....	13
Bluetooth® pairing	13
Connecting a paired Bluetooth® device	13
One-Touch Connection (Connecting by NFC)	13
Remote control code	14

Operations

Using this system	15
3D sound	16
Sound menu	16
Audio format	17
Setup menu	18
Linked operations with the TV (VIERA Link “HDAVI Control™”).....	19

Reference

Troubleshooting	20
About Bluetooth®	23
Unit care	23
Licenses	23
Specifications	24

Supplied items

This system (SC-HTE200)

- 1 Main unit (speaker)
(SC-HTE200)

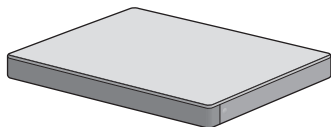

Accessories

Check the supplied accessories before using this system.

- 1 Remote control
(with a battery)
(N2QAYC000098)



- 1 AC mains lead
For the United Kingdom and Ireland
(SFQ0018)

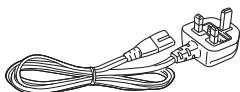

- For Continental Europe
(SFQ0016)

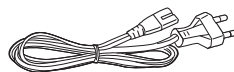

- Product numbers are correct as of March 2015. These may be subject to change.
- The supplied AC mains lead is for use with this system only.
Do not use it with other equipment. Also, do not use cords from other equipment with this system.

Control reference guide

This system (Front)

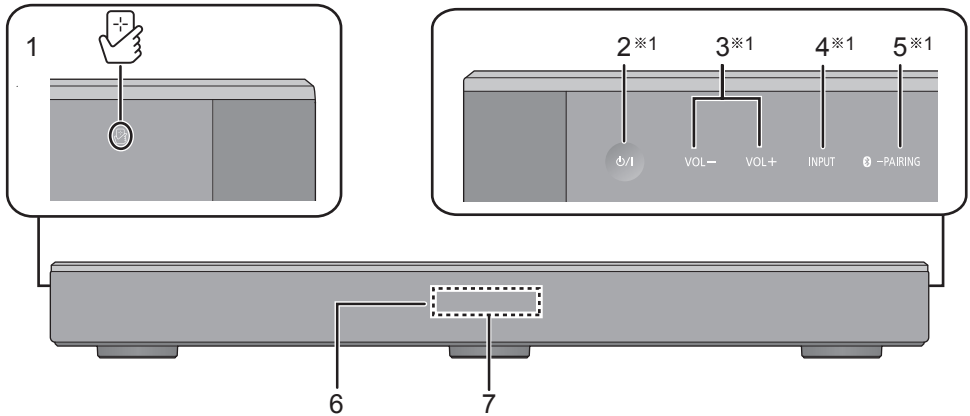

- | | |
|--|---|
| <p>1 [NFC] NFC touch area (⇒ 13, 14)</p> <p>2 [⏻/⏻] Standby/on switch (⏻/⏻)
Touch to switch the unit from on to standby mode or vice versa. In standby mode, the unit is still consuming a small amount of power.</p> <p>3 [VOL -] [VOL +] Adjust the volume of this system (⇒ 15)</p> | <p>4 [INPUT] Select the input source (⇒ 15)</p> <p>5 [Bluetooth] -PAIRING
 <ul style="list-style-type: none"> • Select the Bluetooth® device as the source (⇒ 15) • Bluetooth® pairing (⇒ 13) • Disconnecting a Bluetooth® device (⇒ 13) </p> <p>6 Remote control signal sensor (⇒ 7)</p> <p>7 Display</p> |
|--|---|

This system (Rear)

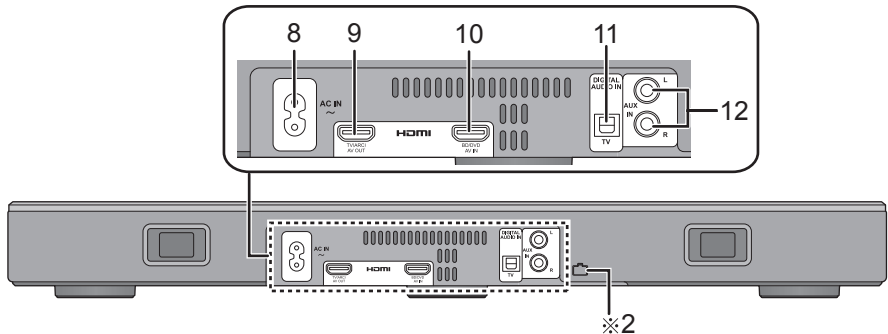

- | | |
|--|---|
| <p>8 AC IN terminal (⇒ 10)</p> <p>9 HDMI AV OUT (TV (ARC)) terminal (ARC compatible) (⇒ 8, 9)</p> <p>10 HDMI AV IN (BD/DVD) terminal (⇒ 9)</p> | <p>11 OPTICAL DIGITAL AUDIO IN (TV) terminal (⇒ 9)</p> <p>12 AUX IN terminal (⇒ 10)</p> |
|--|---|

- ※1 These switches work just by touching the marks. Each time you touch the switch, there will be a beep sound. The beep sound can be set to off. (⇒ 18)
- ※2 USB port (for service use only)

Remote control

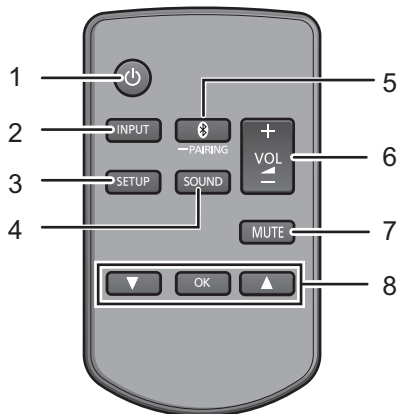

- 1 [⏻] Turn the main unit on or off (⇒ 15)
- 2 [INPUT] Select the input source (⇒ 15)
- 3 [SETUP] Select the setup menu (⇒ 18)
- 4 [SOUND] Select the sound menu (⇒ 16, 17)
- 5 [📶 -PAIRING]
 - Select the Bluetooth® device as the source (⇒ 15)
 - Bluetooth® pairing (⇒ 13)
 - Disconnecting a Bluetooth® device (⇒ 13)
- 6 [- VOL +] Adjust the volume of this system (⇒ 15)
- 7 [MUTE] Mute the sound (⇒ 15)
- 8 [▼][OK][▲] Select and confirm the option

■ Before using for the first time

Remove the insulation sheet **A**.

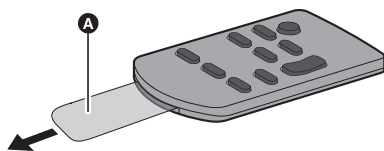

- Dispose of the insulation sheet responsibly after removing it.

■ To replace a button-type battery

Battery type: CR2025 (Lithium battery)

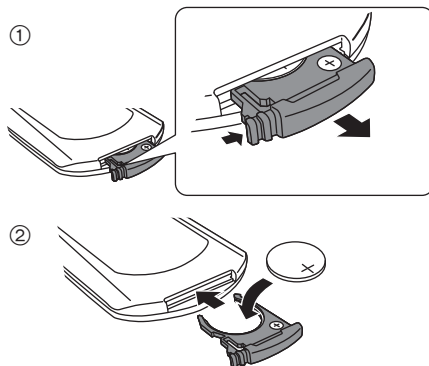

- Set the button-type battery with its (+) mark facing upward.

■ About remote control signal sensor

The remote control signal sensor is located on the main unit.

- Use the remote control within the correct operation range.
 - Distance: Within approx. 7 m directly in front
 - Angle: Approx. 30° left and right

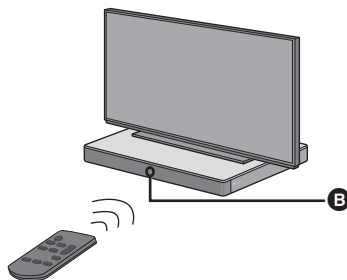

- B** Remote control signal sensor

Connections

- Turn off all equipment before connection and read the appropriate operating instructions.

Do not connect the AC mains lead until all other connections are completed.

■ HDMI (High-Definition Multimedia Interface)

- The HDMI connection supports VIERA Link "HDAVI Control" (⇒ 19) when used with a compatible Panasonic TV.
- Use the ARC compatible High Speed HDMI Cables. Non-HDMI-compliant cables cannot be utilised.
- It is recommended that you use Panasonic's HDMI cable.

■ HDMI standby pass-through

Even if the main unit is in standby mode, the audio and/or video signal from the device connected to the HDMI AV IN terminal will be sent to the TV connected to the HDMI AV OUT terminal (the sound will not be output from this system).

■ 3D compatibility

Compatible with FULL HD 3D TV and Blu-ray Disc player.

- The main unit can pass-through the 3D video signal from a 3D compatible Blu-ray Disc player to a FULL HD 3D TV.

■ 4K/60p compatibility

Compatible with 4K Ultra HD TV and Blu-ray Disc player.

- This system can pass-through the 4K content of a 4K compatible equipment to a 4K Ultra HD TV.
- When connecting to 4K compatible equipment and 4K Ultra HD TV, use High Speed HDMI cables which support 18 Gbps bandwidth.

Connection with the TV

1 Verify if the TV's HDMI terminal is labelled "HDMI (ARC)".

Connection differs depending on the label printed next to the HDMI terminal.

Labelled "HDMI (ARC)":

Connection **A**

Not Labelled "HDMI (ARC)":

Connection **B**

■ What is ARC?

ARC is an abbreviation of Audio Return Channel, also known as HDMI ARC. It refers to one of the HDMI functions. When you connect the main unit to the terminal labelled "HDMI (ARC)" on the TV, the optical digital audio cable that is usually required in order to listen to sound from a TV is no longer required, and TV pictures and sound can be enjoyed with a single HDMI cable.

2 Make the connection.

A Labelled "HDMI (ARC)"

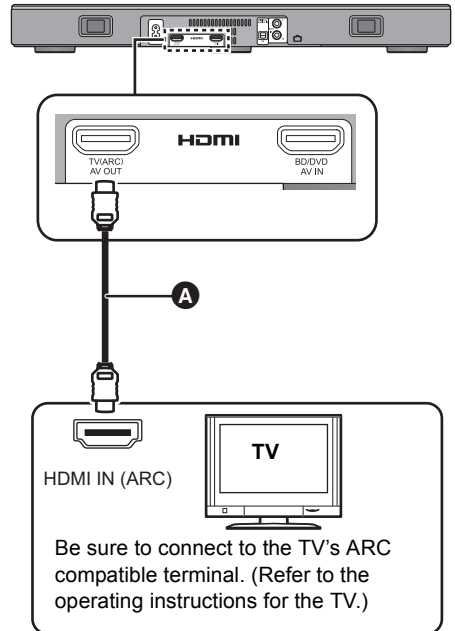

A HDMI cable

B Not Labelled “HDMI (ARC)”

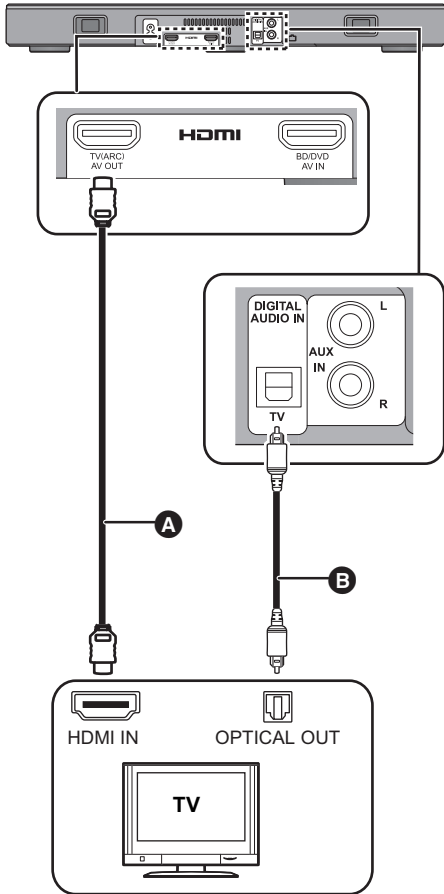

- A** HDMI cable
- B** Optical digital audio cable
 - When you use the optical digital audio cable, insert the tip correctly into the terminal.

Connection from an HDMI compatible device

You can direct the audio signal from the connected Blu-ray Disc player, DVD player, Set Top Box, etc. to this system.

Preparation

- Connect the main unit to the TV. (⇒ 8)

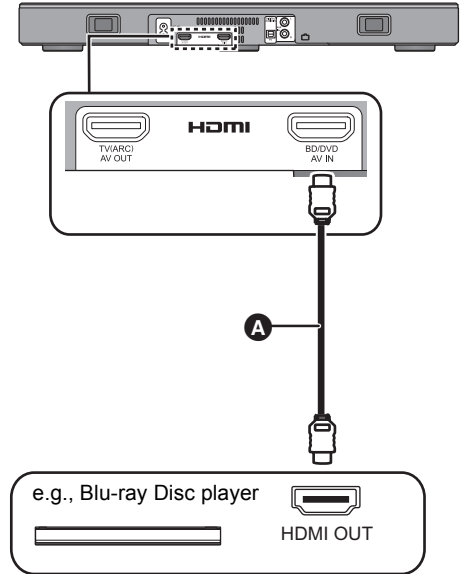

- A** HDMI cable



- Refer to the operating instructions of the connected HDMI compatible device for the necessary setting, to output the video and audio signals.
- When connecting to 4K compatible equipment and 4K Ultra HD TV, use High Speed HDMI cables which support 18 Gbps bandwidth.

Connection from an other device (AUX)

You can connect a device such as a Blu-ray Disc recorder, DVD recorder, game machine, or set top box.

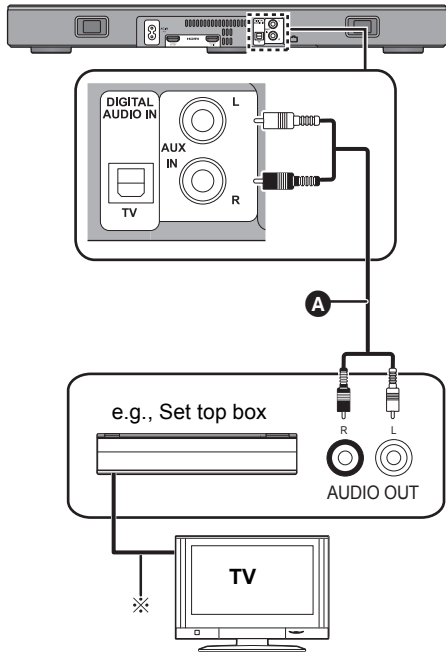

A Audio cable

※ Refer to the operating instructions of the respective devices for the optimal connection.

AC mains lead connection

- Connect only after all other connections are completed.

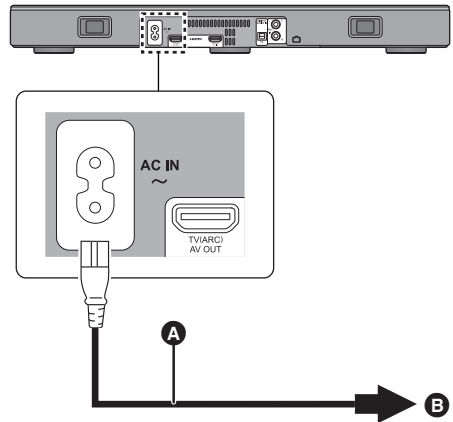

A AC mains lead (supplied)

B To a household mains socket

- This system consumes a small amount of AC power (⇒ 24) even when it is turned off. In the interest of power conservation, if you will not be using this system for a long time, unplug it from the household mains socket.

Saving energy

The main unit is designed to conserve its power consumption and save energy.

- The main unit will automatically switch to standby mode when no signal is input and no operation is performed for approx. 20 minutes. Refer to page 18, "AUTO POWER DOWN" to turn this function off.

Placement

Caution

- Make sure the TV is upright and not bent when setting up the TV on top of this unit. Also, do not put heavy objects on this unit or try to get on it. Be particularly careful when there are small children around. This may result in tipping, breakage, and injury.

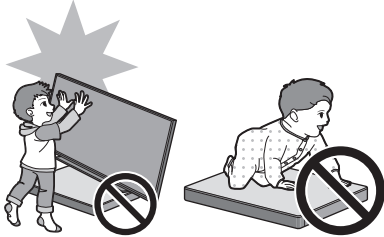

- Moving the TV on the surface of this unit can scratch the surface of this unit. Lift the TV when you need to move it.
- Toughened glass has been used on the top of this unit. Incorrect use may result in the glass breaking, resulting in possible injury.
- Take care not to scratch the glass on the top of this unit with pointy or sharp objects.
- Take care not to hit the glass on the top of this unit, drop pointy objects on it, or apply shocks to it.
- If the toughened glass is used for a long time after it is scratched, scratches may grow and eventually lead to the glass breaking.
- In very rare cases, the top glass of this unit may break naturally. If the glass does break, do not touch the broken glass with bare hands. This may result in injury.
- Be cautious when lifting the TV. The top plate may stick to the TV and the product may be lifted along with the TV.

Safety precaution

When the TV is less than 50 kg, and the pedestal of the TV is within 590 mm (width) by 355 mm (depth), you can put the TV on top of this unit.

- Do not put the TV on this unit if the TV stand overhangs this unit. This may result in tipping, breakage, and injury.

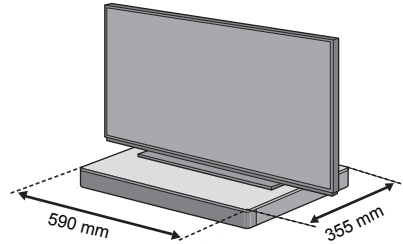

Otherwise, put this unit in a rack.

- It may become more difficult to touch Bluetooth® devices to the NFC touch area on this unit when it is placed in a rack.

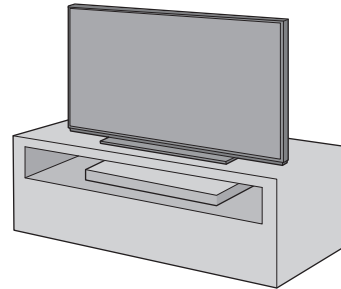

- Do not put this unit in a metal cabinet.
- Interference may occur if you are using other devices (wireless router, microwaves, cordless phones, etc.) that use the 2.4 GHz frequency band, causing some problems with Bluetooth® communication (sound is interrupted, sound skips, there is a lot of noise, etc.). In this case, separate this unit from the other equipment so there is no interference.
- Keep magnetised items away. Magnetised cards, watches, etc., can be damaged if put too near to this unit.

Preventing tipping

The TV may tip over during incidents such as earthquakes. Take measures to prevent tipping and falling for your safety.

- The information in this section is presented to help you reduce the damage caused by tipping or falling due to earthquakes, but is not meant to guarantee this effect in the event of an earthquake or similar incident.
- When setting up this unit under a TV, take the measures against tipping described in the operating instructions of the TV. When the TV and TV stand are attached with the belt, attach the belt so that this unit is between the TV and TV stand.
- Use the fittings included with the TV to prevent tipping or falling. Refer to the operating instructions of the TV for details.
- Take care not to fix this unit to the TV.

e.g.,

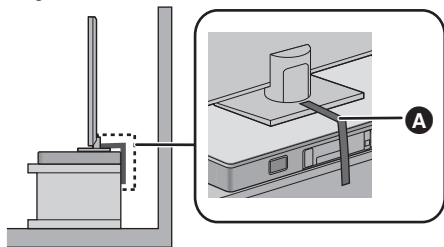

A Belt

Bluetooth® connection

By using the Bluetooth® connection, you can listen to the sound of the Bluetooth® audio device from this system wirelessly.

- Refer to the operating instructions of the Bluetooth® device for further instruction on how to connect a Bluetooth® device.

Preparation

- Turn on the Bluetooth® feature of the device and place the device near the main unit.

Bluetooth® pairing

1 Press [-PAIRING] to select “BLUETOOTH”.

- If “PAIRING” is indicated on the display, go to step 3.

2 Press and hold [-PAIRING] until “PAIRING” is indicated on the display.

3 Select “SC-HTE200” from the Bluetooth® device’s Bluetooth® menu.

- The MAC address (e.g., 6C:5A:B5:B3:1D:0F) may be displayed before the device name is displayed.
- If prompted for the passkey on the Bluetooth® device, enter “0000”.
- Once the Bluetooth® device is connected, the name of the connected device will be indicated on the display for a few seconds.



- You can register up to 8 devices with this system. If a 9th device is paired, the device that has not been used for the longest time will be replaced.

Connecting a paired Bluetooth® device

- 1 Press [ -PAIRING] to select Bluetooth® mode.
- 2 After confirming that “BLUETOOTH READY” is indicated on the display, select “SC-HTE200” from the Bluetooth® device’s Bluetooth® menu.

■ Disconnecting a Bluetooth® device

Press and hold [ -PAIRING] until the “BLUETOOTH READY” is indicated on the display.



- When “BLUETOOTH” is selected as the source, this system will automatically try and connect to the last connected Bluetooth® device. If the connection attempt fails, try to establish a connection again.
- This system can only be connected to one device at a time.
- To change the sound quality, refer to “LINK MODE”. (⇒ 18)

One-Touch Connection (Connecting by NFC)

For NFC-compatible Bluetooth® devices (Android™ devices) only

Simply by touching an NFC (Near Field Communication)-compatible Bluetooth® device on the main unit, you can complete all preparations, from registering a Bluetooth® device to establishing a connection.

Preparation

- Turn on the NFC feature of the device.
- Android device version lower than 4.1 requires the installation of the app “Panasonic Music Streaming” (free of charge).
 - 1 Enter “Panasonic Music Streaming” in the search box of Google Play™ to search, and then select “Panasonic Music Streaming”.
 - 2 Start the app “Panasonic Music Streaming” on the device.
 - Follow on-screen instructions on your device.
 - Always use the latest version of the app.

1 Press [Bluetooth] -PAIRING] to select “BLUETOOTH”.

2 Touch and hold your device on the NFC touch area of the main unit [NFC]. (⇒ 6)

Do not move the Bluetooth® device until it beeps, displays a message or reacts in some way. Once the Bluetooth® device has reacted, move the device away from the main unit.

- When the registration and connection of the Bluetooth® device is complete, the name of the connected device is indicated on the display for a few seconds.
- The location of the NFC touch area differs depending on the device. When a connection cannot be established even if your Bluetooth® device has touched the NFC touch area of the main unit, change the position of the device or main unit. The condition may also improve if you re-download the dedicated app “Panasonic Music Streaming” and start it up.

3 Start playback on the Bluetooth® device.



- If you touch another device to the main unit, you can update the Bluetooth® connection. The previously connected device will be disconnected automatically.
- When the connection is established, playback may start automatically depending on the type of device being used.
- The One-Touch Connection may not work properly depending on the type of device being used.

Remote control code

When other Panasonic devices respond to this system's remote control, change the remote control code on this system and the remote control.

Preparation

- Turn off all other Panasonic products.
- Turn on the main unit.
- Aim the remote control at this unit's remote control sensor.

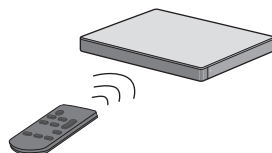

■ To set the code to “REMOTE 2”
While pressing and holding [MUTE], press and hold [OK] for 4 or more seconds. “REMOTE 2” is indicated on the display.

■ To set the code to “REMOTE 1”
While pressing and holding [MUTE], press and hold [▼] for 4 or more seconds. “REMOTE 1” is indicated on the display.

Using this system

Preparation

- Turn on the TV and/or connected device.



- 1 Press [⏻] to turn on the main unit.
- 2 Select the source.

Press	To select
[INPUT]	<p>Input changes in the following order each time you press [INPUT]. “TV”→ “BD/DVD”→ “AUX” ↑ “BLUETOOTH” ←</p> <ul style="list-style-type: none"> • When switching the source to “BLUETOOTH” and then to “TV” in succession, after switching it to “BLUETOOTH”, wait for a while, and press [INPUT].
[📶 -PAIRING]	<p>Select the Bluetooth® device as the source. (⇒ 13, 14)</p>

- This remote control cannot be used to control the operations of the connected devices.

■ When you select “BD/DVD”

Change the input on the TV to the one this unit is connected to, then start play on the device connected to this unit.

■ When you select “AUX”

Start play on the device connected to the audio input terminal on this unit.(⇒ 10, “Connection from an other device (AUX)”)

■ When you select “BLUETOOTH”

Start play on the Bluetooth® device connected to this unit.

■ To adjust the volume of this system

Press [- VOL +].

- Volume range: 0 to 100

■ To mute the sound

Press [MUTE].

- While muting, “MUTE” is indicated on the display.
- To cancel, press the button again or adjust the volume.
- Muting is cancelled if the main unit is turned off.



If this system does not operate as expected or sound is unusual, returning the settings to the factory preset may solve the problem. (⇒ 20)

- If there is sound coming out of the TV’s speakers, reduce the volume of the TV to its minimum.
- There may be a difference in the maximum volume value of the TV and the unit.
- When playing equipment connected to the HDMI AV IN terminal, to switch audio/video to the TV, switch input to the TV tuner. If VIERA Link (HDMI) (⇒ 19) is not enabled, also switch the input of this unit to TV.

3D sound

This system provides a feeling that the sound and the image are as one.

- To change the applied effect, refer to "Sound menu". (⇒ right)

e.g., Image of 3D sound field

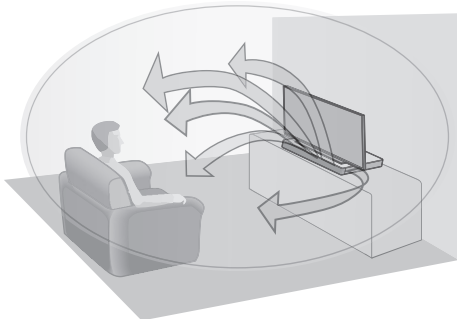

3D sound	
Dolby®Virtual Speaker	With this effect you can enjoy a surround sound effect similar to 5.1ch.
3D surround effect	Adding to the Dolby Virtual Speaker effect, Panasonic has applied its own sound field controlling technology to expand the sound field forwards, backwards, upwards, and downwards, providing a sound with depth and force that better matches 3D images.
Clear-mode dialog	Sports commentary and dialogs from TV dramas are heard as if the sound is coming from the TV, giving the feeling that the sound and the image are one. Also, the dialog will stand out from the other sounds during normal volume playback and when the volume is lowered for night time viewing.



- Dolby Virtual Speaker effect is ON except STEREO mode.
- To turn off Dolby Virtual Speaker and the 3D surround effects, select "STEREO" as the sound mode. (⇒ right)
- To turn off the 3D surround and the Clear-mode dialog effects, refer to "3D CLR DIALOG". (⇒ 17)
- You can also adjust the level of the Clear-mode dialog effect. (⇒ right)

Sound menu

- 1 Press [SOUND] repeatedly to select the sound effect.
- 2 Press [▼] [▲] repeatedly to select the desired setting and then press [OK].

SOUND MODE	Select the sound mode to suit the TV programme or connected equipment. STANDARD: Best suited for dramas and comedy shows. STADIUM: Produces a realistic sound for live sports broadcasts. MUSIC: Enhance the sound of musical instruments and songs. CINEMA: Produces three-dimensional sound unique to movies. NEWS: Enhance the voice of news and sports commentaries. STEREO: Play any source of sound in stereo.
SUBWOOFER	You can adjust the amount of bass. This system automatically selects the most suitable setting according to the type of playback source. LEVEL 1 LEVEL 2: Default for 2 channel audio source LEVEL 3: Default for multi-channel audio source LEVEL 4 The setting you make is retained and recalled every time you play the same type of source.
DIALOG	Adjust the dialog level. LEVEL 1 LEVEL 2 LEVEL 3 LEVEL 4 "DIALOG" is not indicated on the display when "3D CLR DIALOG" is set to "OFF".

H.BASS	Enhance the harmonic bass effect. <u>ON</u> OFF
3D CLR DIALOG	The 3D Clear Mode Dialog feature creates a sound field similar to the sound coming from a TV screen and makes dialogues clearer. <u>ON</u> : 3D Surround, Clear Mode Dialog and Dolby Virtual Speaker effect OFF : Dolby Virtual Speaker effect The setting is set back to “ON” every time you turn the main unit on.
DUAL AUDIO	Sets the preferred audio channel mode when there are two audio modes received by this system. <u>M1</u> : Main <u>M2</u> : Secondary <u>M1 + M2</u> : Main + Secondary This effect only works if the audio output of the TV or player is set to “Bitstream” and “Dolby Dual Mono” is available in the sound source.
AGC	Auto gain control prevents sudden loud sound by reducing the sound level automatically when the input is too high. This function is suitable for TV broadcast that has sound level difference. <u>ON</u> <u>OFF</u> If the sound becomes unnatural, select “OFF”.
LOW VOL MODE	Enhance the dialog in low volume condition. <u>ON</u> OFF Select “OFF” to cancel this effect if the dialog does not sound natural in low volume condition.



- The default setting is underlined. Changed settings will be kept until it is changed again, unless otherwise indicated.

Audio format

You can view the current audio format.

Press and hold [SOUND] for more than 4 sec.

DOLBY DIGITAL	Dolby Digital is the audio source.
DTS	DTS® is the audio source.
PCM MULTI	Linear pulse-code modulation is the audio source.
PCM	2 channel pulse-code modulation is the audio source.
ANALOG	Analogue is the audio source.



- The audio format is displayed for about 2 seconds.
- No audio format is displayed if input to this unit is Bluetooth®.

Setup menu

- 1 Press [SETUP] repeatedly to select the setup item.
- 2 Press [▼] [▲] repeatedly to select the desired setting and then press [OK].

DIMMER	Dims the display after 5 seconds of inactivity. ON <u>OFF</u>
BEEP	A beep sounds when you touch the switch on the main unit or when you turn the unit on/off. <ul style="list-style-type: none"> • This works during muting as well. ON <u>OFF</u>
AUTO POWER DOWN	The main unit automatically is turned off if there is no audio input and when you do not use it for approx. 20 minutes. ON <u>OFF</u> <ul style="list-style-type: none"> • When this is set, the display shows "P.OFF 1" to indicate that the main unit will turn off in approximately 1 minute.
VOL LIMITATION	Sets the volume limit to 50 when you turn on the main unit although the volume is set to above 50 before it is turned off. ON <u>OFF</u>
BLUETOOTH STANDBY	This function allows you to connect a paired Bluetooth® device when the main unit is in standby mode. ON <u>OFF</u> The main unit will be turned on automatically when you connect a paired Bluetooth® device. <ul style="list-style-type: none"> • If this function is set to "ON", the standby power consumption will increase.

LINK MODE	Change the transmission mode to prioritise transmission quality or sound quality. Make sure that the Bluetooth® device is not connected ("BLUETOOTH READY" is indicated on the display). MODE 1: Emphasis on connectivity. <u>MODE 2:</u> Emphasis on sound quality.
VIERA LINK	Turn on the VIERA Link function. ON <u>OFF</u> Select "OFF" when your HDAVI Control device does not work correctly with this system. <ul style="list-style-type: none"> • ARC will be disabled. Connect an optical digital audio cable. • Turn off all connected devices and then turn them on again after changing the setting.



- The default setting is underlined. Changed settings will be kept until it is changed again, unless otherwise indicated.

Linked operations with the TV (VIERA Link “HDAVI Control™”)

What is VIERA Link “HDAVI Control”?

VIERA Link “HDAVI Control” is a convenient function that offers linked operations of this system, and a Panasonic TV (VIERA) under “HDAVI Control”.

You can use this function by connecting the equipment with an HDMI cable. See the operating instructions for connected equipment for operational details.

Preparation

- ① Confirm that the HDMI connection has been made. (⇒ 8, 9)
- ② Set the “HDAVI Control” operations on the connected equipment (e.g., TV).
- ③ For the optimal “HDAVI Control” operations change the following settings on the connected TV*1.
 - Set the default speaker settings to this system.*2
 - Set the speaker selection settings to this system.
- ④ Turn on all “HDAVI Control” compatible equipment and select the TV’s input for this system so that the “HDAVI Control” function works properly.
- ⑤ If a device is connected to the HDMI AV IN terminal, start play to check that the picture is displayed on the TV correctly.

When the connection or settings are changed, repeat this procedure.

- ※1 The availability and function of the settings may vary depending on the TV. Refer to the operating instructions for the TV for details.
- ※2 If the TV has a default speaker setting within the VIERA Link setting items, choosing this system as the default speaker will automatically change the speaker selection to this system.



- VIERA Link “HDAVI Control”, based on the control functions provided by HDMI which is an industry standard known as HDMI CEC (Consumer Electronics Control), is a unique function that we have developed and added. As such, its operation with other manufacturers’ equipment that supports HDMI CEC cannot be guaranteed.
- This unit supports “HDAVI Control 5” function. “HDAVI Control 5” is the standard for Panasonic’s HDAVI Control compatible equipment. This standard is compatible with Panasonic’s conventional HDAVI equipment.
- Please refer to individual manuals for other manufacturers’ equipment supporting VIERA Link function.

What you can do with VIERA Link “HDAVI Control”

To make sure that the audio is output from this system, turn the main unit on by using the TV’s remote control and selecting home cinema from the speaker menu of VIERA Link menu. The availability and function of the settings may vary depending on the TV. Refer to the operating instructions for the TV for details.

■ Speaker control

You can select whether audio output is from this system or the TV speakers by using the TV menu settings.

Home cinema

This system is active.

- When the main unit is in standby mode, changing the TV speakers to this system in the VIERA Link menu will automatically turn the main unit on.
- You can control the volume setting of this system using the volume or mute button on the TV remote control.
- If you turn off the main unit, TV speakers will be automatically activated.
- Audio will automatically be output from this system if the TV is compatible to VIERA Link “HDAVI Control 4” or later.

TV

TV speakers are active.

- The volume of this system is set to its minimum.

■ Automatic input switching

When the following operations are performed, the main unit will automatically change the input to the corresponding source.

- When play starts on an HDMI connected device.*3
- When the TV input or the TV channel is changed.

※3 If the speaker output setting on the TV is set to this system, the TV and the main unit turn on automatically (Power on link).

■ Power off link

When the TV is turned off, the main unit also turns off automatically. (This function does not work when Bluetooth® or AUX is the source.)

■ Automatic lip-sync function

(for HDAVI Control 3 or later)

Delay between audio and video is automatically adjusted by adding time-lag to the audio output, enabling you to enjoy smooth audio for the picture.



- It may take up to 8 seconds for sound to be output from this unit after turning the TV (VIERA) on. You can reduce the amount of time it takes for sound to be output by using an optical digital audio cable. If you do so, reconnect the HDMI cable to a non-ARC compatible HDMI terminal on the TV (VIERA). (⇒ 9)
- The delay information is automatically set if the TV is compatible to VIERA Link “HDAVI Control 3” or later and the VIERA Link is set to on. The setting causes a sound delay of approximately 0.04 seconds when connected to a Panasonic TV (VIERA) with VIERA Link (HDMI) version 2 or earlier or a TV from another manufacturer.

Troubleshooting

Before requesting service, make the following checks. If you are in doubt about some of the check points, or if the solutions indicated in the following guide do not solve the problem, consult your dealer for instructions.

If this system does not operate as expected, returning the settings to the factory preset may solve the problem.

To return to the factory preset.

- ① While the main unit is on, touch and hold [⏻/⏪] on the main unit for more than 4 sec.
(“RESET” is indicated on the display when this system is reset.)
- ② Turn the unit off, then turn it on again.
 - The remote control code will return to “REMOTE 1” when this system is returned to the factory preset. To change the remote control code, refer to “Remote control code” (⇒ 14).

General operation

No power.

- Unplug the AC mains lead for 10 sec before plug in again.
- After turning the main unit on, if the main unit immediately turns off, unplug the AC mains lead and consult your dealer.
- If the main unit does not turn on by turning on TV (HDAVI control), turn on the main unit manually.
If the problem persists, refer to “HDMI” in “Troubleshooting”.

The remote control does not work properly.

- The battery is depleted. Replace it with a new one. (⇒ 7)
- It is possible that the insulation sheet has not been removed. Remove the insulation sheet. (⇒ 7)
- It may be necessary to set the code of the remote control again after changing the battery of the remote control. (⇒ 14)
- Use the remote control within the correct operation range. (⇒ 7)

The main unit is automatically switched to standby mode.

“AUTO POWER DOWN” function is on.

The main unit will automatically switch to standby mode when no signal is input and no operation is performed for approx. 20 minutes. Refer to page 18 to turn this function off.

The main unit is turned off when the TV’s speakers are selected in the speaker control.

This is a normal feature when using VIERA Link (HDAVI Control 4 or later). Please read the operating instructions for the TV for details about its power save feature. (⇒ 19)

The switches on the main unit do not work.

[⏻/⏪], [VOL -], [VOL +], [INPUT], and [⊗ -PAIRING] on the main unit are touch keys. Touch the switches with your finger. They may not work if operated with your fingernails or hands wearing gloves.

Colour irregularities on a CRT TV.

If colour irregularities appear on the TV, turn off the TV for about 30 minutes and move the TV away from this unit slightly. If this does not fix the problem, move this unit away from the TV.

HDMI

This system does not operate correctly.

If the HDMI cable is connected to the wrong terminal (HDMI AV IN or HDMI AV OUT), this system will not operate correctly. Turn the main unit off, disconnect the AC mains lead and reconnect the HDMI cable(s). (⇒ 8, 9)

VIERA Link related operations no longer function properly.

- Check the VIERA Link setting on the connected devices.
 - Turn on VIERA Link function on the connected devices.
 - Select this system as the speaker in the TV’s VIERA Link menu.
- Have you turned the VIERA Link settings off? (⇒ 18)

- When the HDMI connections are changed, after a power failure or after the AC mains lead has been removed, VIERA Link operations may not function properly.
 - Turn on all the devices that are connected to the TV with an HDMI cable and then turn the TV on.
 - Turn off the VIERA Link settings of the TV and turn it on again. For details refer to the operating instructions for the TV.
 - While the main unit and the TV are connected with the HDMI cable, turn on the TV and then remove the main unit's AC mains lead and reconnect it again.

The first few seconds of audio cannot be heard when using the HDMI connection.

This may occur during DVD-Video chapter playback. Change the digital audio output setting on the connected device from "Bitstream" to "PCM".

When operating an HDMI compatible device of a different brand, the main unit reacts in an unwanted manner.

HDAVI Control commands may use a different signal depending on the brand of the device. In this case, turn VIERA Link off. (⇒ 18)

When the main unit is turned on or off, audio and video are temporarily disabled.

When the main unit is turned on or off it is normal for the audio and video to be temporarily disabled. This is not a malfunction. This can occur when the device it is connected to, via HDMI, does not support Panasonic's VIERA Link feature (HDAVI Control 3 or later).

The images from this system do not appear on the TV.

When outputting in 60p (4K), images may be distorted depending on the HDMI cable. Use High Speed HDMI cables which support 18 Gbps bandwidth.

Bluetooth®**Pairing cannot be done.**

Check the Bluetooth® device condition.

The device cannot be connected.

- The pairing of the device was unsuccessful or the registration has been replaced. Try pairing the device again. (⇒ 13)
- This system might be connected to a different device. Disconnect the other device and try pairing the device again.

The device is connected but audio cannot be heard through this system.

For some Bluetooth® devices, you have to set the audio output to "SC-HTE200" manually. Read the operating instructions for the device for details.

Connection is interrupted.**Sound is interrupted/sound skips/there is a lot of noise.**

- Remove any obstacle between the main unit and the device.
 - Other devices that use the 2.4 GHz frequency band (wireless router, microwaves, cordless phones, etc.) are interfering. Bring the Bluetooth® device closer to the main unit and distance it from the other devices.
 - Select "MODE1" for stable communication. (⇒ 18)
- If the above does not fix the problem, you may be able to fix the problem by reconnecting this unit and the Bluetooth® device. (⇒ 13)

The One-Touch Connection (NFC feature) is not working.

- Make sure the main unit and the NFC feature of the device are turned on. (⇒ 13, 14)
- Change the touch location of the Bluetooth® device or main unit and then touch the NFC touch area again.

Sound**No sound (or image).**

- Turn muting off. (⇒ 15)
- Check the connections to the other devices. (⇒ 8 - 10)
- Make sure that the received audio signal is compatible with this system. (⇒ 24)
- Turn this system off and then on again.
- If the main unit is connected to the TV with only an HDMI cable, make sure that the TV's HDMI terminal is labelled "HDMI (ARC)". If not, connect using the optical digital audio cable. (⇒ 8, 9)

- If the main unit is connected to a Panasonic TV and turned on using the remote control or the touch key on the main unit, sound might not be output from this system. In this case, turn the main unit on using the TV's remote control. (⇒ 19)
- If the connections are correct, there might be a problem with the cables. Redo the connections with different cables.
- Check the audio output settings on the connected device.

The dual audio cannot be changed from main to secondary.

If the audio received from the connected device is not "Dolby Dual Mono" or the output setting is not "Bitstream", the setting cannot be changed from this system. Change the setting on the connected device.

The volume is lowered when the main unit is turned on.

"VOL LIMITATION" is on.

If the main unit is turned off with the volume setting in the greater half (above 50), the main unit will automatically lower the volume to the middle (50) when the main unit is turned on. (⇒ 18)

The dialog is too persistent or the dialog does not sound natural.

This system has a function to make the dialog stand out when the volume is low. (⇒ 17)

The sound lags behind the image.

Depending on the TV, when this unit is connected to it via Bluetooth®, the sound output from this unit may lag behind the TV image. Connect this unit and the TV with an HDMI cable/optical digital audio cable. (⇒ 8, 9)

Sound stops.

The power of the main unit turns off automatically.

(When the main unit detects a problem, a safety measure is activated and the main unit automatically switches to standby mode.)

- There is a problem with the amplifier.
- Is the volume extremely high?
If so, lower the volume.
- Is this system placed in an extremely hot place?
If so, move this system to a cooler place and wait a few moments and then try to turn it on again.

If the problem persists, confirm the display, turn this system off, remove the AC mains lead cord and consult your dealer. Please be sure to remember the display that was indicated and inform the dealer.

Main unit displays

"F61"

- There is a problem with the amplifier of the system.
- Disconnect the AC mains lead and consult the dealer.

"F70 HDMI"/ "U701"/ "U703"

- Check HDMI connection.
- Turn off the main unit and then switch it on again.
- Disconnect the HDMI cable.

"F76"

- There is a problem with the power supply.
- Disconnect the AC mains lead and consult the dealer.

"U704"

- This system is receiving unsupported video format signal from the input source.
 - Change the video resolution setting on the connected device. (Refer to the operating instructions for the device.)
 - If there is no image, connect the device directly to the TV to change the settings.

"U705"

- The TV's HDMI terminal connected to the main unit or the TV's setting is not compatible with the HDCP 2.2 playback source.
 - Ensure to connect to the TV's HDCP 2.2 compatible terminal.
 - Ensure the TV's HDMI HDCP setting corresponds to HDCP 2.2.
 (Refer to the operating instructions for the TV.)

"REMOTE □" ("□" stands for a number.)

The remote control and this unit are using different codes. Change the code on the remote control. (⇒ 14)

About Bluetooth®

Panasonic bears no responsibility for data and/or information that is compromised during a wireless transmission.

■ Frequency band used

This system uses the 2.4 GHz frequency band.

■ Certification of this device

- This system conforms to frequency restrictions and has received certification based on frequency laws. Thus, a wireless permit is not necessary.
- The action below are punishable by law in some countries:
 - Taking apart or modifying the unit.
 - Removing specification indications.

■ Restrictions of use

- Wireless transmission and/or usage with all Bluetooth® equipped devices is not guaranteed.
- All devices must conform to standards set by Bluetooth SIG, Inc.
- Depending on the specifications and settings of a device, it can fail to connect or some operations can be different.
- This system supports Bluetooth® security features. But depending on the operating environment and/or settings, this security is possibly not sufficient. Transmit data wirelessly to this system with caution.
- This system cannot transmit data to a Bluetooth® device.

■ Range of use

Use this device at a maximum range of 10 m. The range can decrease depending on the environment, obstacles or interference.

■ Interference from other devices

- This system may not function properly and troubles such as noise and sound jumps may arise due to radio wave interference if the main unit is located too close to other Bluetooth® devices or the devices that use the 2.4 GHz band.
- This system may not function properly if radio waves from a nearby broadcasting station, etc. are too strong.

■ Intended usage

- This system is for normal, general use only.
- Do not use this system near equipment or in an environment that is sensitive to radio frequency interference (example: airports, hospitals, laboratories, etc.).

Unit care

■ Clean this system with a soft, dry cloth

- When dirt is heavy, wring a cloth moistened in water tightly to wipe the dirt, and then wipe it with a dry cloth.
- When cleaning the speakers, use a fine cloth. Do not use tissues or other materials (towels, etc.) that can fall apart. Small grains may get stuck inside the speaker cover.
- Never use alcohol, paint thinner or benzine to clean this system.
- Before using chemically-treated cloth, carefully read the instructions that came with the cloth.

■ To dispose or transfer this system

This system may keep the user settings information in the main unit. If you discard the main unit either by disposal or transfer, then follow the procedure to return all the settings to the factory presets to delete the user settings. (⇒ 20, "To return to the factory preset.")

- The operation history may be recorded in the memory of the main unit.

Licenses

Manufactured under license from Dolby Laboratories. Dolby, Pro Logic, and the double-D symbol are trademarks of Dolby Laboratories.

For DTS patents, see <http://patents.dts.com>. Manufactured under license from DTS Licensing Limited. DTS, the Symbol, & DTS and the Symbol together are registered trademarks, and DTS Digital Surround is a trademark of DTS, Inc. © DTS, Inc. All Rights Reserved.

HDMI, the HDMI Logo, and High-Definition Multimedia Interface are trademarks or registered trademarks of HDMI Licensing LLC in the United States and other countries.

HDAVI Control™ is a trademark of Panasonic Corporation.

The Bluetooth® word mark and logos are registered trademarks owned by Bluetooth SIG, Inc. and any use of such marks by Panasonic Corporation is under license. Other trademarks and trade names are those of their respective owners.

Google Play and Android are trademarks of Google Inc.

Specifications

AMPLIFIER SECTION

RMS output power (non-simultaneous drive)	
Front ch (L, R ch)	50 W per channel (1 kHz, 10 %, 6 Ω)
Subwoofer ch	100 W per channel (100 Hz, 10 %, 3 Ω)
Total RMS output power	200 W

TERMINAL SECTION

HDAVI Control	This unit supports "HDAVI Control 5" function.
HDMI AV input (BD/DVD)	1
Input connector	Type A (19 pin)
HDMI AV output (TV (ARC))	1
Output connector	Type A (19 pin)
Digital audio input (TV)	
Optical digital input	Optical terminal
Sampling frequency	32 kHz, 44.1 kHz, 48 kHz 88.2 kHz, 96 kHz (only LPCM)
Audio format	LPCM, Dolby Digital, DTS Digital Surround™
USB Port	For service use only.
Analog audio input	
Audio input	Terminal type, Pin jack (1 system)

GENERAL

Power consumption	54 W
In standby condition	
When "Network Standby"*1 is "OFF"	Approx. 0.4 W
When "Network Standby"*1 is "ON"	Approx. 3.0 W

Power supply	AC 220 V to 240 V, 50 Hz
Dimensions (W×H×D)	600 mm×63 mm×365 mm
Mass	Approx. 5.9 kg
Operating temperature range	0 °C to +40 °C
Operating humidity range	20 % to 80 % RH (no condensation)

SPEAKER SECTION

Front speakers (Built-in, L/R)	
Full range	3.8 cm×9 cm cone type × 1/ch (Bass reflex type)
Subwoofers (Built-in)	
woofer	8 cm cone type × 2 (Bass reflex type)

Bluetooth® SECTION

Bluetooth® system specification	Bluetooth® Ver.2.1 +EDR
Wireless equipment classification	Class 2 (2.5 mW)
Supported profiles	A2DP
Frequency band	2.4 GHz band FH-SS
Operating distance	Approx. 10 m Line of Sight*2
Supported codec	SBC



- Specifications are subject to change without notice.
- Mass and dimensions are approximate.
- Total harmonic distortion is measured by a digital spectrum analyzer.

- ※ 1 "Network Standby" means both "BLUETOOTH SATNDBY" and "VIERA LINK".
- ※ 2 Prospect communication distance. Measurement environment. (Temperature 25 °C, Height 1.0 m)

Disposal of Old Equipment and Batteries

Only for European Union and countries with recycling systems



These symbols on the products, packaging, and/or accompanying documents mean that used electrical and electronic products and batteries must not be mixed with general household waste.

For proper treatment, recovery and recycling of old products and used batteries, please take them to applicable collection points in accordance with your national legislation.

By disposing of them correctly, you will help to save valuable resources and prevent any potential negative effects on human health and the environment.

For more information about collection and recycling, please contact your local municipality.

Penalties may be applicable for incorrect disposal of this waste, in accordance with national legislation.



Note for the battery symbol (bottom symbol):

This symbol might be used in combination with a chemical symbol. In this case it complies with the requirement set by the Directive for the chemical involved.

Safety information for customers in Norway

NORSK

ADVARSEL

Produkt

- For å redusere faren for brann, elektrisk støt eller skade på apparatet:
 - Utsett ikke produktet for regn, fukt, drypping eller sprut.
 - Ikke plasser objekter som er fylt med væske, som vaser, på apparatet.
 - Bruk kun anbefalt tilbehør.
 - Fjern ikke deksler.
 - Reparer ikke denne enheten selv, overlat service til kvalifisert servicepersonell.

Vekselstrømnett

- Nettstøpselet er trukket ut fra denne enheten. Installer denne enheten slik at nettstøpselet umiddelbart kan trekkes fra stikkontakten.

FORSIKTIG

Produkt

- Plasser ikke åpen ild, slik som levende lys, oppå apparatet.
- Dette apparatet er beregnet for bruk under moderate klimaforhold.

Plassering

- For å redusere faren for brann, elektrisk støt eller skade på apparatet:
 - Ikke plasser apparatet i en bokhylle, et innebygget kabinett eller et annet lukket sted. Pass på at produktet er godt ventilert.
 - Apparatets ventilasjonsåpninger må ikke dekkes til med aviser, duker, gardiner eller lignende.

CE 0560

English

Declaration of Conformity (DoC)

Hereby, "Panasonic Corporation" declares that this product is in compliance with the essential requirements and other relevant provisions of Directive 1999/5/EC.

Customers can download a copy of the original DoC to our R&TTE products from our DoC server:
<http://www.doc.panasonic.de>

Contact to Authorised Representative: Panasonic Marketing Europe GmbH,
Panasonic Testing Centre, Winsbergring 15, 22525 Hamburg, Germany

This product is intended for general consumer. (Category 3)

Ελληνικά

Δήλωση συμμόρφωσης (DoC)

Με την παρούσα, η "Panasonic Corporation" δηλώνει ότι το προϊόν αυτό είναι σύμφωνο με τις βασικές απαιτήσεις και άλλες σχετικές διατάξεις της οδηγίας 1999/5/EC.

Οι πελάτες μπορούν να κατεβάσουν ένα αντίγραφο του πρωτοτύπου DoC για τα R&TTE προϊόντα μας από τον DoC server μας:

<http://www.doc.panasonic.de>

Στοιχεία επικοινωνίας Εξουσιοδοτημένου Αντιπροσώπου:
Panasonic Marketing Europe GmbH,
Panasonic Testing Centre, Winsbergring 15, 22525 Hamburg, Γερμανία

Αυτό το προϊόν προορίζεται για καταναλωτές. (Κατηγορία 3)

Português

Declaração de Conformidade (DoC)

Com o presente documento, a "Panasonic Corporation" declara que este produto é conforme os requisitos específicos e demais especificações referentes à Directriz 1999/5/EC.

Os clientes podem baixar uma cópia da declaração de conformidade (DoC) para nossos produtos R&TTE do Server DoC:

<http://www.doc.panasonic.de>

Contacto o representante autorizado: Panasonic Marketing Europe GmbH,
Panasonic Testing Centre, Winsbergring 15, 22525 Hamburg, Alemanha

Este produto destina-se ao consumidor geral. (Categoria 3)

Hrvatski

Deklaracija o podobnosti (DoC)

Ovime, "Panasonic Corporation" izjavljuje da je ovaj proizvod udovoljava osnovnim zahtjevima i ostalim relevantnim uvjetima Smjernice 1999/5/EC.

Kupci mogu preuzeti kopiju originalne DoC za naše R&TTE proizvode s našeg DoC poslužitelja:

<http://www.doc.panasonic.de>

Adresa ovlaštenog predstavništva: Panasonic Marketing Europe GmbH,
Panasonic Testing Centre, Winsbergring 15, 22525 Hamburg, Njemačka

Ovaj proizvod je namijenjen za opću potrošnju. (kategorija 3)

Lietuviškai

Atitikties deklaracija (AD)

Bendrovė "Panasonic Corporation" patvirtina, kad šis gaminyss tenkina direktyvos 1999/5/EB esminius reikalavimus ir kitas taikytinas nuostatas.

Mūsų R&TTE gaminių originalios atitikties deklaracijos kopiją klientai gali atsisiųsti iš mūsų AD serverio:

<http://www.doc.panasonic.de>

Igaliojoto atstovo adresas: "Panasonic Marketing Europe GmbH",
Panasonic Testing Centre, Winsbergring 15, 22525 Hamburg, Vokietija.

Šis gaminyss skirtas bendrajam vartojimui. (3 kategorija.)

Slovensko

Izjava o skladnosti (DoC)

S pričujočo izjavo podjetje "Panasonic Corporation" izjavlja, da so svoji izdelki skladni s poglavitnimi zahtevami in drugimi odgovarjajočimi predpisi direktive 1999/5/ES.

Stranka lahko naloži izvod izvirnega DoC o naših izdelkih R&TTE s strežnika DoC:

<http://www.doc.panasonic.de>

Pooblaščenil zastopnik: Panasonic Marketing Europe GmbH,
Panasonic Testing Centre, Winsbergring 15, 22525 Hamburg, Nemčija

Izdelek je namenjen splošni uporabi. (Razred 3)

Slovensky

Vyhlasenie o zhode (DoC)

"Panasonic Corporation" týmto prehlasuje, že tento výrobok je v zhode so základnými požiadavkami a ďalšími príslušnými ustanoveniami smernice 1999/5/ES.

Zákazníci si môžu stiahnuť kópiu pôvodného DoC na naše R&TTE výrobky z nášho servera DoC:

<http://www.doc.panasonic.de>

Kontakt na spinomocneného zástupcu: Panasonic Marketing Europe GmbH,
Panasonic Testing Centre, Winsbergring 15, 22525 Hamburg, Nemecko

Tento produkt je určený pre všeobecného spotrebiteľa. (Kategória 3)

Norsk

Samsvarserklæring (DoC)

"Panasonic Corporation" erklærer at utstyret er i samsvar med de grunnleggende krav og øvrige relevante krav i direktiv 1999/5/EF.

Kundene kan laste ned en kopi av den originale samsvarserklæringen (DoC) for vårt R&TTE utstyr fra vår DoC server:

<http://www.doc.panasonic.de>

Kontakt vår autoriserte representant: Panasonic Marketing Europe GmbH,
Panasonic Testing Centre, Winsbergring 15, 22525 Hamburg, Tyskland

Utstyret er beregnet på den vanlige forbruker (klasse 3).

Eesti keel

Vastavusdeklaratsioon (DoC)

"Panasonic Corporation" kinnitab käesolevaga, et see toode on vastavuses põhiliste nõuete ja muude direktiivi 1999/5/EÜ asjakohaste sätetega.

Kliendid saavad koopia meie R&TTE toodetele kehtiva originaalvastavusdeklaratsiooni koopia alla laadida meie DoC-serverist:

<http://www.doc.panasonic.de>

Võtke ühendust volitatud esindajaga: Panasonic Marketing

Europe GmbH,

Panasonic Testing Centre, Winsbergring 15, 22525 Hamburg,

Saksamaa

See toode on mõeldud tavakasutajale. (III kategooria)

Latviski

Atbilstības deklarācija (DoC)

Kompānija "Panasonic Corporation" ar šo paziņo, ka šis izstrādājums atbilst būtiskām prasībām un citām saistošām Direktīvas 1999/5/EK prasībām.

Pircēji var lejupielādēt oriģinālo DoC kopiju mūsu R&TTE izstrādājuma no mūsu DoC servera:

<http://www.doc.panasonic.de>

Lūdzam sazināties ar pilnvaroto parstāvi Panasonic

Marketing Europe GmbH,

Panasonic Testing Centre, Winsbergring 15, 22525

Hamburg, Vācijā

Šis izstrādājums ir paredzēts parastam patērētājam. (3. kategorija)

Български

Декларация за съответствие (DoC)

"Panasonic Corporation" декларира, че този продукт съответства на съществените изисквания и другите приложими разпоредби на Директива 1999/5/ЕС.

Потребителите могат да свалят копия от оригиналните DoC към нашите продукти от типа R&TTE от сървъра, на който се съхраняват DoC:

<http://www.doc.panasonic.de>

За контакт с оторизиран представител: Panasonic Marketing

Europe GmbH,

Panasonic Testing Centre, Winsbergring 15, 22525 Hamburg,

Германия

Този продукт е предназначен за обща употреба. (Категория 3)

Român

Declarație de Conformitate (DoC)

Prin prezenta, societatea "Panasonic Corporation" declară că produsul este conform cu cerințele esențiale și cu alte norme corespunzătoare Directivei 1999/5/EC.

Clienții pot descărca o copie a DoC-ului original al produselor noastre R&TTE de la adresa noastră DoC din Internet:

<http://www.doc.panasonic.de>

Contact la Reprezentanța autorizată: Panasonic Marketing

Europe GmbH,

Panasonic Testing Centre, Winsbergring 15, 22525 Hamburg,

Germania

Acest produs a fost proiectat pentru clientela generală. (Categoria 3)

Magyar

Megfelelőségi Nyilatkozat (DoC)

Ezennel a "Panasonic Corporation" kijelenti, hogy a jelen termék kielégíti az 1999/5/EK Irányelv létfontosságú követelményeit és más vonatkozó rendelkezéseit.

A vásárlók letölthetik az R&TTE termékek eredeti DoC

másolatát a DoC szerverünkről:

<http://www.doc.panasonic.de>

Forduljon a hivatalos márkaképviselethez: Panasonic Marketing

Europe GmbH,

Panasonic Testing Centre, Winsbergring 15, 22525 Hamburg,

Németország

A terméket általános fogyasztóknak szánták. (3-as kategória)

Türkçe

Uygunluk Beyanı (DoC)

"Panasonic Corporation" işbu belge ile bu ürünü 1999/5/EC sayılı Direktif'in temel gereklerine ve diğer ilgili hükümlerine uygun olduğunu beyan etmektedir.

Müşterilerimiz R&TTE ürünlerimizle ilgili orijinal DoC belgesinin bir kopyasını DoC sunucumuzdan indirebilir:

<http://www.doc.panasonic.de>

Yetkili Temsilci ile temasa geçin:

Panasonic Marketing Europe GmbH, Panasonic Testing Centre,

Winsbergring 15, 22525 Hamburg, Almanya

İşbu ürün genel tüketicilere yöneliktir. (Kategori 3)

For the United Kingdom and Ireland customers

Sales and Support Information

Customer Communications Centre

- For customers within the UK: 0344 844 3899
- For customers within Ireland: 01 289 8333
- Monday–Friday 9:00 am – 5:00 pm (Excluding public holidays).
- For further support on your product, please visit our website:
www.panasonic.co.uk

Direct Sales at Panasonic UK

- Order accessory and consumable items for your product with ease and confidence by phoning our Customer Communications Centre Monday–Friday 9:00 am – 5:00 pm (Excluding public holidays).
- Or go on line through our Internet Accessory ordering application at www.pas-europe.com.
- Most major credit and debit cards accepted.
- All enquiries transactions and distribution facilities are provided directly by Panasonic UK.
- It couldn't be simpler!
- Also available through our Internet is direct shopping for a wide range of finished products. Take a browse on our website for further details.



Manufactured by: Panasonic Corporation
Kadoma, Osaka, Japan

Importer for Europe: Panasonic Marketing Europe GmbH
Panasonic Testing Centre
Winsbergring 15, 22525 Hamburg, Germany



Panasonic Corporation
Web Site: <http://www.panasonic.com>

