

Angelcare®

FOR YOUR PEACE OF MIND

OWNER'S MANUAL

MOVEMENT MONITOR

Model AC300



IMPORTANT ADVICE FOR INITIAL SETUP

**DON'T
FORGET**



Movement Alarm

Your monitor comes with the movement alarm activated. When switching on your monitor it will alarm, with or without the Sensor Pad plugged in, if no movement is detected. Deactivate the movement function to use the monitor without the Sensor Pad.



Cord Safety

Ensure the Nursery Unit is at least 1 metre away from your baby's cot. The Sensor Pad cord must always be kept out of reach of baby and secured using the cord cover kit provided.

PLEASE FOLLOW THE INSTRUCTIONS CAREFULLY FOR CORRECT SETUP

Please DO NOT return this product to the store. For assistance please contact our helpline on **0345 009 1789** or email **helpline@babyhelpline.co.uk**
Mon - Fri 10am - 4pm, excluding bank holidays.

TABLE OF CONTENT

 WARNINGS	3
AC300 SETUP REQUIREMENTS.....	6
STEP 1 - Installing the Sensor Pad	7
STEP 2 - Setting up the Nursery Unit.....	10
STEP 3 - Testing and getting to know your monitor.....	11
Troubleshooting	13
Technical specifications.....	14
Limited warranty	14

OWNER'S MANUAL

KEEP YOUR OWNER'S MANUAL FOR FUTURE REFERENCE.

PLEASE READ THE WARNINGS AND INSTRUCTIONS CAREFULLY BEFORE ASSEMBLING & USING THE PRODUCT.

FAILURE TO FOLLOW THE WARNINGS AND THE INSTRUCTIONS COULD RESULT IN SERIOUS INJURY OR DEATH OR DAMAGES TO THE PRODUCT.

THE SENSOR PAD FEATURE IS NOT FOR USE WITH ADULTS, CHILDREN OR INFANTS OLDER THAN 24 MONTHS.

THE SENSOR PAD IS NOT INTENDED TO BE USED TO DETERMINE IF A CHILD IS OUT OF THE CRIB.

WARNING

Adult assembly required.

Keep small parts away from children when assembling.



This Angelcare Monitor is a Personal Care Product. Please DO NOT return this to the store where you purchased it from. If you have any questions or require assistance please call the Angelcare Helpline on 0345 009 1789 or email helpline@babyhelpline.co.uk.

The Baby Helpline is open Monday to Friday, 10am to 4pm. The helpline is closed on bank holidays.

For additional FAQs and to download instruction manuals visit; www.angelcare.co.uk.

To order spare parts for your Angelcare Baby Monitor visit; www.megababy.co.uk.

WARNING

1. THIS PRODUCT CANNOT REPLACE RESPONSIBLE ADULT SUPERVISION. This product is designed to aid in the monitoring of your child. When using the monitor, you must still provide the supervision necessary for the continued safety of your child. Monitoring of premature babies, or those considered to be at risk, should always be carried out under the supervision of a health professional. This monitor SHOULD NOT be used as a medical device, nor as a device to prevent Sudden Infant Death Syndrome (SIDS)

2. STRANGULATION Hazard — Children have STRANGLED in cords. NEVER use Sensor Pad(s) without the protective cord covering. Check protective cord covering before each use. Immediately discontinue use of Sensor Pad(s) if protective covering is damaged or broken.

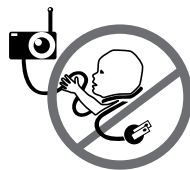

3. ALWAYS be sure to immediately check on baby whenever an alarm sounds.

4. DO NOT use monitor near water (such as bath tub, sink, etc.).



5. Keep monitor AWAY from heat sources (such as stoves, radiators, etc.).

6. ALWAYS place the Nursery Unit on a flat surface in an upright position and allow for proper ventilation. DO NOT place on sofas, cushions, beds, etc. which may block ventilation.

7. This product is NOT a toy. DO NOT allow children to play with it.

8. This product contains small parts. Adult assembly required. Exercise care when unpacking and assembling the product and keep small parts away from children.

9. When using the monitor, the room temperature should be between 10 °C and 40 °C.

BATTERY WARNING

10. DO NOT mix old and new batteries. DO NOT mix alkaline, standard or rechargeable batteries. Insert batteries with correct polarity. DO NOT short-circuit supply terminals. ONLY use the recommended batteries or equivalent (volts and size). Remove batteries when product is stored for long periods of time or when batteries are exhausted. Dispose exhausted batteries properly.

11. IMPORTANT SAFETY INSTRUCTIONS

11.1 Read these instructions - All the safety instructions should be read before the product is operated.

11.2 Keep these instructions. The safety and operating instructions should be retained for future reference.

11.3 Heed all warnings - All warnings on the product and in the operating instructions should be adhered to.

11.4 Follow all instructions - All operating and use instructions should be followed.

11.5 Water and moisture - DO NOT use this apparatus near water. For example, near a bath tub, wash bowl, kitchen sink, laundry tub, in a wet environment or near a swimming pool and the like. Care should be taken so that objects DO NOT fall onto units and that liquids are not spilled into either unit or Sensor Pad through its openings.

11.6 Cleaning - Disconnect all units before cleaning. DO NOT immerse in water any part of the Nursery Unit. Clean only with dry cloth. DO NOT spray with cleaning products or solvents. Wipe Sensor Pad with a cloth moistened very slightly with an antiseptic or mild detergent.

11.7 Ventilation - DO NOT block any ventilation openings. Allow for proper ventilation when unit is in use. DO NOT cover the Nursery Unit with any object such as a blanket. DO NOT place it in a drawer or in any location which would muffle the sound or interfere with the normal flow of air.

11.8 Heat sources - DO NOT install near any heat sources such as radiators, heat registers, stoves, TVs or other apparatus (including amplifiers) that produce heat. Heat can damage the case or electrical parts.

11.9 Power cord protection - Protect the Sensor Pad cord from being walked on or pinched by furniture or other items - Power supply cords should be routed so that they are not likely to be walked on or pinched by items upon or against them, paying particular attention to cords and plugs, convenience receptacle, and the point where they exit from the product.

11.10 Accessories - Only use attachments/accessories specified by the manufacturer. DO NOT place this product on an unstable cart, stand, tripod, bracket or table. The product may fall, causing serious injury to a child or adult and serious damage to the product. Use ONLY with a cart, stand, tripod, bracket or table recommended by the manufacturer or sold with the product. Any mounting of the product should follow the manufacturer's instructions.

11.11 Servicing - DO NOT attempt to service this product yourself as opening or removing covers (except battery doors) may expose you to dangerous voltage or other hazards.

11.12 Replacement parts - When replacement parts are required, be sure the replacement parts specified by the manufacturer have the same characteristic as the original part. Unauthorized substitution may result in fire, electric shock or other hazards.

11.13 Usage - This baby monitor is intended as an aid. It is NOT a substitute for responsible and proper adult supervision and should not be used as such. Use this appliance ONLY for its intended use as described in this manual.

11.14 Object and Liquid Entry - NEVER push objects of any kind into this product through casing slots as they may touch dangerous voltage points or short out parts that could result in a risk of fire or electric shock. NEVER spill liquid of any kind on the product.

11.15 STRANGULATION Hazard - Children have STRANGLED in cords. NEVER use Sensor Pad(s) without the protective cord covering. Check protective cord covering before each use. Immediately discontinue use of Sensor Pad(s) if protective covering is damaged or broken.

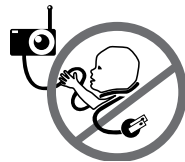

11.16 Vibration Source - When the monitor is in use, DO NOT use a crib mobile or other crib accessories that may produce vibrations. Other sources of vibrations may include fans, washing machines, loud music, etc. These sources of vibration may interfere with the performance of your Angelcare® monitor and the alarm will not sound if it continues to detect any movement other than your baby's. Be sure all vibration sources are eliminated before using the monitor.

You may experience false alarms for several reasons. The most common reason is the Nursery Unit has not been turned OFF after you have removed your baby from the crib. Another reason is the Sensor Pad has not been placed under the mattress properly.

Be sure the Sensor Pad is on a flat, firm surface with the printed side facing up. The sensitivity level may also need to be adjusted. Refer to step 3.1. Always be sure to immediately check on baby whenever an alarm sounds.

11.17 Sensor Pad - If the crib has a spring or slat base, place a hard board between the crib base and the Sensor Pad measuring at least 33 x 33 cm and 6 mm thick. Only use your Angelcare® monitor in a stationary sleeping environment such as a crib where the Sensor Pad can rest on a completely flat, firm surface.

12. IMPORTANT SAFETY INSTRUCTIONS RELATED TO USE OF BATTERIES

12.1 Use ONLY the type and size of batteries specified in the owner's manual. There is a risk of explosion if batteries are replaced with an incorrect type.

12.2 DO NOT use rechargeable batteries in the Nursery Unit. Use alkaline batteries ONLY.

12.3 DO NOT dispose batteries in fire. They may explode. Check with local regulations for possible special disposal instructions.

12.4 Exercise care in handling batteries in order not to short out the batteries with conducting materials such as rings, bracelets and keys. Overcharging, short circuiting, reverse charging, mutilation, or incineration of batteries must be avoided to prevent one or more of the following occurrences: release of toxic materials, release of hydrogen and/or oxygen gas, rise in surface temperature.

12.5 DO NOT attempt to rejuvenate the batteries provided with or identified for use with this product by heating them. Sudden release of battery electrolyte may occur, causing burns or irritation to eyes or skin.

12.6 If and when necessary, the batteries must be replaced with identical new ones or equivalent (volts and size). If a battery to be replaced is connected with other batteries in series, replace the other batteries at the same time as well. DO NOT mix old and new batteries.

12.7 Reverse polarity installation of the batteries in the end product must be avoided. Reverse insertion of batteries can cause charging, and that may result in leakage or explosion.

12.8 Remove batteries from this product if you store the product over 30 days because the batteries could leak and damage the product.

12.9 Discard 'dead' batteries as soon as possible since 'dead' batteries are more likely to leak in a product. If a battery has leaked or vented, it should be replaced immediately using protective gloves.

12.10 DO NOT store this product, or the batteries provided with or identified for use with this product, in high-temperature areas.

SETUP REQUIREMENTS

MOVEMENT MONITOR

Model AC300

INCLUDED:

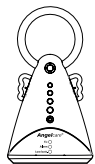

Nursery Unit

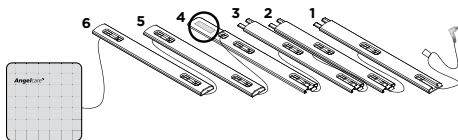

1 Sensor Pad (AC300) or
2 Sensor Pads (AC300-2SP)
with pre-installed cord covers

YOU MUST PREPARE:

One hardboard (not included)
Thickness: **6 mm**
Minimum dimensions:
33 cm x 33 cm
Maximum dimensions:
equal to the mattress size



Hardboard

IMPORTANT

The hardboard must be larger than the Sensor Pad surface area or in the case of the AC300-2SP of two Sensor Pads.

WHAT YOU WILL NEED (NOT INCLUDED):



2 AA Alkaline
Batteries



Miniature Philips
Screwdriver

BABY'S ROOM:

IMPORTANT

Place the crib near a supporting wall and far from air currents. Install the Nursery Unit on a flat, stable surface facing the crib at a distance of at least 1 meter.

Make sure to plug the adapter to the socket outlet nearest to the equipment and that it is easily accessible.

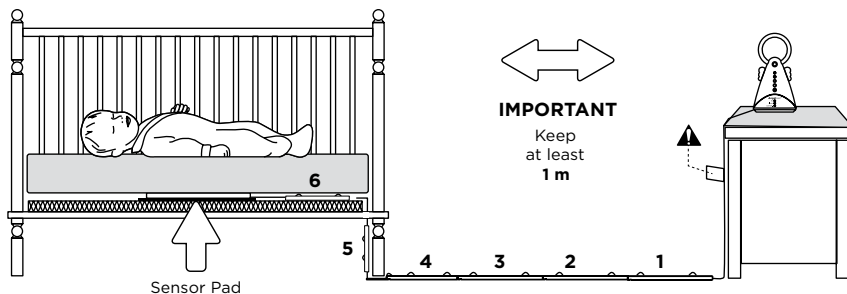

Sensor Pad

STEP 1 - INSTALLING THE SENSOR PAD

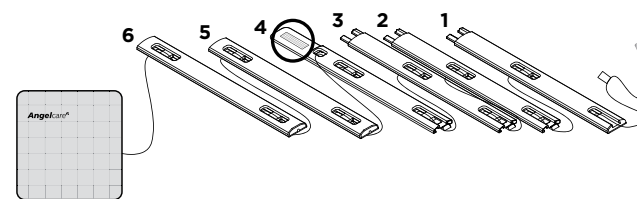

Sensor Pad with pre-installed cord covers

Cord covers 1, 2, 3, 4:
Position on floor

Cord cover 4:
Contains double sided tape to securely install beneath crib leg

Cord cover 5:
Position vertically between mattress support and floor

Cord cover 6:
Place under the mattress

! WARNING

STRANGULATION HAZARD.

Children have been STRANGLED by cords.

- NEVER use Sensor Pad (s) without the protective cord covering.
- Because of the serious strangulation risk to infants and toddlers, parents and caregivers should never place the Nursery Unit within 1 m of a crib.
- **NEVER** use Sensor Pad without the cord covers. Check cord covers before each use to ensure it is securely placed under the leg of the crib. Discontinue use of Sensor Pad if any cord covers are damaged or broken.

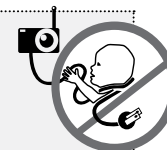

1.1 - SELECT A LOCATION FOR THE NURSERY UNIT

Select a location for the Nursery Unit that is at least **1 meter away from the crib.**

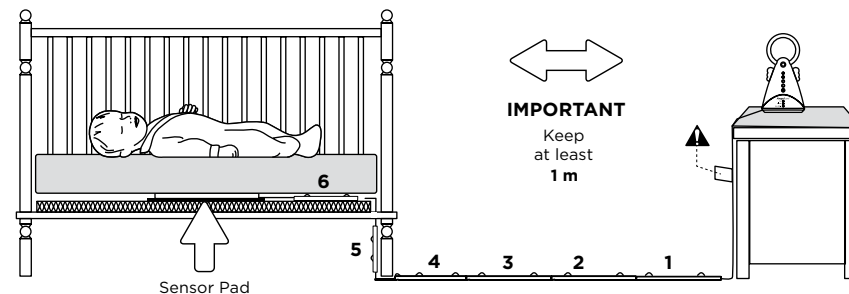

Sensor Pad

IMPORTANT
Keep
at least
1 m

1.2 SELECT THE CRIB LEG YOU WILL BE USING TO SECURE THE CORD COVERS

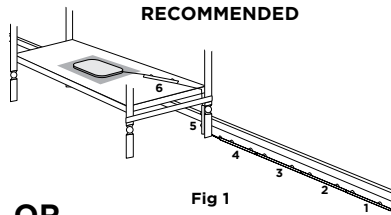

OR

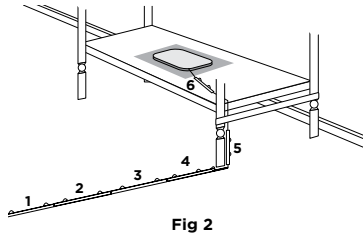

Use the crib leg by the wall closest to the Nursery unit (**fig 1**). In cases where the Nursery Unit is across the room, use the leg closest to the Nursery Unit to position the covered wire (**fig 2**). It is always preferable that the covered cord run along a wall.

1.3 - INSTALL THE SENSOR PAD ON THE MATTRESS SUPPORT

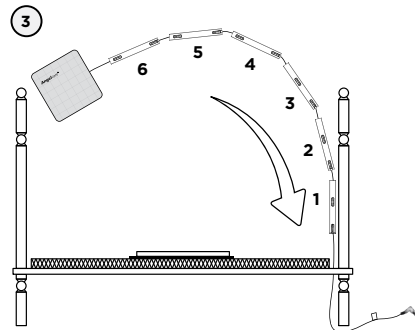
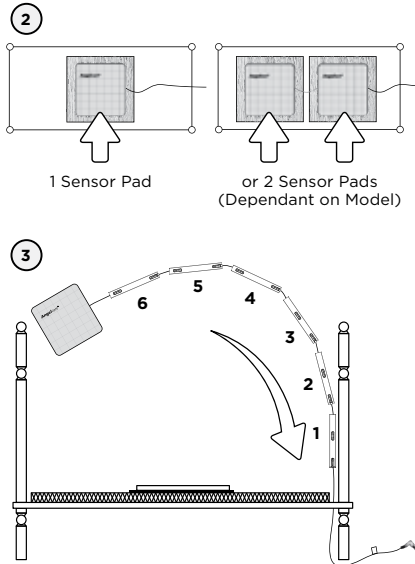

- 1) Remove the mattress from the crib.
- 2) Place the Sensor Pad - printed side up - on top of the **hardboard** at the center of the crib.
- 3) Run the connection pin, warning label and the first 5 cord covers down along the backside's of the crib leg, **between the mattress support and the inside edge of the crib**.
- 4) Bring the first 4 cord covers down the floor, and keep the 5th cord cover vertically, along the backside of the crib leg, **(between the mattress support and the inside edge of the crib)**.
- 5) Remove any cord slack to make sure no parts of the cord are loose.

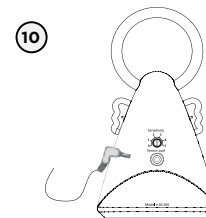
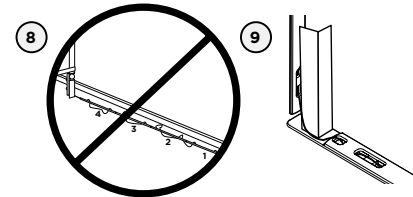
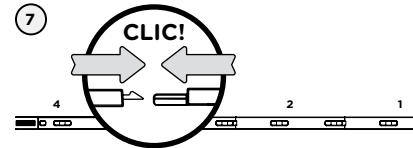
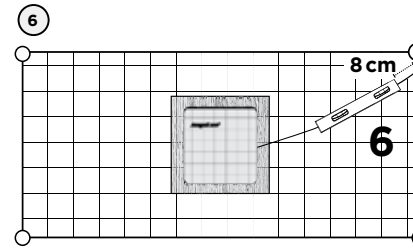

- 6) Place the 6th cord cover approximately 8 cm from the edge of the mattress support.
- 7) Snap together the remaining cord covers that will run along the floor.
- 8) Remove any cord slack to make sure no parts of the cord are loose.
- 9) Peel off the double-sided tape on the 4th cord cover and place it securely under the crib leg.
- 10) Install the Nursery Unit on a flat, stable surface facing the crib at a distance of at least 1 m and plug the Sensor Pad cord into the Nursery Unit.
- 11) Check to make sure the Sensor Pad has not moved from position.
- 12) Place the mattress back inside the crib.

The Sensor Pad functions with any size and type of mattress except memory-foam mattresses and hollow frame mattresses.

The hardboard maintains a constant pressure on the Sensor Pad, enabling it to detect the baby's movements even when the baby is at the edges of the crib.

WARNING STRANGULATION HAZARD

- Remove all slack from Sensor Pad Cord.
- When lowering the mattress support as your child grows, slide the vertical Cord Cover (5) upward so it remains approximately in the center between the mattress support and the floor. Slide the Sensor Pad Cord through the Floor Cover to eliminate any additional slack.

- The Sensor Pad is not designed for use with adults, children or infants older than 24 months.
- Discontinue use of the Sensor Pad when child is older than 24 months. Remove sensor pad from crib and store for future use.
- BEFORE FIRST TIME USE: To test that the unit is ready for use, refer to instruction manual on how to test that the installation has been done



STEP 2 - SETTING UP THE NURSERY UNIT

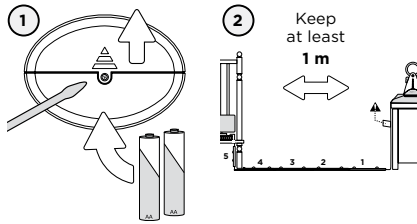

- 1) Remove the battery door and insert 2 AA Alkaline Batteries (not included).
- 2) Place the Nursery Unit at a **minimum of 1 m** away from the crib.

NURSERY UNIT:

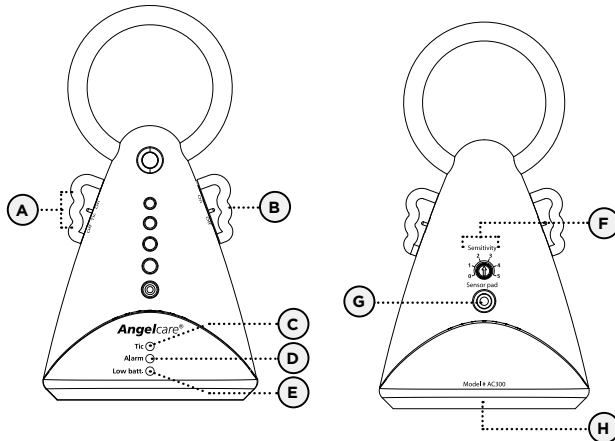

Front Side

Back Side

- A) Movement 'TIC' ON/OFF button
- B) POWER ON/OFF switch
- C) Movement 'TIC' Indicator (flashing)
- D) Alarm Indicator
- E) Low battery indicator
- F) Movement sensitivity adjustment dial
- G) Sensor Pad socket
- H) Battery Door (not shown)

STEP 3 - TESTING AND GETTING TO KNOW YOUR MONITOR

Test monitor when moving Sensor Pad to a new location to ensure sensitivity is adjusted correctly to the new padding or mattress.

3.1 - SENSOR PAD

TO TEST SENSOR PAD:

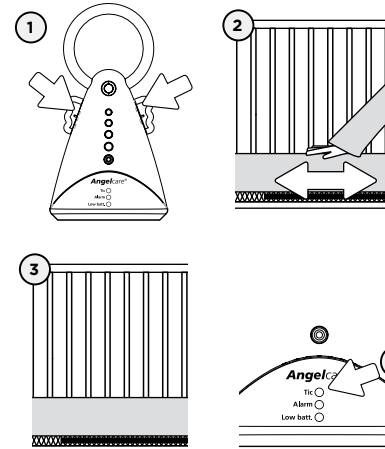

- 1) Turn ON Power/'TIC' switch
- 2) Move your hand lightly on the mattress.
- 3) Remove your hand from the mattress. After 15 seconds you will hear a 'TIC' pre-alarm sound.
- 4) 5 seconds later the alarm will sound and the red light (Alarm Indicator) will flash continuously.

MOVEMENT ALARM

- If NO movement is detected after 15 seconds you will hear a single 'TIC' pre-alarm sound from the Nursery Unit.
- If after a further 5 seconds there is still NO movement detected, Nursery Unit speakers will emit a loud warning sound.

IF THE ALARM DOES NOT SOUND

- Avoid contact with crib while Sensor Pad is in operation.
- Place crib near a supporting wall.
- Adjust Sensor Pad sensitivity level.

TO STOP THE ALARM

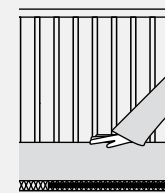

Place your hand back on the mattress.

OR

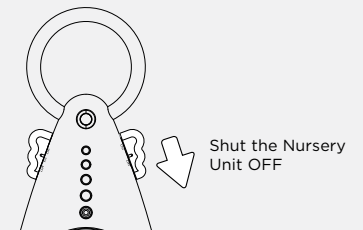

Shut the Nursery Unit OFF

TO ADJUST SENSOR PAD SENSITIVITY LEVEL:

Turn the Nursery Unit sensitivity dial from less sensitive (0) to very sensitive (5).

For optimal results begin with the sensitivity level dial on the 3rd bar, adjusting the sensitivity by half a bar increases or decreases as required.

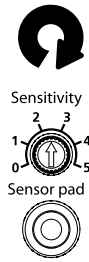

IMPORTANT

- The Sensor Pad is not designed for use with adults, children or infants older than 24 months.
- Once you are finished using the Sensor Pad, please remove it from the baby's crib and store it away.

NOTE:

If you are experiencing false alarms, adjust the sensitivity level.

3.3 - BATTERIES

The Angelcare® Movement Monitor is battery operated.

- Batteries will last approximately 3 to 4 months.

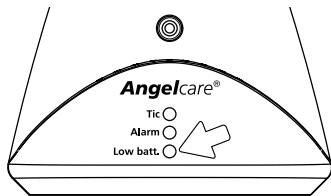

BATTERY ALARM

- When Nursery Unit produces a rapid clicking sound, change batteries promptly.

YOU ARE NOW READY TO USE YOUR MONITOR

3.4 - ACTIVATING THE TIC FUNCTION

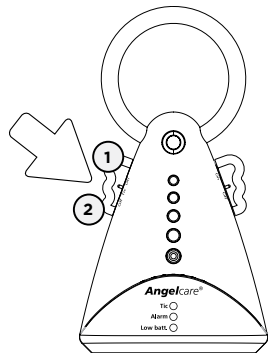

- 1) **Slide switch ON** to activate the 'TIC' function. A green light will flash as well to indicate movement.
- 2) **Slide switch OFF** to remove 'TIC' sound. The green light will continue to flash to indicate movement function is still working.

NOTE:

If the green light does not appear but a red light is flashing; or if there are false alarms, adjust the sensitivity level (**Step 3**).

TROUBLESHOOTING

FALSE ALARMS

- Turn OFF the Nursery Unit.
- Verify the connection between the Sensor Pad and the Nursery Unit. Unplug and reconnect the cord.
- Make sure there is no bedding between the mattress and the Sensor Pad.
- If the crib has a spring or slat base, place a hardboard between the crib base and the Sensor Pad measuring at least 33 x 33 cm and 6 mm thick.
- Make sure Sensor Pad is positioned as described under the setup requirements. Sensitivity may need to be adjusted, refer to step 3.1.

ALARM WILL NOT SOUND

- Avoid contact with the crib when the monitor is ON.
- Place crib near a solid supporting wall to avoid Sensor Pad from detecting movement from outside the crib.
- Turn OFF crib mobile, fans, loud music or anything else that may cause vibration.
- You may need to decrease the sensitivity, refer to step 3.1.

ALARM INDICATOR LIGHT IS FLASHING RED (MONITOR IS BARELY DETECTING MOVEMENT)

- Make sure there is no bedding between the mattress and the Sensor Pad.
- The Sensor Pad must rest on a completely flat and firm surface. If the crib has a spring or slat base, place a hard board between the crib base and the Sensor Pad measuring at least 33 x 33 cm and 6 mm thick.
- Make sure Sensor Pad is positioned as described under the setup requirements. Sensitivity may need to be adjusted, refer to step 3.1.

NO POWER

- Check or replace batteries.
- Make sure Monitor is ON.

If you experience a problem that is not noted in this manual, please **DO NOT return this product to store**. For assistance please contact our helpline on 0345 009 1789 or email helpline@babyhelpline.co.uk.

Monday to Friday, 10am to 4pm, excluding bank holidays.

TECHNICAL SPECIFICATIONS

Power Supply:

2 AA alkaline batteries (not included)

Caution: To reduce the risk of electric shock, do not expose this product to rain or moisture.

Batteries:

- DO NOT mix old and new batteries.
- DO NOT mix alkaline and standard (carbon-zinc) batteries.

Hereby, Angelcare Monitors Inc declares this baby monitor is in compliance with the essential requirements and other relevant provisions of Directive 2004/108/ EC.

The EU declaration of conformity can be obtained through your local distributor. Please refer to address in the manual

LIMITED WARRANTY

Angelcare® warrants to the original owner of this product that Angelcare®, Movement monitor (model AC300) is free from any material and workmanship defects, for a period of one (1) year from the date of the original purchase. If this monitoring system fails to function properly when used as directed under normal conditions within the one year period, Angelcare® will either repair or replace the product, at our discretion, free of charge. Please contact your distributor.

The product must be accompanied by a proof of purchase, either a bill of sale or other proof that the monitoring system is within the warranty period. Angelcare® will bear the cost of repairing or replacing the product and shipping it back to you.

This warranty does not apply to a product which has been damaged as a result of improper maintenance, an accident, improper voltage supply or any other form of misuse. The warranty is also void if the owner repairs or modifies the product in any way. Angelcare® is not liable for any incidental or consequential damages with regard to this product. The warranty also excludes any liability other than what is stated above. No other warranty is given.

This warranty does not cover products and accessories which are not Angelcare-branded, or any problems that result from usage that is not in accordance with product instructions, failure to follow the product instructions, or problems caused by using accessories, parts or components not supplied by Angelcare.

LEGAL RIGHTS VARY FROM COUNTRY TO COUNTRY. SOME COUNTRIES DO NOT ALLOW THE EXCLUSION OR LIMITATION OF INCIDENTAL OR CONSEQUENTIAL DAMAGES, SO THE ABOVE LIMITATIONS MAY NOT APPLY TO YOU.

WE ARE NOT IN ANY WAY RESPONSIBLE FOR ANY OUTCOME RESULTING FROM THE USE OF THIS PRODUCT.

IMPORTANT!

This Angelcare® monitor is a personal care product. Please do not return this product to the store. If you have questions or need help, please call your distributor before returning this product.



PROTECT THE ENVIRONMENT

This electronic equipment contains reusable material and must not be disposed with domestic waste. Please take it to a collecting point for electric and electronic equipment (ask your local authorities for details).

..... This Angelcare Baby Monitor is a Personal Care Product. **Please DO NOT return this to the store**, but contact us initially for advice and assistance:

Angelcare Helpline on **0345 009 1789**

Website: www.angelcare.co.uk

Email: helpline@babyhelpline.co.uk

..... NOTE: Helpline is open Monday to Friday, 10am to 4pm, excluding bank holidays.

