

# Haier

## HB22FWRSSAA

**GB** Combined fridge - freezer - Instruction for use

English only version



**GB**

#### **DECLARATION OF CONFORMITY**

The manufacturer of the product/s described herein, to which this description refers, declares on its sole responsibility that the product/s meet the relevant fundamental safety, health and protection requirements of the relevant EU guidelines and that the corresponding test reports are available for examination by the relevant authorities and can be requested from the seller of the appliance, especially with regard to CE Declaration of Conformity issued by the manufacturer or with the manufacturer's approval. Moreover, the manufacturer declares that the parts of the appliance described in this user manual, which come into contact with fresh food, do not contain any toxic substances.

**D**

#### **KONFORMITÄTSERKLÄRUNG**

Der Hersteller der/des hierin beschriebenen Produkte(s) auf welche(s) sich diese Erklärung bezieht, erklärt hiermit in alleiniger Verantwortung, dass diese(s) die einschlägigen, grundlegenden Sicherheits- Gesundheitsund Schutzanforderungen der hierzu bestehenden EG Richtlinien erfüllen und die entsprechenden Prüfprotokolle, insbesondere die vom Hersteller oder seinem Bevollmächtigten ordnungsgemäss ausgestellte **CE-Konformitätserklärung** zur Einsichtnahme der zuständigen Behörden vorhanden sind und über den Geräteverkäufer angefordert werden können.

Der Hersteller erklärt ebenso, dass die Bestandteile der in dieser Bedienungsanleitung beschriebenen Gerät, welche mit frischen Lebensmitteln in Kontakt kommen können, keine toxischen Substanzen enthalten.

**F**

#### **DECLARATION DE CONFORMITE**

Par la présente, le fabricant du (des) produit(s) décrit(s) se rapportant à la présente déclaration, déclare sous sa propre responsabilité que ce(s) produit(s) satisfait(font) aux normes de sécurité requises en matière de santé personnelle et de protection et sont conformes aux directives CE en la matière et que les procès-verbaux d'essai correspondant, notamment la déclaration de conformité CE régulièrement émise par le fabricant ou par le délégué relatif pour la prise de connaissance de la part des autorités compétentes, existent et peuvent être remis au vendeur de l'appareil.

Le fabricant déclare en outre que les composants de l'appareil décrits dans la notice d'utilisation pouvant entrer en contact avec les aliments frais ne contiennent aucune substance toxique.

**I**

#### **DICHIARAZIONE DI CONFORMITÀ**

Con la presente, il produttore del(dei) prodotto(i) qui descritto(i) a cui si riferisce la presente dichiarazione dichiara dietro propria responsabilità che questo(i) prodotto(i) soddisfa(no) i requisiti di sicurezza, salute personale e protezione di base pertinenti alle direttive CE esistenti in materia e che i relativi verbali di prova, in particolare la dichiarazione di conformità CE emessa regolarmente dal produttore o dal relativo delegato per la presa in visione da parte delle autorità competenti, sono presenti e possono essere richiesti al rivenditore dell'apparecchio.

Il produttore dichiara inoltre che i componenti dell'apparecchio descritto nelle presenti istruzioni per l'uso, che possono venire a contatto con alimenti freschi, non contengono alcuna sostanza tossica.

**E**

#### **DECLARACIÓN DE CONFORMIDAD**

El fabricante del(de los) producto(s) aquí descrito(s) declara bajo su propia responsabilidad que este(os) producto(os) cumple(n) los correspondientes requisitos para la seguridad, salud personal y protección de acuerdo con las directivas CE existentes en esta materia y que las respectivas actas de aprobación, en particular la declaración de conformidad - CE emitida regularmente por el fabricante o por su representante autorizado, se encuentran disponibles para el examen por parte de las autoridades competentes, pudiendo ser exigidas al vendedor del aparato.

El fabricante también declara que los componentes del aparato descrito en las presentes instrucciones para el uso, que pudieran entrar en contacto con alimentos frescos, no contienen sustancias tóxicas.

**NL**

#### **VERKLARING VAN OVEREENSTEMMING**

De fabrikant van het/de hierin beschreven product/producten waarop deze verklaring van toepassing is, verklaart hierbij geheel onder eigen verantwoordelijkheid dat dit product/deze producten in overeenstemming is/zijn met de van toepassing zijnde, fundamentele veiligheids-, gezondheids- en beschermingseisen van de hiertoe bestaande EG-richtlijnen en dat de bijbehorende testrapporten, in het bijzonder de door de fabrikant of zijn gevolmachtigde volgens de voorschriften opgestelde CE-Verklaring van Overeenstemming ter inzage door de bevoegde instanties beschikbaar zijn en via de verkoper opgevraagd kunnen worden.

De fabrikant verklaart eveneens, dat de onderdelen van het in deze handleiding beschreven apparaat die met verse levensmiddelen in contact kunnen komen, geen giftige bestanddelen bevatten.

# Table of contents

---

The appearance, color, design of the refrigerator may vary from the actual product

Product Features .....	1
Name of Components.....	2
Safety Notice .....	3-6
Disassembly and Assembly of Door .....	7-8
Preparation .....	8-9
Connecting the Water Supply Line .....	10
Getting Started .....	11
Product Function .....	12-14
How to save energy.....	15
About Refrigerating Chamber.....	15-16
Precautions for Refrigerating Food.....	17
Smart Use of Refrigerating Chamber .....	18
About Freezing Chamber .....	18-19
Usage of Ice Maker and the Cold Water Dispenser .....	20
How to Use the Water Dispenser .....	21
Water Dispenser Precautions .....	21
Cleaning and Disuse .....	22-25
Suspension.....	25
Cleaning and Disuse .....	26
FAQ (stange voice in refrigerator) .....	27-28
Safety instructions .....	29-30

- Please read this Operation Manual carefully before using the appliance.
- Keep this Manual for future reference.
- See the physical object for the appearance, color and the door pattern.

# Product Features

---

## **Ice-making function**

Manual ice maker can satisfy user's different need for ice.

## **Full width shelf design, more convenience for storing and taking food.**

## **Fuzzy Function**

The refrigerator can be automatically adjusted to the best refrigerating condition according to the chamber temperature and ambient temperature without human intervenes.

## **Super large and super luxurious design**

The refrigerator has super large capacity, super large refrigerating and freezing chamber, as well as super luxurious inter design.

## **Fluoride-free, frostless, complete air cooling refrigeration, deep cooling, and rapid freezing.**

## **Defrost and pre-refrigeration**

The refrigerator will make judgment on the temperature in the refrigerator before defrosting, and the compressor will automatically and rapidly refrigerate after defrosting.

## **Equipped with condensing unit, heat dissipation by blower, better refrigeration effect, and long service life of compressor.**

## **Open door alarm, touch-sensitive button, large-screen LED display.**

## **Drawers have track way. It can be pushed and pulled smoothly.**

## **Deodorant Brick**

It separates the refrigerating chamber and freezing chamber, avoiding tainting.

# Name of Components

## Refrigerating Chamber

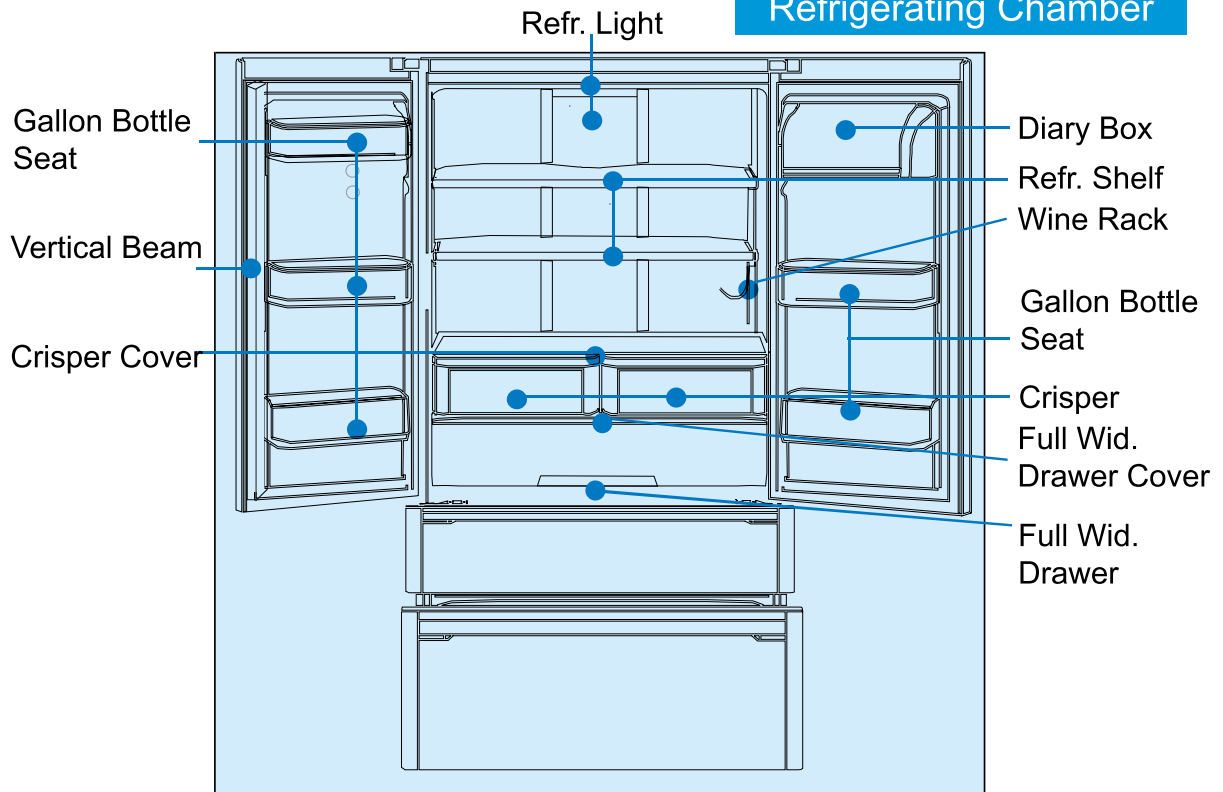

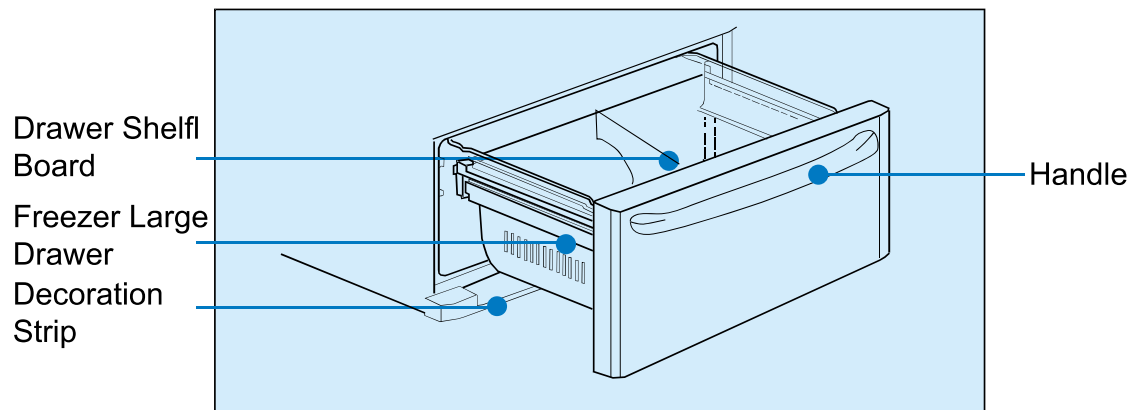
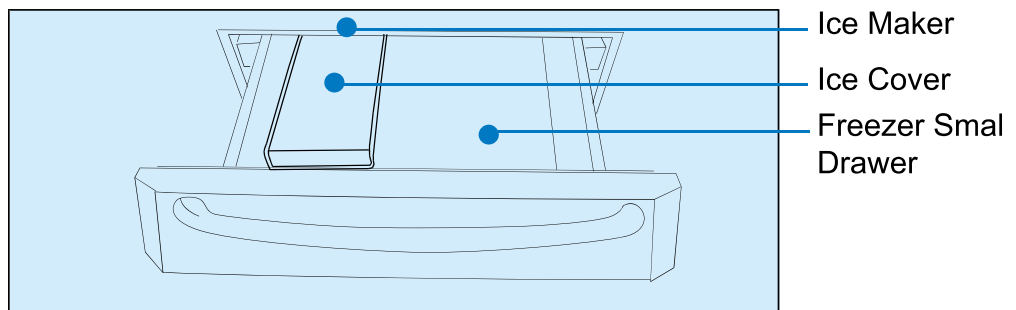

## Freezing Chamber



# Safety Notice

Dear user,

Thank you for using haier Refrigerator! For your better understanding of the instruction and better use of the product, we explain the signs appeared in the instruction as follow:

 <p>Prohibit</p>	<p>All action with this sign is prohibited; it may cause product damages or endanger the personal safety of users.</p>
 <p>Warning</p>	<p>All action with this sign is related to the safe use of products and the personal safety of users. Operation must follow the requirement strictly; otherwise it may cause product damages or endanger the personal safety of users.</p>
 <p>Caution</p>	<p>Any action with this sign shall be paid more attention. Otherwise it will cause product damages and other damages due to improper operation.</p>

The refrigerator use AC 220-240V/50Hz power supply.

If the voltage variation is large (greater than 187-242V), it may cause the refrigerator fail to start, and the master control board and compressor will burn out, or compressor has abnormal noise. At this time, auto stabilizer of 750W or above must be added.

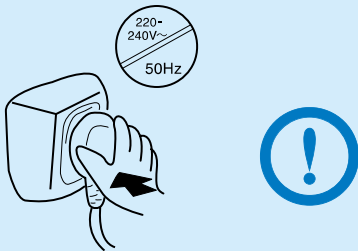

Independent dedicated socket must be used and reliably grounded.

The power cord of the refrigerator has three-pin plug (for grounding) which complies with standard. In no circumstances the third pin of the power cord for grounding shall be cut or dismantled. After the refrigerator is installed, the plug shall be accessible to facilitate plug in and out.

Warning! The plug of power cord shall be attached firmly with the socket; otherwise it may cause a fire

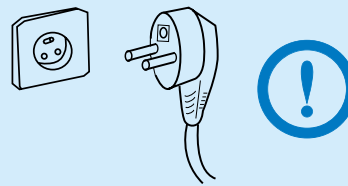

When the power cord is damaged  
When the power cord is damaged or the plug is worn, do not use. The worn or damaged power cord must be replaced at the specified maintenance provider by the manufacturer.

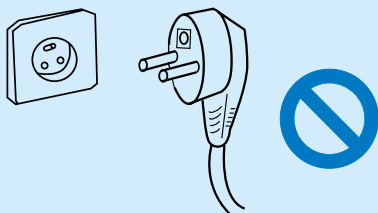

Detach the power plug when:

1. Before cleaning and maintenance, please detach the power plug of the refrigerator.
2. When replacing damaged lighting devices, the power plug of the refrigerator shall be detached to prevent electric shock.

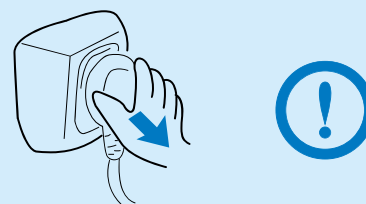

# Safety Notice

## Do not damage the power cord

1. Do not pull the power cord to disconnect the plug of refrigerator. The plug shall be hold tightly and directly detached from the socket.
2. The body of refrigerator shall not press on the power cord and do NOT stamp on the power cord.
3. Please be careful when moving the refrigerator from the wall, do not press or damage the power cord.

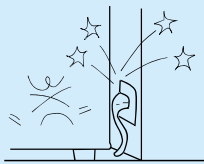

It is recommended not to place appliance such as power socket, regulated power supply, microwave oven on the refrigerator, and do not use electrical appliances Inside the refrigerator to avoid electromagnetic interference or other accident.

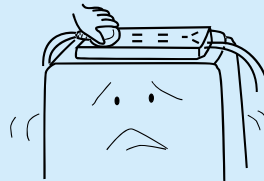

Do not store or use gasoline or other combustibles around the pump to avoid fire.

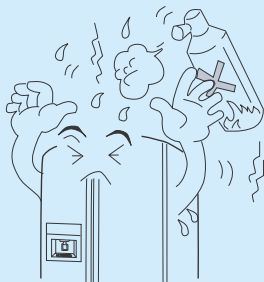

When flammable gas such as natural gas leaks

1. Close the valve which leaks the gas,
2. Open house door and window,
3. Do not unplug/plug the power plug of refrigerator or other electrical appliance.

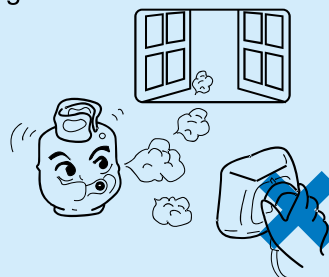

Never sit on the bottle seat inside the refrigerator door to avoid the door tiles or the bottle seat damages, and the refrigerator falls to hurt people;when take in and out the food, please do not stamp on the door of freezing chamber and body of refrigerator. Do not sit on the drawers to avoid therefrigerator falling down to hurt people.



After the refrigerator is in operation, do not touch the cold surface in the freezing chamber, particularly when hands are damp or wet. Skin may adhere to these extremely cold surfaces.



# Safety Notice

When open and close the door, the handle shall be hold to open and close. The space between the doors and between the doors and the body is small. Cautions shall be made not to put your hands in these spaces to avoid jam your fingers. When open and close the doors, don't let children approach to avoid hurt the children.



Do not use water to spray on or flush the refrigerator, and do not place the refrigerator at wet place or the place which is easy to be splashed with water to avoid the impact to the electric insulation performance of the refrigerator.



The refrigerator shall be placed far from heat source and avoid direct sunshine to prevent from impact to performance.



Do not place the refrigerator at damp or wet place and the place which is easy to be splashed with water. The splashed water and dirt shall be wiped out with soft cloth in a timely manner to avoid rustiness and impact to electric insulation.

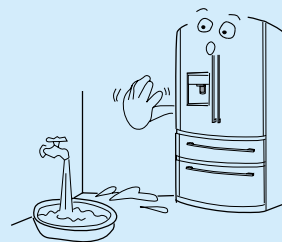

Dismantle and alter the refrigerator is prohibited, and the refrigerating pipeline shall not be damaged. The maintenance of the refrigerator must be carry out by professional personnel.

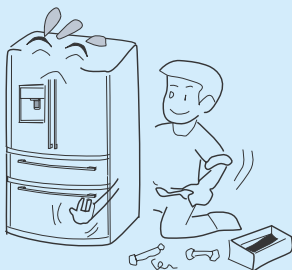

When the refrigerator falls into disuse, please remove the door, door seal, and shelves, and place them in proper location to avoid children entering into the refrigerator and causing accident.

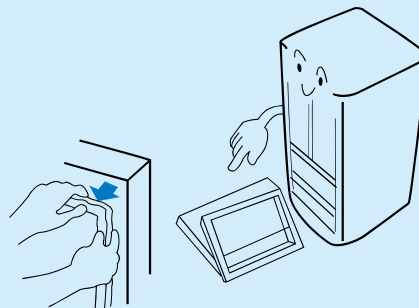



# Safety Notice

## Leveling Your Refrigerator

The Refrigerator shall be placed on flat and solid ground. If it's necessary to block up the refrigerator, flat, solid, and nonflammable cushion block shall be used. Do not use the package foam to block up. Adjustable leveling legs can be adjusted by turning them clockwise (as shown by the arrow) to raise your refrigerator or by turning them counterclockwise to lower your refrigerator if your refrigerator is not leveled.

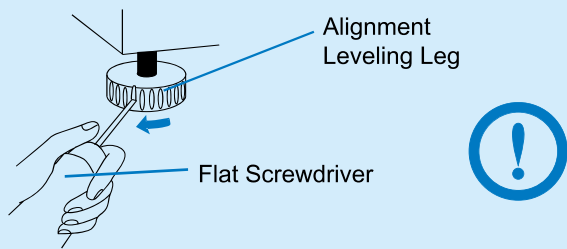

## Door Alignment

If the two doors of refrigerating chamber is not aligned, please align the doors as following:

1. Use one hand to raise the door at the hinge in the middle.
2. The other hand insert a spacer with pliers, as shown.
3. Insert remained spacers till the doors is aligned. (3 cramp rings are provided with the product)

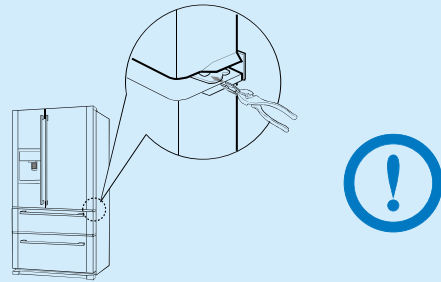

Do not put bottled beer or drinks into the freezing chamber to avoid frost cracking.

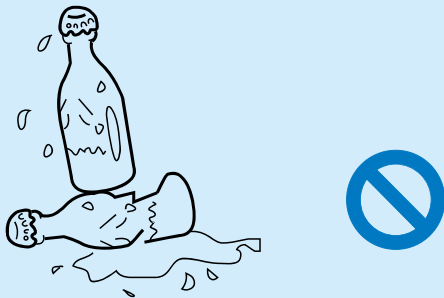

The refrigerator shall be placed in well-ventilated place. Clearance of 10cm or above shall be left around the refrigerator including the back.

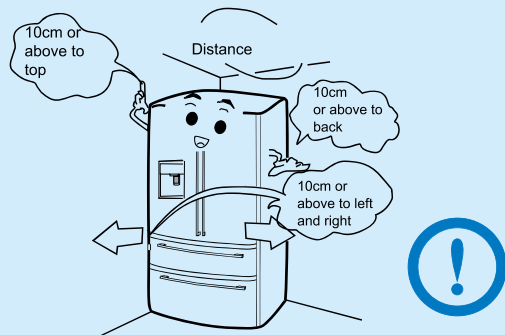

Never place combustibles, explosives, highly corrosive acid/alkali in the refrigerator.



The product is household refrigerator. According to the national standard, household refrigerator is only suitable for food, cannot be used for other purpose, such as storing blood, chemicals, cosmetics, medicine, and biological products.

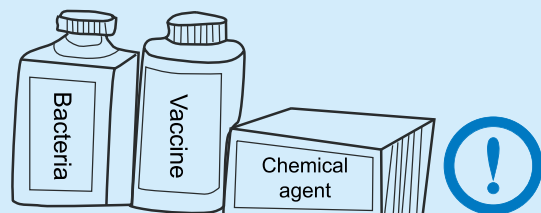

# Disassembly and Assembly of Door



Caution

Before disassembling and assembling the doors, please remove food on the bottle seat, and remove the bottle seat, and then cut the power, shutdown the water source to avoid personal injury, product or property loss. When install and dismantle the doors, please contact the servicer centre of Haier.

Prevent children or pets from asphyxia due to trap in the refrigerator.  
Do not let them play in the drawer.

## Refr. Right Door Disassembly and Assembly

1. Remove the screw which fixes the upper hinge cover with screwdriver, and then remove the upper hinge cover.

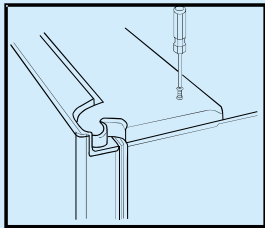

3. Raise the right door and remove proper location.

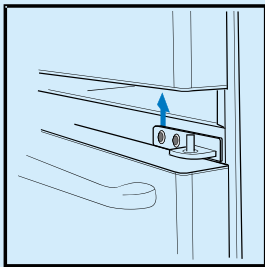

2. Remove the screw which fixes the upper right hinge with hex driver, and move forward the upper right hinge and the door, and then remove right upper hinge.

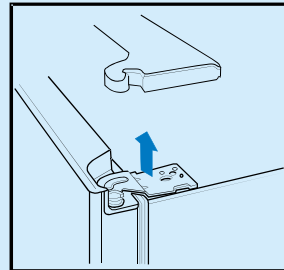

4. Middle hinge may be removed if necessary.

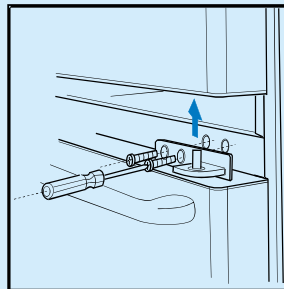

5. The door can be installed by reverse steps.

## Refr. Left Door Disassembly and Assembly

1. Remove the screw which fixes the upper hinge cover with screwdriver, and then remove the upper hinge cover.

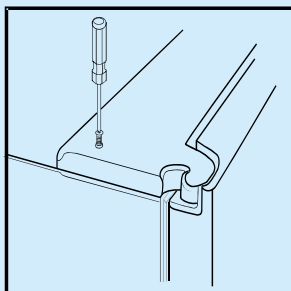

2. Disconnect the wire terminal, and separate the connectors on the upper right corner at the back. Remove humidity sensor, and then remove the screw with hex driver. Move forward the hinge, water pipe, and door, and then remove the upper left hinge.

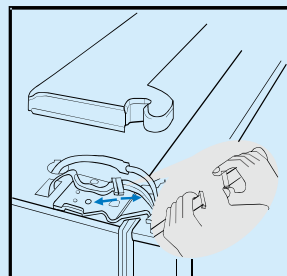

# Disassembly and Assembly of Door

## Refr. Left Door Disassembly and Assembly

3. Remove the left door and place it to proper location.

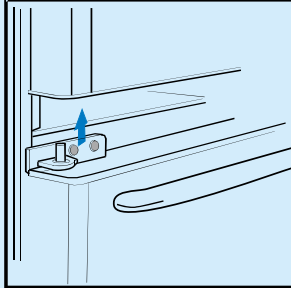

4. Middle hinge may be removed if necessary.

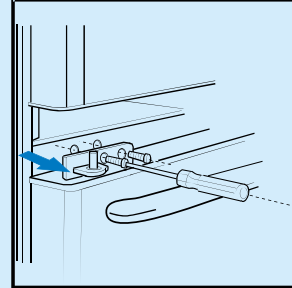

5. The door can be installed by reverse steps.

## Disassembly and Assembly of Ice Receiving Drawer

1. Pull the drawer to the maximum length at first, and then remove the drawer.  
2. The Ice Receiving Drawer can be Install by reverse steps.

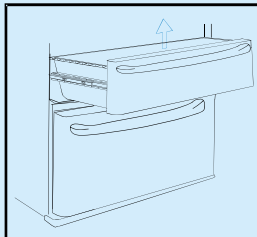

1. Follow the direction of the arrow 1, pull out the gear at the horizontal station.  
2. Follow the direction of the arrow 2, bending pole of gear, and then split it.

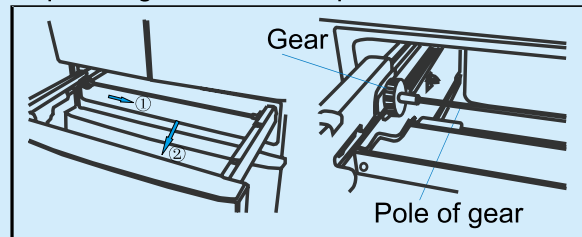

## Disassembly and Assembly of Freezer Drawer

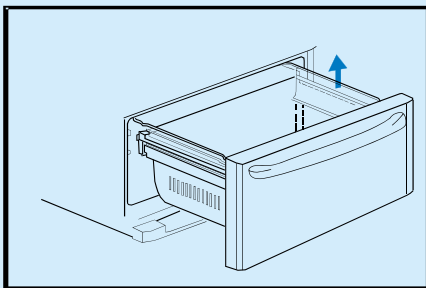

1. Pull the freezer door to the maximum length at first, and then remove the drawer.  
2. Pull the freezer door to the maximum length at first, and then remove the drawer.

## Preparation

1. Remove all package  
Packing base and tapes that fix accessories also must be removed.
2. Check out the accessories and materials  
Check out the items in the box according to the packing list. If varies, please make query to the seller.
3. Place your refrigerator into proper location
4. It is better to clean your refrigerator before use (see section leaning for details)
5. Standing  
After leveling and cleaning, the refrigerator shall keep standing more than 6 hours before connecting to power supply to ensure the normal running of the refrigerator.

# Preparation

## 6. Install the bottom decorative strip

Open the door of refrigerating chamber, take out the decorative strip from the chamber, and install it to the shown location, and fix it with screw.  
(2 screws are provided with the product)



Please wear gloves when dismantle the bottom decorative strip and adjustable leveling legs to avoid injury to your hands.

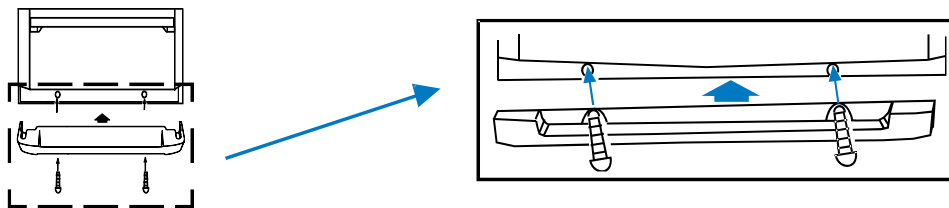

## 7. Disassembly and Assembly of the Handle of Refr. Door

At the first, remove the handle connector, and pinch the connector to the hole on the door shell (Fig. 1). Take out one refr. handle, align the hole on the handle head to the connector and install the handle to the connector. Take out inside-hexagonal spanner, and use it to pinch the cap screw tight on the handle head (Fig. 2).

The handle can be dismantled by reverse steps.

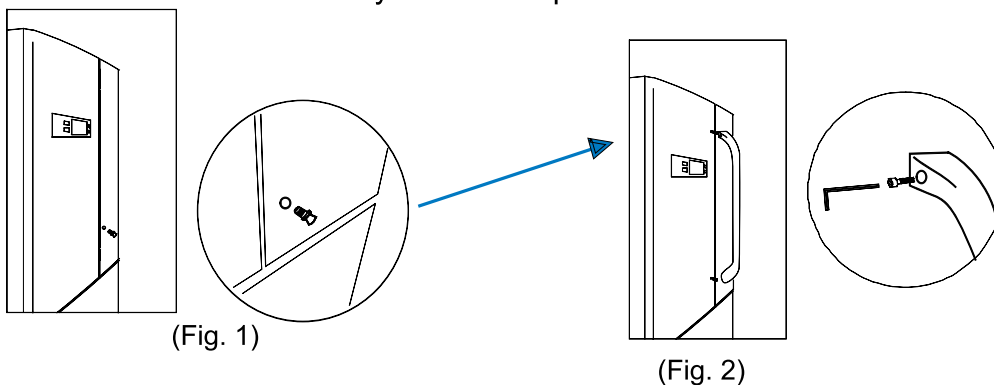

## 8. Disassembly and Assembly of the Handle of Freezer Door

At the first, remove the handle connector, and pinch the connector to the hole on the door shell (Fig. 3). Take out one freezer handle, align the hole on the handle head to the connector and install the handle to the connector. Take out inside-hexagonal spanner, and use it to pinch the cap screw tight on the handle head (Fig. 4).

The handle can be dismantled by reverse steps.

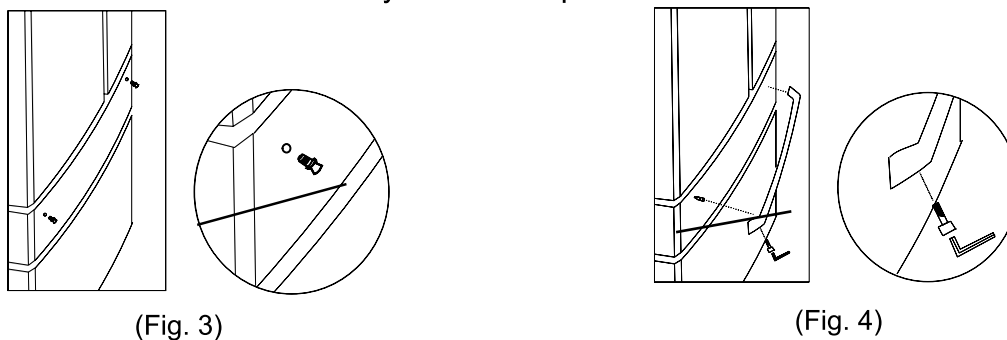

# Connecting the Water Supply Line

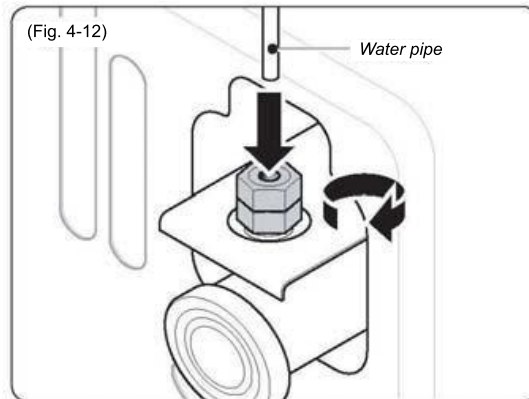

It is recommended to have this product installed by a qualified technician.

Cut the water pipe according to need and avoid bending the water pipe too much.

Usually, the pipe length should be less than 5m. If the water pipe is too long, the ice and cold water content will be affected because there may be insufficient water pressure.

Insert one end of the water supply pipe into the water inlet on the rear of the appliance (Fig.4-12). Connect the other end into the plastic adaptor. Screw the adaptor onto a suitable 1/2" BSP connector water outlet.

The water pressure should be between 0.15~0.6MPa for correct operation of the cold water dispenser and ice maker. It is recommended to use drinking water for producing ice cubes since the filter does not sterilise bacteria.

Open the water valve to flush the pipe, check leakage in the water pipe joints and allow the water to run until it is clear.

The water pipe cannot withstand heat. Keep it away from all heat sources.

Before first use, press the water dispenser pad several times for 1 minute. Do not press for more than 1 minute to prevent overheating of the pad activator solenoid. Cold water will begin to flow from the outlet.

The water filter is there to filter impurities in the water, and to make ice clean and hygienic.

It cannot sterilise or destroy anything, so be certain to connect the water pipe to a drinkable water source.

- To prevent the pipe from freezing, do not install the water pipe in a space below 0°C. When the temperature of the ice maker is equal to or below -15°C the ice maker will begin to make ice.
- Throw out the first few batches of ice cubes if you are making ice for the first time or have not made it for a long time.
- After the refrigerator is installed, put the water supply pipe in a suitable place to prevent crushing and damage.
- If the cubed ice becomes smaller, this may suggest that the filter is blocked from the impurities.

# Getting Started

## 1. Power On

Immediately after the power on, the temperature is displayed as the actual temperature of the refrigerating and freezing chamber. At this time, the set temperature for refrigerating is 5t, the set temperature for freezing is -1ffC, the buttons are in unlocked status.

The refrigerator has Power Outage Memory function. At every power on after the first power on the refrigerator will run under the settings set at the last time. (See Power Outage Memory Function for details)

## 2. Operation Mode of the Refrigerator



Caution

Within the applicable temperature range of the refrigerator, as long as you selected the Fuzzy Mode, you will not need to adjust other settings to maintain the best freezing effect regardless of the ambient temperature changes. Make you worry less and work less.

You may select one of the two modes bellow to set your refrigerator as needed.

(1) Fuzzy Mode: We recommend using the Fuzzy Mode, if where is no special need. (See Fuzzy Function Setting for details)

(2) Manual Mode: The temperature can be set by using temperature control button. (See Temperature Setting and Adjustment for details)

## 3. Put the food into your refrigerator

After running for a while, the inside of the refrigerator is sufficiently cooled. At this time, food can be put into the refrigerator.

Note: small freezer drawer may be removed before putting food into large freezer drawer in order to put more food.

4. If you have lots of fresh food (such as fresh meat) put into Freezing Chamber, please start Super Freezing function 12 hour before.



Caution

When the temperature setting changes, the inner temperature will be balanced after a while. The length of the period depends on the changes made to the temperature setting, the ambient temperature, door-open times, and the food stored in the refrigerator.

# Product Function

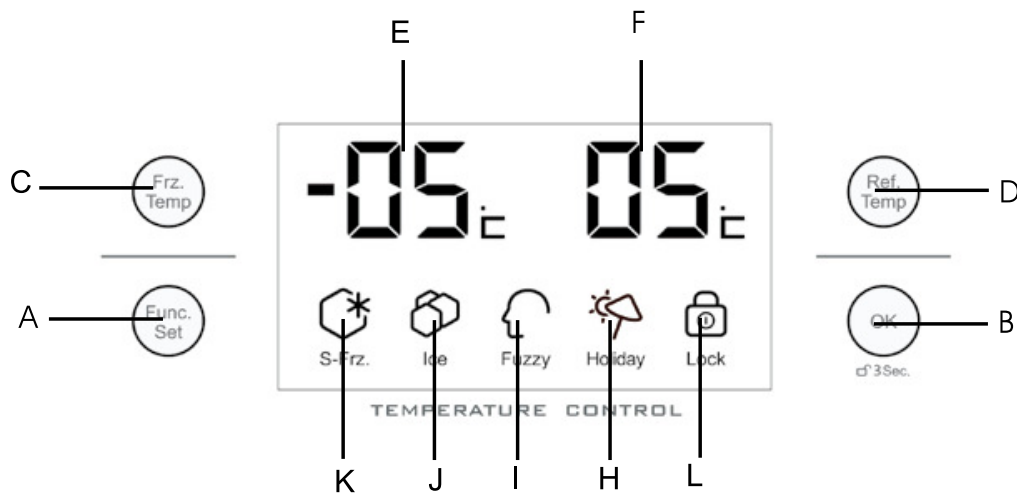

- A. Function Selection Select Super Freezing, Ice, Fuzzy, Holiday and Lock.
- B. Function Confirmation: enable and disable the selected function;
- C. Freezing Temperature Control Button: adjust freezing temperature;
- D. Refrigerating Temperature Control Button: adjust refrigerating temperature;
- E. Freezing Temperature Display Icon
- F. Refrigerating Temperature Display Icon
- H. Holiday Icon
- I. Fuzzy Icon
- J. Ice Icon
- K. Super Freezing Icon
- L. Lock Icon

## 1. Holiday Function Setting

In the unlocked status, press "Function Select Button", select the Holiday function, at this time the "Holiday Icon" is blinking, press down the "Function Confirmation Button", the Holiday Icon displays, and enter the Holiday function; If you want to exit the Holiday function, please press the "Function Confirmation Button" and select the Holiday function, and the "Holiday Icon" is still in blinking, press down the "Function Confirmation Button", the Holiday Icon will be off, and the Holiday function is exited.



Caution

Before activating the Holiday function, please empty the refrigerating chamber to avoid spoilage.

## 2. Fuzzy Function Setting

In Fuzzy status, refrigerator will adjust the temperature setting automatically according to the ambient temperature and the temperature within the refrigerator.

No manual control is required. In the unlocked status, press "Function Select Button", select the Fuzzy function, then "Fuzzy Cursor" will blink, press down the "Function Confirmation Button", the Fuzzy Icon will display and enter the function of Fuzzy; If you want to exit the Fuzzy function, please press the "Function Select Button", select the Fuzzy function, the "Fuzzy Icon" is still blinking, press down the "Function Confirmation Button", the Fuzzy Icon will off and the Fuzzy function is exited.

# Product Function

## 3. Ice maker switch function setting

First power on, ice maker is in off state . If you want to use the ice maker, in the unlocked status, please press the "function confirmation button" and select the ice maker function, and the " ice Icon" is blinking, press down the "Function Confirmation Button", the ice Icon will be on, and the ice maker function will be used. Note: before ice maker is off, pls remove all the ice in ice maker and ice-making chamber to avoid ice melt.

## 4. Super Freezing Function Setting

Super Freezing function is designed to maintain the nutritional value of food inside the freezing chamber, it will completely freeze the food in a short time. In the unlocked status, press "Function Select Button", select the Super Freezing function, at this time the "Super Freezing Icon" is blinking, press down the "Function Confirmation Button", the Super Freezing icon displays, and enter the Super Freezing function; If you want to exit the Super Freezing function, please press the "function confirmation button" and select the Super Freezing function, and the "Super Freezing Icon" is still in blinking, press down the "Function Confirmation Button", the Super Freezing Icon will off, and the Super Freezing function is exited.



Select Super Freezing functions in Fuzzy status, the Fuzzy status will exit automatically; additionally, select Fuzzy function in Super Cooling or Super Freezing status, the Super Freezing Caution status will exit automatically.

## 5. Lock/Unlock Functions Setting

In unlocked status, press "Function Select Button", select the Lock function, the "Lock Icon" blinks, press down the "Function Confirmation Button", the Lock Icon displays, and enter the locked status; In the locked status, press down the "Function Confirmation Button" for 3 seconds, the Lock Icon will be off and the locked status is exited. In the locked status, the functional controls of refrigerating temperature, freezing temperature, Holiday, Fuzzy, and Super Freezing are not available.

## 6. Temperature Setting and Control

### (1 ) Controi of Freezing Temperature

In the unlocked status, press "Freezing Chamber Temperature Control Button", the original freezing chamber setting temperature start to blink. Enter freezing chamber temperature setting status, since then for each single press of this button, the freezing chamber setting temperature is displayed in cyclic form by "14, -15, -16, -17,-18,-19, -20, -21, -22", if no button-pressing operation is initialed over 5 seconds, the blinking will stop and confirm the current temperature setting value.



# Product Function

---

## (2) Control of refrigerating Temperature

In the unlocked status, press " Refrigerating Temperature Control Button ", the original refrigerating chamber setting temperature start to blink. Enter refrigerating chamber temperature setting status, since then for each single press of this button, the refrigerating chamber setting temperature is displayed in cyclic form by "09, 08, 07, 06, 05, 04, 03, 02, 01", if no button-pressing operation is initiated over 5 seconds, the blinking will stop and confirm the current temperature setting value.

(3) In the status of Holiday, Fuzzy the refrigerating temperature control is not available; in Fuzzy and Super Freezing status, the freezing temperature control is not available.

## 7. Alarm Function

Open-door Alarm Function. When the refrigerator door is left open for a long-term period or not closed in tight, the refrigerator will sound a buzzer in a time interval to reminding you close the door immediately.

## 8. Energy-saving Display Control Function

30 seconds after button-pressing operation, display screen backlight will be off, this could save electric energy. When pressing any key or opening the door, resume the display panel lighted status. The corresponding press-button light will activate for button-pressing operation

## 9. Power Outage Memory Function

When refrigerator has a power outage, the instantaneous working status during the outage is memorized. After the power is on, the refrigerator will still run according to the setting tags and function states before the power outage.



Caution

The Lock function is not memorable. The refrigerator is at unlocked status when the power is on.

# How to save energy

(1) Install the appliance in a cool, well ventilated room, far from a heat source (radiator, cooker, etc.), not in direct sunlight.

(2) The time and frequency for opening of the doors should as short as possible, For example, store food in an organized way will reduce your time when you take something out from the appliance.

(3) Store the food covered or packaged.

(4) Let the hot food or drinks to cool down before placing them in the appliance.

(5) When thawing frozen food, place it in the refrigerator compartment. You can use the low temperature of the frozen food cool the food in the refrigerator compartment.

(6) Do not store too much food in the appliance, that may block air circulation.

(7) Temperature setting , the lower the temperature set in the compartment, the higher the energy consumption. So it is better to set a higher temperature if your food storage condition is no problem.

(8) Keep the large freezing drawer closed, take out the small freezing drawer, and then take out and put the food in the small freezing drawer; in this way, larger using space can be obtained and power consumption of refrigerator can be reduced.

# About Refrigerating Chamber

## Please put the frequently-eat or short-term storage food into refrigerating chamber

Adjusting the temperature level can maintain the average temperature between 0-10 °C For most of the areas in the refrigerating chamber, but it can not make long-term preservation for food, and the refrigerating chamber can only be used as a short-term storage chamber.

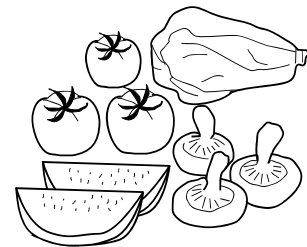

## The height of shelf is adjustable

Adjust the shelf to a suitable height for food storage. Please remove the shelf when adjusting the height. The remove method is: raise the shelf in upwards incline direction, then lift it up, and the shelf is removed. When placing it, push-in the joint along the pad to lower front-end of the shelf and then insert into the groove.

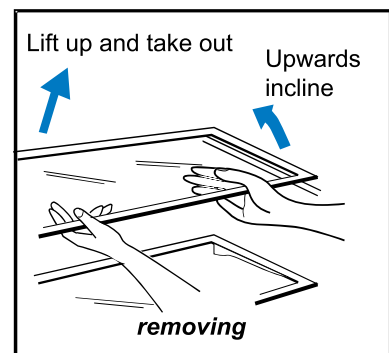

Caution

Make sure the both ends of shelf are on level position. If it can not maintain the level position, the shelf may fall or the food may drop out.

# About Refrigerating Chamber

## The Remove of Crisper Cover

First take out the Crisper Cover and put it to a suitable position, then uplift the back-end of the cover in a direction(1), then pull it out in a direction (2).

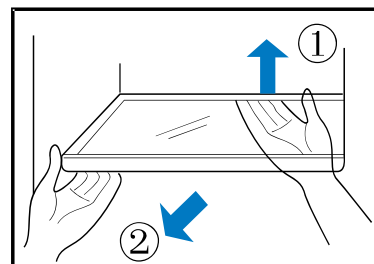

## Full Wid. Drawer

1. Left slide the moisture control knob to increase the cool air access to the full wid. drawer, so a relatively low temperature is kept in the full wid. Drawer.
2. Right slide the moisture control knob to decrease the cool air access to the full wid. drawer, so a relatively high temperature is kept in the full wid. drawer.

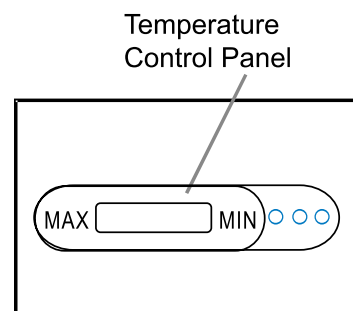

## Storage area recommendation for different kinds of food

Due to the cold air circulation inside the refrigerator, there are temperature variations at different parts inside the refrigerator, so different kinds of food should be placed in different temperature zones.

- (1) eggs, butter and cheese, etc
- (2) zip-top can, tin can and seasoning, etc
- (3) beverages and other kinds of bottled foods
- (4) pickled food, tin can, etc
- (5) meat products and snack foods, etc
- (6) wheaten food, noodle, tin, milk and tofu, etc
- (7) fruits, vegetable and salad, etc
- (8) cooked meat and sausages, etc

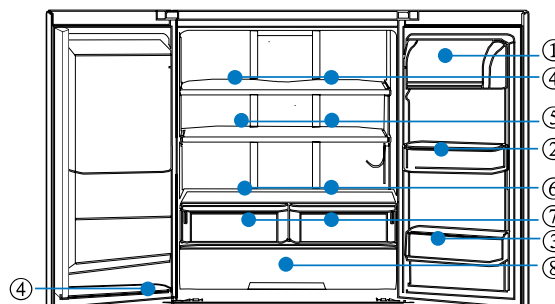





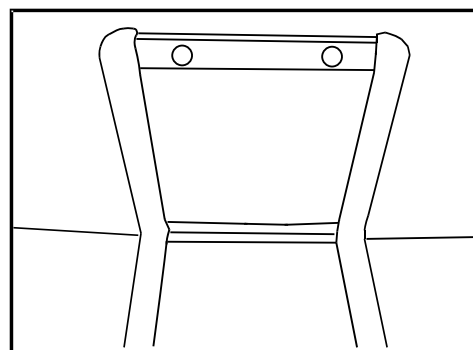

## Refrigerating Chamber Light and Its Replacement

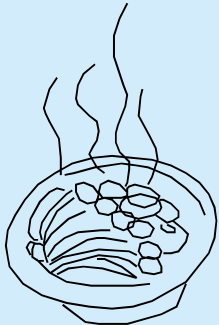
Parameters for each light: DC12V-, 2W The light is LED light with low energy consumption and long operation life. If any unusual activity occurs, do not remove it at your own discretion, please contact after-sale service personnel immediately for a replacement.

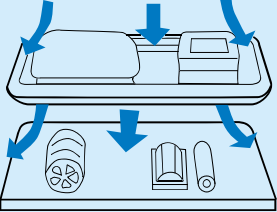
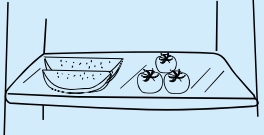
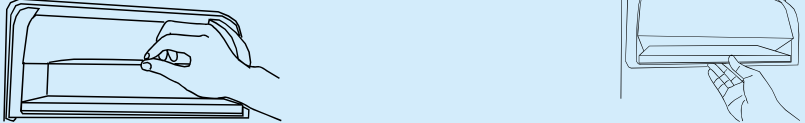

# Precautions for Refrigerating Food

<p>Do not put hot food into the refrigerator before cooling it to room temperature.</p> 	<p>Put the food into the refrigerator for storage after it is cleaned and dried from the water drops.</p> 
<p>Food must be sealed before being put into refrigerator so as to prevent water from evaporating and keep fruits and vegetables fresh, and also to avoid the food tainted by odors.</p> 	<p>Food should be refrigerated in classifications. Manage the foods according to their classifications. Daily diet food should be put at the front of the shelf so the doors do not need to keep open for a long time, also no food expiration will occur because of oblivion.</p> 
<p>Do not overfill the food in the refrigerator, separate the foods accordingly and left spaces for cold air circulation, so that a better refrigerating result can be achieved.</p> 	<p>Food storage should not be too close to the inner wall. The higher moisture contented food should not be close to the shelf inner wall to avoid being frozen, so please keep some distance from the inner wall when managing the food.</p> 
<p>When managing and taking food from diary box, please open and close the diary box according to the below processes in order to avoid hand stuck.</p> 	
 <p>Caution</p>	<p>The food in the refrigerator, especially greasy food that keeps in touch with the liner for a long-term period, will cause corrosion to the liner. Avoid possibly direct contact between food and the liner. When the liner is stained Caution with oil, please clean it in a timely manner.</p>

# Smart Use of Refrigerating Chamber

- (1) Leaves of radish food should be cut off to prevent the nutrients absorption by the leaves.
- (2) Put the frozen food into refrigerating chamber for deforestation, this can refrigerate the food with the low temperature from the frozen food and also for energy saving.
- (3) There are some foods such as onion, garlic, ginger, water chestnuts, roots etc, they can be preserved under normal temperature for a long time without refrigeration.
- (4) Other foods like zucchini, muskmelon, papaya, banana, pineapple are not suitable for refrigeration because it will accelerate their metabolism. But if they are unripe fruits, they can be stored in the refrigerating chamber for a certain period of time for the maturation.



Caution

When ambient temperature in winter is between 0-1 °C and the lower refrigerating chamber temperature is relatively as low as around 0°C, then the vegetable and fruit should be stored into the upper refrigerating chamber to avoid frost damage.



Caution

While upon closing the left door of refrigerating chamber, make sure the vertical brace is closed on position, otherwise, the door can not be closed tightly and for a long time, it will cause the temperature rising inside the refrigerator and alarming.

# About Freezing Chamber

## Freezing chamber is for long-term food storage

Low temperature in the freezing chamber can keep food fresh for a long time, so the best way for long-term food preservation is to put the food into the freezing chamber, but it should comply with the storage durations noted on food packaging.

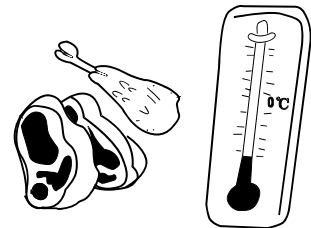

## About Freezer Small Drawer

The freezer small drawer is equipped with an all-in-one ice maker.

For ice taking, please detach the ice storage box from the all-in-one ice maker and take out the ice block.

If larger capacity is required by user, please just take out the freezer small drawer while keeping the freezer large drawer closed, then you could take out or put in a large amount of food from/to the freezer small drawer.

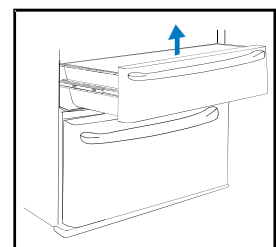

## The Adjustment of Freezer Large Drawer Board

For better convenience of food storage, the refrigerator is equipped with freezer large drawer board, this board can divide the freezer large drawer into two parts, the user can adjust the position of the board according to their food type.

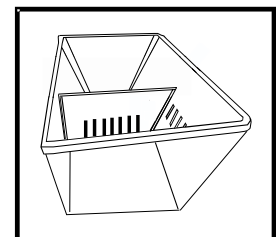

# About Freezing Chamber



Warning

Please take good care of your children and pets, do not let them play in the drawer in case of any unnecessary harms. Please do not dismantle the freezing drawer plate.

## Freezing Chamber Light and Its Replacement

Light parameters: DC12V-, 1W

If any unusual activity occurs, do not remove it at your own discretion, please contact after-sale service personnel immediately for a replacement.

## Frozen Food Precautions

When the room temperature is high, the freezer temperature can be set into the lowest temperature setting directly so as to get the best freezing effect.

Divide the food into appropriate small portions in order to freeze it entirely. It also can better guarantee the quality when defrosting and cooking. Each portion of food should not be heavier than 2.5kg.

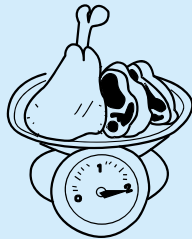

Do not put too much fresh food into the freezing chamber per time; you'd better refer to the freezing ability of the refrigerator.

Pack the food and keep the package outer surface dry before freezing in order not to be frozen together. The packing material should be tasteless, airtight, watertight, non-toxic, free of contamination in order to avoid odor and quality deterioration.

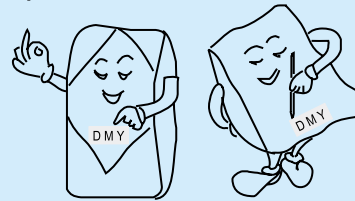

About food storage, you should mark the date, deadline and name on the food packing bag according to its storage duration to avoid food expiration.

Do not put hot food into the freezing chamber before cooling to room temperature. Please start up "Quick-freezing" function in advance of 12 hours if a large number of foods need to be frozen once only.

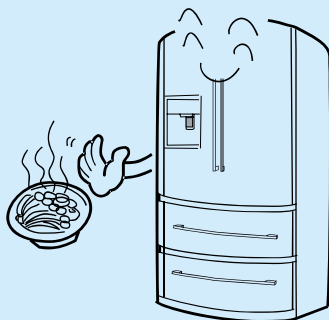

Principally, only take out required amount of food from the freezing chamber for defrosting, the defrosted food can not be re-frozen unless it is cooked, otherwise it will affect its taste quality.

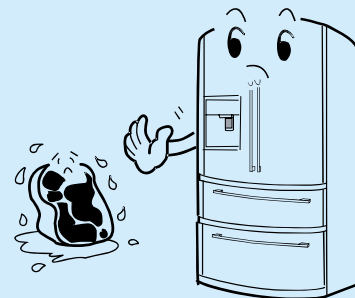

# Usage of Ice Maker and the Cold Water Dispenser

## 1. Preparation before using the ice maker and cold water dispenser:

- a.) Cut the water pipe according to need, and avoid bending the water pipe too much. Usually the length should be less than 18 ft. (5 m). If the water pipe is too long, the ice content and cold water content are affected because there is not enough water pressure.
- b.) The water pipe cannot stand heat. Keep it away from heat sources.
- c.) You may want to have a service engineer install the water pipe.
- d.) During the first use, in order to supply water to the fresh food water tank, press the water dispenser pad several times for 1 minute each. Do not press for more than 1 minute, to prevent overheating of the pad activator solenoid. Cold water will begin to flow from the outlet.
- e.) Water supply pipe instruction: The cold water pressure should be between 0.15~0.6MPa-for automatic ice making.
- f.) The water filter is for removing chlorine and odors from the water. It cannot sterilize or destroy anything - therefore, make sure to connect the water pipe to a drinkable water source.

## 2. Precautions

- a.) To prevent the pipe from freezing, do not install the water pipe in a place below 0°C
- b.) Open water valve to flush pipe, and check leakage in water pipe joints until water is clean.
- c.) When temperature of ice maker is equal to or below 5F, the ice maker will begin to make ice. (Throw out the first several batches of ice cubes if you make ice after not having made it for a long time.)
- d.) After the fridge is installed, put the water supply pipe in a proper place to prevent pressing and damage.
- e.) The filter in the water pipe is there to filter impurities in the water and to make ice clean and hygienic. Therefore, the filter will absorb impurities during normal use. After a long time of usage, if the cubed ice becomes smaller, it may mean that the filter is blocked from the impurities. After 6 months of use, the "Change Filter" indicator light will turn on. At this time, we suggest going to your local authorized Haier after-sale service center or call 1-877-337-3639. After you change the filter, the indicator light will turn off. The refrigerator comes with a filter installed; after this you have to buy and change the filter yourself.
- f.) The ice maker should only be connected to a source of drinkable water.

## 3. Ice maker Working Principle:

The ice maker tray periodically receives an automatic flow of water to the ice maker ice cube tray. Once the water freezes a sensor on the tray recognizes cubes have been made and automatically twists the tray to drop the ice cubes into the ice bucket. Capacity of the ice maker depends on the ambient temperature, frequency of freezer door openings, and freezer compartment cooling temperature setting. Typical ice harvest per day is 4 pounds of ice.



Note

After first plugging in your refrigerator it typically takes 24 hours to make your first batch of ice cubes.

## 4. If this is your first ice maker:

Occasionally you may hear some sounds, like flowing of water or ice cubes dropping. These sounds are normal. Occasionally, in periods of infrequent ice use, cubes may stick together. This is normal.

## 5. If you do not use ice often:

Older ice cubes can get stale. Clean the ice container periodically and use warm water to clean. Before putting it back dry it well so cubes do not stick to surfaces.

## 6. When you do not use the ice bucket for long periods of time:

If you will not be using the ice container for a long time, throw out the remaining ice cubes, wash the container with warm water, dry it with a towel, and place it back in the fridge. Then close the water supply valve to the fridge.

### Note:

1. Your center freezer drawer is arranged to load ice cubes on a tray in the left side and either more ice or frequently frozen and reused foods on the right side of the drawer.
2. When opening the center freezer drawer avoid rapid pullout which can cause ice cubes to fall into lower deep freeze drawer.
3. When ice maker is dropping ice into the center freezer drawer ice bucket a signal of circling dashes will appear on the dispenser clock screen. It is recommended the user wait for the ice cubes to drop before opening the center freezer drawer.

# How to Use the Water Dispenser

- The use of the cold water dispenser.

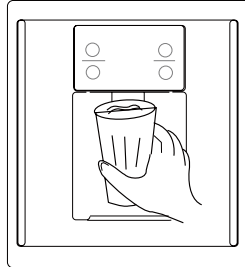

- When pressing the water dispenser tab the first time you may not get water out since air will be in the line. Please press it for at least 1 -2 minutes, in order to clear the air and replace it with water from the water tank.
- The first few cups of water you take out will be warmer than the remaining cups. This is normal.
- The cold water you remove may benefit from first adding the ice cubes from the center freezer drawer if you like very cold water.



Warning

Don't put hands or other articles into the cold-drinks taking out equipment or the ice storing box.

# Water Dispenser Precautions

1. Do not use a paper cup or one that is too tall to fit into the dispenser cavity.
2. When dispensing water please keep your cup under the spout for a few seconds after you disengage the activation tab to catch all the water droplets.
3. Please throw away the first 5 cups of water to remove any impurities in the lines.



# Cleaning and Disuse

## Frost Removing of the Freezing Chamber

Automatic way of frost removing is applied in the freezing chamber of this refrigerator. Manual operation is not in need.

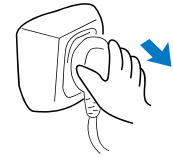

## Cleaning

Food left in the refrigerator will release harmful stink, so periodic cleaning is in need.

Unplug the power supply plug before cleaning for safety. Dip soft towel or sponge to warm water (neutral detergent may be added) to clean the refrigerator. Wipe out water on the surface of the refrigerator with dry towel.



Caution

Scrubbing brush, wire brush, abrasive (such as tooth paste, cleanser and etc), organic solvent (such as gasoline, banana oil, acetone and Caution etc) hot water, acid or base are forbidden from cleaning the refrigerator.



Caution

- (1) For the refrigerator is quite heavy; protect the ground when you move the refrigerator for cleaning and maintenance. Keep the refrigerator standing in movement. Shake is forbidden to protect the ground.
- (2) Spraying is avoided in cleaning to guarantee the electrical insulation.
- (3) In the cleaning of electrical parts like the switch and the lamp, dry wiping must be applied after electricity is cut down.
- (4) Wet hands is forbidden from touching the surface of the freezing chamber parts to avoid sticking of the skin to the parts.
- (5) Hot water is forbidden from cleaning the icy glass shelves to avoid physical damage and treasury loss due to break of the glass resulted by severe change of temperature.
- (6) The door seal is easy to smear. Please keep it clean.

## Cleaning of the Bottle Seat of the Door

Hold both sides of the bottle seat; lift it up in direction (1) and then pull it out in direction (2). Bottle seat can be fixed in the reverse direction after cleaning.

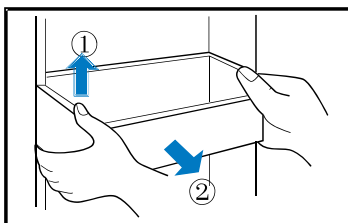

## Cleaning of the Diary Box

Hold both sides of the diary box with your hands, lift it up in direction (1) And then pull it out in direction (2). It can be fixed in the reverse direction after cleaning.

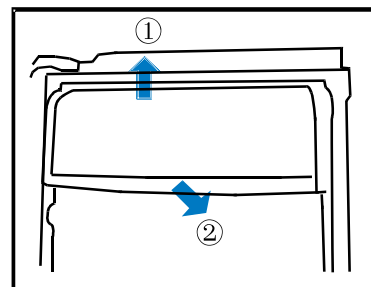

# Cleaning and Disuse

## Cleaning of the Freezing Refrigerator Shelf

Lift the shelf up and pull it out forward. Dip soft towel or sponge to warm water (neutral detergent may be added) to clean the shelf. It can be fixed in the reverse direction after cleaning.

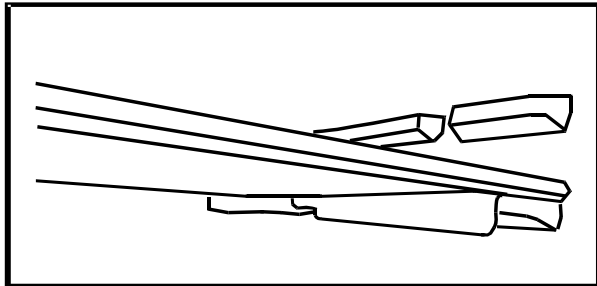

## Cleaning of the Wine Shelf

Simply lift the shelf up. Dip soft towel or sponge to warm water (neutral detergent may be added) to clean the shelf. It can be fixed in the reverse direction after cleaning.

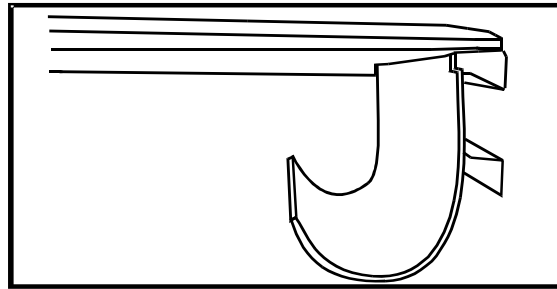

## Cleaning of the Crisper

Simply pull the crisper out and lift it up. Dip soft towel or sponge to warm water (neutral detergent may be added) to clean the crisper. It can be fixed in the reverse direction after cleaning.

## Cleaning of the Crisper Cover.

Get the crisper down and lay it in a proper place. Lift the cover up and pull it out forward. Dip soft towel or sponge to warm water (neutral detergent may be added) to clean the cover (notice that the cover is made of glass plate and plastic shelf. Attention should be paid to the glass plate to avoid damage.). It can be fixed in the reverse direction after cleaning.

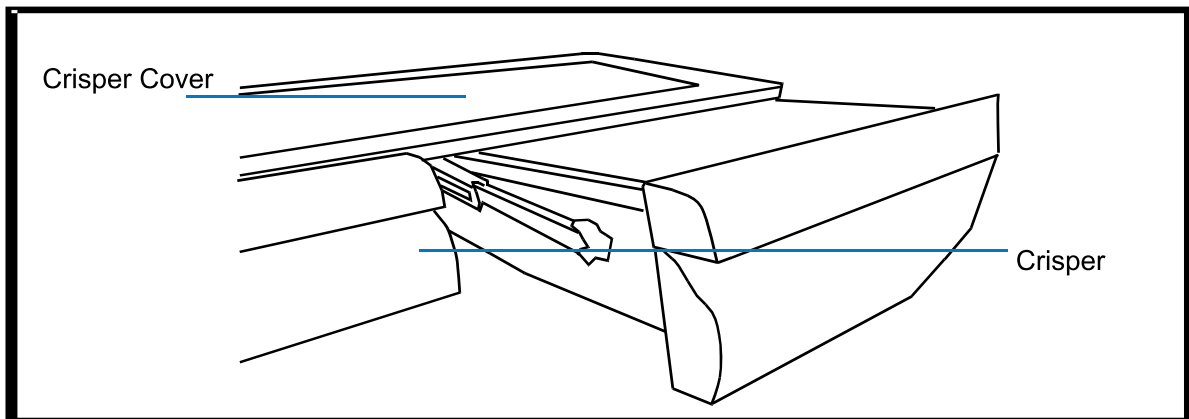

## Cleaning of the Rectangle Drawer and Its Cover

Pull the drawer out forward and lift it up; get the crisper and the drawer down and lay them in a proper place. Then lift the cover up and pull it out forward. Dip soft towel or sponge to warm water (neutral detergent may be added) to clean the drawer. It can be fixed in the reverse direction after cleaning.

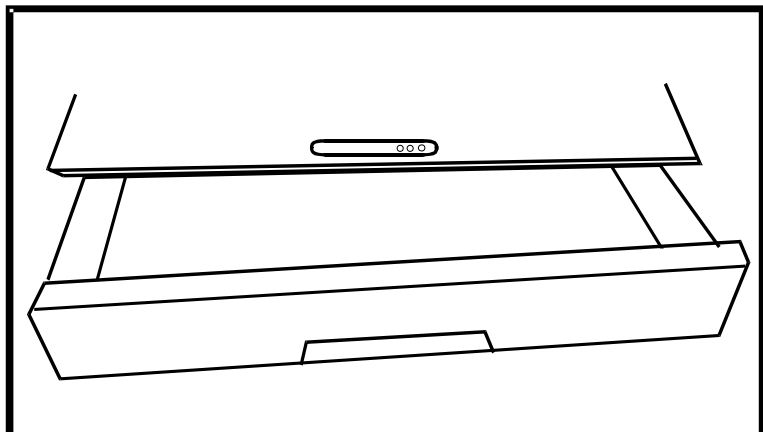

# Cleaning and Disuse

---

## Ice Maker in the Freezing Chamber

Get the ice maker out of the freezer small drawer. Dip soft towel or sponge to warm water (neutral detergent may be added) to clean. Simply place it back into the small drawer after cleaning.

## Freezer Small Drawer

Simply pull the freezer small drawer forward and lift it up. Dip soft towel or sponge to warm water (neutral detergent may be added) to clean the drawer. It can be fixed in the reverse direction after cleaning.

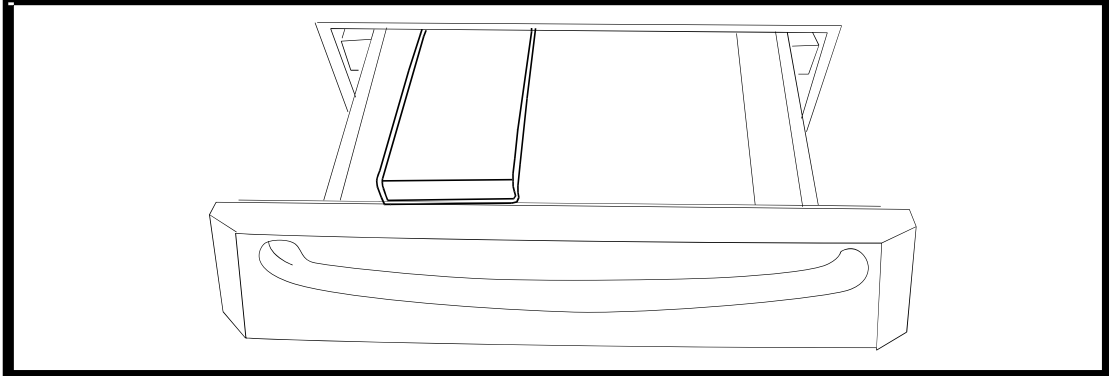

## Freezer Large Drawer

Simply pull the freezer wire frame forward and lift it up. Dip soft towel or sponge to warm water (neutral detergent may be added) to clean the small drawer. It can be fixed in the reverse direction after cleaning.

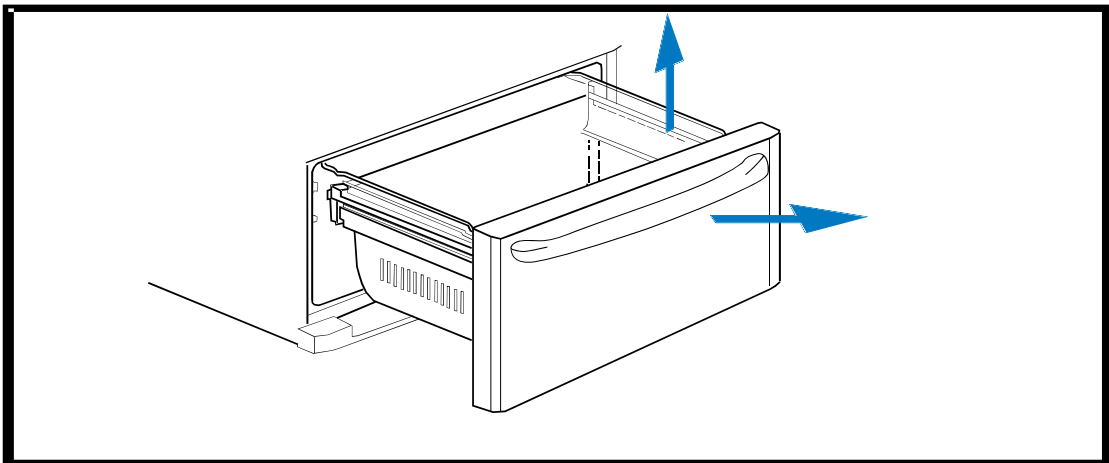

# Cleaning and Disuse

## Disassembly and Assembly of Freezer Small Door

Pull the freezer small drawer out. Then lift up the freezer small door and pull it up to get the freezer small door down.

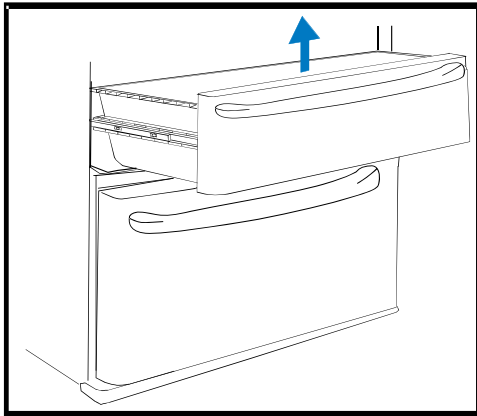

## Disassembly and Assembly of Freezer Large Door

Pull the freezer large drawer out. Then lift up the freezer small door and pull it up to get the freezer large door down.

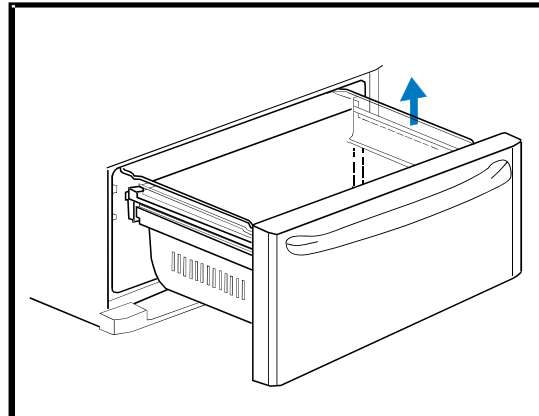

# Suspension

## Treatment of Power Failure

Within 1-2 hours of power failure, the refrigerator can undoubtedly store food. If the power failure lasts over 24 hours, frozen food will all unfreeze.

Never place more food into the refrigerator after power failure. Open the door of the refrigerator as few times as possible. If the power failure is known in advance, more ice cubes should be made and placed in leakproof container to lie on the upper side of the refrigerating chamber.

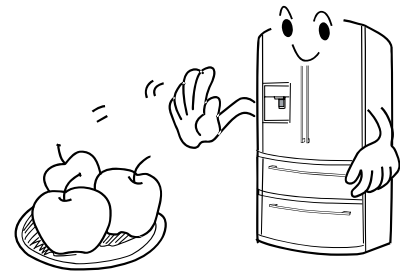

Caution

Temperature upturn within the freezing chamber due to power cut or other causes will shorten the shelf time and lower the eating quality of the food.

## Disuse

In need of a rather long suspension of use, power supply plug of the refrigerator should be plucked to cut the power, and clean the refrigerator following means as mentioned above. The door of the refrigerator should be open in suspension of use to prevent the small amount of food left producing harmful stink.

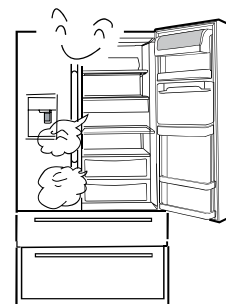

# Cleaning and Disuse



Caution

Never use the refrigerator in common situation in avoidance of impact on the work life of the refrigerator.  
After the power supply plug is plucked, at least 5 minutes should be suspended before a second plug.

## On Vacation outside

In case of long vacation outside, please cut off the electricity and get the food out. After the frost is melted away, clean the internal. Open the door of the refrigerator to prevent food left producing harmful stink.



Warning

After the stools are out of work, they are to be properly handled or handed to professionals. Never throw them away at will to prevent harming the Warning environment or provoking other dangers.

## In Movement

Pluck the power supply plug to cut off the power. Take all food out of the refrigerator. Fix moving parts like the refrigerating chamber shelf, crisper and freezing chamber shelf with tapes. Close the door of the refrigerator tightly and fix it with tapes to prevent open in the movement. In the movement of the refrigerator, the maximum inclination angle should be less than 45 degree (angle in the vertical direction) to prevent damage to the ice-making system to impact the normal use.

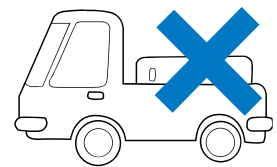
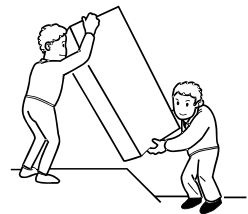

Forbidder

Never lay the refrigerator down.

## FAQ (stange voice in refrigerator)

When running the refrigerator at first time, there will be a loud voice keeping for a short while, as it has not entered into a steady running status; the voice will come to be normal after it becomes steady.

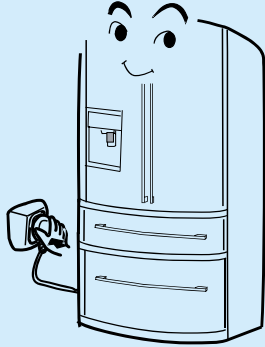

There will be a normal voice comes from working fan while the refrigerator is working.

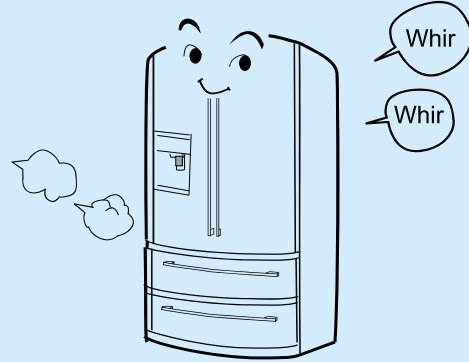

As the temperature changing occurs when the refrigerator's running, things in refrigerator will expand or contract frequently so there will be a pit-a-pat from evaporator and pipelines.

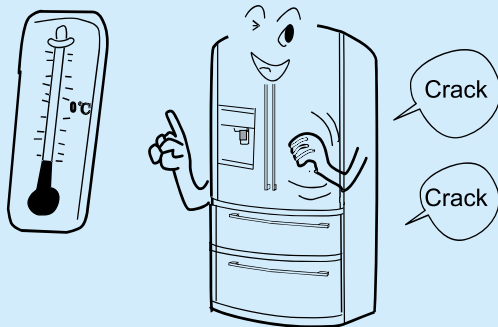

Tap-tap is a normal sound when the compressor is working, or when you are starting up or shutting down the refrigerator.

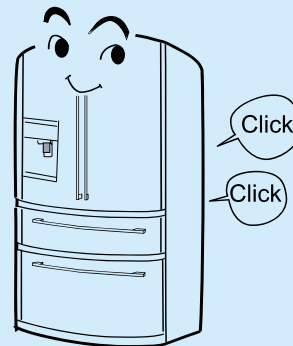

When liquid refrigerant is flowing in the evaporator, it will produce a voice that sounds like water flow. Normally, this voice is heard in evaporator and compressor; when the refrigerator stops working, such voice may also continuously or discontinuously occur due to the backflow of liquid working substance.

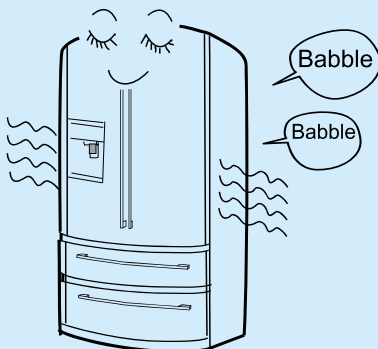

When working the defrosting cycle, water drops onto the hot filament will lead a sound like Chi-Chi. After the cycle gets completed, there may occurs small cracking sounds, and a boiling sound or Gu-Gu sound may be heard from evaporator. These are the normal sounds during defrosting operation.

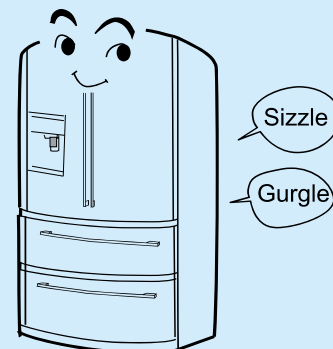

# FAQ

When refrigerator used for the first time, long-time working may cause high temperature of body and compressor, which is a normal phenomenon.

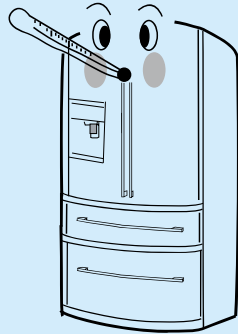

When refrigerator runs for long hours, the surface of the erect-beam installed on the left door of the refrigerating chamber and the door body will be warm, this is a normal phenomenon which is mainly designed to prevent condensation phenomenon.

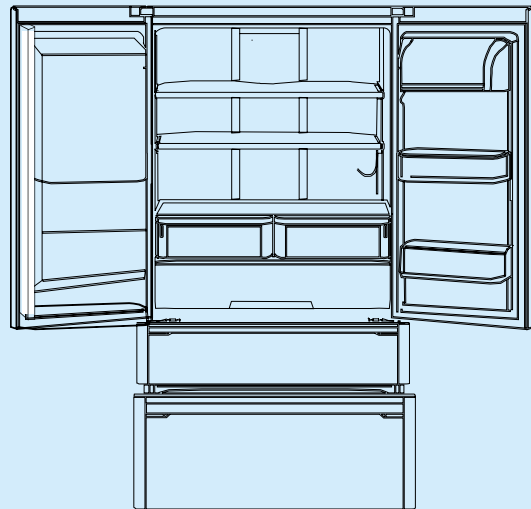

Water droplets may appear on outside surface and center beam between doors when air humidity is high, just mop them with soft cloth.

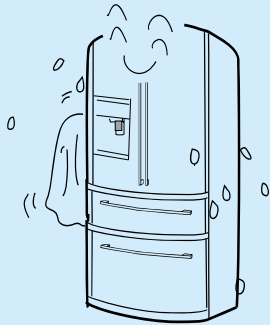

## Meaning of crossed out wheeled dustbin:

Do not dispose of electrical appliances as unsorted municipal waste, use separate collection facilities. Contact your local government for information regarding the collection systems available. If electrical appliances are disposed of in landfills or dumps, hazardous substances can leak into the groundwater and get into the food chain, damaging your health and well-being. When replacing old appliances with new ones, the retailer is legally obligated to take back your old appliance for disposals at least free of charge.

# Safety instructions

---

Intended use: This appliance has been designed exclusively for use in dry-interior households. Every other use is improper and may lead to injuries, whereby the liability of the manufacturer will cease.

- Hold the plug, not the cable, when unplugging the refrigerator.
- Ensure that the power cable is not trapped by the refrigerator. Do not step on the power cable.
- Take care not to roll over the power cable or damage it when moving the refrigerator.
- When the power cable is damaged or the plug is worn, turn off the refrigerator and consult an authorized service agent for replacement.
- If cool gas or other inflammable gas is leaking in the vicinity of the refrigerator, turn off the valve of the leaking gas, open the doors and windows and do not unplug a plug in the power cable of the refrigerator or any other appliance.
- Never store inflammable, explosive or corrosive materials in the refrigerator
- Do not store medicines, bacteria or chemical agents in the refrigerator. This refrigerator is a household appliance. It is not recommended to store materials that require strict temperatures.
- Do not store or use petrol or other inflammable materials in the vicinity of the refrigerator to avoid a fire.
- Do not place unstable articles (heavy objects, containers filled with water) on top of the refrigerator, to avoid personal injury caused by falling or electric shock caused by contact with water.
- Do not pull on the bottle racks in the door. The door may be pulled askew, the bottle rack may be pulled away, or the refrigerator may topple. Do not step on the freezer storage compartment door or cabinet when putting in or taking out food.
- Do not touch the inside surface of the freezer storage compartment when in operation, especially with wet hands, as your hands may freeze onto the surface.
- Open and close the doors only with the handles. The gap between the doors and the cabinet is very narrow. Do not extend your hands in these areas to avoid pinching your fingers. Open or close the refrigerator doors only when there are no children standing within your range of door movement.
- To ensure the refrigerator's electrical insulation, do not spray or flush the refrigerator when cleaning, nor place the refrigerator in a damp area or location where it might be splashed with water.
- Disassembly and alteration of the refrigerator must be authorized. Any agitated movement of the refrigerator may damage the cooling pipes. Property damage or personal injury may result. Repair of the refrigerator must be performed by professional personnel.
- Never store bottled beer or beverages in the freezer, as these will burst during freezing.



# Safety instructions

---

- Unplug the refrigerator in the event of a power interruption or before cleaning. Allow at least 5 minutes before restarting the refrigerator, as frequent starting may damage the compressor.
- When discarding the refrigerator, to avoid the accidental trapping of children, please remove the refrigerator doors, door seals and shelves and put them in an appropriate place.
- Do not use electrical devices inside the food storage compartments of the appliance, unless they are of the type recommended by the manufacturer.
- This appliance is not intended for use by persons (including children) with reduced physical, sensory or mental capabilities, or lack of experience and knowledge, unless they have been given supervision or instruction concerning use of the appliance by a person responsible for their safety.
- Do not store too much food in the freezer storage compartment to avoid longer operation time of the compressor or falling food. It is recommended not to exceed the load line of the drawers. The total weight of the food should not exceed 30 kg. To prevent the food from falling on the ground, do not pull open the freezer drawer too strongly or at an angle.
- Do not use mechanical devices or other means to accelerate the defrosting process, other than those recommended by the manufacturer.
- Children should be supervised to ensure that they do not play with the appliance.

## SAFETY INSTRUCTIONS FOR INSTALLATION

Never place the refrigerator in a damp area or location where it might be splashed with water. Clean and dry water splashes and stains with a soft clean cloth.

The refrigerator should be placed in a well-ventilated place not far from a drink water source. Ensure a space of at least 20 cm above and 10 cm around the refrigerator.

Keep ventilation openings in the appliance or in the in-built structure clear of obstruction. The refrigerator is operated by a 220-240 VAC/50 Hz power supply.

Abnormal voltage fluctuation may cause the refrigerator to fail to start, or damage to the temperature control or compressor, or there may be an abnormal noise when operating. In such case, an automatic regulator shall be mounted.

A dedicated socket with reliable grounding must be provided for the refrigerator. The refrigerator's power cable is fitted with a 3-pin (grounding) plug that fits a standard 3-pin (grounding) socket. Never cut off or disassemble the grounding.

The appliance must be positioned so that the plug remains accessible.

If the supply cord is damaged, it must be replaced by the manufacturer, its service agent or similarly qualified persons in order to avoid a hazard.

Do not damage the refrigerant circuit.