

ALCATEL
onetouch.
Watch

SM-02

User Manual



ALCATEL
onetouch.

English - CJA33NBALAAA

Introduction

WATCH

Wear, Feel, Tap and Experience it.

- Raise your hand with the screen towards you to wake up your WATCH and see the time.
- Track your daily activities and monitor your sleep.
- Control your device's Music Player and Camera.
- Measure your heart rate while resting.

Onetouch Move

Onetouch Move helps you to pair WATCH with your device, review the activity dashboard, set goals, etc. (Page 18)

You can download this app in any of the following ways:

- Search for "**Onetouch Move**" in Google Play Store. (For Android)
- Search for "**Onetouch Move**" in Apple Store. (For IOS)
- Scan the following QR code:



Minimum requirements for paired devices

- Android 4.3
- iOS 7
- Bluetooth 4.0

Compatible devices⁽¹⁾:

- iPhone4s
- iPhone5
- iPhone5s
- iPhone6
- iPhone6 Plus
- LG G3
- LG Nexus 5
- Samsung Galaxy S5
- Samsung Galaxy Note3
- SONY Xperia Z3
- HTC One Max

(1) This list only contains the most well-known devices compatible with our WATCH.

- HTC One (M8)
- Motorola Moto G
- Motorola Moto X
- HUAWEI Ascend P7
- ALCATEL ONETOUCH POP S7
- ALCATEL ONETOUCH HERO 2
- ALCATEL ONETOUCH HERO 2C
- ALCATEL ONETOUCH Hero 8
- ALCATEL ONETOUCH PIXI 8
- ALCATEL ONETOUCH PIXI 7
- ALCATEL ONETOUCH POP D5
- ALCATEL ONETOUCH POP ASTRO

Table of contents

1	Your WATCH	1
2	Pairing.....	7
3	Screen	10
4	Notifications.....	12
5	Applications.....	14
6	Onetouch Move.....	18
	Safety and use.....	26
	General information	42
	Warranty.....	44
	Troubleshooting.....	46



www.sar-tick.com

This device meets applicable national SAR limits of 2.0W/kg. The specific maximum SAR values can be found on page 28 of this user manual.

Your WATCH

1.1 Wearing

Open

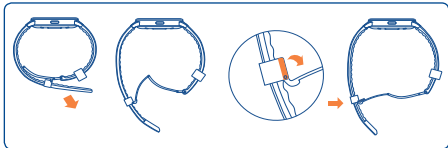

Take out your watchband from the ring sleeve, unbuckle the band and open the clasp.

Wear

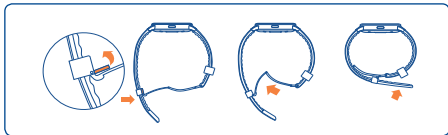

- Put it around your wrist and cross the watchband through the clasp.
- Move the clasp along the band to adjust the watchband size to fit your wrist.
- Close the clasp until it clicks.
- Cross the watchband through the ring sleeve to secure your WATCH.

Watchband adjustment

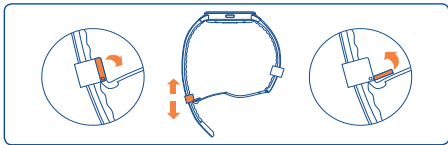

Open the clasp and adjust the watchband size to fit your wrist.

1.2 Keys and sensor

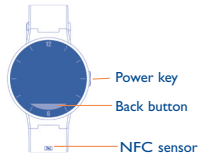

Power key

- Press: Turn on/off screen.
- Press and hold: Power on/off WATCH. Press and hold for 10 seconds to restart WATCH.

Back button

- Tap to go back to the previous screen.
- Tap to dismiss notifications only on WATCH.

NFC sensor

Tap it to the NFC antenna of your phone to quickly pair WATCH with your phone.

1.3 Vibration reminding

Your WATCH vibrates to remind you of:

- Notifications
- Call, alarm, calendar, event, etc.
- Low battery
- Disconnection with your phone

1.4 USB charging

Open the USB port cover at the end of the watchband. Connect your WATCH with a computer to charge via USB. Make sure that the chip on WATCH is correctly inserted. Otherwise, it won't charge.



The following instructs you to correctly charge WATCH.

The left picture shows the correct insertion and the right one shows the incorrect charging.

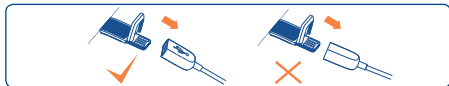

1.5 Power on your WATCH

Hold down the **Power** key until WATCH powers on. It will take a few seconds before the screen lights up.

1.6 Power off your WATCH

You can power off your WATCH in the following two ways:

- Hold down the **Power** key. Swipe icon  right or left to power off your WATCH. Touch **Back** button to cancel power-off operation.
- Keep holding down the **Power** key for around 8 seconds.

2 Pairing.....

2.1 NFC pairing

If your phone supports NFC and Onetouch Move is installed, you can quickly pair your phone with WATCH by using NFC.

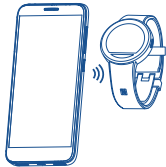



Find the logo  and tap it to the NFC antenna in your phone.

2.2 Bluetooth Pairing

- Start Onetouch Move. After completing your profile, touch **Connect Your Watch**.
- Turn on Bluetooth on your phone.



- Select your WATCH in **Available Devices** list, then touch it to connect.
- Swipe icon  left on your WATCH to confirm connection. Swipe icon  right to reject pairing.



1. Keep your WATCH's screen on if your phone cannot detect any Bluetooth device. Your WATCH's Bluetooth will be disabled for power saving if it has not paired with any device a long time after its screen is off.

2. WATCH can be connected only through the Bluetooth searching in Onetouch Move.

3 Screen

Home screen

Tap on watch face to access main menu screen.



Main menu screen

The screen is provided in an extended format. You can swipe left/right to view the extended screen.



Tap **Back** button to access Home screen.

3.1 Using the touch screen

Touch



To access, select an application or confirm an action, touch it with your finger.

Swipe left/right



Swipe left/right the applications, images, life modes and etc. at your convenience.

Slide



Slide up the screen to open notifications.

4 Notifications.....

4.1 Icons

Notification/Status icons

	Phone is disconnected		Missed call(s)
	Battery is low (in red)		Unread message(s)
	Battery is full		Unread email(s)
	Battery is charging (in blue)		Sleep tracker is active ⁽²⁾
	Mute is on		Stopwatch is active
	Airplane mode is on		Workout tracker is active
	Watch is disconnected with phone (in red) ⁽¹⁾		

(1) If your WATCH is well connected with phone, the Bluetooth icon will not show.

(2) Watch only records your deep and light sleep if you are asleep for 30 minutes or longer.

4.2 Notifications⁽¹⁾

When there are notifications, touch and drag up to open the Notification panel and read the detailed information⁽²⁾.





- Incoming call** Informs you when the phone gets an incoming call. You can reject or mute the incoming call from WATCH.
- Message⁽³⁾** Shows you the content of an incoming message.
- Calendar reminder** Reminds you of upcoming events.
- Alarm** When the time of your alarm set in Onetouch Move comes, your WATCH will vibrate.

(1) Make sure WATCH is connected with your phone.





(2) WATCH will gently vibrate when there is an incoming notification.

(3) Supports SMS and SNS.

5 Applications.....



	Weather⁽¹⁾ forecasts the weather for the next 12 hours and for the next 4 days. Current temperature is displayed in the bottom left of the screen. You can Swipe right to see the weather forecast for the next day.
	Life records all of your activities. You can view detailed data of different modes such as Steps, Calories, Distance, Sleep, etc. Watch only records your deep and light sleep if you are asleep for 30 minutes or longer.
	Workout tracks your workout activities. You can specify some periods of your workout by lap and swipe the screen to view detailed information (such as the steps you made, distance you moved) for each lap.
	Stopwatch measures the amount of elapsed time

(1) The weather information is provided by AccuWeather. For details about the app, go to www.accuweather.com.

	<p>Music⁽¹⁾ can help play the previous/next and stop songs on your phone. You can also adjust sound volume by making circles on the screen with your finger.</p>
	<p>Compass obtains geographic and altitude information. The altitude information will be more accurate if you are outdoor or in an open space. Conversely, the altitude may have deviation if the weather or atmospheric pressure sharply changes, or you are in a closed space such as an air-conditioned room or a cabin.</p>
	<p>Camera⁽²⁾⁽³⁾ controls the Camera in your phone to take a picture. Touch the icon on your WATCH to turn on Camera and touch  to take a picture. Images will be saved in the Gallery of your phone.</p>

- (1) Make sure WATCH is connected with your phone.
 (2) Make sure WATCH is connected with your phone.
 (3) Make sure your phone is unlocked.

	<p>Watch face personalises your watch face. You can swipe left/right to select a watch face type.</p>
	<p>Search phone helps you to find your phone. Touch it and then your phone sounds or vibrates if WATCH is connected to your phone.</p>
	<p>Mute enables/disables vibration mode of your WATCH. When Mute is on, notifications can still be received but you won't be reminded by vibration.</p>
	<p>Airplane mode disconnects WATCH from your phone. You can touch this icon to turn airplane mode on/off.</p>
	<p>Brightness personalises brightness of your WATCH. You can touch this icon to adjust brightness.</p>

	<p>Theme personalises theme of your WATCH. You can touch this icon to select a theme.</p>
	<p>Heart Rate measures your heart rate. Touch the heart-shaped icon to measure in several seconds. Note that your WATCH must have proper contact with your wrist to ensure data correctness. Do not move your body while taking heart rate measurements.</p>



To make sure your heart rate test is accurate, WATCH should be tightened firmly on your wrist, as shown in the following picture. Do not move during the testing. Otherwise, the test result can be abnormal.

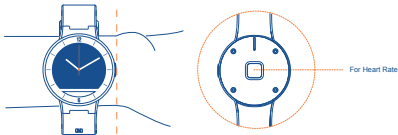

6 Onetouch Move.....

Onetouch Move helps you to pair WATCH with your phone, review the activity dashboard, set goals, etc.

You need to log in and fill your information the first time. You can set your account by:

- Creating an account on Onetouch Move login page directly.
- Using other social app accounts (such as Google accounts) to log in.

Your account can be used on Onetouch Move online website <http://move.alcatelonetouch.com>

6.1 Dashboard

Shows your general activity.

For IOS

Touch a category to view detailed information

Touch to set goals

Touch to share your achievements

Swipe right to view the activity of previous days

Shows the maximum and minimum heart rate you measured



- 1 Touch to show steps you made
- 2 Touch to show calories you burned
- 3 Touch to show distance you moved
- 4 Touch to show minutes you moved
- 5 Touch to show hours you slept

For Android

Touch to show menu list
Touch a category to view detailed information

Touch to share your achievements and set goals

Swipe right to view the activity of previous days



6.2 Timeline

Shows detailed information about a period of activity.

Touch to view detailed information of this period of activity



6.3 Me

Profile

Touch to update your photo or personal information such as name, gender, height, weight, and age.

My Account

Shows your account information and helps you change your password.

My Goals

Touch to set your goal for each category.

Cloud

Synchronisation

You can choose whether your data is automatically synchronised to cloud, or only when Wi-Fi is connected.

Rate Onetouch

Touch to rate this app.

Move

Help

Touch to view more information about your WATCH and Onetouch Move.

6.4 Setting goals

Touch **Me\My Goals**. All the categories are listed.

Select one to set your goal, and then touch **Save**.

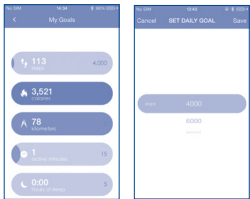

6.5 Watch

Alarm

Touch to set alarms that will make WATCH vibrate.

Wallpaper

Touch **Wallpaper\Change Wallpaper** to customise your watch face background with predefined wallpapers, solid colours, or your own images stored in phone.

Notifications

Select some apps so that notifications from these apps will be displayed on your WATCH.

6.6 Upgrade

WATCH firmware upgrade

If a new firmware version is available, a message is prompted when you start Onetouch Move for the first time every day. You can also touch **Watch\Settings** to check for an update.

Onetouch Move upgrade

If a new app version is available, a message is prompted when you start Onetouch Move for the first time every day. You can also touch **Me\Onetouch Move** to check for an update.

6.7 Settings

Calendar Events/ Incoming Call	Select to make WATCH remind you of calendar events and incoming calls.
Anti-loss	If this function is enabled and you are far from phone, your WATCH will vibrate.
Screen Timeout	Touch to select the duration after which your WATCH's screen will turn off automatically.
Language	Touch to select the language in your WATCH.
Firmware Version	Displays the WATCH's firmware version.
Factory Reset	Touch to reset all settings. All your data will be deleted.
Disconnect Current Watch	Touch to disconnect the current WATCH to allow your phone to connect to a new watch.

Safety and use

We recommend that you read this chapter carefully before using your device. The manufacturer disclaims any liability for damage, which may result as a consequence of improper use or use contrary to the instructions contained herein.

- **TRAFFIC SAFETY:**

Given that studies show that using a device while driving a vehicle constitutes a real risk, drivers are requested to refrain from using their device when the vehicle is not parked.

When switched on, your device emits electromagnetic waves that can interfere with the vehicle's electronic systems such as ABS anti-lock brakes or airbags. To ensure that there is no problem:

- do not place your device on top of the dashboard or within an airbag deployment area,
- check with your car dealer or the car manufacturer to make sure that the dashboard is adequately shielded from RF energy.

- **CONDITIONS OF USE:**

You are advised to switch off the device from time to time to optimise its performance.

Switch the device off before boarding an aircraft.

Switch the device off when you are in health care facilities, except in designated areas. As with many other types of equipment now in regular use, mobile devices can interfere with other electrical or electronic devices, or equipment using radio frequency.

Switch the device off when you are near gas or flammable liquids. Strictly obey all signs and instructions posted in a fuel depot, petrol station, or chemical plant, or in any potentially explosive atmosphere.

When the device is switched on, it should be kept at least 15 cm from any medical device such as a pacemaker, a hearing aid or insulin pump, etc. In particular when using the device, you should hold it against the ear on the opposite side to the device, if any.

Do not let children use the device and/or play with the device and accessories without supervision.

Please note that your device is a unibody device, the battery is not removable. Do not attempt to disassemble your device. If you disassemble your device the warranty will not apply. Also disassembling the device may damage the battery, and may cause leakage of substances that could create an allergic reaction.

Always handle your device with care and keep it in a clean and dust-free place.

Do not allow your device to be exposed to adverse weather or environmental conditions (moisture, humidity, rain, infiltration of liquids, dust, sea air, etc). The manufacturer's recommended operating temperature range is -10°C to $+55^{\circ}\text{C}$.

At over 55°C the legibility of the device's display may be impaired, though this is temporary and not serious.

Do not open, dismantle or attempt to repair your device yourself.

Do not drop, throw or bend your device.

Do not use the device if the glass made screen, is damaged, cracked or broken to avoid any injury.

Do not paint it.

Use only batteries, battery chargers, and accessories which are recommended by TCL Communication Ltd. and its affiliates and are compatible with your device model. TCL Communication Ltd. and its affiliates disclaim any liability for damage caused by the use of other chargers or batteries.

Pay attention to any warnings.

Do not attempt to open or disassemble WATCH. Under inappropriate operation, the device and battery can be damaged and be hazardous to the human body and the environment.

Do not clean WATCH with corrosive cleaning products.

Do not place WATCH in dishwashers, washing machines or dryers.

Do not place WATCH on or in heating devices, such as microwave ovens, stoves, or radiators.

Do not expose WATCH to extreme temperatures. The recommended temperature ranges from -20°C to 60°C .

Do not place WATCH close to fire.

Do not dispose of WATCH in a fire. This may cause the device to explode.

Your WATCH has been IP67-certified. This means it can resist water when you're washing your hands or face, but needs to be dried in heavy rain or when doing the dishes. Also, it's not recommended to wear your WATCH while swimming or taking a shower.

Prevent the USB connector from contacting water to avoid rust.

Do not crush, drop, or puncture your WATCH.

Do not store NFC tag with magnetic devices to keep good performance.

Never allow children to play with WATCH. Small components may present a choking hazard to children.

You are not recommended to wear WATCH on the frequently-used hand.

• **ALLERGENS:**

TCL Communication Ltd. avoids using known allergens in our products. From time to time, trace amounts of an allergen may be added during manufacture of a device or device component that could cause discomfort for some individuals. This approach is common for many types of products. We recommend that you monitor any products that may be in prolonged contact with your skin, and remove them if you experience skin irritation.

• **HEART RATE ALERT**

TCL Communication Ltd. shall not be liable in the event of inaccuracy of your heart rate or failure to provide the heart rate.

• **EXERCISE**

Pedometer, Sleep, Workout, and Heart Rate are intended for leisure, well-being and fitness purposes only and are not intended for medical use. Before using these applications, read the instructions carefully. Consult a medical professional if you experience any health problems or need medical assistance.

Heart rate monitor

The heart rate figures may not be accurate depending on measurement conditions and surroundings.

- Take heart rate measurements when you are seated and relaxed.
- If heart rate measurements are taken at low temperatures, the result may be inaccurate.
- Do not move your body while taking heart rate measurements. Doing so may cause your heart rate to be recorded inaccurately.
- Users with thin wrists may receive inaccurate heart rate measurements.
- Inaccurate measurements occur when the device is loose and the light used to provide the measurement is reflected unevenly.

- If the measurement is very different from the expected heart rate, rest for 30 minutes and then measure it again.
- Measurements are calculated using average values and should be repeated at least five times.
- During winter or in cold weather, keep yourself warm when measuring your heart rate.
- Smoking or consuming alcohol before taking measurements may cause your heart rate to be different from your normal heart rate.
- Do not talk, yawn, or breathe deeply while taking heart rate measurements. Doing so may cause your heart rate to be recorded inaccurately.
- If your heart rate is extremely high or low, measurements may be inaccurate.
- Heart rate measurements taken for infants and toddlers may be inaccurate.
- Do not look directly at the heart rate sensor's lights. Doing so may impair your vision.

If heart rate measurement is not working properly, adjust the position of WATCH on your wrist. For example, move WATCH right, left, up, or down on your wrist to adjust the position of the heart measurement sensor. Or, wear WATCH with the heart rate sensor firmly against the inside of your wrist.

- If the heart rate sensor is dirty, wipe the sensor and try again.

Before You Start Exercising

This app can be used to monitor your exercise. While moderate physical activity, such as brisk walking, is safe for most people, health experts suggest that you talk with your doctor before you start an exercise program, particularly if you have any of the following conditions:

- Heart disease;
- Asthma or lung disease;
- Diabetes, or liver or kidney disease;
- Arthritis.

You should also check with your doctor if you have symptoms suggestive of heart, lung, or other serious disease, such as:

- Pain or discomfort in your chest, neck, jaw, or arms during physical activity;
- Dizziness or loss of consciousness;
- Shortness of breath with mild exertion or at rest, or when lying down or going to bed;
- Ankle swelling, especially at night;
- A heart murmur or a rapid or pronounced heartbeat;

- Muscle pain when walking upstairs or up a hill that goes away when you rest.

Finally, it is recommended that you see your doctor before engaging in vigorous exercise if two or more of the following apply:

- You are a man older than age 45 or a woman older than age 55;
- You have a family history of heart disease before age 55;
- You smoke or quit smoking in the past six months;
- You have not exercised for three months or more;
- You are overweight or obese;
- You have high blood pressure or high cholesterol.
- You have impaired glucose tolerance, also called pre-diabetes.

When in Doubt - Check it Out

If you are unsure of your health status, have several health problems, or are pregnant, you should speak with your doctor before starting a new exercise program. Working with your doctor ahead of time is a good way to plan an exercise program that is right and safe for you. Consider it the first step on your path to physical fitness.

• PRIVACY:

Please note that you must respect the laws and regulations in force in your jurisdiction or other jurisdiction(s) where you will use your device regarding taking photographs and recording sounds with your device. Pursuant to such laws and regulations, it may be strictly forbidden to take photographs and/or to record the voices of other people or any of their personal attributes, and duplicate or distribute them, as this may be considered to be an invasion of privacy. It is the user's sole responsibility to ensure that prior authorisation be obtained, if necessary, in order to record private or confidential conversations or take a photograph of another person; the manufacturer, the seller or vendor of your device (including the operator) disclaim any liability which may result from the improper use of the device.

• DATA PRIVACY

Please note by using WATCH some of your personal data may be shared with the main device (smartphone). It is under your own responsibility to protect your own personal data, not to share with it with any unauthorized devices or third party devices connected to yours. For products with Wi-Fi features, only connect to trusted Wi-Fi networks. Also when using your product as a hotspot (where available), use network security. These precautions will help prevent unauthorized access to your device. Your

product can store personal information in various locations including a SIM card, memory card, and built-in memory. Be sure to remove or clear all personal information before you recycle, return, or give away your product. Choose your apps and updates carefully, and install from trusted sources only. Some apps can impact your product's performance and/or have access to private information including account details, call data, location details and network resources.

Note that any data shared with TCL Communication Ltd. is stored in accordance with applicable data protection legislation. For these purposes TCL Communication Ltd. implements and maintains appropriate technical and organizational measures to protect all personal data, for example against unauthorized or unlawful processing and accidental loss or destruction of or damage to such personal data whereby the measures shall provide a level of security that is appropriate having regard to

- (i) the technical possibilities available,
- (ii) the costs for implementing the measures,
- (iii) the risks involved with the processing of the personal data, and
- (iv) the sensitivity of the personal data processed.

You can access, review and edit your personal information at any time by logging into your user account, visiting your user profile or by contacting us directly. Should you require us to edit or delete your personal data, we may ask you to provide us with evidence of your identity before we can act on your request.

• **BATTERY:**

Please note your device is a unibody device, the battery is not removable. Observe the following precautions:

- Do not attempt to open the back cover,
- Do not attempt to eject, replace and open battery,
- Do not punctuate the back cover of your device,
- Do not burn or dispose of your device in household rubbish or store it at temperature above 60°C.

Device and battery as a unibody device must be disposed of in accordance with locally applicable environmental regulations.



This symbol on your device, the battery and the accessories means that these products must be taken to collection points at the end of their life:

- Municipal waste disposal centres with specific bins for these items of equipment
- Collection bins at points of sale.

They will then be recycled, preventing substances being disposed of in the environment, so that their components can be reused.

In European Union countries:

These collection points are accessible free of charge.

All products with this sign must be brought to these collection points.

In non European Union jurisdictions:

Items of equipment with this symbol are not to be thrown into ordinary bins if your jurisdiction or your region has suitable recycling and collection facilities; instead they are to be taken to collection points for them to be recycled.

CAUTION: RISK OF EXPLOSION IF BATTERY IS REPLACED BY AN INCORRECT TYPE. DISPOSE OF USED BATTERIES ACCORDING TO THE INSTRUCTIONS.

- **CHARGERS**

ALCATEL ONETOUCH recommends to use a universal charger (output 5V, 500mA) in order to avoid any technical issues.

Mains powered chargers will operate within the temperature range of: 0°C to 45°C.

The chargers designed for your device meet with the standard for safety of information technology equipment and office equipment use. They are also compliant to the ecodesign directive 2009/125/EC. Due to different applicable electrical specifications, a charger you purchased in one jurisdiction may not work in another jurisdiction. They should be used for this purpose only.

- **RADIO WAVES:**

THIS DEVICE MEETS INTERNATIONAL GUIDELINES FOR EXPOSURE TO RADIO WAVES

Your mobile device is a radio transmitter and receiver. It is designed not to exceed the limits for exposure to radio waves (radio frequency electromagnetic fields) recommended by international guidelines. The guidelines were developed by an independent scientific organization (ICNIRP) and include a substantial safety margin designed to assure the safety of all persons, regardless of age and health.

The radio wave exposure guidelines use a unit of measurement known as the Specific Absorption Rate, or SAR. The SAR limit for mobile devices is 2 W/kg.

Tests for SAR are conducted using standard operating positions with the device transmitting at its highest certified power level in all tested frequency bands. The highest SAR values under the ICNIRP guidelines for this device model are:

Maximum SAR for this model and conditions under which it was recorded.	
Body-worn SAR	0.0032 W/kg

During use, the actual SAR values for this device are usually well below the values stated above. This is because, for purposes of system efficiency and to minimize interference on the network, the operating power of your mobile device is automatically decreased when full power is not needed for the call. The lower the power output of the device, the lower its SAR value. Body-worn SAR testing has been carried out at a separation distance of 0 mm.

For more information you can go to www.alcatelonetouch.com

Additional information about electromagnetic fields and public health are available on the following site: <http://www.who.int/peh-emf>.

General information

TCL Communication Ltd.

- **Internet address:** <http://www.alcatelonetouch.com>
- **Address:** Room 1910-12A, Tower 3, China HK City, 33 Canton Road, Tsimshatsui, Kowloon, Hong Kong

CE | 588

This equipment is in compliance with the essential requirements and other relevant provisions of Directive 1999/5/EC. The entire copy of the Declaration of Conformity for your telephone can be obtained through our website: www.alcatelonetouch.com.

• LICENCES



The Bluetooth word mark and logos are owned by the Bluetooth SIG, Inc. and any use of such marks by TCL Communication Ltd. and its affiliates is under license. Other trademarks and trade names are those of their respective owners.

**WATCH Bluetooth Declaration ID
D024873**

Regulatory information

The following approvals and notices apply in specific regions as noted.

TCT Mobile
TCT Mobile Europe SAS
55 Avenue des Champs Piémus,
Immeuble Le Caprice 92030 Nanterre, France
+33 1 48 52 81 80

EC declaration of conformity / Déclaration de conformité CE

Product / Produit : Connected wristband with Bluetooth technology / Bracelet connecté avec technologie Bluetooth

Product Identification / Identification du produit : ALCATEL ONE TOUCH WATCH type 9M52

Mfr / Nour : TCT Mobile Europe SAS
55, avenue des Champs Piémus
92000 Nanterre
France

Declares under our sole responsibility that the product above mentioned is conform to the applicable essential requirements of the directive 1999/5/EC and that all essential radio test suites have been carried out. Conformity assessment procedure : annex IV of the directive. / déclare sous notre seule responsabilité que le produit ci-dessus est en conformité avec les exigences essentielles applicables de la directive 1999/5/CE et que toutes les séries d'essais radio essentielles ont été effectuées. Procédure d'évaluation de conformité : annexe IV de la directive.

Applied standards / Normes appliquées

- Item 3.1.a (protection of the health and of the safety of the user) / Article 3.1.a (protection de la santé et de la sécurité de l'utilisateur)
 - EN 60950-1:2006 + A1:2009 + A1:2010 + A12:2011
 - EN 62479: 2010, Council recommendation 1989/18/EC (July 99)
- Item 3.1.b (protection requirements with respect to electromagnetic compatibility) / Article 3.1.b (exigences de protection en ce qui concerne la compatibilité électromagnétique)
 - EN 301 488-1 v.1.9.2 (2011-08), EN 301 488-17 v.2.2.1 (2012-08)
- Item 3.2 (effective use of spectrum so as to avoid harmful interferences) / Article 3.2 / utilisation efficace du spectre radioélectrique de façon à éviter les interférences dommageables
 - EN 300 328 v.1.6.1 (2011-06)

This product also conforms to the applicable requirements of following directives, / Ce produit est en conformité avec la directive:

- directive 2011/65/EU (RoHS - restriction of the use of certain hazardous substances)

The charges delivered with this product also conform to the applicable requirements of the directive 2009/125/EC(Energy Related Product) / Les chargeurs livrés avec ce produit est en conformité avec la directive 2009/125/EC(écoconception des produits)

Conformity of this product has been reviewed by the following Notified body of directive 1999/5/EC / La conformité de ce produit a été vérifiée par l'organisme de certification (notified body) suivant:
American Certification Body, Inc.
Suite C110, Whittier Avenue #721, 22101 McLean, Virginia, United States
Identification number: 1548

Date :2015-03-19
Signature

CE 1588

TCT Mobile Europe SAS
Immeuble Le Caprice
55 Avenue des Champs Piémus
92000 Nanterre
France
+33 1 48 52 81 80
Christophe Davier
TCT Mobile Europe SAS / Deputy General Manager, EMEA.

TCT Mobile Europe SAS - Siège social - 55 Avenue des Champs Piémus, Immeuble Le Caprice 92000 Nanterre France
SAS au capital de 23 011 072 euros - RCS Nanterre B 440 039 222 - Siret 440 039 222 000 06 APE 4852Z

Disclaimer

TCL Communication Ltd. WILL NOT BE LIABLE FOR ANY DAMAGES OF ANY KIND ARISING OUT OF OR RELATING TO THE USE OR THE INABILITY TO USE THE SOFTWARE OR ANY THIRD PARTY APPLICATION, ITS CONTENT OR FUNCTIONALITY, INCLUDING BUT NOT LIMITED TO DAMAGES CAUSED BY OR RELATED TO ERRORS, OMISSIONS, INTERRUPTIONS, DEFECTS, DELAY IN OPERATION OR TRANSMISSION, COMPUTER VIRUS, FAILURE TO CONNECT, NETWORK CHARGES, IN-APP PURCHASES, AND ALL OTHER DIRECT, INDIRECT, SPECIAL, INCIDENTAL, EXEMPLARY, OR CONSEQUENTIAL DAMAGES EVEN IF TCL Communication Ltd. HAS BEEN ADVISED OF THE POSSIBILITY OF SUCH DAMAGES. SOME JURISDICTIONS DO NOT ALLOW THE EXCLUSION OR LIMITATION OF INCIDENTAL OR CONSEQUENTIAL DAMAGES, SO THE ABOVE EXCLUSIONS OR LIMITATIONS MAY NOT APPLY TO YOU. NOTWITHSTANDING THE FOREGOING, TCL Communication Ltd. TOTAL LIABILITY TO YOU FOR ALL LOSSES, DAMAGES, CAUSES OF ACTION, INCLUDING BUT NOT LIMITED TO THOSE BASED ON CONTRACT, TORT, OR OTHERWISE, ARISING OUT OF YOUR USE OF THE SOFTWARE OR ANY OTHER PROVISION OF THIS EULA, SHALL NOT EXCEED THE AMOUNT PURCHASER PAID SPECIFICALLY FOR THE MOVE OR ANY SUCH THIRD PARTY APPLICATION THAT WAS INCLUDED WITH THIS MOBILE DEVICE. THE FOREGOING LIMITATIONS, EXCLUSIONS, AND

DISCLAIMERS SHALL APPLY TO THE MAXIMUM EXTENT PERMITTED BY APPLICABLE LAW, EVEN IF ANY REMEDY FAILS ITS ESSENTIAL PURPOSE.

There may be certain differences between the user manual description and the phone's operation, depending on the software release of your device or specific operator services.

Childcare

These devices are not toys and may be hazardous to small children.

Recycling

Please don't dispose of products or electrical accessories (such as chargers, headsets, or batteries) with your household waste. Warning: Never dispose of batteries, either separately or within a mobile device, in a fire because they may explode. These items should be disposed of in accordance with the national collection and recycling schemes operated by your local or regional authority. Or, you may return unwanted ALCATEL ONETOUCH products and electrical accessories to any ALCATEL ONETOUCH Approved Service Center in your region. Packaging and product guides should only be disposed of in accordance with national collection and recycling requirements. Please contact your regional authorities for more details.

Warranty

We aim at "creating value for consumers". In order to better protect consumers' rights, please read through the following points in case of controversy:

WATCH is warranted against any defect or malfunctioning which may occur in conditions of normal use during the warranty period of twelve (12) months from the date of purchase as shown on your original invoice. (The warranty period may vary depending on your country.)

Within the warranty span, damages and defects deemed by authorized technical personnel as incurred from normal uses, are subject to free repair service provided by the company and the company is allowed to charge or refuse to repair under the following.

- A. Damage caused by accident or abuse.
- B. Conducting or allowing unauthorized personnel to conduct tests, repair, or disassembly of the device.
- C. Damages caused by usage of or connection to non-official accessories.

Battery

This Limited Warranty covers batteries only if battery capacity falls below 80% of rated capacity or the battery leaks, and this Limited Warranty does not cover any battery if:

- (i) The battery has been charged by a battery charger not specified or approved by TCL Communication Ltd. for charging the battery;
- (ii) Any of the seals on the battery are broken or show evidence of tampering; or
- (iii) The battery has been used in equipment other than the watch for which it is specified.

Software

- Software Embodied in Physical Media.

No warranty is made that the software will meet your requirements or will work in combination with any hardware or software applications provided by third parties, that the operation of the software products will be uninterrupted or error free, or that all defects in the software products will be corrected.

- Software NOT Embodied in Physical Media.

Software that is not embodied in physical media (e.g. software that is downloaded from the Internet), is provided “as is” and without warranty.

Troubleshooting

Please refer to the instructions below before contacting our aftersales service:

Your WATCH cannot be detected.

- Press the **Power** key to light up the screen. Your WATCH can be detected for only 3 minutes after the screen is off.
- Turn on Bluetooth if it is disabled.
- Enable the Bluetooth service to search for devices.

Your WATCH fails to pair with your phone or the pairing is slow.

- Press the **Power** key to light up the screen. Your WATCH can be detected for only 3 minutes after the screen is off.
- Make sure the communication between your WATCH and phone is normal.

Your WATCH often disconnects from your phone.

- The background Onetouch Move Service is killed. Restart the APP.
- Make sure the communication between your WATCH and phone is normal.

When there are other devices connected to your phone:

- It is normal if the rate of transferring files using Bluetooth decreases.
- It is normal if the Wi-Fi speed slows down. Note that the Wi-Fi speed will be severely affected for some phones with defects.

How many BT 4.0 Low Energy (BLE) devices can be connected to the phone at most?

5 BLE devices can be connected to the phone at the same time.

After Onetouch Move is installed and WATCH is connected to your phone, the battery consumption speed of your phone increases.

This is normal and the consumption includes:

- Connection keeping between your WATCH and phone
- File transfer between your WATCH and phone
- Disconnection, device scanning, and re-connection

Your WATCH fails to be charged.

- Make sure the USB connector of your WATCH is correctly inserted into the computer. (The chip on the USB connector must contact that of the computer.)
- Make sure your WATCH is tightly inserted into the USB port.

Vibration does not work.

- Charge and confirm that the battery works.
- Make sure the connection between your WATCH and phone is not interrupted.

WATCH vibrates unexpectedly.

- Check whether you have a notification.
- Make sure your WATCH is not far away from your phone.

Your WATCH does not respond.

Press and hold the **Power** key for 10 seconds to restart WATCH.

Factory reset

If the instructions above fail to solve the problem, try to reset your WATCH.

In Onetouch Move, tap , then touch **Watch\Settings\Factory Reset** to reset your WATCH.

ALCATEL is a trademark of ALCATEL-Lucent
and is used under license by
TCL Communication Ltd.

© Copyright 2015 TCL Communication Ltd.
All rights reserved

TCL Communication Ltd. reserves
the right to alter material
or technical specification
without prior notice.