

Argos

Value Range

# Bagless Upright

Instruction Manual - Please keep for future reference

## VUS31ASS1

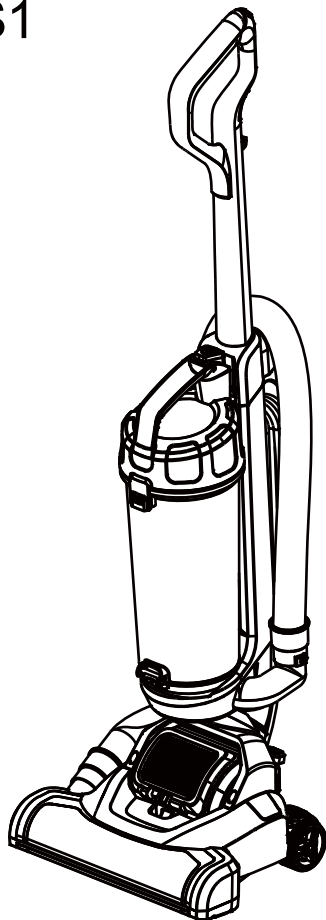

For the relevant accessories information, please visit <http://www.argosspares.co.uk/>  
Or call 08445570320

**Important - Please read these instructions fully before installing or using**

These instructions contain important information which will help you get the best from your appliance and ensure safe and correct use and maintenance.

# Contents

<b>Safety Information</b>	<b>2-3</b>
<b>Parts</b>	<b>4</b>
<b>Assembly</b>	<b>5</b>
<b>Operation</b>	<b>6-8</b>
Operating the appliance	6-7
Using the Hard Floor Adaptor	8
Emptying the dirt container	8
<b>Maintenance</b>	<b>9-10</b>
<b>Troubleshooting</b>	<b>11</b>
<b>Technical Specifications</b>	<b>12</b>
<b>Guarantee</b>	<b>13</b>

# Safety Information

**Important - Please read all instructions before use and keep for future reference**

FOR HOUSEHOLD USE ONLY.  
When using the vacuum cleaner, basic safety precautions should always be observed, including the following:

1. Only use the vacuum cleaner indoors on dry surfaces. Do not handle the plug or vacuum cleaner with wet hands. Do not use outdoors or on wet surfaces.
2. Turn off the vacuum cleaner controls before disconnecting or connecting from the mains supply.
3. Always unplug the vacuum cleaner before connecting or disconnecting the vacuum hose and accessories.
4. Children should be supervised to ensure that they do not play with the appliance.
5. This appliance can be used by children aged from 8 years and above and persons with reduced physical, sensory or mental capabilities or lack of experience and knowledge if they have been given supervision or instruction concerning use of the appliance in a safe way and understand the hazards involved.
6. Only use as described in this manual. Only use recommended attachments.
7. Do not use the vacuum cleaner if it has been dropped, damaged, left outdoors or dropped into water.
8. Do not use the vacuum cleaner with a damaged cord or plug. If the supply cord is damaged, please consult qualified technician.
9. Do not pull or carry by cord. Do not use the cord as a handle, close a door on the cord or pull cord around sharp edges or corners. Do not run the vacuum cleaner over the cord. Keep the cord away from heated surfaces.
10. Do not put any objects into openings. Do not use with any openings blocked and do not restrict air-flow. Keep all openings free of dust, lint, hair or anything that might reduce airflow.
11. Keep hair, loose clothing, fingers and all parts of the body away from openings and moving parts.
12. Do not pick up hot coals, cigarette butts, matches or any hot, smoking or burning objects.
13. Do not pick up flammable or combustible materials (lighter fluid, petrol, kerosene etc.) or use in the presence of explosive liquids or vapours.

# Safety Information

**Important - Please read all instructions before use and keep for future reference**

14. Do not vacuum up harmful or toxic material (chlorine, bleach, ammonia, drain cleaner etc.).
15. Do not vacuum up hard or sharp objects such as glass, nails, screws, coins, etc.
- 16 Do not use without ALL of the filters in place.
17. Take extra care when vacuuming on stairs.
18. Keep vacuuming area well lit.
19. Store the vacuum cleaner in a cool, dry area.
20. Turn off the on/off switch before unplugging the vacuum cleaner.
21. Only use CE-approved 13 amp extension cords. Non-approved cords may overheat. Care should be taken to arrange the cord so that the cord cannot be tripped over.

 **WARNING:** Always switch off and unplug the vacuum cleaner from the electrical outlet before assembling, opening or emptying the dirt container, connecting/disconnecting the attachments, or carrying out maintenance or troubleshooting checks.

 **CAUTION:** The vacuum cleaner is a very powerful unit. Before plugging the cord into the electrical outlet, make sure the switch is in the 'off' position. Hold the vacuum cleaner firmly when starting and in use.

 **IMPORTANT:** If the inlet, hose or extension tube is blocked, switch off the vacuum cleaner and remove the blockage(s) before re-starting the vacuum cleaner.

 **IMPORTANT:** We recommend that filters should be checked and cleaned periodically. For washable filters, ensure they are completely dry before inserting back into the vacuum cleaner. Do not wash with detergents. Only use warm water, max 40°C.

 **IMPORTANT:** The motor is equipped with a thermal cut-out. If for any reason the unit should overheat, the thermostat will automatically turn the unit off. Should this occur, unplug the vacuum cleaner from the electrical outlet and turn off the switch. Remove dirt container and empty. Clean filters. Allow the unit to cool for approximately one (1) hour. To re-start, plug into an electrical outlet and switch back on. This vacuum cleaner is intended for household use only and NOT for commercial or industrial use.

**PLEASE KEEP INSTRUCTIONS FOR FURTHER USE**

# Parts

Please familiarise yourself with parts and accessories listed below

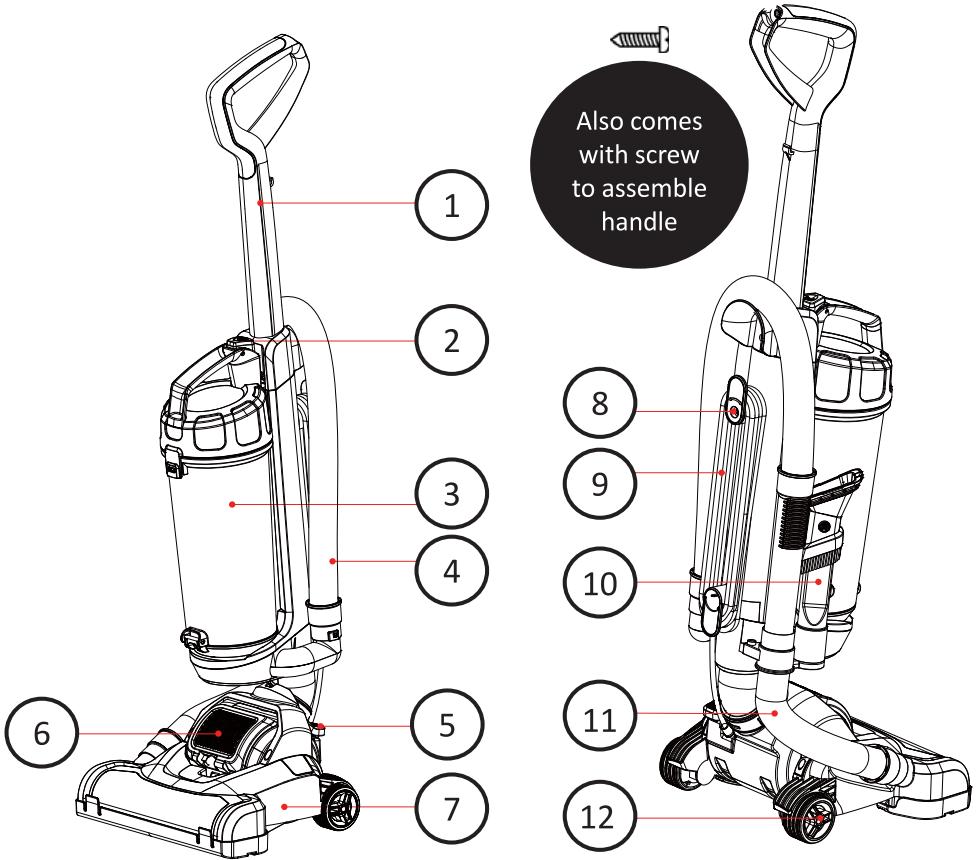

- 1. Handle
- 2. Dust container release button
- 3. Dust container
- 4. Hose
- 5. Power button
- 6. Air outlet

- 7. Hard floor adaptor
- 8. Quick cord release
- 9. Power cord
- 10. 2 in 1 crevice tool
- 11. Brush hose
- 12. Wheel

# Assembly

## Assembling your upright

1. Remove the dust container first then insert the handle into the body, then rotate the screw into body.

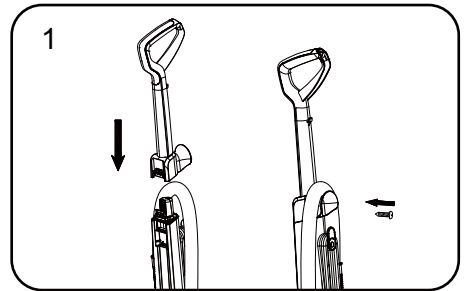

2. Place the dust container onto the machine and push until it clicks into place.

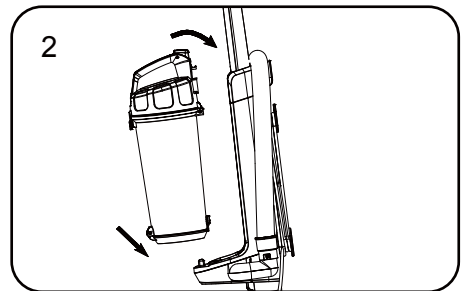

3. Insert the handle hose end into the connector hose and rotate the join clockwise. Then insert the handle into the other hose of the body.

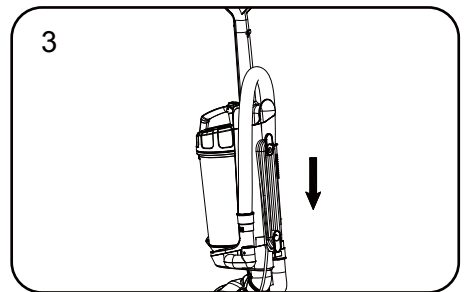

4. Insert the crevice tube into the machine.

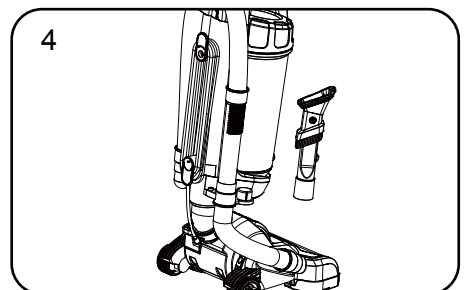

# Operation

## Operating the appliance

1. Twist the quick release cord hook to release the power cord.

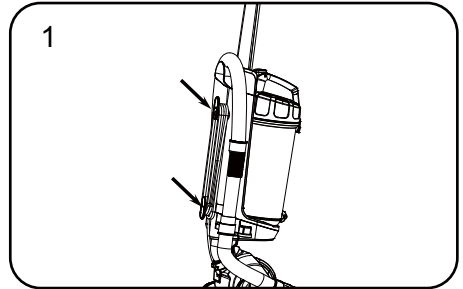

2. Step on the brush cover then turn the machine along the arrow.

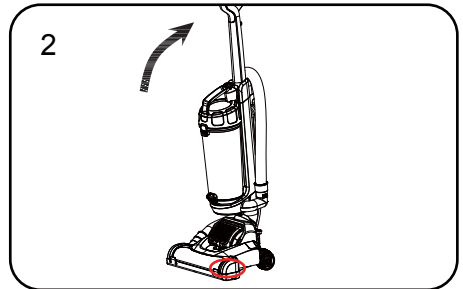

3. Plug in your machine and push ON/OFF button to switch on.

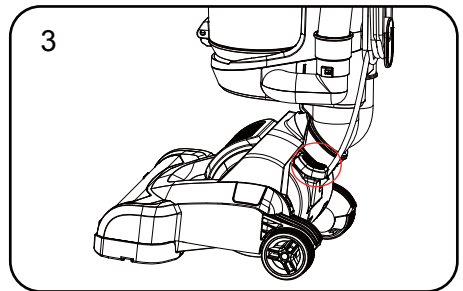

4. Don't over fill the dirt container to avoid clogging your filter.

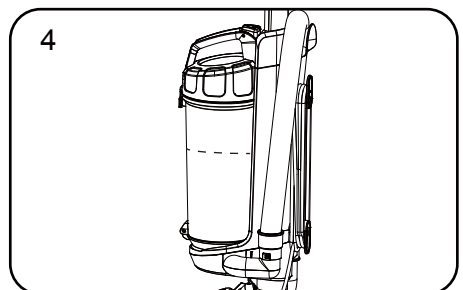

# Operation

## Operating the appliance

5. Remove hose handle and crevice tube from the machine.

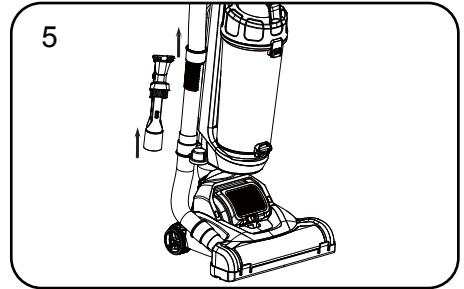

6. The handle hose can used immediate.

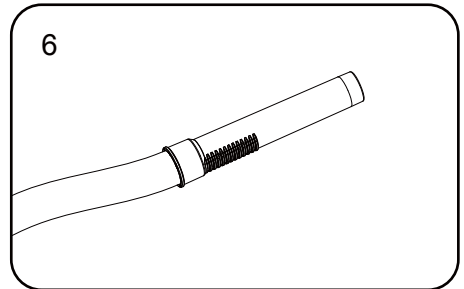

7. At the same time, you can insert the crevice tube into the hose handle to extend the distance.

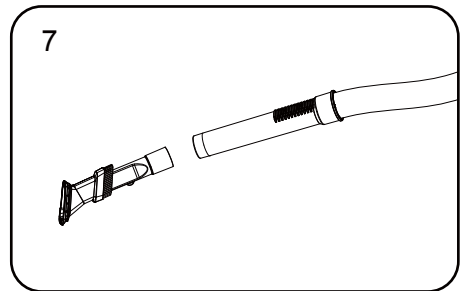

8. Cord can be winded around upper hook when using.

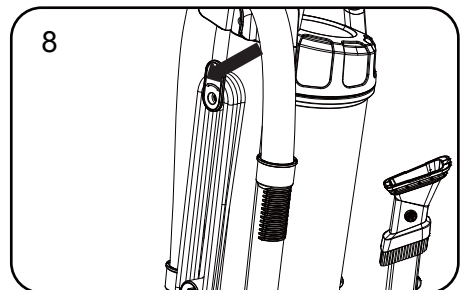



# Operation

## Using the Hard Floor Adaptor

Apply the Hard Floor Adaptor for optimum results on hard floors. The Hard Floor Adaptor can be used on any floor setting.

1. Lie vacuum cleaner on its back exposing brush bar.
2. Align Hard Floor Adaptor with base of vacuum cleaner, push until it clicks into place.

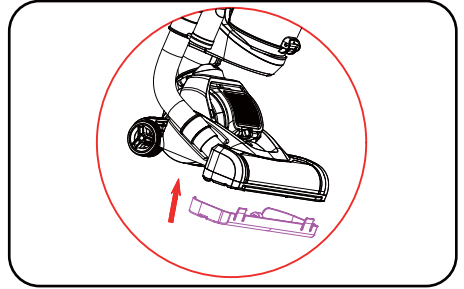

## Emptying the dirt container

1. Press dust container release button to remove the dust container.
2. Hold dust container over a bin and unclip the lock on the bottom of the dust container, allowing the dust to fall out.
3. Close the base of the dust container, align the dust container base back onto the machine and push until it clicks back into place.

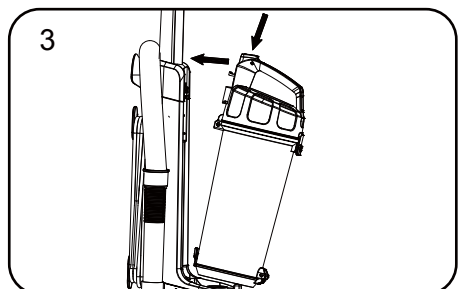
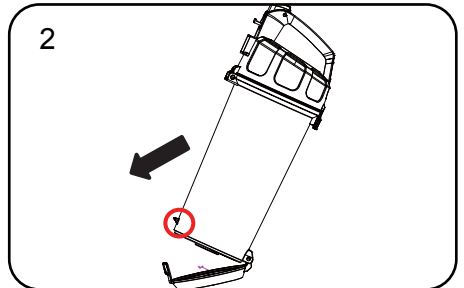
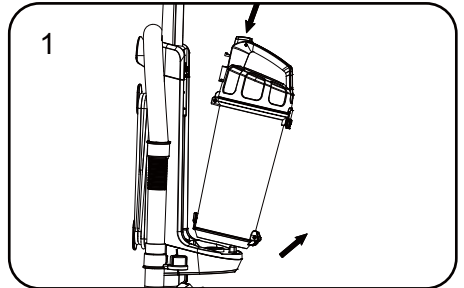

# Maintenance

## How to clean the filters

With frequent use you need to clean the filters in order to maintain peak performance and lengthen product life span,

To remove the dust container, press the red release button on the head and pull away/upwards from the unit.

1. open the head of the container by pulling the tab on the front in an outwards/ upwards motion.

2. Once you have lifted off the lid, pull out the filters as per the diagram and separate the foam from the plastic.

3. Both parts of the filter need to be washed. Dust off the filter over the bin by tapping/using a brush. Run both parts of the filter under the tap to clean.

4. Leave to fully dry for at least 24 hours before placing back in the container.

The black foam filter slots back into the plastic, with the foam facing downwards. Put the assembled filter back into the dust container with the plastic side facing upwards and close the lid. It will 'click' and secure.

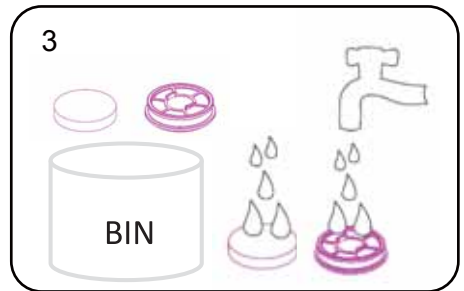
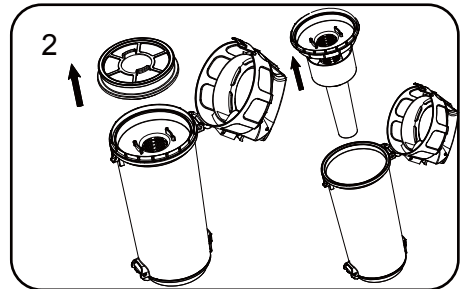
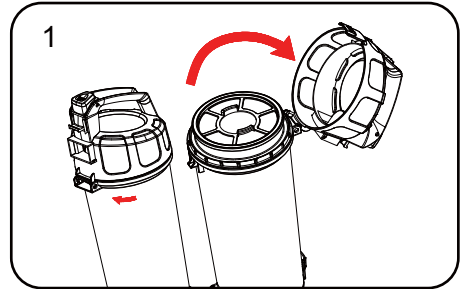

# Maintenance

## How to clean the filters

Repeat the step 1 and 2 on page 9.

3. Lift out the cone filter.

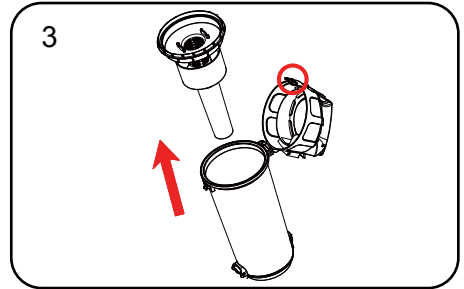

4. Rinse the cone filter under the tap.

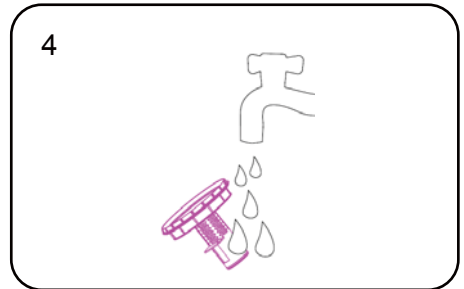

5. Leave to fully dry for at least 24 hours before placing back in the container.

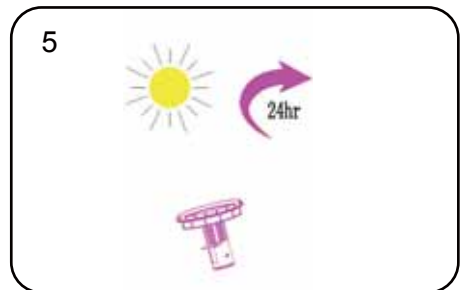

To place back into the container, lower inside the dust container. Put the assembled filter back into the dust container with the plastic side facing upwards and close the lid. It will 'click' and secure.

# Troubleshooting

<b>Problem</b>	<b>Possible causes</b>	<b>Solutions</b>
There is an accessory missing	1. A part(s) is missing from box	1. Check the 'PARTS' page of your instructions
The vacuum cleaner does not switch on	<ol style="list-style-type: none"> <li>1. The unit is not plugged into a mains socket</li> <li>2. The power button on the unit has not been depressed</li> <li>3. The thermal motor cut out has been activated</li> <li>4. There is no electricity to the power socket</li> </ol>	<ol style="list-style-type: none"> <li>1. Ensure the plug is firmly in the socket and switched on</li> <li>2. Depress the power switch on the unit</li> <li>3. If the unit has cut out during use, disconnect the unit from the wall socket, allow to cool for one hour, clean the filters, empty bin and check the hose/accessories for blockages</li> <li>4. Seek expert help from a qualified electrician</li> </ol>
The vacuum cleaner won't pick up	<ol style="list-style-type: none"> <li>1. The accessories are not correctly fitted</li> <li>2. There are blockages in the hose/ accessory</li> <li>3. The dust bag is full</li> <li>4. The filters are blocked/clogged</li> </ol>	<ol style="list-style-type: none"> <li>1. Check hose/tools are correctly attached to the machine/hose/tube; refer to 'ASSEMBLY/ OPERATION' section</li> <li>2. Check the air paths of the hose/accessory are not obstructed by blockages</li> <li>3. Check dust bag and if necessary empty</li> <li>4. Frequently cleaning filters will maintain performance; see 'MAINTENANCE' section</li> </ol>
Dust is escaping from the vacuum cleaner	<ol style="list-style-type: none"> <li>1. The filters/dust bag are not fitted correctly</li> <li>2. The filters are damaged</li> </ol>	<ol style="list-style-type: none"> <li>1. See 'PARTS' and 'MAINTENANCE' sections</li> <li>2. If the filters are damaged these will need to be replaced</li> </ol>
Accessories won't pick up dust/debris	<ol style="list-style-type: none"> <li>1. The wrong tool is fitted for the task</li> <li>2. The tools are blocked</li> <li>3. The filters are blocked</li> <li>4. The dust bag is full</li> <li>5. The hose/tubes are blocked</li> </ol>	<ol style="list-style-type: none"> <li>1. See 'PARTS' section</li> <li>2. Check the air paths of the tools are not obstructed by blockages</li> <li>3. Frequently cleaning filters will maintain performance; check 'MAINTENANCE' section</li> <li>4. Check and empty the dust bag</li> <li>5. Check the air paths of the hose/tubes are not obstructed by blockages</li> </ol>
The blockage indicator (if applicable to model) activates	<ol style="list-style-type: none"> <li>1. The filters/dust bag are blocked</li> <li>2. The dust bag is full</li> <li>3. The accessories/hose/tube are blocked</li> </ol>	<ol style="list-style-type: none"> <li>1. Frequently cleaning filters will maintain performance; check 'MAINTENANCE' section</li> <li>2. Check and empty dust bag</li> <li>3. Check the air paths of the accessories/hose/ tubes are not obstructed by blockages</li> </ol>

# Technical Specifications

<b>Model Number</b>	VUS31ASS1
Voltage	220-240V~ 50Hz
Energy efficiency class	A
Annual energy consumption	27,2 kWh/annum
Carpet cleaning performance class	C
Hard floor cleaning performance class	D
Dust re-emission class	G
Sound power level	88dB(A)
Rated input power	700W

We apologise for any inconvenience caused by minor inconsistencies in these instructions, which may occur as a result of product improvements and development.



## EEC statement of compliance



Manufacturer/EEC importer: Hereby on our own responsibility, declare that the VUS31ASS1 is manufactured in compliance with the following Directives:

Safety: 2006/95/EC Low Voltage Directive  
EMC: 2004/108/EC Electromagnetic Compatibility Directive

Waste electrical products should not be disposed of with household waste. Please recycle where facilities exist. Check with your Local Authority or retailer for recycling advice.



## PRODUCT GUARANTEE

This product is guaranteed against manufacturing defects for a period of



Year

This product is guaranteed for twelve months from the date of original purchase.

Any defect that arises due to faulty materials or workmanship will either be replaced, refunded or repaired free of charge where possible during this period by the dealer from whom you purchased the unit.

The guarantee is subject to the following provisions:

- The guarantee does not cover accidental damage, misuse, cabinet parts, knobs or consumable items.
- The product must be correctly installed and operated in accordance with the instructions contained in this manual.
- It must be used solely for domestic purpose.
- The guarantee will be rendered invalidated if the product is re-sold or has been damaged by inexpert repair.
- Specifications are subject to change without notice.
- The manufacturer disclaims any liability for the incidental or consequential damages.
- The guarantee is in addition to, and does not diminish your statutory or legal rights.
- In the event of a problem with the product within the guarantee period call the Customer Helpline on 0345 640 0800.

Guarantor: Argos Ltd  
489 - 499 Avebury Boulevard  
Central Milton Keynes  
MK9 2NW