



we ♥ clean

User Guide

Vax Careline: (UK) 0844 412 8455
(ROI) 1-800 928 308

Multifunction

6131

multivax



Get Cleaning...

What's your Vax model number?

6 1 3 1 ■ ■

What's your serial number? (Located on the base of the machine)

■ - ■ ■ ■ ■ ■ ■ ■ - ■ ■ ■ - ■ ■ ■ - ■ ■ ■ - ■ ■ ■ ■ ■ ■ ■ ■ ■ ■

Note these down in case you need them in future. Please keep instructions for further use.

Machine Overview

- 1 Filter housing
- 2 Clean water tank
- 3 Dirty water tank/dirt container
- 4 Carry handle
- 5 on/off button
- 6 Solution pump on/off button
- 7 Power cord
- 8 Motor housing lid
- 9 2 piece extension tube
- 10 Crevice tool
- 11 Dusting brush
- 12 Upholstery tool
- 13 Hose and handle
- 14 Solution delivery tube
- 15 Combination floor head
- 16 Fibre flow wash head
- 17 Upholstery wash tool
- 18 3 x paper dust bags
- 19 Vax cleaning solution

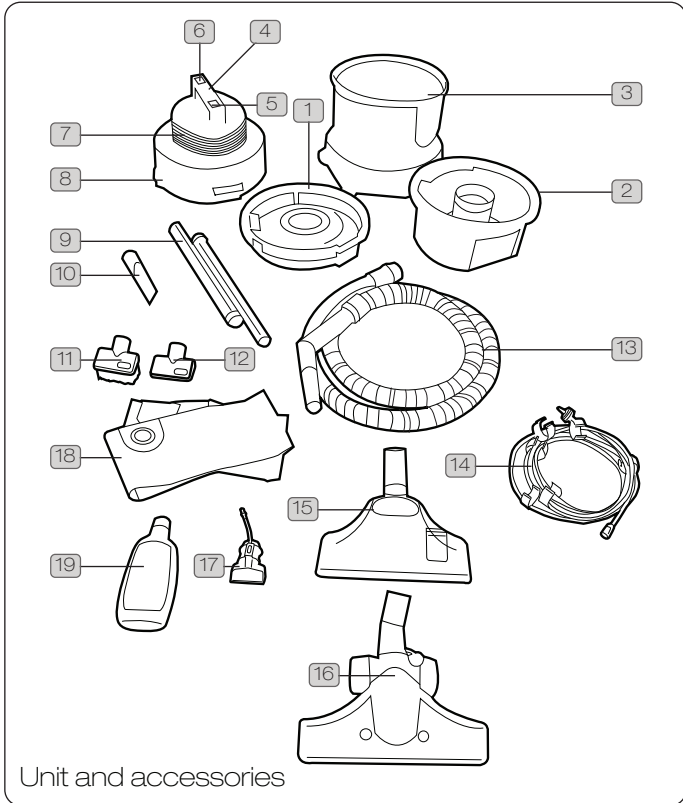

20

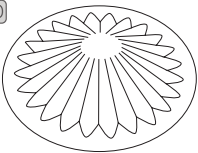

21

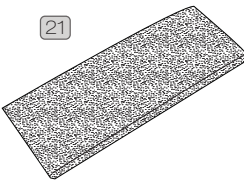

22

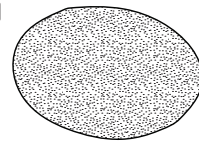

Filters

20 Cone filter

21 Foam post-motor filter

22 Foam pre-motor filter

General Safety Information

FOR HOUSEHOLD USE ONLY.

When using the vacuum cleaner, basic safety precautions should always be observed, including the following:

1. Do not leave the multifunction machine unattended when plugged in. Unplug it from the socket when not in use.
2. To prevent electric shock do not use outdoors.
3. Not to be used as a toy.
4. Children should be supervised to ensure that they do not play with the appliance.
5. This appliance is not intended for use by persons (including children) with reduced physical, sensory or mental capabilities, or lack of experience and knowledge, unless they have been given supervision or instruction concerning the use of the appliance by a person responsible for their safety.
6. Use only as described in this manual. Use only Vax recommended attachments.
7. Do not use the vacuum cleaner if it has been dropped, damaged, left outdoors or dropped into water. Do not use the vacuum cleaner with a damaged cord or plug. If the supply cord is damaged, it must be replaced by the manufacturer or a recommended Service Agent to avoid hazard and invalidating the guarantee.
8. Do not handle the plug or multifunction machine with wet hands. Do not use outdoors.
9. Do not put any objects into openings or operate with openings blocked. Keep them free of anything that might reduce airflow.
10. Keep hair, loose clothing, fingers and all parts of body away from openings and moving parts.
11. Do not pick up hot coals, cigarette butts, matches or any hot, smoking or burning objects.
12. Do not use the carpet washing function without the solution tank and dirty water tank in place.
13. Do not use the vacuum without the dust bag in place.
14. Turn off all controls before unplugging.
15. Do not vacuum up harmful or toxic material (chlorine, bleach, ammonia, drain cleaner etc.).
16. Do not vacuum up hard or sharp objects such as glass, nails, screws, coins, etc.
17. Use only CE-approved 13 amp extension cords. Non-approved cords may overheat. Care should be taken to

arrange the cord so that the cord cannot be tripped over.

18. Store the multifunction machine in a cool, dry area.
19. To prevent dirty water from running into motor, do not hold the appliance upside-down or lay on its side. Use appliance in normal vacuuming/carpet washing position.
20. Take extra care when cleaning on stairs.
21. Turn off the on/off switch before unplugging the multi-function machine.
22. Do not carry appliance while motor is running.

 **WARNING:** Always switch off and unplug the multifunction machine from the electrical outlet before assembling, opening, emptying the dirt container, before connecting/disconnecting the attachments, or carrying out maintenance or troubleshooting checks.

 **NOTE:** Carpets should be dry vacuumed thoroughly before washing.

 **IMPORTANT:** If the inlet, hose or telescopic tube is blocked, switch off the vacuum cleaner and remove the blockage(s) before re-starting the vacuum cleaner. See maintenance; Clearing Blockages.

 **IMPORTANT:** Cleaning filters maintains vacuum performance. Vax recommends that your filters should be checked and cleaned periodically. If your filters are washable make sure they are completely dry before inserting back into the multifunction machine.

 **IMPORTANT:** The motor is equipped with a thermal cut-out. If for any reason the unit should overheat, the thermostat will automatically turn the unit off. Should this occur, unplug the vacuum cleaner from the electrical outlet and turn off the switch. Remove dirt container and empty. Clean filters. Allow the unit to cool for approximately one (1) hour. To re-start, plug into an electrical outlet and switch back on.

This multifunction is intended for household use only and NOT for commercial or industrial use.

PLEASE KEEP INSTRUCTIONS FOR FURTHER USE.

Operation

! WARNING: Always switch off and unplug your multifunction machine from the electrical outlet before assembling, opening, emptying the dirt container, connecting/disconnecting the attachments, or carrying out maintenance or troubleshooting checks.

Vacuating

Assembling your multifunction cleaner (dry vacuuming)

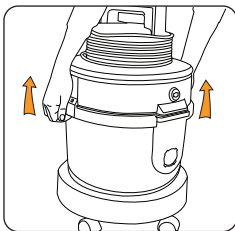

Remove motor housing.

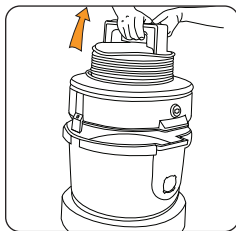

Remove clean water tank.

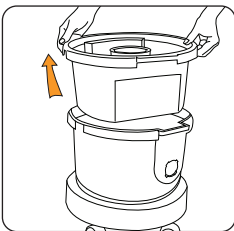

Insert dust bag.

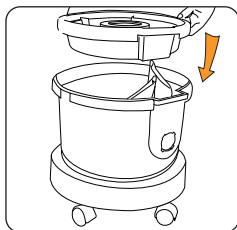
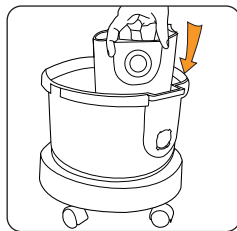

Insert the filter housing.

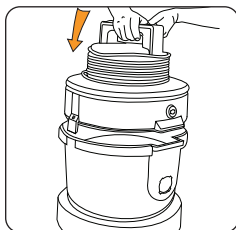

Press down on clips to secure.

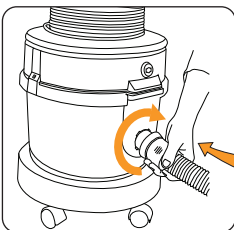

Insert hose and twist clockwise.

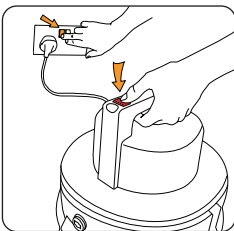
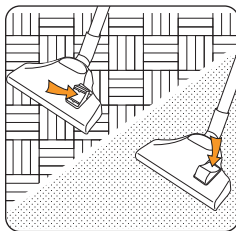
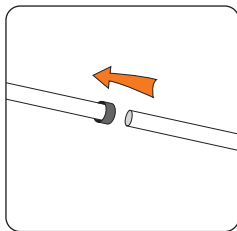
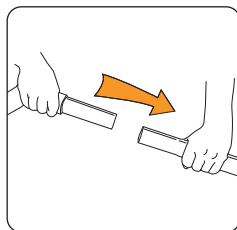

! NOTE: Fully unwind power cord.

! NOTE: The crevice tool, dusting brush and upholstery tool, can all be attached to the telescopic tube/handle.

Operation

Carpet washing



IMPORTANT: Do not use the cleaner as a dry vacuum when set up in carpet washing mode.

Before you begin cleaning:

1. Vacuum thoroughly – Use your machine in dry mode and vacuum your upholstery with appropriate tool.
2. For upholstery, always check manufacturers guidelines before washing.

Test for colourfastness – Wet a white absorbent cloth with the solution. In a small, hidden area gently rub the surface with the dampened cloth. Wait ten minutes and check for colour removal or bleed with white paper towel or cloth. If surface has more than one colour, check all colours.

When cleaning entire floor, move furniture out of area to be cleaned. For furniture too heavy to move, place aluminium foil or wax paper under legs. This will prevent wood finishes from staining carpet. Pin up furniture skirts or curtains.

Helpful hints for cleaning carpet:

1. Only use Vax recommended solution with this machine.
2. Do not over saturate carpet with cleaning solution while using the machine.
3. For heavy soiled areas, additional applications may be necessary.
4. Allow plenty of time to dry carpet thoroughly.
5. Try not to walk on carpet until it is completely dry.
6. After carpet is thoroughly dry, vacuum the carpet using your vacuum cleaner in dry mode.
7. Before cleaning, determine where to start and end, making sure not to walk over previously cleaned areas.
8. Thoroughly clean the dirty water tank and clean water tank after use with warm water (max 40°C).

Operation

Assembling your multifunction cleaner (carpet washing)

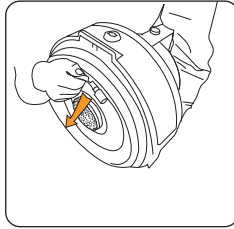
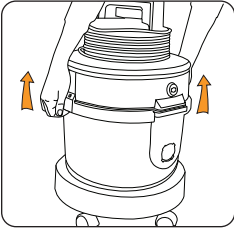

Remove solution tube from under side of motor housing.

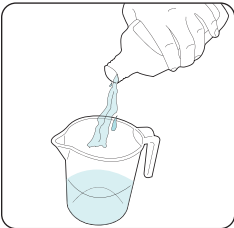
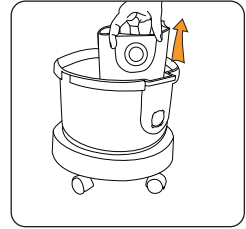
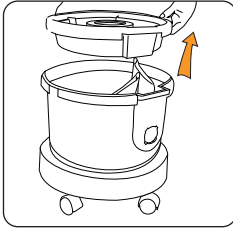

Add 40ml of Vax solution per 1 litre of water, unless otherwise stated on the bottle.

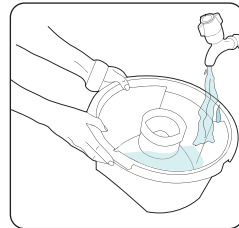
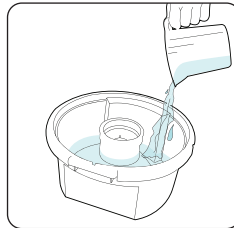

Fill tank with warm water (max 40° C).

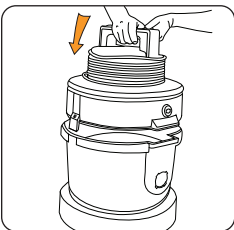

Press down on clips to secure.

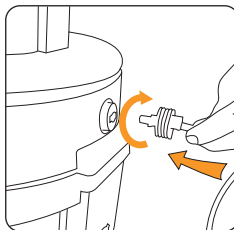

Attach solution tube.

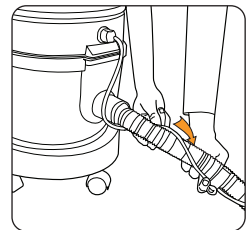
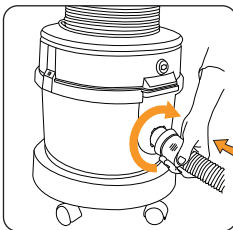

Ensure the solution tube is wrapped loosely around the hose and extension tubes. Secure in place with the clips provided.

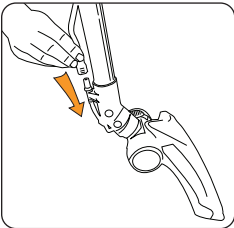

Operation

Operating the appliance (carpet washing mode)

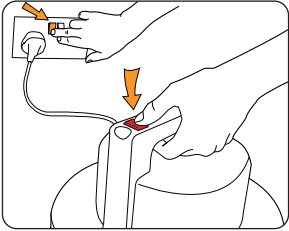

Red button – Power.

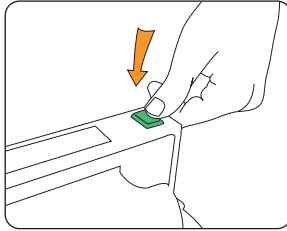

Green button – Activate pump.

Washing carpets

! **NOTE:** For best results apply solution on the forward stroke and recover solution on the backward stroke.

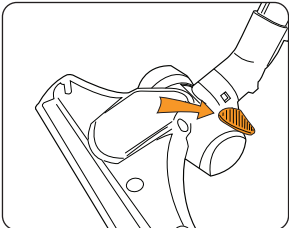

Ensure rocker switch is towards the back of the Fibreflow wash head to allow water flow.

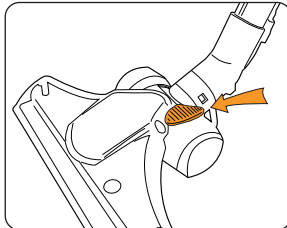

To suck up excess water push the rocker switch to the front.

Operation

Washing upholstery

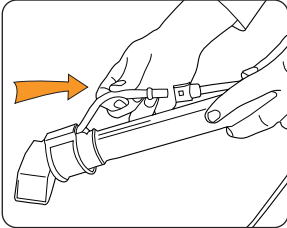

Attach the upholstery wash tool directly onto the handle of the hose and wrap the excess solution tube around as necessary.

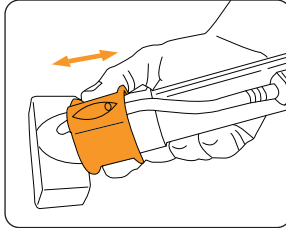

To start water and solution flow, push the collar on the wash tool forwards.

To recover excess water and solution, pull the collar backwards.

Maintenance (Keep your Vax as good as new)

! **WARNING:** Always switch off and unplug your multifunction machine from the electrical outlet before assembling, opening, emptying the dirt container, connecting/disconnecting the attachments, or carrying out maintenance or troubleshooting checks.

Emptying and replacing the dust bag

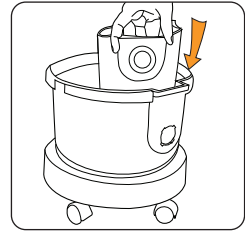
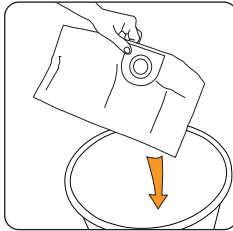
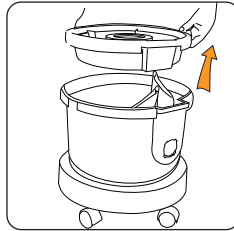
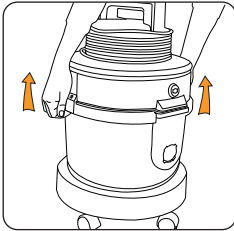

Insert new bag.

! **IMPORTANT:** The condition of the filters affects the performance of your machine. Please check, wash/change filters periodically (depending on level of use).

Replacing the cone filter

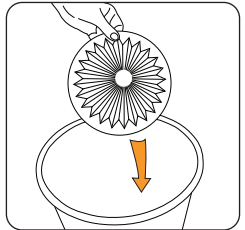
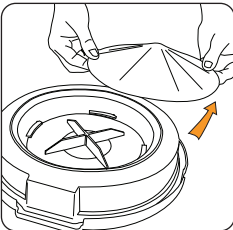
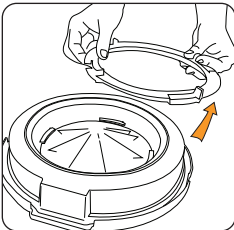
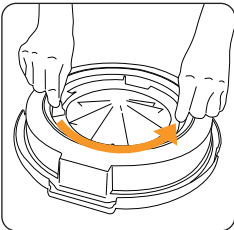

Cleaning the post motor filter

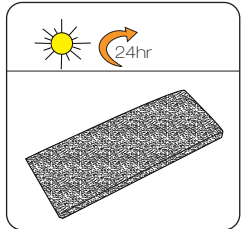
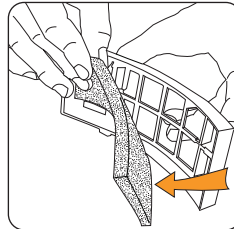
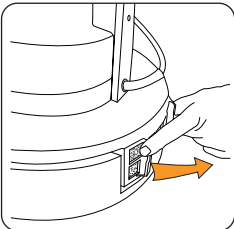

Maintenance (Keep your Vax as good as new)

! WARNING: Always switch off and unplug your multifunction machine from the electrical outlet before assembling, opening, emptying the dirt container, connecting/disconnecting the attachments, or carrying out maintenance or troubleshooting checks.

Cleaning the pre-motor filter

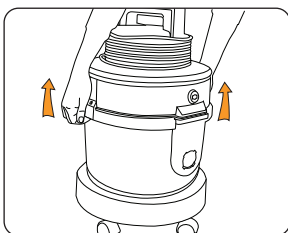

Remove motor housing.

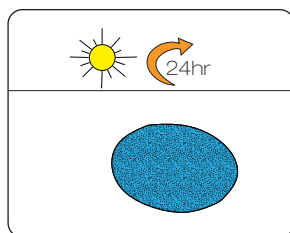
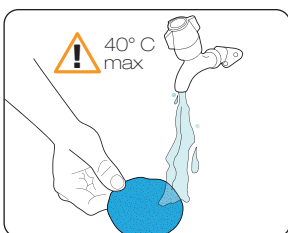
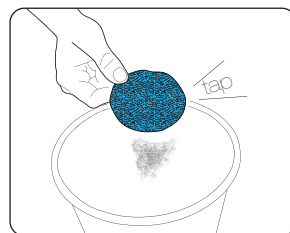
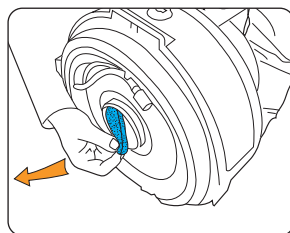

Emptying and cleaning the clean and dirty water tanks

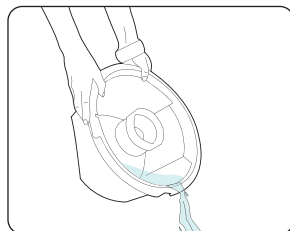

Empty and rinse both tanks out with clean water after use.

FAQs



WARNING: To reduce the risk of personal injury, unplug your multifunction cleaner before performing maintenance/troubleshooting checks.

Is there an accessory missing?

- Check the parts overview page to make sure the attachment is supplied with your unit.
- If it is missing, please call our vax careline to order a replacement: 0844 412 8455 or visit vax.co.uk to order online.

Why won't my multifunction cleaner put down water/solution mix?

- Check there is water/solution mix in the clean water tank.
- Ensure the solution tube on the underside of the motor housing has been released and is in the clean water tank.
- Check that the pump button on the carry handle has been switched on.
- Ensure the foot pedal on the floor head is positioned to the back of the floor head.
- Ensure the collar on the wash tool is pushed forward.

Why won't my multifunction cleaner recover water?

- The dirty water tank may be full.
- The floor head/wash tool nozzle might have an obstruction.

What do I do if an accessory/the unit has become damaged or broken?

- Visit vax.co.uk for parts and spares.
- Please call our careline to purchase new spares or order a replacement: 0844 412 8455.

Why won't the multifunction cleaner pick up in dry mode?

- A filter may be clogged; refer to maintenance section for cleaning instructions.
- The dust bag may be incorrectly fitted, check assembling your machine in dry mode.
- The dust bag may be full, check and replace with a new dust bag.
- Check for blockages in the hose/floor heads/accessories.

Why is dust escaping from my multifunction cleaner in dry mode?

- The filters may be incorrectly installed, check that they are fitted correctly.
- The dust bag may be incorrectly fitted, check assembling your machine in dry mode.



Don't take your machine back to the shop, simply contact us

vax.co.uk

0844 412 8455

This does not affect your statutory rights.

Other Information

Service & Help

Vax Careline:

(UK) 0844 412 8455

(ROI) 1-800 928 308

Monday-Friday 8.30am to 6.30pm

Saturday-Sunday 9.00am to 5.00pm

If you have any queries or concerns about using your multifunction cleaner, call the Vax Careline. Please make a note of the serial number and model number of the carpet cleaner before calling. For the nearest Service Agent, please call the Vax Customer Careline or visit vax.co.uk

Technical Specification

Voltage: 220-240V ~50Hz

Wattage: 1300 W

Capacity: Dust bag 10 litres
Clean water tank 4 litres
Dirty water tank 8 litres

Cord Length: 10m

Weight: 8.7kg

Subject to technical change without notice.



EEC Statement of Compliance

Manufacturer/EEC importer: Vax Limited, hereby on our own responsibility, declare that the 6131 series is manufactured in compliance with the following Directives:

Safety: 2006/95/EC Low Voltage Directive

EMC: 2004/108/EC Electromagnetic Compatibility Directive



Waste electrical products should not be disposed of with household waste. Please recycle where facilities exist. Check with your Local Authority or retailer for recycling advice.

Notes



Notes



Notes





Vax Ltd., Kingswood Road, Hampton Lovett, Droitwich, Worcestershire, WR9 0QH, UK
email: info@vax.co.uk - website: vax.co.uk

Version 1.1