

# COOKWORKS

## FOOD PROCESSOR

### INSTRUCTION MANUAL



Read all the instructions carefully before using and please retain this instruction manual for further reference.

## IMPORTANT SAFEGUARDS

When using electrical appliances, basic safety precautions should always be followed, including the following:

- Read all instructions carefully, even if you are familiar with appliance.
- To protect against the risk of electric shock DO NOT IMMERSE the appliance, cord set or the plug in water or any other liquid.
- To clean, wipe exterior with a damp cloth.
- Close supervision is necessary when any appliance is operated near children. The appliance must not be used by children.
- Always disconnect the blender from the supply if it is left unattended and before assembling, disassembling or cleaning.
- Avoiding contacting moving parts. Keep hands, hair, clothing as well as spatulas and other utensils away during operation to prevent injury and/or damage to the appliance.
- Do not operate any appliance with a damaged cord or plug, or if appliance malfunctions or is damaged in any manner.
- Handle sharp blades carefully to avoid cuts and injuries.
- The use of attachments or accessories not recommended or sold by this appliance manufacturer may result in fire, electrical shock or injury.
- This appliance is designed for indoor use only.
- Do not allow cord to hang over edge of table or counter, or touch hot surfaces.
- Do not place unit on or near a gas or electric burner or a heated oven.
- Do not use appliance for mixing paints or other flammable liquids or in a location contaminated with flammable gases or vapours.
- Do not leave the appliance unattended. Do not use the appliance for other than its intended use.
- Do not use abrasive cleaners or scouring pad on appliance.
- Ensure switch off the unit after each use. Make sure the motor stops completely before disassembled.
- If the supply cord is damaged, it must be replaced by the manufacturer, its service agent or similarly qualified persons in order to avoid a hazard.
- Do not allow children to use the blender without supervision.
- This appliance can be used by children aged from 8 years and above and persons with reduced physical, sensory or mental capabilities or lack of experience and knowledge if they have been given supervision or instruction concerning use of the appliance in a safe way and understand the hazards involved. Children shall not play with the appliance. Cleaning and user maintenance shall not be made by children without supervision.

- Never blend frozen ingredients that have formed a solid mass during freezing, break it up before adding to the bowl.
- Ensure switch off the unit after each use. Make sure the motor stops completely before disassembled.
- Never blend more than the maximum capacity stated in the recommended speed chart.
- To ensure long life of your blender, do not run it for longer than 60 seconds. Stop and allow to cool for 3 minutes before resume.

## KNOW YOUR APPLIANCE

1. Motor Base
2. Driver
3. Processing Bowl
4. Blade Adapter
5. Chopper
6. Transparent lid
7. Pusher
8. Blade Holder
9. Slicing Blade
10. Fine Grating Blade
11. Coarse Grating Blade

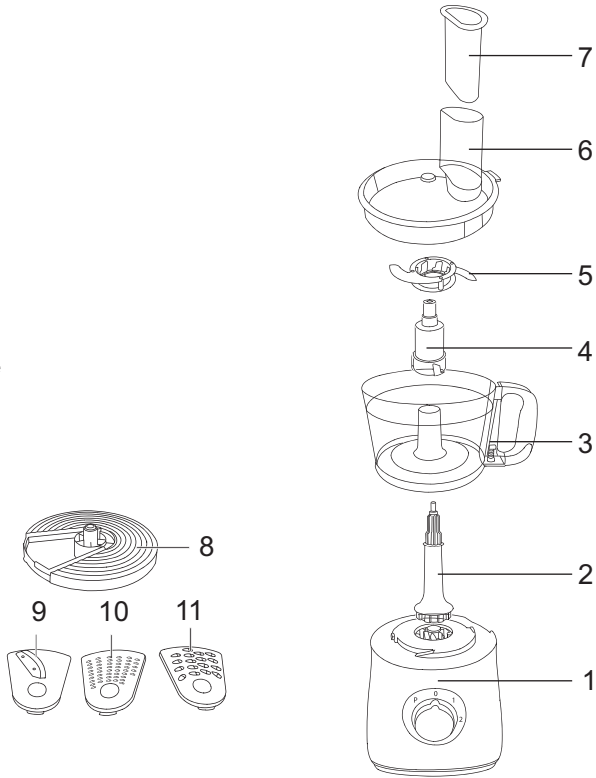

## BEFORE USING FOR THE FIRST TIME

- Check that the voltage of the appliance corresponds to the voltage at your house.
- Wash the bowl in warm soapy water and rinse well.
- The bowl assembly should be firmly in place on motor base.

## SAFETY LOCK SYSTEM

This appliance is equipped with a safety lock system which will prevent the motor starting without proper installation of the bowl and its lid.

To activate the system, you have to carry out the following:

- Put the plastic bowl onto the base with the handle at right hand side.
- Turn the bowl until the alignment marks on the base and bowl are in line.
- The lid has an activator to trigger the safety lock system. The lid must be fitted onto the bowl and turn until it clicks into position.

The food processor can only be operated with the bowl handle fitted at the right hand side. The unit does not operate if the bowl was fitted at left hand side. (see right diagram)

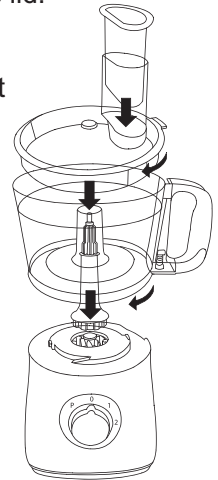

## USEFUL INFORMATION

- DO NOT OPERATE PROCESSOR LONGER THAN 60 SECONDS AT ONE TIME. STOP AND COOL FOR 3 MINUTE THEN RESUME.
- The lid should be in place when operating.
- Do not use the bowl for storing beverages or foods.
- This appliance is equipped with a protective device. While the internal temperature is too high, it will switch itself off. Wait at least 15 minutes for the protection system to reset before attempting to restart the unit.
- The bowl capacity is 1200ML (for liquid) / 2000ML (for dry).

## OPERATION GUIDE FOR FOOD PROCESSOR

1. Position the driver on motor base.
2. Position the processing bowl into the driver and turn clockwise to seat firmly on motor base.
3. Place blade adaptor onto the driver.
4. Place chopper onto the blade adaptor.
5. Turn the chopper to the right position.
6. Place cover on bowl, turn clockwise until cover interlocks on bowl.
7. Place pusher into feeding chute

Processed Food	Measurement Per batch
Chocolate	≤100g
Cheese	≤200g
meat	≤500g
Tea or Spice	50~100g
Fruit & Vegetable	100~300g
Onion	≤500g

### Tips and Warning

Always keep the chopper inside the bowl before feeding food.

Use pulse function for several times to avoid cutting too fine. Do not run for too long while cutting hard cheese or chocolate. Otherwise these materials will overheat and begin to melt.

Standard chopping period: 30-60 sec.

### IMPORTANT HINTS

- **TO ENSURE LONG LIFE OF YOUR FOOD PROCESSOR, DO NOT RUN IT FOR LONGER THAN 60 SECONDS. STOP AND COOL FOR 3 MINUTES BETWEEN BLENDING CYCLES.**
- Switch off as soon as you've got the right consistency.
- Don't process spices – they may damage the plastic.
- Thick mixtures, e.g. pâtés and dips, may need scraping down. If the mixture is difficult to process, add more liquid.
- Do not switch on your processor if the bowl is empty. The cutter bearing may be damaged if run at “No Load”.
- Cut cooked meats into one centimeter before adding into bowl. Please do not add raw meats.
- Do not use the bowl for storing beverages or foods.

## CLEANING

- The pulse button allows you to clean the bowl and the blade easily, rapidly and in complete safety.
- Pour a little lukewarm water into the bowl.
- Turn to pulse function for a few seconds.
- Remove the bowl and rinse under running water.
- Wipe and clean the motor housing with a damp cloth. Never immerse in water.

## STORING

The appliance should not be stored while hot or plugged in. When not in use, allow the appliance to cool, then put it back into the box and store out of reach of children in safe, dry place.

## CONNECTION TO POWER

- Before connecting, check that the voltage indicated on the appliance corresponds with the main voltage in your home. If this is not the case, consult your dealer and do not use.
- This appliance may be fitted with a non-rewirable plug. If you need to change the fuse in a non-rewirable plug, the fuse cover must be refitted. If the fuse cover is lost or damaged, the plug must not be used until a replacement is obtained (available from the appliance manufacturer).
- If the plug has to be changed because it is not suitable for your socket, or becomes damaged, it should be cut off and appropriate plug fitted following the wiring instructions. The plug removed must be disposed of safely as insertion into a mains socket is likely to cause an electrical hazard.
- This equipment must be disconnected from the mains when not in use. Do not allow this unit to be exposed to rain or moisture.

**For your own safety read the following instructions carefully before attempting to connect this unit to the mains.**

You should only plug the appliance into a 220-240V AC, 50Hz supply. Connecting it to other power sources may damage the appliance.

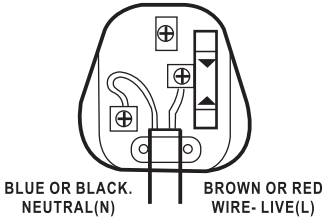

The wires in this mains lead are coloured in accordance with the following code:

**BLUE = NEUTRAL**  
**BROWN = LIVE**

## **IMPORTANT**

The colours of the wires in the mains lead of this appliance may not correspond with the coloured markings identifying the terminals in your plug, proceed as follows:



**Caution**  
To prevent electric shock disconnect from the mains before removing the cover

The blue wire must be connected to the terminal marked with the letter N or coloured black.

The brown wire must be connected to the terminal marked with the letter L or coloured red.

If a 13 Amp (BS1363) fused plug is used it must be fitted with a 13A fuse conforming to BS1362 and be ASTA approved.

If in doubt contact a qualified electrician

## DISPOSAL INFORMATION



Waste electrical products should not be disposed of with household waste. Please recycle where facilities exist. Check with your local authority for recycling advice.



## GUARANTEE

This product is guaranteed against manufacturing defects for a period of 1 year.

This does not cover the product where the fault is due to misuse, abuse, use in contravention of the instructions, or where the product has been the subject of unauthorized modifications or alterations, or has been the subject of commercial use

In the event of a problem with the product within the guarantee period please return it to your nearest Argos store

If the item is shown to have had an inherent defect present at the time of sale, the store will provide you with a replacement.

Your statutory rights remain unaffected

Guarantor: Argos Ltd  
489 499 Avebury Boulevard  
Central Milton Keynes  
MK9 2NW