



电话(TEL)

0573-83225888-503

网址(Http)

www.yattool.com

名称/料号	说明书PR8458-620132	颜色				<b>K</b>
制作日期	2014-10-14	专 色				
尺 寸	A5(145x210)mm					
运用软件	PDF					
客 户	CH171	页 数	12 张A5纸			
材质,表面处理	70g双胶纸	备 注				
设计人员	张妹珍					

# Sovereign 2600W Blower Vac

2921084  
(Model: YT6201-12)

## Instruction Manual



### After Service Support

Helpline No.: 0345 077 8888

Web site: <http://www.argosspares.co.uk>

**WARNING Important-Please read these instructions fully before starting assembly.**

These instructions contain important information that will help you get the best from your product, ensuring it is assembled correctly and safely. If you need help or have damaged or missing parts, call the Customer Helpline on 0345 077 8888.

# CONTENTS

- GENERAL POWER TOOLS SAFETY WARNINGS.....3
- SPECIAL SAFETY INSTRUCTIONS FOR SHREDDERS.....5
- SYMBOLS.....7
- DIAGRAM.....9
- PARTS LIST.....9
- INTENDED USE.....10
- ASSEMBLY.....11
- OPERATION.....14
- CLEANING AND MANTENIANCE .....18
- TECHNICAL DATA.....20
- GUARANTEE ..... 21
- TROUBLESHOOTING .....22
- RECYCLING AND DISPOSAL.....22

# GENERAL POWER TOOLS SAFETY WARNINGS

## General Power Tool Safety Warnings



**WARNING** Read all safety warnings and all instructions.

Failure to follow the warnings and instructions may result in electric shock, fire and/or serious injury.



**WARNING!** Read all safety warnings designated by the  symbol and all instructions. Save all warnings and instructions for future reference.

The term "power tool" in the warnings refers to your mains-operated (corded) power tool or battery-operated (cordless) power tool.

**WARNING!** Depending on the actual use of the product the vibration values can differ from the declared total! Adopt proper measures to protect yourself against vibration exposures. Take the whole work process including times the product is running under no load or switched off into consideration.

Proper measures include among others regular maintenance and care of the product and application tools, keeping hands warm, periodical breaks and proper planning of work processes.

## Work Area Safety

**a) Keep work area clean and well lit.**

Cluttered or dark areas invite accidents.

**b) Do not operate power tools in explosive atmospheres, such as in the presence of flammable liquids, gases or dust.**

Power tools create sparks which may ignite the dust or fumes.

**c) Keep children and bystanders away while operating a power tool.**

Distractions can cause you to lose control.

## Electrical Safety

**a) Power tool plugs must match the outlet. Never modify the plug in any way. Do not use any adapter plugs with earthed (grounded) power tools.**

Unmodified plugs and matching outlets will reduce risk of electric shock.

**b) Avoid body contact with earthed or grounded surfaces, such as pipes, radiators, ranges and refrigerators.**

There is an increased risk of electric shock if your body is earthed or grounded.

**c) Do not expose power tools to rain or wet conditions.**

Water entering a power tool will increase the risk of electric shock.

**d) Do not abuse the cord. Never use the cord for carrying, pulling or unplugging the power tool. Keep cord away from heat, oil, sharp edges or moving parts.**

Damaged or entangled cords increase the risk of electric shock.

**e) When operating a power tool outdoors, use an extension cord suitable for outdoor use.**

Use of a cord suitable for outdoor use reduces the risk of electric shock.

**f) The use of a residual current device (RCD) when using this tool is recommended.**

Use of an RCD reduces the risk of electric shock.

# GENERAL POWER TOOLS SAFETY WARNINGS

## Personal Safety

**a) Stay alert, watch what you are doing and use common sense when operating a power tool. Do not use a power tool while you are tired or under the influence of drugs, alcohol or medication.**

A moment of inattention while operating power tools may result in serious personal injury.

**b) Use personal protective equipment. Always wear eye protection.**

Protective equipment such as dust mask, non-skid safety shoes, hard hat, or hearing protection used for appropriate conditions will reduce personal injuries.

**c) Prevent unintentional starting. Ensure the switch is in the off-position before connecting to power source and/or battery pack, picking up or carrying the tool.**

Carrying power tools with your finger on the switch or energising power tools that have the switch on invites accidents.

**d) Remove any adjusting key or wrench before turning the power tool on.**

A wrench or a key left attached to a rotating part of the power tool may result in personal injury.

**e) Do not overreach. Keep proper footing and balance at all times.**

*This enables better control of the power tool in unexpected situations.*

**f) Dress properly. Do not wear loose clothing or jewellery. Keep your hair, clothing and gloves away from moving parts.**

Loose clothes, jewellery or long hair can be caught in moving parts.

**g) If devices are provided for the connection of dust extraction and collection facilities, ensure these are connected and properly used.**

Use of dust collection can reduce dust-related hazards.

## Power Tool Use and Care

**a) Do not force the power tool. Use the correct power tool for your application.**

The correct power tool will do the job better and safer at the rate for which it was designed.

**b) Do not use the power tool if the switch does not turn it on and off.**

Any power tool that cannot be controlled with the switch is dangerous and must be repaired.

**c) Disconnect the plug from the power source and/or the battery pack from the power tool before making any adjustments, changing accessories, or storing power tools.**

Such preventive safety measures reduce the risk of starting the power tool accidentally.

**d) Store idle power tools out of the reach of children and do not allow persons unfamiliar with the power tool or these instructions to operate the power tool.**

Power tools are dangerous in the hands of untrained users.

**e) Maintain power tools. Check for misalignment or binding of moving parts, breakage of parts and any other condition that may affect the power tool's operation. If damaged, have the power tool repaired before use.** Many accidents are caused by poorly maintained power tools.

**f) Keep cutting tools sharp and clean.**

Properly maintained cutting tools with sharp cutting edges are less likely to bind and are easier to control.

**g) Use the power tool, accessories and tool bits etc. in accordance with these instructions, taking into account the working conditions and the work to be performed.**

Use of the power tool for operations different from those intended could result in a hazardous situation.

## GENERAL POWER TOOLS SAFETY WARNINGS

### Service

1. Have your power tools serviced by a qualified repair person using only identical replacement parts. This will ensure that safety of the power tool is maintained.
2. For cable replacement, please contact the specified helpline for spare parts.

## SPECIAL SAFETY INSTRUCTIONS FOR BLOWER VAC

### NOTE

**It is recommended that appliances should be supplied via a residual current device (RCD) with a tripping current of not more than 30mA.**

### Before Using

- Study this manual thoroughly.
- Familiarize yourself with the operation of the blower vac and learn to use it properly.
- Never allow others (especially children) who have not read the manual to use the machine.
- If the unit must be given to other people, give them as this manual.
- Never remove the labels or security elements.
- Check that the voltage and frequency indicated on the specification label affixed to the electrical blower vac correspond to the mains electricity supply.
- To connect the blower vac to the power, use only appropriate and compliant power equipment in perfect condition.
- Keep the cord away from the radius of action of the machine and make sure it is not subjected to tension. Move the cable from water, heat and sharp edges.
- Never use the cord for carrying, pulling or unplugging the power tools.
- Do not use the blower vac if the trigger on / off does not work properly. If necessary, contact your stores for any repair.
- Never expose the electric blower vac to rain or moisture. Never allow water or other liquids enter the machine.
- Do not operate blower vac in an environment with flammable items such as liquids, gases or dust. The sparks generated by the operation of the machine can cause an explosion.

### When Using

- Use the blower vac only in daylight or good artificial light.
- The use of power equipment can be regulated. Remember to comply with legal regulations which may differ from one location to another.
- Do not use the machine if you are tired or ill. Also avoid use if you have consumed alcohol or taken drugs. A moment of inattention can result in serious injury.
- When using, keep the hair away from the machine. Never wear loose clothing or accessories such as tie, cord, scarf or jewelry that could get caught in the machine.
- Wear close-fitting clothing, convenient and protect you from cuts. Always wear long pants, sturdy and non-slip shoes, and protective equipment such as gloves, goggles, a helmet with

## SPECIAL SAFETY INSTRUCTIONS FOR BLOWER VAC

a visor and acoustic shield, etc.

- Never blow dust, ash or harmful substances.
- Do not vacuum wet materials, water or other liquids.
- Never vacuum solids, such as chips, branches on ground which may damage the mulching system.
- Never vacuum hot material, incandescent, inflammable substances or explosives.
- Make sure the blower vac is switched off before plugging it to the power supply to avoid sudden and unexpected machine starting.
- Do not allow anyone to remain in the range of the electric grass size during use. Keep people, children and animals away from work area. If it is a group work, keep sufficient distance between people.
- Always work in a stable balanced and firm position. Do not work on slippery or unstable ground.
- Never operate a damaged machine repaired poorly, poorly fitted or changed arbitrarily.
- Do not overload the machine. Always use the proper equipment for the job.

### **After Using**

- Always unplug the unit before making any checking or maintenance.
- Always follow the instructions provided for maintenance. Replace worn or damaged parts.
- Electric blower vac shall be repair by qualified personnel. For safety reasons, use only original spare parts.
- Keep the electric blower vac clean and keep it always disconnected in a dry place, away from direct sunlight and out of reach of children.
- Keep this manual carefully and consult it whenever you use the machine.

## SYMBOLS

**IMPORTANT:** Some of the following symbols may be used on your tool. Be sure to study them and learn their meaning. Proper interpretation of these symbols will allow you to use the machine more effectively and reduce the risk of accident.



Indicates danger, warning, or caution.



**WARNING** – To reduce the risk of injury, user must read instruction manual.



Protect the machine from the damp and never expose it to rain.



Always wear safety goggles, masks, ear muffs and protective gloves.

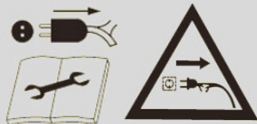

**SWITCH OFF:** Remove plug from mains before cleaning or maintenance  
Switch off! Remove plug from the mains immediately if the cable is damaged or cut.



Keep bystanders away



Keep hands out of the openings while the tools is running



Keep a safety distance of at least 5m from bystanders

## SYMBOLS



Conforms to relevant safety standards.



This class II symbol indicates that the product is correctly insulated. Grounding this machine is therefore unnecessary.



WEEE symbol. Tools that are no longer usable should not be disposed of with household waste but in an environmentally friendly way. Please recycle where facilities exist. Check with your local council authority for recycling advice.



Guaranteed sound power level (tested according to Directive 2000/14/EC as amended by 2005/88/EC)

## DIAGRAM

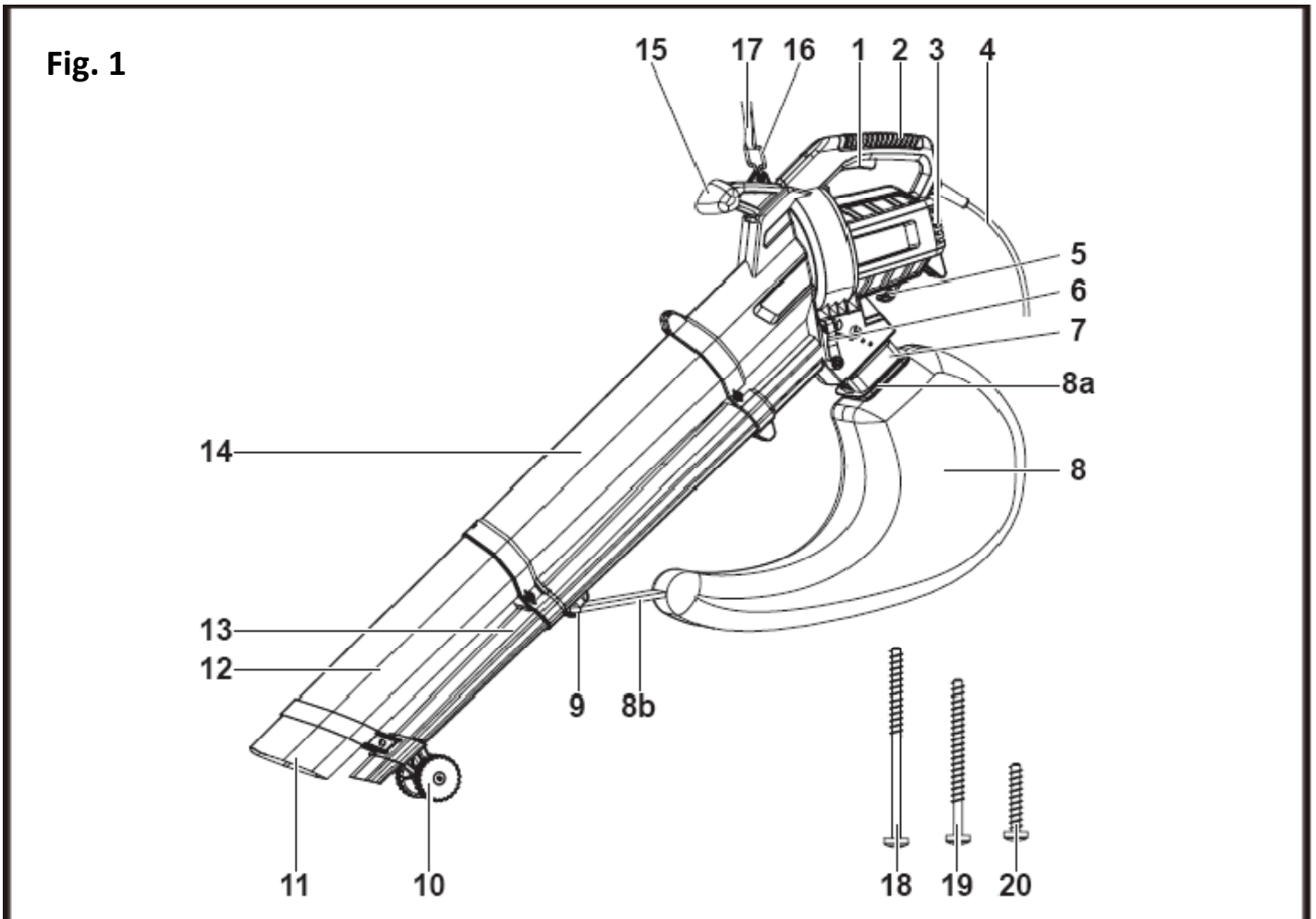

## PARTS LIST

**(See Fig. 1)**

- |    |                         |
|----|-------------------------|
| 1. | ON/OFF SWITCH           |
| 2. | MAIN HANDLE             |
| 3. | AIR VENTS               |
| 4. | POWER CORD WITH PLUG    |
| 5. | CORD RETAINER           |
| 6. | MODE LEVER FOR BLOW-VAC |
| 7. | OUTLET NOZZLE           |

## PARTS LIST

**(See Fig. 1 continued)**

- |                                     |
|-------------------------------------|
| 8. COLLECTION BAG                   |
| 8a. COLLECTOR                       |
| 8b. HANGING LOOP                    |
| 9. HOOK                             |
| 10. GUIDE WHEELS                    |
| 11. NOZZLE                          |
| 12. LOWER TUBE (LARGE)              |
| 13. LOWER TUBE (SMALL)              |
| 14. UPPER TUBE ASSEMBLY             |
| 15. FRONT HANDLE                    |
| 16. CLIP                            |
| 17. HARNESS                         |
| 18. CROSSHEAD SCREW (4X55MM) (x1PC) |
| 19. CROSSHEAD SCREW (4X45MM) (x1PC) |
| 20. CROSSHEAD SCREW (4X20MM) (x1PC) |

Remark: Above are all assembled in the standard delivery.

## INTENDED USE

This product is not intended for use by persons (including children) with reduced physical, sensory or mental capabilities, or lack of experience and knowledge, unless they have been given supervision or instruction concerning use of the product by a person responsible for their safety.

Children should be supervised to ensure that they do not play with the product.

This device is intended solely for blow or to collect the leaves in private gardens. Any other use not expressly permitted in these instructions may result in damage and may pose a serious hazard to the user and is not permitted.

In particular, the unit must never be used:

- On steep land;
- On a rainy day or in a humid environment;
- From intensively;
- For children under 16;
- For unaccompanied minors.

## ASSEMBLY



**WARNING!** The product must be fully assembled before operation! Do not use a product that is only partly assembled or assembled with damaged parts

Follow the assembly instructions step-by-step and use the pictures provided as a visual guide to easily assemble the product

Do not connect the product to power supply before it is completely assembled



**NOTE:** Take care of small parts that are removed during assembly or when making adjustments. Keep them secure to avoid loss.



**NOTE:** Pay attention to the alignment of the tubes. In particular observe the orientation of the fixation threads on the tubes.

## Unpacking

1. Unpack all parts and lay them on a flat, stable surface.
2. Remove all packing materials and shipping devices if applicable.
3. Make sure the delivery contents are complete and free of any damage. If you find that parts are missing or show damage do not use the product but contact your store. Using an incomplete or damaged product represents a hazard to people and property.
4. Ensure that you have all the accessories and tools needed for assembly and operation. This also includes suitable personal protective equipment.

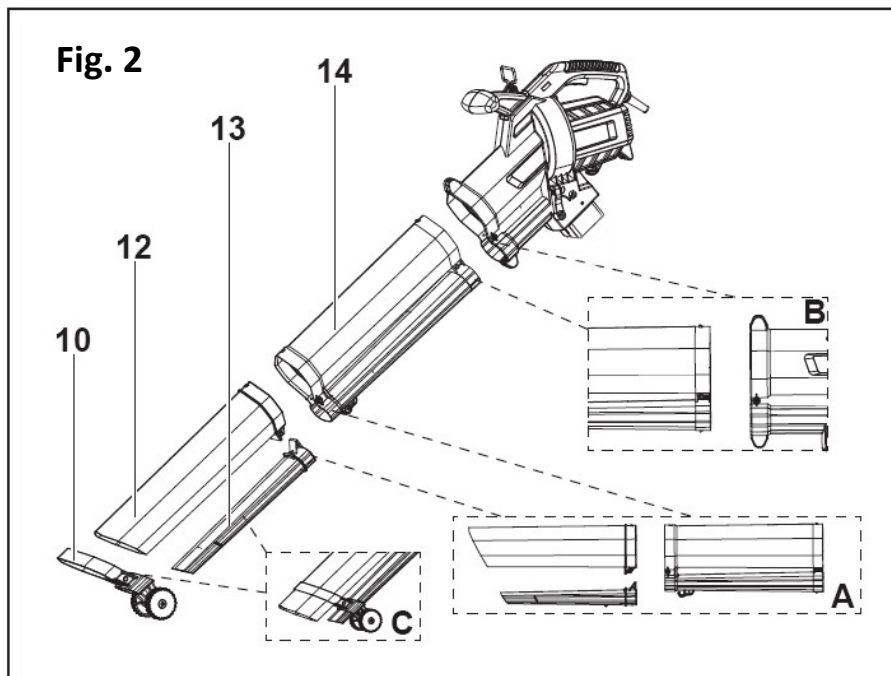

## ASSEMBLY

### (See Fig. 2)

1. Align the large (12) and small lower tube (13) to the upper tube assembly (14). First insert the small lower tube (13) all the way to the stop. Then repeat the step with the large lower tube (12). Secure the connection with the middle crosshead screw (19) in the middle of both tubes. (Fig. 2, detail A)
2. Align the assembled tubes to the motor unit and insert them all the way to the stop. Secure the tubes with the long crosshead screw (18) in the middle of both tubes. (Fig. 2, detail B)



**WARNING! Once the tube has been completely assembled it may not be disassembled or removed from the motor unit! Contact a qualified specialist in case the tube must be disassembled, e.g. for removing blockages or replacing damaged tube parts!**

3. Attach the guide roller (10) to the tubes. Fix the guide roller (10) with the short crosshead screw (20). (Fig. 2, detail C)

**NOTE: Ensure that all screws are securely tightened with a suitable crosshead screwdriver.**

4. Align the connector (8a) on the collection bag (8) with the outlet nozzle (7) and insert it in place. Attach the hanging loop (8b) to the hook (9). (Fig. 3)

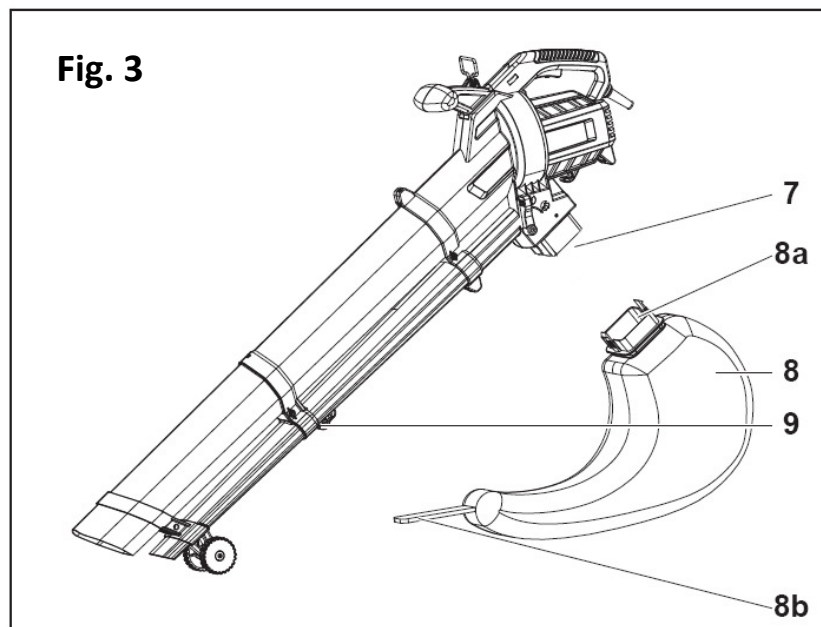

**WARNING! Always use the product with its collection bag attached when operating it to protect yourself against dashed debris and to avoid injuries! Do not use this product with a damaged collection bag or without one at all!**

## ASSEMBLY

### Connection to the Power Supply



**WARNING!** For your safety, it is required that the plug attached to this product is always connected to the cord retainer.

**Always use a residual current supply (RCD) protected supply!**

1. Double the cord back, about a foot from the end and lead the loop through the hole on the motor unit. Pull it over the cord retainer (5) and gently tug on the cord to ensure that it is firmly secured (Figs. 4).

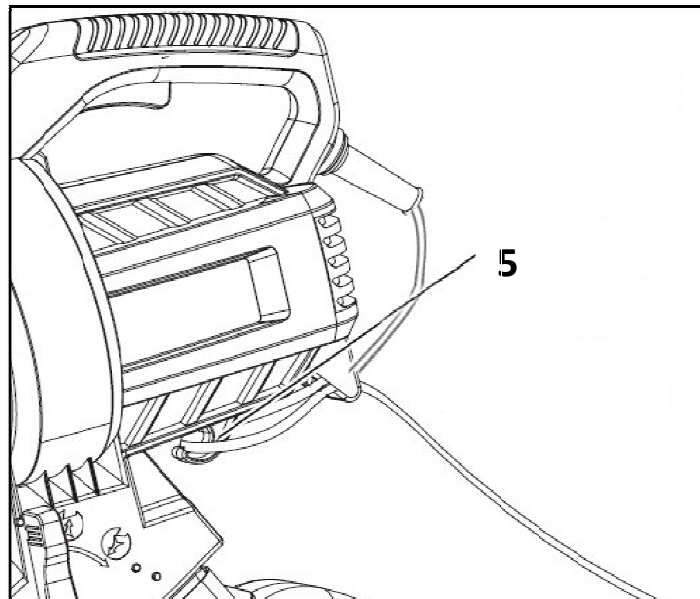

**Fig. 4**

2. Ensure the on/off switch (5) is in its off position.

3. Connect the plug of 10M cable.



**WARNING! Check the voltage! The voltage must comply with the information on the rating label!**

4. Your product is now ready to be used.

## OPERATION

1. Check the product, its power cord and plug as well as accessories for damage before each use. Do not use the product if it is damaged or shows wear.
2. Double check that accessories or application tools are properly fixed.
3. Always hold the product on its handle(s)/gripping surface(s).  
Keep the handle(s)/gripping surface(s) dry and clean to ensure safe support.
4. Ensure that the air vents are always unobstructed and clear.  
Clean them if necessary with a soft brush. Blocked air vents may lead to overheating and damage the product.
5. Switch the product off immediately if you are disturbed while working by other people entering the working area. Always let the product come to complete stop before putting it down.
6. Do not overwork yourself. Take regular breaks to ensure you can concentrate on the work and have full control over the product.
7. Before switching the product on, check whether it has been assembled correctly and all the moving parts are running smoothly!
8. While working, ensure that the product does not strike hard objects, as this can cause damage.
9. Do not blow any solid bodies such as stones, branches or pieces of branch, fir cones or similar.
10. We recommend slightly dampening surfaces in dusty conditions or using a mister attachment.

## Harness

The harness (17) helps the operator carry the product.

1. Place the harness (17) so that it runs over the left shoulder, crossing the breast and the back (Fig. 5).
2. Attach the harness (17) to the clip (16) on the upper side of the motor unit (Fig. 6).

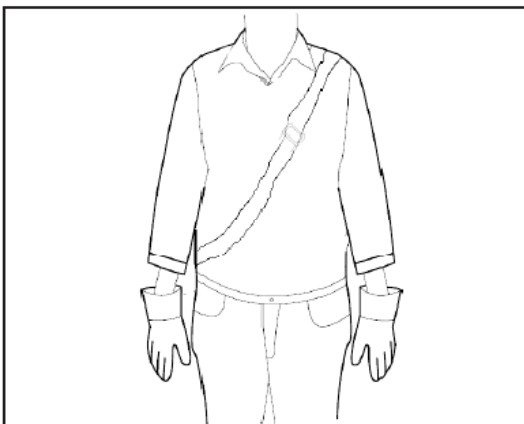

Fig. 5

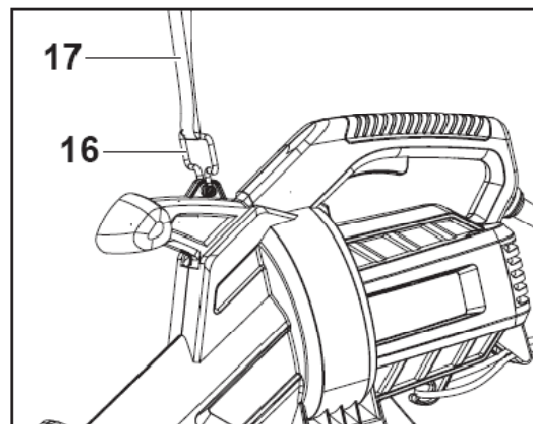

Fig. 6

## OPERATION

### Harness (continued)



**WARNING! Always use the product with the harness! Do not carry it only with your hands!**

3. Open the buckle to quickly release the harness (17).

### Operating Mode



**WARNING! Always turn the product off and let it come to a complete stop before changing the operating mode!**

1. Select the operating mode by moving the mode lever (6) to the respective symbol.
2. Move the lever (6) to the proper position to use the product as a vacuum (Fig. 7).
3. Move the lever (6) to the proper position to use the product as a blower (Fig. 8).
4. Always ensure that the lever is adjusted in either end positions. Do not use it in any other position!

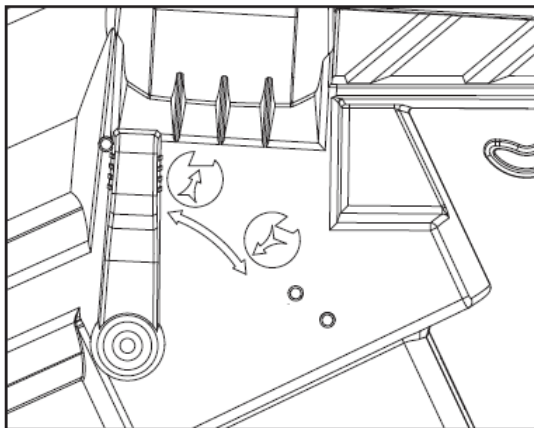

Fig. 7

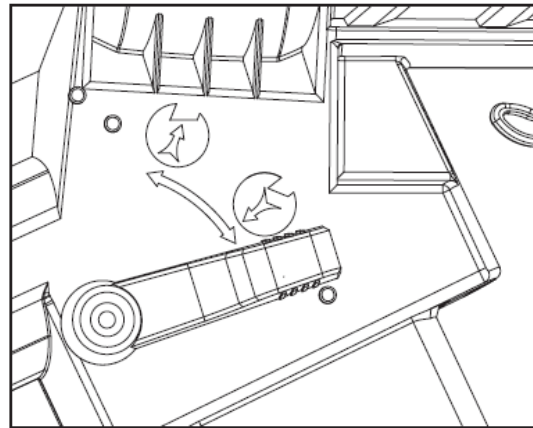

Fig. 8

### On/off Switch

1. Press the on/off switch (1) to turn the product on.
2. Release the on/off switch (1) to turn the product off.



**WARNING! The product will continue to work for some time even after the motor has been switched off! Wait until it comes to a complete stop before putting the product down!**

## OPERATION

### Blowing

1. Before blowing, loosen leaves that are stuck to the ground using a broom or rake.
2. Hold the tube approximately 10 cm above the ground and walk slowly forward using a sweeping motion from side to side (Fig. 9).

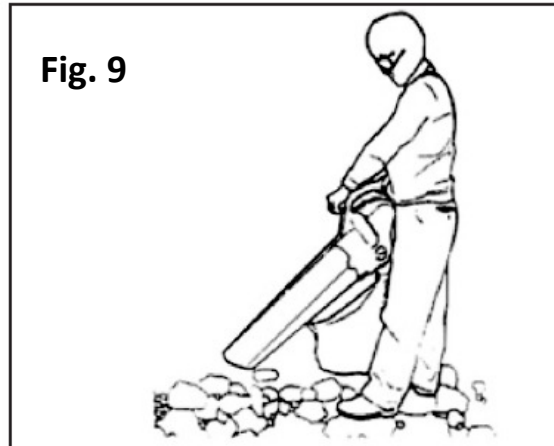

3. Direct the air stream away from yourself.
4. Ensure that you do not stir up any heavy objects and hurt somebody or damage something.

### Vacuum

1. Push the product in front of you. The guide rollers (10) make it easy to guide the tube along the ground.
2. The leaves will be sucked up into the tube and thrown into the collection bag (8).
3. Make sure the volume of leaves sucked in at one time is not too large. This will avoid clogging the tube and blocking the impeller wheel.

**NOTE: Switch the product off and disconnect it from the power supply if it stops suddenly during operation and does not produce any suction. Refer to the instructions below about removing blockages and the “Troubleshooting” section.**

### Collection Bag

1. Always operate the product with the collection bag (8) attached.
2. Inspect the collection bag (8) each time before use. Do not use it if you detect any damage.
3. Empty frequently during use. Do not wait until the collection bag (8) is completely full. We recommend emptying it when it is half full.

## OPERATION

### Collection bag (continued)

**NOTE: A full collection bag reduces the performance of this product.**

4. Switch the product off and disconnect it from the power supply.
5. Open the collection bag (8) by its zipper and empty the clippings onto a compost heap.
6. Close the zipper before continuing operation.

## CLEANING AND MAINTENANCE



**WARNING!** Always switch the product off, disconnect it from the power supply and let the product cool down before performing inspection, maintenance and cleaning work!

Keep the product clean. Remove debris from it after each use and before storage. Regular and proper cleaning will help ensure safe use and prolong the life of the product. Inspect the product before each use for worn and damaged parts. Do not operate it if you find broken and worn parts.

### General cleaning

1. Make sure the product is switched off, cooled down and disconnected from the power supply.
2. Clean the product with a slightly damp cloth and mild soap. Use a brush for areas that are hard to reach.
3. In particular clean the air vents (3) after every use with a cloth and brush.
4. Remove stubborn dirt with high pressure air (max. 3 bar).



**NOTE:** Do not use chemical, alkaline, abrasive or other aggressive detergents or disinfectants to clean this product as they might be harmful to its surfaces.

5. Check for any damage and wear. Repair damages in accordance with this instruction manual or take it to an authorized service centre before using the product again.

### Collection bag

1. Place the product on an even surface and remove the collection bag (8) in reverse order of assembly.
2. Clean the collection bag (8) after operation by turning it inside out and brushing it.
3. Replace the collection bag with one of the same type if it is damaged.
4. Refit as described.

### Removing blockages



**WARNING!** Wear safety gloves when removing blockages!  
Use proper tools to remove debris, e. g. a wooden stick!  
Never use your bare hands!

1. Place the product on an even surface and remove the collection bag (8) in reverse order of assembly.
2. Check the upper tube assembly (14) and lower tubes (12, 13) for blockages. Carefully tap the tubes (12, 13, 14) to loosen the blockage.

## CLEANING AND MAINTENANCE

### Removing blockages (continued)

3. Check the openings on the motor unit for blockages. Remove them with a suitable damp tool or wooden stick if required.

### Power cord

If the power cord is damaged, it must be replaced by the manufacturer, its service agent or similarly qualified persons in order to avoid a safety hazard.

### UK plug

If you need to replace the fitted plug, then follow the instructions below.

**IMPORTANT:** The wires in the mains lead are coloured in accordance with the following code:  
Blue – Neutral Brown – Live

As the colours of the wire in the mains lead of this product may not correspond with the coloured marking identifying the terminals in your plug, proceed as follows. The wire, which is coloured blue, must be connected to the terminal, which is marked with N or coloured black. The wire, which is coloured brown, must be connected to the terminal, which is marked L or coloured red.

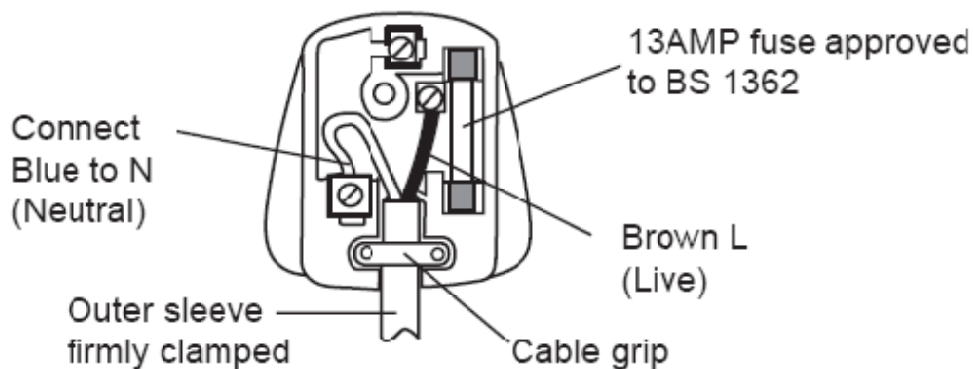

**WARNING! Never connect live or neutral wires to the earth terminal of the plug. Only fit an approved 13 Amp BS 1363 or BS 1363/A plug and the correctly rated fuse. If in doubt, consult a qualified electrician.**

### Repair

This product does not contain any parts that can be repaired by the consumer. Contact a qualified specialist to have it checked and repaired.

## CLEANING AND MAINTENANCE

### Storage

1. Clean the product as described above.
2. Store the product and its accessories in a dry, frost-free place.
3. Always store the product in a place that is inaccessible to children. The ideal storage temperature is between 10 and 30 C.
4. We recommend using the original package for storage or covering the product with a suitable cloth or enclosure to protect it against dust.

### Transportation

1. Switch the product off and disconnect it from power supply before transporting it anywhere.
2. Attach transportation guards, if applicable.
3. Always carry the product on its handles.
4. Protect the product from any heavy impact or strong vibrations which may occur during transportation in vehicles.
5. Secure the product to prevent it from slipping or falling over.

## TECHNICAL DATA

Voltage	220-240V~ 50Hz
Power input power	2600W
Rated no-load speed	15000min <sup>-1</sup>
Max. air volume	12m <sup>3</sup> /min
Max. air speed	160-270km/h
Collection bag	40L
Front handle vibration (under blower)	3.501m/s <sup>2</sup> K=1.5m/s <sup>2</sup>
Main handle vibration (under blower)	3.734m/s <sup>2</sup> K=1.5m/s <sup>2</sup>
Front handle vibration (under vacuum)	2.229m/s <sup>2</sup> K=1.5m/s <sup>2</sup>
Main handle vibration (under vacuum)	2.219m/s <sup>2</sup> K=1.5m/s <sup>2</sup>
Sound pressure level L <sub>PA</sub>	88dB(A) K=3dB(A)
Sound power level L <sub>WA</sub> (blower)	99.31dB(A) K=0.93dB(A)
Sound power level L <sub>WA</sub> (vacuum)	98.48dB(A) K=1.66dB(A)
Guaranteed sound power level L <sub>WA</sub>	100dB(A)
Protection class	II 
Degree of protection	IPX0
Machine weight	4.1kg

## **GURANTEE**

1. This product has been manufactured to a high quality standard. It is guaranteed against faulty materials and workmanship for warranted years from purchase, please retain your till receipt as proof of purchase.
2. If the product is found to be defective within the relevant time period, we will either replace all defective parts or, at our discretion, replace the unit free of charge with the same item or items of a greater value and/or specification.
3. This guarantee does not cover defects caused by or resulting from:
  - Misuse, abuse or neglect,
  - Trade, professional or hire use,
  - Repairs attempted by anyone other than our authorized repair centre (call 0345 077 8888);
4. In the unlikely event that this product does develop a fault please call the helpline on 0345 077 8888.
5. This guarantee does not affect your statutory rights.

## TROUBLESHOOTING

Suspected malfunctions are often due to causes that the users can fix themselves. Therefore check the product using this section. In most cases the problem can be solved quickly. **WARNING!** Only perform the steps described within these instructions! All further inspection, maintenance and repair work must be performed by an authorized service centre or a similarly qualified specialist if you cannot solve the problem yourself!

Problem	Possible Cause	Solution
1. Product does not start	1.1 Not connected to power supply	1.1 Connect to power supply
	1.2 Power cord or plug is defective	1.2 Check by a specialist electrician
	1.3 Other electrical defect to the product	1.3 Check by a specialist electrician
2. Product does not reach full power	2.1 Power source (e.g. generator) has too low voltage	2.1 Connect to another power source
	2.2 Air vents are blocked	2.2 Clean the air vents
	2.3 Collection bag full	2.3 Empty collection bag
	2.4 Mode lever in incorrect position	2.4 Select different mode

## RECYCLING AND DISPOSAL



The product comes in a package that protects it against damage during shipping. Keep the package until you are sure that all parts have been delivered and the product is function properly. Recycle the package afterwards.

Old products are potentially recyclable under WEEE and do not, therefore, belong in your household rubbish. You are requested to assist us and our contribution to saving resources and protecting the environment by handing in this appliance at an equipped collection centre (if there is one available).



