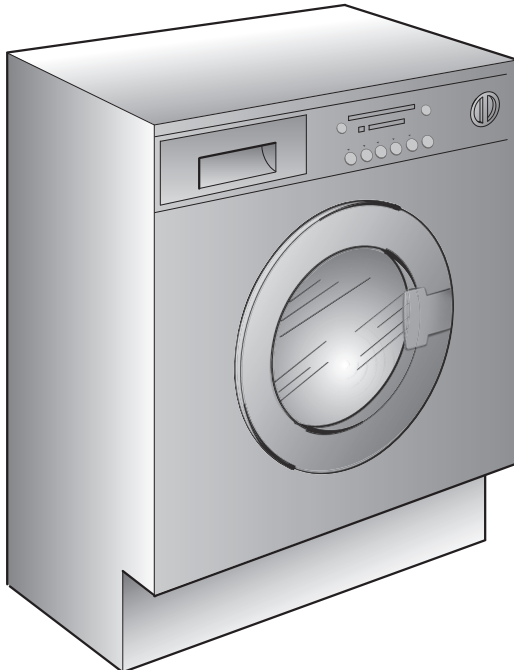

Baumatic

Washer Dryer

Instructions for use

BWDI126N

6⁺⁴ kg
4+4 auto



Introduction

Please read these instructions for use carefully and all other information enclosed with the washing machine.

Keep all documentation in a safe place for future reference or for any future owners.



This appliances is intended to be used in household and similar applications such as:

- staff kitchen areas in shops, offices and other working environments;
- farm houses;
- by clients in hotels, motels and other residential type environments;
- bed and breakfast type environments.

A different use of this appliance from household environment or from typical housekeeping functions, as commercial use by expert or trained users, is excluded even in the above applications.

If the appliance is used in a manner inconsistent with this it may reduce the life of the appliance and may void the manufacturer's warranty.

Any damage to the appliance or other damage or loss arising through use that is not consistent with domestic or household use (even if located in a domestic or household environment) shall not be accepted by the manufacturer to the fullest extent permitted by law.

Notes on disposal

All packaging material used is environmentally-friendly and recyclable. Please help dispose of the packaging via environmentally-friendly means.

Your supplier or local council will be able to give you details of current means of disposal.

Valuable materials can be salvaged from an old appliance via scrap reprocessing.

Note: pull out the mains plug from any old appliance. Cut the power cable and dispose of it, together with the plug.

When disposing of an old washing machine, please ensure that the door lock is rendered inoperable to prevent children shutting themselves in the appliance.

Contents

Page

| | |
|---|----|
| Introduction | 2 |
| General delivery notes | 4 |
| Safety notes | 4 |
| Quick start | 5 |
| Description of controls | 6 |
| Programme Table | 14 |
| Programme selector | 16 |
| Detergent drawer | 19 |
| Detergents, washing aids and amounts to use | 20 |
| Useful advice for the user | 22 |
| The main wash | 23 |
| Drying | 25 |
| Automatic washing/drying cycle | 26 |
| Drying cycle | 27 |
| Cleaning and routine maintenance | 29 |
| Investigating malfunctions | 30 |
| Technical data | 32 |
| Setting up + installation | 33 |

BEFORE SWITCHING ON THE APPLIANCE MAKE SURE IT IS CORRECTLY INSTALLED AND THAT THE TRANSIT SCREWS ARE REMOVED AS SHOWN IN PAGE 33.

General delivery notes

Please check that the following items are delivered with the appliance:

- Instruction manual
- Certificate of guarantee
- Inlet hose
- Liquid detergent or liquid bleach compartment

Check that no damage has occurred during transit, and if so, call your nearest Authorised Technical Support Service agent.

Safety notes.

Note:

for cleaning or maintenance of the washing machine.

- A) Pull out the plug
- B) Turn off the tap
- C) **Baumatic** equips all its appliances with earthing. Ensure that the mains supply is earthed, and if it is not, seek assistance from a qualified person.
- D) Do not touch the appliance when hands or feet are wet or damp. Do not use the appliance with bare feet.
- E) The use of adapters, multiple connectors and/or extensions is not recommended.

Note:

water temperature can reach 90°C during the wash cycle.

- F) Check there is no water left in the drum before opening the door.
- G) This appliance is not intended for use by persons (including children) with reduced physical, sensory or mental capabilities, or lack of experience and knowledge, unless they have been given supervision or instruction concerning use of the appliance by a person responsible for their safety.
Children should be supervised to ensure that they do not play with the appliance.
- H) Do not pull the power cable or the appliance itself to remove the plug from the socket.
- I) The appliance must not be exposed to weather conditions (rain, direct sun, etc...)
- L) When moving the appliance never lift it by the controls or by the detergent drawer.
When in transit never rest the door against the trolley or transport the appliance without the polystyrene base.

M) N.B!

If the appliance is installed on a carpeted floor ensure that the ventilation holes on the base of the appliance are not obstructed.

N) If the appliance is not running properly or breaks down, switch it off, turn off the tap and do not tamper with the appliance.

Consult only the Authorised Technical Support Service for possible repair and ask them to use original spare parts.

Failure to comply with the above can compromise the safety of the appliance.

O) If the appliance's power cable should ever need replacing, consult the Authorised Technical Support Service

Quick start

Washing

- Open the door by using the handle "A" (Fig. 1, page 6)
- Select laundry and put it in the machine
- Close the door
- Put detergent in the compartments as indicated in the programme guide in this instruction manual
- Select programme
- Wait for the "STOP" indicator light to flash

DRYING

If you would like the drying cycle to begin automatically after washing, select the programme required using the Drying Selection button.

Otherwise it is possible to finish the wash and then decide on the drying programme and load.

Press additional function buttons (if required)

- Press the "Start/Pause" button.
- The programme starts.

After washing

- The indicator light "STOP" will go on.
- Wait for the door lock to be released (about 2 minutes after the programme has finished). The "Door Security" indicator light will go out.
- Switch off the washing machine by turning the selector to "OFF" position.
- Open the door and remove the laundry.

Ensure that the machine is correctly installed in line with the instructions found on page 33.

Description of controls

Fig. 1

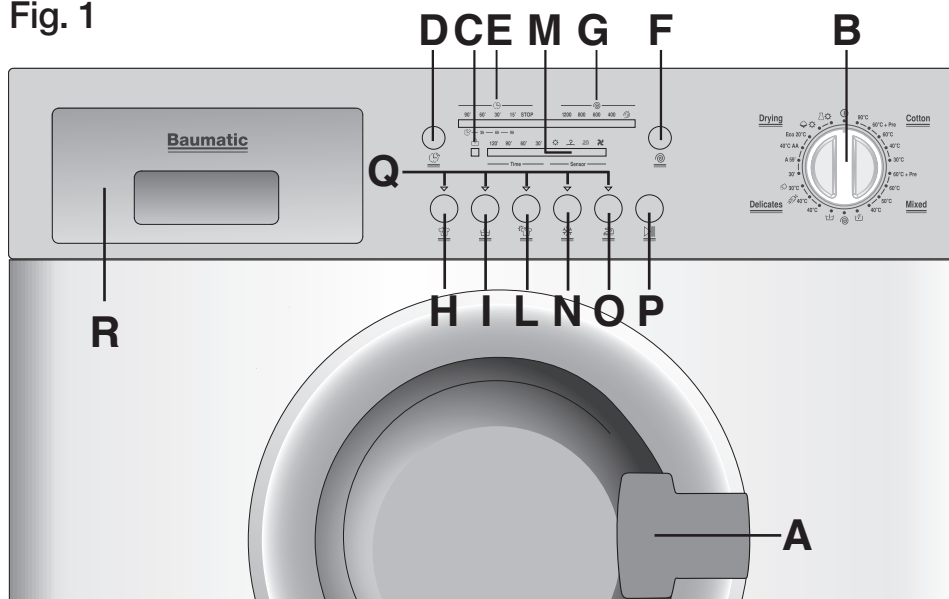

- | | |
|---|---|
| Door handle | A |
| Programme selector with "OFF" position | B |
| "Door Security" indicator light | C |
| "Delay Start" button | D |
| "Time To End" and "Delay Start" indicator light | E |
| "Spin Selection" button | F |
| Spin speed indicator light | G |
| "Stain Vanish" button | H |
| "Sensitive Care" button | I |
| "Drying Selection" button | L |
| Drying programme indicators | M |
| "Cold Wash" button | N |
| "Easy Iron" button | O |
| "Start/Pause" button | P |
| Buttons indicator light | Q |
| Detergent drawer | R |

Door handle

A

To open the door turn the handle in the manner illustrated in fig.

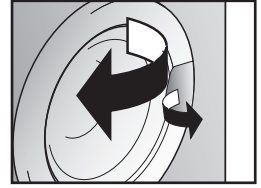

PROGRAMME selector with "OFF" position

B

Rotates in both directions.
The machine is turned on by selecting a programme via the programme selector. This status will be indicated by the "STOP" indicator light flashing, this light will continue to flash until the machine has started or the machine is returned to the "OFF" position.

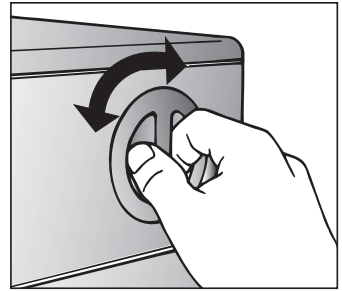

Press the "**Start/Pause**" button to start the selected cycle.

Once a programme is selected the programme selector remains stationary on the selected programme till cycle ends.

Switch off the washing machine by turning the selector to "OFF".

Note:

The programme selector must be return to the "OFF" position at the end of each cycle or when starting a subsequent wash cycle prior to the next programme being selected and started.

DOOR SECURITY indicator light

**C**

The "**Door Security**" indicator light is illuminated when the door is fully closed and the machine is ON. When "**Start/Pause**" is pressed on the machine with the door closed the indicator will flash momentarily and then illuminate.

If the door is not closed the indicator will continue to flash.

A special safety device prevents the door from being opened immediately after the end of the cycle. Wait for 2 minutes after the wash cycle has finished and the "**Door Security**" light has gone out before opening the door. At the end of cycle turn the programme selector to "OFF".

“DELAY START button”

D

Appliance start time can be set with this button, delaying the start by 3, 6 or 9 hours.

Proceed as follows to set a delayed start:

Select a programme (“**STOP**” indicator light blinks)

Press "**Delay Start**" button (each time the button is pressed the start will be delayed by 3, 6 or 9 hours respectively and the corresponding light will blink).

Press "**Start/Pause**" to commence the Delay Start operation (the indicator light associated with the selected Delay Start time stops blinking and remains ON).

At the end of the required time delay the programme will start.

To cancel the Delay Start function :

press the "**Delay Start**" button until the indicator lights will be off (The "**STOP**" light blinks) and the programme can be started manually using the "**Start/Pause**" button or switch off the appliance by turning the programme selector to "**OFF**" position.

Warning: If there is any break in the power supply while the machine is operating, a special memory stores the selected programme and, when the power is restored, it continues where it left off.

TIME TO END indicator light

E

In order to manage your time better, this washing machine features an indicator light system that keeps you constantly informed on the remaining cycle time.

Indicator light 90:

Remaining time above 60 minutes.

Indicator light 60:

Remaining time less than 60 minutes.

Indicator light 30:

Remaining time less than 30 minutes.

Indicator light 15:

Remaining time less than 15 minutes.

Indicator light STOP:

End of the programme.

“SPIN SELECTION” button

F

The spin cycle is very important to remove as much water as possible from the laundry without damaging the fabrics. You can adjust the spin speed of the machine to suit your needs.

By pressing this button, it is possible to reduce the maximum speed, and if you wish, the spin cycle can be cancelled. To reactivate the spin cycle press the button until you reach the spin speed you would like to set. To prevent damage to the fabrics, it is not possible to increase the speed over that which is automatically suitable during the selection of the program.

It is possible to modify the spin speed without to pausing the machine.

Note:

The machine is fitted with a special electronic device, which prevents the spin cycle should the load be unbalanced. This reduces the noise and vibration in the machine and so prolongs the life of your machine.

Spin speed indicator light

G

When you set a program, the maximum possible spin speed will be automatically shown by the relevant indicator light.

Choosing a smaller spin speed by the appropriate button, the relevant indicator light will go on.

The option buttons should be selected before pressing the "Start/Pause" button.

“STAIN VANISH” Button

H

By pressing this button, which can only be activated in the **Cotton** cycles, the sensors in the new system come into operation. They affect both the selected temperature, keeping it at a constant level throughout the wash cycle, and the mechanical function of the drum.

The drum is made to turn at two different speeds at crucial moments. When the detergent enters the garments, the drum rotates in such a way that the detergent is distributed in a uniform manner; during the wash and rinse procedures, however, the speed increases in order to maximise the cleaning action. Thanks to this special system, the efficiency of the wash procedure is improved WITHOUT ANY INCREASE IN THE LENGTH OF THE PROGRAM.

“SENSITIVE CARE” button

I

By pressing this button you can activate a special new wash cycle in the **Cotton** and **Mixed Fabrics** programs, thanks to the new Sensor System. This option treats with care the fibres of garments and the delicate skin of those who wear them.

The load is washed in a much larger quantity of water and this, together with the new combined action of the drum rotation cycles, where water is filled and emptied, will give you garments which have been cleaned and rinsed to perfection. The amount of water in the wash is increased so that the detergent dissolves perfectly, ensuring an efficient cleaning action. The amount of water is also increased during the rinse procedure so as to remove all traces of detergent from the fibres. This function has been specifically designed for people with delicate and sensitive skin, for whom even a very small amount of detergent can cause irritation or allergy.

You are advised to also use this function for children’s clothing and for delicate fabrics in general, or when washing garments made of towelling, where the fibres tend to absorb a greater quantity of detergent. To ensure the best performance for your wash, this function is always activated on the Delicates and Woollens/Hand Wash programs.

“DRYING SELECTION” button

L

With the programme selector not in the OFF position, press the button to select the required drying programme; an indicator will light to display the drying result selected each time you press the button.

To cancel the selection before the start of a drying programme, press the button repeatedly until the indicators go out or return the programme selector to the OFF position.

To cancel the cycle during the drying phase, hold the button down for 2 seconds until the cooling indicator lights up; given the high temperature inside the drum, we recommend that you allow the dryer to complete the cool down period before returning the programme selector to the OFF position and removing the laundry.

Drying programme indicators

M

The indicators display the type of programme and/or drying time:

Automatic Programmes: By selecting one of these 3 automatic programmes, the washer-dryer will calculate the time needed for drying and the residual dampness required, according to the load and drying type selected.

After pressing the START button, one of the indicators will light to display the drying time remaining.



= Extra dry drying programme (recommended for towels, bathrobes and bulky loads)



= Cupboard dry drying programme



= Iron dry drying programme

USEFUL TIPS:

The 30 minute drying programme is recommended for small loads (less than 1 kg) or slightly damp loads.

Your washer-dryer ends the cycle automatically when it reaches the drying level selected.

For the correct operation of the appliance, it is preferable not to interrupt the drying phase unless it is really necessary.

Timed programmes:

120 minutes – 90 minutes – 60 minutes – 30 minutes:

Dual function indicators:

If one of the 3 automatic drying programmes is selected, the indicators display the drying time remaining

They may be used to select timed drying programmes.

Cool down phase

Switched on during the final cool down period, in the last 10 minutes of each drying phase.

“COLD WASH” button

N

By pressing this button it is possible to transform every programme into a cold washing one, without modifying other characteristics (water level, times, rythmes, etc...).

Curtains, small carpets, man made delicate fabrics, non color fast garments can be safely washed thanks to this new device.

“EASY IRON” button

O

The Easy Iron function (Not available on COTTON programmes) minimizes creases as much as possible with a uniquely designed anti-crease system that is tailored to specific fabrics.

MIXED FABRICS - the water is gradually cooled throughout the final two rinses with no spinning and then a delicate spin assures the maximum relaxation of the fabrics.

DELICATE FABRICS – after the final two rinses with no spinning the machine stops in the final rinse stage and the **option indicators blink**. The load is held in the water in the drum, thus reducing creasing and enabling easier ironing.

WOLLENS/SILK – after the final rinse the load is held in the water in the drum, thus reducing creasing and enabling easier ironing and the **option indicators blink**.

To complete the cycle press the Easy Iron button and the machine will pump out the water and complete the cycle.

If you do not want to spin the clothes and activate drain only:

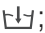
- Turn the programme selector to the "OFF" position;
- Select programme drain only ;
- Switch on the appliance again by pressing the "Start/Pause" button.

START/PAUSE button

P

When a programme is selecting, wait for the "STOP" indicator light to flash before pressing the "Start/Pause" button.

Press to start the selected cycle (according to the selected cycle one indicator lights will go on).

NOTE: When the "Start/Pause" button has been pressed, the appliance can take few seconds before it starts working.

Changing the settings after the programmes has started (PAUSE)

The programme may be paused at any time during the wash cycle by holding down the "Start/Pause" button for about two seconds. When the machine is in the paused mode, the indicator light "Time To End", spin speed and option buttons will flash.

To restart the programme, press the "Start/Pause" button once again.

If you wish to add or remove items during washing, wait 2 minutes until the safety device unlocks the door.

When you have carried out the manoeuvre, close the door, press "Start/Pause" button and the appliance will continue working where it left off.

CANCELLING THE PROGRAMME

To cancel the programme, set the selector to the OFF position.

Select a different programme.

Re-set the programme selector to the OFF position.









Buttons indicator light

Q

These light up when the relevant buttons are pressed.

If an option is selected that is not compatible with the selected programme then the light on the button first flashes and then goes off.

TABLE OF PROGRAMMES

| PROGRAM FOR: | PROGRAMME SELECTOR ON: | WEIGHT MAX kg | TEMP. °C | CHARGE DETERGENT | | | |
|---|-------------------------------|--|----------|------------------|---|---|---|
| | | | | 2 |  | 1 | |
| Resistant fabrics Cotton, linen | * Whites | 90°C | 6 | 90° | ● | ● | |
| Cotton, mixed resistant | * Whites with Prewash | 60°C + Pre | 6 | 60° | ● | ● | ● |
| Cotton, mixed | * Fast coloureds | 60°C ** | 6 | 60° | ● | ● | |
| | * Non fast coloureds | 40°C | 6 | 40° | ● | ● | |
| | * Delicates | 30°C | 6 | 30° | ● | ● | |
| Mixed fabrics and synthetics Mixed, resistant | * Fast coloureds with Prewash | 60°C + Pre | 3 | 60° | ● | ● | ● |
| Cotton, mixed fabrics, synthetics | * Fast coloureds | 60°C | 3 | 60° | ● | ● | |
| Synthetics (nylon, perlon), mixed cotton | * Synthetics | 50°C | 3 | 50° | ● | ● | |
| | * Non fast coloureds | 40°C | 3 | 40° | ● | ● | |
| | * Rinse |  | - | - | △ | ● | |
| | * Fast spin |  | - | - | | | |
| | Drain only |  | - | - | | | |
| Very delicate fabrics | Delicates | 40°C | 2 | 40° | ● | ● | |
| | "MACHINE WASHABLE" woollens |  40°C | 1,5 | 40° | ● | ● | |
| | Hand wash |  30°C | 1 | 30° | ● | ● | |
| Specials | * Rapid 30 minutes | 30' | 2 | 30° | ● | ● | |
| | * Resistant Fabrics | A 59' | 3 | 60° | ● | ● | |
| | * Resistant Fabrics | 40°C AA | 6 | 40° | ● | ● | |
| | Resistant or Mixed fabrics | Eco 20°C | 6 | 20° | ● | ● | |
| | Cotton - Drying |  | 4 | - | | | |
| | Mixed - Drying |  | 3 | - | | | |

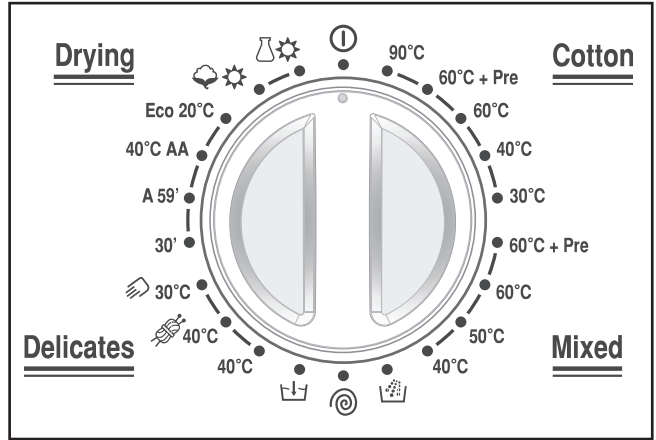
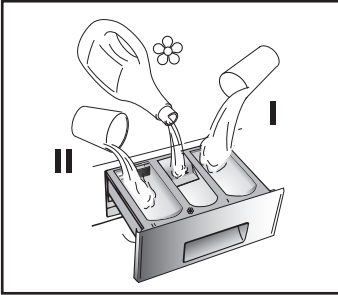

Please read these notes

When washing heavily soiled laundry it is recommended the load is reduced to 4 kg maximum.

**Information for the test laboratories
(Ref. EN 50229 Standards)**

Washing

Use the programme **

Drying

First drying with 4kg (the load consist: pillowcases and hand-towels) selecting the cotton drying programme (☀️⚙️) cupboard dry (📏).
 Second drying with 2kg (the load consist: 2 sheets and hand towels) selecting the cotton drying programme (☀️⚙️) cupboard dry (📏).

The spin speed may also be reduced, to match any guidelines suggested on the fabric label, or for very delicate fabrics cancel the spin completely this option is available with a spin speed button.

* Programmes for automatic drying.

- ⚠️ When only a limited number of articles have stains which require treatment with liquid bleaching agents, preliminary removal of stain can be carried out in the washing machine. Pour the bleach into the liquid bleach container, inserted into the compartment marked "2" in the detergent drawer, and set the special programme "RINSE" (🚰).

When this phase has terminated, switch off the appliance, add the rest of the fabrics and proceed with a normal wash on the most suitable programme.

Programme selector

For the various types of fabrics and various degrees of dirt the washing machine has different programme bands according to: wash cycle, temperature and length of cycle (see table of washing cycle programmes).

COTTONS

The Cotton programme is designed for maximum washing and rinsing efficiency. With spin cycles in between, the programme guarantees the laundry is rinsed perfectly. The final spin cycle ensures laundry is spun dry as much as possible up to the maximum speed.

The Cotton programme includes a Prewash cycle. This option is particularly useful for really dirty loads and can be used independently of the main wash programme. Additional detergent for the Prewash part of the programme should be added to the first compartment of the soap drawer labelled "I" (please refer to the section of this manual entitled "Detergent"). We recommend you use only 20% of the quantity used for the main wash programme.

Cotton

90°C
60°C + Pre
60°C
40°C
30°C

MIXED AND SYNTHETIC FABRICS

The main wash and the rinse gives best results thanks to the rotation rhythms of the drum and to the water levels.

A gentle spin will mean that the fabrics become less creased.

Mixed

60°C + Pre
60°C
40°C
30°C

SPECIAL "RINSE" PROGRAMME

This programme carries out three rinses with an intermediate spin (which can be reduced or excluded by using the correct button). It can be used for rinsing any type of fabric, eg. use after hand-washing.



This program can be also used as cycle of Bleaching (see table of washing cycle programmes).

SPECIAL "SPIN" PROGRAMME

Programme "SPIN" carries out a maximum spin (which can be reduced by using the correct button).



DRAIN ONLY

This programme drains out the water.



SPECIAL DELICATE FIBRES

This is a new wash cycle which alternates washing and soaking and is particularly recommended for very delicate fabrics.

The wash cycle and rinses are carried out with high water levels to ensure best results.

Delicates

40°C

WOOLMARK PROGRAMME

This special cycle enables to thoroughly wash garments without damaging them. The cycle comprises of alternate periods of activity and pauses.

The programme has a maximum temperature of 40°and concludes with 3 rinses and a short spin.



SPECIAL "HAND WASH"

This washing machine also has a gentle Hand Wash programme cycle.

This programme allows a complete washing cycle for garments specified as "Hand Wash only" on the fabric care label. The programme has a temperature of 30°C and concludes with 3 rinses and a slow spin.



30 MINUTE RAPID PROGRAMME

The 30 minute rapid programme allows a complete washing cycle to be carried out in approximately 30 minutes, with up to a maximum load of 2 kg and a temperature of 30°C.

When selecting the "30 minute rapid" programme, please note that we recommend you use only 20% of the recommended quantities shown on the detergent pack.

30'

"A" WASH 59'

This specially designed programme maintains the high quality wash performance identified with the "A" rating whilst greatly reducing the wash time. The programme is designed for a maximum load of 3 kg with a temperature of 60°C and concludes with 2 rinses and a high speed spin sequence.

A 59'

AA SPECIAL PROGRAMME AT 40°C

This special programme has been studied to allow you to obtain the best washing performance, even at full load, as the 60°C Cotton programme (the normative cycle), but with the advantage of an energy saving due to 40°C temperature, instead of 60°C.

The length of this programme lasts almost the 3 hours.

40°C AA

ECO 20°C

This innovative programme, allows you to wash different fabrics and colours together, such as cottons, synthetics and mixed fabrics at only 20°C and provides an excellent cleaning performance.

Consumption on this program is about 40% of a conventional 40°C cottons wash.

Eco 20°C

DRYING

Note: Dispensers used for concentrated powders and liquid detergents must be removed from the drum before commencing the tumble drying programmes.

Drying

The drum changes direction during the drying cycle to prevent the laundry from tangling and hence produce even drying. Cool air is used during the last ten minutes of the drying cycle to minimise creasing.

LOW HEAT

Low temperature drying programme for synthetics and mixed fibres, always refer to the care label.



HIGH HEAT

High temperature drying programme for Cottons and linen items, always refer to the care label



Auto half load

The washing machine is fitted with a self adjusting water level system.

This system enables the machine to use the amount of water needed to wash and rinse the laundry in relation to the particular load.

This results in a reduction of the water and electricity used, without in any way compromising the washing and rinsing performance.

In fact the amount of water and electricity used will always be appropriate for the clothes load. The washing machine automatically ensures excellent washing results at minimum cost whilst respecting the environment .

Detergent drawer

R

The detergent drawer is split into 3 compartments:

- the compartment labelled "I" is for prewash detergent;
- the compartment labelled "☼" is for special additives, fabric softeners, fragrances, starch, brighteners etc;
- the compartment labelled "II" is for main wash detergent.

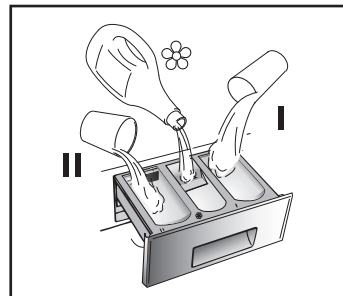

If liquid detergents are used, please insert the special container supplied into the compartment marked "II" in the detergent drawer. This ensures that the liquid detergent enters the drum at the right stage of the wash cycle.

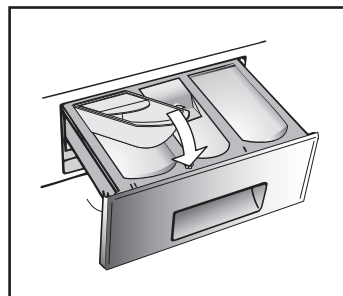

This special container must be inserted into the compartment marked "II" in the detergent drawer, also when you wish to use the "RINSE" programme as BLEACHING cycle.

NOTE:

Some Detergents are Difficult to utilise. Ensure to use an in drum dispenser if recommended by the detergent Manufacturer.

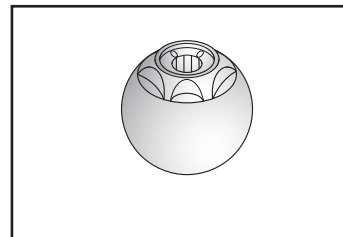

Note: only put liquid products in the compartment labelled "☼". The machine is programmed to automatically take up additives during the final rinse stage for all wash cycles.

Detergents, washing aids and amounts to use

Choice of detergent

General purpose detergents

- **Powder detergents**, for a thorough wash, with bleaching agent, particularly suitable for use in hot wash programmes (60°C and over), for heavily soiled and stained laundry.
- **Liquid detergents**, particularly suitable for grease stains, such as greasy skin marks, cosmetics and oil.
These detergents are not suitable for washing stained laundry, as they do not contain bleach.
- **Biological detergents**, not all the products available give a really thorough wash.

Additional laundry aids

- **Water softener**, means less detergent can be used where water hardness is classed as hard to very hard.
- **Prewash substances**, for the programmed treatment of stains prior to the main wash. Using them means the subsequent wash can be at a low temperature or with bleach-free detergents.
- **Fabric softener**, prevents static build-up in synthetic fabrics and softens fabrics. If you own a tumble dryer, clothes are softened even without the use of a fabric softener.

Do not put solvents in the washing machine!

Keep detergents and other laundry products out of children's reach.

Before pouring in the detergent check that there are no foreign bodies in the detergent drawer.

Dosage details are usually shown on the detergent packaging. Follow those instructions.

Dosages

Only use detergents which are suitable for use in a washing machine.

You will obtain the best results from your wash with the minimum use of chemical products and the best care for your laundry if you take into consideration the degree of soiling as well as the type of detergent to choose.

The amount of detergent to use depends on:

- water hardness: depending on the hardness of the water and the type of detergent used, it is possible to reduce the amount of detergent.
- the degree of soiling: it is possible to reduce the amount of detergent used depending on the degree of soiling.
- amount of laundry: it is possible to reduce the amount of detergent when washing only a small amount of laundry.

Dosage for powder detergent

For normal and low concentration detergents: for normally soiled laundry choose a programme without prewash.

Put the detergent in compartment “II” of the drawer.

For heavily soiled laundry, choose a programme with prewash.

Put 1/4 of the detergent in compartment “I”, 3/4 in compartment “II” of the drawer.

When using water softeners, first put in the detergent, then add the softener to compartment “II”.

For highly concentrated detergents not in single dose format, follow what is shown on pack exactly as regards type and amount of dosage.

To avoid the difficulty of checking if the detergent has been taken up, use the dosage aids provided in the detergent packaging.

Liquid detergent dosage

Liquid detergents may be used in accordance with the instructions on the relevant packaging, for all programmes without prewash, by using the special container which is placed in the drum or, for those models that have it, in the special insert for liquid detergents.

Recommendations on the use of detergent at various temperatures

When washing heavily soiled whites, we recommend using cotton programs of 60°C or above and a normal washing powder (heavy duty) that contains bleaching agents that at medium/high temperatures provide excellent results. For washes between 40°C and 60°C the type of detergent used needs to be appropriate for the type of fabric and level of soiling. Normal powders are suitable for “white” or colour fast fabrics with high soiling, while liquid detergents or “colour protecting” powders are suitable for coloured fabrics with light levels of soiling. For washing at temperatures below 40°C we recommend the use of liquid detergents or detergents specifically labeled as suitable for low temperature washing. For washing wool or silk, only use detergents specifically formulated for these fabrics. For dosage amounts please follow the instructions on the detergent package label.

Useful advice for users

Tips on using your domestic appliance in the most environmentally-friendly and economical way

Do a full load in your washing machine

To prevent any possible waste of energy, water or detergent we recommend that you put a full load in your washing machine, not exceed the recommended maximum load size. Up to 50% energy saving can be made with one full load compared to two half load washes

When is prewashing really needed?

Only with particularly dirty loads!

Energy savings of 5 to 15% are made by not selecting the prewash option for normal soiled laundry.

Which wash temperature should you choose?

Using stain removers before machine washing reduces the need to wash at temperatures over 60°C.

Energy savings of up to 50% can be made by using a 60°C wash temperature rather than 90°C

Before using a drying programme...

SAVE energy and time by selecting a high spin speed to reduce the water content in laundry before using a drying programme.

Main wash

Sorting the laundry

- It is recommended you wash only items which are machine washable with water and detergent and not dry-clean items.
- If you need to wash rugs, bedspreads or other heavy items, it is best not to spin them.
- Sort the laundry according to fabric type, degree of soiling and wash temperature: Always follow the wash care advice on the garment label for the most suitable care and treatment of the laundry

Laundry for hot wash 

Coloured, easy-care materials   

Delicates and wool  

Wash by hand 

Items labelled with the following symbol are not suitable for machine washing:

Dry clean 

For very delicate items, such as net curtains, underwear, tights etc., you are advised to use a laundry net or wash bag.

- Woollen items must be labelled with the "Pure New Wool" symbol to be washed in the machine, and must also be labelled "non-matting" or "machine washable".
- Colour often leaks from new coloured items.

This can then colour other lighter items being washed.

We therefore recommend that coloured items should be washed for the first time separately.

For future washes, colourfast items can only be washed with whites up to 40°C.

Note: when sorting laundry

- check there are no metal objects in the laundry (such as paper clips, safety pins, pins, coins etc...);
- button up pillowcases, fasten zips, hook & eye fasteners, belts and long dressing gown cords;
- remove curtain hooks;
- pay close attention to the labels on items
- if you notice stubborn stains whilst sorting the laundry, remove them using a special detergent or a special stain remover.

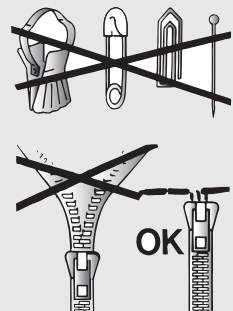

- We recommend that you do not do a full load of towelling items only as these become too heavy since they absorb a lot of water.

The correct way to wash

Preparing the laundry

A) Select the laundry.

Loading the laundry

B) Open the porthole.

C) Put the laundry in the washing machine.

Close the porthole again, ensuring that no items of laundry are obstructing the lock.

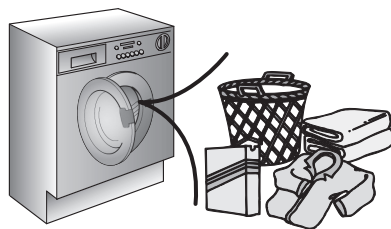

Putting detergent in machine

D) Open the drawer, choose the detergent and put in the correct amount, according to the manufacturer's instructions and the advice on page 20.

Add any other laundry aids (see page 20). Close the drawer again.

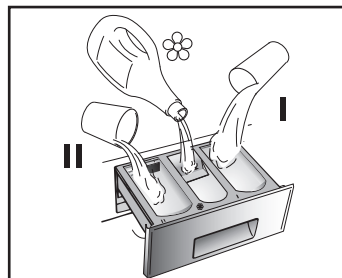

Selecting the wash programme

Refer to the programme guide or the programme descriptions on the machine to select the most suitable programme.

Turning the selector knob, the required programme is activated.

Wait for the "STOP" indicator light to flash.

Press additional function buttons (if required).

Check that the tap is turned on and that the discharge hose is positioned correctly.

Press the "Start/Pause" button.

When the "Start/Pause" button is pressed the machine sets the working sequence in motion.

The programme carries out with the programme selector stationary on the selected programme till cycle ends.

Warning: If there is any break in the power supply while the machine is operating, a special memory stores the selected programme and, when the power is restored, it continues where it left off.

When the programme is finished

At the end of the programme the indicator light "STOP" will go on.

Wait for the door lock to be released (about 2 minutes after the programme has finished).

The "Door Security" indicator light will go out.

Switch off the machine by turning the programme selector on the "OFF" position. Open the door and remove the laundry. Turn off the tap.

DRYING

DON'T DRY GARMENTS MADE FROM FOAM RUBBER OR FLAMMABLE MATERIALS.

**IMPORTANT:
THIS DRYER CAN ONLY BE USED FOR LAUNDRY
WHICH HAS BEEN WASHED AND SPIN DRIED.**

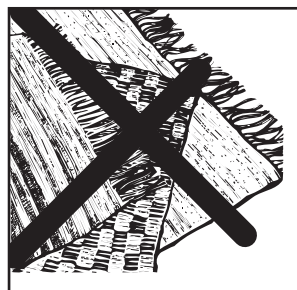

WARNING:

Indications given are general, therefore some practice is needed for the best drying results. We recommend setting a lower drying time than indicated, when first using, so as to establish the degree of dryness required. We recommend not to dry fabrics that fray easily, such as rugs or garments with a deep pile, to avoid air duct clogging.

The water is then conveyed to the drain circuit, which is sealed and therefore, no steam can be released outside.

Important

Never open the door after the drying cycle has begun - wait until the cool down period provided for by the cycle. ✕

Only dry pre-spun laundry

The washer/dryer can perform two types of drying:

1 Cotton, terry towelling, linen, hemp fabrics, etc... ☁☀ symbol on programme dial.

Advisory note

During drying phase the drum will accelerate to a higher speed to distribute the load and to optimize the drying performance

2 Mixed fabrics (synthetics/cotton), synthetic fabrics ☁☀ symbol on programme dial.

Automatic washing/drying

Warning: only a maximum 4 kg of dry laundry can be loaded otherwise the dried laundry will be not satisfactory.

WASHING:

Open the drawer, choose the detergent and put in the correct amount.

Refer to the list of washing programmes according to fabrics to be washed (e.g. very dirty cotton) and without pressing Start button, prepare wash as described:

Turning the selector knob, the required programme is activated.

Wait for the **"STOP"** indicator light to flash.

Check that the tap is turned on and that the discharge hose is positioned correctly.

DRYING:

Select the degree of dryness that you require.

This ranges from Extra Dry (⚙️) for bath towels and bathrobes, through Cupboard Dry (👉) for items that will be put away without ironing, to iron dry (👈) that leaves the laundry suitable for ironing.

If you wish to select a timed drying cycle, press the "drying programme selection" button until the required time indicator lights up.

Press the **"Start/Pause"** button.

When the **"Start/Pause"** button is pressed the machine sets the working sequence in motion.

The programme carries out with the programme selector stationary on the selected programme till cycle ends.

The washer-dryer will then complete the entire drying programme.

The drying programme indicator will be on until the cool down phase will begin and the indicator "🌀" will go on.

When the programme is finished

At the end of the programme the indicator light **"STOP"** will go on.



Wait for the door lock to be released (about 2 minutes after the programme has finished).

The **"Door Security"** indicator light will go out.

Switch off the machine by turning the programme selector on the **"OFF"** position. Open the door and remove the laundry. Turn off the tap.

Drying cycle

The correct way to dry:

- Open door.
- Fill with up to 4 kg - in case of large items (e.g. sheets) or very absorbent items (e.g. towels or jeans), it is a good idea to reduce the load.
- Close door.
- Turn programme dial to   cotton.

Select the degree of dryness that you require.

This ranges from Extra Dry () for bath towels and bathrobes, through Cupboard Dry (2) for items that will be put away without ironing, to iron dry (2) that leaves the laundry suitable for ironing.

If you wish to select a timed drying cycle, press the “drying programme selection” button until the required time indicator lights up.

DOUBLE-SKIN DOOR

The appliance door is fitted with a protective shield to prevent contact with the glass door which can reach high temperatures, during the drying cycle.

It should not be necessary to remove the shield from the machine during the normal course of use.

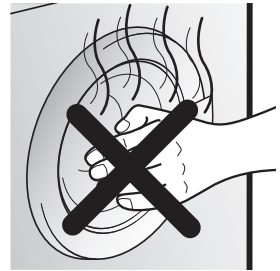

Warning: do not touch door for any reason.



- Make sure water inlet valve is open.
- Make sure water drain is correctly positioned.

Warning:

do not dry woollen garments or articles with special padding, (e.g. quilts, quilted anoraks, etc.).

Delicate fabrics if garments are drip/dry, load less items so as to prevent creasing.

Press the START button.

The drying phase will begin with the programme dial fixed on the   symbol until the end of drying.

The drying programme indicator will be on until the cool down phase will begin and the indicator “” will go on.

When the programme is finished

At the end of the programme the indicator light “**STOP**” will go on.

Wait for the door lock to be released (about 2 minutes after the programme has finished).

The “**Door Security**” indicator light will go out.

Switch off the machine by turning the programme selector on the “**OFF**” position. Open the door and remove the laundry. Turn off the tap.

Table of drying times (in minutes):

| PROGRAMME | COTTON | | MIXED | |
|------------------|-----------------|-----------------|-----------------|-----------------|
| | Min 1 Kg | Max 4 Kg | Min 1 Kg | Max 3 Kg |
| <i>Extra</i> | <i>from 30'</i> | <i>to 230'</i> | <i>from 30'</i> | <i>to 170'</i> |
| <i>Cupboard</i> | <i>from 30'</i> | <i>to 220'</i> | <i>from 30'</i> | <i>to 150'</i> |
| <i>Iron</i> | <i>from 30'</i> | <i>to 170'</i> | <i>from 30'</i> | <i>to 80'</i> |

USEFUL TIPS:

Do not dry unwashed items in the washer dryer.

Items that have been soiled with substances such as cooking oil, acetone, alcohol, petrol, kerosene, spot removers, turpentine, waxes and wax removers should be washed in hot water with an extra amount of detergent before being dried in the washer dryer.

Items such as foam rubber (latex foam), shower caps, waterproof textiles, rubber backed articles and clothes or pillows fitted with foam rubber pads should not be dried in the washer dryer.

Fabric softeners, or similar products, should be used as specified by the fabric softener instructions.

The final part of a washer dryer cycle occurs without heat (cool down cycle) to ensure that the items are left at a temperature that ensures that the items will not be damaged.

WARNING:

Never stop a washer dryer before the end of the drying cycle unless all items are quickly removed and spread out so that the heat is dissipated.

Cleaning and routine maintenance

Do not use alcohol-based scourers and / or thinners on the outside of your washing machine, just a wipe with a damp cloth will suffice. The washing machine needs very little maintenance:

- Cleaning the drawer compartments.
- Cleaning the filter.
- Cleaning the door glass.

Cleaning the drawer compartments

Even if it is not strictly necessary, it is good to clean the compartments for bleaching detergents and additives occasionally.

- To do this you just need to pull them out firmly, but without forcing them.
- Clean everything in the compartment under running water.
- Put everything back in its proper place.

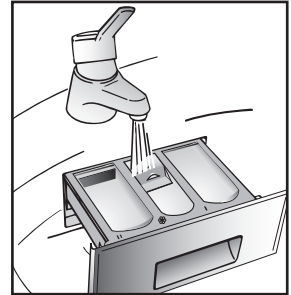

Cleaning the filter

The washing machine is fitted with a special filter for handling large deposits which could block the discharge hose (coins, buttons etc.) and which can, therefore, be easily retrieved.

We recommend that the filter be cleaned at least once a month.

The cleaning operation is as follows:

- Before removing the filter, place an absorbent towel below the filter cap to collect the small amount of water likely to be inside the pump
- Turn the filter anti-clockwise until it stops in the vertical position.
Remove and clean.
- After cleaning, replace by turning the notch on the end of the filter clockwise.

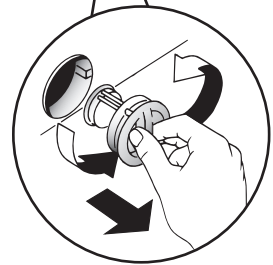

Cleaning the door glass

Regularly clean the door glass with a damp cloth. A build up of soiling and residues from the water may result in water leaking from the door.

Do not use abrasive cleaners as they can scratch the surface.

Transporting the appliance or long periods when appliance is not in use

If the appliance is being transported or is out of use for long periods in unheated places, all remaining water must be completely removed from the hoses.

Ensure mains power is off, then unclip the hose and point it downwards into a basin until all the water has emptied out. When finished, repeat the operation in the reverse order.

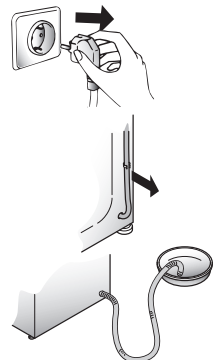

Investigating malfunctions

What might be the cause of... Defects you can remedy yourself

| MALFUNCTION | CAUSE | REMEDY |
|--|--|--|
| 1. Does not work on any programme | Plug not in socket. Not switched on. Power failure. Fuse blown. Door open. | Plug it in. Switch on. Check. Check. Close door. |
| 2. Does not fill with water | See cause 1. Tap turned off. Programme selector not correctly positioned. Fill hoses are kinked | Check. Turn on tap. Position programme selector correctly. Straighten fill hoses |
| 3. Water does not drain away | Kink in discharge hose. House drain is blocked Odd material blocking filter | Straighten discharge hose. Clean drain Check filter |
| 4. Water on floor around the washing machine | Leaking gasket between tap and water inlet hose. House drain is blocked Soap drawer blocked with soap residues | Replace gasket and tighten hose and tap well. Clean drain Clean soap drawer |
| 5. Does not spin | Water has not yet drained away. "No spin" selected (certain models only). | Wait a few minutes for machine to empty. Reset button or turn "no spin" knob. |
| 6. Machine vibrates a lot during spin | Washing machine not completely level. Transit brackets not removed yet. Load not distributed evenly. | Adjust the special adjustable feet. Remove transit brackets. Rearrange the laundry evenly. |
| 7. Door will not open | Two minutes have not elapsed since the programme finished. | Wait two minutes. |

During drying phase the drum will accelerate to a higher speed to distribute the load and to optimize the drying performance

The machine makes a different noise when spinning! This is because it has a brush motor for better performance.

Only a small level of water can be seen in the drum! This is because new machines do not use much water, yet achieve the same standard of washing and rinsing.

Note:

The use of environmentally-friendly, phosphate-free detergents can have the following effects:

- waste water from rinsing may be cloudier because of the presence of zeolites held in suspension, without the rinse performance being adversely affected;
- presence of white powder (zeolites) on laundry after washing, which is not absorbed by the fabric and does not alter the colour of the fabric.
- The presence of foam in the final rinsing water is not necessarily an indication of poor rinsing.
- Anionic surfactants used in washing detergent formulae often prove to be difficult to remove from the laundry itself and, even in small quantities, can still cause considerable foam production.
- Carrying out more rinse cycles does not serve any purpose in such cases.

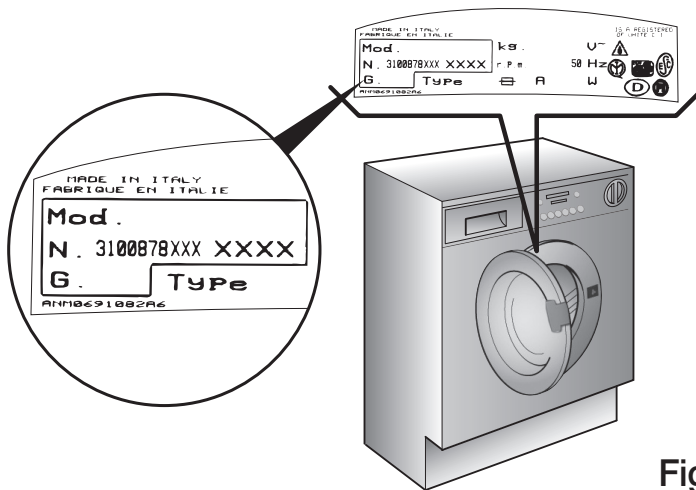

Fig. 2

Technical data

- Max. load of dry laundry
- Max. load of dry laundry for drying
- Water pressure

6 kg
4 kg
0,05 ÷ 0,8 MPa

Measurements

- Width
- Depth
- Height

60 cm
54 cm
82 cm

NB: For specifications regarding electrical data, see the data panel on the front of the washing machine (porthole area) - as shown in diagram above.



Appliance complies with European Directives 73/23/EEC and 89/336/EEC, replaced by 2006/95/EC and 2004/108/EC, and subsequent amendments.

SETTING UP + INSTALLATION

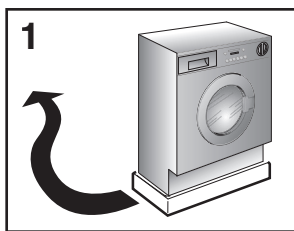

Remove the polystyrene base and place the machine near its permanent position (diagram 1).

Carefully cut through the hose retaining clip at the rear of the appliance (diagram 2).

Remove the 3 fixing screws marked (A) and remove the 3 spacers marked (B) (diagram 3).



Remove the screw (C).

A spacer will fall inside the machine.

By tilting the machine, remove the above mentioned spacer.

Cover the 4 holes using the caps provided in the instruction booklet pack (diagram 4).

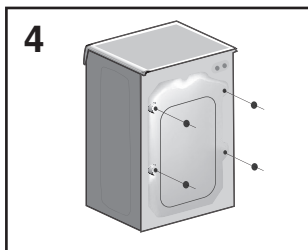
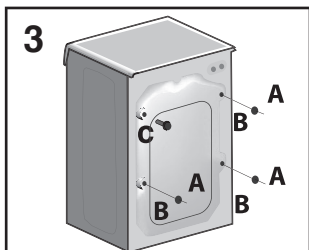

WARNING:

DO NOT LEAVE THE PACKAGING WITHIN REACH OF CHILDREN AS IT IS A POTENTIAL SOURCE OF DANGER.

Apply the insulation sheet of corrugated material to the base as shown.

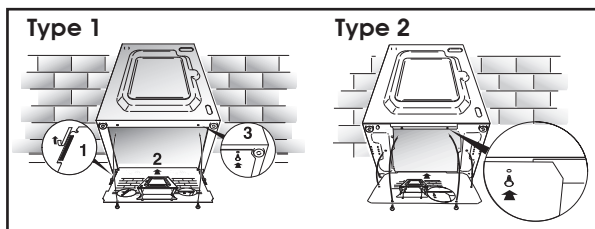

Use the 4 feet to level the machine with the floor:

- Turn the nut clockwise to release the screw adjuster on the foot.
- Rotate the foot to raise or lower it until it stands firmly on the ground.
- Lock the foot in position by turning the nut anti-clockwise until it comes up against the bottom of the machine.

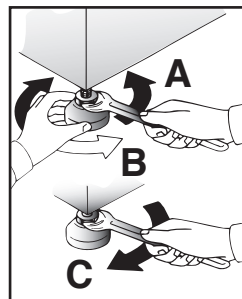

Note: we recommend you keep the screws to immobilise the machine for future transit.

The Manufacturers will not be responsible for any possible damage to the machine caused by not following the rules relating to releasing the mechanism. The user is responsible for all costs of installation.

Water connection

The appliance must be connected to the water mains using new hose-sets.

The old hose-sets should not be re-used.

The machine has an inlet hose with 3/4" B.S.P threaded end connection to attach between the threaded connector on the appliance and the cold water supply.

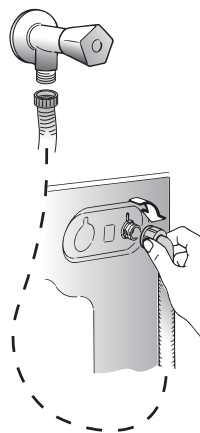

This machine only uses cold water, therefore only one hose is needed to connect to the cold water supply. Do not connect to the hot supply. Cold fill is an energy efficient system. Only the water required for the washing is heated. There is no loss of heat in the pipeline from a hot water tank or boiler to the machine.

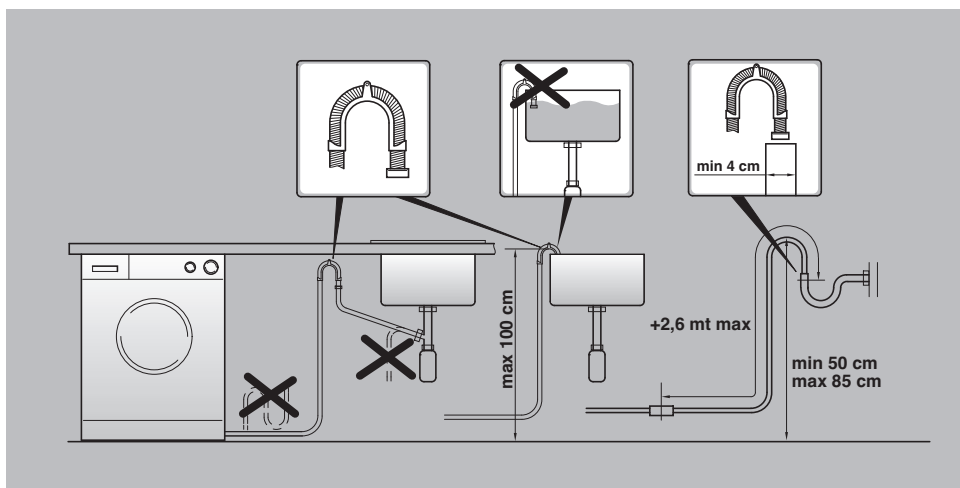

Note: it is advisable to turn off the tap after each wash to isolate the washing machine from the water supply.

For the washing machine to function properly the terminal end of the discharge hose (mouth) must be at a minimum of 50 cm and a maximum of 85 cm from the ground.

ELECTRICAL CONNECTIONS

After installation, the appliance must be positioned so that the plug is accessible.

If the plug we supply does not fit

CUT IT OFF AND DESTROY IT!

You can't use it on other appliances, and the exposed wires could be dangerous if plugged in.

To fit a replacement plug, proceed as follows:

Connect

green and yellow wire

to the terminal in the plug

marked with the letter E,
OR marked
with the symbol, 
OR coloured green,
OR coloured green and yellow.

blue wire

marked N
OR coloured black.

brown wire

marked L
OR coloured red.

WARNING

This appliance must be earthed

Fuses and plugs

This appliance should be used only on a socket with a minimum rating of 13 Amp.

Our ready-fitted plug is already equipped with a 13 amp fuse which is BS 1362 ASTA approved. Any replacement should be exactly the same.

If the fuse cover is lost, do not use the plug until it is replaced. A correct replacement fuse cover (obtainable from your local retailer) must be the same colour as shown or named on the insert on the base of the plug.

INSTRUCTIONS FOR MOUNTING DOOR

Drill holes in the door using the cardboard template as indicated in Fig. 1 to mount the hinges and closure magnet in the right or left-hand position according to your requirements. The position of the hinges refers to the upper edge.

Screw the hinges in place with the 4 screws (A). Screw on the magnet (B) with screw (C).

Mount the plate (D) in the right or left-hand position, according to your requirements. Place the rubber washers under the plate and screw in place with screw (G). Snapmount cap (H) in the lower position.

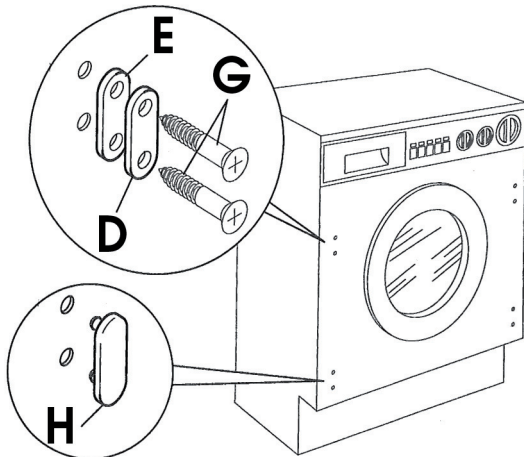
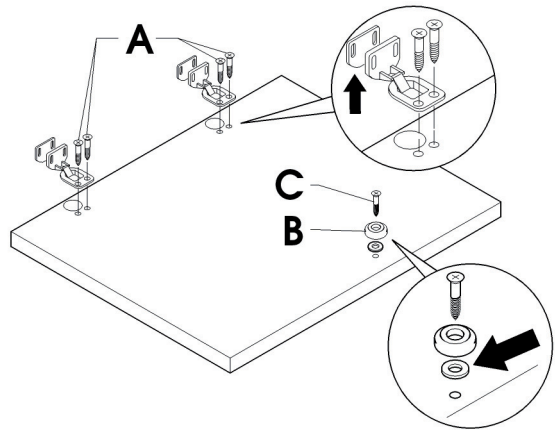
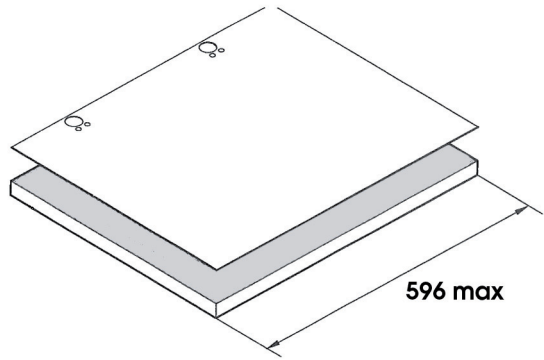

Mount the door with hinges by screwing with screws (L) to the front of the washing machine.

NOTE: You are advised to mount the door so that it opens towards the left, in the same direction as the washing machine load door for more loading space.

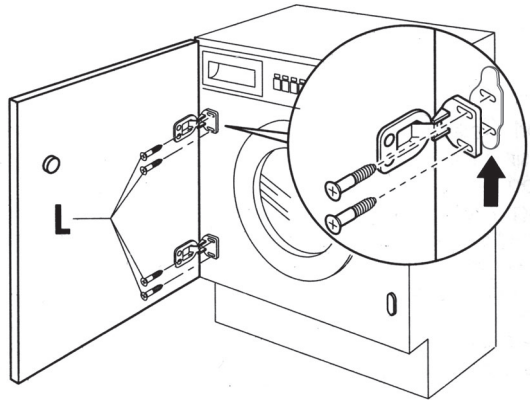

Slide the washing machine into an opening of adequate size. The lower skirting may be applied as preferred but within the size provided for.

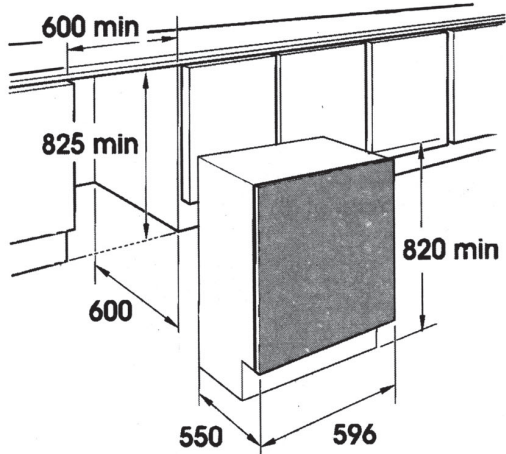

The four adjustable feet allow the height of the washing machine to be adjusted from 820 mm (by removing the nuts supplied and substituting with 5 mm nuts) to a max. 840 mm by raising the feet and blocking the lock nut to the base of the plate.

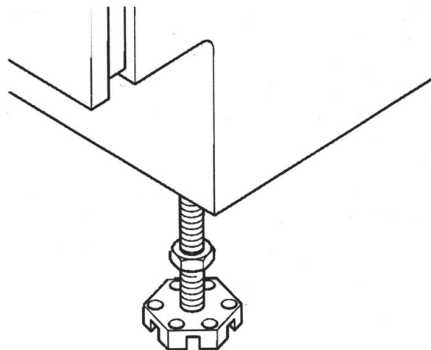

The manufacturer declines all responsibility in the event of any printing mistakes in this booklet. The manufacturer also reserves the right to make appropriate modifications to its products without changing the essential characteristics.

This appliance is marked according to the European directive 2002/96/EC on Waste Electrical and Electronic Equipment (WEEE).

By ensuring this product is disposed of correctly, you will help prevent potential negative consequences for the environment and human health, which could otherwise be caused by inappropriate waste handling of this product.

The symbol on the product indicates that this product may not be treated as household waste. Instead it shall be handed over to the applicable collection point for the recycling of electrical and electronic equipment. Disposal must be carried out in accordance with local environmental regulations for waste disposal.

For more detailed information about treatment, recovery and recycling of this product, please contact your local city office, your household waste disposal service or the shop where you purchased the product.

