

mamas & papas®

carrycot/bassinette

capazo

nacelle de landau



x1



<15m

PCPC 0368_0515_V3

© Mamas & Papas Ltd. 2015

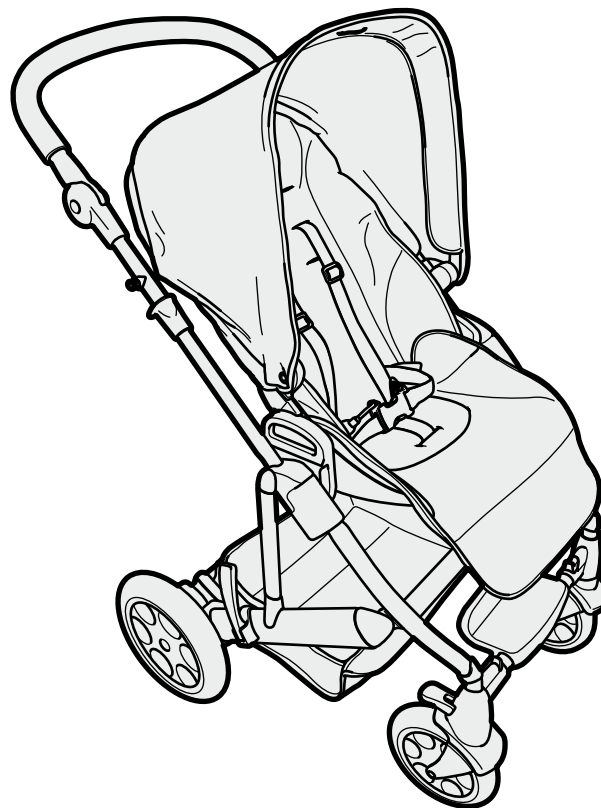

pixo

Thank you for ordering from Mamas & Papas.

For over 30 years, we have been committed to creating a world of quality, individuality and style for parents around the world. At the very beginning we were inspired by our daughters — now we see them all grown up, with children of their own, helping us to share our passion for parenting to their generation of Mums and Dads. We hope you enjoy exploring our new collection and wish you a very warm welcome to our world.

We are committed to designing and developing products to the highest standards, for your family to enjoy and we welcome any feedback or comments you may have.

The Mamas & Papas Family.

**IMPORTANT: READ THE INSTRUCTIONS
CAREFULLY BEFORE USE AND KEEP
THEM FOR FUTURE REFERENCE.**



Attaching the basket

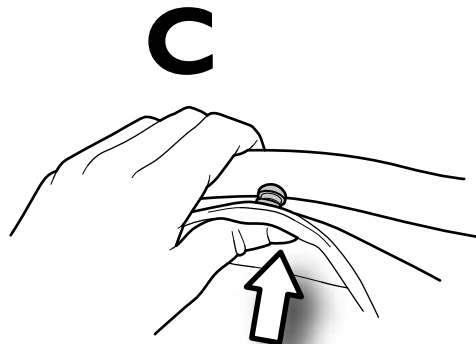
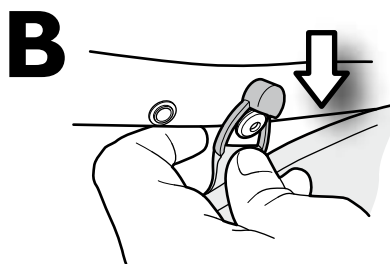
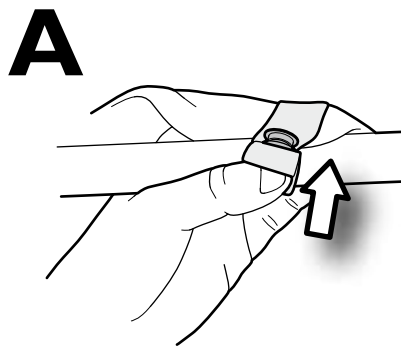
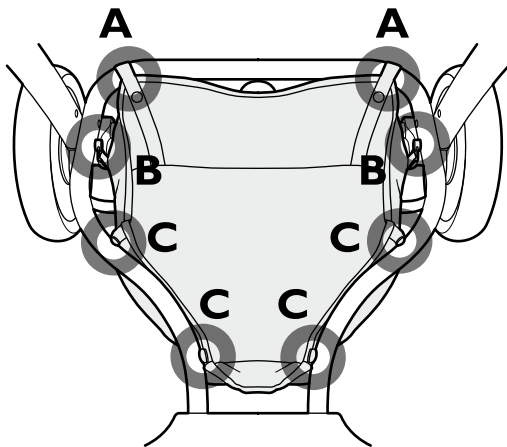

Opening the chassis

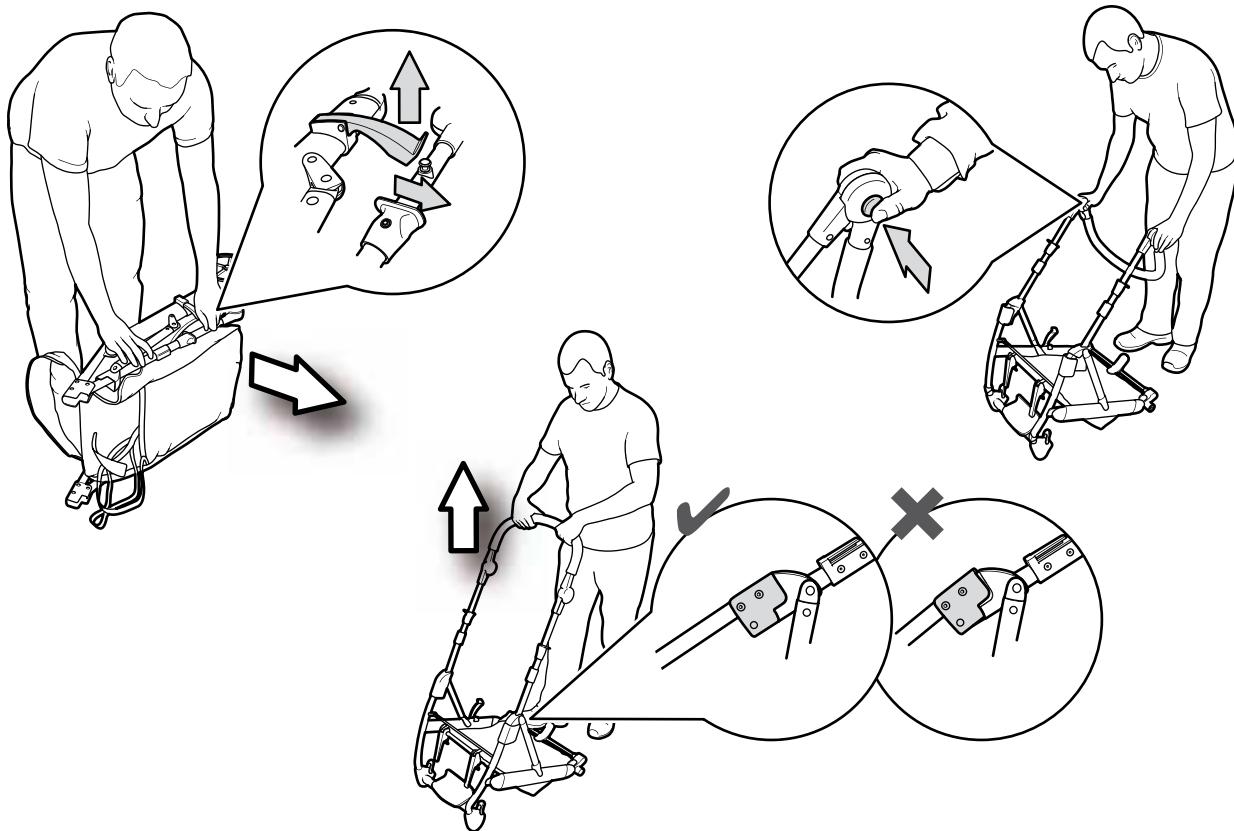

Fitting the rear wheels.

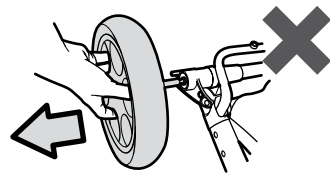
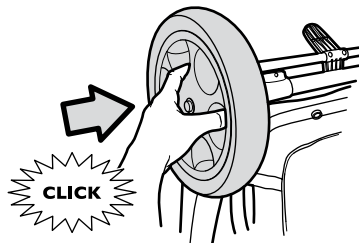
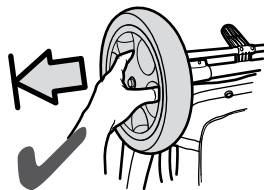
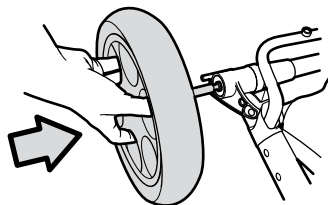
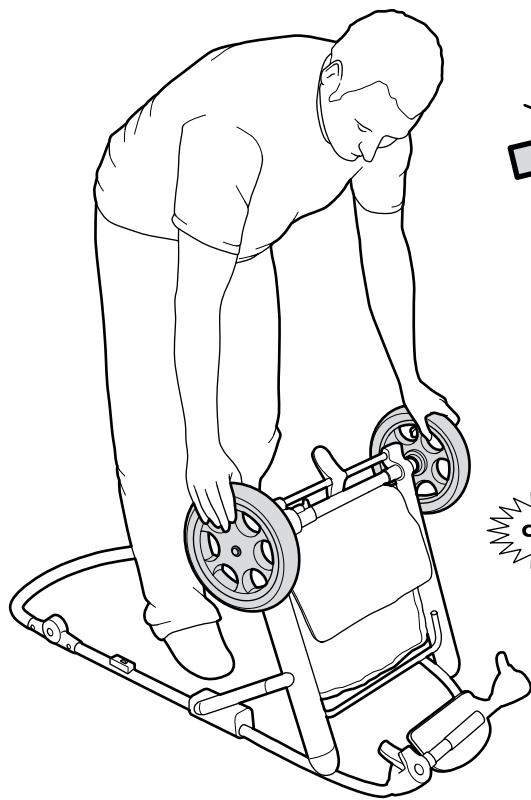

Fitting the front wheels.

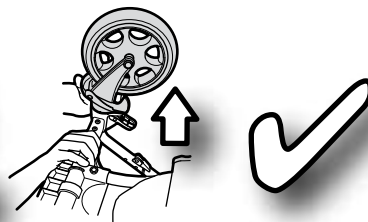
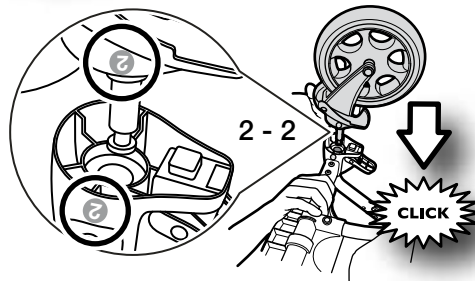
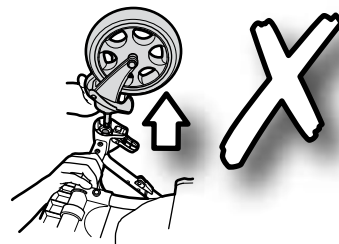
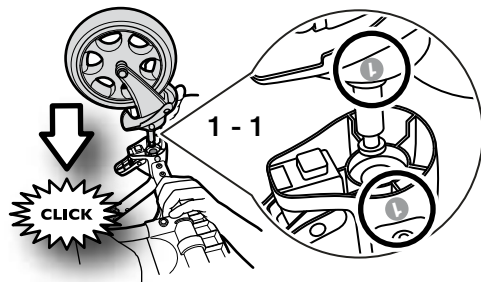

Using the brakes.

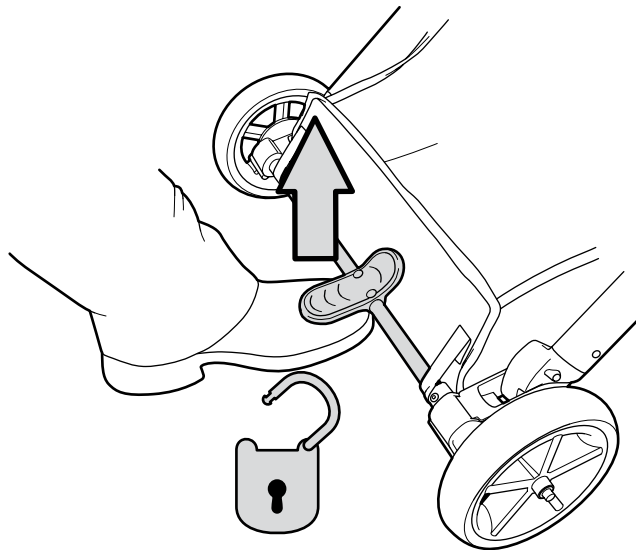
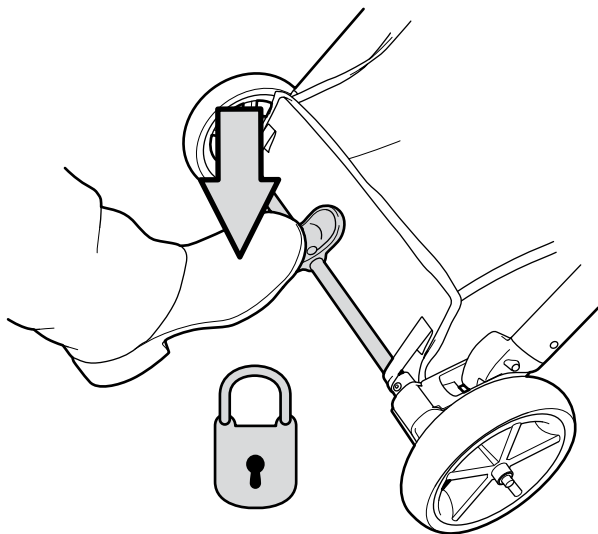

Using the swivel wheels

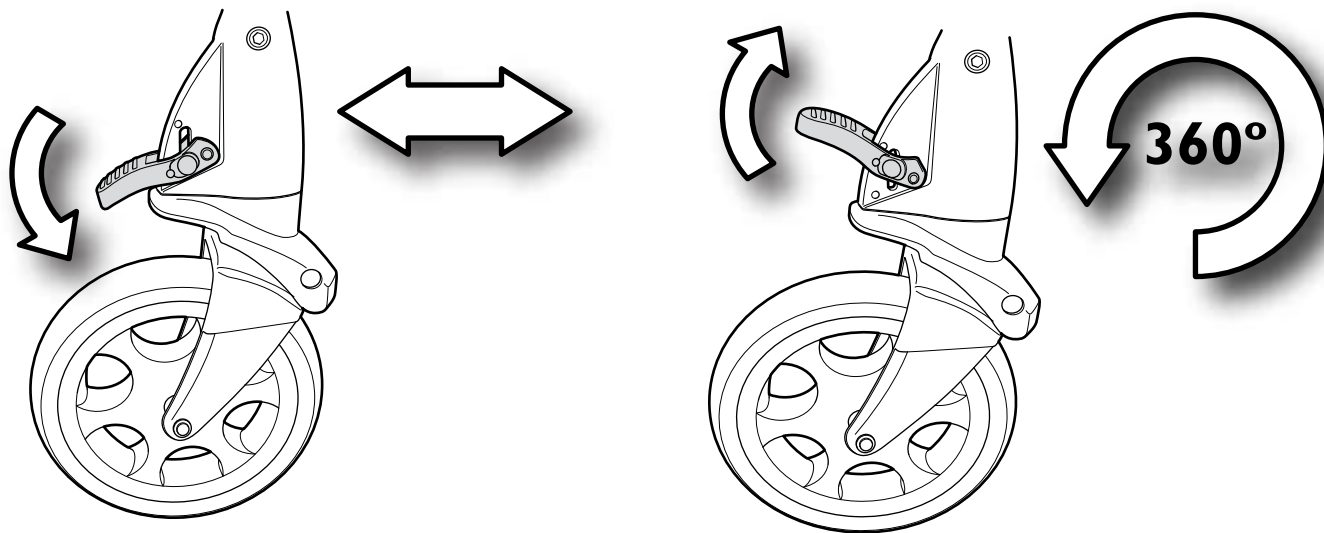

Assembling the carrycot

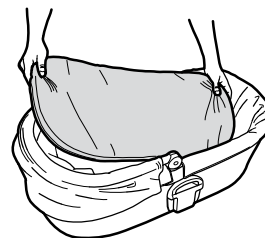
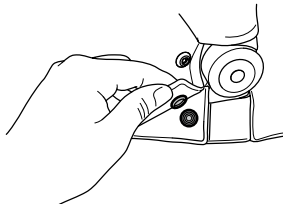
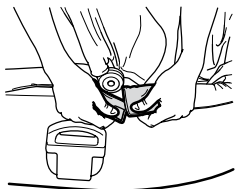
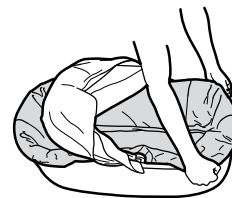
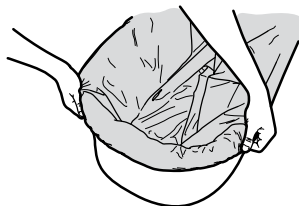
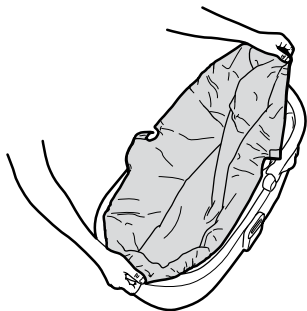
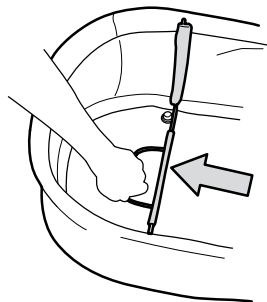
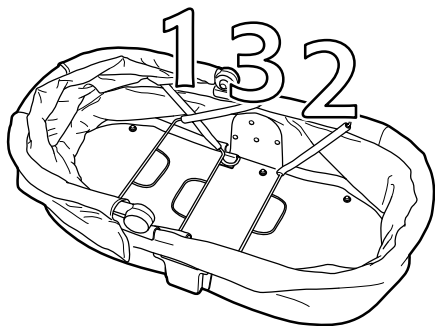

Fitting the apron.

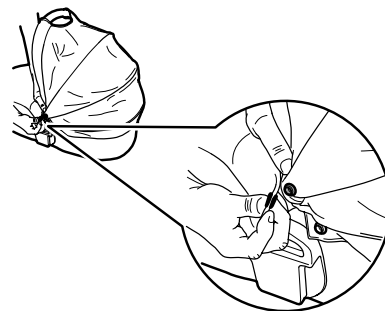
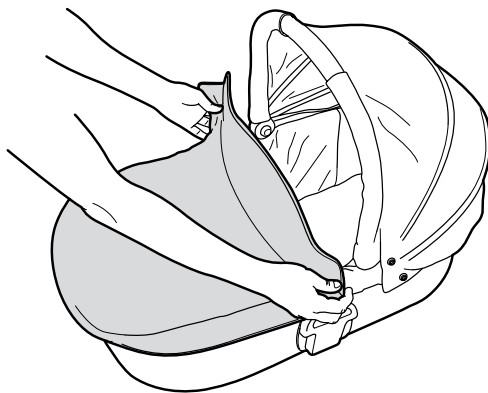
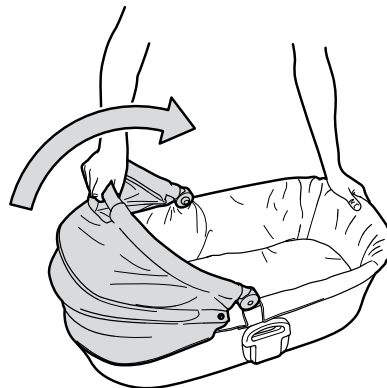
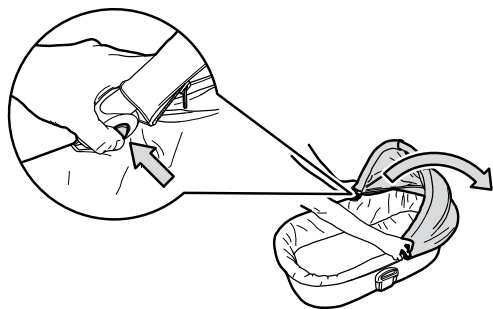

Attaching the carrycot

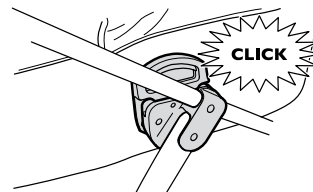
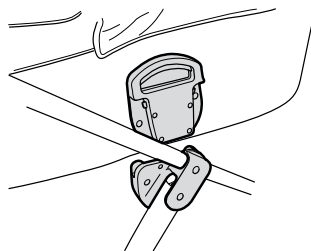
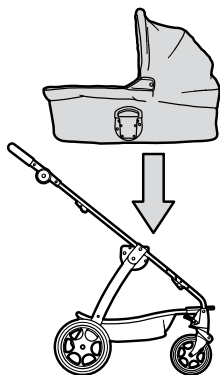

Removing the carrycot

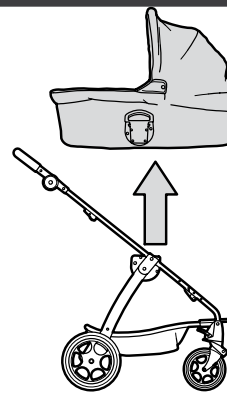
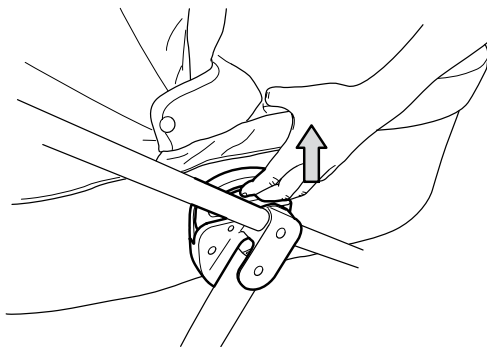

Fitting the carrycot raincover

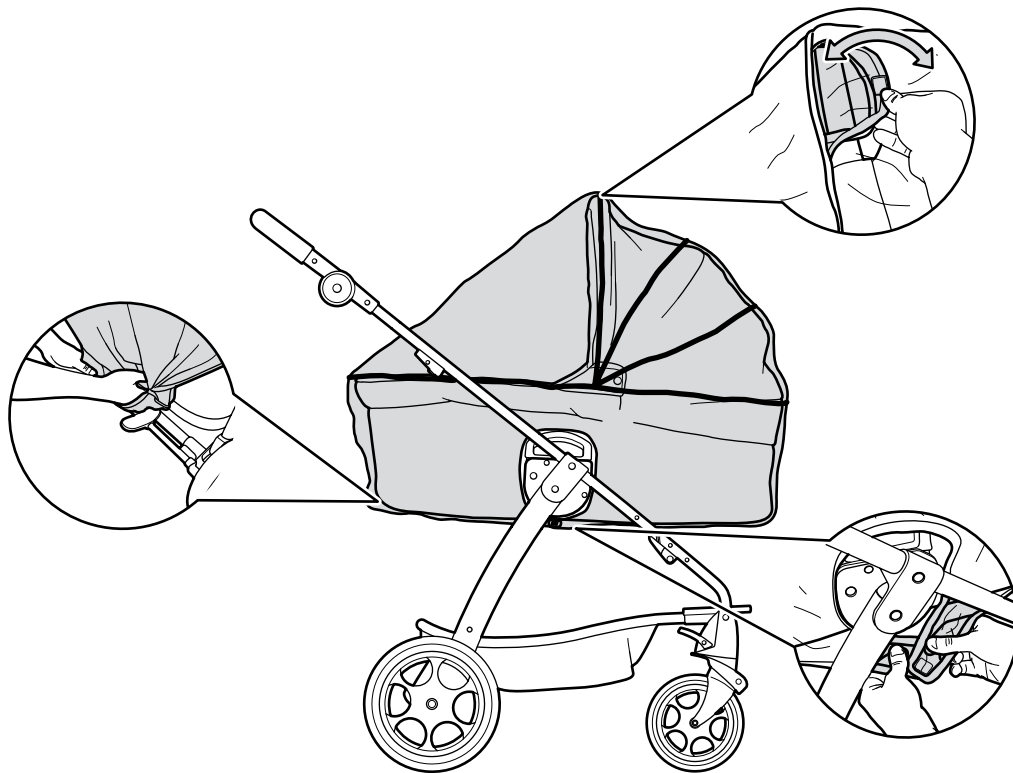

Complete



Fitting the seat unit hood.

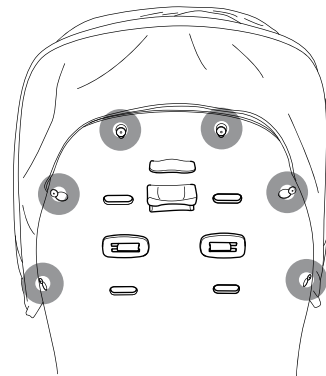
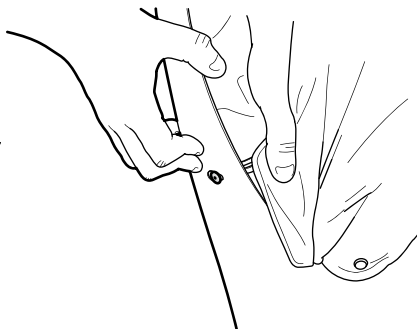
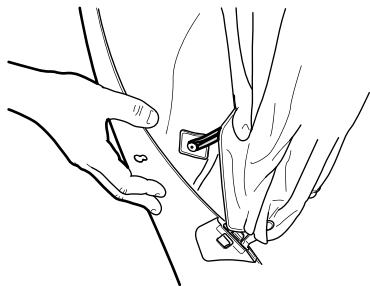
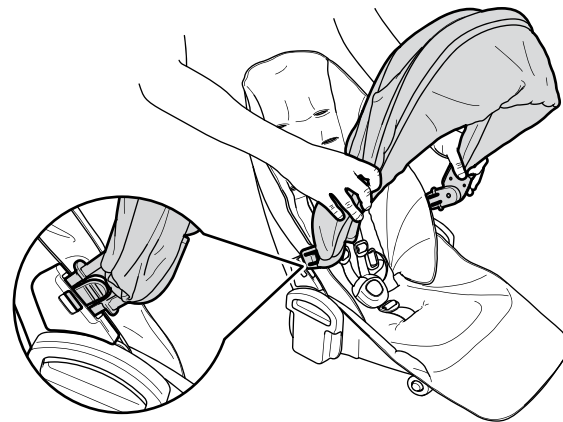
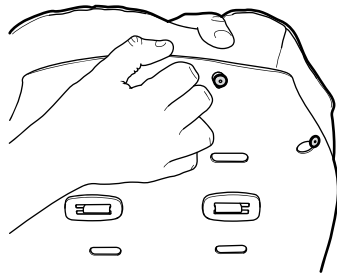
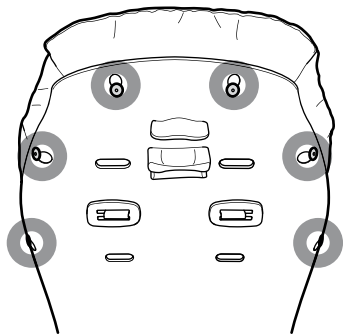

Refitting the harness

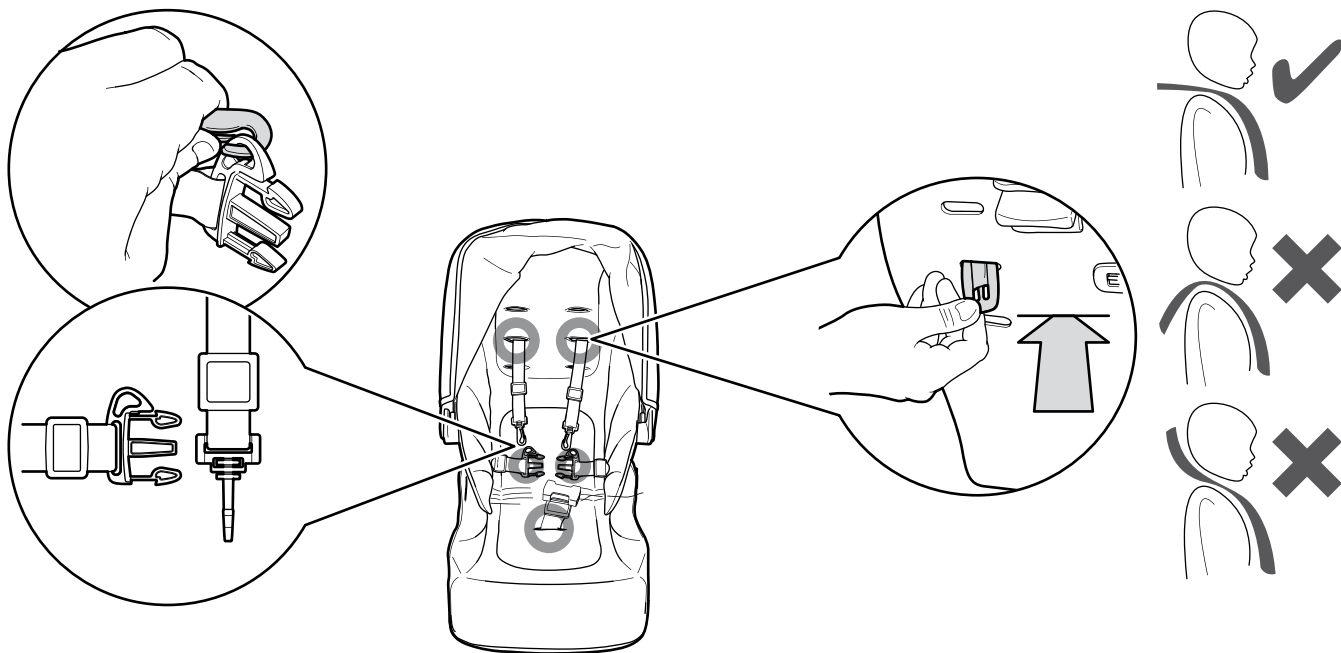

Using the harness

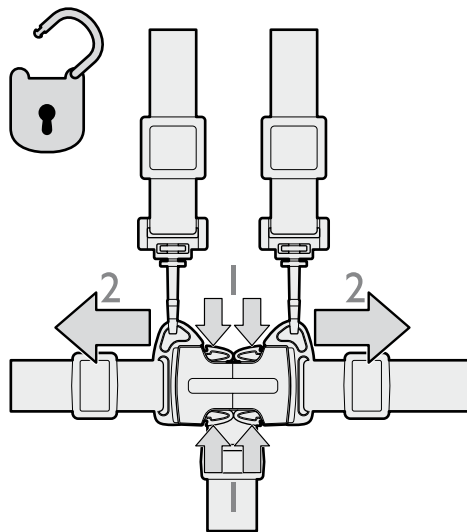
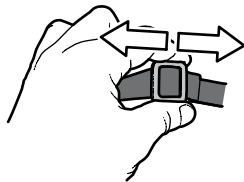
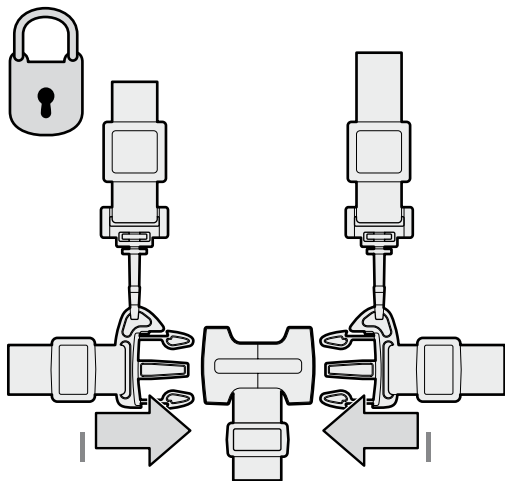

Attaching the seat unit.

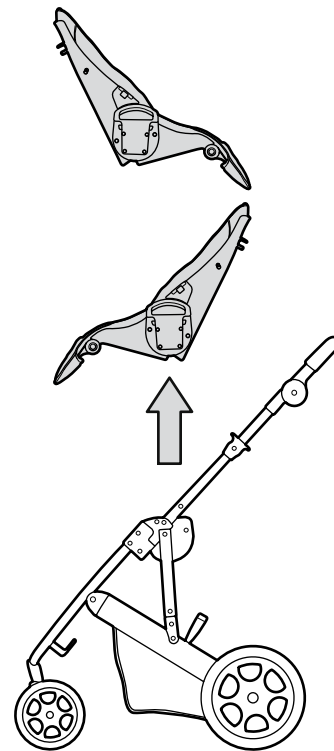
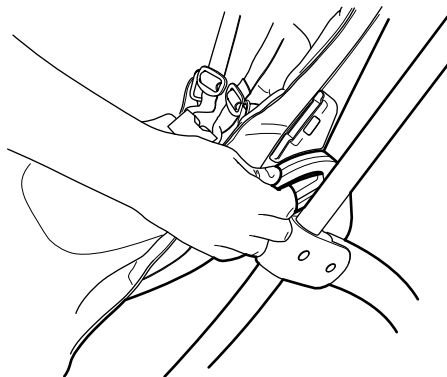
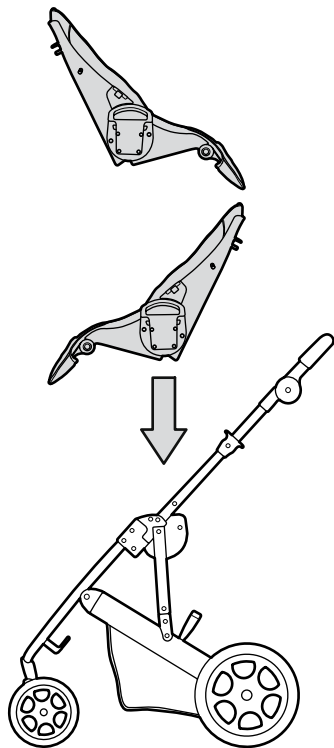

Adjusting the legrest and backrest.

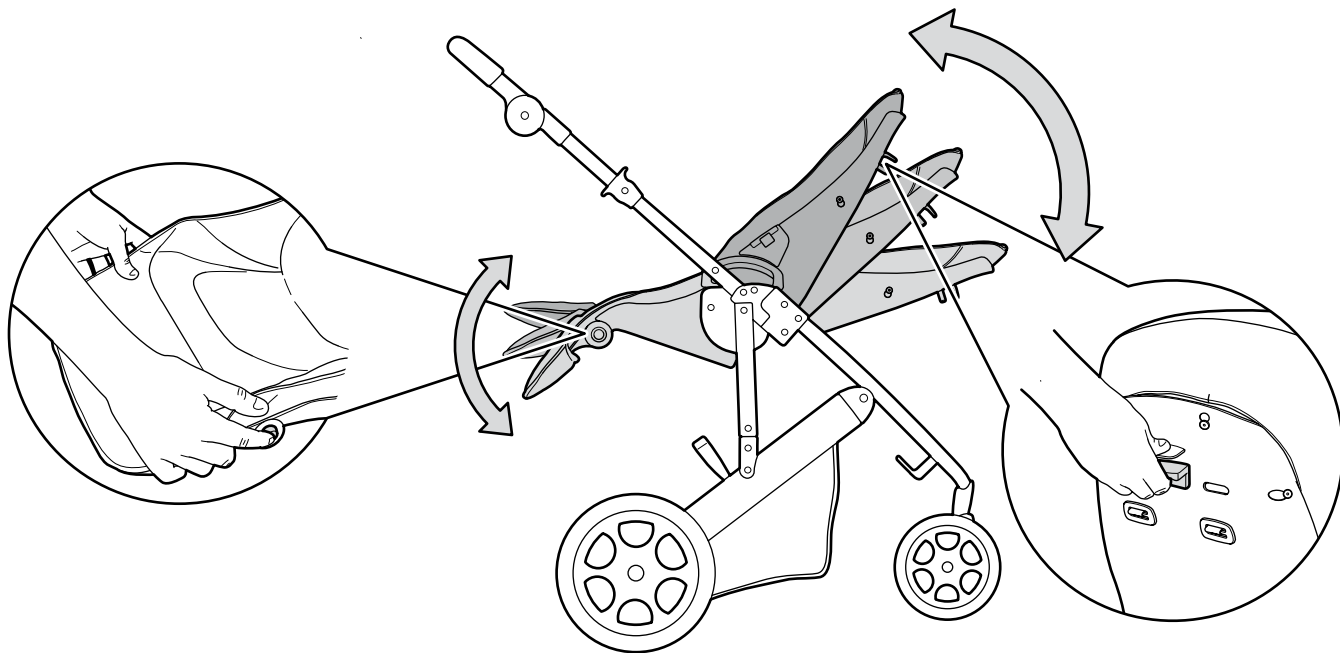

Folding the chassis.

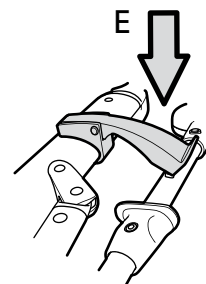
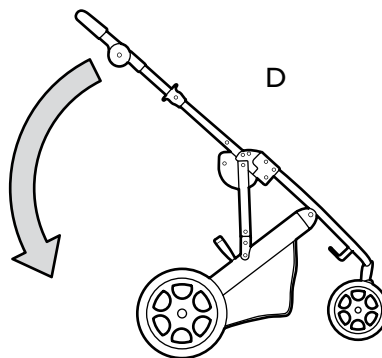
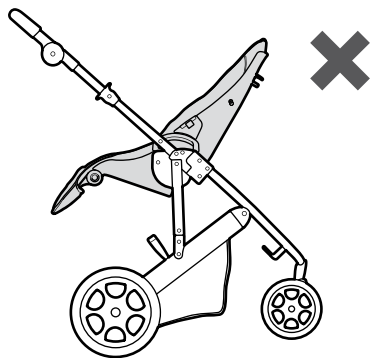
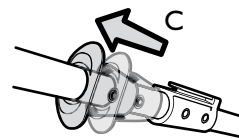
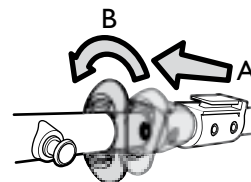
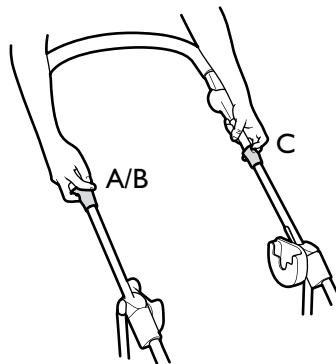
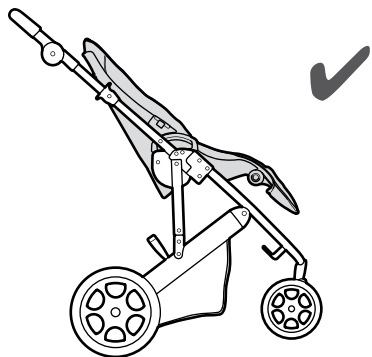

Fitting the pushchair raincover

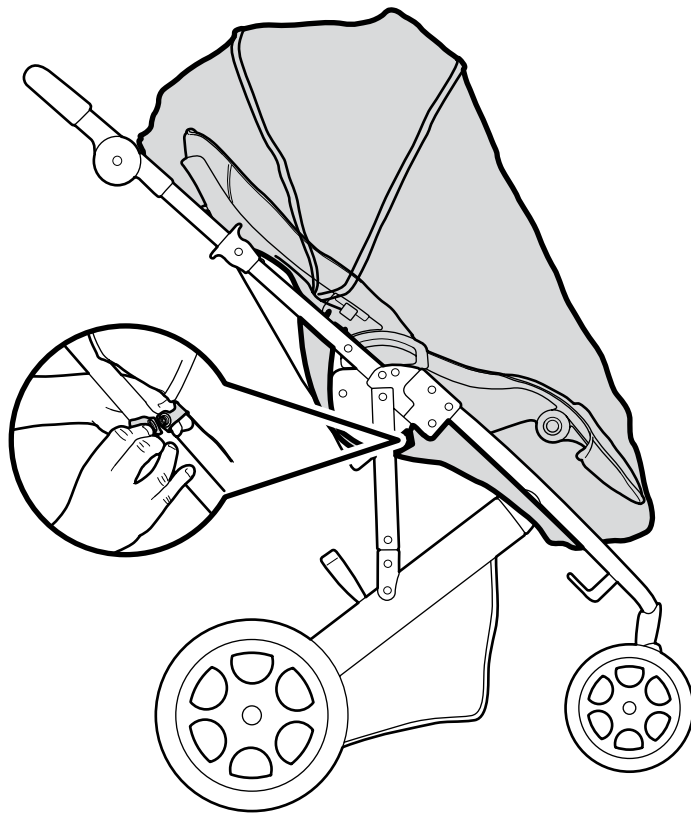

Finished

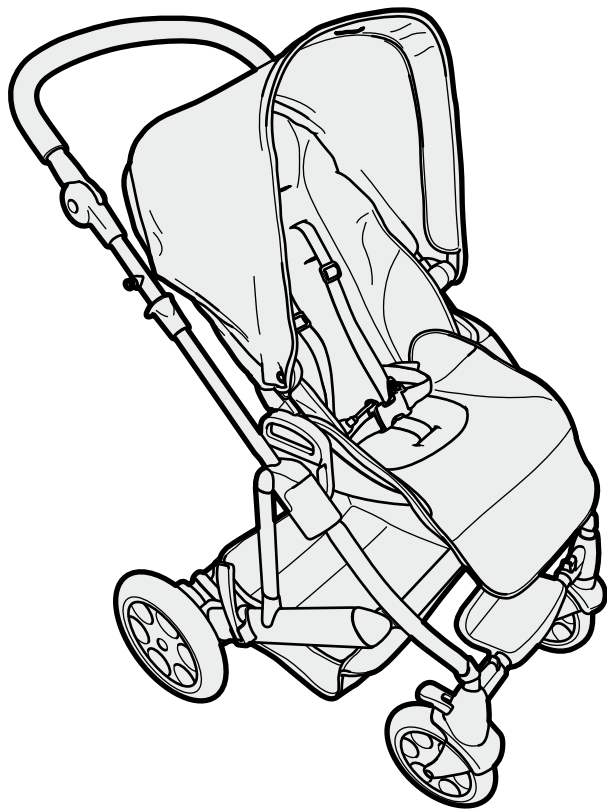

THE SAFETY STANDARDS AND TESTING METHODS MAY VARY IN DIFFERENT COUNTRIES AND REGIONS. DEPENDING ON THE INDIVIDUAL COUNTRY OR SAFETY STANDARD SPECIFIC WARNINGS MAY APPLY.

- In Europe this vehicle is intended for children from birth up to 15kgs. (3 years approximately).
 - The maximum height of a child this product is designed to carry is 109cm/43".
 - This pushchair is designed to carry up to 1 child/children only. Never allow additional children to ride on the pushchair.
 - Always use the most reclined backrest position for new born babies.
-

 WARNING:

- Never leave your child unattended.
 - Ensure that all the locking devices are engaged before use.
 - To avoid injury ensure that your child is kept away when unfolding and folding this product.
 - Do not let your child play with this product. Do not allow your child to climb or stand on this product.
 - Always use the restraint system
 - Check that the pram body or seat unit or car seat attachment devices are correctly engaged before use.
 - This product is not suitable for running or skating.
 - Avoid finger entrapment, take care when folding and unfolding the product.
 - When making adjustments ensure that all parts of the child's body are clear of any moving parts.
 - Never lift the seat unit using the bumper bar.
 - Always use with bumper bar attached in pushchair mode.
 - The use of a car seat with this product does not replace a cot or a bed. Should your child need to sleep, then it should be placed in a suitable pram body, cot or bed.
 - Any load attached to the handle affects the stability of the pram/pushchair. Do not carry additional children, parcels, goods or accessories in or on this vehicle except as recommended in the manufacturer's instructions.
 - Avoid serious injury from falling or sliding out. Always use the restraint system.
-

COMPATIBILITY.

- This product is compatible with infant carseats when used with the appropriate car seat adaptor, for details of the adaptor system to fit your product please contact your Mamas & Papas stockist.
- Designed to fit the Pixo seat unit and the Pixo Carry Cot only.

CAUTIONS AND HAZARDS.

- **SUFFOCATION HAZARD:** Infants can suffocate. Always make sure there is enough room around your baby's face such that the airflow is not obstructed. Strings can cause strangulation. Do not place items with a string around the child's neck, such as hood strings or pacifier cords. Do not suspend strings over a product or attach string to toys.
 - Ensure the parking device is engaged when placing or removing children.
 - When child is in the seat unit always use the restraint system.
 - Take care when using the stroller on stairs or escalators.
 - Do not overload the basket. Maximum weight of 3kg/6.6lbs.
 - Do not overload the canopy pocket. Maximum weight 0.45kg/1lbs.
 - No additional mattress shall be added, if you require a replacement mattress please contact your product retailer. The mattress must always be placed with the textile opening facing down.
 - The 'D' rings attached to the rear of the waist belt are for the use of a separate harness.
 - Always use products with the hood fitted.
-

SERVICE INFORMATION.

- Do not use any replacement parts or accessories other than those approved by or supplied by Mamas & Papas.
- Wipe all plastic/metal parts clean with a damp cloth using mild soap, dry thoroughly. Light soiling of the seat pad can be removed with a damp cloth and a mild soap.

CARE AND MAINTENANCE

- A pushchair has many moving parts, and surfaces which move against each other, over time these surfaces can become dry or even attract dirt or dust. By simply cleaning your pushchair chassis on a regular basis and lightly spraying the moving parts with a silicon spray your pushchair will fold and push better for longer.
- Different environments can present different challenges to your pushchair, a visit to the beach can increase salt corrosion to parts, but so too can a wet or snowy day, so again by cleaning and lubricating your pushchair you can help fight the effects of the environment on your pushchair.
- When a pushchair is in use, with all its locking mechanisms in place, its a solid rigid item designed for carrying your child. However, when folded its the exact opposite, impacts can knock it out of alignment, or putting things on top of it could twist it out of shape, so we recommend taking a little more care with it when folded for storage.
- Hanging bags on the handles of the pushchair not only creates a risk of tipping, but it can also cause excessive and uneven wear, as weight here causes the chassis to twist as handles are not designed to be a load bearing part.
- Just as with extra weight in the basket, or bags on handles, the use of a buggy-board reduces the life of your product by increasing the weight on the product, but by also putting weight and strain onto parts in a direction they were not designed to experience. Consequently use of these products invalidates the warranty on pushchairs.
- Fabric care: All the Mamas & Papas pushchairs fabrics are shower resistant. Should your pushchair become wet, do not fold the hood or apron when you take it inside. Always allow the fabrics to dry naturally away from strong heat sources such as fires, radiators and out of direct sunlight.
- Whilst fabrics are carefully selected and tested, washing, wear and normal exposure to bright sunlight may cause their colour to change.
- The exposed edges of fabrics are often the first to wear and fray, remember this when storing or transporting your pushchair and accessories.
- Light soiling to the pushchair can be removed with a damp sponge and a mild detergent.
The fabric cover can be sponged clean using a mild detergent if necessary.

Your child's safety may be affected if you do not follow these instructions

WARNING:

- When the carrycot is fitted, this product is only suitable for a child who cannot sit up unaided.
 - When the carrycot is fitted, this product is suitable for a child who cannot sit up by itself, roll over and cannot push up on its hands and knees. Maximum weight of the child: 9kg.
 - When the carrycot is fitted, use only on a firm, horizontal level and dry surface.
 - Do not let other children play unattended near the carrycot.
 - Do not use if any part of the carry cot is broken, torn or missing
 - Be aware of the risk of open fire and other sources of strong heat, such as electric bar fires, gas fires, etc, in the near vicinity of the carrycot.
 - Do not use any additional mattresses in the carry cot.
 - The handles and the base of the carrycot require regular inspection for wear and damage.
 - Do not leave your child unattended.
 - Never use the carrycot on a stand.
 - Always ensure the hood is fully open and engaged before lifting and carrying the carrycot.
 - The head of the child in the carrycot should never be lower than the child's body.
-

CARE AND MAINTENANCE

- Fabric care: All the Mamas & Papas pushchairs fabrics are shower resistant. Should your pushchair become wet, do not fold the hood or apron when you take it inside. Always allow the fabrics to dry naturally away from strong heat sources such as fires, radiators and out of direct sunlight.
- Whilst fabrics are carefully selected and tested, washing, wear and normal exposure to bright sunlight may cause their colour to change.
- The exposed edges of fabrics are often the first to wear and fray, remember this when storing or transporting your pushchair and accessories.
- Care Instructions: Surface cleaned with a moist cloth or sponge that has been dipped in warm water.





mamas & papas[®]

HD5 0RH, UK



mamasandpapas.com
mamasandpapas.ca
mamaspapas.kr



UK T: +44 (0)345 268 2000
USA T: 1-800-490-0331
CAN T: 1-800-667-4111
AU T: 1300-663-034



/mamasandpapasuk
/mamasandpapasusa
/mamasandpapasmltaregion
/mamasandpapasmagyarország



@mamasandpapas



/user/mamasandpapasglobal



mamasandpapasblog.com



/mamasandpapas



/mamasandpapasuk
/mamasandpapasus



/+mamasandpapas

┌
└

LOT

┌
└