



You're home.™

6 year
guarantee

Air³ Compact

Let's get started



U86-AC-B

vax.co.uk

Let's talk safety



Basic safety precautions

This vacuum cleaner is intended for household use only and NOT for commercial or industrial use.

- Only use the vacuum cleaner indoors on dry surfaces and keep the area your cleaning well lit.
- Keep fingers, hair and loose clothing from moving parts and openings whilst using the vacuum cleaner.
- This vacuum cleaner is NOT to be used by children under eight years or persons with reduced physical, sensory or

mental capabilities, unless they have been given instructions on how to use the machine or are supervised during use. (Is the age limit correct or can this be removed?)

- Any cleaning or maintenance of your vacuum cleaner should not be made by children without supervision and ensure they don't play with the vacuum cleaner.
- Only Vax recommend tools should be used with this vacuum cleaner.



Don'ts

- ✗ Don't use this vacuum cleaner if it has been dropped, damaged or left outdoors.
- ✗ Don't run over the power cord or use vacuum cleaner if the power cord or plug is damaged. Please contact our Customer Care Line on: 0844 4128 455 (Mon - Fri 8:30am to 6:30pm, Sat 9:00am to 5:00pm).
- ✗ Don't handle the plug or use the vacuum cleaner with wet hands.
- ✗ Don't pull or carry this vacuum cleaner by the power cord. Don't use the Power cord as a handle, pull the power cord around corners, sharp edges or close a door over the Power cord. Don't unplug vacuum cleaner by pulling on the power cord.
- ✗ Don't vacuum up any flammable or combustible materials (lighter fluid, petrol, kerosene etc.) or use the vacuum cleaner in an area with explosive vapours or liquid.
- ✗ Don't vacuum up hot coals, cigarette butts, matches or smoking hot burning items or use in an area where there may be harmful fluids (chlorine, bleach, and ammonia drain cleaner).
- ✗ Don't attempt to remove blockages with sharp objects as this may cause damage to your vacuum cleaner.
- ✗ Don't vacuum up hard or sharp objects such as glass, nails, screws or coins etc.
- ✗ Don't use the vacuum cleaner with incorrect voltage as this may result in damage or injury to the user. The correct voltage is listed on the ratings label.



Do's

- ✓ Turn off all controls on the vacuum cleaner before disconnecting or connecting the power cord.
- ✓ Always keep the power cord away from the brushes whilst using your vacuum cleaner. After use always wrap the power cord around the cord clips provided.
- ✓ Always make sure both the pre-motor/post motor filters are in place before use.
- ✓ Always switch off the vacuum cleaner before disconnecting or connecting the hose and accessories.
- ✓ Keep all openings clear and free from debris as this may affect the airflow/suction.
- ✓ Always replace the fuse in the plug with a 13amp fuse.
- ✓ Always protect the power cable from heated surfaces and open flames.
- ✓ Always ensure the brushbar is turned off when using your vacuum on the stairs and take extra care when positioning the vacuum cleaner on your stairs.
- ✓ Use only CE approved 13amp extension cords, non-approved extension cords may overheat. Care should be taken to arrange the extension cord as it can be a trip hazard.
- ✓ Store your vacuum cleaner in a cool, dry area. If filters have been cleaned as per user guide instructions ensure they are thoroughly dry before storing away.

Please keep instructions for further use.

Thank you for buying this Air³ Compact.

Taking care of your carpets

The Air³ Compact is designed to make vacuuming carpets regularly, as effective and efficient as possible and this user guide will help you get the most out of your vacuum cleaner.

Maintaining your carpets will ensure they keep their appearance for longer and smell fresh and clean. You've chosen carpets for your home for a reason and Vax will help you take good care of them.

Taking care of your Air³ Compact

Also inside this guide are instructions on maintaining your new vacuum cleaner, so that it's always ready when you are to tackle your carpets.

Taking care of you

We're here if you need us. Instead of taking me back to the shop, simply visit:

vax.co.uk/support or call:

(UK) **0844 412 8455** (ROI) 1-800 928 308

Monday-Friday 8.30am to 6.30pm, Saturday 9.00am to 5.00pm

Calls are charged at the UK local rate. Before you call we'll need you to have the following information to hand:

Your Machine
Your Proof of Purchase or
Warranty registration code

Alternatively, you can write to us at:

Vax Ltd., Kingswood Road, Hampton Lovett, Droitwich, Worcestershire, WR9 0QH, UK



You're home.™



Let us know what you think @VaxUK

Contents

Let's talk safety

Getting to know your machine

Getting started

Using your machine

Taking care of your machine

Let's talk technical

What to do if it goes wrong

Getting in touch

Notes

Air³ Compact U86-AC-B

Included with your machine

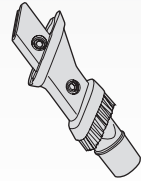

3-in-1 crevice tool,
dusting brush and
upholstery tool

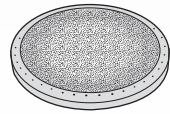

Pre-motor filter

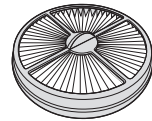

Post-motor filter

Getting to know your machine

Handle

Dirt container
release button

Carry handle

Power on/off button

Inner cyclones

Dirt container

Post-motor filter cover

Brushbar blockage
indicator

Rotating brushbar

Wand release button

Brushbar on/off button

Quick release
cord wrap

Quick release
cord wrap

Stretch hose

Wheels

Technical Specification

Name **Air³ Compact**

Code **U86-AC-B**

Part Number **1-1-133591-00**

Voltage **220-240V ~50Hz**

Wattage **1000W**

Cord length **6m**

Weight **4.0kg**

Hose **1.5m**

Consumables & Accessories

Pre-motor filter (Type 58)*

1-1-131167-00

HEPA Post-motor filter (Type 83)*

1-1-133592-00

Belt Kit (Type 21)

1-1-133593-00

3-in-1 tool (Type 1)

1-1-129167-00

Subject to technical change without notice.

*To purchase consumables and accessories, please visit vax.co.uk

Getting started

PLEASE READ 'LET'S TALK SAFETY' AT THE BEGINNING BEFORE USE

Assembling your upright

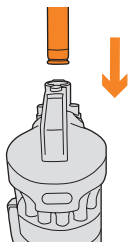

Remove all packaging. Insert the handle.

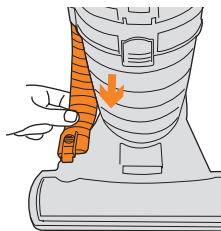

Attach the hose end to the floorhead ensuring it clicks into place. (All accessories can be used by either attaching them to the handle or the hose).

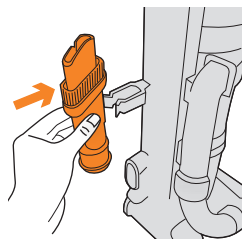

Place your tools onto the product.

Before you begin cleaning

WARNING: Always switch off and unplug the vacuum cleaner before connecting or disconnecting the hose/attachments, or removing and emptying the dirt container.

WARNING: Always switch off the brushbar before using any accessories/hose/telescopic extension tube.

IMPORTANT: The vacuum cleaner is equipped with a thermal cut-out. If for any reason the vacuum cleaner does overheat the thermostat will automatically turn the vacuum cleaner off. If this happens, switch the vacuum cleaner off and unplug from electrical socket. Remove and empty the dirt container also check the vacuum cleaner for blockages. Allow the vacuum cleaner to cool for approximately 1 hour (if you have cleaned the filters please wait 24 hours for the filters to fully dry before putting back into the vacuum machine).

IMPORTANT: For best cleaning results filters require cleaning at least every 3 months.

IMPORTANT: If the vacuum cleaner is blocked, switch off and unplug before removing the blockage.

Using your machine

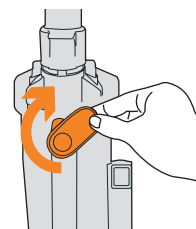

Twist the cord holder to release the cord.

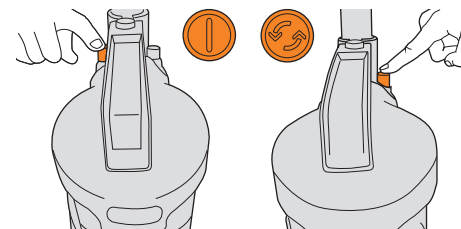

Plug in your machine and turn it on.

To activate brushes, press the brushbar on/off button at the top of the machine.
Brushbar on – carpets.
Brushbar off – hard floors.

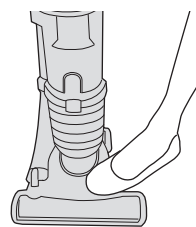

Place your foot on the base of the vacuum and pull backwards to recline the unit.

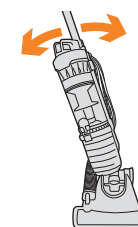

Twist the handle to manoeuvre under and around furniture.

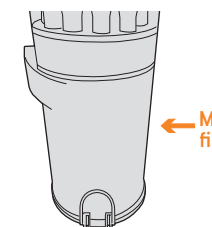

Don't over fill the container to avoid clogging your filters.

Hose

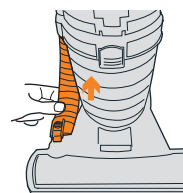

Remove hose.

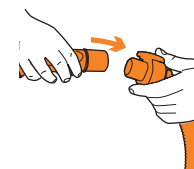

Attach required tool to the hose.

Extension tube

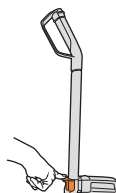

Remove extension tube.

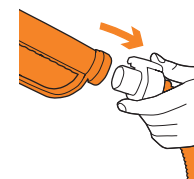

Attach hose to extension tube.

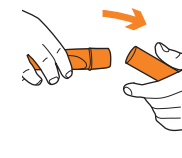

Attach accessory to extension tube.



IMPORTANT: Hold vacuum cleaner when using hose or extension tube for above floor cleaning.



The 3-in-1 tool can be attached to the tube or directly to the hose.

Switch off the brushbar before using any accessories/hose/telescopic extension tube.

Emptying and cleaning the dirt container

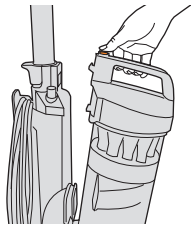

Press dirt container release button to remove the dirt container.

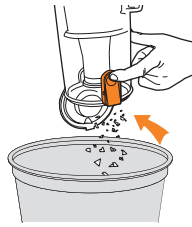

Hold dirt container over a bin and press dirt release button to open, allowing dirt to fall out.

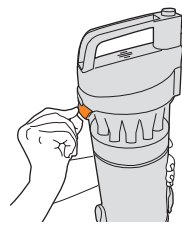

Unclip the dirt container lid to open.



Lift lid to access inner cyclones.

Cleaning the pre-motor filter

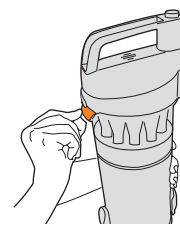

Unclip the dirt container lid to open.



Lift lid to access filter.

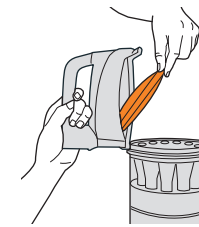

Remove filter.

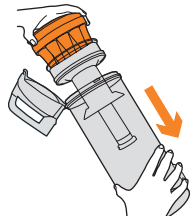

Lift out the inner cyclones.



Hold cyclones/separator over bin and tap to remove dirt and debris.

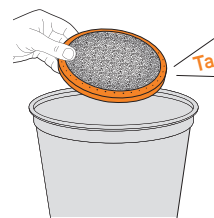

Tap filter clean.

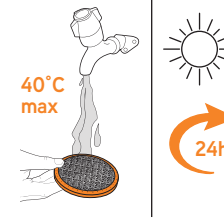

Wash in water 40°C max and leave for at least 24 hours or until dry before replacing into the machine.

Cleaning the HEPA post-motor filter

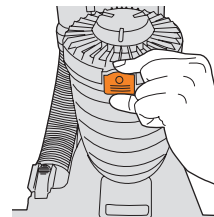

Remove the post-motor filter by unclipping it from the body of the vacuum .



Tap filter clean.



WARNING

Always switch off and unplug the vacuum cleaner from the electrical socket before assembling, opening or emptying the dirt container, or before connecting/disconnecting the attachments.

IMPORTANT: For best cleaning results filters require cleaning at least every three months.

Do not use your vacuum cleaner without all of the filters in place.

IMPORTANT: The motor is equipped with a thermal cut-out. If for any reason the unit should overheat, the thermostat will automatically turn the unit off. For further help go to the 'Why to do if it goes wrong' page.

Re-setting the brushbar

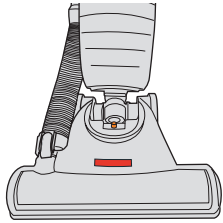

A **RED** light will indicate a jammed brushbar.

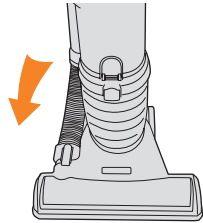

Push the machine into the upright position to automatically reset the brushbar.

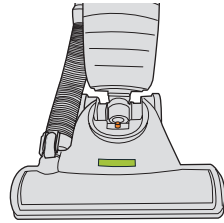

A **GREEN** light indicates no blockages in the brushbar.

IMPORTANT: If the brushbar, air inlet, hose or telescopic tube is blocked, switch off the vacuum cleaner and remove the blockage(s) before re-starting the vacuum cleaner.

Removing debris from the brushbar

If the light continues to flash red after resetting, the brushbar may still be blocked. Using a pair of scissors, cut through any threads or hairs caught around the brushbar. To access brushbar:

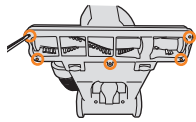

Switch off machine then unplug. Place the vacuum cleaner on the floor and remove the 5 screws on the back of the brushbar cover.

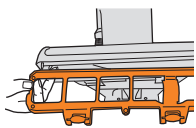

Remove the brushbar cover.

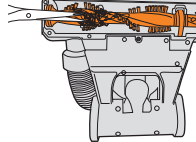

Using a pair of scissors cut any hair or debris free from around the brushbar. Screw the brushbar cover back on.

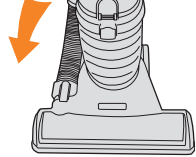

Push the machine into the upright position to automatically reset the brushbar.

IMPORTANT: Always switch off your vacuum cleaner at the mains before carrying out any maintenance.

Changing the belt

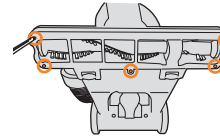

Switch off your vacuum cleaner at the main socket and unplug. Place the vacuum cleaner on the floor and remove the 5 screws on the back of the brushbar cover.

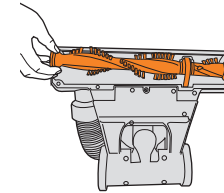

Remove the brushbar cover and lift the brushbar from the machine to access the belt.

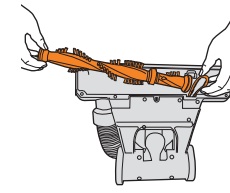

Lift the belt and slide the belt off the brushbar.

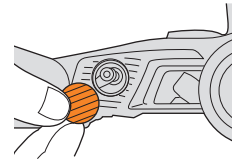

Unscrew round access panel and remove.

Note: To remove debris from the brushbar see 'Removing debris from the brushbar' opposite.

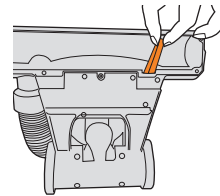

Remove the belt from the metal spindle through access panel located inside the machine and replace with the new belt.

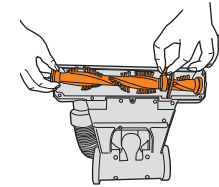

Once the belt has been replaced, insert the brushbar back onto the vacuum.

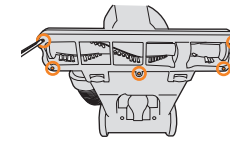

Attach the brushbar cover by screwing back into place.

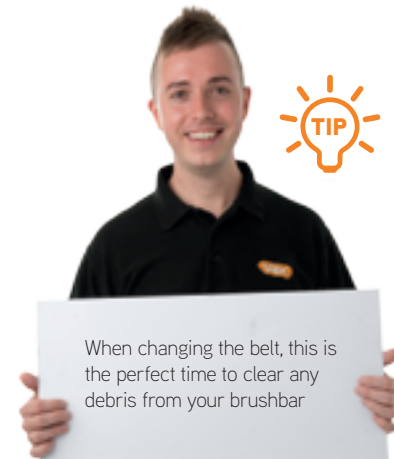
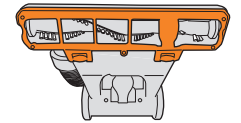

When changing the belt, this is the perfect time to clear any debris from your brushbar

Problem

Solution

Why does my vacuum cleaner have no power?

- The plug may not be fully pushed into the electrical socket.
- Check the fuse in the plug if this needs replacing, always replace with a 13amp fuse.
- The motor thermostat may have tripped. If this has happened, unplug the vacuum cleaner. Remove and empty the dirt container and check the hose for blockages. Clean the filters and allow the vacuum cleaner to cool for approximately 1 hour (if you have washed the filters you will need to wait 24 hours for the filters to fully dry before putting them back into the vacuum cleaner).

Why won't the vacuum cleaner turn on?

- There may be a blockage in the hose. Please remove the hose from the vacuum cleaner, check and clear any blockages
- Empty the dirt container and clean filters. Go to the 'Taking care of your machine' pages.
- The brushbar may not be turning. Go to 'My brushbar isn't turning?' below.
- If the accessory/tool will not pick up, check and clear any blockages.

My brushbar isn't turning?

- The brushbar may not be switched on, please check the brushbar on/off switch.
- If the vacuum cleaner is not reclined the brushbar will automatically switch off.
- If the red light is flashing the brushbar may be jammed. Clear any blockages for further help go to the 'Let's talk technical' pages.
- To check the belt, go to 'Changing the belt' on the 'Let's talk technical' pages.

My vacuum cleaner is making an excessive noise?

- If the vacuum cleaner is making a whistling noise, please remove the dirt container open the bottom and clean the seals. Replace the dirt container and retry.
- If there is an air sucking noise from the top of the dirt container, this would indicate a blockage in the machine. Go to 'Why won't the vacuum cleaner pick up?' above.

Warning: To reduce the risk of personal injury, unplug the vacuum cleaner before performing maintenance /troubleshooting checks.



* Calls are charged at the UK local rate. Please make a note of the serial number and model number of the vacuum cleaner before calling.

Don't forget your accessories!

Order at: www.vax.co.uk/spares-and-solutions

Pro cleaning kit 1-1-133326-00

All our best tools all in one kit that makes cleaning your home quicker, easier and with even better results. We've taken care of cleaning all of the hard to reach areas such as on top of cupboards and in between blinds to the dust that collates behind and within the radiator.



TurboTool 1-1-126261-00

A TurboTool for your vacuum cleaner. Use the TurboTool for vacuuming your stairs, upholstery and car interiors. It's great for picking up stubborn pet hair.



Stretch hose 1-1-132129-00

A stretch hose for your vacuum cleaner. This hose makes it easy to clean right to the top of your staircase, leaving the machine safely at the bottom.





Vax Ltd., Kingswood Road, Hampton Lovett, Droitwich, Worcestershire, WR9 0QH, UK
email: info@vax.co.uk website: vax.co.uk

Version 2.0



EEC Statement of Compliance: Manufacturer/EEC importer: Vax Limited, hereby on our own responsibility, declare that the U86-AC series is manufactured in compliance with the following Directives: **Safety:** 2006/95/EC Low Voltage Directive. **EMC:** 2004/108/EC Electromagnetic Compatibility Directive



Waste electrical products should not be disposed of with household waste. Please recycle where facilities exist. Check with your Local Authority or retailer for recycling advice.