



You're home.™

2 year
guarantee

Impact 504 Upright

Let's get started



U86-IAe Series

vax.co.uk

Let's talk safety



Basic safety precautions

Please keep instructions for further use and use only as instructed in this guide

This vacuum cleaner is intended for household use only and NOT for commercial or industrial use

- Only use the vacuum cleaner indoors on dry surfaces and keep the area you're cleaning well lit
- Keep fingers, hair and loose clothing away from moving parts and openings whilst using the vacuum cleaner
- This appliance can be used by children aged from 8 years and above and persons with reduced physical, sensory or mental capabilities or lack of experience and knowledge if they have been given supervision or instruction concerning use of the appliance in a safe way and understand the hazards involved. Children shall not play with the appliance. Cleaning and user maintenance shall not be made by children without supervision
- Only Vax recommended tools should be used with this vacuum cleaner.



Don'ts

- ✗ Don't use this vacuum cleaner if it has been dropped, damaged or left outdoors
- ✗ Don't run over the power cord or use vacuum cleaner if the power cord or plug is damaged. Please contact our Customer Care Line on: 0844 4128 455 (Mon-Fri: 8.30am to 6.30pm, Sat: 9.00am to 5.00pm)
- ✗ Don't handle the plug or use the vacuum cleaner with wet hands
- ✗ Don't pull or carry this vacuum cleaner by the power cord. Don't use the power cord as a handle, pull the power cord around corners, sharp edges or close a door over the power cord. Don't unplug vacuum cleaner by pulling on the power cord
- ✗ Don't vacuum up any flammable or combustible materials (lighter fluid, petrol, kerosene etc.) or use the vacuum cleaner in an area with explosive vapours or liquid
- ✗ Don't vacuum up hot coals, cigarette butts, matches or smoking hot burning items or use in an area where there may be harmful fluids (chlorine, bleach, and ammonia drain cleaner)
- ✗ Don't attempt to remove blockages with sharp objects as this may cause damage to your vacuum cleaner
- ✗ Don't vacuum up hard or sharp objects such as glass, nails, screws or coins etc
- ✗ Don't use the vacuum cleaner with incorrect voltage as this may result in damage or injury to the user. The correct voltage is listed on the ratings label.



Do's

- ✓ Turn off all controls on the vacuum cleaner before disconnecting or connecting the power cord
- ✓ Always keep the power cord away from the brushes whilst using your vacuum cleaner. After use always wrap the power cord around the cord clips provided
- ✓ Always make sure both the pre-motor/post motor filters are in place before use
- ✓ Always make sure the brushbar is set to hard floor when using your vacuum on the stairs and take extra care when positioning the vacuum cleaner on the stairs
- ✓ Always switch off the vacuum cleaner before disconnecting or connecting the hose and accessories
- ✓ Keep all openings clear and free from debris as this may affect the airflow/suction
- ✓ Always replace the fuse in the plug with a British 13amp fuse. Always protect the power cable from heated surfaces and open flames
- ✓ Use only CE approved 13amp extension cords, non-approved extension cords may overheat. Care should be taken to arrange the extension cord as it could be a trip hazard
- ✓ Store the vacuum cleaner in a cool, dry area. If filters have been cleaned as per user the guide instructions ensure they are thoroughly dry before storing away.

Thank you for buying this Impact 504.

Taking care of your carpets

The Impact 504 is designed to make vacuuming carpets regularly, as effective and efficient as possible and this user guide will help you get the most out of your machine.

Maintaining your carpets will ensure they keep their appearance for longer. You've chosen carpets for your home for a reason and Vax will help you take good care of them.

Taking care of your Impact 504

Also inside this guide are instructions on maintaining your new machine, so that it's always ready when you are to tackle your carpets.

Taking care of you

We're here if you need us. Instead of taking me back to the shop, simply visit:

vax.co.uk/support or call:

(UK) **0844 412 8455** (ROI) 1-800 928 308

Monday-Friday 8.30am to 6.30pm, Saturday 9.00am to 5.00pm

Calls are charged at the UK local rate. Please make a note of the serial number and model number of the product before calling.

Alternatively, you can write to us at:

Vax Ltd., Kingswood Road, Hampton Lovett, Droitwich, Worcestershire, WR9 0QH, UK



You're home.™



Let us know what you think @VaxUK

Contents





- Let's talk safety
- Getting to know your machine
- Getting started
- Using your machine
- Taking care of your machine
- Let's talk technical
- Accessories
- What to do if it goes wrong
- Getting in touch

Initial Setup for normal operation

- Use the base accessories.
 - Shortest hose
 - Extension tube set to shortest practicable length.
- Clean filters installed.
- Dust receptacle empty.
- All Bleeds must be closed.
- Variable Power set to Maximum.
- Floor heads/tools set to Carpet Mode for carpet cleaning.
- Mechanical Agitation turned ON for carpet cleaning.
- Floor heads/tools set to Hard Floor Mode for hard floor cleaning.
- Mechanical Agitation turned OFF for hard floor cleaning.

Impact 504 Upright

Included with your machine

-  3 in 1 crevice, dust and upholstery tool
-  Pre-motor filter
-  Post-motor filter
-  Hard floor adaptor

+ Impact 504 Pet

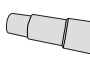
-  TurboTool
-  Tool connector

+ Impact 504 Reach

-  3.2m stretch hose

Getting to know your machine



Technical Specification

Name **Impact 504**
Voltage **220-240V-50Hz**
Wattage **700W**
Cord length **8-10m**
Weight **6.8kg**

Accessories & Consumables

Filter Kit (Type 98)*
1-1-134233-00
Belt Kit (Type 1)*
1-1-130669-01

Subject to technical change without notice.

*To purchase consumables and accessories, please visit vax.co.uk

PLEASE READ 'LET'S TALK SAFETY' AT THE BEGINNING BEFORE USE

Assembling your upright

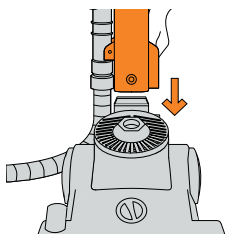

Insert the back panel into the floorhead

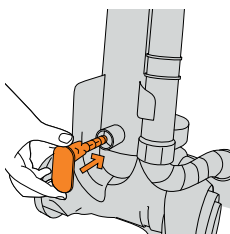

Insert the lower quick release cord hook into the hole at the bottom of the back panel

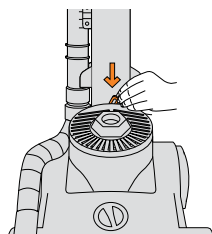

Now take the small clip and push it down between the post motor filter cover and back panel, over the quick release cord hook to lock into place

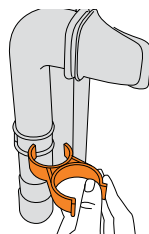

Attach hose clip to the air inlet tube

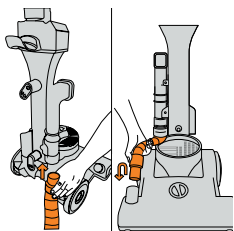

Insert the short end of the hose into the tube at the back of the machine and connect the hose end to the floorhead

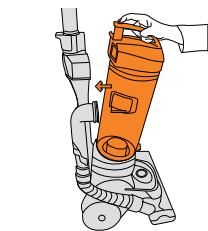

Place the dirt container onto the machine and push until it clicks into place

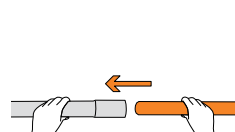

Insert the extension tube into the handle

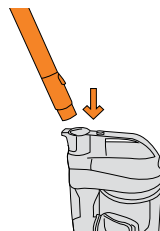

Push handle into the top of the machine until it clicks into place

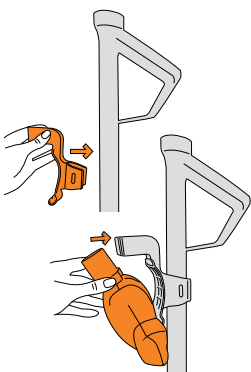

Push TurboTool holder on to the handle and clip TurboTool into position

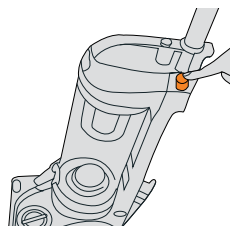

Plug in and switch on your machine

Before you begin cleaning

- Always switch off and unplug the vacuum cleaner before connecting or disconnecting the hose/attachments, or removing and emptying the dirt container
- The vacuum cleaner is equipped with a thermal cut-out. If for any reason the vacuum cleaner does overheat the thermostat will automatically turn the vacuum cleaner off. If this happens, switch the vacuum cleaner off and unplug from electrical socket. Remove and empty the dirt container also check the vacuum cleaner for blockages. Allow the vacuum cleaner to cool for approximately 1 hour (if you have cleaned the filters please wait 24 hours for the filters to fully dry before putting back into the vacuum)
- Filters require cleaning at least every 3 months
- If the vacuum cleaner is blocked, switch off and unplug before removing the blockage
- When using the accessories always make sure the brushbar is switched to the off position

IMPORTANT: When the vacuum cleaner is stood in the upright position or when using on stairs and the hose/tools, the brushbar height adjust dial must be set to hard floor

How to use

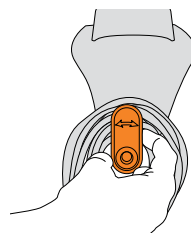

Twist the quick release cord hook to release the power cord

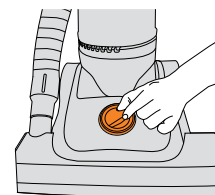

Choose your desired carpet height or hardfloor setting

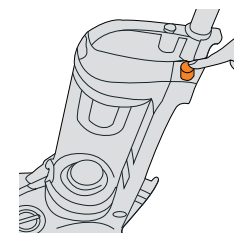

Plug in your machine and push ON/OFF button to switch on



Don't over fill the dirt container to avoid clogging your filter

Using the Hard Floor Adaptor

Apply the Hard Floor Adaptor for optimum results on hard floors. The Hard Floor Adaptor can be used on any floor setting.

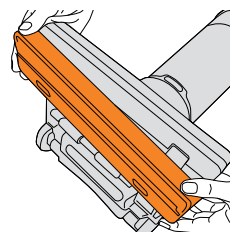

Lie vacuum cleaner on its back exposing brush bar

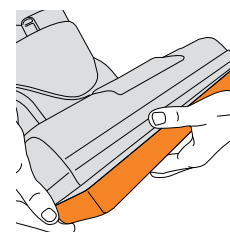

Align Hard Floor Adaptor with base of vacuum cleaner, push until its clicks into place



To ensure the Hard Floor Adaptor is correctly fitted, the wheels should be towards the back of the floor tool when attached to vacuum cleaner.

Using your machine

Taking care of your machine

Using accessories

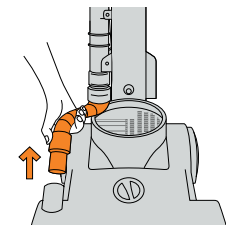

Remove hose end from the floorhead

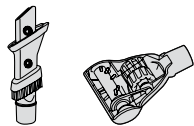

Choose an accessory



Attach accessory adapter to hose end

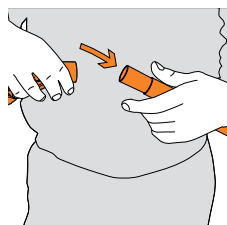

If required use tool connector

Extension tube

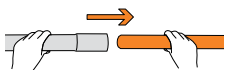

Remove extension tube from inside the handle

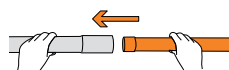

Turn the extension tube and attach to the handle

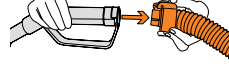

Attach hose to the top of the handle

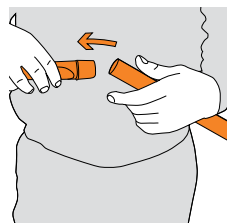

Push accessory on to the extension tube

Using your machine on the stairs

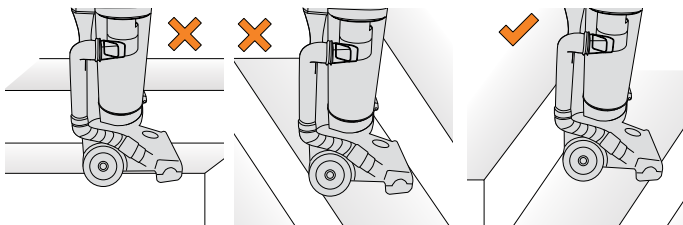

Hold the machine to steady when using on the stairs. Always make sure the brushbar is overhanging the stair tread during use

! WARNING

This machine has a constantly rotating brushbar. When using the machine on stairs, ensure the height adjuster dial is set to hard floor and the brushbar is overhanging the stair tread (as pictured). Always take extra care when cleaning stairs.

Emptying and cleaning the dirt container

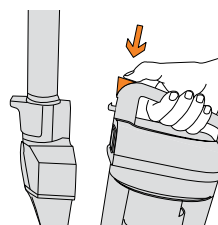

Press dirt container release button to remove the dirt container

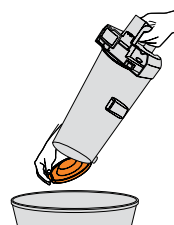

Hold dirt container over a bin and unclip the lock on the bottom of the dirt container, allowing the dirt to fall out

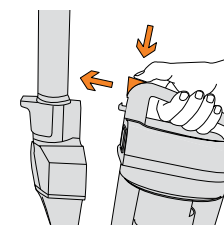

Close the base of the dirt container, align the dirt container base back onto the machine and push until it clicks back into place

Cleaning the pre-motor filter

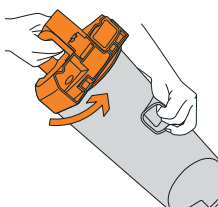

Turn the dirt container lid anti-clockwise to remove

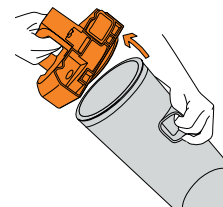

Lift the dirt container lid to remove



Remove the filter

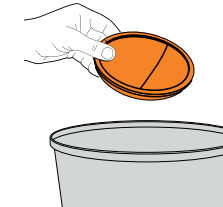

Tap the filter over a bin to release and dirt

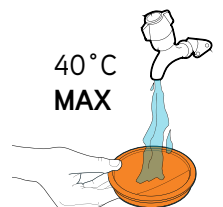

Wash the filter under running water (40°C max)



Leave to fully dry for a least 24 hours before placing back in the machine

TIP

Wash filters with warm water (MAX 40°C) at least every 3 months.

Cleaning the shroud

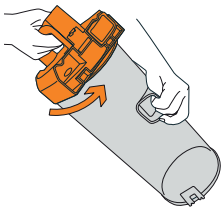

Turn the dirt container lid anti-clockwise and lift to remove

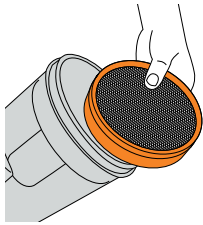

Remove the pre-motor filter to allow access to the shroud

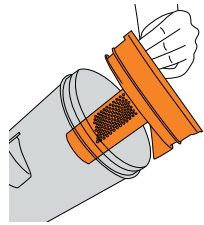

Tap the shroud over a bin to remove dirt and debris

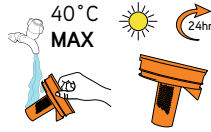

Wash the shroud under running water and leave to fully dry before placing back into the machine

Removing debris from the brushbar

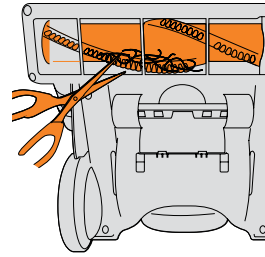

Switch off your vacuum cleaner at the main socket. Using a pair of scissors cut any hair or debris free from around the brushbar

Cleaning the post-motor filter

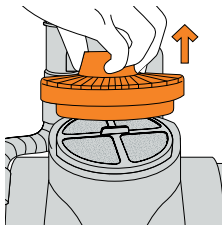

Twist post motor filter cover anti-clockwise and lift to remove

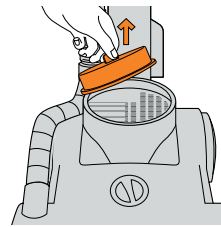

Remove the filter



Tap the post motor filter over a bin to remove any dirt or debris

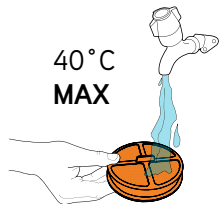

Wash the filter under running water (40°C max)

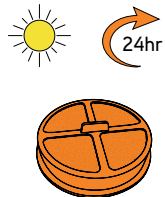

Leave to dry for 24 hours and then replace before using your vacuum

Removing blockages from the TurboTool

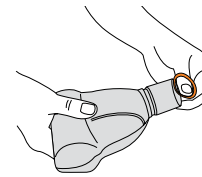

Remove the rubber ring

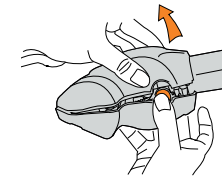

Push both buttons to open the TurboTool

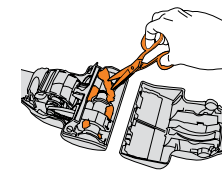
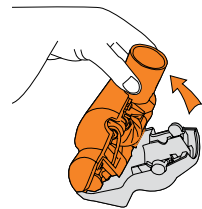

Using a pair of scissors, cut any hair or debris free from around the brushes



Changing the belt

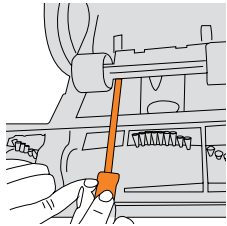

Switch off your vacuum cleaner at the main socket and unplug. Unclip the 2 small wheels from the base of the vacuum to enable you to remove the screws from behind. Note: The screw for the height adjuster dial is located here

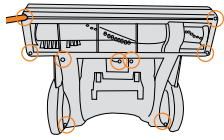

Remove the 9 screws from the base of the floorhead cover



Remove the floorhead cover

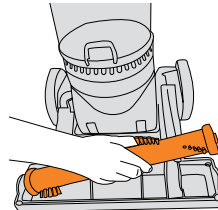

Lift the brushbar from the machine to remove the belt. Note: To remove debris from the brushbar

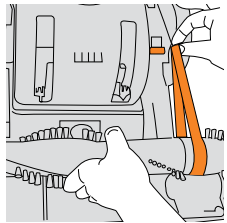

Place the brushbar through the belt and hook the belt onto the metal spindle

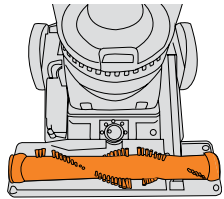

Once the belt has been replaced attach the brushbar back onto the vacuum

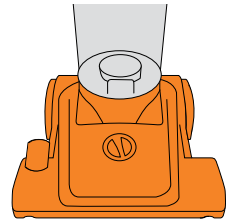

Replace the floorhead cover, 2 small wheels and height adjuster dial by screwing back into place

Don't forget your accessories!

Order at: www.vax.co.uk/spares-and-solutions

TurboTool

Use the TurboTool for vacuuming your stairs, upholstery and car interiors. It's great for picking up stubborn pet hair.



3 in 1 Tool

1-1-129167-00

3-in-1 tool includes crevice tool for awkward areas and corner, dusting brush for areas such as skirting and an upholstery tool for cleaning sofas, curtains, chair seats and car interiors.



Flexi Crevice Tool

1-1-131393-00

A handy long, flexible tool for getting far behind and around furniture.



Fur and Fluff Tool

1-1-131392-00

Specifically designed to remove extra stubborn pet hair from upholstery, furniture and carpets.



Problem

Solution

There is an accessory missing

- Check the 'This pack contains' panel on the box to make sure the part is included with your machine

Why does my vacuum cleaner have no power?

- The plug may not be fully pushed into the electrical socket
- Check the fuse in the plug if this needs replacing, always replace with a British 13amp fuse
- The motor thermostat may have tripped. If this has happened, unplug the vacuum cleaner. Remove and empty the dirt container and check the hose for blockages.
- Clean the filters and allow the vacuum cleaner to cool for approximately 1 hour (if you have washed the filters you will need to wait 24 hours for the filters to fully dry before putting them back into the vacuum cleaner)

Why won't the vacuum cleaner pick up?

- There may be a blockage in the hose. Please remove the hose from the vacuum cleaner, check and clear any blockages
- Empty the dirt container and clean filters. Go to the 'Taking care of your machine'
- The brushbar may not be turning. Go to my brushbar isn't turning below
- If the accessory/tool will not pick up, check and clear any blockages

My brushbar isn't turning?

- The brushbar may be clogged, check the brushbar and clear any hair or debris Go to 'Let's talk technical'
- The belt may be broken, Go to 'Let's talk technical'

Warning: To reduce the risk of personal injury, unplug the vacuum before performing maintenance /troubleshooting checks.

It's quick and easy to register for your **FREE**

2 year guarantee

Online at: vax.co.uk/guarantees

Please retain your original receipt for proof of purchase.

we're here if you need us

Online vax.co.uk/support

Call: (UK) **0844 412 8455** (ROI) 1-800 928 308

Monday-Friday 8.30am to 6.30pm, Saturday 9.00am to 5.00pm *

Alternatively, you can write to us at:

Vax Ltd., Kingswood Road, Hampton Lovett, Droitwich, Worcestershire, WR9 0QH, UK

* Calls are charged at the UK local rate. Please make a note of the serial number and model number of the vacuum cleaner before calling.



You're home.™



@VaxUK

Vax Ltd., Kingswood Road, Hampton Lovett, Droitwich, Worcestershire, WR9 0QH, UK
email: info@vax.co.uk website: vax.co.uk

Version 1.0



EEC Statement of Compliance: Manufacturer/EEC importer: Vax Limited, hereby on our own responsibility, declare that the U86-IAe Series is manufactured in compliance with the following Directives:

Safety: 2006/95/EC Low Voltage Directive. **EMC:** 2004/108/EC Electromagnetic Compatibility Directive.



Waste electrical products should not be disposed of with household waste. Please recycle where facilities exist. Check with your Local Authority or retailer for recycling advice.