



You're home.™

2 year
guarantee

Impact 102

Let's get started



C86-TOe Series

vax.co.uk

Let's talk safety



Basic safety precautions

This vacuum cleaner is intended for household use only and NOT for commercial or industrial use.

- Only use the vacuum cleaner indoors on dry surfaces and keep the area you're cleaning well lit.
- Keep fingers, hair and loose clothing away from moving parts and openings whilst using the vacuum cleaner.
- This vacuum cleaner can be used by children aged from 8 years and above and persons with reduced physical, sensory or mental capabilities or lack of

experience and knowledge if they have been given supervision or instruction concerning use of the vacuum cleaner in a safe way and understand the hazards involved. Children shall not play with the vacuum cleaner. Cleaning and user maintenance shall not be made by children without supervision.

- Only Vax recommend tools and accessories should be used with this vacuum cleaner.



Don'ts

- ✗ Don't use this vacuum cleaner if it has been dropped, damaged or left outdoors or the filters not in their original place.
- ✗ Don't run over the power cord or use vacuum cleaner if the power cord or plug is damaged. Please contact our Customer Care Line on: 0844 4128 455 (Mon-Fri 8.30am-6.30pm Sat 9.00am-5.00pm).
- ✗ Don't handle the plug or use the vacuum cleaner with wet hands.
- ✗ Don't pull or carry this vacuum cleaner by the power cord. Don't use the power cord as a handle, pull the power cord around corners, sharp edges or close a door over the power cord. Don't unplug vacuum cleaner by pulling on the power cord.
- ✗ Don't lift or carry the vacuum cleaner by the dirt container handle.
- ✗ Don't vacuum up any flammable or combustible materials (lighter fluid, petrol, kerosene etc.) or use the vacuum cleaner in an area with explosive vapours or liquid.
- ✗ Don't vacuum up hot coals, cigarette butts, matches or smoking hot burning items or use in an area where there may be harmful fluids (chlorine, bleach, and ammonia drain cleaner).
- ✗ Don't attempt to remove blockages with sharp objects as this may cause damage to your vacuum cleaner.
- ✗ Don't vacuum up hard or sharp objects such as glass, nails, screws or coins etc.
- ✗ Don't use the vacuum cleaner with incorrect voltage as this may result in damage or injury to the user. The correct voltage is listed on the ratings label.



Do's

- ✓ Turn off all controls on the vacuum cleaner before disconnecting or connecting the power cord.
 - ✓ Always make sure both the pre-motor/post-motor filters are in place before use.
 - ✓ Always switch off the vacuum cleaner before disconnecting or connecting the hose and accessories.
 - ✓ Keep all openings clear and free from debris as this may affect the airflow/suction.
 - ✓ Always replace the fuse in the plug with a British 13amp fuse. Always protect the power cable from heated surfaces and open flames.
 - ✓ Take extra care when positioning and using the vacuum cleaner on the stairs.
 - ✓ Use only CE approved 13amp extension cords, non-approved extension cords may overheat. Care should be taken to arrange the extension cord as it can be a trip hazard.
 - ✓ Store your vacuum cleaner in a cool, dry area. If filters have been cleaned as per user guide instructions ensure they are thoroughly dry before storing away.
- Please keep instructions for further use.**

Thank you for buying this Impact 102.

Taking care of your carpets

The Impact 102 is designed to make vacuuming carpets and hard floors regularly, as effective and efficient as possible and this user guide will help you get the most out of your machine.

Maintaining your carpets and hard floors will ensure they keep their appearance for longer. You've chosen carpets and hard floors for your home for a reason and Vax will help you take good care of them.

Taking care of your Impact 102

Also inside this guide are instructions on maintaining your new machine, so that it's always ready when you are to tackle your carpets and hard floors.

Taking care of you

We're here if you need us. Instead of taking me back to the shop, simply visit:

vax.co.uk/support or call:

(UK) **0844 412 8455** (ROI) 1-800 928 308

Monday-Friday 8.30am to 6.30pm, Saturday 9.00am to 5.00pm

Calls are charged at the UK local rate. Please make a note of the serial number and model number of the product before calling.

Alternatively, you can write to us at:

Vax Ltd., Kingswood Road, Hampton Lovett, Droitwich, Worcestershire, WR9 0QH, UK



You're home.™



Let us know what you think @VaxUK

Contents

- Let's talk safety
- Getting to know your machine
- Getting started
- Using your machine
- Taking care of your machine
- Let's talk technical
- What to do if it goes wrong
- Getting in touch
- Accessories
- Notes

Initial Setup for normal operation

- Use the base accessories.
 - Shortest hose
 - Extension tube set to shortest practicable length.
- Clean filters installed.
- Dust receptacle empty.
- All Bleeds must be closed.
- Floor heads/tools set to Carpet Mode for carpet cleaning.
- Mechanical Agitation turned ON for carpet cleaning.
- Floor heads/tools set to Hard Floor Mode for hard floor cleaning.
- Mechanical Agitation turned OFF for hard floor cleaning.

Impact 102

Included with your machine

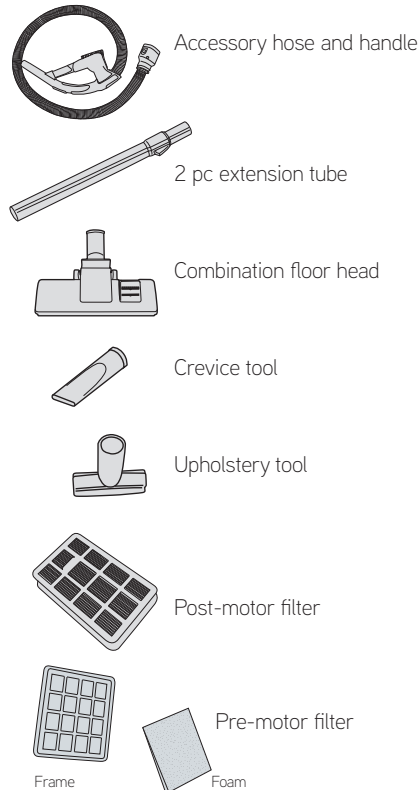

+ Impact 102 Pet

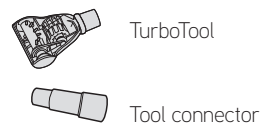

Getting to know your machine

Dirt container release button

Dirt container handle

Shroud

Hose entry point



Floor head parking slot

Carry handle

Post-motor filter release button

Cord rewind button

Post-motor filter cover

On/off button

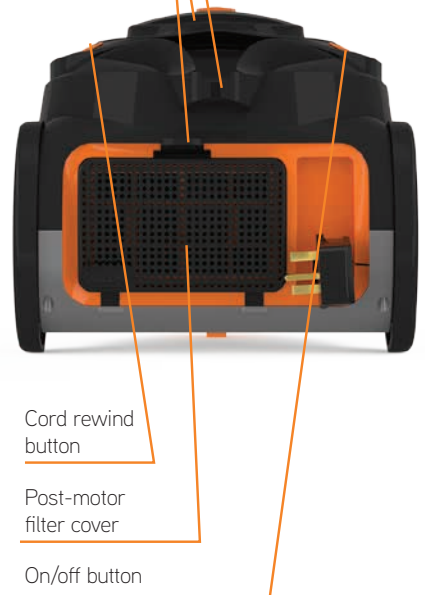

Technical Specification

Name **Impact 102**
Voltage **220-240-50Hz**
Wattage **700watts**
Cord Length **5m**
Weight **4.9kg**

Accessories & Consumables

Filter Kit (Type 109) 1-1-134393-00	Crevice Tool (Type 10) 1-9-128020-00
TurboTool (Type 6) 1-1-134419-00	Combination Floor Tool (Type 6) 1-1-134330-00
Tool Connector (Type 1) 1-1-133838-00	Upholstery tool (Type 4) 1-9-128019-00

Getting started

PLEASE READ 'LET'S TALK SAFETY' AT THE BEGINNING BEFORE USE

Before you begin cleaning

IMPORTANT: The vacuum cleaner is equipped with a thermal cut-out. If for any reason the vacuum cleaner does overheat the thermostat will automatically turn the vacuum cleaner off. If this happens, switch the vacuum cleaner off and unplug. Remove and empty the dirt container also check the vacuum cleaner for blockages. Allow the vacuum cleaner to cool for approximately 1 hour (if you have cleaned the filters please wait 24 hours for the filters to fully dry before putting back into the machine).

For best cleaning results clean the pre-motor filter every time the dirt container is emptied and replace the post-motor filter every 12 months.

If the vacuum cleaner is blocked, switch off and unplug before removing the blockage.

Assembling your upright

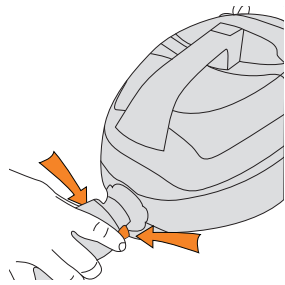

Press both buttons at end of hose and insert into hose entry point.

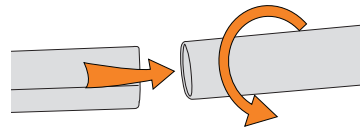

Insert hose grip into extension tube.

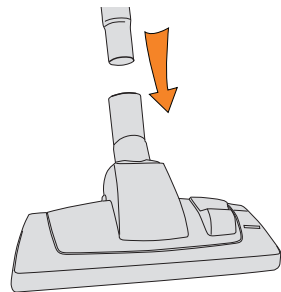

Insert the other end of the telescopic tube into the floor head.



WARNING

Always switch off the vacuum cleaner before connecting or disconnecting the hose / attachments, or removing and emptying the dirt container.

Using your machine

Important: The base of the vacuum cleaner should always be positioned flat on the floor when starting and in use.

WARNING: When unwinding the power cord do not pull further than the yellow marker.

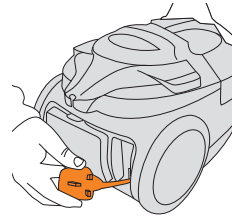

Unwind the power cord. Do not pull further than the yellow marker.

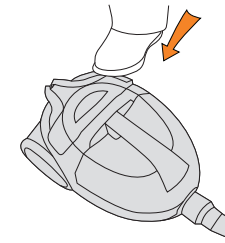

Plug into mains and push the on/off button to turn your machine on.

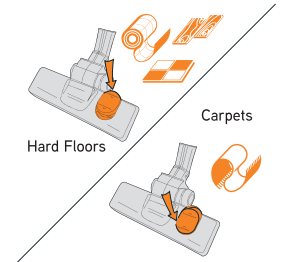

For use on carpets, click rocker switch forward. For use on hard floors click rocker switch back.



Raise brushes for carpets.

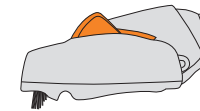

Lower brushes for hard floors.

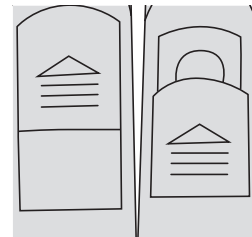

Slide vent cover on hose grip open to reduce suction if required.



TIP

Brushes on the floor head should be visible when using on hard floors.

Using your machine

Carrying your machine

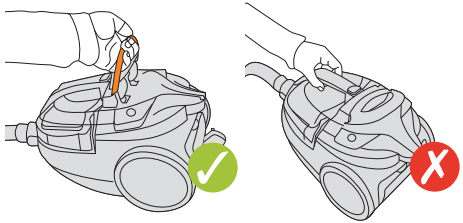

Always use the carry handle to lift and carry the machine. Do not use the dirt container handle.

Using your tools



Choose an accessory and push onto the telescopic extension tube or hose.

Attach accessory to hose end. If required use tool connector.

Taking care of your machine

IMPORTANT: Unplug and switch off vacuum cleaner before performing maintenance or troubleshooting checks.

Emptying and cleaning the dirt container

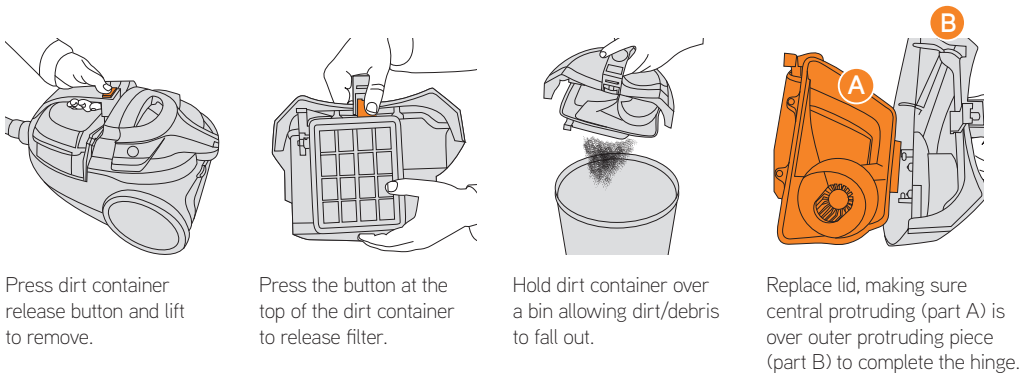

Press dirt container release button and lift to remove.

Press the button at the top of the dirt container to release filter.

Hold dirt container over a bin allowing dirt/debris to fall out.

Replace lid, making sure central protruding (part A) is over outer protruding piece (part B) to complete the hinge.

Taking care of your machine

Cleaning the shroud

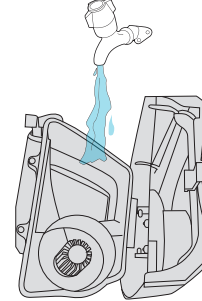

Rinse both dirt container and shroud under water (Max 40°C). Leave to dry for 24 hours or until fully dry before placing back in the machine.



! WARNING

Don't over fill the dirt container to avoid blocking the air flow through the vacuum cleaner.

IMPORTANT: The shroud cannot be removed from the dirt container.

Cleaning the pre-motor filter

Warning: Do not wash the pre-motor filter in the washing machine or dishwasher.

For best cleaning results clean the pre-motor filter every time the dirt container is emptied.

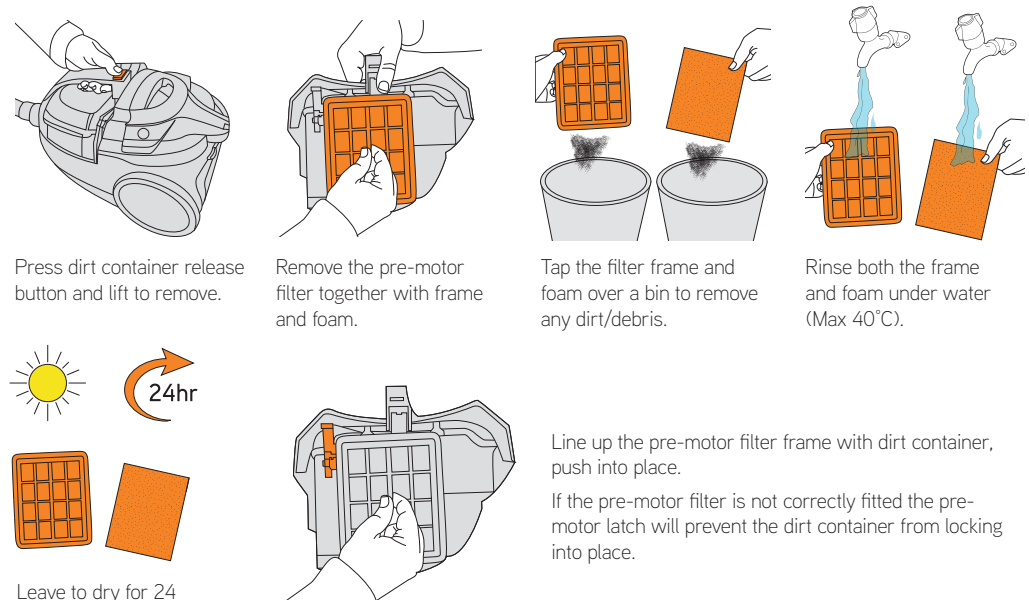

Press dirt container release button and lift to remove.

Remove the pre-motor filter together with frame and foam.

Tap the filter frame and foam over a bin to remove any dirt/debris.

Rinse both the frame and foam under water (Max 40°C).

24hr

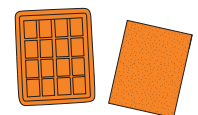

Leave to dry for 24 hours or until fully dry before placing back in the machine.

Line up the pre-motor filter frame with dirt container, push into place.

If the pre-motor filter is not correctly fitted the pre-motor latch will prevent the dirt container from locking into place.

Cleaning the post-motor filter

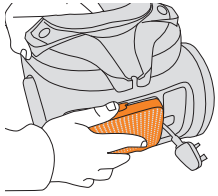

Press button on post-motor filter cover pull to remove.

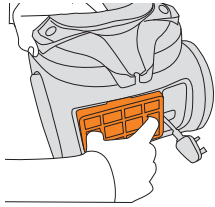

Pull tabs on post-motor filter to remove.



Tap the post-motor filter over a bin to release dirt /debris. Always replace before using your vacuum.

For best cleaning results, replace the post-motor filter every 12 months.



Storing your vacuum cleaner

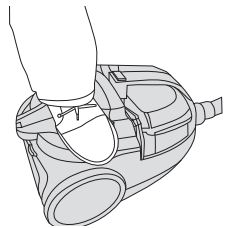

Press cord rewind button to retract cord into vacuum cleaner.

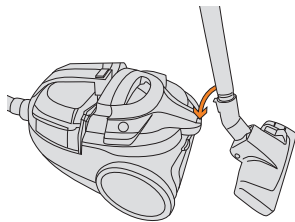

Place floor head into parking slot located at rear of vacuum cleaner for storage and carrying.

IMPORTANT: Remove accessory from hose or telescopic extension tube before performing maintenance or trouble shooting checks.

Removing blockages from the TurboTool*

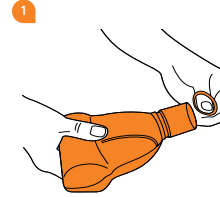

Slide the locking ring to remove.



Lift and separate the housing.

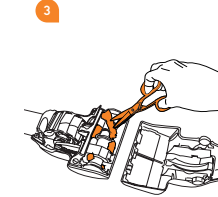

Using a pair of scissors, remove any threads or hair caught around the brushbar.

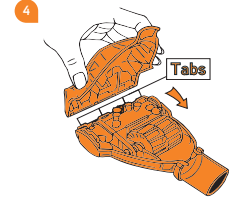

Line up the tabs on front of housing and push together to refit. Slide locking ring into groove to secure.

Removing a blockage from the hose

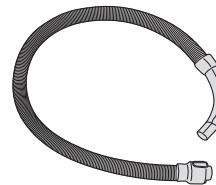

Remove the hose from the vacuum cleaner and telescopic extension tube. Remove any blockage by inserting wire coat hanger in to hose.



Problem

Solution

Is there an accessory missing?

- Check the 'This pack contains' panel on the box to make sure the part is included with your vacuum cleaner.

Why won't the vacuum cleaner pick up?

- The dirt container may not be correctly fitted, remove the dirt container from the vacuum cleaner and check pre-motor filter and dirt container are assembled correctly, refit ensuring it's locked into place. Go to 'Taking care of your machine'.
- The filter may be clogged, clean the filter. Go to 'Taking care of your machine'.
- The dirt container may be blocked, empty the dirt container. Go to 'Taking care of your machine'.
- There may be a blockage in the hose/tube. Disconnect from the vacuum cleaner and carefully remove any blockages. Go to 'Let's talk technical'.

Why does my vacuum cleaner have no power?

- The plug may not be fully pushed into the electrical socket.
- Check the fuse in the plug if this needs replacing, always replace with a 13amp fuse.
- The motor thermostat may have tripped. If this has happened, unplug the vacuum cleaner. Remove and empty the dirt container and check the hose for blockages. Clean the filters and allow the vacuum cleaner to cool for approximately 1 hour (if you have washed the filters you will need to wait 24 hours for the filters to fully dry before putting them back into the vacuum cleaner).

Why is dust escaping from the vacuum?

- The filters may be clogged, clean the filter. Go to 'Taking care of your machine'.

Warning: To reduce the risk of personal injury, unplug the vacuum cleaner before performing maintenance /troubleshooting checks.



* Calls are charged at the UK local rate. Please make a note of the serial number and model number of the vacuum cleaner before calling.

Don't forget your accessories!

Order at: www.vax.co.uk/spares-and-solutions

Pro cleaning kit (Type 2)

1-1-133326-00

All our best tools all in one kit that makes cleaning your home quicker, easier and with even better results. We've taken care of cleaning all of the hard to reach areas such as on top of cupboards and in between blinds to the dust that collates behind and within the radiator.



TurboTool (Type 6)

1-1-134419-00

Use the TurboTool for vacuuming your stairs, upholstery and car interiors. It's great for picking up stubborn pet hair.



Fur 'n' Fluff Tool

1-1-131392-00

Specifically designed to remove extra stubborn pet hair from upholstery, furniture and carpets.





You're home.™



@VaxUK

Vax Ltd., Kingswood Road, Hampton Lovett, Droitwich, Worcestershire, WR9 0QH, UK
email: info@vax.co.uk website: vax.co.uk

Version 1.0



EEC Statement of Compliance: Manufacturer/EEC importer: Vax Limited, hereby on our own responsibility, declare that the C86-T0e series is manufactured in compliance with the following Directives:

Safety: 2006/95/EC Low Voltage Directive. **EMC:** 2004/108/EC Electromagnetic Compatibility Directive.



Waste electrical products should not be disposed of with household waste. Please recycle where facilities exist. Check with your Local Authority or retailer for recycling advice.