

Argos

Value Range

# Bagless Upright Vacuum Cleaner

Instruction Manual - Please keep for future reference

VU-01e

VU-02e



For help, spares or  
assistance please call  
**0845 6042377**  
or visit  
[www.bagsandfilters.com](http://www.bagsandfilters.com)

**Important - Please read these instructions fully before installing or using**

These instructions contain important information which will help you get the best from your appliance and ensure safe and correct use and maintenance. If you need help or have damaged or missing parts, call the **Customer Helpline: 0845 6042377**

# Contents

<b>Safety Information</b>	<b>2</b>
<b>Parts</b>	<b>3</b>
<b>Initial Setup for normal operation</b>	<b>4</b>
<b>Assembly</b>	<b>5-6</b>
<b>Operation</b>	<b>7</b>
Accessories	8
<b>Maintenance</b>	<b>9-10</b>
Emptying the dirt container	9
Cleaning the HEPA media filter	9
Cleaning the pre motor filter	10
Replacing the belt	10
<b>Clearing Blockages</b>	<b>11</b>
Removing debris from the Turbotool	11
Removing debris from the hose	11
Removing debris from the brushbar	11
<b>Troubleshooting</b>	<b>12</b>
<b>Technical Specifications</b>	<b>13</b>
<b>Guarantee</b>	<b>14</b>



## Product Code

VU-01e/VU-02e

# Safety Information

**Important - Please read all instructions before use and keep for future reference**

## FOR HOUSEHOLD USE ONLY.

When using the vacuum cleaner, basic safety precautions should always be observed, including the following:

1. **Only** use the vacuum cleaner indoors on dry surfaces. Do not handle the plug or vacuum cleaner with wet hands. Do not use outdoors or on wet surfaces.
2. Turn off the vacuum cleaner controls before disconnecting or connecting from the mains supply.
3. **Always** unplug the vacuum cleaner before connecting or disconnecting the vacuum hose and accessories.
4. **Children** should be supervised to ensure that they do not play with the appliance.
5. This appliance is not intended for use by persons (including children) with reduced physical, sensory or mental capabilities, or lack of experience and knowledge, unless they have been given supervision or instruction concerning use of the appliance by a person responsible for their safety.
6. **Only** use as described in this manual. Only use recommended attachments.
7. **Do not** use the vacuum cleaner if it has been dropped, damaged, left outdoors or dropped into water.
8. **Do not** use the vacuum cleaner with a damaged cord or plug. If the supply cord is damaged, call the helpline for assistance.
9. **Do not** pull or carry by cord/hose. Do not use the cord/hose as a handle, close a door on the cord/hose or pull cord/hose around sharp edges or corners. Do not run the vacuum cleaner over the cord. Keep the cord away from heated surfaces.
10. **Do not** put any objects into openings. **Do not** use with any openings blocked and do not restrict air-flow. Keep all openings free of dust, lint, hair or anything that might reduce airflow.
11. Keep hair, loose clothing, fingers and all parts of the body away from openings and moving parts.
12. **Do not** pick up hot coals, cigarette butts, matches or any hot, smoking or burning objects.
13. **Do not** pick up flammable or combustible materials (lighter fluid, petrol, kerosene etc.) or use in the presence of explosive liquids or vapours.
14. **Do not** vacuum up harmful or toxic material (chlorine, bleach, ammonia, drain cleaner etc.).

15. **Do not** vacuum up hard or sharp objects such as glass, nails, screws, coins, etc.
16. **Do not** use without ALL of the filters in place.
17. Take extra care when vacuuming on stairs.
18. Keep vacuuming area well lit.
19. Store the vacuum cleaner in a cool, dry area.
20. Turn off the on/off switch before unplugging the vacuum cleaner.
21. **Only** use CE-approved 13 amp extension cords. Non-approved cords may overheat. Care should be taken to arrange the cord so that the cord cannot be tripped over.

**! WARNING:** Always switch off and unplug the vacuum cleaner from the electrical outlet before assembling, opening or emptying the dirt container, connecting/disconnecting the attachments, or carrying out maintenance or troubleshooting checks.

**! CAUTION:** The vacuum cleaner is a very powerful unit. Before plugging the cord into the electrical outlet, make sure the switch is in the 'off' position. Hold the vacuum cleaner firmly when starting and in use.

**! IMPORTANT:** If the inlet, hose or extension tube is blocked, switch off the vacuum cleaner and remove the blockage(s) before re-starting the vacuum cleaner.

**! IMPORTANT:** We recommend that filters should be checked and cleaned periodically. For washable filters, ensure they are completely dry before inserting back into the vacuum cleaner. Do not wash with detergents. Only use warm water, max 40°C.

**! IMPORTANT:** The motor is equipped with a thermal cut-out. If for any reason the unit should overheat, the thermostat will automatically turn the unit off. Should this occur, unplug the vacuum cleaner from the electrical outlet and turn off the switch. Remove dirt container and empty. Clean filters. Allow the unit to cool for approximately one (1) hour. To re-start, plug into an electrical outlet and switch back on.

**This vacuum cleaner is intended for household use only and NOT for commercial or industrial use.**

**PLEASE KEEP INSTRUCTIONS FOR FURTHER USE.**

# Parts

If you have damaged or missing parts, call the **Customer Helpline: 0845 6042377**

Please familiarise yourself with parts and accessories listed below

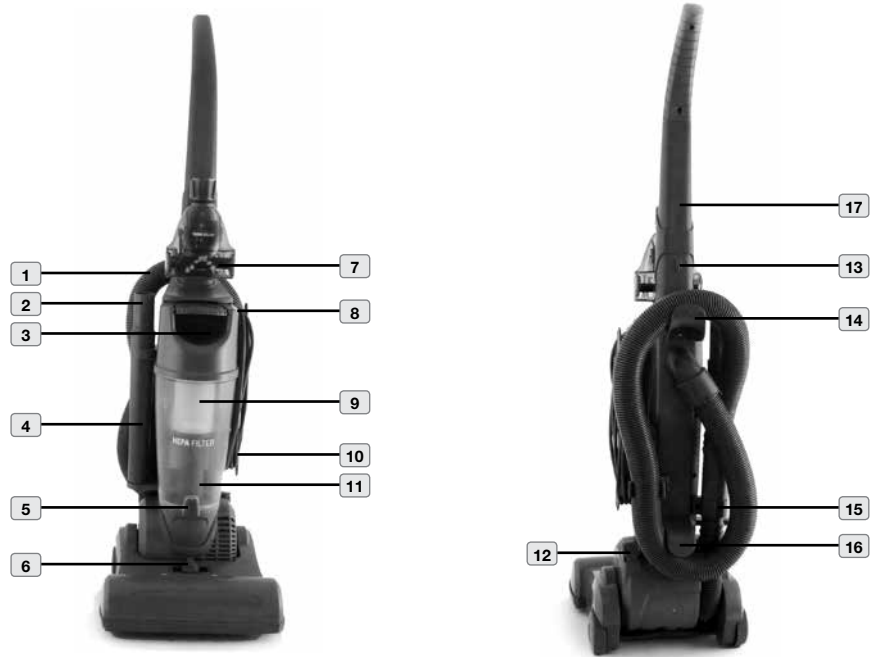

- 1 Hose
- 2 Crevice tool
- 3 Dirt container release handle
- 4 Extension tube
- 5 Dirt release button
- 6 Floor height adjust slider
- 7 Turbotool (VU-02e only)
- 8 Upper cord wrap

- 9 HEPA media filter
- 10 Power cord
- 11 Dirt container
- 12 On/off button
- 13 Cable clip
- 14 Upper hose caddy/carry handle
- 15 Hose/tool connector
- 16 Lower hose caddy
- 17 Turbotool caddy

## Filters (pre-assembled in product)

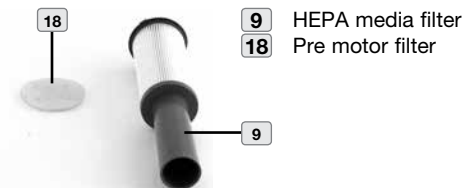

- 9 HEPA media filter
- 18 Pre motor filter

## Tools required for assembly



1 x Crosshead screwdriver

# Initial Setup for normal operation

1. Use the base accessories.
  - Shortest hose
  - Extension tube set to shortest practicable length.
2. Clean filters installed.
3. Dust receptacle empty.
4. All Bleeds must be closed.
5. Variable Power set to Maximum.
6. Floor heads/tools set to Carpet Mode for carpet cleaning.
7. Mechanical Agitation turned ON for carpet cleaning.
8. Floor heads/tools set to Hard Floor Mode for hard floor cleaning.
9. Mechanical Agitation turned OFF for hard floor cleaning.

# Assembly

## Assembling your vacuum cleaner

1. Insert the handle into the main body of the vacuum.

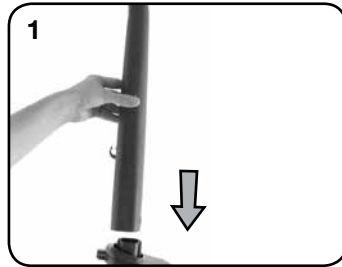

2. Insert the carry handle/upper hose caddy into the back of the vacuum.

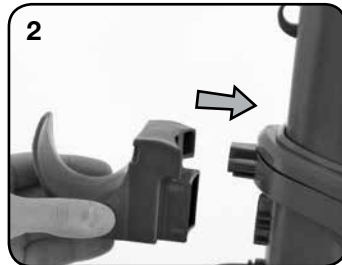

3. Secure the handle and carry handle to the unit by inserting the 'U' shaped pin.



4. Insert the three screws provided and secure.

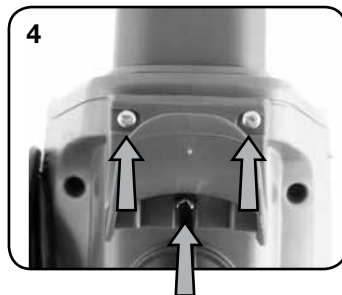

# Assembly

## Assembling your vacuum cleaner

5. Connect the upper hose to the upper hose connector on the back of the vacuum cleaner. Tabs will click into place.

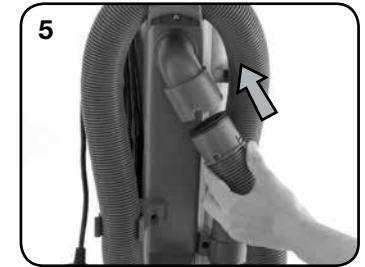

6. Connect the lower hose to the lower hose connector on the side of the vacuum.

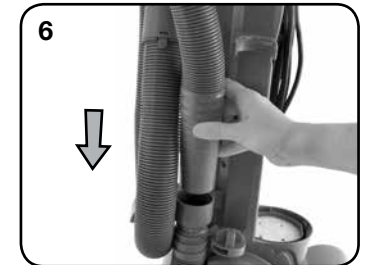

7. Attach the dirt container to the unit, ensuring it is fitted correctly. The dirt container will click when secured.



8. **VU-02e ONLY.** Slide the Turbotool holder over the end of the handle and fit into place.



# Operation

## Operating the appliance

**⚠ NOTE:** Do not use this vacuum on hard floors. Intended for all carpet types only. Brushbar continually rotates when in upright position. Do not leave in one place for extended period of time. When vacuuming stairs, do not place the unit on the stairs.

1. Fully unwrap the power cord, twisting the upper cord wrap and plug into mains.
2. Adjust the brushbar height to suit your carpet type.
3. Turn the vacuum cleaner on using the on/off button situated on the base of the unit.
4. Push foot on floor head to recline handle.

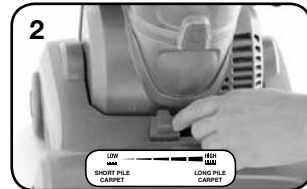

## Accessories

1. Remove the hose from the lower hose caddy.
2. Fit the crevice tool or the Turbo tool to the end of the hose.

**⚠ NOTE:** Do not use the Turbo tool on suede and leather surfaces.

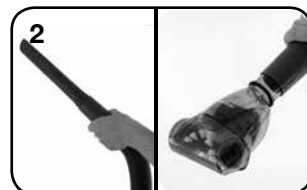
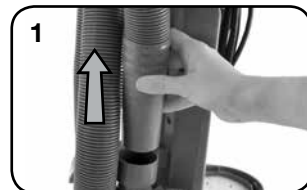

# Operation

## Using the Hard Floor Adapter

Apply the Hard Floor Adapter for optimum results on hard floors. The Hard Floor Adapter can be used on any floor setting.

1. Lie vacuum cleaner on its back exposing brush bar.

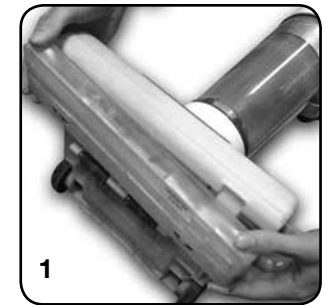

2. Align the Hard Floor Adapter with the base of the vacuum cleaner, push until it clicks into place.

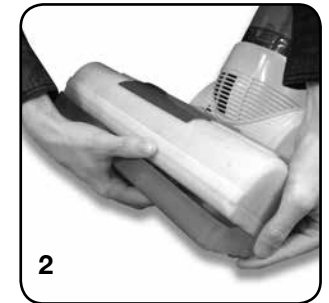

# Maintenance

**⚠ WARNING:** To reduce the risk of electric shock, turn the vacuum cleaner off and unplug from the electrical outlet before performing maintenance/trouble shooting checks.

## Emptying the dirt container

**⚠ NOTE:** Empty the dirt container regularly. When maximum dust capacity is reached it is necessary to empty/clean the dirt container.

1. Remove the dirt container, lifting the release handle.
2. Empty the dirt container over a bin by pressing the dirt release button.

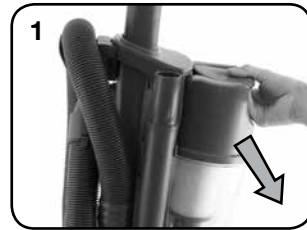

## Cleaning the HEPA media filter

**⚠ NOTE:** Failure to keep filters clean will result in a loss of performance.

1. Remove lid of dirt container by twisting anti clockwise.

**⚠ NOTE:** To remove/attach the lid to the dust container align arrows.

2. Remove the HEPA media filter by twisting anti clockwise.
3. Clean the HEPA media filter by tapping it against a bin and washing it under warm water (max 40°C).
4. Leave the filter to dry for 24 hours, before returning to the dirt bin and using your machine.

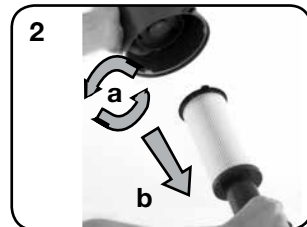
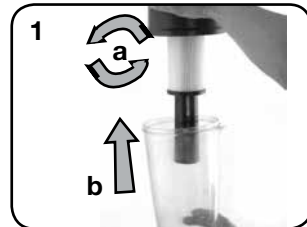

# Maintenance

## Cleaning the pre motor filter

1. Remove the pre motor filter from underneath the dirt container.
2. Clean the pre motor filter by tapping it against a bin and washing it under warm water (max 40°C).
3. Leave to dry for 24 hours before returning to your machine and using your vacuum cleaner.



## Replacing the belt

1. Remove the 4 screws on the base of the unit.
2. Remove the 2 screws underneath the middle set of wheels.
3. Lift the floor head cover.
4. Remove the belt from the unit, by lifting out the brushbar. Replace the belt and fit the brushbar back into the floor head.

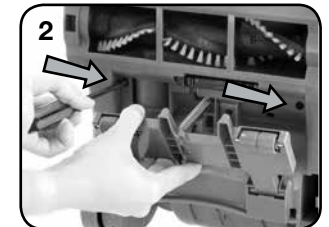
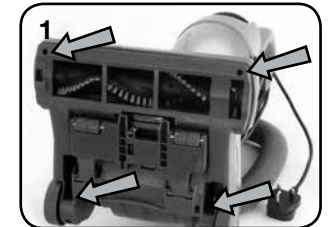

# Clearing Blockages

## Removing debris from the Turbotool (VU-02 only)

1. Remove the rubber ring from the neck of the Turbotool.
2. Lift the top cover from the Turbotool.
3. Using scissors cut any threads from the brushbar and remove.
4. To re-assemble the Turbotool align the tabs at the front of the lid and close.

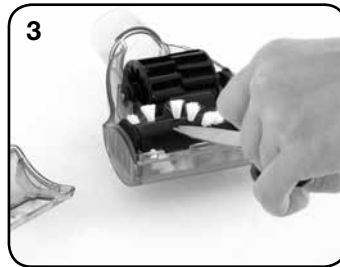
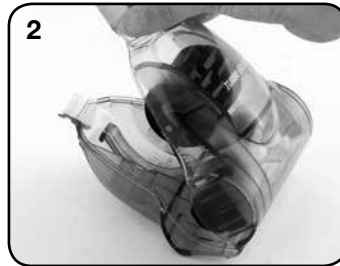

## Removing debris from the hose

1. Disconnect the hose from the vacuum cleaner and remove any blockages and reconnect the hose securely.

## Removing debris from the brushbar

1. Using scissors cut any threads from the brushbar and remove.

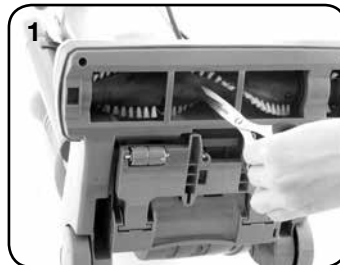

# Troubleshooting

For help, spares or assistance please call: 0845 6042377 or visit [www.bagsandfilters.com](http://www.bagsandfilters.com)

Problem	Possible causes	Solutions
There is an accessory missing	1. A part(s) is missing from box	1. Check the 'PARTS' page of your instructions
The vacuum cleaner does not switch on	1. The unit is not plugged into a mains socket 2. The power button on the unit has not been depressed 3. The thermal motor cut out has been activated 4. There is no electricity to the power socket	1. Ensure the plug is firmly in the socket and switched on 2. Depress the power switch on the unit 3. If the unit has cut out during use, disconnect the unit from the wall socket, allow to cool for one hour, clean the filters, empty bin and check the hose/accessories for blockages 4. Seek expert help from a qualified electrician
The vacuum cleaner won't pick up	1. The accessories are not correctly fitted 2. There are blockages in the hose/accessory 3. The dirt container is full 4. The filters are blocked/clogged 5. The carpet height adjust slider setting is not correct 6. The belt is broken/brushbar not rotating	1. Check hose/tools are correctly attached to the machine/hose/tube; refer to 'ASSEMBLY/OPERATION' section 2. Check the air paths of the hose/accessory are not obstructed by blockages 3. Check dirt container and if necessary empty 4. Frequently cleaning filters will maintain performance; see 'MAINTENANCE' section 5. See 'OPERATION' section for correct carpet height setting for your carpet 6. Disconnect the unit from the power supply, remove the floor head cover and check the belt has not detached from the motor spindle or that the belt is not worn/damaged; see 'MAINTENANCE' section
Dust is escaping from the vacuum cleaner	1. The filters/dirt container are not fitted correctly 2. The filters are damaged	1. See 'ASSEMBLY' and 'MAINTENANCE' sections 2. If the filters are damaged these will need to be replaced
Accessories won't pick up dust/debris	1. The wrong tool is fitted for the task 2. The tools are blocked 3. The filters are blocked 4. The dirt container is full 5. The hose/tubes are blocked	1. See 'PARTS' section 2. Check the air paths of the tools are not obstructed by blockages 3. Frequently cleaning filters will maintain performance; check 'MAINTENANCE' section 4. Check and empty the dirt container 5. Check the air paths of the hose/tubes are not obstructed by blockages
The blockage indicator (if applicable to model) activates	1. The filters/dirt container are blocked 2. The dirt container is full 3. The accessories/hose/tube are blocked	1. Frequently cleaning filters will maintain performance; check 'MAINTENANCE' section 2. Check and empty dirt container 3. Check the air paths of the accessories/hose/tubes are not obstructed by blockages

# Technical Specifications

Model Number	VU-01e/VU-02e
Voltage	220-240V~/50Hz

We apologise for any inconvenience caused by minor inconsistencies in these instructions, which may occur as a result of product improvements and development.



## EEC statement of compliance



Manufacturer/EEC importer: Hereby on our own responsibility, declare that the VU-01e and VU-02e are manufactured in compliance with the following Directives:

Safety: 2006/95/EC Low Voltage Directive  
EMC: 2004/108/EC Electromagnetic Compatibility Directive

Waste electrical products should not be disposed of with household waste. Please recycle where facilities exist. Check with your Local Authority or retailer for recycling advice.



## PRODUCT GUARANTEE

This product is guaranteed against manufacturing defects for a period of



Year

This product is guaranteed for twelve months from the date of original purchase. Any defect that arises due to faulty materials or workmanship will either be replaced, refunded or repaired free of charge where possible during this period by the dealer from whom you purchased the unit.

The guarantee is subject to the following provisions:

- The guarantee does not cover accidental damage, misuse, cabinet parts, knobs or consumable items.
- The product must be correctly installed and operated in accordance with the instructions contained in this manual.
- It must be used solely for domestic purpose.
- The guarantee will be rendered invalid if the product is re-sold or has been damaged by inexpert repair.
- Specifications are subject to change without notice.
- The manufacturer disclaims any liability for the incidental or consequential damages.
- The guarantee is in addition to, and does not diminish your statutory or legal rights.

Guarantor: Argos Ltd  
489 - 499 Avebury Boulevard  
Central Milton Keynes  
MK9 2NW