



You're home.™

# PowerWash

1700W – VPW1

Compact use Pressure Washer

Perfect for cleaning small cars, garden furniture, bikes, garden tools, and small scale patio areas.



VPW1

[vax.co.uk](http://vax.co.uk)

## Let's talk safety



### Basic safety precautions

**This pressure washer is intended for household use only and NOT for commercial or industrial use.**

- This Pressure washer is for outdoor use only.
- It is your responsibility to check the suitability of the surface to be cleaned. Vax UK Ltd cannot be held responsible for damage caused.
- Keep fingers, hair and loose clothing from moving parts and openings whilst using the pressure washer.
- When using your pressure washer the recommended working distance between the nozzle and surface area or object to be cleaned is 30cm.
- This appliance can only be used by children aged from 8 years and above and persons with reduced physical, sensory or mental capabilities or lack of experience and knowledge if they have been given supervision or instruction concerning use of the appliance in a safe way and understand the hazards involved. Children should not play with the appliance. Cleaning and user maintenance shall not be made by children without supervision.
- Vax only recommend the use of Vax genuine accessories and solution to be used with this pressure washer. The use of non-branded Vax accessories and solution will invalidate your warranty.



### Don'ts

- ✗ Don't leave the pressure washer unattended or running when not in use for more than 5 minutes without depressing the trigger.
- ✗ Don't use this pressure washer if it has been dropped, damaged or immersed in water.
- ✗ Don't use pressure washer if the power cord or plug is damaged. Please contact our Customer Care Line on (UK) 0844 412 8455 (ROI) 1-800 928 308.
- ✗ Don't handle the plug of the pressure washer with wet hands.
- ✗ Don't use the pressure washer without supply hose (minimum length 7.5m) in place and unwind the hose fully from reel.
- ✗ Don't use the pressure washer without the water filter in place.
- ✗ Don't pull or carry this pressure washer by the power cord. Don't use the power cord as a handle, pull the power cord around corners or sharp edges or close a door over the power cord. Don't unplug pressure washer by pulling on the power cord.
- ✗ Don't aim the pressure washer at people, animals, plants, electrical components, wires, or the pressure washer itself.
- ✗ Don't use the pressure washer on electrical components, damaged/delicate paint surfaces, tyres, engines/motors.
- ✗ Don't use the pressure washer with incorrect voltage as this may result in damage or injury to the user. The correct voltage is listed on the rating label.



### Do's

- ✓ Always wear suitable clothing footwear and eye protection whilst using the pressure washer.
- ✓ Always connect the water supply, remove the lance and squeeze the trigger to run water through the machine before switching the power on.
- ✓ Always use a suitable hose connector to match the coupling on the pressure washer with a non-return valve at tap end of the supply hose.
- ✓ Always unplug the pressure washer before cleaning or carrying out any maintenance.
- ✓ Always turn off and unplug the pressure washer before disconnecting or connecting the hose, after use always wrap the pressure hose and power cord around the storage clips provided.
- ✓ Always release any built up pressure in the handle prior to disconnecting the hose and ensure water inlet filter is clean prior to storage in a cool dry place.
- ✓ Use only CE approved 13amp extension cords with RCD, non-approved extension cords may overheat. Care should be taken to arrange the extension cord as it could be a trip hazard.
- ✓ Always make sure the power/extension cord is fully unwound and prevent the power/extension cord from getting wet during use.
- ✓ Always replace the fuse in the plug with a British 13amp fuse. Always protect the power cable from heated surfaces or near open flames.
- ✓ Always carry the pressure washer by the handle.
- ✓ Always check water hose and accessories are not damaged, broken or worn before use.

## Thank you for buying this Pressure Washer.

### Taking care of your outdoor cleaning

The pressure washer is designed to make outdoor cleaning tasks as effective and efficient as possible and this user guide will help you get the most out of your machine.

Completing outdoor cleaning tasks using a Vax pressure washer will keep your outdoor items and surfaces cleaner for longer.

### Taking care of your Pressure Washer

Also inside this guide are instructions on maintaining your new machine, so that it's always ready when you are to tackle your outdoor cleaning tasks.

### Taking care of you

We're here if you need us. Instead of taking me back to the shop, simply visit:

[vax.co.uk/support](http://vax.co.uk/support) or call:

(UK) **0844 412 8455** (ROI) 1-800 928 308

**Monday-Friday 8.30am to 6.30pm, Saturday 9.00am to 5.00pm**

Calls are charged at the UK local rate. Please make a note of the serial number and model number of the pressure washer before calling.

Alternatively, you can write to us at:

**Vax Ltd., Kingswood Road, Hampton Lovett, Droitwich, Worcestershire, WR9 0QH, UK**



You're home.™



Let us know what you think @VaxUK

# Contents

- Let's talk safety
- Getting to know your machine
- Getting started
- Using your machine
- Taking care of your machine
- Let's talk technical
- What to do if it goes wrong
- Getting in touch
- Accessories

## Pressure Washer

### Included with your machine

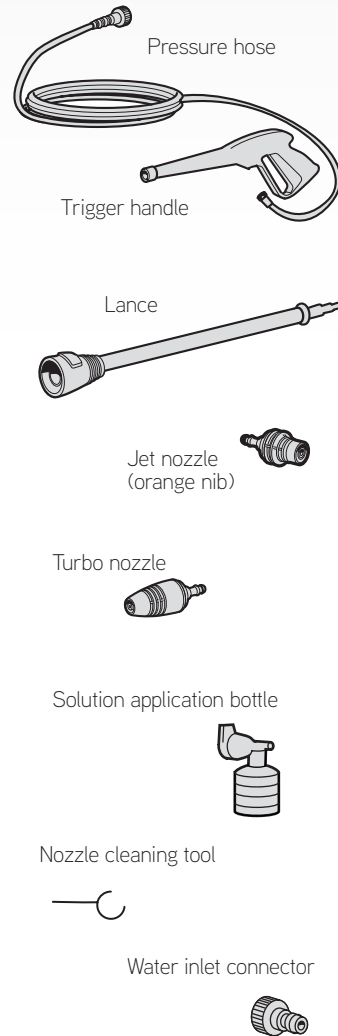

## Getting to know your machine



### Technical Specification

Name	Pressure Washer
Voltage	1700W
Wattage	220-240V~50Hz
Max Pressure	130 bar
Working Pressure	90 bar
Flow Rate	370L/Hr

### Accessories & Consumables

Universal detergent	1-9-133398-00	Wash & Protect vehicle detergent	1-9-133400-00
Patio & Decking detergent	1-9-133401-00		

Subject to technical change without notice.

\*To purchase consumables and accessories, please visit [vax.co.uk](http://vax.co.uk)

PLEASE READ 'LET'S TALK SAFETY' AT THE BEGINNING BEFORE USE.

**IMPORTANT:** Always use an RCD (Residual Current Device) adaptor when using this pressure washer.

## Assembling your pressure washer

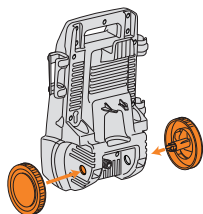

Attach both wheels and push until they click into place.

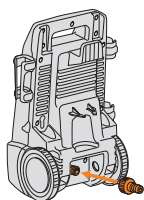

Attach the hose connector to water inlet by turning clockwise until tight.



After connecting pressure hose, lance and accessories check they are securely fitted and locked in place before turning on.

Always make sure the pressure washer and water supply is off before connecting or disconnecting the hose and accessories

**IMPORTANT:** Always make sure the trigger safety lock is in the **LOCKED** position when not in use or connecting/disconnecting the pressure hose.

Always check water hose, pressure hose, lance and accessories are not damaged broken or worn before use.

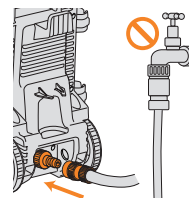

Make sure water supply is not connected. Firmly push the water hose pipe with suitable connector onto the water inlet to lock into position.

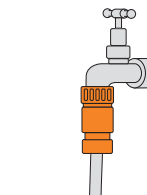

Connect water hose pipe to a suitable water supply and turn water on.

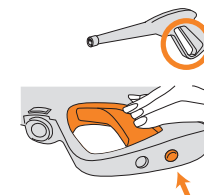

Before plugging the machine in, press the unlock safety button on the trigger handle and squeeze the trigger until water starts to flow through the nozzle.

## Preparing your pressure washer for use

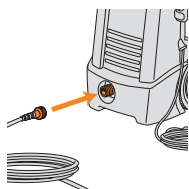

Push the pressure hose firmly to the water outlet and turn the pressure hose collar clockwise until tight.

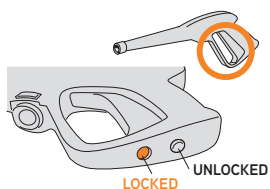

A trigger safety lock is located underneath the handle. The safety lock should always be in LOCKED position before connecting/disconnecting the pressure hose to the trigger handle.

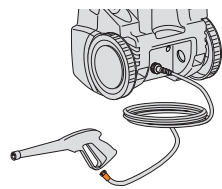

To connect pressure hose to trigger handle, press the pressure hose release button and push pressure hose to lock into position. Gently pull the pressure hose to make sure it is locked securely.

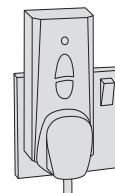

Connect the power cord to the mains supply via an RCD adaptor.

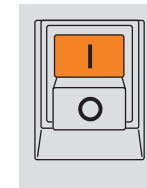

Push switch to 'I' position to turn on. The machine will run for a few seconds then stop but no water will be released.

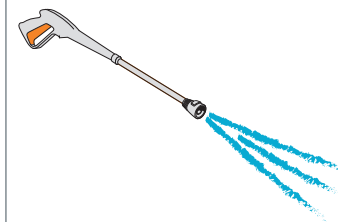

Squeeze the trigger on the trigger handle to release a high pressured water jet, and start cleaning.

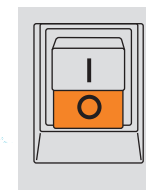

Push switch to 'O' position to turn off.

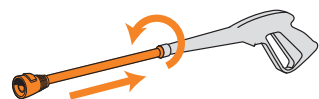

Whilst firmly pushing the lance into the trigger handle turn clockwise to lock into position.



To remove the lance from the trigger handle firmly push and twist the lance anti-clockwise. When unlocked pull to remove.

## ! WARNING

Don't aim the pressure washer directly at people, animals, plants, electrical components, wires or the pressure washer itself.



## Using your machine

**IMPORTANT:** Always make sure the machine is switch off and the safety button on the trigger handle is LOCKED before connecting/disconnecting the lance, nozzle or accessories.

Jet nozzle has a wider spray and is ideal for use on surfaces areas such as cars, garden furniture, decking and boats.

### Using your accessories

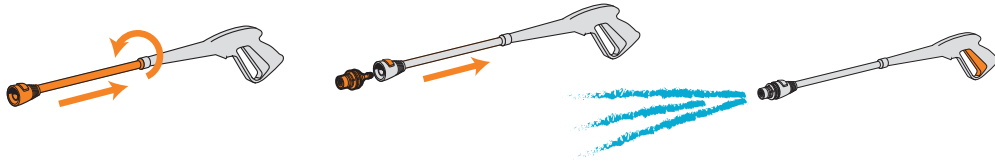

To attach the jet nozzle, fit the lance with a firm push and twist to lock into place.

Hold down the release button on the lance, push the jet nozzle and lance firmly together until you hear an audible CLICK. Release the button and gently pull the jet nozzle to make sure it is locked securely before use.

Squeeze the trigger on the trigger handle to release a high pressured water jet, and start cleaning.

Turbo nozzle has a more concentrated spray and is ideal for use on very dirty surfaces, patios or masonry. As it is not fitted with a pressure regulator it is not suitable for use on delicate or painted surfaces.

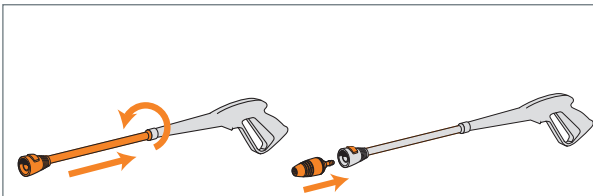

To attach the turbo nozzle, fit the lance with a firm push and twist to lock into place.

Hold down the release button on the lance, push the turbo nozzle and lance firmly together until you hear an audible CLICK. Release the button and gently pull the turbo nozzle to make sure it is locked securely before use.

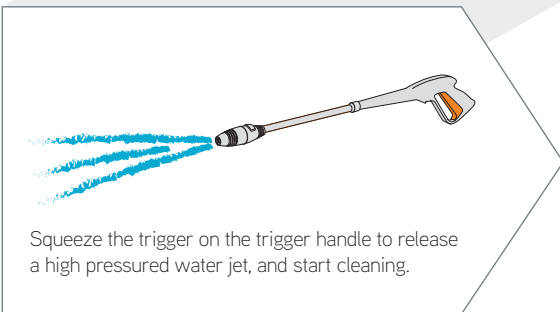

Squeeze the trigger on the trigger handle to release a high pressured water jet, and start cleaning.

## Using your machine

**IMPORTANT:** When using solution make sure you follow the dilution instructions and use Vax solution only.  
**IMPORTANT:** Solution can only be used with the jet nozzle.

### Using solution with your pressure washer

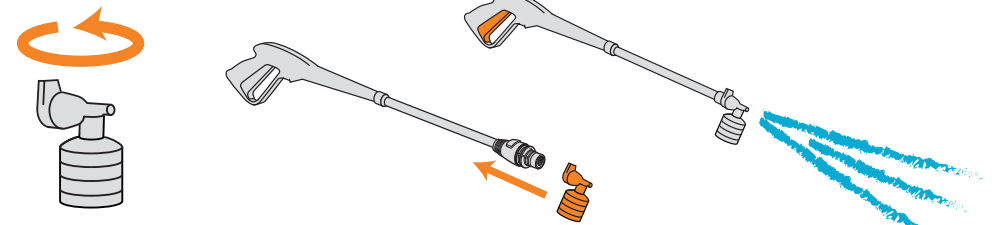

Fill the solution application bottle with the diluted solution mix. Turn the lid clockwise to lock.

Push the solution application bottle onto the lance fitted with jet nozzle until locked into place.

Switch the pressure washer on and squeeze trigger to dispense the water and solution mix.



To remove or refill, lift the locking tab to release the solution application bottle from the jet nozzle.



**!** **WARNING**

Never use the turbo nozzle on cars, tyres and engines.



**TIP**  
Always rinse fresh water through your pressure washer for 1 minute after using solution to prevent blockages.

**IMPORTANT:** Always rinse fresh water through your pressure washer and accessories for 1 minute after using solution to prevent blockages.

## Maintenance

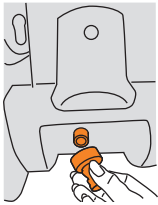

To access water filter unscrew water inlet connector and remove.

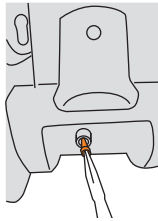

To remove water filter, pinch the inner water filter tab with pliers and gently pull.

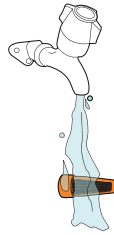

Water filter can be rinsed under running water periodically.

**IMPORTANT:** Before storing your machine always make sure no water remains in the pressure washer or hose/ accessories to prevent frost damage. Keep in a dry place above zero degrees and out of the reach of children.

## Storage

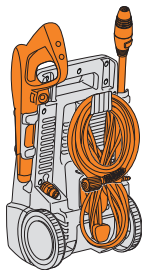
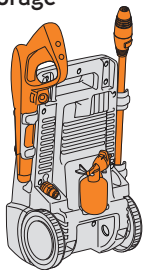

Always store tools/cable/solution tank into allocated slots.

## Removing a blockage in the lance and nozzles

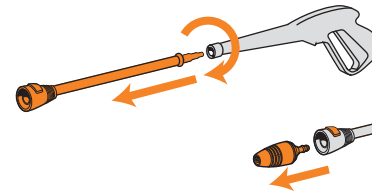

To remove the lance from trigger handle firmly push and twist the lance, when unlocked pull to remove.

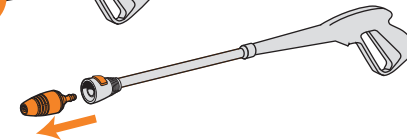

To remove the nozzles press the nozzle release button and pull.

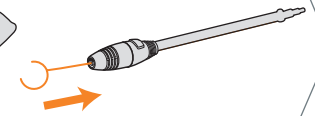

Insert the nozzle cleaning tool into the end of lance and nozzles to remove any dirt or debris.



## WARNING

Before carrying out any maintenance make sure the machine is switched off and unplugged.

### Problem

### Solution

There is an accessory missing

- Check the 'This pack contains' panel on the box to make sure the part is included with your machine.

Why won't my pressure washer turn on?

- Make sure the on/off switch is set to the 'I' position.
- The plug may not be fully pushed into the electrical socket.
- Check the fuse in the plug if this needs replacing, always replace with a British 13amp fuse.
- Check if your RCD has been tripped, if it has tripped, reset it.
- The power cord maybe damaged. Please contact our Customer Care Line on (UK) 0844 412 8455 (ROI) 1-800 928 308.

Why won't the water/solution dispense?

- The pump may have stopped, make sure the on/off switch is set to the 'I' position and check the plug fuse.
- The pump may have stopped. This may be because of overheating due to poor water supply. Check the water flow rate to your water supply.
- Hose may be blocked or kinked, check for leaks in the hose and clear any blockages. Straighten out the hose to ensure no kinks and check the hose pipe connections to the tap and water inlet.
- There may be an air lock. To remove, unlock the trigger safety lock and squeeze the trigger to release water before the machine is switched on.
- Check assembly of solution application bottle Go to the 'Using your machine' pages. Nozzle/accessory may be blocked, clear any blockages and clean nozzle Go to the 'Lets talk technical' page.

Why won't my pressure washer reach operating pressure?

- Hose may be blocked or kinked, check for leaks in the hose and clear any blockages. Straighten out the hose to ensure no kinks and check the hose pipe connections to the tap and water inlet.
- Nozzle may be blocked, clear any blockages and clean nozzle. Go to the 'Lets talk technical' page.
- Remove and clean the water inlet filter Go to the 'Taking care of your machine' page.
- Check the water flow rate to your water supply.



\* Calls are charged at the UK local rate. Please make a note of the serial number and model number of the pressure washer before calling.

## Accessories

# Don't forget your accessories!

Order at: [www.vax.co.uk/spares-and-solutions](http://www.vax.co.uk/spares-and-solutions)

### Universal detergent

Universal detergent to aid the break down and removal of stubborn dirt, moss, and grime.

1-9-133398-00



### Patio & Decking detergent

Patio & decking detergent to aid the break down and removal of stubborn dirt from patio and decked areas.

1-9-133401-00



### Wash & Protect vehicle detergent

Wash & protect vehicle detergent to aid the removal of road dirt, oil and grease from vehicles, and provide short term protection against weathering conditions.

1-9-133400-00



### Standard lance

Standard lance connection between your trigger handle and attachments.

1-9-133749-00



### Detergent nozzle

A detergent nozzle to directly apply detergent to surfaces to help loosen dirt, moss, and grime.

1-9-133759-00



### Attachable detergent bottle

A detergent nozzle to directly apply detergent to surfaces to help loosen dirt, moss, and grime.

1-2-133752-00



### Trigger handle

A smooth shape hand handle with an easy squeeze trigger and a built in safety lock for easy on/off trigger release.

1-2-133750-00



### Jet nozzle

Jet nozzle to apply concentrated pressure to dislodge dirt and grime on all surface types.

1-9-133754-00



### Turbo nozzle

A high pressure turbo nozzle to blast away tough embedded dirt from high traffic areas.

1-9-133753-00



### Patio cleaning set

A large circular cased brush, supplied with an extension tube for cleaning concentrated areas quickly and efficiently. Ideal for: Patios, Decking, Driveways, Garage doors.

1-9-133767-00



### Rotary brush

A firm bristled brush with 360 degree rotation, providing extra scrub power for an extra clean. Ideal for: Car alloy wheels, Car grills.

1-9-133766-00



### Car brush

A soft bristled brush, perfect for agitating tough dirt from sensitive surfaces. Ideal for: Car mirrors, Car body.

1-9-133765-00



### Outdoor brush

A handy outdoor brush, perfect for gently removing dirt from various outdoor surfaces. Ideal for: Garden furniture, Conservatories.

1-9-133769-00



### Extension bar

An additional connection tube providing you extra reach.

1-9-133768-00



### Replacement hose (10m)

An additional high pressure hose, highly durable and resistant to weather conditions.

1-9-133751-00





You're home.™



@VaxUK

Vax Ltd., Kingswood Road, Hampton Lovett, Droitwich, Worcestershire, WR9 0QH, UK  
email: [info@vax.co.uk](mailto:info@vax.co.uk) website: [vax.co.uk](http://vax.co.uk)

Version 1.0



**EEC Statement of Compliance:** Manufacturer/EEC importer: Vax Limited, hereby on our own responsibility, declare that the VPW series is manufactured in compliance with the following Directives:  
**Safety:** 2006/95/EC Low Voltage Directive. **EMC:** 2004/108/EC Electromagnetic Compatibility Directive.



Waste electrical products should not be disposed of with household waste. Please recycle where facilities exist.  
Check with your Local Authority or retailer for recycling advice.