



You're home.™

2 year
guarantee

Dual Power

Let's get started



W86-DP-R

vax.co.uk

Let's talk safety



Basic safety precautions

- This carpet washer is intended for household use only and NOT for commercial or industrial use.
- Only use the carpet washer indoors and keep the area you're cleaning well lit.
- Keep fingers, hair and loose clothing from moving parts and openings whilst using the carpet washer.
- This carpet washer is NOT to be used by children under eight years or persons with reduced physical, sensory or mental capabilities, unless they have been given instructions on how to use the machine or are supervised during use.
- Any cleaning or maintenance of your carpet washer should not be made by children without supervision and ensure they don't play with the carpet washer.
- Before using your carpet washer test your carpets/rugs/upholstery for colourfastness and pile distortion.
- Only Vax recommend tools and solution should be used with this carpet washer. Using other solutions may invalidate the guarantee.

Please keep instructions for further use.



Don'ts

- ✗ Don't leave the carpet washer plugged in when unattended.
- ✗ Don't use this carpet washer if it has been dropped, damaged or left outdoors.
- ✗ Don't run over the power cord or use carpet washer if the power cord or plug is damaged. Please contact our Customer Care Line on: 0844 4128 455 (Mon-Fri 8:30am to 6:00pm, Sat 09:00am to 5:00pm)
- ✗ Don't use your carpet washer to pick up any flammable or combustible materials (lighter fluid, petrol, kerosene etc.) or use the carpet washer in an area with explosive vapours or liquid.
- ✗ Don't handle the plug or use the carpet washer with wet hands.
- ✗ Don't carry the carpet washer while it's switched on.
- ✗ Don't pull or carry this carpet washer by the power cord.
- ✗ Don't use the power cord as a handle, pull the power cord around corners, sharp edges or close a door over the power cord. Don't unplug carpet washer by pulling on the power cord.
- ✗ Don't use your carpet washer to pick up hot coals, cigarette butts, matches or smoking hot burning items or use in an area where there may be harmful fluids (chlorine, bleach, and ammonia drain cleaner).
- ✗ Don't attempt to remove blockages with sharp objects as this may cause damage to your carpet washer.
- ✗ Don't over saturate your carpet.
- ✗ Don't use the carpet washer with incorrect voltage as this may result in damage or injury to the user. The correct voltage is listed on the ratings label.



Do's

- ✓ Check with the manufacturer of your flooring prior to using the carpet washer
- ✓ The clean water tank should only be filled with warm water (max 40°C). Filling the clean water tank with hot or boiling water may damage your machine and invalidate your guarantee.
- ✓ Store your carpet washer in a cool, dry area. Before storing your carpet washer please ensure all water/solutions tanks and filters are thoroughly clean and dry.
- ✓ Always vacuum your carpets thoroughly before using your carpet washer.
- ✓ Always unplug the carpet washer before carrying out any maintenance and before connecting or disconnecting the hose/accessories.
- ✓ Turn off all controls on the carpet washer before disconnecting or connecting the power cord, after use always wrap the power cord around the cord clips provided.
- ✓ Always replace the fuse in the plug with a 13amp fuse. Always protect the power cable from heated surfaces or near open flames.
- ✓ Always keep the power cord away from the brushes whilst using your carpet washer.
- ✓ Use only CE approved 13amp extension cords, non-approved extension cords may overheat. Care should be taken to arrange the extension cord as it can be a trip hazard.
- ✓ Take extra care when cleaning on the stairs.
- ✓ Always use the carpet washer with all water/solution tanks and filters in place.
- ✓ Keep all openings clear and free from debris as this may affect the airflow/suction.
- ✓ Always use the carpet washer in an upright position. To prevent motor damage from dirty water, never hold the carpet washer upside down or lay on its side.

Thank you for buying this Dual Power.

Taking care of your carpets

The Dual Power is designed to make washing carpets regularly, as effective and efficient as possible and this user guide will help you get the most out of your machine.

Maintaining your carpets will ensure they keep their appearance for longer and smell fresh and clean. You've chosen carpets for your home for a reason and Vax will help you take good care of them.

Taking care of your Dual Power

Also inside this guide are instructions on maintaining your new machine, so that it's always ready when you are to tackle your carpets.

Taking care of you

We're here if you need us. Instead of taking me back to the shop, simply visit:

vax.co.uk/support or call:

(UK) **0844 412 8455** (ROI) 1-800 928 308

Monday-Friday 8.30am to 6.30pm, Saturday 9.00am to 5.00pm

Calls are charged at the UK local rate. Please make a note of the serial number and model number of the product before calling.

Alternatively, you can write to us at:

Vax Ltd., Kingswood Road, Hampton Lovett, Droitwich, Worcestershire, WR9 0QH, UK



You're home.™



Let us know what you think @VaxUK

Contents

Let's talk safety

Getting to know your machine

Getting started

Using your machine

Taking care of your machine

Let's talk technical

What to do if it goes wrong

Getting in touch

Accessories

Notes

Dual Power

Included with your machine

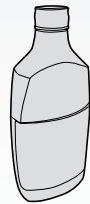

Vax Ultra+ Carpet Cleaning Solution



Wash tool

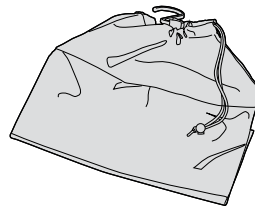

Accessory bag

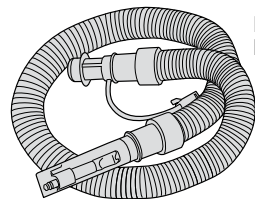

Long reach hose

Getting to know your machine

Handle

Carry handle

Clean water tank release button

Clean water tank

Dirty water tank handle

Dirty water tank

Hose connector

Solution port

Dual rotating brushbars

Solution trigger (hidden)

Cord storage hooks

Power cable

On/off pedal

Cord storage hooks

Handle release pedal

Wheels

Technical Specification

Name **Dual Power**

Code **W86-DP-R**

Part Number **1-1-133342-00**

Voltage **220-240V ~50Hz**

Wattage **800W**

Cord length **8m**

Weight **6.6kg**

Subject to technical change without notice.

PLEASE READ 'LET'S TALK SAFETY' AT THE BEGINNING BEFORE USE

Assembling your carpet washer

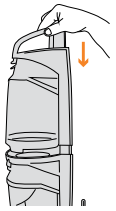

Stand base in upright position and lower top section to connect onto base

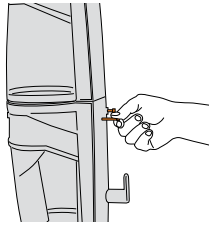

Assemble the two lower handle screws and tighten with a cross/flat head screwdriver.

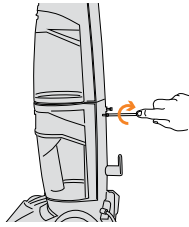

Slide handle down onto unit.

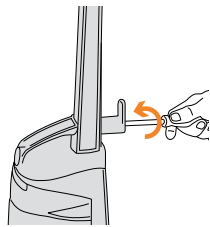
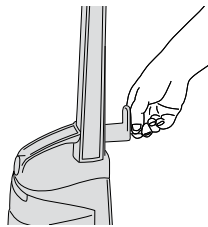
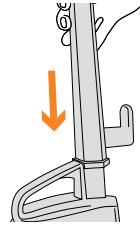

Assemble the upper handle screw and tighten with a cross/flat head screwdriver

Before you begin cleaning

- **IMPORTANT:** Carpets should be dry vacuumed thoroughly before washing
- Test for colourfastness – Wet a white absorbent cloth with the solution. In a small hidden area of your carpet/rugs/upholstery gently rub with the dampened cloth. Wait ten minutes and check for colour removal or bleed with white paper towel or cloth. If your carpet has more than one colour, check all colours
- Test your carpet/rugs/upholstery – Run the carpet washer over a small hidden area. If no pile distortion occurs continue cleaning
- Don't over saturate your carpets.
- When using the carpet washer, basic safety precautions should always be observed
- **IMPORTANT:** Only use Vax carpet solution. Using other solutions may cause excess foaming and may invalidate your warranty
- **IMPORTANT:** The clean water tank should only be filled with warm water (max 40°C). Filling the clean water tank with hot/boiling water may damage your machine and invalidate your warranty.
- **CAUTION:** This is a powerful carpet washer, before plugging in make sure all controls are turned off also hold carpet washer firmly when starting and during use.



When cleaning an entire room, move furniture out of the area to be cleaned. If the furniture is too heavy to move, place aluminium foil or wax paper under legs. This will prevent wood finishes from staining your carpet. Pin up furniture skirts and curtains.

Operating your carpet washer

Your dirty water tank is fitted with a float. When the dirty water tank is full or the floor head is not in contact with the carpet the float will shut off the suction at the floor nozzle. You will be able to hear if this has happened as the motor noise on the unit will increase. Once the float is activated, empty the dirty water tank if full. If the dirty water tank is not full then turn off your machine at the power switch and wait for the float to settle.

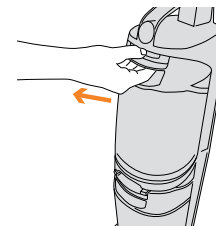

Remove clean water tank

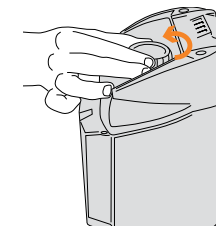
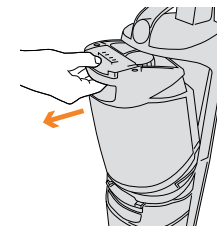

Unscrew the clean water tank cap from the top of the clean water tank.

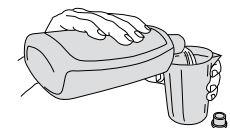

Pour required dose of carpet cleaning solution (approx.40ml per 1.0L of water) and pour into tank.

Operating your carpet washer

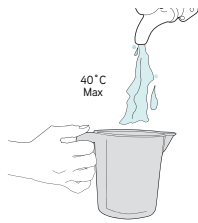

Mix solution with warm water. (40°C Max)

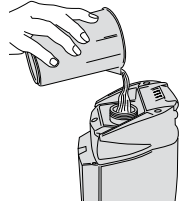

Fill clean water tank with solution mix.



Tighten cap before returning tank to unit.

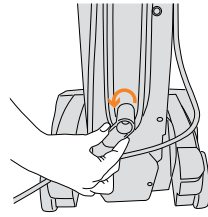

Unwrap power cord and plug unit in.

Picking up spills

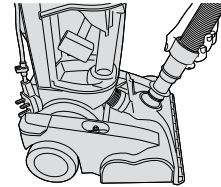

Remove the long reach hose from the accessory bag.

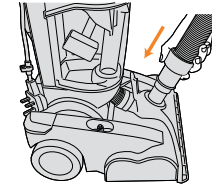

Plug the long reach hose into the front of the cleaner.

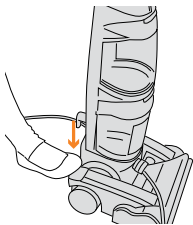

Turn the machine on.

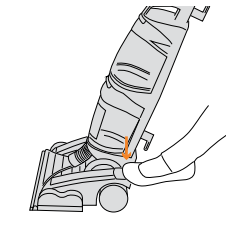

Recline the machine.

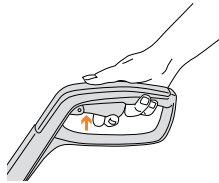

Press trigger to release solution.

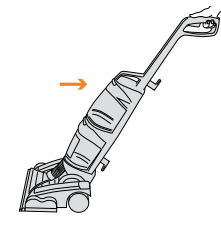

For best results apply solution on the forward stroke and release the trigger to recover solution on the backward stroke.

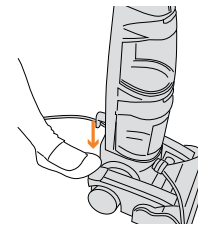

Turn the machine on.

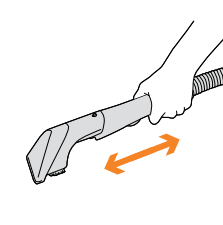

Pull wash tool over spill to pick up liquid.

Carpets should be dry vacuumed thoroughly before washing.

Using the wash tool

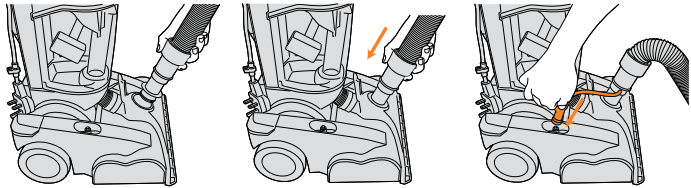

Remove the long reach hose from the accessory bag.

Plug the long reach hose into the front of the cleaner.

Plug the solution tube, from the long reach hose, into the solution port.

For large spills use the carpet washer

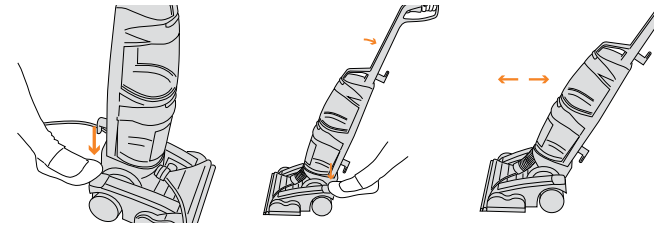

Turn the machine on.

Recline the machine.

For best results use straight parallel strokes.

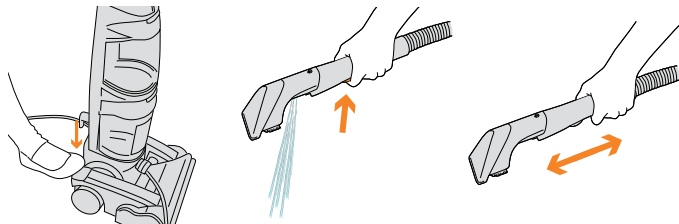

Turn the machine on.

Press trigger to release solution.

Pull wash tool over treated area to pick up solution.



Emptying the dirty water tank

IMPORTANT: All solution must be emptied from tanks when storing the machine
NOTE: Rinse out tank with clean water and leave to air dry before storing your machine

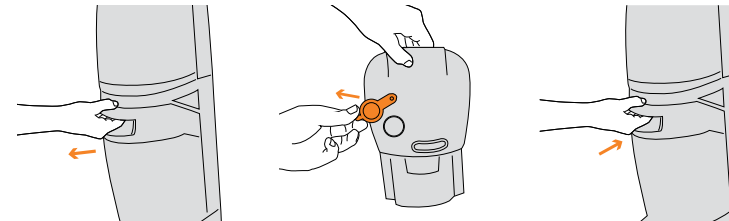

Remove dirty water tank

To empty the tank, unplug the quick spout pour cap and empty.

Insert dirty water tank back into the cleaner

Do not over saturate your upholstery. The clean water tank will need to be filled with solution and water before use.

For best results apply solution on the forward stroke and release the trigger to recover on the backward stroke.

! WARNING

Always switch off and unplug the carpet washer from the electrical outlet before assembling, filling and emptying the clean water tank, emptying the dirty water tank, or before connecting / disconnecting the attachments.

Cleaning the dirty water tank

IMPORTANT: Be sure to remove any debris that has accumulated in the screen above the float. If the screen becomes clogged, this may reduce the performance of your cleaner.

IMPORTANT: For full suction it is important that the quick pour cap is securely in place. If misplaced, suction will be severely affected.

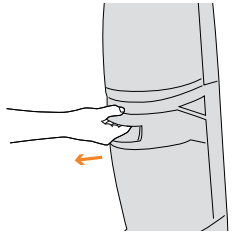

Remove dirty water tank

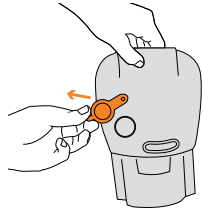

Open quick spout pour cap and partially fill dirty water tank with clean water and swirl around to loosen debris

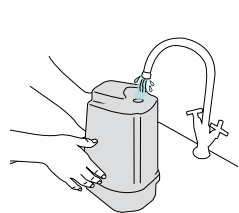
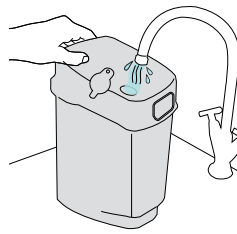

To clean dirty water tank ducting, place dirty water tank under a tap and dispense high pressure clean water into the inlet port of the dirty water tank to loosen debris that has accumulated

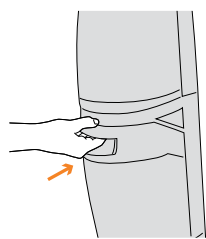

Allow tank to dry completely, replace quick spout pour cap and insert dirty water tank back onto unit



Storage

Empty and rinse out clean and dirty water tanks and leave to air dry before replacing. Do not leave solution stored in the tanks between uses.

During normal use of cleaning, debris may accumulate inside the dirty water tank. In order to keep your unit functioning properly and to prevent any odours building up, it is best to rinse out your dirty water tank with fresh water after each use.

Removing blockages from the brushbar

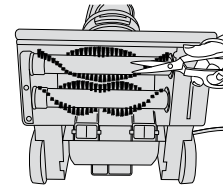

Threads caught in the brushbar can be cut.



WARNING

To reduce the risk of electric shock, turn the machine off and unplug from electrical socket before performing maintenance/troubleshooting checks.

Replacing the belt or brushbars

WARNING: Do not open the motor cover.

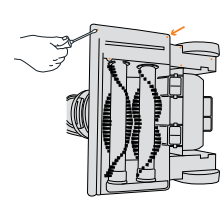

Use a crosshead screwdriver to remove the seven screws.

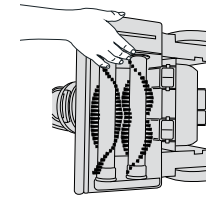

Remove belt cover from unit. NOTE: Wheel is intended to be removed with belt cover.

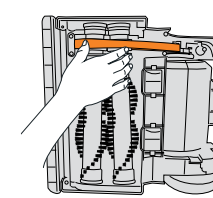

Pull both brushbars towards user to remove from unit.

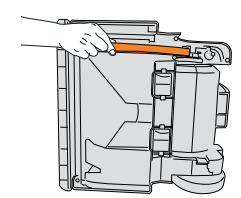

Remove and dispose of old belt.

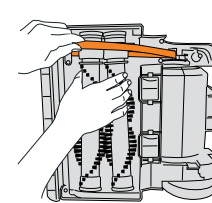

To replace belt, slip the brushbars through the belt. NOTE: Place belt on rounded areas of brushbars without bristles.

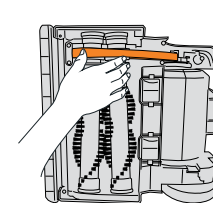

With the belt in place, pull and slide the brushbars into the unit, making sure the brushbar end caps are in the correct position.

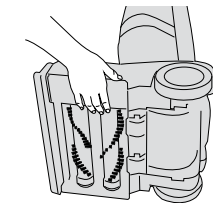

Place new belt on motor shaft. Replace belt cover and secure by replacing all screws.

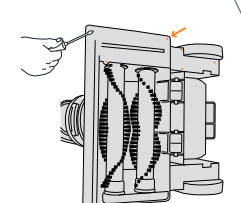

Problem

Solution

Why won't my carpet washer turn on?

- The plug may not be fully pushed into the electrical socket.
- Check the fuse in the plug if this needs replacing, always replace with a 13amp fuse

Why won't the solution/clean water dispense?

- Make sure the clean water tank is fitted securely
- The clean water tank valve may be stuck, hold the clean water tank over the sink and press the valve underneath to release

Why won't my carpet washer pick up?

- The float in the dirty water tank may have been activated. Empty the dirty water tank wait for the float to settle before re-starting your carpet washer
- Check the dual spin power brushes for blockages and clear
- The dirty water tank may not be fitted correctly, also make sure the lid is pushed down securely
- Check the nozzle for blockages and clear

Why won't the brushes spin?

- Check the power brushes for blockages and clear
- Check the belt Go to 'Replacing the belt or brushbars'

Warning: Always switch off and unplug the carpet washer from the electrical outlet before assembling, filling and emptying the clean water tank, emptying the dirt water tank, or before connecting/disconnecting the attachments.

Important: Carpets should be dry vacuumed thoroughly before washing.

Caution: The carpet washer is a very powerful unit. Before plugging the cord into the electrical outlet, make sure all controls on the unit are turned off. Hold the carpet washer firmly when starting and in use.

Important: The motor is equipped with a thermal cut-out. If for any reason the unit should overheat, the thermostat will automatically turn the unit off. Should this occur, unplug the carpet washer from the electrical outlet and turn off the switch. Check the hose for blockages. Clean the filters. Allow the unit to cool for approximately one hour. To re-start the machine, plug it into an electrical outlet and switch it back on.



* Calls are charged at the UK local rate. Please make a note of the serial number and model number of the product before calling.

Don't forget your solution!

Order at: www.vax.co.uk/spares-and-solutions

Ultra+ Pet Carpet Cleaning Solution (1.5L) (1-9-132707-00)

Our best ever deep cleaning performance on carpets and upholstery. Ultra+ Pet Carpet Cleaning Solution tackles stubborn spots and stains and removes unpleasant pet odours too.

Pre Treatment Trigger Spray (500ml) (1-9-131929-00)

Ideal for use on carpets and upholstery. Use this spray before washing your carpets to loosen stubborn stains and embedded dirt. It is perfect for those high traffic areas, removing dirty foot prints and muddy paw prints.

Post Treatment Trigger Spray (500ml) (1-9-131930-00)

Ideal for use on carpets and upholstery. Use this spray after washing your carpets to protect your carpets. It contains an anti-resoil agent to protect carpet fibres and keep them cleaner for longer after cleaning.





You're home.™



@VaxUK

Vax Ltd., Kingswood Road, Hampton Lovett, Droitwich, Worcestershire, WR9 0QH, UK
email: info@vax.co.uk website: vax.co.uk

Version 2.0



EEC Statement of Compliance: Manufacturer/EEC importer: Vax Limited, hereby on our own responsibility, declare that the Dual Power series is manufactured in compliance with the following Directives:
Safety: 2006/95/EC Low Voltage Directive. **EMC:** 2004/108/EC Electromagnetic Compatibility Directive



Waste electrical products should not be disposed of with household waste. Please recycle where facilities exist.
Check with your Local Authority or retailer for recycling advice.