

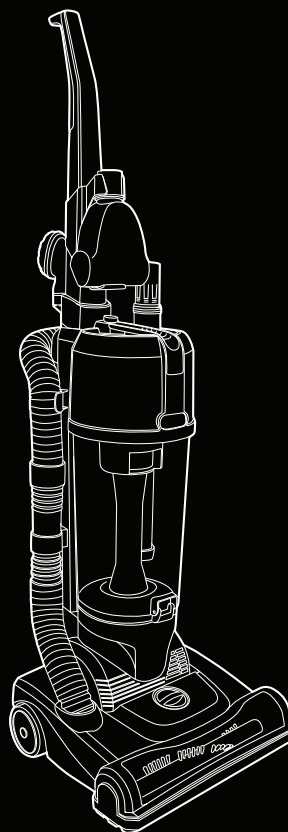

# User Guide

Vax Careline: (UK) 0844 412 8455  
(ROI) 1-800 928 308

## Bagless Upright V-2300U



### Get Cleaning...

What's your Vax model number? (Located on the top flap of the packaging)

e.g. U88-VU-T-A

What's your serial number? (Located on the base of the machine)

Note these down in case you need them in future. Please keep instructions for further use.



# Machine Overview

- 1 Handle
- 2 TurboTool caddy (some models only)
- 3 Dirt container release button
- 4 Carry handle
- 5 Dirt container lid
- 6 Separator
- 7 Dirt container
- 8 Pre-motor filter housing
- 9 Brushbar height adjust
- 10 Cord storage hook
- 11 Cord
- 12 Cord safety hook
- 13 Hose storage
- 14 Power on/off button
- 15 Recline pedal
- 16 Hose
- 17 Extension tube
- 18 Crevice tool
- 19 Dusting brush
- 20 TurboTool (some models only)
- 21 Flexi crevice tool (some models only)
- 22 Flat nozzle/upholstery tool (some models only)
- 23 Pre-motor filter
- 24 Fur 'n' Fluff tool

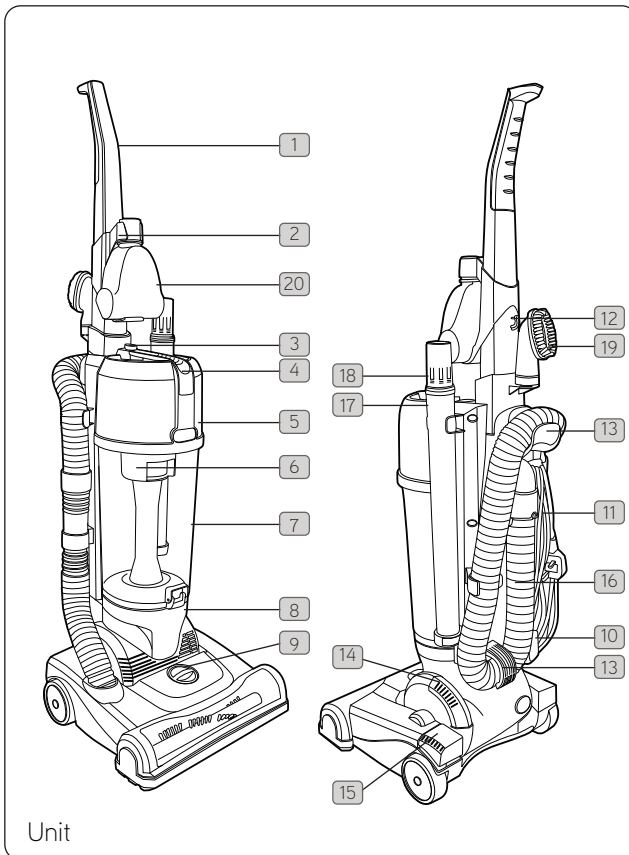

PLEASE NOTE: some parts may vary according to model. Please check inside flap of box for more details.

## Accessories

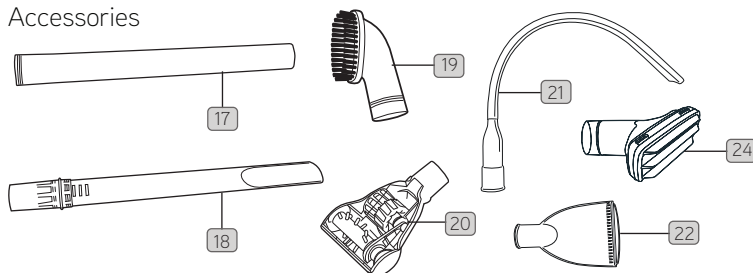

## Filters

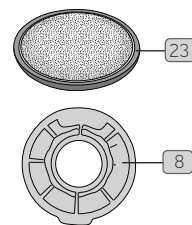



# General Safety Information

## FOR HOUSEHOLD USE ONLY.

When using the vacuum cleaner, basic safety precautions should always be observed, including the following:

1. Only use the vacuum cleaner indoors on dry surfaces.
2. Turn off the vacuum cleaner controls before disconnecting or connecting from the mains supply.
3. Always unplug the vacuum cleaner before connecting or disconnecting the vacuum hose and accessories.
4. Children should be supervised to ensure that they do not play with the appliance.
5. This appliance is not intended for use by persons (including children) with reduced physical, sensory or mental capabilities, or lack of experience and knowledge, unless they have been given supervision or instruction concerning use of the appliance by a person responsible for their safety.
6. Use only as described in this manual. Use only Vax recommended attachments.
7. Do not use the vacuum cleaner if it has been dropped, damaged, left outdoors or dropped into water. Do not use the vacuum cleaner with a damaged cord or plug. If the supply cord is damaged, it must be replaced by the manufacturer or a recommended Service Agent to avoid hazard and invalidating the guarantee.
8. Do not pull or carry by cord/hose. Do not use the cord/hose as a handle, close a door on the cord/hose or pull cord/hose around sharp edges or corners. Do not run the vacuum cleaner over the cord/hose. Keep the cord away from heated surfaces.
9. Do not handle the plug or vacuum cleaner with wet hands. Do not use outdoors or on wet surfaces.
10. Do not put any objects into openings. Do not use with any openings blocked and do not restrict air-flow. Keep all openings free of dust, lint, hair or anything that might reduce airflow.
11. Keep hair, loose clothing, fingers and all parts of the body away from openings and moving parts.
12. Do not pick up hot coals, cigarette butts, matches or any hot, smoking or burning objects.
13. Do not pick up flammable or combustible materials (lighter fluid, petrol, kerosene etc.) or use in the presence of explosive liquids or vapours.
14. Do not vacuum up harmful or toxic material (chlorine, bleach, ammonia, drain cleaner etc.).
15. Do not vacuum up hard or sharp objects such as glass, nails, screws, coins, etc.
16. Do not use without ALL of the filters in place.
17. Take extra care when vacuuming on stairs.
18. Keep vacuuming area well lit.
19. Store the vacuum cleaner in a cool, dry area.
20. Turn off the on/off switch before unplugging the vacuum cleaner
21. Use only CE-approved 13 amp extension cords. Non-approved cords may overheat. Care should be taken to arrange the cord so that the cord cannot be tripped over.



**WARNING:** Always switch off and unplug the vacuum cleaner from the electrical outlet before assembling, opening or emptying the dirt container, or before connecting/disconnecting the attachments.



**CAUTION:** The vacuum cleaner is a very powerful unit. Before plugging the cord into the electrical outlet, make sure the switch is in the 'off' position.



**IMPORTANT:** If the inlet, hose or telescopic tube is blocked, switch off the vacuum cleaner and remove the blockage(s) before re-starting the vacuum cleaner. See Maintenance; Clearing Blockages.



**IMPORTANT:** Cleaning filters maintains vacuum performance. Vax recommends that your filters should be checked and cleaned periodically. If your filters are washable make sure they are completely dry before inserting back into the vacuum cleaner.



**IMPORTANT:** The motor is equipped with a thermal cut-out. If for any reason the unit should overheat, the thermostat will automatically turn the unit off. Should this occur, unplug the vacuum cleaner from the electrical outlet and turn off the switch. Remove dirt container and empty. Clean filters. Allow the unit to cool for approximately one (1) hour. To re-start, plug into an electrical outlet and switch back on.

**This vacuum cleaner is intended for household use only and NOT for commercial or industrial use.**

**PLEASE KEEP INSTRUCTIONS FOR FURTHER USE.**



# Operation

## Keep your Vax like new



**!** **IMPORTANT:** The condition of the filters affects the performance of your machine. For best cleaning results, filters require cleaning at least every three months. For full cleaning instructions, see page 7.

**!** **IMPORTANT:** Do not use the vacuum cleaner without all of the filters in place.

## Assembling your vacuum cleaner

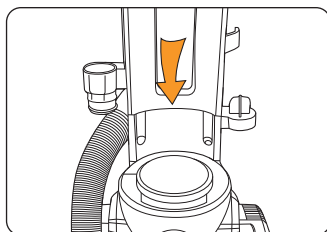

Push the lower back panel onto the base of the unit.

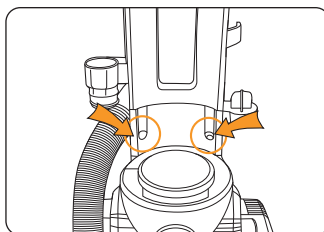

Secure with the two long screws provided.

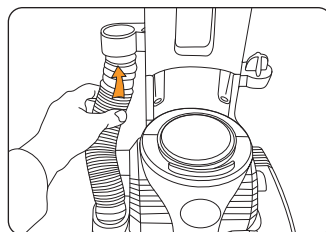

Slide end of the hose into the hose connector.

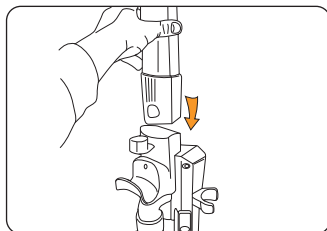

Attach handle to the back panel by pushing down firmly.

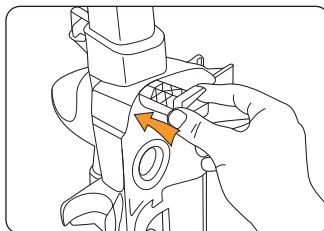

Insert locking pin into place at the bottom of the handle.

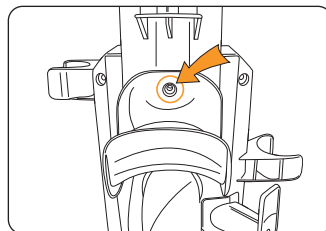

Secure locking pin with the small screw provided.

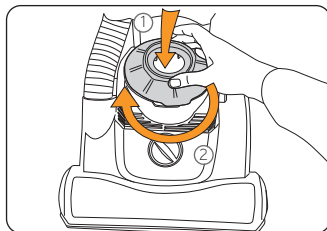

Place pre-motor filter and holder onto the base of the unit.

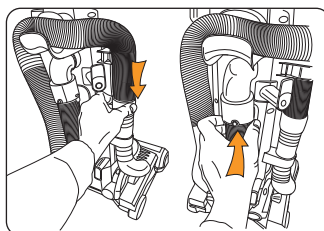

Connect hose.

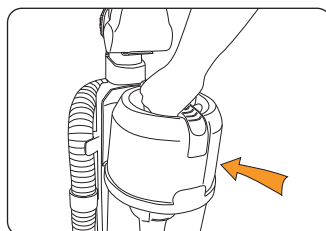

Attach dirt container and click into place.

# Operation

## Operating the appliance

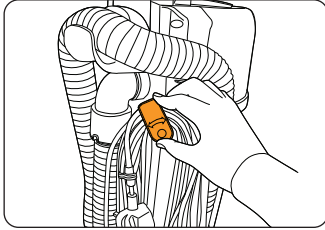

Twist cord storage hook to release cord.

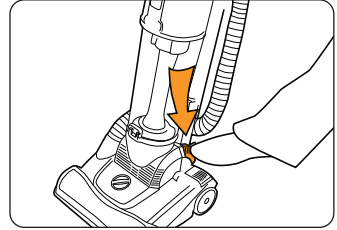
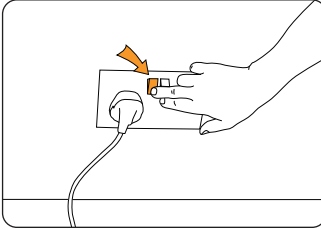

Turn unit on.

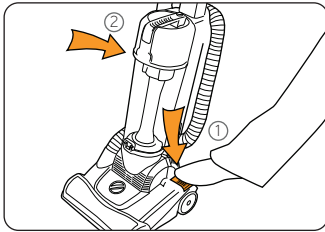

Recline unit.

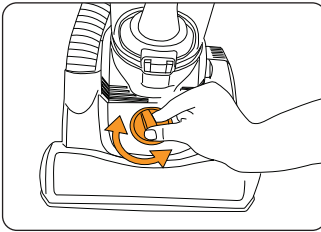

In upright position turn brushbar height adjust to desired setting.

**High** - long carpet pile and hard floors  
**Low** - short carpet pile

**! IMPORTANT:** When the vacuum cleaner is stood in the upright position or when using the hose and tools, the brushbar height adjust must be set to the highest position.

**! IMPORTANT:** Vax recommends that you raise the height of the brushbar to the highest position when using this cleaner on lino and hard flooring due to constant rotation. Vax cannot be held responsible for damage to these surfaces if the customer fails to take notice of this recommendation.

# Operation

## Using accessories

**NOTE:** The crevice tool and TurboTool can be attached to both extension tube and hose directly.

**NOTE:** The dusting brush can only be attached to the hose directly.

**NOTE:** This unit has a constantly rotating brushbar. Vax recommends you raise the brushbar before attaching accessories.

## Attaching to hose

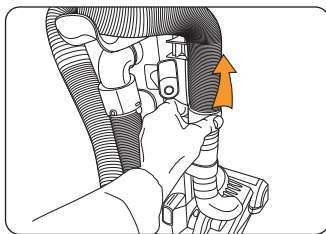

Remove hose from its holder and unwind hose from unit.

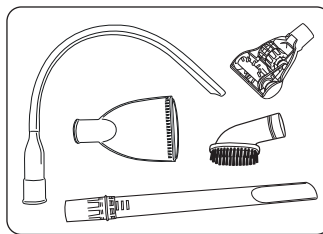

Choose an accessory.

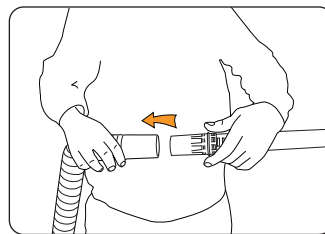

Attach accessory to hose.

## Attaching to extension tube

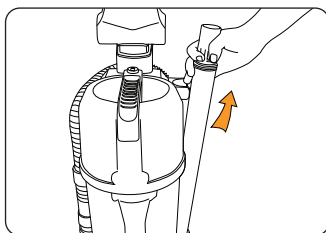

Remove extension tube from holder.

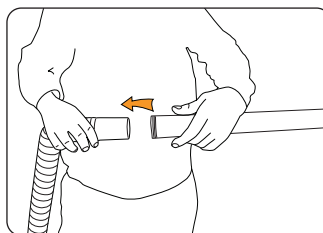

Attach extension tube to hose.

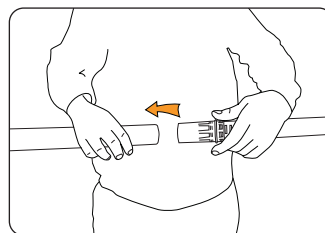

Attach accessory to extension tube.

# Maintenance (Keep your Vax as good as new)

## Emptying and cleaning the dirt container

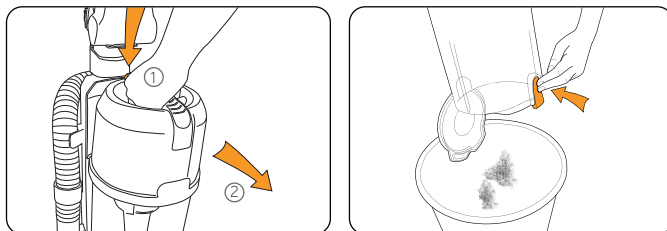

## Cleaning the HEPA pre-motor filter

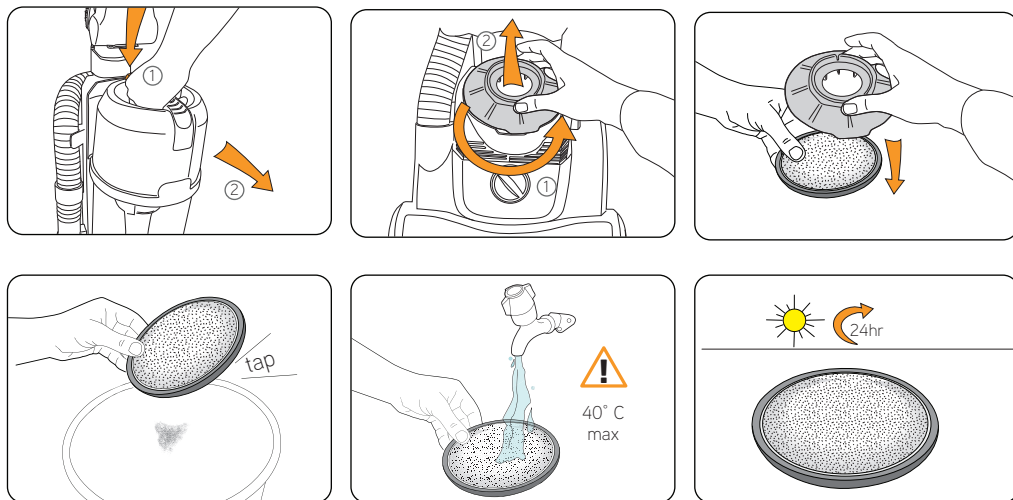

**NOTE:** Wash filters with warm water (40° C max) at least every 3 months for best cleaning results.

# Maintenance (Keep your Vax as good as new)

## Advanced filter cleaning

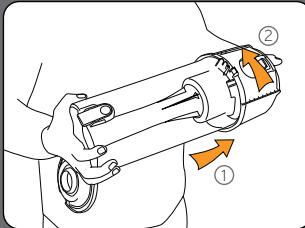
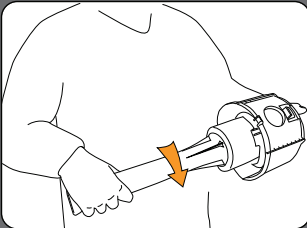
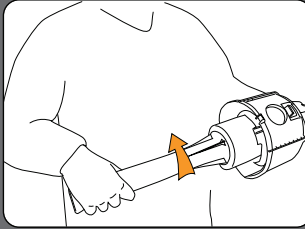
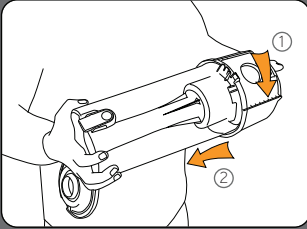



# Maintenance (Keep your Vax as good as new)

## Removing blockages



**WARNING:** To reduce the risk of electric shock, turn the vacuum cleaner off and unplug from the electrical outlet before performing maintenance/troubleshooting checks. Disconnect the hose from the vacuum cleaner and remove any blockages found then reconnect the hose securely.

## Removing blockages from the brushbar

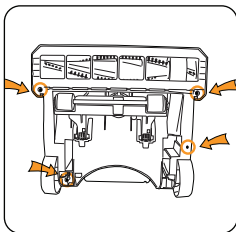

Unscrew the four screws on the base of unit.

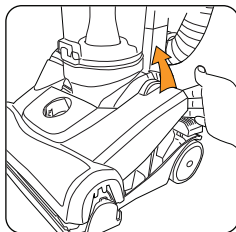

Remove floor nozzle cover.

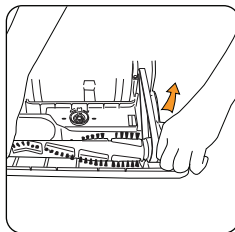

Lift brushbar.

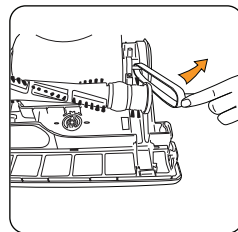

Remove the belt from the end of the brushbar.

## Removing blockages from the TurboTool (some models only)

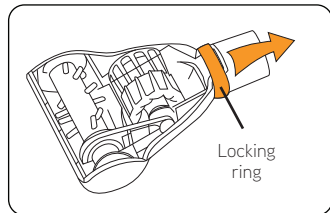

Turn the TurboTool over and slide off the locking ring.

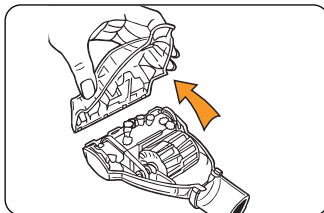

Detach lower housing and remove blockage.

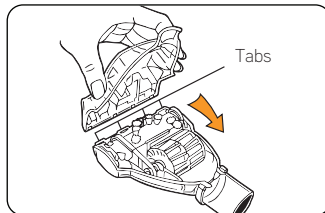

To re-assemble the TurboTool, ensure that the tabs are engaged and pivot the lower housing closed. Slip the locking ring over the neck of the TurboTool and into the groove to finish.

# FAQs



**WARNING:** to reduce the risk of personal injury, unplug the vacuum cleaner before performing maintenance/troubleshooting checks.

## Is there an accessory missing?

- Check the 'Parts Overview' page in this guide to make sure the part is definitely included in your unit.
- If it is missing, we're here to help. Simply call us on **0844 412 8455**

## Why won't the vacuum cleaner pick up?

- The dirt container may be incorrectly installed; remove the dirt container from the unit by pressing the dirt container release button and then re-attaching it to the unit, ensuring it is locked firmly back into place.
- The filter may be clogged; refer to 'Maintenance: Cleaning the filters' on page 7.
- The dirt container may be blocked; refer to 'Maintenance: Emptying and cleaning the dirt container' on pages 7 and 8.
- There may be a blockage in the hose/tube; disconnect from the vacuum cleaner. Carefully remove any blockages found and reconnect securely.

## Why is dust escaping from the vacuum?

- The filter may be clogged; refer to 'Maintenance: Cleaning the filters' on pages 7 and 8.
- The dirt container may be blocked; refer to 'Maintenance: Emptying and cleaning the dirt container' on page 7.
- The dirt container may be incorrectly installed; remove the dirt container from the unit by pressing the dirt container release button and then re-attaching it to the unit, ensuring it is locked firmly back into place.

## What do I do if the unit/an accessory becomes damaged or broken?

- We're here to help. Simply call **0844 412 8455** or visit [vax.co.uk](http://vax.co.uk)

## Why won't the accessories pick up properly?

- **Hose blockages:** remove the hose from the unit. Carefully remove any blockages found and reconnect hose securely.
- **Accessory blockages:** remove accessory from handle/tube. Carefully remove blockage and re-attach to the vacuum cleaner.
- The accessory may be faulty. Simply call us on **0844 412 8455** for assistance.

## Why will the vacuum cleaner not run?

- It may not be plugged into the electrical outlet correctly; ensure that the plug is pushed in securely.
- The electrical outlet may not be working properly; check the fuse or breaker, or consult an electrician.
- The motor thermostat may have tripped; switch off and unplug the vacuum cleaner, and leave for one hour before switching the cleaner back on.

## we're here to help

Instead of taking me back to the shop, simply call:

**(UK) 0844 412 8455**

**(ROI) 1-800 928 308**

[vax.co.uk](http://vax.co.uk)

[vaxireland.ie](http://vaxireland.ie)

This does not affect your statutory rights

# Other Information

## UK Service & Help

Vax Customer Careline 0844 412 8455

Monday-Friday 8.30am to 6.30pm

Saturday 9.00am to 5.00pm

If you have any queries about using your Vax, call the Vax Careline. Calls are charged at the UK national rate. Please make a note of the serial number and model number of the carpet cleaner before calling. For the nearest Service Agent, please call the Vax Customer Careline or visit [vax.co.uk](http://vax.co.uk)

## Consumables

To purchase spares and accessories, please visit [vax.co.uk](http://vax.co.uk)

Pre-Motor filter (Type B): 1-1-130851-00

## Technical Specification

Voltage: 220-240V ~50Hz  
 Wattage: 2300W  
 Capacity: 5L  
 Filters: pre-motor filter (washable)  
 Cord length: 10m (approx)  
 Weight: 8.7kg - 8.9kg (depending on model)

Subject to technical change without notice.

## EEC Statement of Compliance

Manufacturer/EEC importer: Vax Limited, hereby on our own responsibility, declare that the U87, U88-VU series is manufactured in compliance with the following Directives:

**Safety:** 2006/95/EC Low Voltage Directive

**EMC:** 2004/108/EC Electromagnetic Compatibility Directive



Waste electrical products should not be disposed of with household waste. Please recycle where facilities exist. Check with your Local Authority or retailer for recycling advice.



Vax Ltd., Kingswood Road, Hampton Lovett, Droitwich, Worcestershire, WR9 0QH, UK  
email: [info@vax.co.uk](mailto:info@vax.co.uk) - website: [vax.co.uk](http://vax.co.uk)

Version 1.0