

# HOME

**16 INCH PEDESTAL &  
DESK FAN DIGITAL  
INSTRUCTION MANUAL  
Model No. FS40-18BRA**

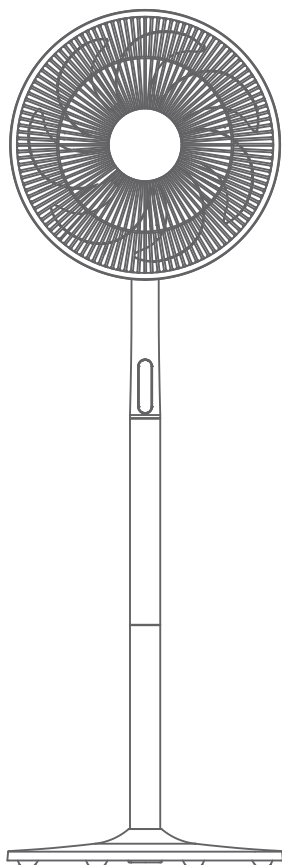

## **CAUTION**

Read all instructions before using this appliance. Carefully retain these instructions for future reference.

## **WARNING**

- If the supply cord is damaged, it must be replaced by manufacturer, its service agent or a similarly qualified person in order to avoid a hazard.
- This appliance can be used by children aged from 8 years and above and persons with reduced physical, sensory or mental capabilities or lack of experience and knowledge if they have been given supervision or instruction concerning use of the appliance in a safe way and understand the hazards involved. Children shall not play with the appliance. Cleaning and user maintenance shall not be made by children without supervision.
- Keep electrical appliances out of reach from Children or infirm persons. Do not let them use the appliances without supervision.
- For indoor and household use only.
- When the fan was assembled, the rotor blade guard shall not be taken off anymore.
- To protect against the risk of electrical shock, do not disassemble the fan and do not immerse the unit, cord or plug in water or other liquid.
- When the appliance is not in use and before cleaning, unplug the appliance from the outlet.
- Trip Hazard. Beware of trailing cables when in use and while in storage.
- Strangulation Hazard. Children have STRANGLED in cords. Keep power cords out of reach of children. Never leave a cord positioned where a child could reach it.
- This appliance is not intended to be used in: staff kitchen areas in shops, offices and other working environments; farm houses; by clients in hotels, motels and other residential type environments; bed and breakfast type environments.
- Do not use in wet or damp locations.

# INSTALLATION INSTRUCTIONS

## Name of components

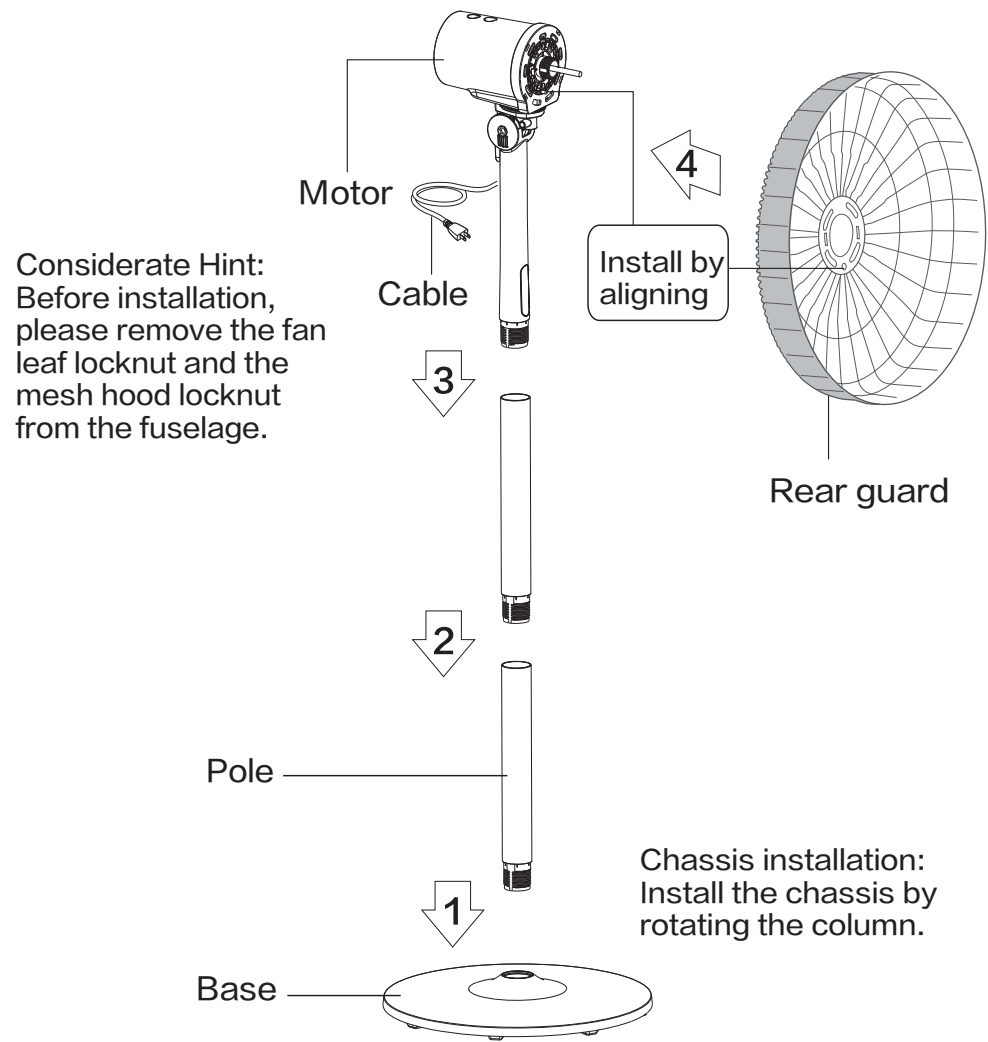

## Front and Rear Guard Installation

Align and buckle the Front Guard with the catch of the Rear Guard

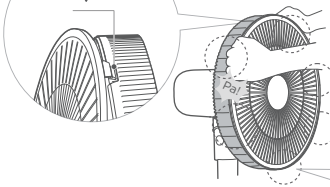

Press guards sequentially with both hands, it installed in place with the sound of "Pa", then fix it with a screw.

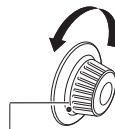
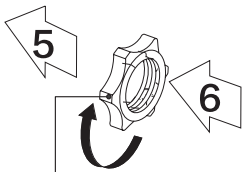
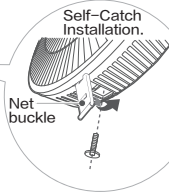

Front guard

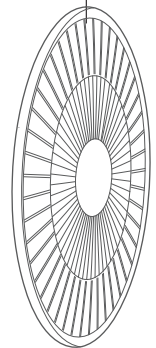

Blade

Lock nut of blade

- Lock nut of blade anticlockwise, and then install the front fan cover.

- Pull the blade to rotate after installing, so as to ensure that the blade can be normally rotated.



Lock nut of guard

- Screw the lock nut of guard clockwise, and in the meantime, fix the rear guard.

# INSTRUCTIONS FOR USE

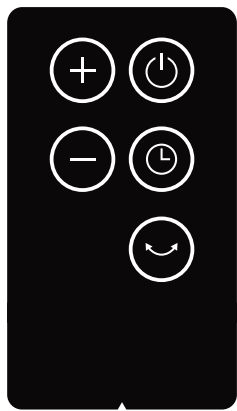
## Instructions for key of remote controller



	Start up/Standby key
+	“+” key
-	“-” key
	Timer key
	Swing key

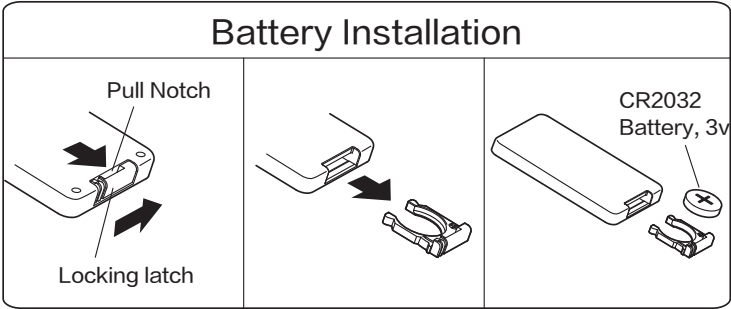

It uses one button battery of type "CR2032".

Considerate Hint:

1. Install the battery with positive side facing up.
2. Effective Range of Remote Control: within 5m distance and 30-degree deflection in front of Product.

# INSTRUCTIONS FOR USE

## Instructions for operation of body

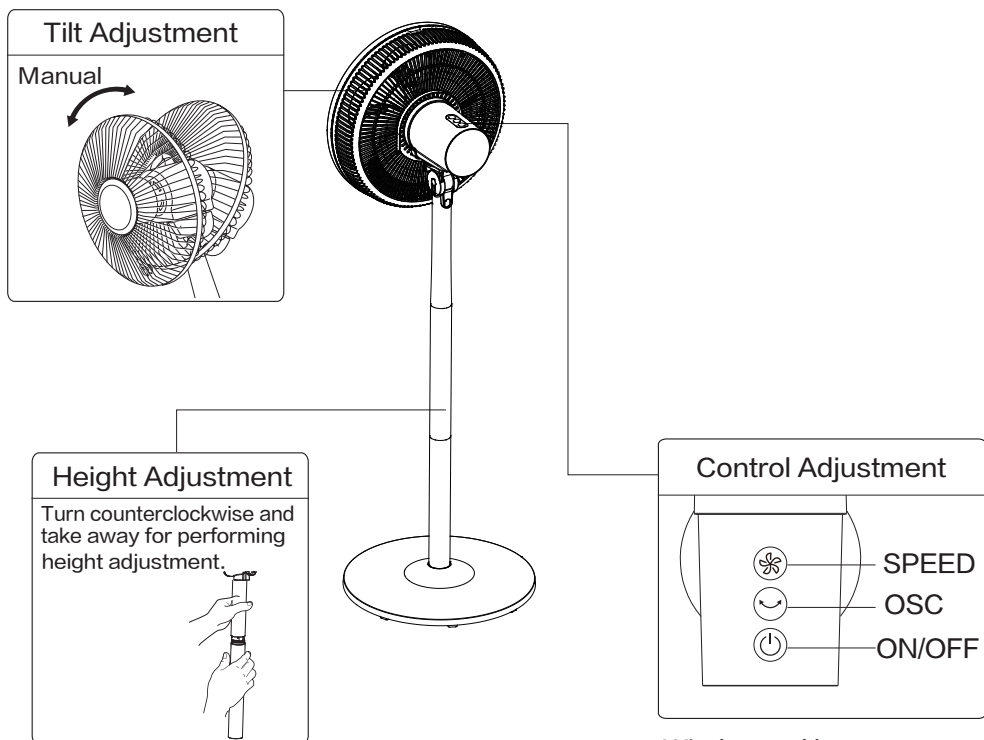

Wind speed key:  
short press the key to adjust  
the wind speed, long press  
the key for 2 seconds to set  
the timer.

## MAINTENANCE INSTRUCTION

The fan requires little maintenance. Do not try to fix it by yourself. Refer it to qualified service personnel if service is needed.

- Before cleaning and assembling, fan must be unplugged.
- To ensure adequate air circulation to the motor, keep vents at the rear of the motor free of dust. Do not disassemble the fan to remove dust.
- Please wipe the exterior parts with a soft cloth soaking a mild detergent.
- Do not use any abrasive detergent or solvents to avoid scratching the surface.
- Do not use any of the following as a cleaner: gasoline, thinner.
- Do not allow water or any other liquid into the motor housing or interior parts.

## CLEANING

- Be sure to unplug from the electrical supply source before cleaning.
- Plastic parts should be cleaned with a soft cloth moistened with mild soap. Thoroughly remove soap film with a dry cloth.

## Technical Specifications

Description	Symbol	Value	Unit
Model no.	--	FS40-18BRA	--
Voltage	--	220-240	VAC
Maximum fan flow rate	F	41.3	m <sup>3</sup> /min
Fan power input	P	45	W
Service value	S <sub>v</sub>	1.0	(m <sup>3</sup> /min)/W
Maximum air velocity	C	4.1	meters/sec
Off mode power consumption	P <sub>SB</sub>	0.2	W
Fan sound power level	L <sub>WA</sub>	58	dB(A)
Seasonal electricity consumption	Q	14.6	kWh/a
Measurement standard for service value	GB/T 13380-2007		
Contact details for obtaining more information	Customer helpline 0345 640 2020		

## CONNECTION TO POWER

Before Switching on make sure that the voltage of your electricity supply is the same as that indicated on the rating plate

### MAIN CORD

This appliance may be fitted with a non-rewireable plug.

If it is necessary to change the fuse in a non-rewireable plug the fuse cover must be refitted. If the fuse cover is lost or damaged, the plug must not be used until a replacement is obtained.

It is important that the color of the replacement fuse cover corresponds with the colour marking on the base of the plug.

If the plug has to be changed because it is not suitable for your socket, or becomes damaged, it should be cut off and an appropriate plug fitted following the wiring instructions below.

The plug removed must be disposed of safely as insertion into a 13A socket is likely to cause an electrical hazard. For your own safety read the following instructions carefully before attempting to connect this unit to mains.

The wires in this mains lead are coloured in accordance with the following code:

BLUE = NEUTRAL

BROWN = LIVE

### IMPORTANT

As the colours of the wire in the mains lead of this appliance may not correspond with the coloured markings identifying the terminals in your plug, proceed as following:-

The wire which is coloured blue must be connected to the terminal which is marked with the letter N or coloured black. The wire which is coloured brown must be connected to the terminal which is marked with the letter L or coloured red. No connection is to be made to the earth terminal of the plug.

If a 13 Amps (BS 1363) plug is used, it must be fitted with a 3 Amp Fuse conforming to BS1362 and be ASTA approved. If in doubt consult a qualified electrician who will be pleased to do this for you.

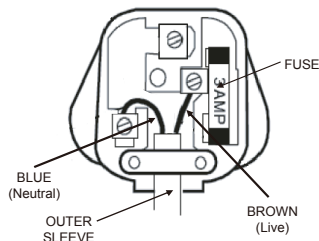

**DISPOSAL:** Do not dispose of electrical appliances as unsorted municipal waste, use separate collection facilities. Contact your local government for information regarding the collection systems available. If electrical appliances are disposed of in landfills or dumps, hazardous substances can leak into the groundwater and get into the food chain, damaging your health and well-being.



Produced in China and imported  
for

Argos Limited,  
489-499 Avebury Boulevard,  
Milton Keynes, MK9 2NW.



## PRODUCT GUARANTEE

This product is guaranteed against manufacturing defects for a period of



Year

This product is guaranteed for twelve months from the date of original purchase. Any defect that arises due to faulty materials or workmanship will either be replaced, refunded or repaired free of charge where possible during this period by the dealer from whom you purchased the unit.

The guarantee is subject to the following provisions:

- The guarantee does not cover accidental damage, misuse, cabinet parts, knobs or consumable items.
- The product must be correctly installed and operated in accordance with the instructions contained in this manual.
- It must be used solely for domestic purpose.
- The guarantee will be rendered invalid if the product is re-sold or has been damaged by inexpert repair.
- Specifications are subject to change without notice.
- The manufacturer disclaims any liability for the incidental or consequential damages.
- The guarantee is in addition to, and does not diminish your statutory or legal rights.

Guarantor: Argos Ltd  
489 - 499 Avebury Boulevard  
Central Milton Keynes  
MK9 2NW  
[www.argos-support.co.uk](http://www.argos-support.co.uk)





