

DOOR GASKET



PROCEDURE

GENERAL METHOD TO REPLACE GASKET

Step 1

Pull gasket out from the corner.



Step 2

Install a new gasket, starting from the corner.



Step 3

Make sure base of gasket is pressed into trough completely.



Step 4

Make sure gasket is properly aligned with edges of trough.

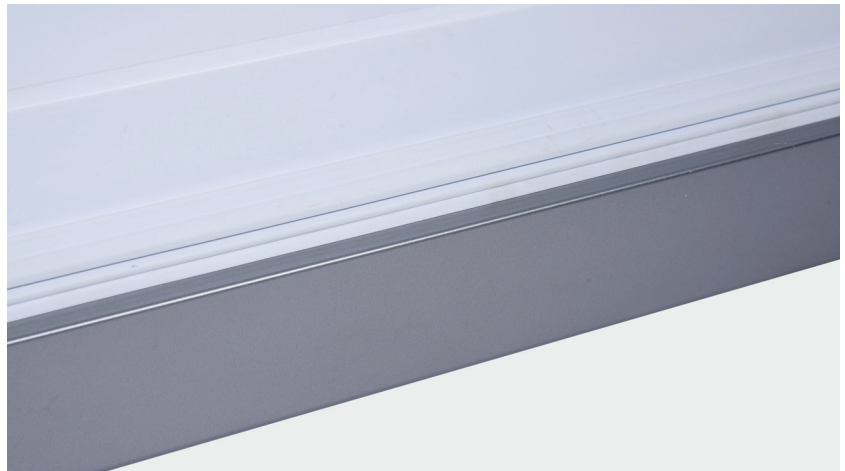

Step 5

After closing the door, make sure gasket is well attached to door.



Note

HANDLE

BUSH



PROCEDURE

GENERAL METHOD TO REPLACE THE HANDLE

Step 1

Unscrew handles with Hex wrench.

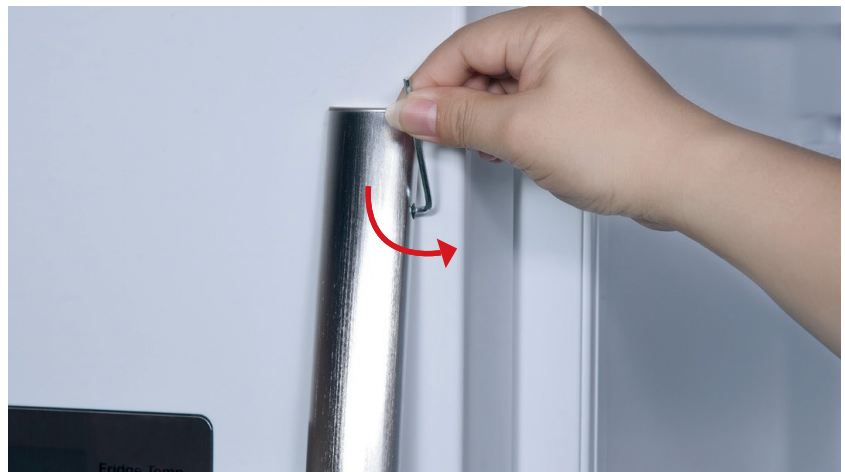

Step 2

Lift up the handle. Take away the handle.



Step 3

Replace the handle with new one.



Step 4

Tighten the handle screws.

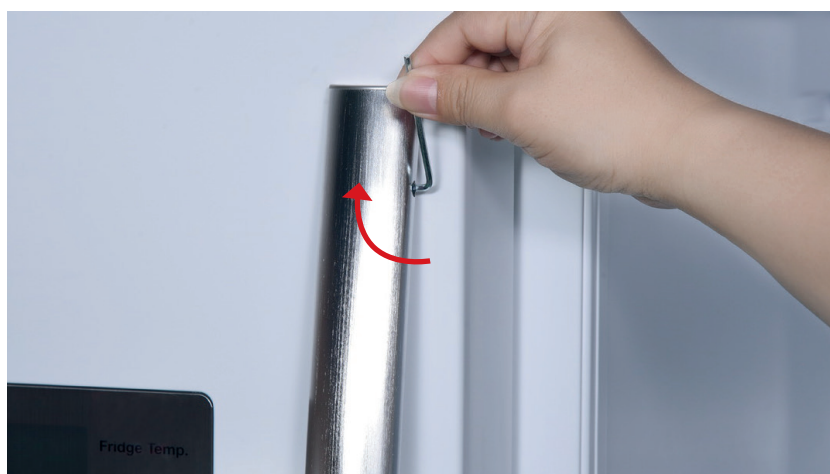

Note

HINGE AND DOOR

BUSH



TOOLS



6x300 Slotted Screwdriver

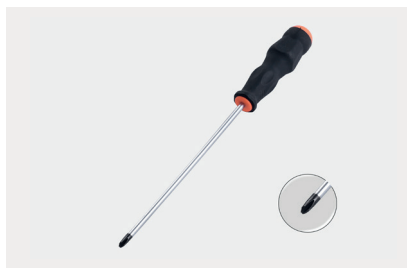

6x300 Cross-head Screwdriver

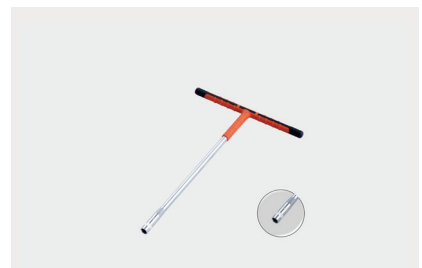

8mm Inner Hexagon Spanner



PROCEDURE 1

GENERAL METHOD TO DISASSEMBLE THE DOOR AND HINGE

THE METHOD IS SUITABLE FOR FRIDGE DOOR AND FREEZER DOOR.

Step 1

Unscrew hinge cover.



Step 2

Remove the cover.

**Step 3**

Disconnect the terminals.

**Step 4**

Unscrew 3 bolts and remove the top hinge.

**Step 5**

Remove the door.



Step 6

Tilt cabinet.

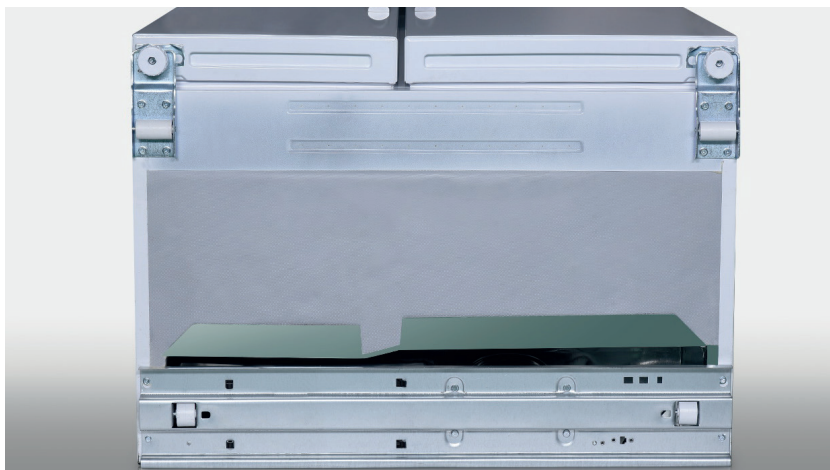
**Step 7**

Unscrew 4 bolts and remove bottom hinge.

**PROCEDURE 2**

REPLACE THE DOOR OR HINGE WITH NEW ONE.
REVERSE PROCEDURE 1 ABOVE TO REINSTALL IT, AND PAY
ATTENTION TO THE KEY POINTS BELOW.

Tip 1

When installing door onto hinge, please check the alignment between door-stopper and hinge.



Tip 2

Make sure gasket is attached well.

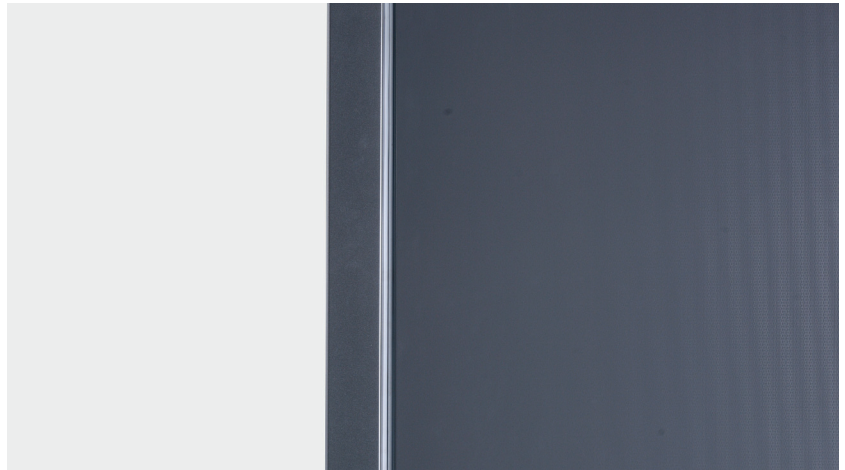

Tip 3

Make sure gaps between doors are even.



Note

This image shows a single sheet of white paper with horizontal ruling lines. The lines are evenly spaced and run across the width of the page. There are no margins or other markings on the paper.

INTERNAL ACCESSORIES

BUSH



DIAGNOSIS.

Drawer or crisper

Pull out and lift up to take it out.



Shelves

Lift up the inner side and pull out.

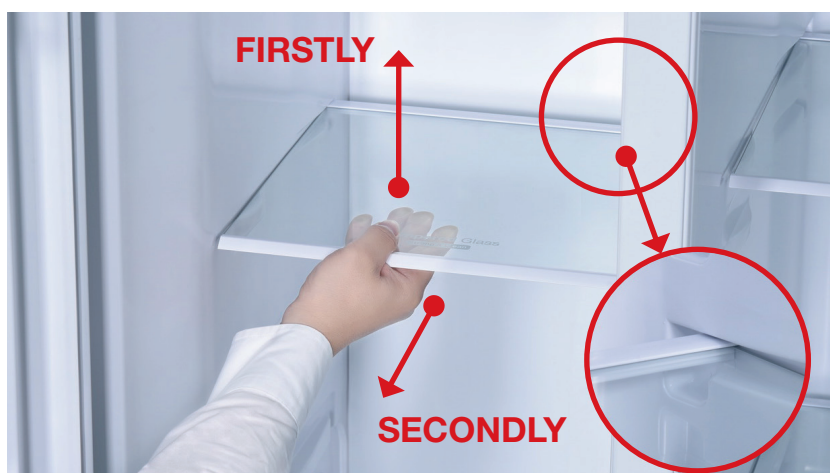

Balconies

Repeatedly alternate pushing left and right ends to remove balconies.



Tip

When install the new balconies, make sure the balconies are pushed into proper final position.

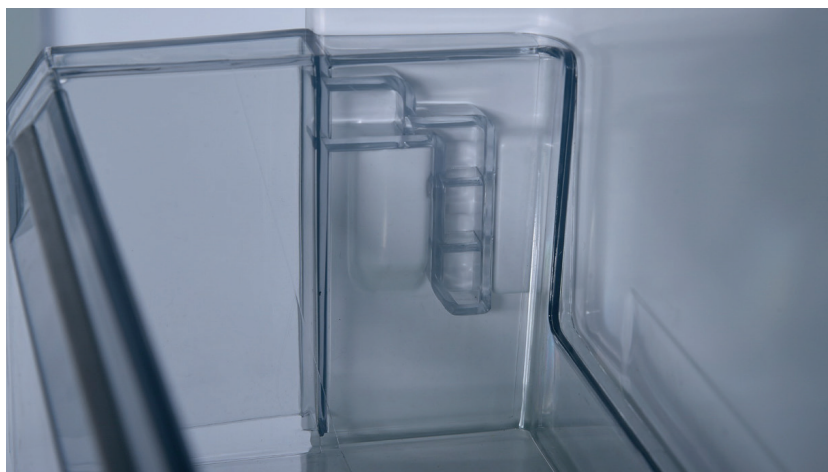

Note