

Jessie

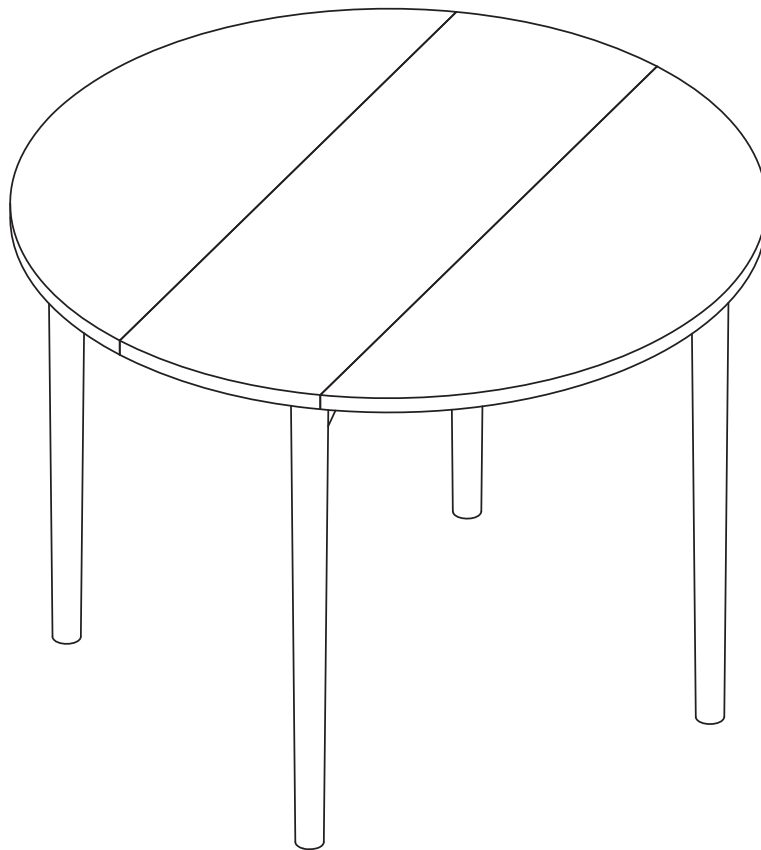

Spare Parts

 www.argos-support.co.uk

 Help@ClickSpares.co.uk

 0370 112 1928

Customer Support

 0345 640 2020



Safety and Care Advice

Product Details

Jessie Dropleaf Table Oak / 9593109

Jessie Dropleaf Table Walnut / 9623457

IMPORTANT, RETAIN FOR FUTURE REFERENCE: READ CAREFULLY.

- Keep children and animals away from the work area, small parts could choke if swallowed.
- Make sure you have enough space to layout the parts before starting.
- This product has been constructed to be used in the domestic environment only and not for commercial purposes.

- Assemble the item as close to its final position (in the same room) as possible.
- Assemble on a soft level surface to avoid damaging the unit or your floor.

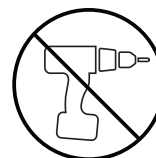

- We do not recommend the use of power drill/drivers for inserting screws as this could damage the unit. Only use hand screwdrivers.
- Parts of the assembly will be easier with 2 people.
- Dispose of all packaging carefully and responsibly.

Care and maintenance

- Only clean using a damp cloth and mild detergent. Do not use abrasive cleaners.
- Use a dry cloth to clean the product, furniture polish is not recommended.
- From time to time check that there are no loose screws, nuts or bolts. If there are please re-tighten.
- This product should not be discarded with household waste. Take to your local authority waste disposal centre.

Additional Guidance

- Assemble all parts and bolts loosely during assembly, only once the product is complete should you fully tighten the bolts.
- Regularly check and ensure that all bolts and fittings are tightened properly.
- Maximum loading weight 100kg
- This product is compliant EN12521

Fittings (Shown to scale)

Bag 1

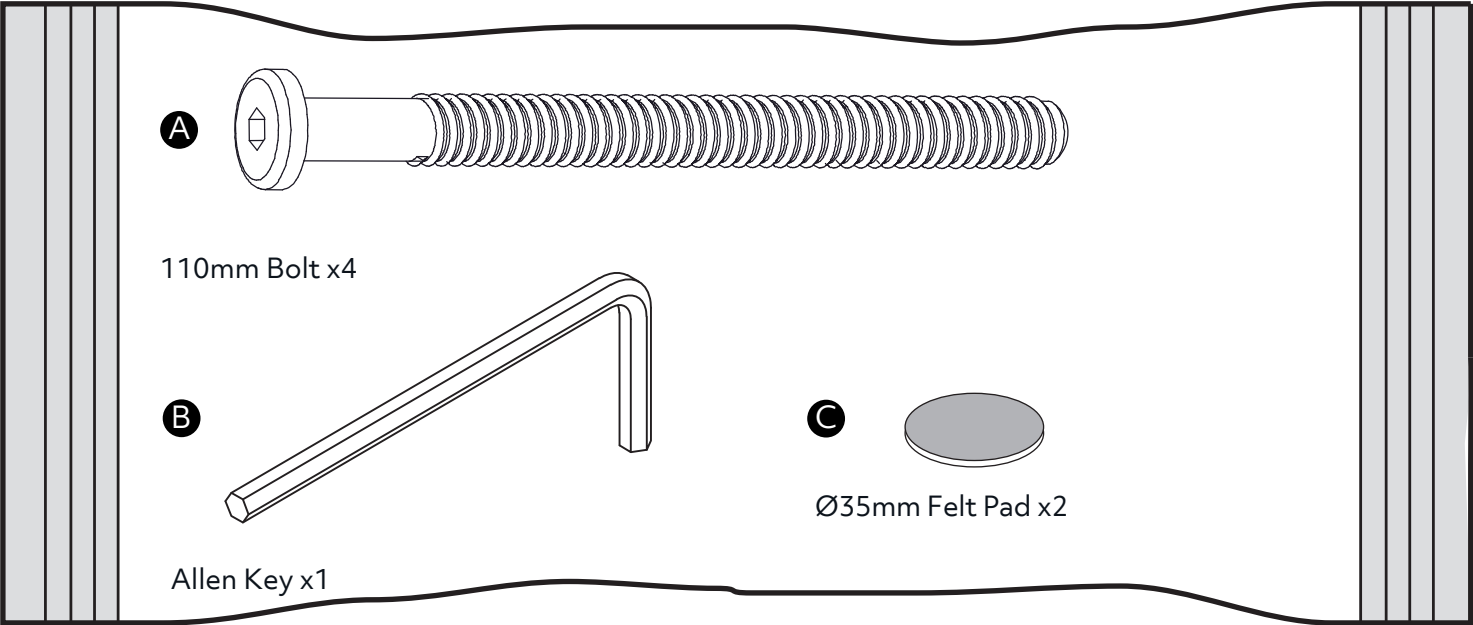

Parts

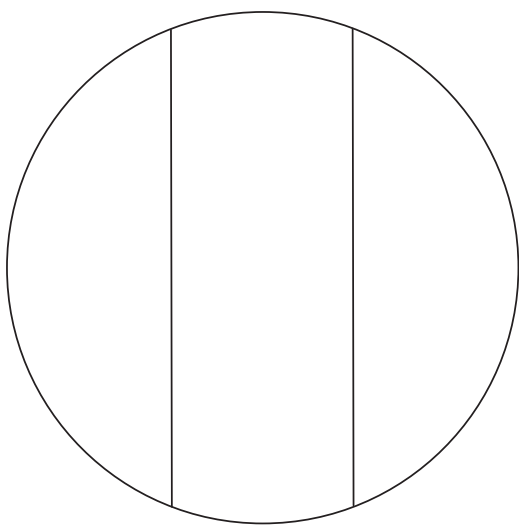

1 Table Top x1
(1000 x 1000mm)

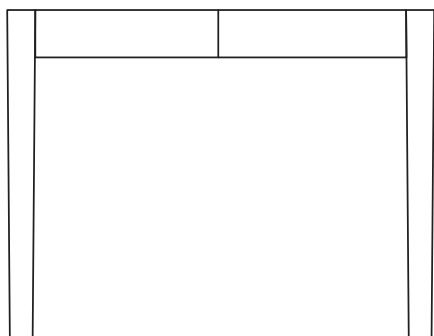

2 Leg Frame x1
(999 x 707mm)

1

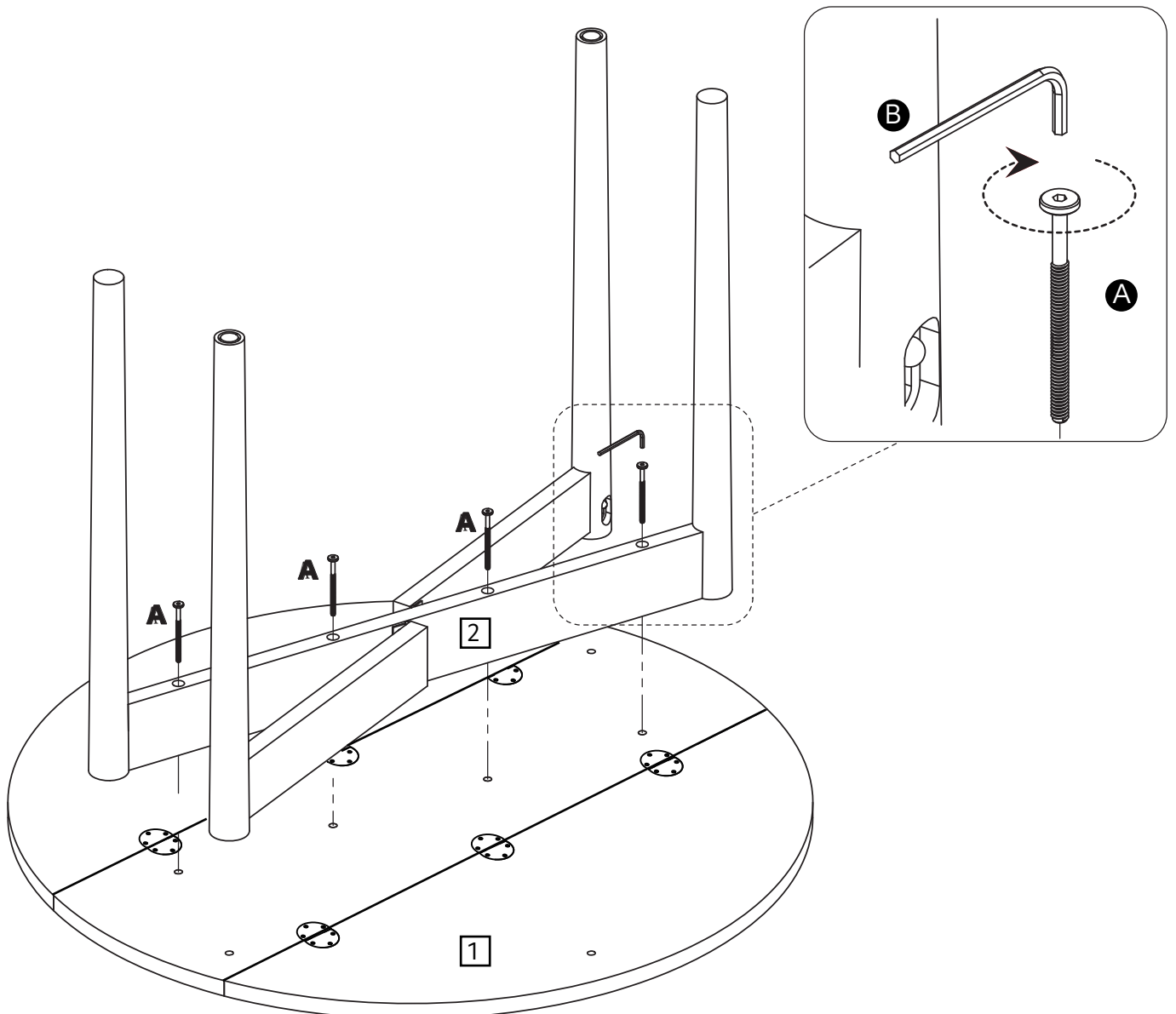
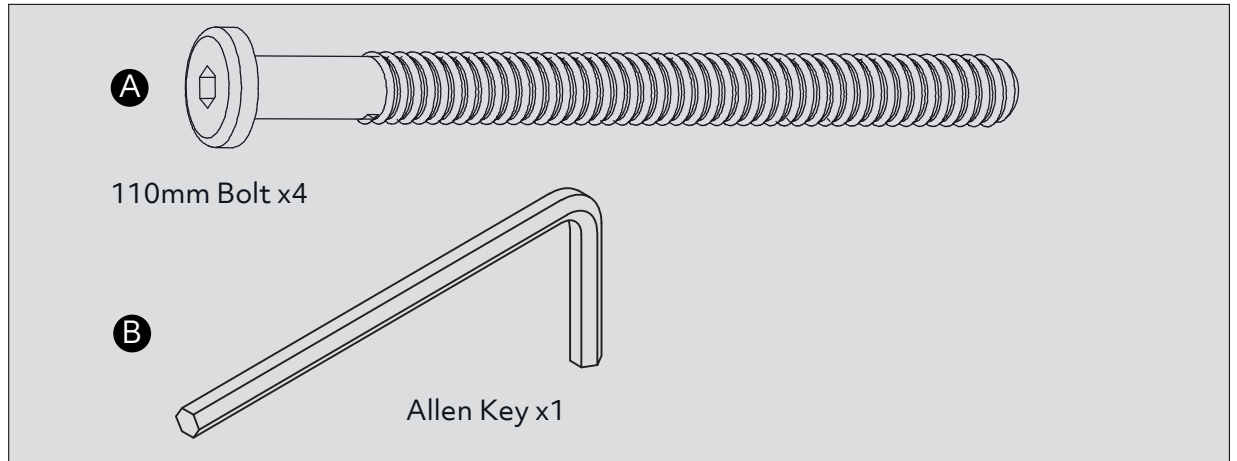
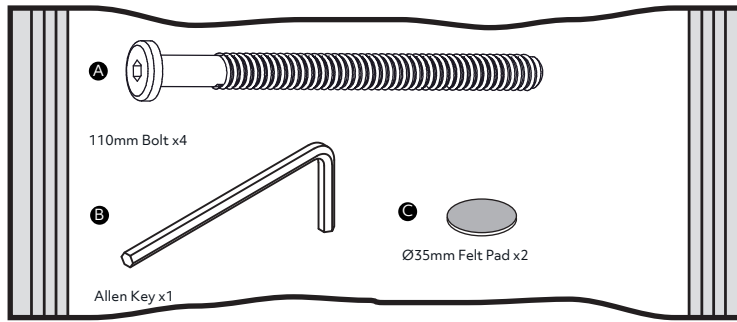

2



Feet can be adjusted for uneven surfaces.

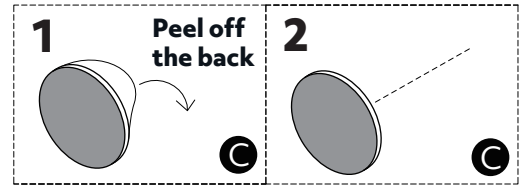
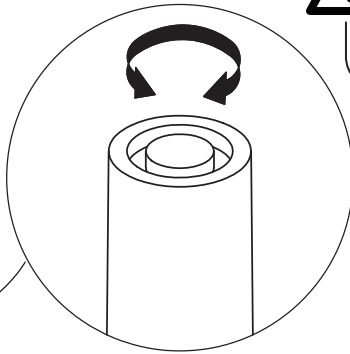

C X2

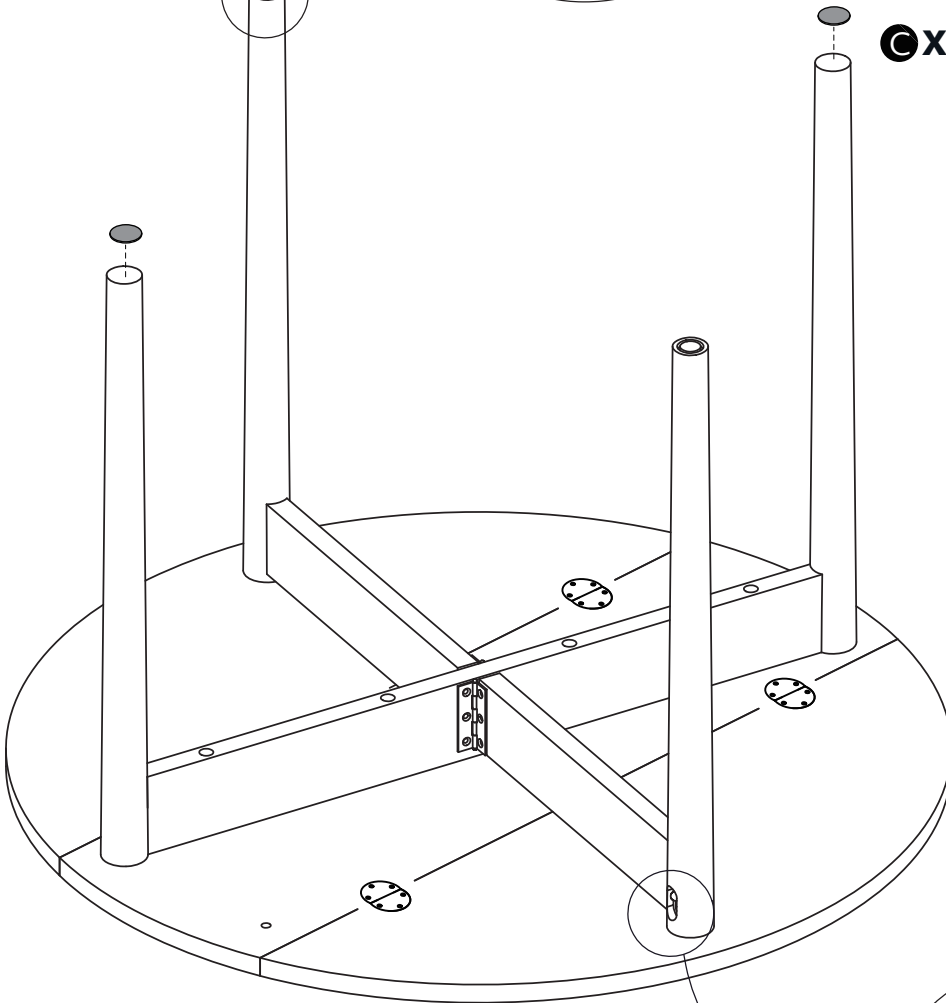

Always lock the table top in the open position to ensure that the legs cannot be moved accidentally.

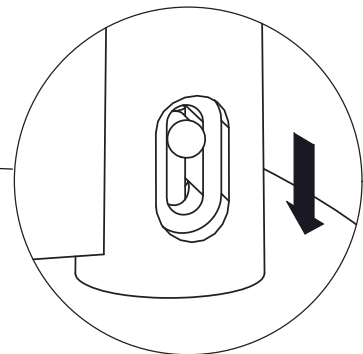

3

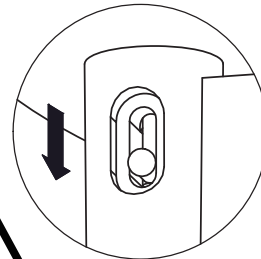
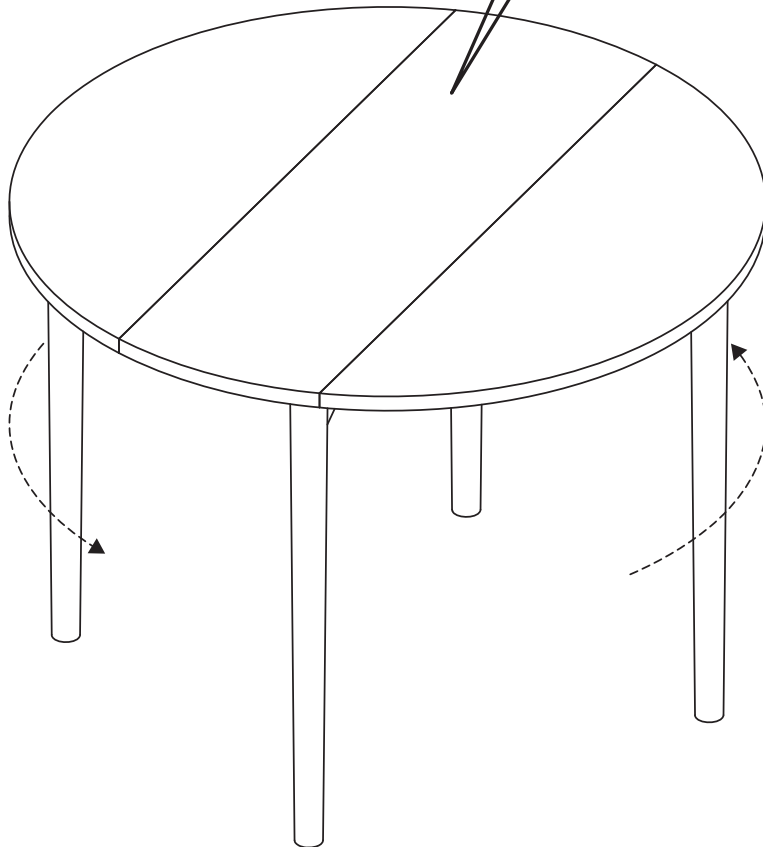
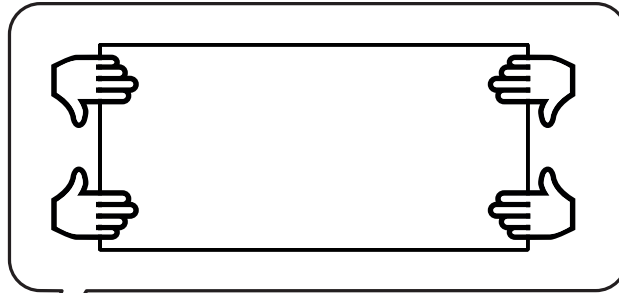
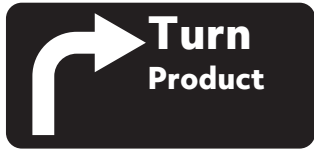

Unlock and rotate the legs to folded position

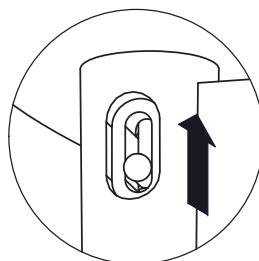
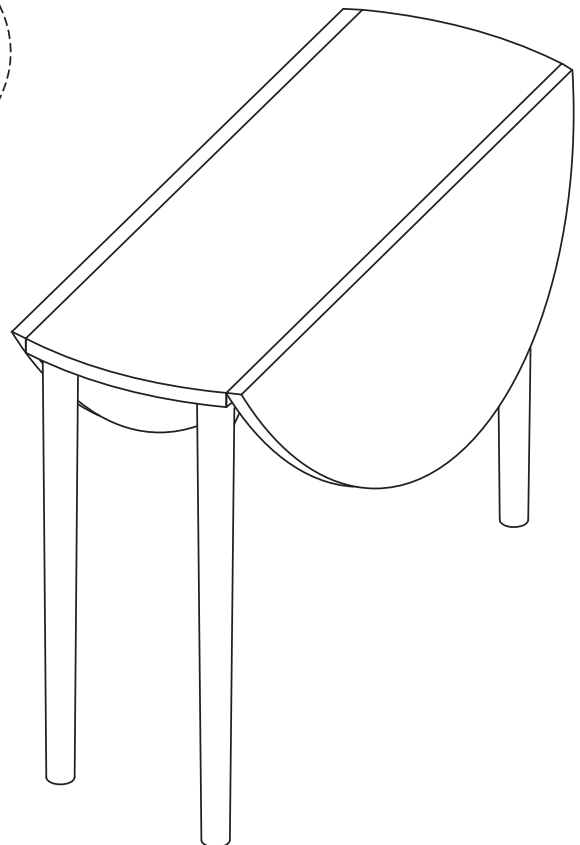

When Not in use always lock the legs in the closed position to ensure the folded down table is stable.

Assembly is complete.