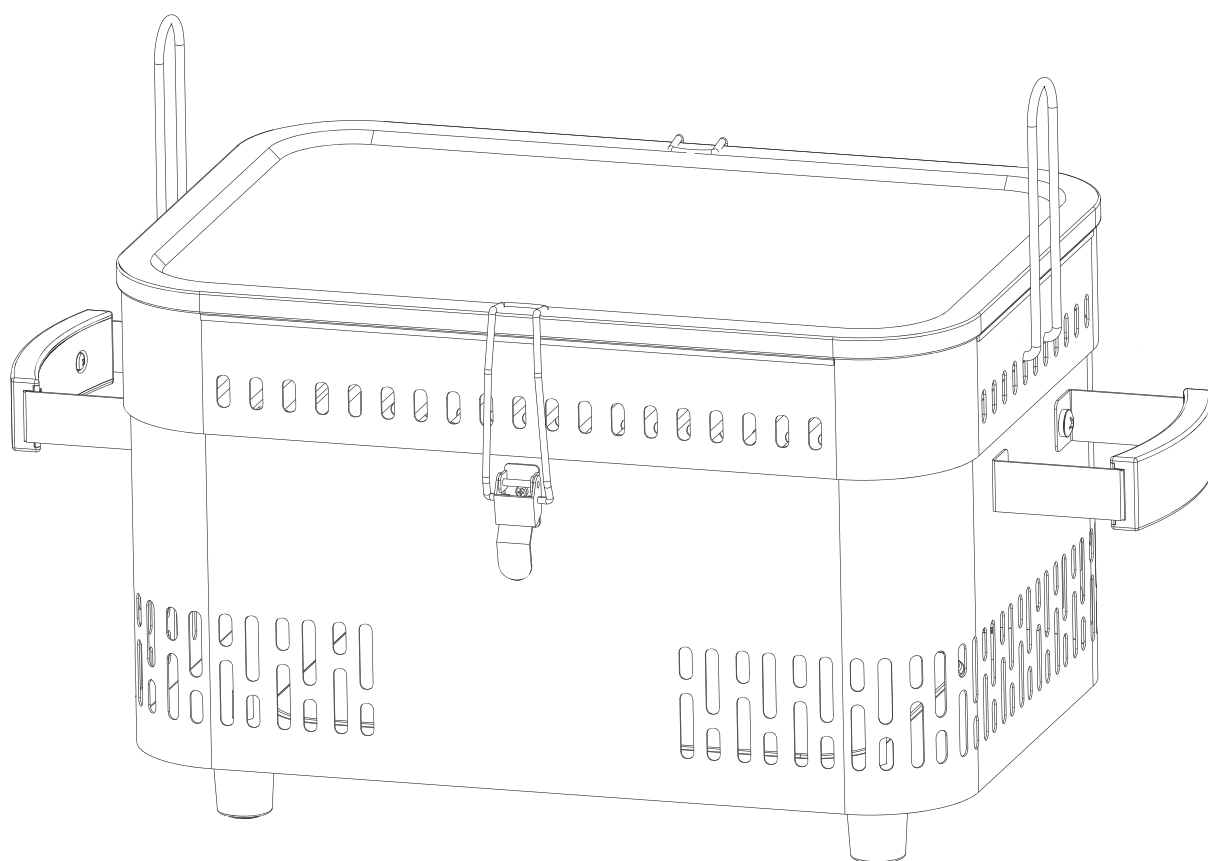

Table Top Charcoal BBQ

Assembly Instructions - Please keep for future reference

9611672



FOR OUTDOOR USE ONLY

Retain these instructions for future use

Important: The installer or seller must leave these instructions with the consumer.

If you need help or have damaged or missing parts, call the **Customer Helpline: 03456 400800**.
Please visit the website www.argos.co.uk for more information.

IMPORTANT SAFETY WARNINGS

We want you to assemble and use your Gascraft Charcoal Grill as safely as possible.



When you see this safety alert symbol please pay particular attention to the information which follows it.

Read all safety warnings and instructions carefully before assembling and operating the Charcoal Grill.



WARNING

- WARNING! Keep children and pets away.
- Do not use this barbecue without first reading the operating instruction carefully.
- Do not use indoors.
- NEVER take a smoldering or lit BBQ into your house, a tent, a caravan or a cabin. When in use BBQ is to remain outside at all times.
- ATTENTION! This barbecue will become very hot, do not move during operation.
- This barbecue should not be left unattended while in use.
- This barbecue is not designed for commercial use and doing so will void its warranty.
- This barbecue is for outdoor use only. If used in enclosed spaces such as a building or garage toxic fumes will build up and may cause death or serious injury.
- Always use the barbecue in a well ventilated area, but out of high winds.
- Position the barbecue so that wind does not carry hot ash onto combustible surfaces.
- Improper assembly of the barbecue may be dangerous. Please follow all the assembly instruction carefully before lighting the barbecue. Altering the barbecue in any way from the manufacturer's instructions may be dangerous and will void all warranties.
- Remember the signs and symptoms of carbon monoxide poisoning – headaches dizziness, breathlessness, nausea, collapse and loss of consciousness.

SAFETY INFORMATION

- Make sure the ash collection cup/tray is securely attached and the air vents are clean and clear before you light the barbecue.
- When lighting the barbecue ensure you do not have any loose clothing touching or near the coals.
- Always wear barbecue mitts and protective clothing when lighting the barbecue with a chimney starter or when adding more fuel to the barbecue.
- Ensure the barbecue is on a solid, flat and level non combustible surface before lighting.
- Do not use paraffin, alcohol or other combustible materials to light the barbecue.
- CAUTION! Do not use spirit or petrol for lighting or re-lighting the barbecue! Use only firelighters complying to EN 1860-3!

- **REMOVE WOODEN LID BEFORE USE AND DURING USE DO NOT REFIT WOODEN LID UNTIL BBQ IS COMPLETELY COOLED**
- Minimum clearance from combustible surface. Side of BBQ - 700cm, Back of BBQ - 700cm, Vertical above BBQ 1500cm.
- Do not store or use petrol or any other flammable vapours or materials within 8 meters of this barbecue.
- Keep all combustible items and surfaces at least 60cm away from the barbecue at all times. This includes wooden decks both treated and untreated.
- Keep the grilling area free from combustible materials, petrol and other flammable vapours or liquids.
- Keep all electrical cables away from the hot surface of the barbecue.
- Do not touch metal parts of the barbecue until it has completely cooled. Wear barbecue mitts when adjusting air vents or lifting the lid.
- Do not touch the grills, charcoal or any part of the barbecue to see if they are hot.
- Never move the barbecue while in use and wait until the coals are completely extinguished and cold before attempting to move the barbecue.
- Always open the lid carefully as steam and heat builds up inside the barbecue and can cause serious injury.

CAUTION

- Regularly check and clean the barbecue to avoid any built up of fats which may cause a fat fire and would void your warranty,
DAMAGE CAUSED BY FAT FIRES ARE NOT COVERED BY THE WARRANTY
- Do not remove the ash until it is completely extinguished and clod.
- Using abrasive cleaners on the barbecue or grills will damage the finish and void the warranty.
- Using sharp objects to clean the bowl and hood will damage the finish and void the warranty.
- Allow the barbecue to cool before cleaning and washing in a warm soapy solution. Ensure that any dried fat and food deposits are cleaned off the grills after EVERY cooking session. Wash the grills with hot soapy water then rinse and dry before returning the grills to the barbecue.
- Be fire safe. Always do a safety check before you light any type of outdoor fire. If you start or see a fire that is out of control, call 999 from a safe place.

Carbon Monoxide Hazard

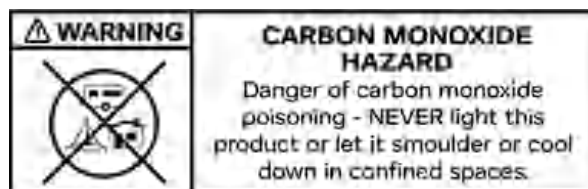



WARNING

Important

Please check with your local council regarding the use of BBQ in outdoor spaces.

Please check with your local council regarding air quality regulations.

- ⚠ **IMPORTANT** Only use this Charcoal BBQ on a flat, non-flammable surface level or ground.
- ⚠ This product is for **OUTDOOR USE ONLY**. **NEVER** use in an enclosed space such as a carport, garage, veranda, covered patio, or under an overhead structure of any kind.
- ⚠ **ATTENTION!** This Charcoal BBQ will become very hot. Do not attempt to move it during operation.
- ⚠ **WARNING!** Keep children and pets away from the Charcoal BBQ when in use. Any modification of this BBQ may be dangerous.
- ⚠ When positioning, ensure the Charcoal BBQ is a minimum of 1 metre from flammable items or structures.
- ⚠ Do not overfill metal tray with burnable products.
- ⚠ Never handle hot parts with unprotected hands.
- ⚠ Do not use indoors. If used indoors, toxic fumes can build up and cause bodily injury or death. Only use outdoors in a well-ventilated area.
- ⚠ **ATTENTION!** This Charcoal BBQ should not be used under overhead combustible construction.
- ⚠ Do not leave this Charcoal BBQ unattended when in use.
- ⚠ Do not add starter fluid or Charcoal impregnated with starter fluid to warm or hot fires.
- ⚠ Do not use clothing with long or loose sleeves when operating the BBQ.
- ⚠ Do not use the BBQ in high winds. Do not touch the BBQ with your hands to check if it is hot.
- ⚠ Do not use water to control flare-ups or extinguish Charcoal. Always extinguish your BBQ when not being monitored
- ⚠ Do not dump hot Charcoal where they may cause a fire hazard. Do not store away or cover the BBQ until the embers are extinguished and removed, and the BBQ is fully cooled.
- ⚠ This BBQ is not intended to be used in recreational vehicles or boats.
- ⚠ **CAUTION!** Do not use petrol, spirit or lighter fluid for lighting or re-lighting the BBQ!
- ⚠ Do not allow grease, fat or food residue to build up in or on the barbecue – RISK OF FIRE.
- ⚠ Do not hang any combustible materials from the handrails of this Charcoal BBQ.
- ⚠ Never overload the cooking grill with food – evenly space food over the cooking grill surface.
- ⚠ Barbecue mitts should always be used while cooking, lighting or adjusting barbecue vents and handling the barbecue.

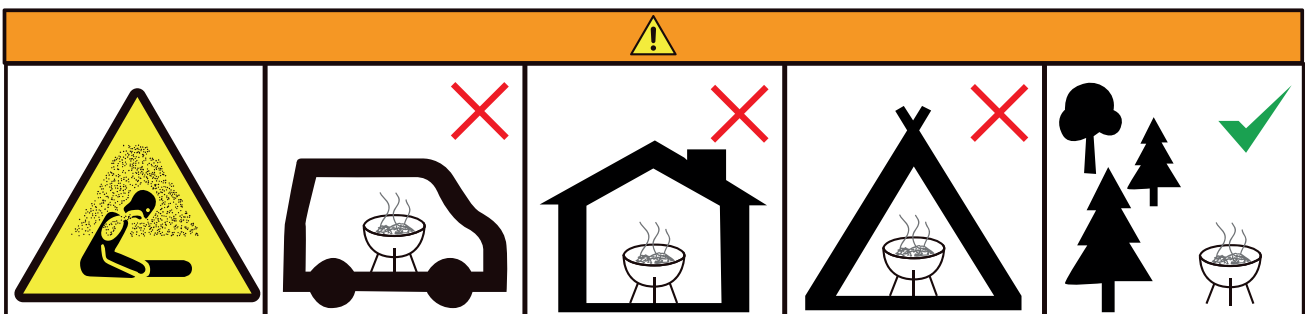

Food Safety

- Thoroughly defrost frozen meat and poultry in the refrigerator before cooking. Keep raw meat and poultry separate from cooked food.
- Ensure that the grill is thoroughly cleaned before cooking and lighting the barbecue.
- Always wash hands after handling raw meat and poultry before handling any ready to eat food.
- Wipe and disinfect surfaces that have been in contact with raw meat and poultry.
- When barbecuing meat and poultry, make sure the barbecue is really hot. Place the larger, thicker portions furthest away from the most intense heat to ensure thorough cooking without burning and turn regularly.
- Use separate utensils for handling raw meat or poultry and cooked food on the barbecue, or wash them thoroughly between use.
- To check whether meat, particularly poultry, is cooked, pierce the flesh with a skewer or fork: the juices should run clear. Ensure the product is piping hot throughout.
- Attention! This BBQ will become very hot do not move it during operation. Do NOT use indoors.

Warning! Keep children and pets away!

Caution! Do not use spirit or petrol for lighting or re-lighting! Use only firelighters complying to EN 1860-3

EXPLODED DIAGRAM

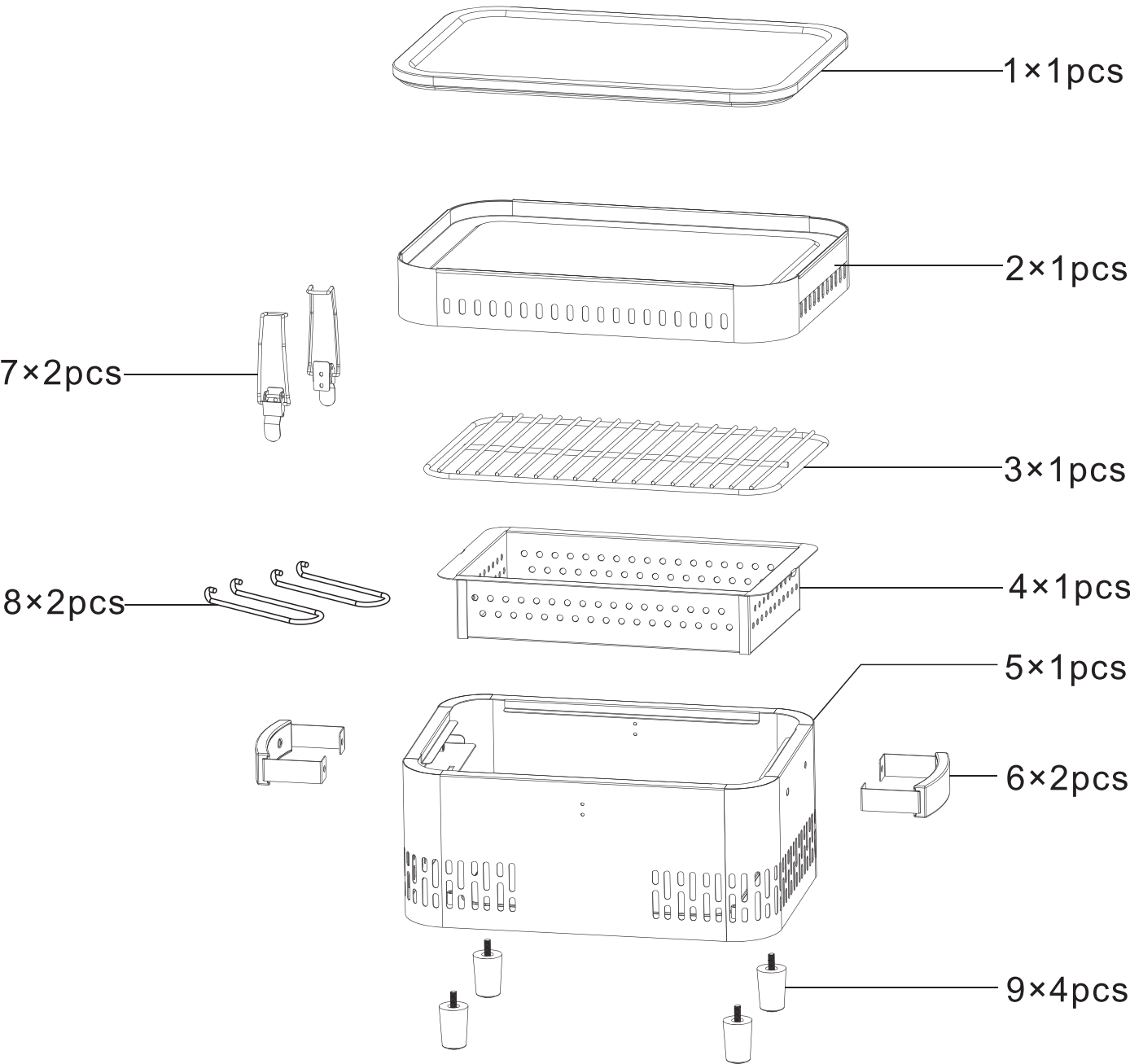

A	M6 x 12mm		x 4
B	M3 x 8 mm		x 4
C	M3		x 4

ASSEMBLY INSTRUCTIONS

Assembly:

- To avoid losing any small components or hardware, assemble the product on a hard level surface that does not have cracks or openings. You may wish to lay down a blanket or similar item, to avoid possible damage to the finish during assembly.
- Clear an area large enough to lay out all components and hardware.
- Great care has been taken during manufacturing to remove sharp edges but you should handle all components with care to avoid injury.
- Check you have all components before beginning assembly.
- When applicable, tighten all hardware connections by hand first. Once the step is completed go back and fully tighten all hardware.
- Follow all steps in order to properly assemble the product.

Tools required:

- Adjustable Spanner or Socket Wrench
 - Phillips Screwdriver
-
- Please check the pack contents before attempting to assemble this product. A full checklist of components is given in this leaflet. If any components are missing, please contact retailer from whom you bought this product.

This product takes approximately **30 MINUTES** to assemble with **1 PERSON**.

The fittings contains **SMALL ITEMS** which should be **KEPT AWAY FROM YOUNG CHILDREN**.

Read this leaflet in full before commencing assembly.

ASSEMBLY INSTRUCTIONS

Step 1

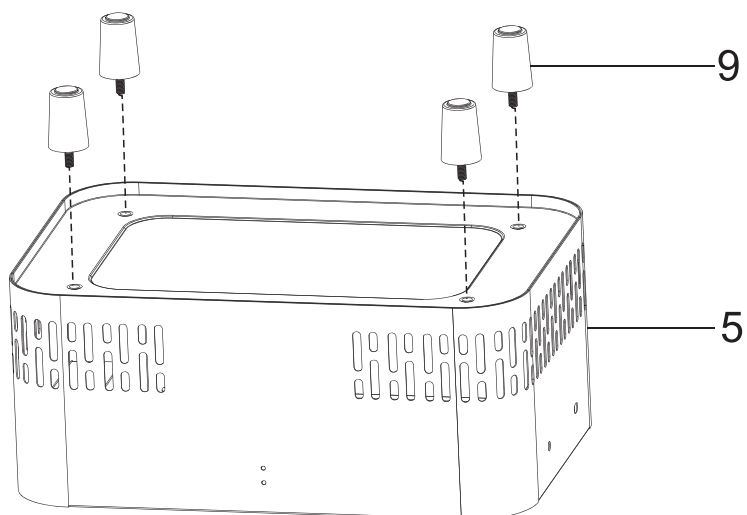

Step 2

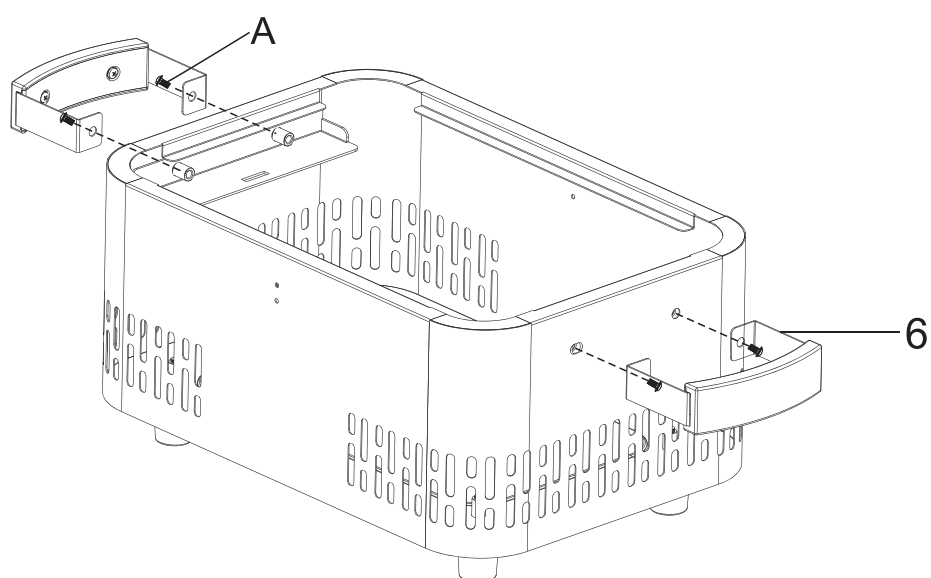

ASSEMBLY INSTRUCTIONS

Step 3

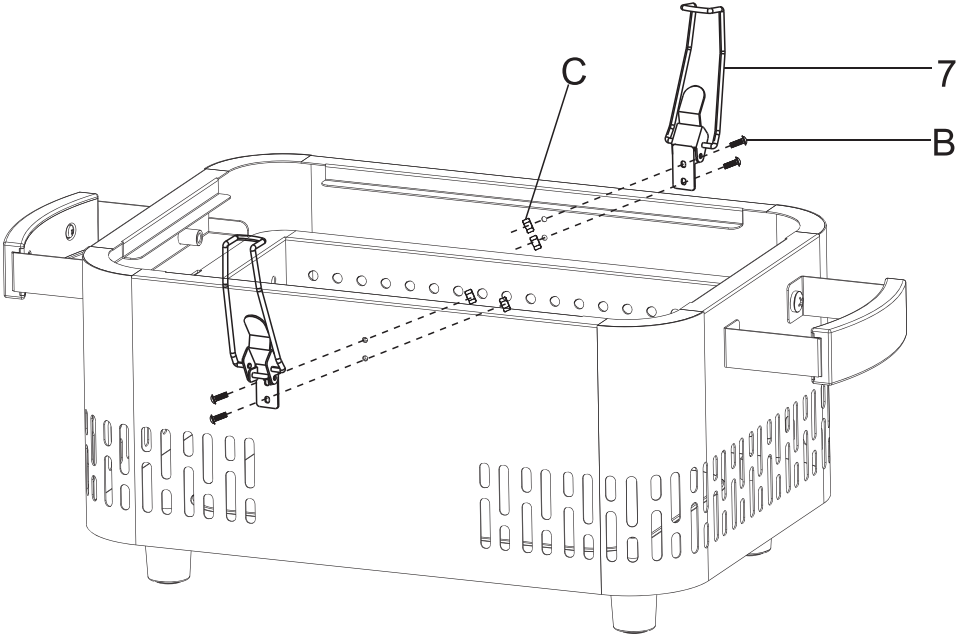

Step 4

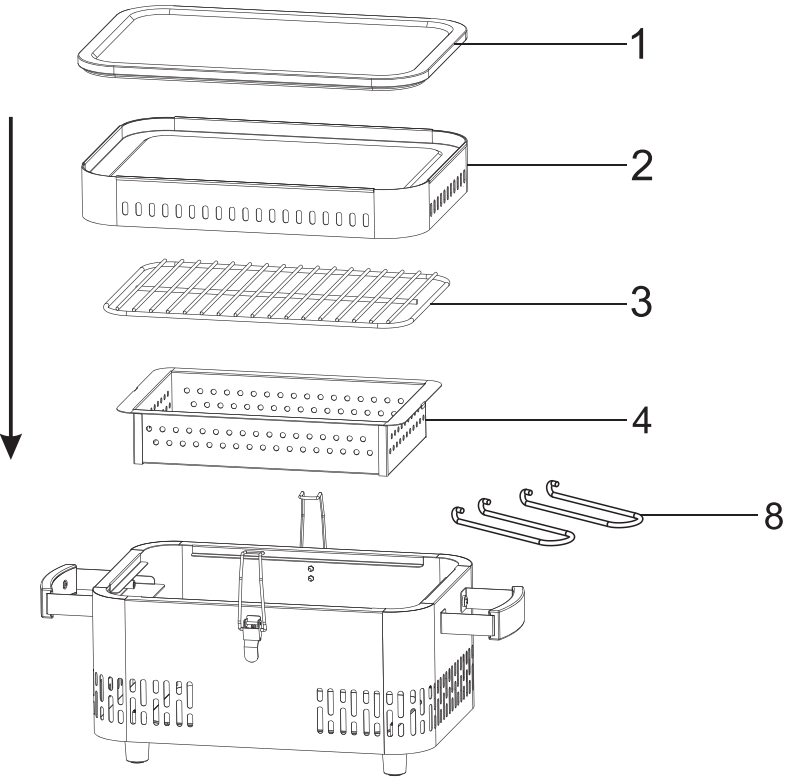

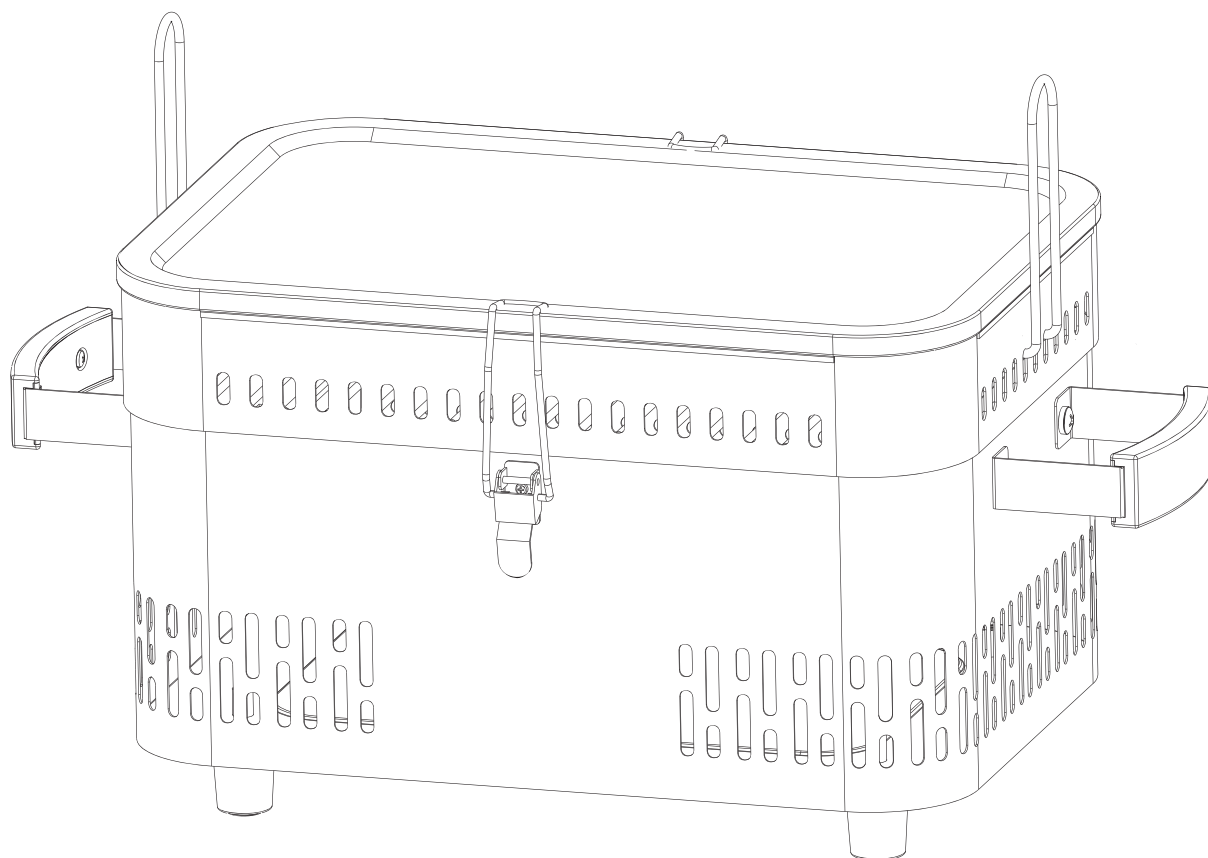

If you need help or have damaged or missing parts, call the **Customer Helpline: 03456 400800.**

Produced in China. Argos Limited, 489-499 Avebury Boulevard, Milton Keynes, MK9 2NW.

Argos (N.I.) Ltd, Forestside Shopping Centre, Upper Galwally, Belfast, United Kingdom, BT8 6FX.

Argos Distributors (Ireland) Limited, Unit 7, Ashbourne Retail Park, Ballybin Road, Ashbourne, County Meath, Ireland