

vax
ONE
PWR
CORDLESS

VAX Edge

Pet & Car

Cordless Vacuum



VAX Edge

Pet & Car

vax[®]
CLUP-EGKS
CLUP-EGBC

Safety Guide

This machine is intended for household use only, not for commercial or industrial use.

Please keep instructions for further use and only as instructed in this guide.

The full user guide can be found at: **support.vax.co.uk**

Don'ts

- Don't leave the charger plugged in when unattended.
- Don't use the machine if it is faulty or has been dropped, damaged or left outdoors.
- Don't use the machine to pick up any flammable or combustible materials (lighter fluid, petrol, kerosene etc.) or use the machine in an area with explosive vapours or liquid.
- Don't use the machine to pick up hot coals, cigarette butts, matches or smoking hot burning items or use in an area where there may be harmful fluids (chlorine, bleach and ammonia drain cleaner).
- Don't handle the charger, battery or use the machine with wet hands.
- Don't unplug the charger by pulling on the power cord.
- The power cord cannot be replaced. If the cord is damaged the charger should be scrapped.
- Don't attempt to remove blockages with sharp objects as this may cause damage to the machine.
- Don't use the machine with the incorrect battery or charger as this may result in damage or injury to the user. The correct battery charger information is listed on the battery pack ratings label.
- Don't charge the battery outdoors, or leave the charger connected to the mains when not in use.
- Don't use the machine with a damaged battery. If the battery is damaged contact us on: **08000 927737**
- Don't use on a surface that is damaged, uneven or incorrectly fitted.
- Don't over fill the dirt container to avoid blocking the air flow through the machine.
- The brushbar in the floorhead and mini motorised pet tool constantly rotates when activated. Never use on one spot for any prolonged period of time as this may damage the floor surface.

Do's

- Only Vax ONEPWR batteries (BVXXXXX) and chargers (BV05XXX) should be used with this machine.
- Always stand the charger on a stable, level surface, uncovered and away from any heat source.
- Always remove the battery from the machine before carrying out any maintenance or if storing unused for a long period of time.
- Keep all openings clear, free from debris and don't overfill the dirt container as this may affect the airflow/suction.
- Turn off all controls on the machine before disconnecting or connecting the battery.
- This machine is not intended to be used or cleaned by persons with reduced physical, sensory or mental capabilities, or lack of experience or knowledge, unless they have been given instructions concerning the safe use of the machine by a person legally responsible for their safety. They should be supervised whilst using the machine. Children shall not use, clean or play with this machine, which when not in use should be secured out of their reach.
- Only use the machine indoors on dry surfaces and keep the area you're cleaning well lit.
- Keep fingers, hair and loose clothing away from moving parts and openings whilst using the machine.
- Store the machine in a cool, dry area. Keep the machine away from rain and moisture.
- Use only CE/UKCA approved 13amp extension cords, non-approved extension cords may overheat. Care should be taken to arrange the extension cord as it can be a trip hazard.
- Take extra care when using the machine on the stairs.
- Check suitability with the manufacturer of your flooring prior to using the machine. Test on an inconspicuous area of the flooring first.
- Always make sure the separator and filter are fitted correctly before using your machine and only use the machine with the filter and separator in place.
- Always check the floorhead, mini motorised pet tool and accessories are free from damage, dirt and debris before using.

Battery safety precautions

- Replace the battery with a Vax ONEPWR battery only. Use of another battery may present a risk of fire or explosion.
- Don't attempt to disassemble the battery, remove any component projecting from the battery terminals and do not dispose of in a fire. The battery and charger have no user serviceable parts. Fire or injury may result.
- Prior to disposal, protect exposed terminals with heavy insulating tape to prevent shorting. The battery is to be disposed of safely at your local battery recycling centre.
- When the battery pack is not in use, keep it away from other metal objects that can make a connection from one terminal to another. Shorting the battery terminals together may cause burns or a fire.
- In case of battery leakages, avoid any contact with skin and contact us on:

08000 927737

Welcome to the Vax family!

You are now the proud owner of a VAX Edge Pet & Car.

Here, you'll find everything you need to know about your machine and, most importantly, instructions on how to get started so that you can get cleaning!



- 1 Handle
- 2 HARD FLOOR mode selector
- 3 CARPET mode selector
- 4 Boost ON/OFF
- 5 Power ON/OFF
- 6 Carry handle
- 7 Battery level indicator
- 8 Dirt container release button
- 9 Pre-motor filter (hidden)
- 10 Separator
- 11 Dirt container
- 12 Dirt release button (hidden)
- 13 Battery dock
- 14 LED headlights
- 15 Brushbar (hidden)
- 16 Brushroll
- 17 Hose hook
- 18 Post-motor filter (hidden)
- 19 Powered hose
- 20 Tool storage
- 21 Hose release clip
- 22 ONEPWR battery*
- 23 ONEPWR charger*
- 24 Mini motorised pet tool
- 25 Dusting brush
- 26 Flexi crevice tool



Weight 4.65kg (without battery pack). Dirt bin capacity 1.5L.
Runtime and charge time dependent on battery pack and mode used.
*Battery and charger included with model CLUP-EGKS only.
Subject to technical change without notice. Images are illustrative only.

Quick Start

1 Assembly

Slide the handle into the top of the machine until it clicks into place.



2 Charging the battery

Fully charge the battery before first use.

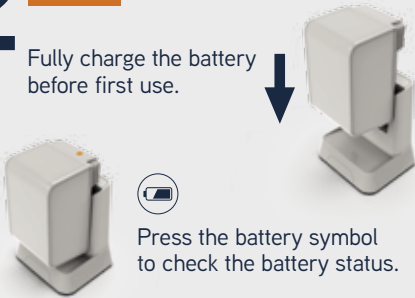

Press the battery symbol to check the battery status.

3 Operation

Switch on the machine and select a mode.

HARD FLOOR

CARPET

BOOST
Increases suction



Registration & Support

All ONEPWR products come with a standard one year warranty

Register your product to receive 2 YEARS FREE additional warranty[†]

For details visit: vax.co.uk/registration

Scan here

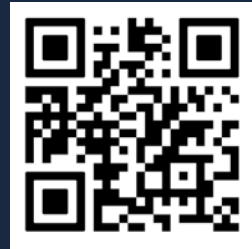

For help and support with your new product

or visit us online: support.vax.co.uk

Still need to get in touch?

Our UK based Customer Care Team are here to support you. For help with assembly, operational or performance problems, or buying and fitting new accessories, you can find all our contact details at vax.co.uk/contact

This user guide can be found online at: support.vax.co.uk

[†] Registration required. Terms and conditions apply, see vax.co.uk for details.

Warranty and technical

Warranty

If a Vax machine is used in the way it is intended and it breaks down within the guarantee period, it's our responsibility to repair or replace it.

Here's what isn't covered:

- Normal wear and tear of consumable items, for example: belts, filters, brushrolls, fuses etc.
- Batteries which have become faulty as a result of improper handling.
- Batteries which have a reduced service life as a result of normal wear.
- Accidental damage
 - Damage as a result of use not in accordance with the product user guide.
 - Damage caused by not carrying out regular maintenance.
 - Damage to the charger cable.
 - Blockages caused by misuse.
- Faults caused by:
 - Negligent use, misuse, neglect or careless operation of the machine.
 - Use of the machine cleaner which is not in accordance with the user guide.
 - Use of a Vax machine for anything other than normal domestic household purposes in the country in which it was purchased.
 - Use of parts, accessories and consumables, which are not genuine Vax components.
 - Faulty installation or repairs – unless carried out by a qualified electrician or engineer.

Technical

Statement of Compliance: Manufacturer/EU importer: Vax Limited, hereby on our own responsibility, declare that the **VAX Edge Pet & Car** is manufactured in compliance with the following Legislation:

Safety: 2014/35/EU Low Voltage Directives/Electrical Equipment (Safety) Regulations 2016. EMC: 2014/30/EU Electromagnetic Compatibility Directive/ Electromagnetic Compatibility Regulations 2016.



Waste electrical products should not be disposed of with household waste. Please recycle where facilities exist. Check with your Local Authority or retailer for recycling advice.

VAX is a trade mark of Techtronic Cordless GP.

© 2022 Techtronic Cordless GP. All rights reserved.

Vax Ltd, Artillery House, Heritage Way, Droitwich, WR9 8YB, UK.

THIS MACHINE IS ONLY TO BE USED WITH VAX ONEPWR BATTERIES AND CHARGER. PLEASE READ THE SAFETY GUIDE BEFORE USE.

Charging the battery

NOTE: Before first use, ensure the battery is fully charged. Failure to fully charge the battery before first use may result in poor battery performance. The life expectancy of the battery will vary depending on the usage of the machine.

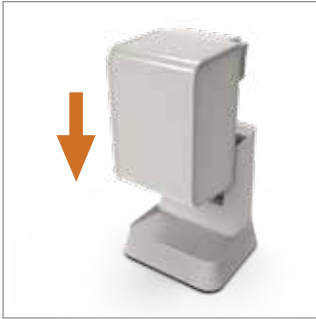

Slide the battery down on to the charger.



The charger light will flash white to show when the battery is charging. The light on the charger will stop flashing and go off when the battery is fully charged.



Once fully charged, slide the battery off the charger to remove.



To check the battery charge level press the battery symbol.

Assembly



Slide the handle into the top of the machine until it clicks into place.

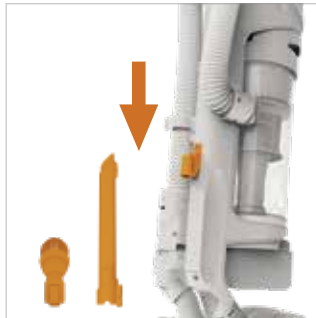

A tool can be pushed onto the clip for storage. Press the button on the tool to remove to use.

Getting started

Operation

CAUTION: The brushbar and brushroll in the floorhead and the brushbar in the mini motorised pet tool constantly rotates when activated. Never use on one spot for any prolonged period of time as this may damage the floor surface. To prevent any damage being sustained test on an inconspicuous area of the flooring first.

NOTE: For best performance the brushbars should be set to the correct mode for carpets and hard floors. Constant use of the boost mode and brushbars will reduce the battery runtime.



Slide the battery into the machine until it clicks into place.



Place a foot on the floorhead and pull the handle backwards to recline it.



Press the on/off button to switch the machine on.



Press the **HARD FLOOR** or **CARPET** button to select flooring mode. Brushes can be switched OFF For delicate floors and flooring not suitable for use with a rotating brushbar.



Press the boost button to increase the suction for particularly dirty areas.



When the machine is in use the battery level indicator lights will illuminate indicating how much charge is remaining. When less than 20% charge is remaining the bottom light will flash red indicating the battery is running low and charging is required.

CAUTION: If the brushes have been obstructed, the motor protection sensor may activate. The brushbar and brushroll will stop and the light on the floorhead will illuminate red. Switch off the machine, clear any obstruction and wait 1 minute before reactivating.



Using the hose and tools

IMPORTANT: Hold the machine by the carry handle at all times when using the hose or when used on stairs.



Hold the machine by the carry handle at all times when using the hose or when being used on stairs.



Press the hose release clip and pull to remove the hose from the hose holder.



Push the chosen accessory to the end of the hose until it clicks.



Soft bristled dusting brush

For delicate surfaces and skirting boards. Use with boost mode for optimum performance.



Mini motorised pet tool

For cleaning pet beds, car boots, stairs and upholstery.



Flexi crevice tool

For cleaning those hard to reach areas. Extends and bends for awkward gaps.



Press the On/Off button to switch the machine on.



Press the boost button to increase the suction for particularly dirty areas.



Press the button on the tool to remove.

Getting started

Using the mini motorised pet tool

IMPORTANT: If the brushbar in the mini motorised pet tool has been obstructed, the motor protection sensor may activate and the brushbar will stop. Switch off the machine, remove the tool from the hose and clear any obstruction. Wait 1 minute before refitting. To reactivate the brushbar, switch the machine on and choose a floor selector button.

NOTE: The mini motorised pet tool will only activate when the machine is locked to the upright position.



Stand the machine in the upright position.



Press the hose release clip and pull to remove the hose from the hose holder.



Slide the mini motorised pet tool onto the end of the hose until it clicks into place.



Press the on/off button to switch the machine on.



Press the **HARD FLOOR** or **CARPET** mode to switch the mini motorised brushbar on/off. For delicate surfaces select **HARD FLOOR**.



Press the boost button to increase the suction for particularly dirty areas.

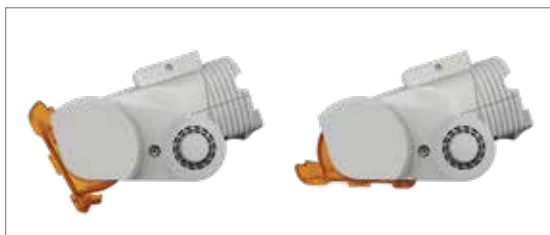

NOTE: The mini motorised pet tool base plate can be rotated so it can be used flat or horizontally for all angle cleaning.

Emptying the dirt container

IMPORTANT: Always switch off the machine before performing maintenance or troubleshooting checks.

CAUTION: Don't over fill the dirt container to avoid blocking the air flow through the machine.
For best results empty after every use.



Press the dirt container release button and pull to remove the dirt container.



Hold the dirt container over a bin and press the dirt release button to allow dirt/debris to fall out.



To close, push the dirt release door until it clicks into place.



To refit, tilt the dirt container and line up the front of the container onto the base of the machine. Push the dirt container back until it clicks into place.

Cleaning and maintenance

Cleaning the pre-motor filter

IMPORTANT: For best cleaning results, the filters should be tapped over a bin every 4-6 uses to remove dirt/debris. The pre-motor filter should be washed every 3 months (depending on the level of use) and replaced every 9-12 months.

Ensure all filters are in place before using the machine.



Push the tab up on the lid of the dirt container and lift to open the cover.



Pull the pre-motor filter tab and remove the filter from the separator.



Tap the pre-motor filter over a bin to remove any dirt/debris.



Wash the filter under running water (40° max). Leave for 24 hours or until fully dry before replacing.

Cleaning the separator



Push the tab up on the lid of the dirt container and lift to open the cover.



Lift and remove the separator out of the dirt container. Using a soft brush remove any dirt/debris from the separator.



Refit the separator making sure that the semi circular tab on the separator fits into the groove on the dirt container.

Cleaning and maintenance

Post-motor filter maintenance

IMPORTANT: The post-motor filter is designed to offer long life with no maintenance. The filter should be checked periodically and when heavily discoloured it should be replaced.

Do not wash, scrub or brush the post-motor filter as this will damage the filter.

Ensure all filters are in place before using the machine.



Press the hose release clip and pull to remove the hose from the hose holder and hook.



Press the tab at the top of the filter cover and pull to remove.



Press the tab at the top of the filter and pull to remove.

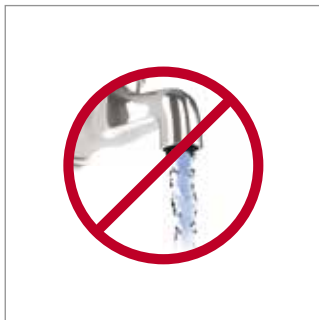

Do not wash, scrub or brush the post-motor filter as this will damage the filter.



Remove the sponge from the filter and check for any discoloration. Replace the filter when it is heavily discoloured.



1. To refit the filter, fit the tab on the base of the filter into the machine and push back until it clicks in to place.

2. To refit the filter cover fit the tab on the base of the cover into the machine and push back until it clicks in to place.

Removing and cleaning the floorhead brushbar

IMPORTANT: If the brushbar or brushroll has been obstructed, the motor protection sensor may activate. The brushes will stop and the light on the powered floorhead will illuminate red. Switch off the machine, clear any obstruction and wait 1 minute before reactivating.

NOTE: For best performance and to reduce hair and dirt build up, remove and clean the brushbars every 1-2 months (depending on the level of use).



Using a coin, push and turn the brushbar cover anticlockwise to the unlock symbol.



Pull the brushbar out from the brush housing.



To remove any threads or hair, slide the blade of a pair of scissors into the groove on the brushbar and cut along the groove.



Clear any dirt/debris from the end caps and inside the brush housing.



Refit the brushbar into the floorhead. Align the arrow on the brushbar cover to the unlock symbol, push firmly until the cover sits flush and turn to lock into place.

Cleaning and maintenance

Removing and cleaning the floorhead brushroll



Using a coin, push and turn the brushroll cover to the unlock symbol. NOTE: The brushroll cover cannot be removed.



Hold the tab and pull away the brushroll from the brush housing.

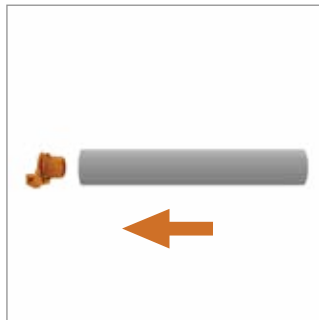

Pull to remove the end cap and slide any hair and threads off the end of the brushroll.



Use a damp cloth to remove any dirt/debris from the brushroll. Allow the brushroll to fully dry before assembling back into the floorhead. DO NOT wash or over saturate the brushroll.



Check the floorhead inlet for any blockages and use a blunt object to remove the blockage.



Clear any dirt/debris inside the brush housing.

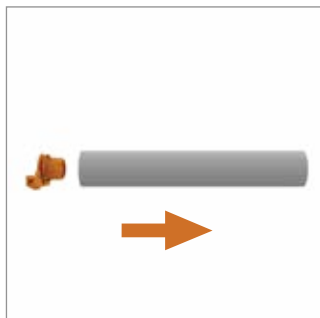

Refit the end cap onto the brushroll.



With the lock in the unlocked position slot the brushroll into the right side of the floorhead first and push the end cap into place.



Using a coin, turn the brushroll cover clockwise. The cover will sit flush to the floorhead when locked into place.

Removing and cleaning the mini motorised pet tool brushbar

IMPORTANT: If the brushbar in the mini motorised pet tool has been obstructed, the brushbar motor protection sensor may activate and the brushbar will stop. Switch off the machine, remove the tool from the hose and clear any obstruction. Wait 1 minute before refitting the tool, switch the machine on and press the brushbar ON/OFF button.

NOTE: For best performance remove and clean the brushbar every 1-2 months (depending on the level of use) to reduce the hair and dirt build up.



Using a coin, turn the brushbar lock anticlockwise to release the brushbar.



Pull the brushbar out from the brushbar housing.



To remove any threads or hair, slide the blade of a pair of scissors into the groove on the brushbar and cut along the groove. Clear any dirt/debris inside the housing of the floorhead.



Check the inlet for any blockages and use a blunt object to remove the blockage.



Refit the brushbar and turn the brushbar lock clockwise to lock.

Cleaning and maintenance

Checking for blockages



Press the dirt container release button and pull to remove the dirt container.



Press the hose release clip and pull to remove the hose from the hose holder.



Drop a small ball of paper into the top of the hose. The paper will drop through if the hose is clear. Use a broom handle or similar blunt object to remove any blockage.

WARNING: Always switch off and unplug the machine before performing any checks or maintenance.

There is an accessory missing

- Check the contents on the box to make sure the part is definitely included with your machine.

Why does the machine have no power?

- The battery is not fitted correctly. **See Operation page 6.**
- The battery has no charge. **See Charging the battery page 5.**
- The motor thermostat may have tripped. Empty the dirt container and check for blockages. Clean the filters and allow the machine to cool for approximately 1 hour. If you have washed the filters, wait 24 hours to fully dry before placing back on the machine. **See Cleaning the pre-motor filter page 10 and Cleaning the separator page 11.**

Why won't the machine pick up?

- The filters may be clogged or may need replacing. **See Cleaning the pre-motor filter page 10.**
- The separator may be blocked. Check the dirt container and separator for blockages. **See Emptying the dirt container page 9 and Cleaning the separator page 11.**
- There may be a blockage in the hose. Check and clear. **See Checking for blockages page 16.**
- The dirt container may not be correctly fitted. **See Emptying the dirt container page 9.**
- The brushes have not been activated. **See Operation page 6.**
- The incorrect flooring mode has been selected. **See Operation page 6.**

Why is there a red light?

- Battery charge is running low (<20%). **See Charging the battery page 5.**

Why is there a red light on the floorhead?

- The brushes have been obstructed. **See Removing and cleaning the floorhead brushbar page 13 and Removing and cleaning the floorhead brushroll page 14.**

Why won't the brushbar/brushroll in the floorhead turn?

- The machine may not be reclined. **See Operation page 6.**
- The brushes in the floorhead have not been activated. **See Operation page 6.**
- The brushes may be obstructed and the motor sensor has been activated. To reset switch off the machine, then check the brushbar/brushroll for an obstruction and clear any hair or debris. Wait 1 minute before switching the machine on. To reactivate the brushes switch the machine on and choose a floor selector button.

Why won't the brushbar in the mini motorised pet tool turn?

- The machine is reclined. Stand the machine in the upright position. The mini motorised pet tool will only activate when the machine is in the upright position.
- The tool has not been activated. Press the CARPET or HARD FLOOR selector button to switch the mini motorised pet tool brushbar on.
- The brushbar in the tool has been obstructed. Switch off the machine, remove the tool from the hose and clear any obstruction. Wait 1 minute before refitting. To reactivate the brushbar, switch the machine on and choose a floor selector button.

For how-to videos and
warranty registration visit
www.vax.co.uk

info@vax.co.uk **vax.co.uk**

Vax Ltd, Artillery House, Heritage Way, Droitwich, WR9 8YB, UK.