

# BUSH

## Instruction Manual

ME5585UCFR



You'll soon be enjoying your new freezer.

It all begins here, with your instructions. Don't worry, there's nothing too technical coming up. Just simple, step-by-step guidance to get you up and running quickly. Sound good? Then let's get started

## Help and Guidance

We're here to help you get the most from your freezer. Should you require any guidance, a simple solution can often be found online at.

**[www.bush-support.com](http://www.bush-support.com)**

If you still require further assistance, call one of our experts on 0345 257 7271.  
Issue-1, 4/1/2021

If you require any technical guidance or find that your product is not operating as intended, a simple solution can often be found in the **Troubleshooting** section of these instructions,

# Contents

## 1 Safety information

|                    |   |
|--------------------|---|
| Safety information | 6 |
|--------------------|---|

## 2 Getting to know your freezer

|                       |    |
|-----------------------|----|
| Ready? Let's begin... | 13 |
| Parts                 | 14 |

## 3 Installing your freezer

|                       |    |
|-----------------------|----|
| Transportation        | 17 |
| Electrical Connection | 18 |

## 4 Using your freezer

|                      |    |
|----------------------|----|
| Before first use     | 23 |
| Using your appliance | 23 |
| Useful information   | 23 |

## 5 Care and Maintenance

|                        |    |
|------------------------|----|
| General                | 27 |
| Light bulb replacement | 27 |
| Power failure          | 27 |
| Moving your appliance  | 27 |
| Technical Specific     | 28 |

## 6 Product support

|                     |    |
|---------------------|----|
| Trouble Shooting    | 31 |
| Help and assistance | 32 |
| Guarantee           | 33 |



# Safety information

1

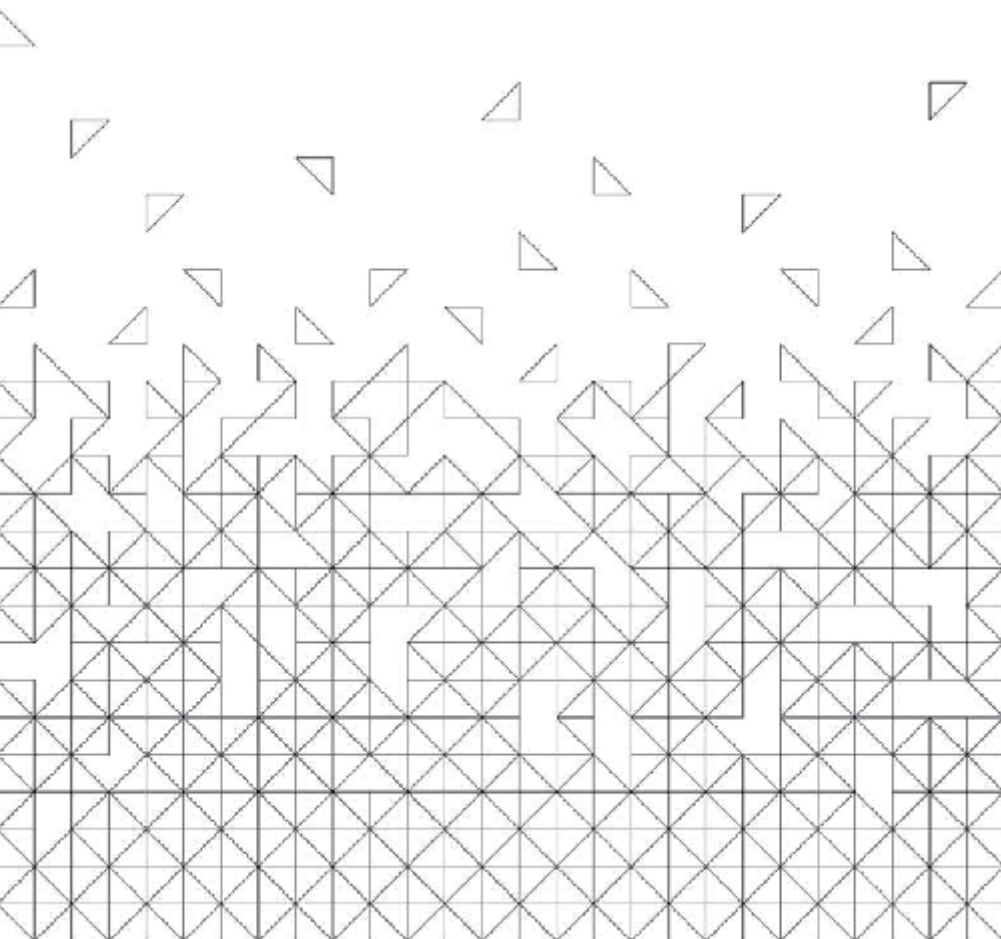



## Safety information

**Important**-Please read these instructions fully before installing or operating

### Before use

The installation of this appliance is best carried out by 2 people.

- Dispose of all packaging carefully and responsibly.
- The appliance is designed for **indoor use only** and must be protected from rain, moisture and extreme temperature variations.
- This appliance is designed for house hold use. **Do not** use the appliance for industrial and commercial use, or any other purpose.
- The appliance **MUST** be positioned on a firm level base.
- **Do not** splash water on the appliance. It may cause electrical parts to fail and result in an electric shock.
- Leave the appliance in its intended place of installation and in its correct orientation for at least 4 hours before switching on to allow the cooling system to settle before first use or after any transportation.
- Your appliance is an environmental friendly product and it contains non CFC/HFC gas substances in the cooling system (Called R600a) and in the insulation (Called cyclopentane) which are potentially flammable if exposed to fire. Therefore, take care not to damage, the cooling circuit/pipes of the appliance in transportation and in use. In case of damage do not expose the appliance to fire,



## Safety information

**Important**-Please read these instructions fully before installing or operating

potential ignition source and immediately ventilate the room where the appliance is situated.

- **Do not** sit, stand or place any other heavy objects on top of the appliance. This could result in injury or damage to the appliance.
- **Do not** allow children to play with the appliance to avoid the risk of entrapment and suffocation.
- Keep ventilation opening, in the appliance enclosure or in the built-in structure, clear of obstruction. During use
- This appliance is not intended for use by persons (including children) with reduced physical, sensory or mental capabilities, or lack of experience and knowledge, unless they have been given supervision or instruction concerning use of the appliance by a person responsible for their safety. Children should be supervised to ensure that they do not play with the appliance.
- This appliance is not intended for use by young children or infirm persons unless they have been adequately supervised by a responsible person to ensure that they can use the appliance safely. Young children should be supervised to ensure that they do not play with the appliance.
- **Do not** use mechanical,



## Safety information

**Important**-Please read these instructions fully

before installing or operating

electrical or chemical way to speed up the defrost process not recommended by the manufacturer.

- **Do not** use or place other electrical products inside the appliance not recommended by the manufacturer.
- **Do not** store liquids in glass containers in the freezer compartment as these may shatter.
- **Do not** store flammable materials such as alcohol, gasoline, LP gas or glue etc in the appliance.
- In case there is an inflammable gas leaking, open the window for air circulation and do not pull out the plug or turn the temperature knob. **Do not** touch the appliance until the valve of gas is turned off. Otherwise, sparks may happen.
- This appliance can be used by children aged from 8 years and above and persons with reduced physical, sensory or mental capabilities or lack of experience and knowledge if they have been given supervision or instruction concerning use of the appliance in a safe way and understand the hazards involved. Children shall not play with the appliance. Cleaning and user maintenance shall not be made by children without supervision.
- **Do not** attempt to repair the appliance yourself. Contact the Customer Helpline: 0345 257 7271.
- Cord entanglement hazard. The cable of the appliance can give rise to risks of entanglement, strangulation or tripping if not correctly placed. You must make sure that the electric cable is positioned safely.

If you require any technical guidance or find that your product is not operating as intended, a simple solution can often be found in the Troubleshooting section of these instructions.





## Safety information

**Important**-Please read these instructions fully before installing or operating

### Before use



**Warning: risk of fire**

- **When** positioning the appliance, ensure the supply cord is not trapped or damaged.
- **Do not** locate multiple portable socket-outlets or portable power supplies at the rear of the appliance.
- **Children** aged from 3 to 8 years are allowed to load and unload freezing appliances.
- **To** avoid contamination of food, pay attention to the following:
  - opening** the door for long periods can cause a significant increase of the temperature in the

compartments of the appliance;

-**clean** regularly surfaces that can come in contact with food and accessible drainage systems;

-**clean** water tanks if they have not been used for 48 hours; flush the water system connected to a water supply if water has not been drawn for 5 days;

-**store** raw meat and fish in suitable containers in the freezer so that it is not in contact with or drip onto other food;

-**two-star frozen-food** compartments are suitable for storing pre-frozen food, storing or making ice-cream and making ice cubes;



## Safety information

**Important-** Please read these instructions fully before installing or operating

### **-one-, two- and three-star**

compartments are not suitable for the freezing of fresh food;

**-if** the freezing appliance is left empty for long periods, switch off, defrost, clean, dry and leave the door open to prevent mould developing

within the appliance.

- **Do not** attempt to repair the appliance yourself. Contact the Customer Helpline: **0345 257 7271.**
- For a freestanding appliance: this refrigerating appliance is not intended to be used as a built-in appliance.

## Using your chest freezer

### Getting the most from your appliance Storing food

The table below contains general guidelines on the storage of food in the freezer.

| Freezer location                     | Type of food  |
|--------------------------------------|---|
| Crisper bin (salad bin)              | <ul style="list-style-type: none"><li>• Foods with natural preservatives, such as jams, juices, drinks, condiments.</li><li>• Do not store perishable foods.</li></ul>  |
| Fridge door                          | <ul style="list-style-type: none"><li>• Fruits, herbs and vegetables should be placed separately in the crisper bin.</li><li>• Do not store bananas, onions, potatoes, garlic in the <b>freezer</b>.</li></ul>  |
| Fridge shelf – bottom<br>Chiller bin | <ul style="list-style-type: none"><li>• Raw meat, poultry, fish (for short-term storage)</li></ul>  |
| Fridge shelf – middle                | <ul style="list-style-type: none"><li>• Dairy products, eggs</li></ul>  |
| Fridge shelf – top                   | <ul style="list-style-type: none"><li>• Foods that do not need cooking, such as ready-to-eat foods, deli meats, leftovers.</li></ul>  |
| Freezer drawer/shelf                 | <ul style="list-style-type: none"><li>• Foods for long-term storage.</li><li>• Bottom drawer/shelf for raw meat, poultry, fish.</li><li>• Middle drawer/shelf for frozen vegetables, chips.</li><li>• Top drawer/shelf for ice cream, frozen fruit, frozen baked goods.</li></ul> |





## Getting to know your freezer

2

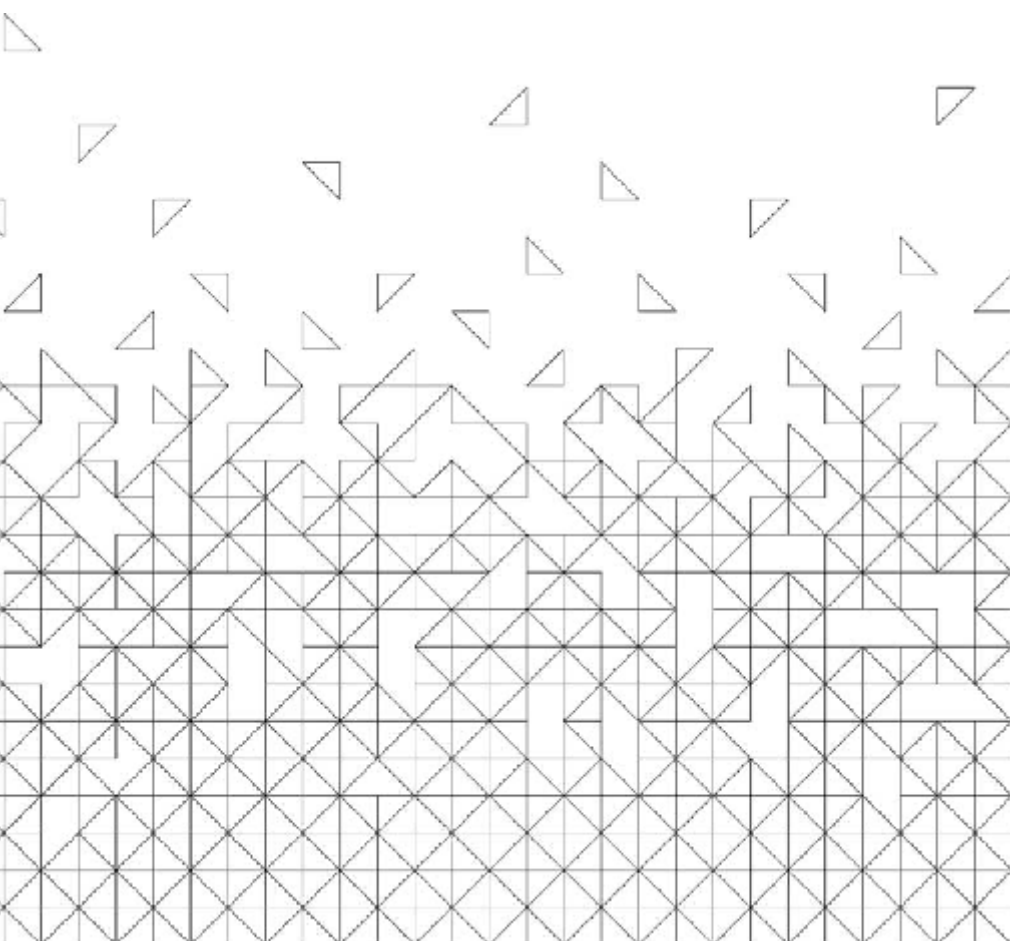

# Getting to know your freezer

You'll be up and running in no time

## Ready? Let's begin...

Please read these instructions carefully. They contain important information which will help you get the best from your freezer and ensure safe and correct installation and operation

If you require any further assistance, our technical experts are happy to help. For full details, refer to the product support section at the end of these instructions.

# Getting to know your freezer

You'll be up and running in no time

## Parts



1、Thermostat

2、Small drawers

3、Large freezer drawer

4、Levelling feet

## Accessories included

**BUSH** Instruction Manual  
H00001-001



Instruction x 1



Turning Thermostat  
tools x 1

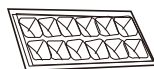

Ice Tray x 1

If you require any technical guidance or find that your product is not operating as intended, a simple solution can often be found in the **Troubleshooting** section of these instructions.





## Installing your freezer

3

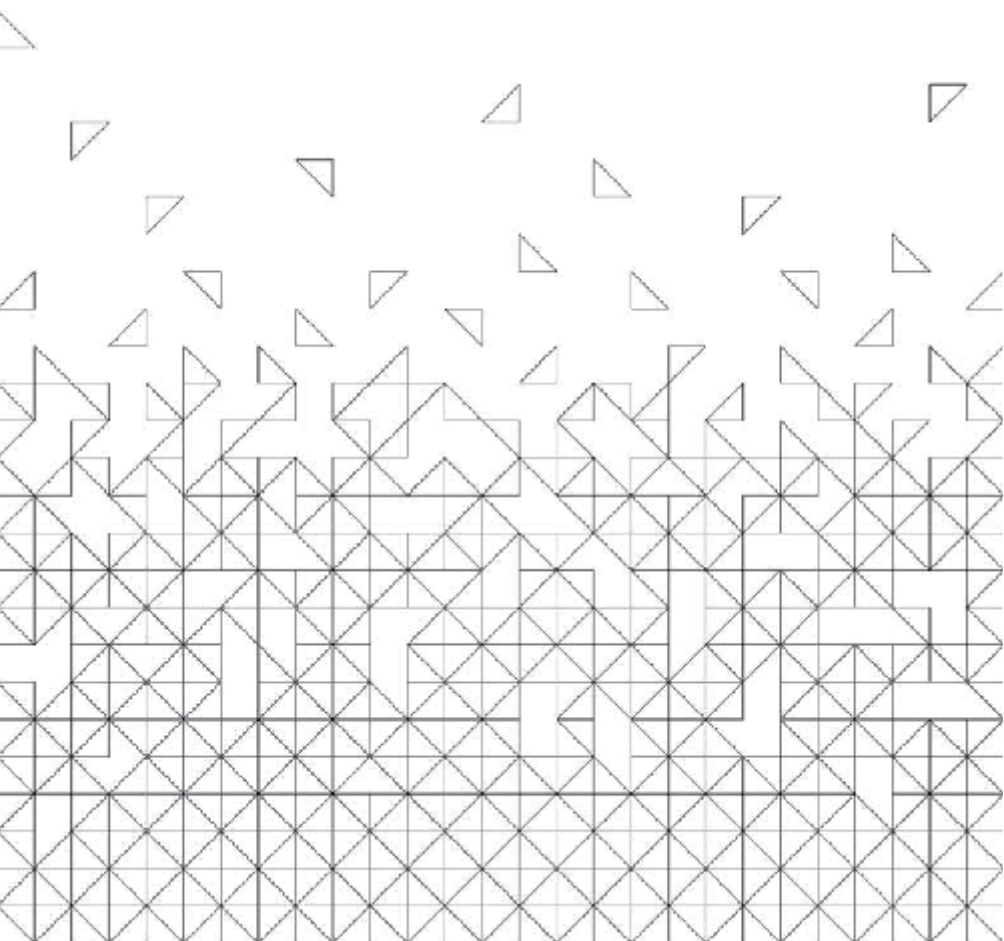



# Installing your freezer

## Bringing it all together

### Transportation



**Caution:** 2 people are required to unpack and handle the appliance, it is recommended that gloves are worn.

- The appliance should be transported only in an upright position. Do not tilt the appliance greater than 45 degrees. The packaging as supplied must be intact during transportation.
- After transporting the appliance, leave it for at least 4 hours before switching on to allow the cooling system to settle. Failure to comply could result in damage to the appliance.
- Do not move the appliance by pulling the door or handle as it may damage your flooring and wall coverings etc.
- Empty any water in the drain tray before moving.
- Make sure that the defrost water pipe at the back of the product is fixed to the plastic evaporating pan on the top of the compressor, to avoid defrost water spillage on the floor.
- Ensure the supply cable is not caught under the appliance during and after moving.
- Carefully remove all packaging materials including the foam base, dispose of correctly

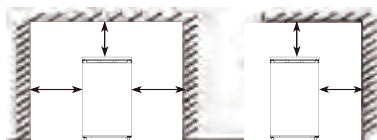

### Installation

- Ensure sufficient spacing is provided for the appliance to be installed. Leave space on both side (10cm) & back (10cm). If a gap can be available on top, it would improve the air circulation around the product. (DO NOT place the object on the top.)
- Do not place the appliance near a heat source or in direct sunlight.
- Do not put any heavy objects on top of the appliance. It will damage the appliance.
- Do not install the appliance in a moist and wet place.
- Adjust the feet at front to level the appliance. It should be installed on a smooth surface to avoid excessive vibration and noise.
- Each appliance has a climate class (shown on the rating plate) where it indicates the temperature range of the appliance operation in place. The appliance may not work properly if it is left for a long period at a temperature outside the specified range.



| Climate Class | Amb.T.(°C) | Amb.T.(°F) |
|---------------|------------|------------|
| SN            | 10~32°C    | 50~90°F    |
| N             | 16~32°C    | 51~90°F    |
| ST            | 16~38°C    | 61~100°F   |
| T             | 16~43°C    | 61~110°F   |

# Installing your freezer

## Bringing it all together

### Electrical connection



**Any electrical work that is required to install this appliance MUST be carried out by a qualified electrician.**



**Warning: THIS APPLIANCE MUST BE EARTHED**

**Before making any electrical connections, ensure that:**

- Electrical safety is only guaranteed when the earth system of your house is in accordance with the related local regulations.
- Do not damage the refrigerant circuit.
- Do not bend, stretch or pull the supply cable to avoid electric shock.
- Do not use electrical appliances inside the food storage compartments of the appliance, unless they are of the type recommended by the manufacturer.
- Ensure the power socket is suitable for the maximum power of the machine (fuses in the power circuit must be 13 amp).
- The supply voltage should be the same as that indicated in the technical specifications and the appliance rating plate.
- The appliance should be earthed and in compliance with the applicable law.
- When installed, the power socket must be within easy reach.
- If the socket outlets in your home are not suitable for the plug supplied with this unit check with a qualified electrician for replacement.
- The use of adapters, multiple connectors or extension cables are not recommended.
- The appliance must be connected to a 220-240 volt 50Hz AC supply by means of a three pin socket, suitably earthed and protected by a 13 amp fuse.
- Should the fuse need to be replaced, a 13 amp fuse approved to BS1362 must be used.
- The plug contains a removable fuse cover that must be refitted when the fuse is replaced. If the fuse cover is lost or damaged, the plug must not be used until a replacement cover has been fitted or the plug is replaced.

• A damaged plug should be cut off as close to the plug body as possible, the fuse should be removed and the plug disposed of safely.

### Plug replacement (UK & Ireland only)

Should you need to replace the plug; the wires in the power cable are coloured in the following way:

Blue Neutral 'N'

Brown Live 'L'

Green & Yellow Earth 'E'

As the colours of the wires in the power cable may not correspond with the coloured markings identifying the terminals in your plug, and proceed as follows:

The green & yellow wire must be connected to the terminal in the plug that is marked with the letter E or by the earth symbol.

The blue wire must be connected to the terminal that is marked with the letter N.

The brown wire must be connected to the terminal that is marked with the letter L.

If the power supply cord is damaged, it must be replaced by the manufacturer or its service agent or a similar qualified person in order to avoid a hazard.

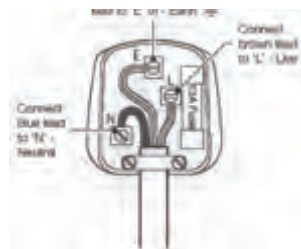

# Installing your freezer

## Bringing it all together

### Door Reverse

1. Remove the 2 screws on the back.

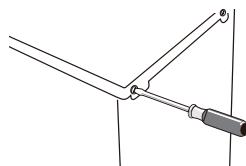

2. Lift the top cover away from the fridge.

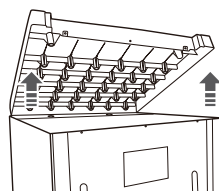

3. Remove the upper screws, then remove the upper hinge that hold the door in place. Lift the door and place it on a padded surface to prevent it from scratching.

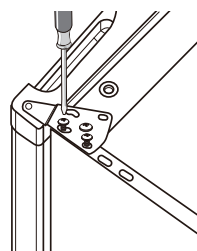

4. Place the door stopper in the opposite side.

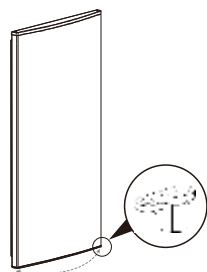

5. Remove the bottom screws, bottom hinge and levelling feet from the unit bottom.

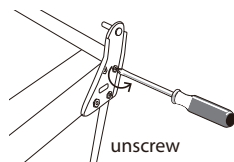
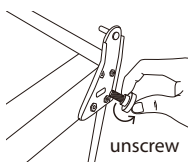

# Installing your freezer

## Bringing it all together

### Door Reverse

6. Remove the levelling feet from another side of the unit bottom and transfer it to the corresponding position on the opposite side of the unit bottom.

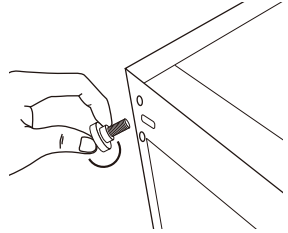

7. Reattach the bottom screws, bottom hinge and levelling feet to the opposite side of the unit bottom. Loosely secure.

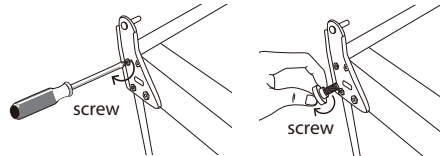

8. Carefully set the door back into place. Install the upper hinge and screws. Ensure the door is aligned horizontally and vertically so that the seals are closed on all sides before finally tightening the upper hinge. Use a spanner to tighten it if necessary.

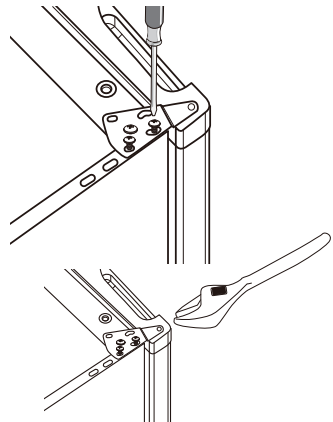

9. Put the top cover back and fix it in place with the screws.

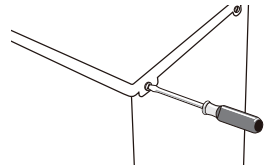

10. With the door closed, check that the door is aligned horizontally and vertically and that the seals are closed on all sides before finally tightening the bottom hinge. Re-adjust the levelling feet as needed.

