

**Assembly Diagrams**

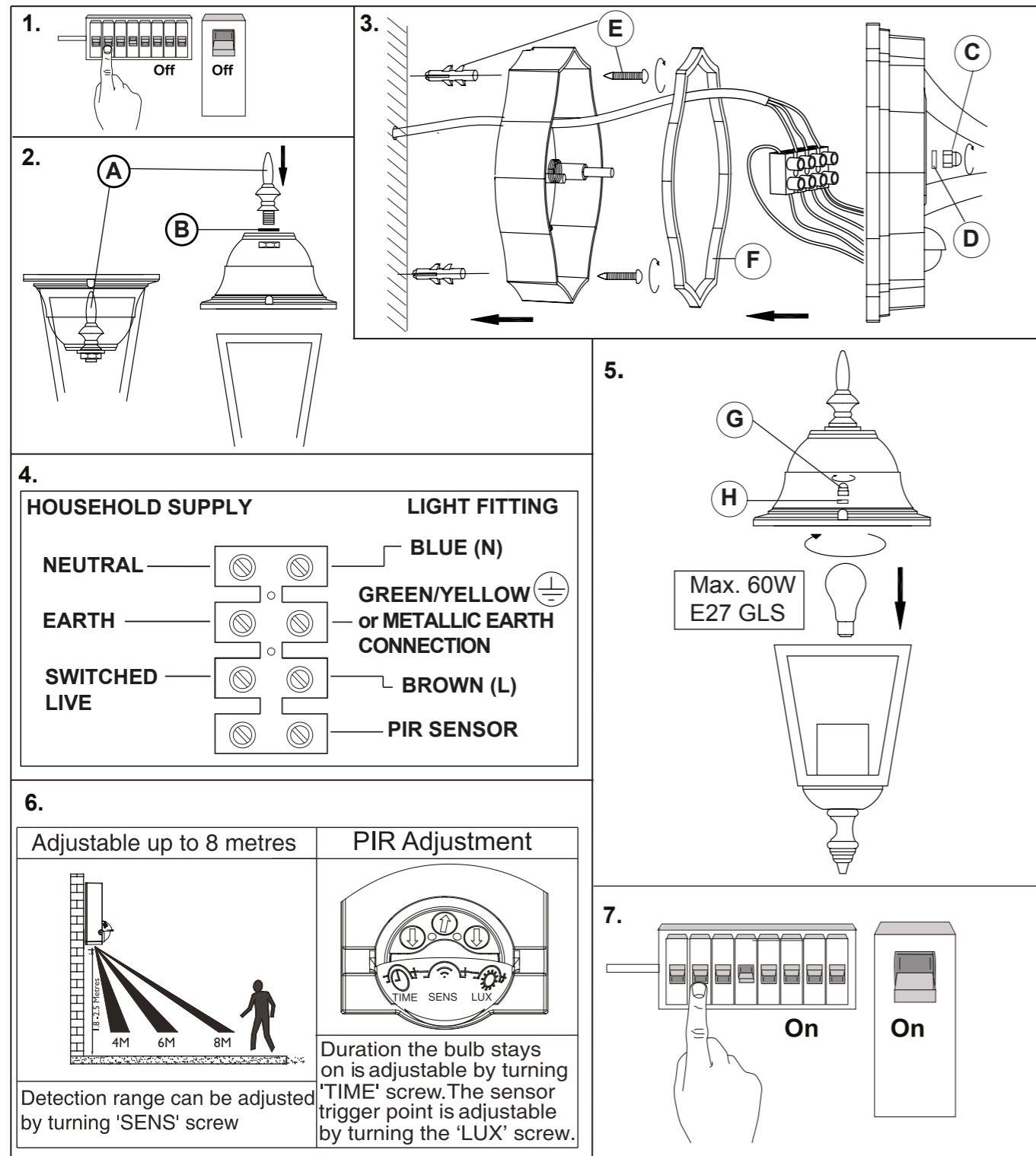

HOME

**Cambridge Outdoor Wall Light**

SKU 914/9106, 916/4837



**Care & Instruction Manual**

Suitable for outdoor use.

Please read and retain these instructions for future reference.

We care about quality and what you think, if you have any comments, good and bad, please call our Careline **0800 636 262** or visit [www.sainsburys.co.uk](http://www.sainsburys.co.uk) Your statutory rights are not affected.

Produced in China for Sainsbury's Supermarkets Ltd, 33 Holborn, London EC1N 2HT.

## **WARNING**

### **This is a Class 1 product and must be earthed.**

- Please read these instructions carefully before commencing any work and keep them for future reference. It is recommended that this fitting is installed by a qualified electrician.
- Install in accordance with the current IEE Wiring regulations and current Building Regulations.
- To prevent electrocution switch off at mains supply before installing or maintaining this fitting. Ensure other persons cannot restore the electrical supply without your knowledge. If you are in any doubt, please consult a qualified electrician.
- This light fitting should be connected to the 5/6 Amp fused lighting circuit in your home.
- If replacing an existing fitting, make a note of the connections.
- Always use the correct type and wattage bulb. Never exceed the wattage stated.
- When changing a bulb, always switch off at the mains and allow the old bulb to cool down before handling.
- Dispose of used bulbs carefully.
- This product is IP44 rated and suitable for outdoor use.

## **INSTALLATION**

Please refer to Assembly Diagrams on back page.

Make sure you have the following required items to install this fitting:

- Small electrical & cross head screwdriver & insulation tape

Please note: The installation of this product will be much easier with the help of an assistant

### **Step 1**

The decorative finial (A) has been attached inside the top canopy to reduce the package size. It is necessary to remove it and reattach it to the outside of the top of the canopy. Ensure rubber washer (B) is fitted under the finial. **Refer to Assembly Diagram 2.**

### **Step 2**

Remove the finials (C) and rubber washers (D) from the front of the product and lift the light fitting body away from the wall back. Keep the finials and washers in a safe place for refitting later.

**Refer to Assembly Diagram 3.**

### **Step 3**

Using the wall back as a template, mark the position of the mounting holes. Drill holes and fit supplied wall plugs (suitable for masonry only - for other surfaces use appropriate fixings). Make sure the wall back is correctly oriented with the drain hole at the base. Take care not to damage any wiring or pipes when drilling the holes. **Refer to Assembly Diagram 3.**

### **Step 4**

Carefully pierce a small hole in the rubber grommet in the mounting box to allow the cable to pass through. Feed the incoming mains supply cable through the grommet entry hole.

**Refer to Assembly Diagram 3.**

### **Step 5**

Secure the wall back to the wall using the screws and wall plugs supplied (E). Ensure the wall is capable of holding the weight of the product.

**Refer to Assembly Diagram 3.**

### **Step 6**

Having identified the household wiring from your existing light fitting, connect to the connection block inside the product as shown **in Assembly Diagram 4.**

### **Check that:-**

- The wiring connections are tight
- The earth wire is correctly fitted to the earth connection
- The incoming mains cable is kept away from the heat of the lamp
- The grommet is still in place to maintain the IP rating

### **Step 7**

Place the light fitting over the threads of the securing screws and refit the washers (D) and finials (C) to secure. Make sure the rubber seal (F) is in place to maintain the IP rating and ensure the fitting is correctly oriented - lampholder must point upwards. **Refer to Assembly Diagram 3.**

### **Fitting/Replacing the bulb - Max. 60W E27 GLS**

To access the bulb, unscrew the finials (G) and washers (H) from the top of the shade and set aside for refitting later.

When changing a bulb, always switch off at the mains and allow the bulb to cool before handling. Dispose of used bulbs carefully. Do not exceed the wattage stated. This fitting is compatible with energy saving lightbulbs. **Refer to Assembly Diagram 5.**

### **Fitting the shade top**

Refit the finials (G) and washers (H) set aside earlier. **Refer to Assembly Diagram 5.**

### **PIR Adjustment**

- The unit must be installed in a vertical position, and fitted 1.8-2.5m above the ground.
- The PIR sensor can be adjusted, allowing the detection distance to be altered to suit the location. The LUX control level is adjustable between 10-20000 lux. The detection angle is set at 120 degrees. The duration that the lamp stays on can be altered from (10±5) seconds - (5±1) minutes. The detection distance "SENS" can be adjusted up to 8m. A small screwdriver is required to adjust the controls. When adjusting in daylight it will be necessary to cover the sensor to simulate night time.
- To access the adjustment screws flip down the cover over the PIR sensor. Take great care when adjusting the sensor screws not to overtighten as they can be easily broken.

**Refer to Assembly Diagram 5.**

### **Step 8**

Replace fuse or circuit breaker and switch on. Your light is now ready for use.

**Refer to Assembly Diagram 6.**

### **Care and cleaning**

Finish - We recommend cleaning with a soft dry cloth. Do not use abrasive materials as these will damage the finish.

### **Safety Information**

For your safety, always switch off the supply before changing lightbulbs, cleaning or removing shades.

### **Recycling Information**



Waste electrical products should not be disposed of with household waste. Please recycle where facilities exist. Check with your Local Authority or retailer for recycling advice.