

# Addie

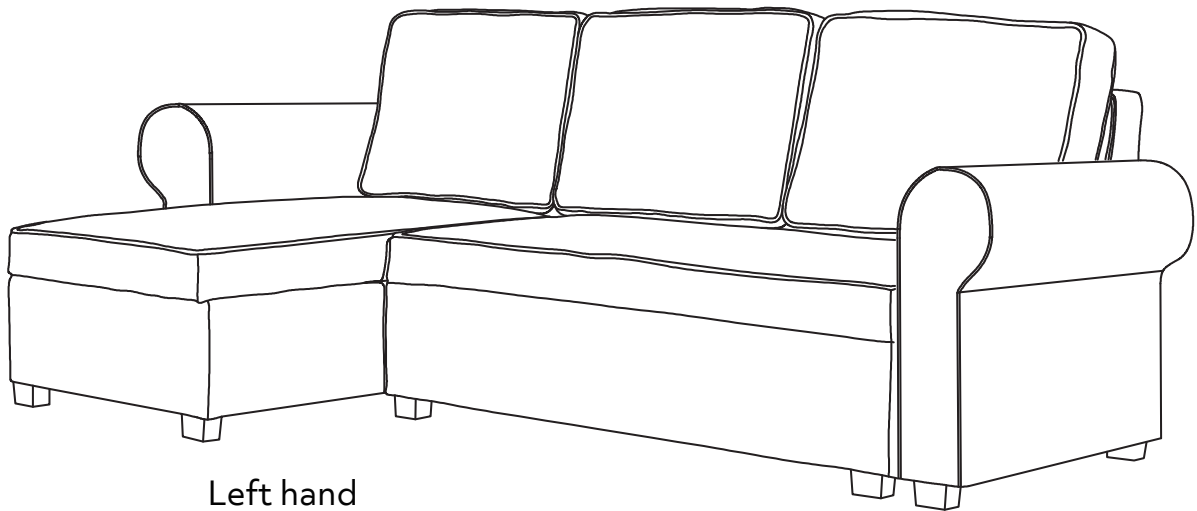

Left hand

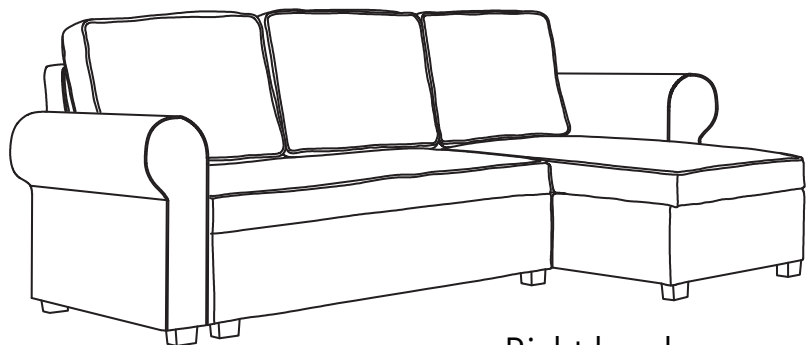

Right hand

## Spare Parts

 [www.argos-support.co.uk](http://www.argos-support.co.uk)

 [Help@ClickSpares.co.uk](mailto:Help@ClickSpares.co.uk)

 0370 112 1928

## Customer Support

 0345 640 2020



# Safety and Care Advice

---

## Product Details

Sofa Bed 913/5268  
Sofa Bed Charcoal 8809911

## IMPORTANT, RETAIN FOR FUTURE REFERENCE: READ CAREFULLY.

- Keep children and animals away from the work area, small parts could choke if swallowed.
- Make sure you have enough space to layout the parts before starting.
- This product has been constructed to be used in the domestic environment only and not for commercial purposes.

- Assemble the item as close to its final position (in the same room) as possible.
- Assemble on a soft level surface to avoid damaging the unit or your floor.

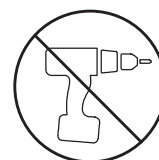

- We do not recommend the use of power drill/drivers for inserting screws as this could damage the unit. Only use hand screwdrivers.
- Parts of the assembly will be easier with 2 people.
- Dispose of all packaging carefully and responsibly.

## Care and maintenance

---

- Only clean using a damp cloth and mild detergent. Do not use abrasive cleaners.
- Use a dry cloth to clean the product, furniture polish is not recommended.

- From time to time check that there are no loose screws, nuts or bolts. If there are please re-tighten.

- This product should not be discarded with household waste. Take to your local authority waste disposal centre

# Fittings (Shown to scale)

A



50mm M4 Wood screw x 16

B



30mm M4 Wood screw x 9

# Parts

---

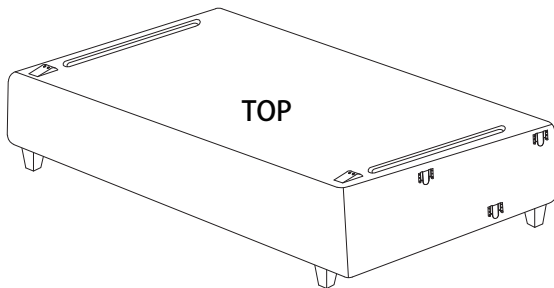

( Note :Feet pre-assembled )

- 1 Sofa base  
1290 x 680 x 230mm

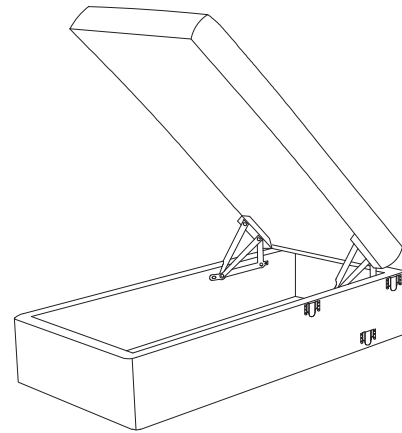

- 2 Ottoman  
1260 x 650 x 350mm

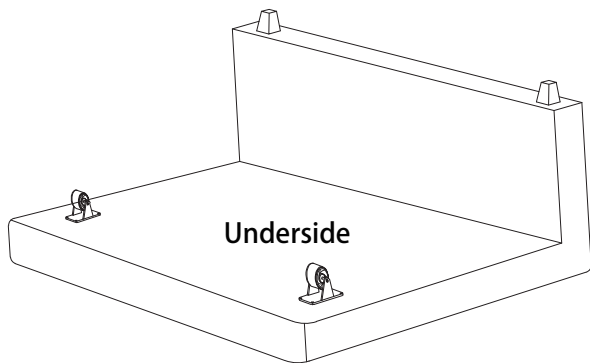

( Note :Feet /Castors pre-assembled )

- 3 Sofa seat  
1280 x 770 x 410mm

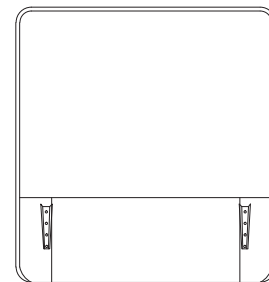

- 4 Ottoman backrest  
655 x 660 x 140mm

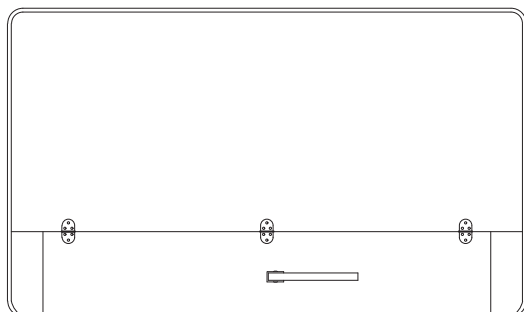

- 5 Sofa Backrest  
1290 x 680 x 140mm

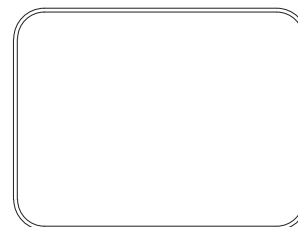

- 6 Cushion x 3  
660 x 460 x 120mm

# Parts

---

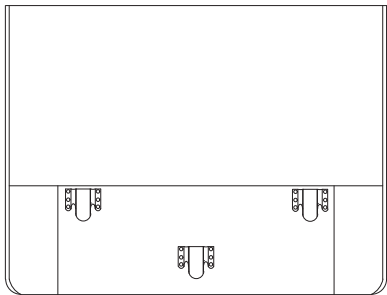

7 Side arm ( Right )  
910 x 540 x 175mm

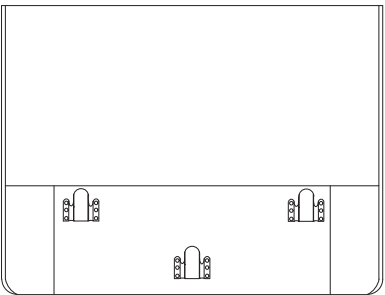

8 Side arm ( Left )  
910 x 540 x 175mm

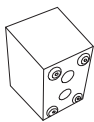

9 Foot x 8  
70 x 50 x 50mm

# Tools required

---

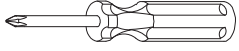

Phillips screwdriver  
(small & medium)

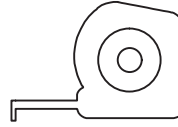

Ruler/tape  
measure

# 1

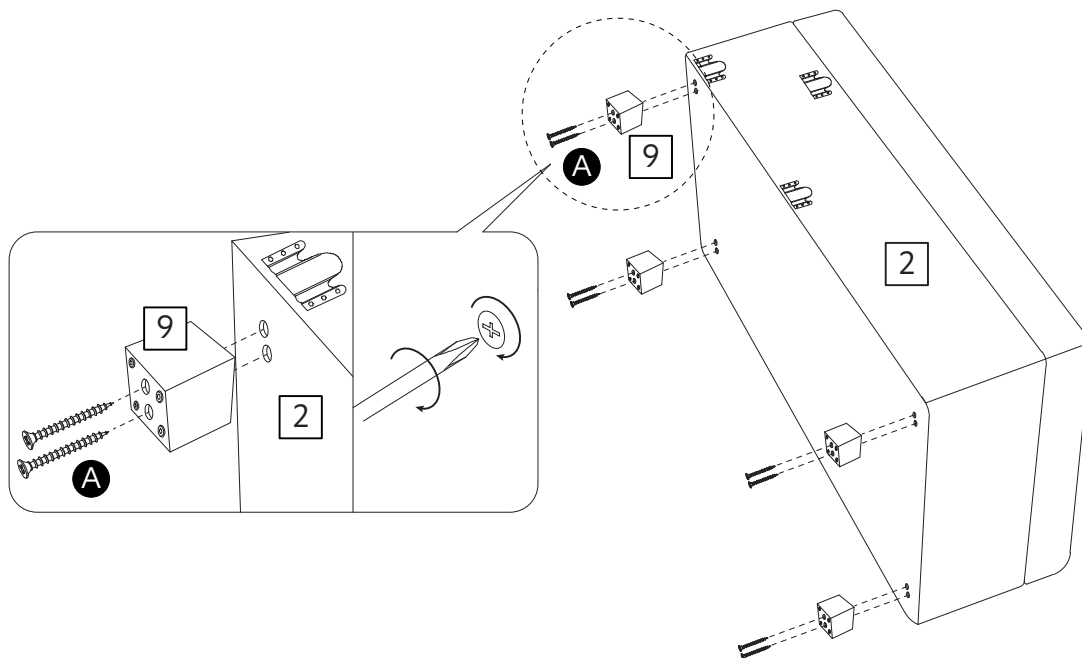
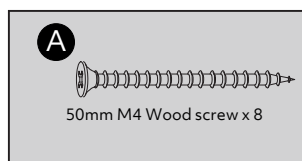
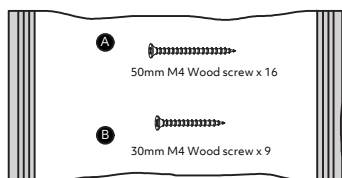

# 2

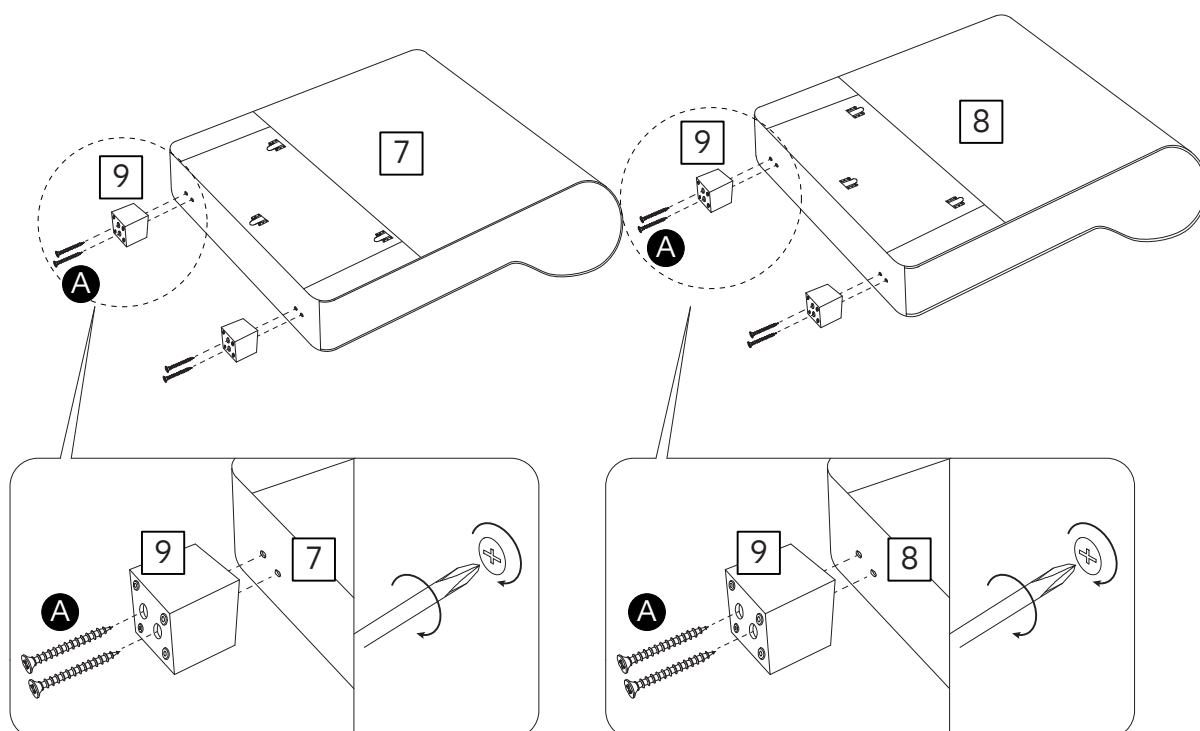
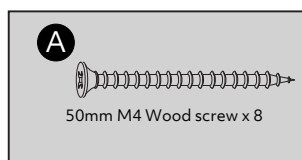

# 3

## Select left hand or right hand

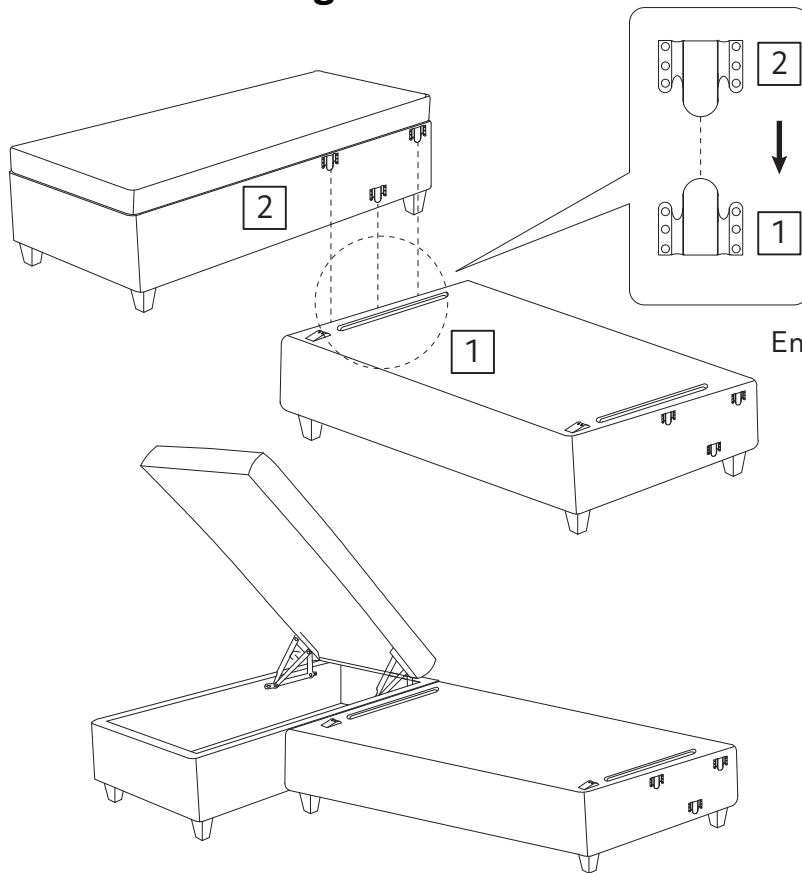

Engage metal brackets.

Left hand

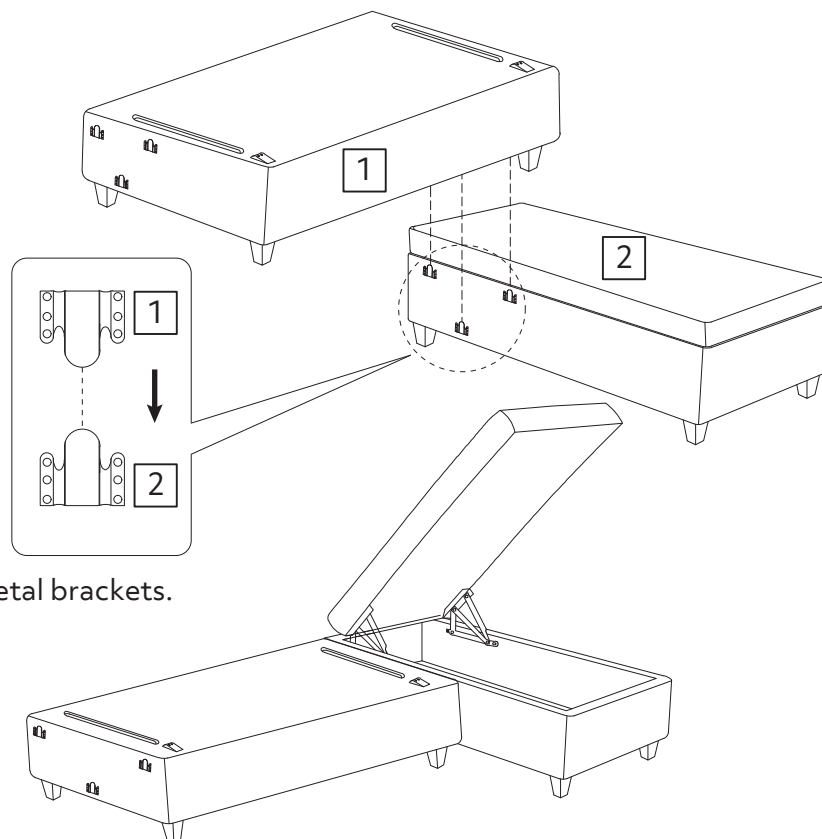

Engage metal brackets.

Right hand



# 4

## Left hand

Engage metal brackets.

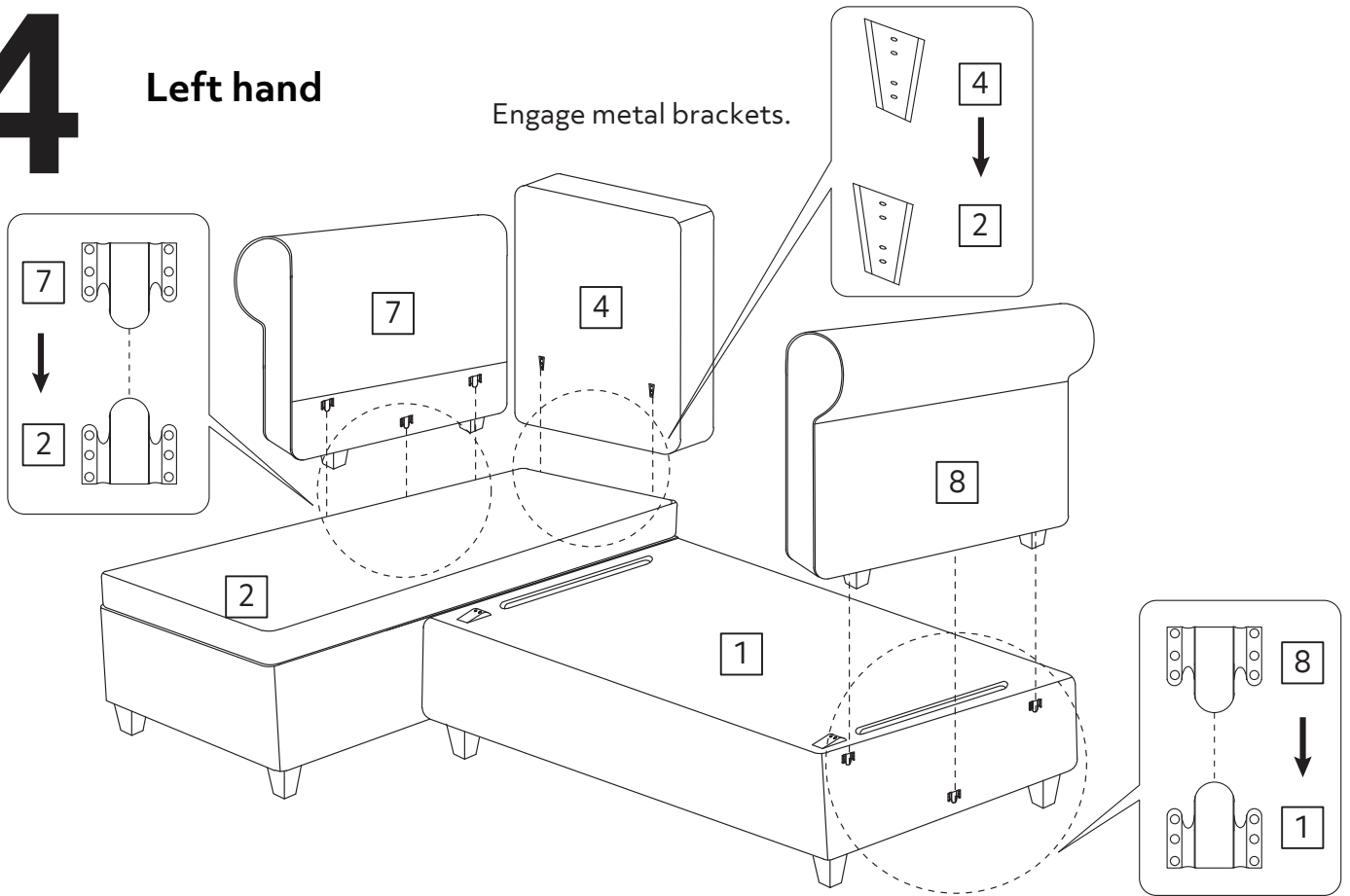

## Right hand

Engage metal brackets.

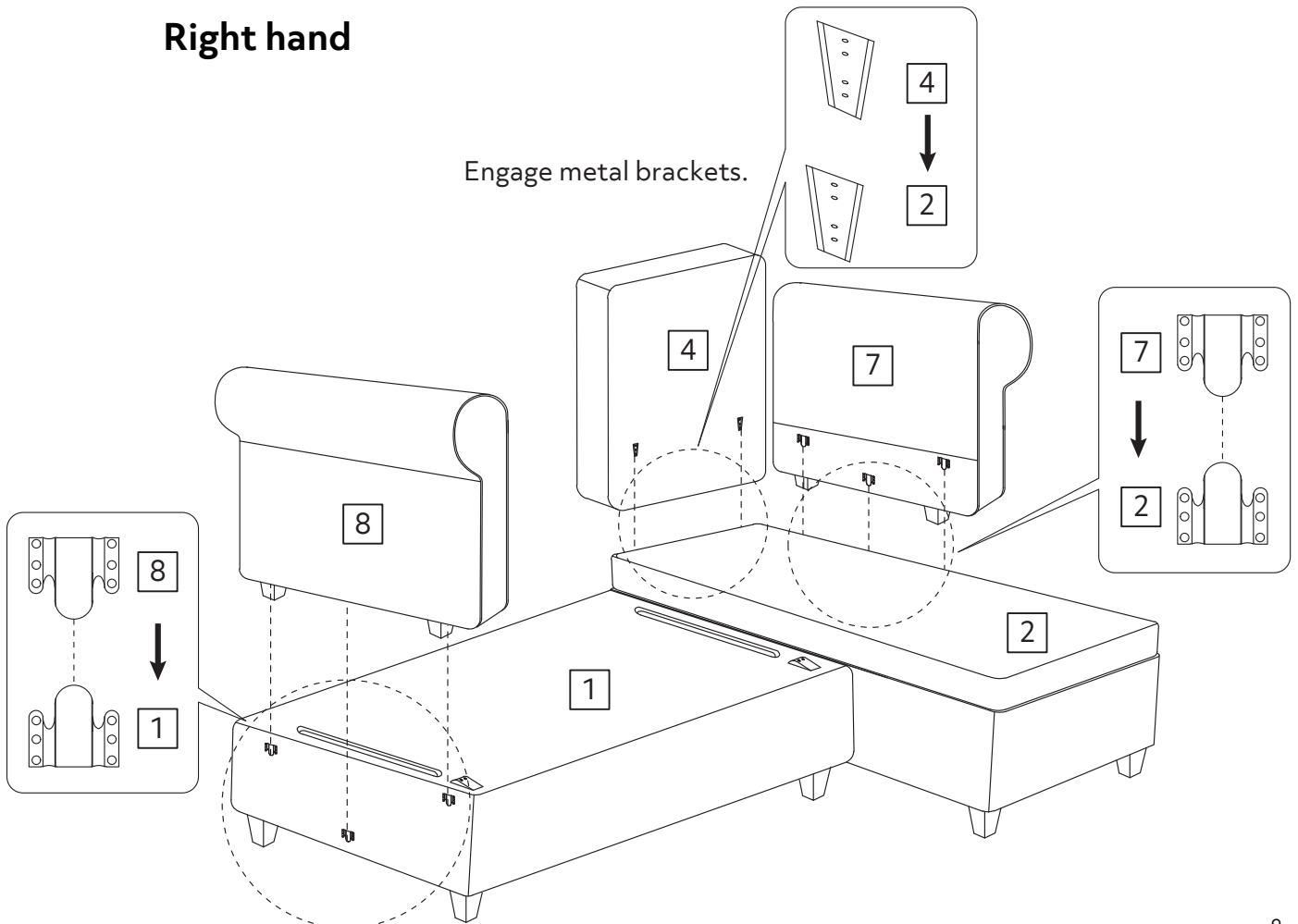

# 5

B



30mm M4 Wood screw x 9

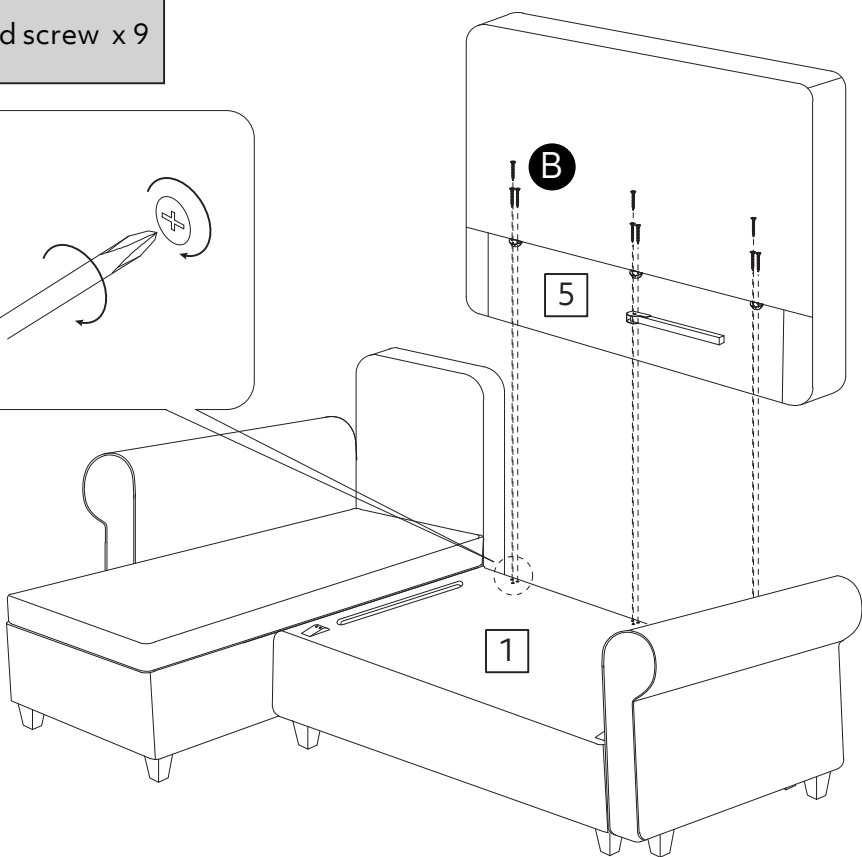
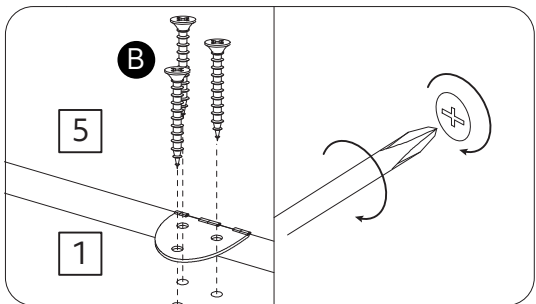

# 6

Sofa

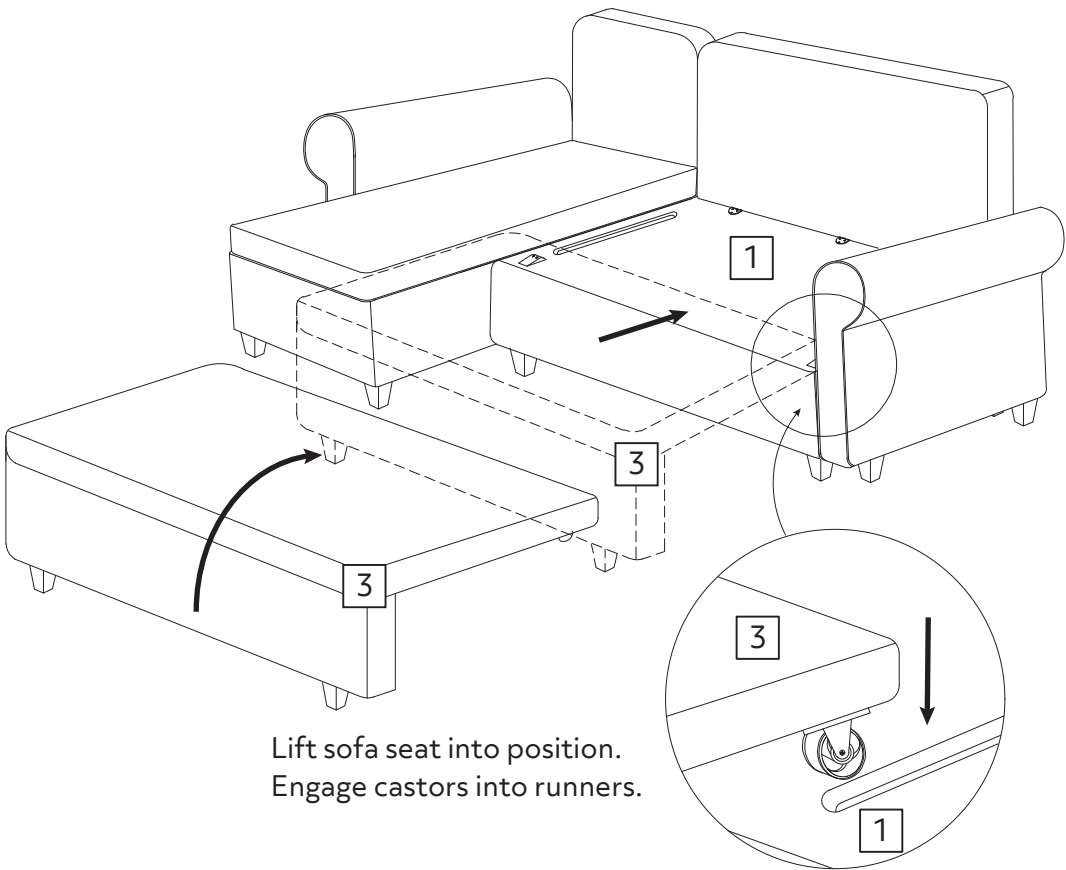

# 7

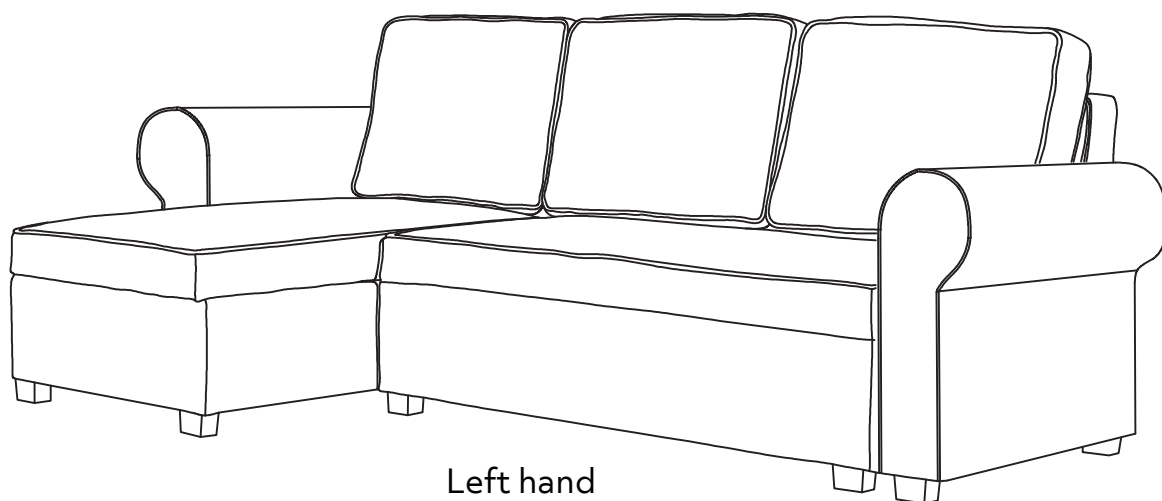
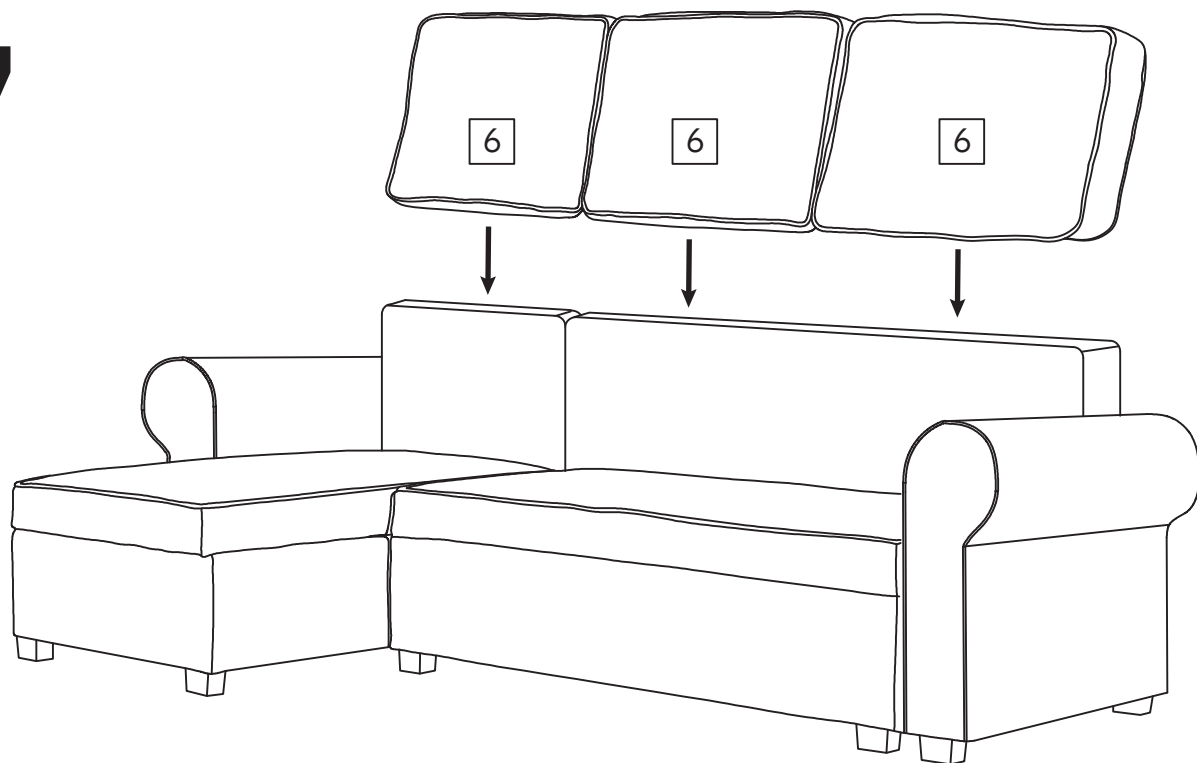

Left hand

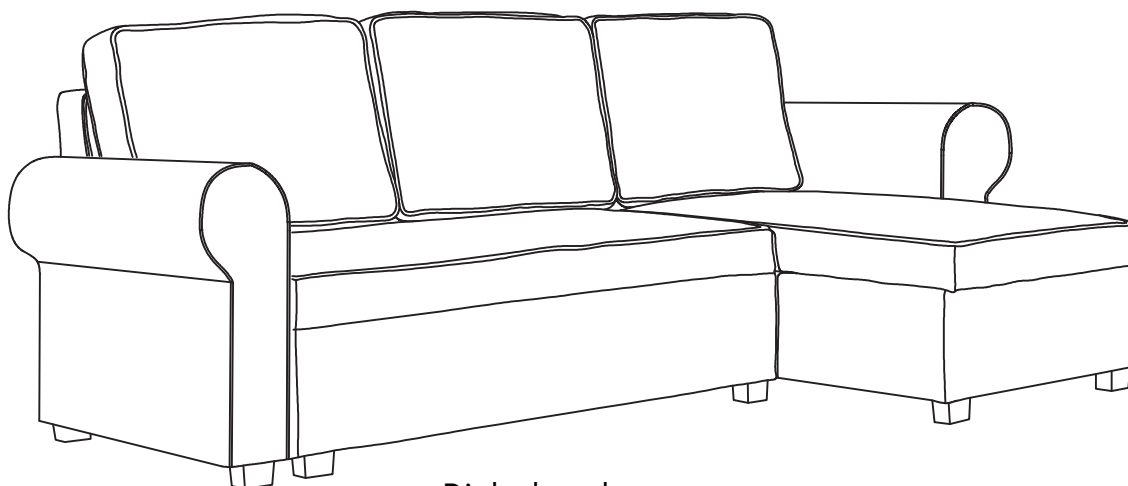

Right hand

# 8

## Bed

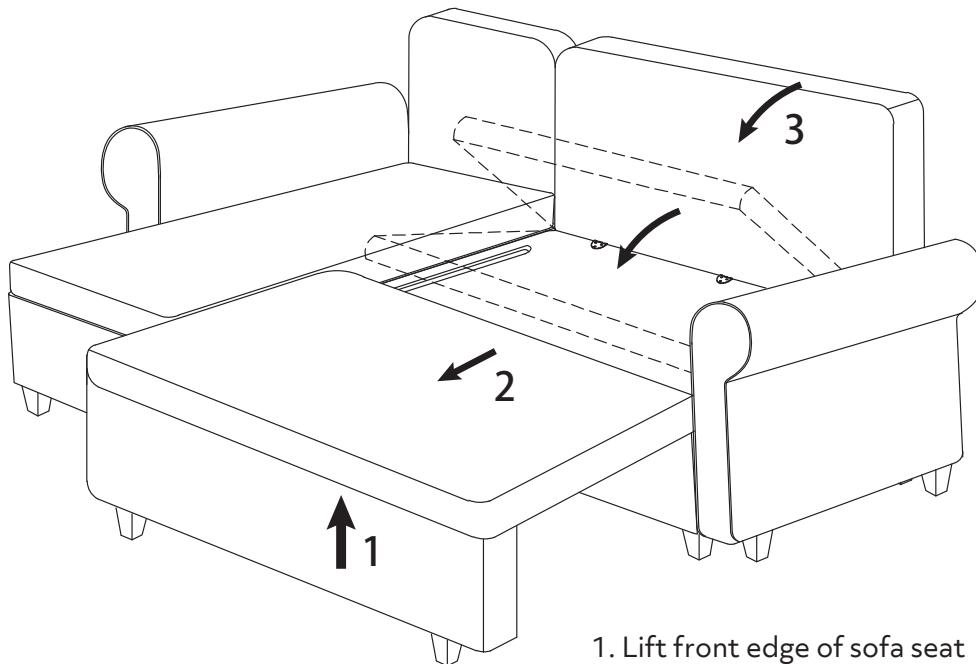

1. Lift front edge of sofa seat
2. Pull out sofa seat
3. Lower backrest
4. Extend leg support

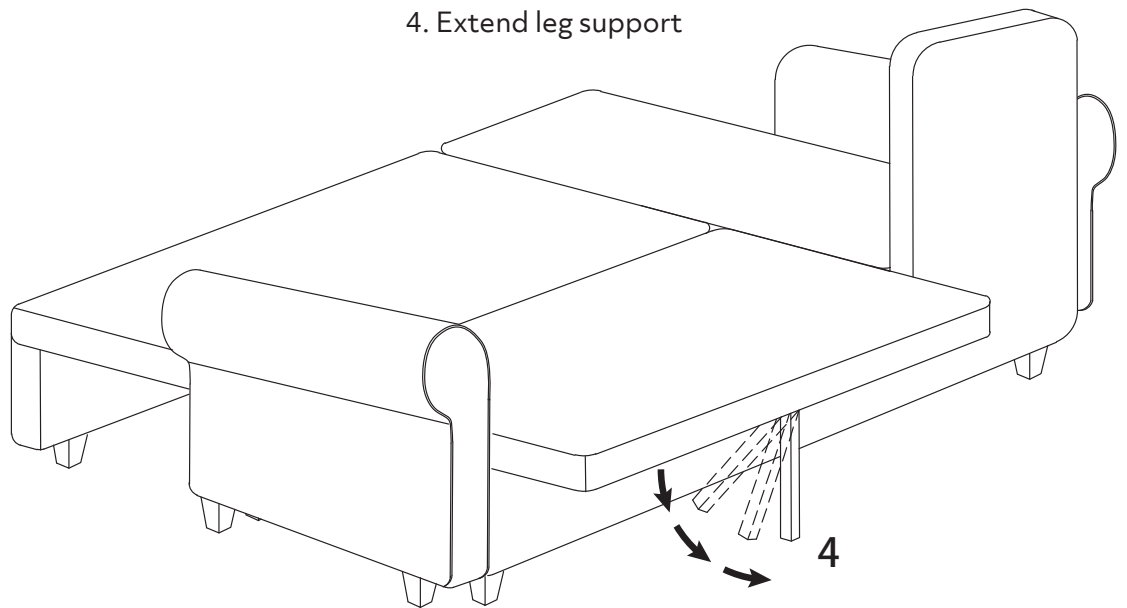

### IMPORTANT

Fold out leg must be extended down whilst in the sleeping position!