

Seville

187/8633 886/1296 433/8792

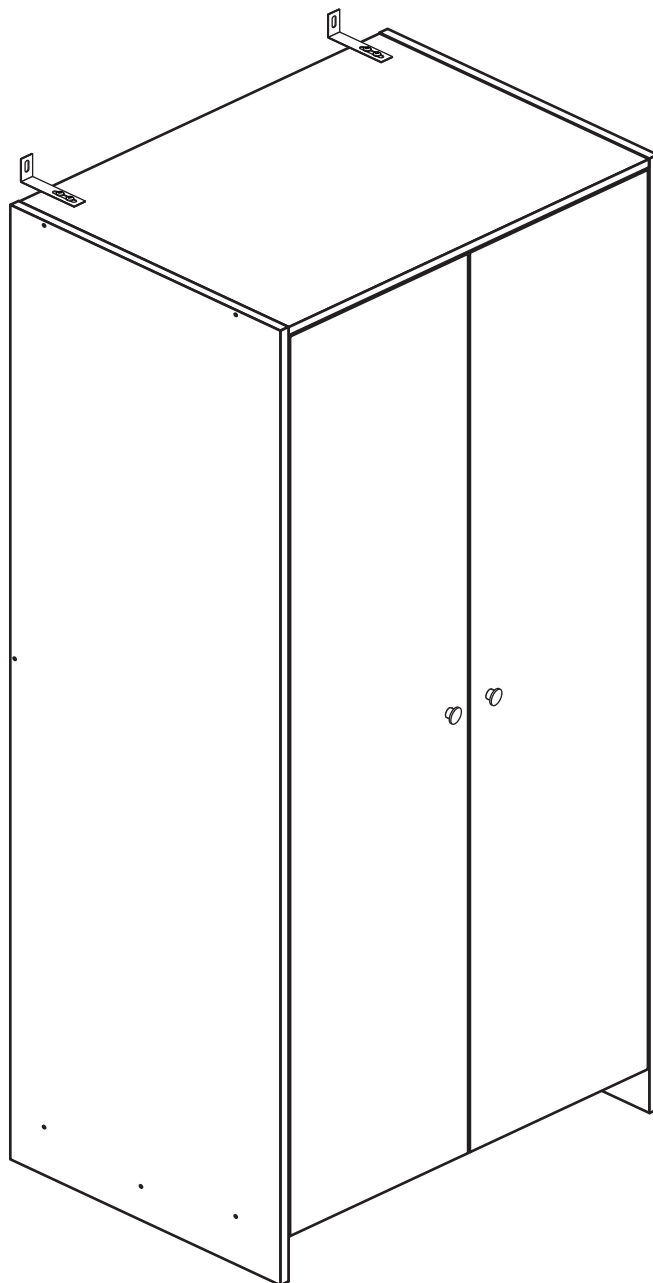

Spare Parts

Visit: www.argos-support.co.uk

Email: Help@ClickSpares.co.uk

Call: 0370 112 1928

Customer Support

Call: 0345 640 2020

Safety

Important - Please read these instructions fully before starting assembly

- Warning: This unit weighs approximately 39kgs. Please lift with care.
- During assembly children should be kept away from the product due to possible risk of injury.
- Installation shall only be carried out exactly according to the manufacturer's instructions - otherwise a safety risk can occur if incorrectly installed.
- Do not use this item if any components are missing or damaged.

- **WARNING:** To prevent possible overbalancing this unit must be secured to a wall using the 2 overbalance protector kits supplied.
- A unit that is allowed to topple can cause serious or fatal injury. In addition to wall fixing the unit, place heavy items in the lower drawers, do not put any heavy objects on top of the unit and never allow children to climb or hang on drawers, doors or shelves.

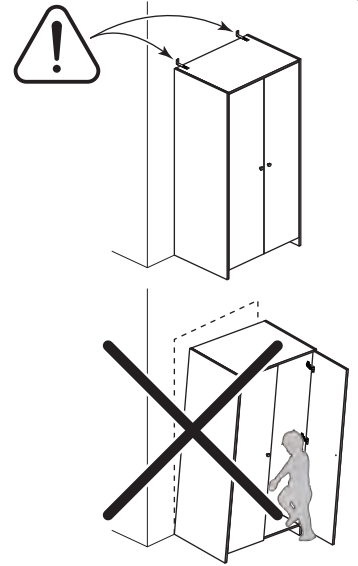

- Refer to guide after section 10 for wall fixing information.

Care Advice

- Check you have all the components and tools listed on page 4.
- Remove all fittings from the plastic bags and separate them into their groups.
- Parts of the assembly will be easier with 2 people.
- Make sure you have enough space to layout the parts before starting.
- Do not stand or put weight on the product, this could cause damage.

- When applicable, remove any protective film from the panels before they are used.
- Assemble the item as close to its final position (in the same room) as possible.
- Assemble on a soft level surface to avoid damaging the unit or your floor (use opened out unit carton).



- Assembly videos are available throughout these instructions by scanning in the QR codes.



- We do not recommend the use of power drill/drivers for inserting screws, as this could damage the unit. Only use hand screwdrivers.
- Dispose of all packaging carefully and responsibly.
- Only clean with a damp cloth.

Tools

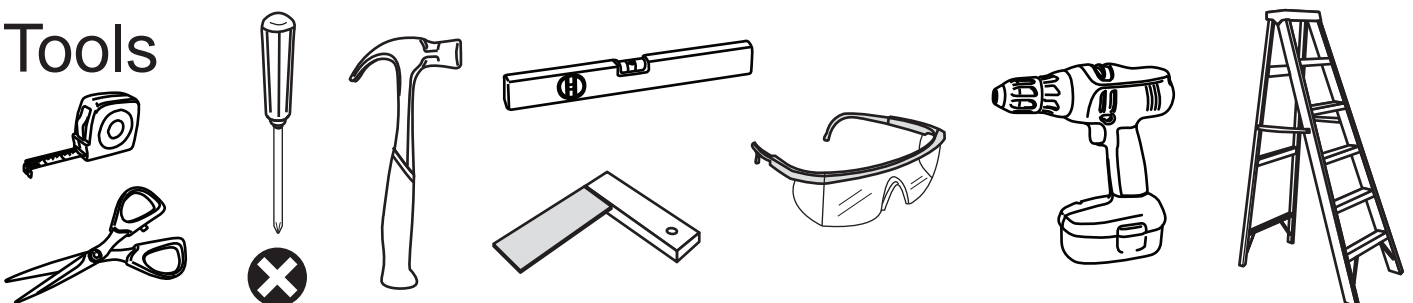

Cabinet Panels

Please remove protective film from any gloss panels

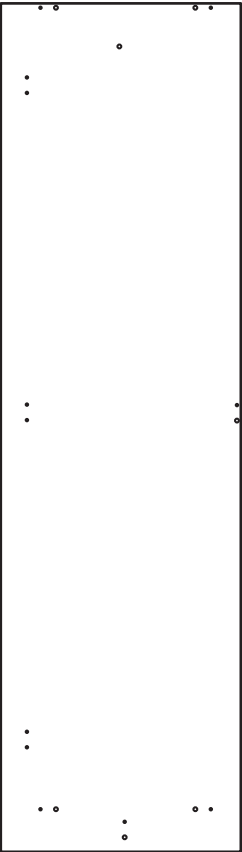

1

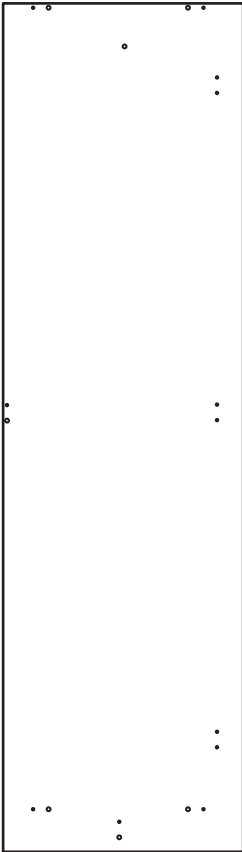
 175.3 x 49.6cm

2

 175.3 x 49.6cm

3

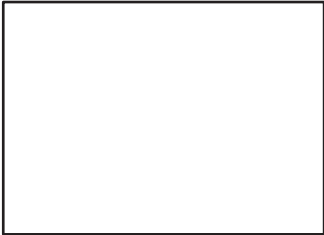
 66.3 x 49.4cm

4

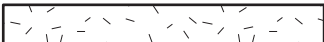
 66.3 x 47.6cm

5

 66.3 x 8.1cm

6

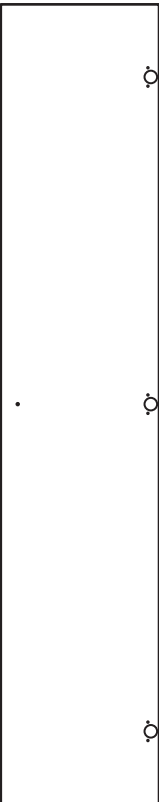
 66.3 x 8.1cm

7

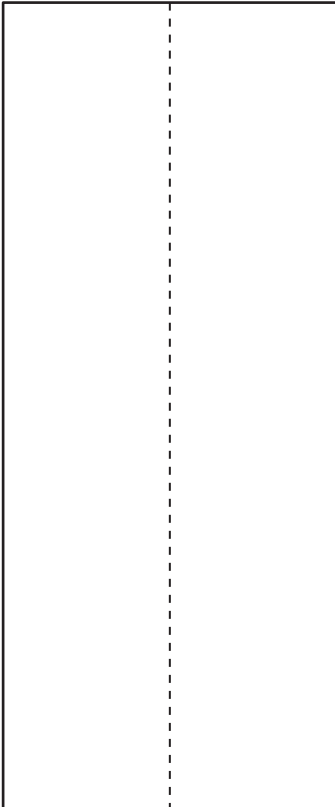
 165.2 x 32.7cm x 2

8

 166.6 x 68.9cm

Fittings

Use these drawings to
correctly identify the fittings

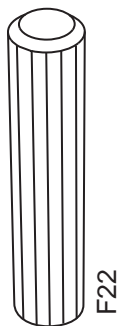

F22

A x 12

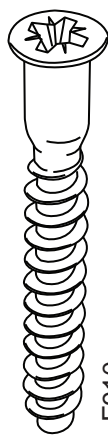

F910

B x 12

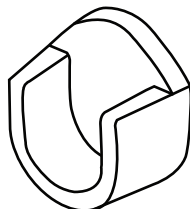

F1014

C x 2

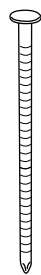

F51

D x 32

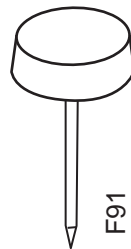

F91

E x 4



F63

F x 14

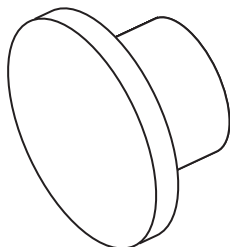

FSVMK3

G x 2

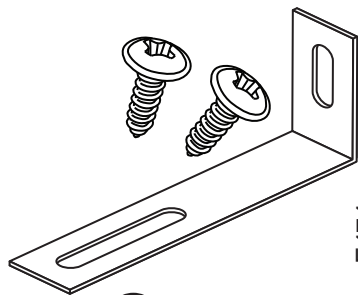

F474

H x 2

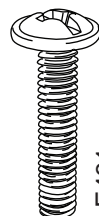

F461

I x 2

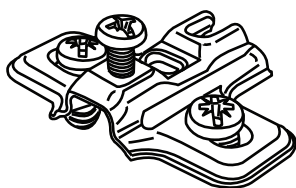

F648

J x 6

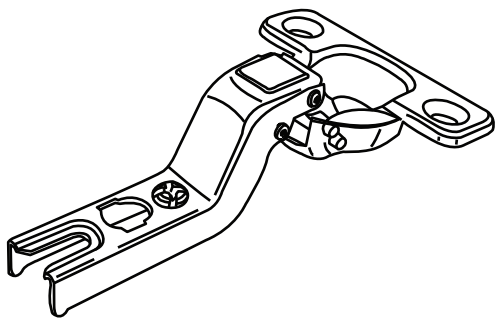

F647

K x 6

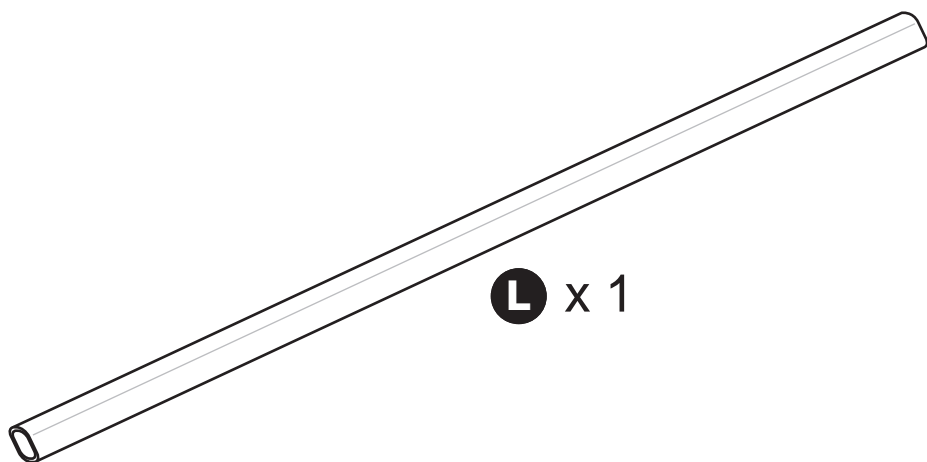

FHR655

L x 1

1

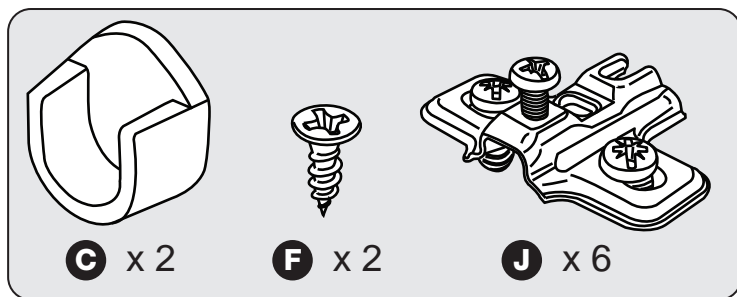

Hinge Fixing and Door Adjustment
www.youtube.com/watch?v=wIMhUHeLBtg

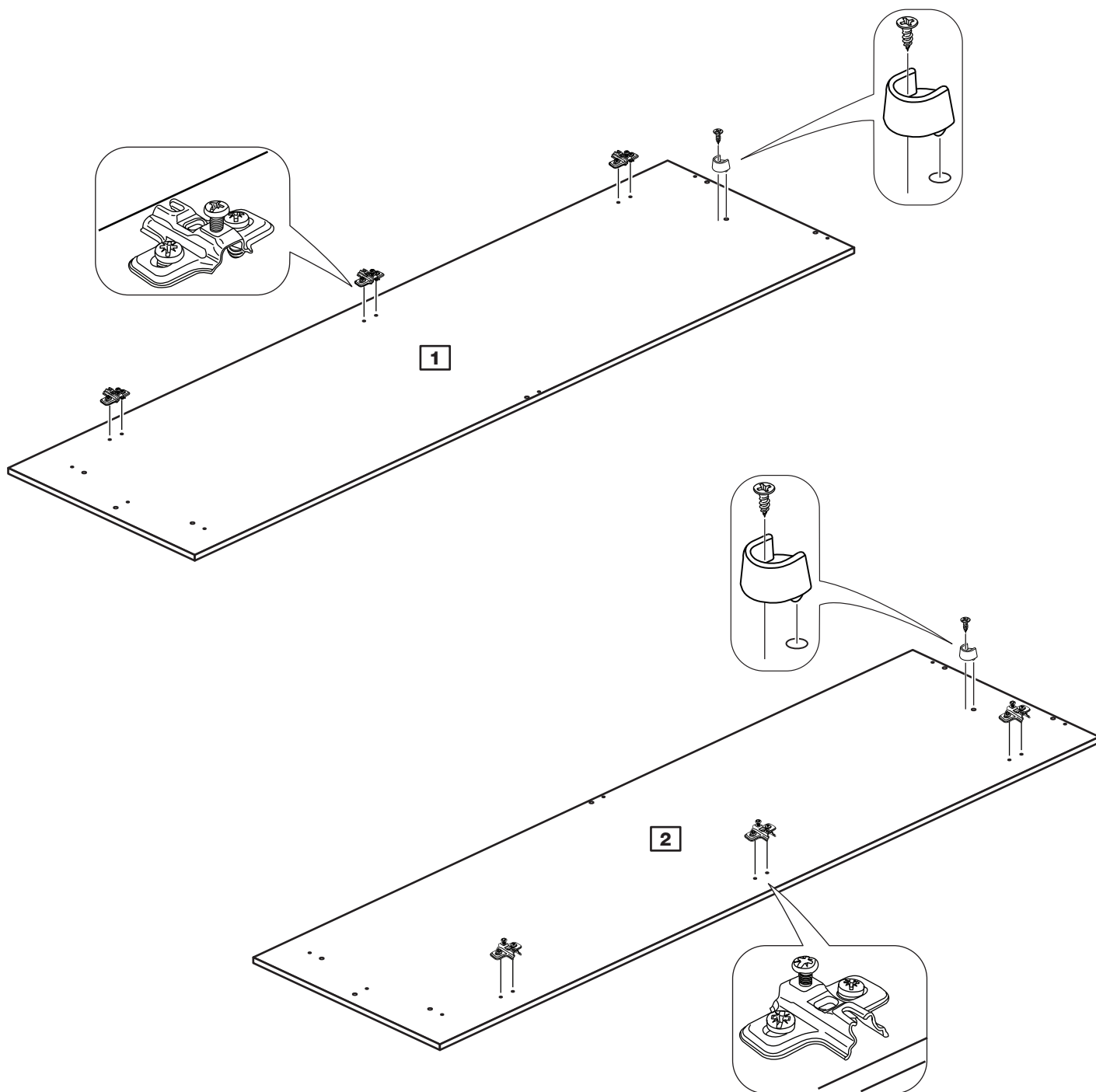

2

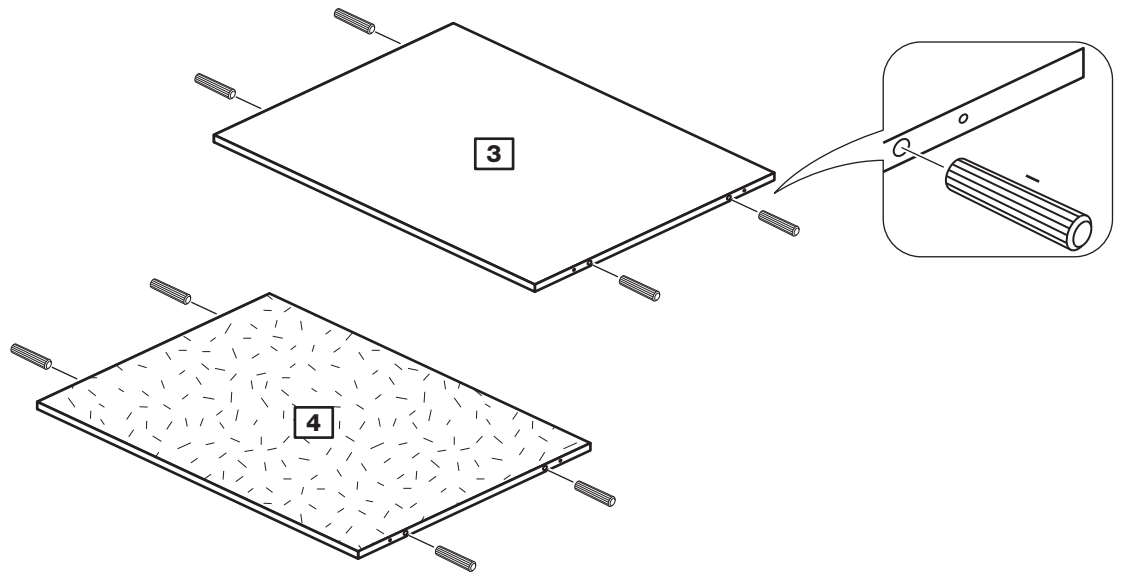
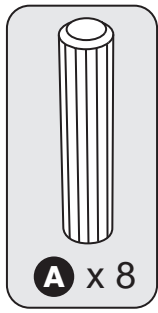

3

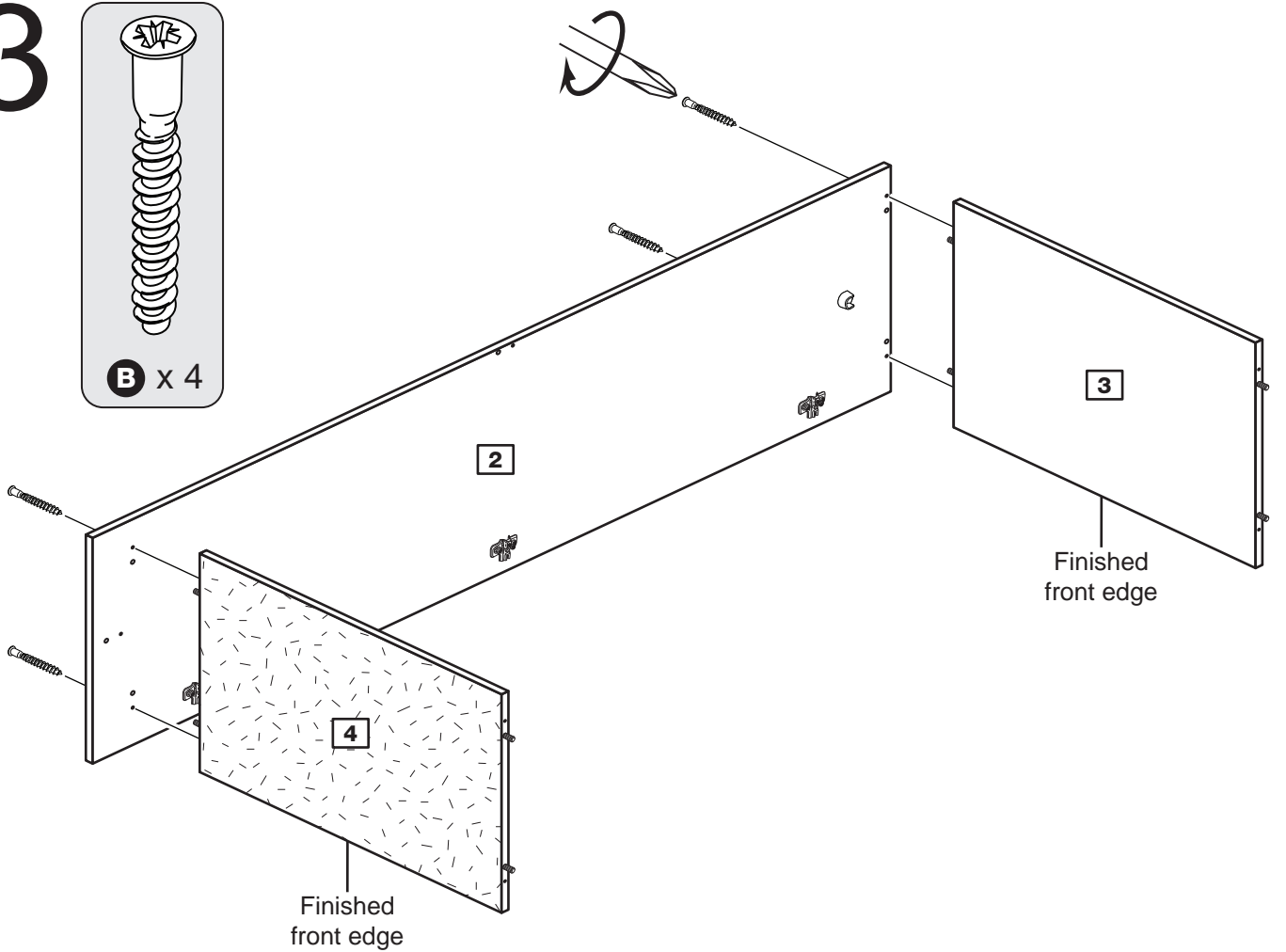
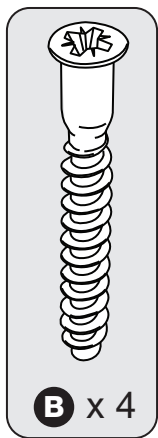

4

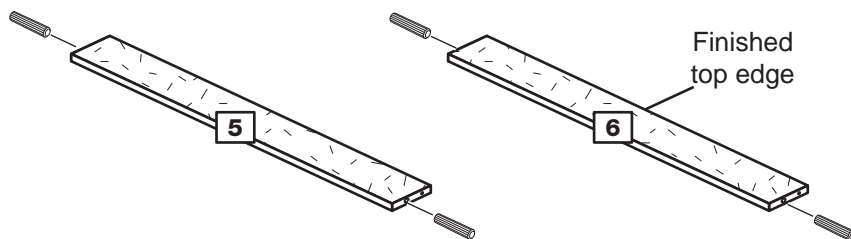
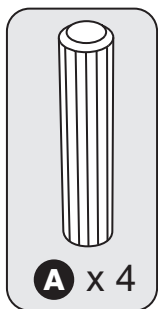

5

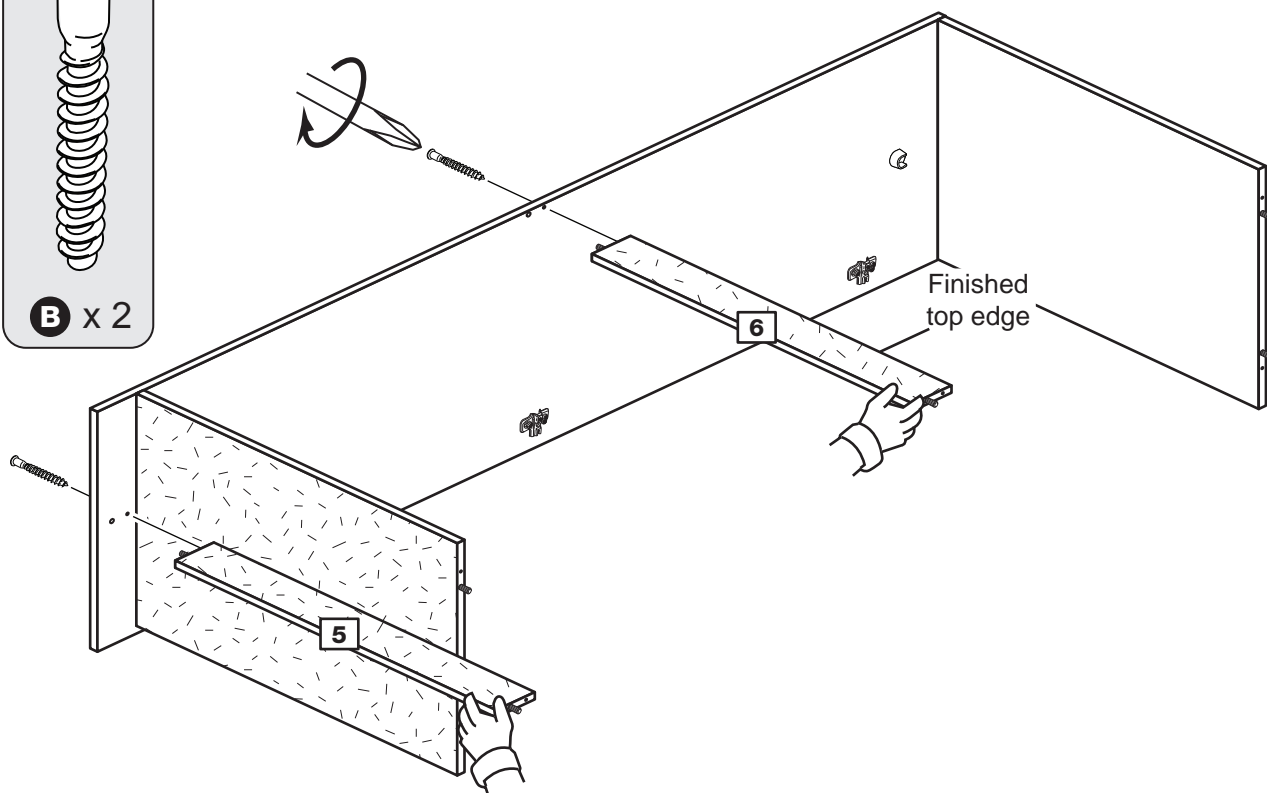
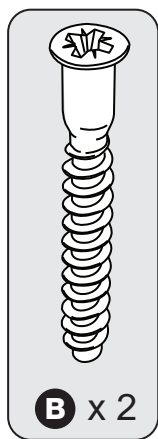

6

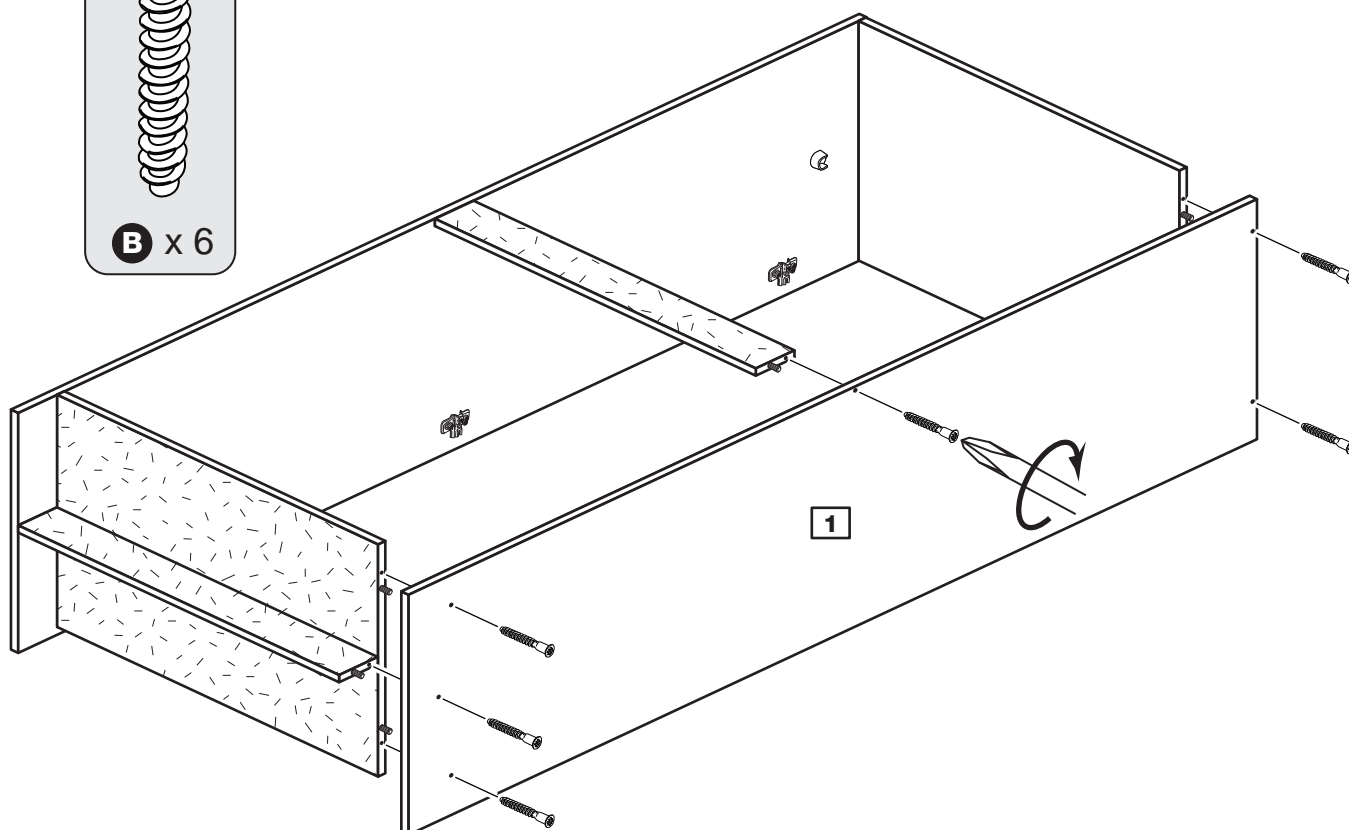
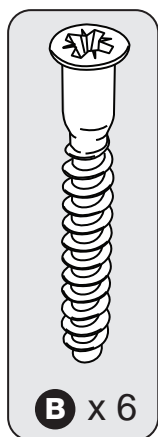

7



Squaring up a Robe and fitting the Back Panel
www.youtube.com/watch?v=udEKmXmPEW0

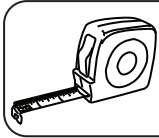

A = B

Make sure measurement
 A and B are the same
 before attaching part 8

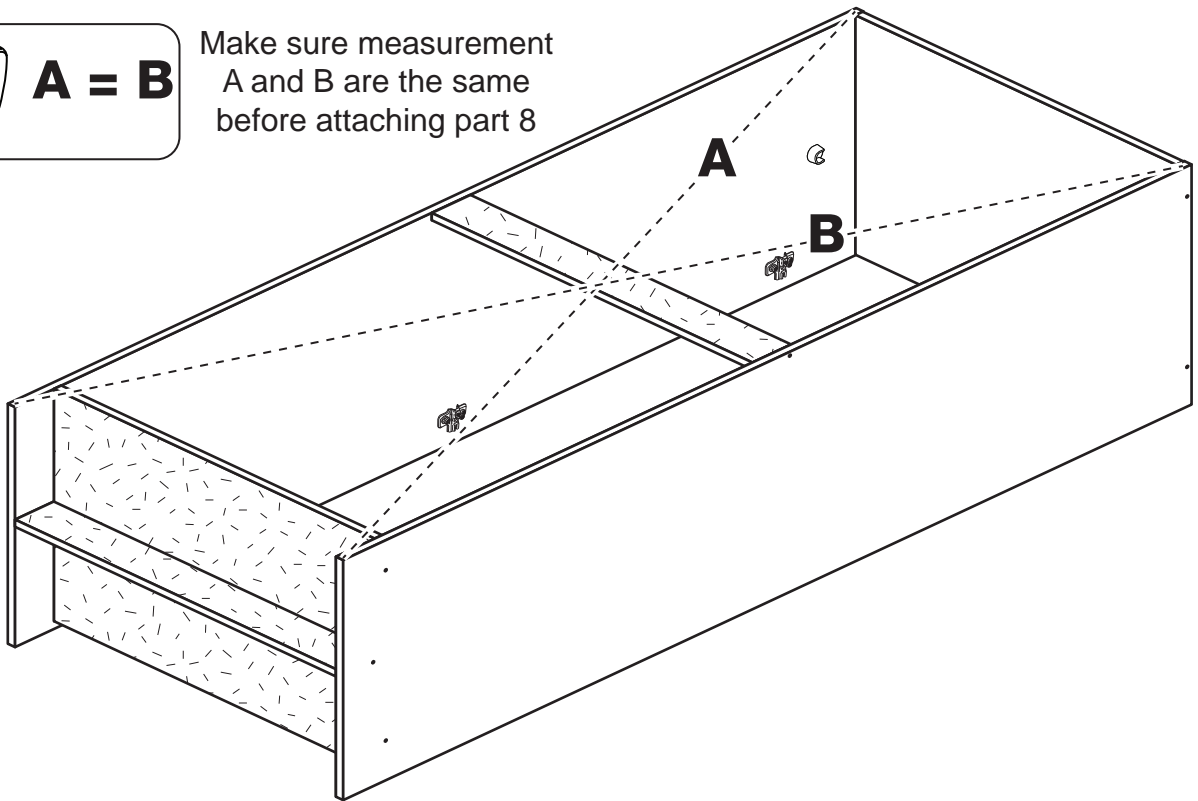

8

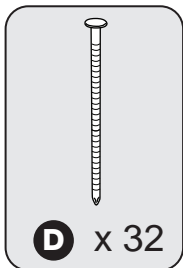

=

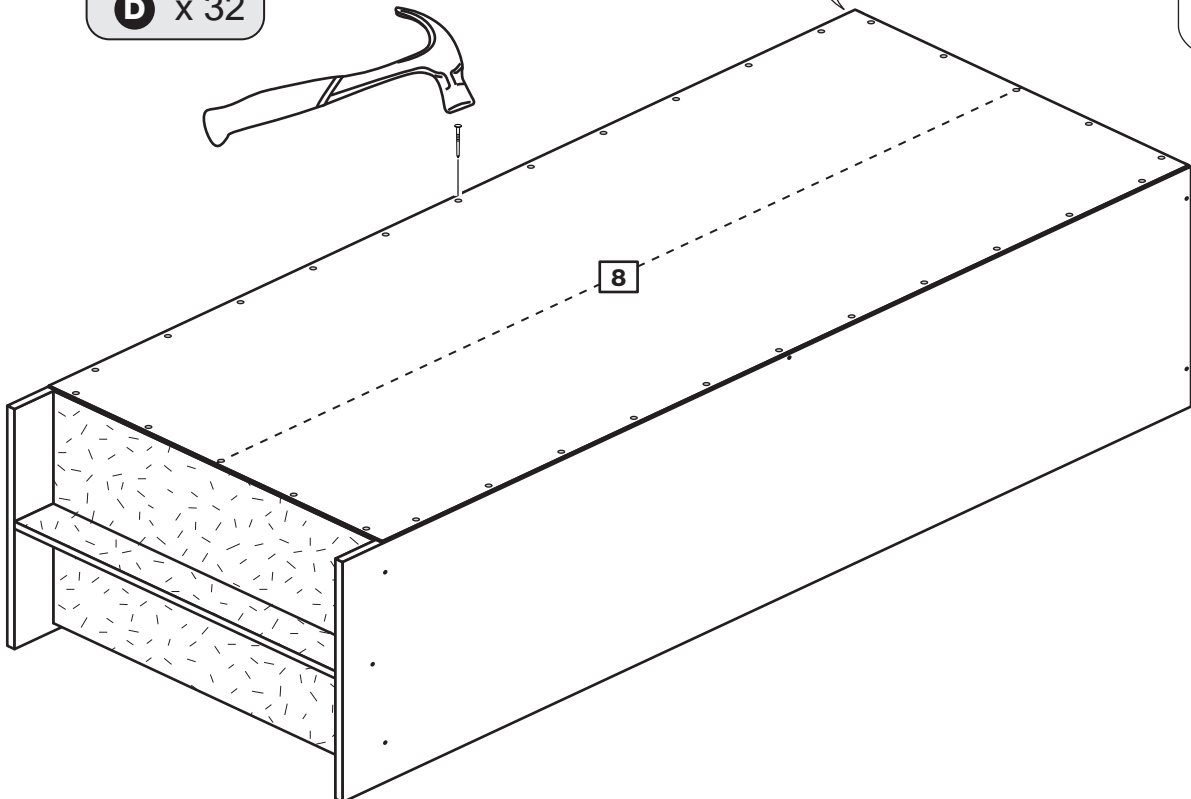
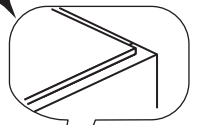

9

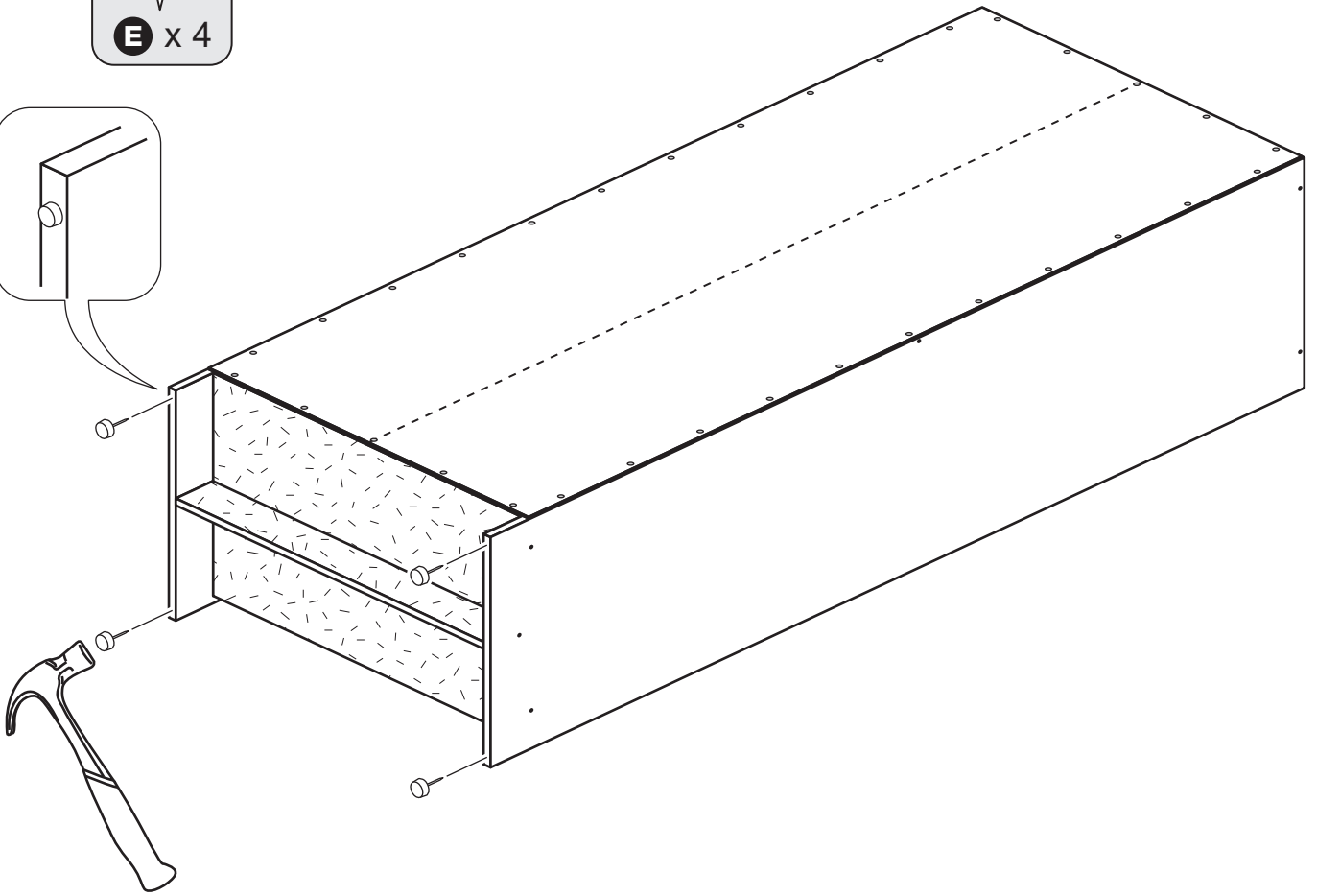
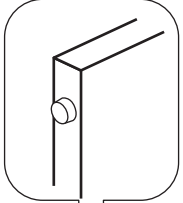
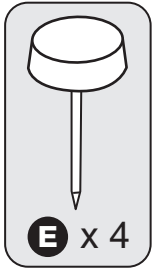

10

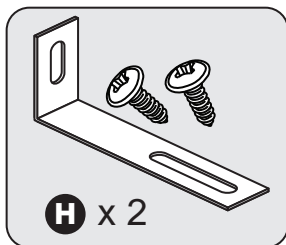

WARNING!

In order to prevent overturning this product must be used with the 2 wall attachment devices provided

See the next section for a guide to wall mounting and fixings

Carefully stand the unit up and push it up against the wall.

Loosely fit the 1st screw through the brackets into the top panel.

Slide the brackets against the wall and mark the slot at the back of the brackets for drilling into the wall.

Swivel the brackets away from the wall and drill the wall using a suitable drill-bit and fit your wall fixings (wall fixings are not supplied as they will need to suit the wall type).

Swivel the brackets back and fix them to the wall.

Fit the 2nd screw into top panel and tighten both screws from the kits.

Note: Take care when drilling the wall that you do not drill into any pipes, wires etc. If in doubt, consult an expert.

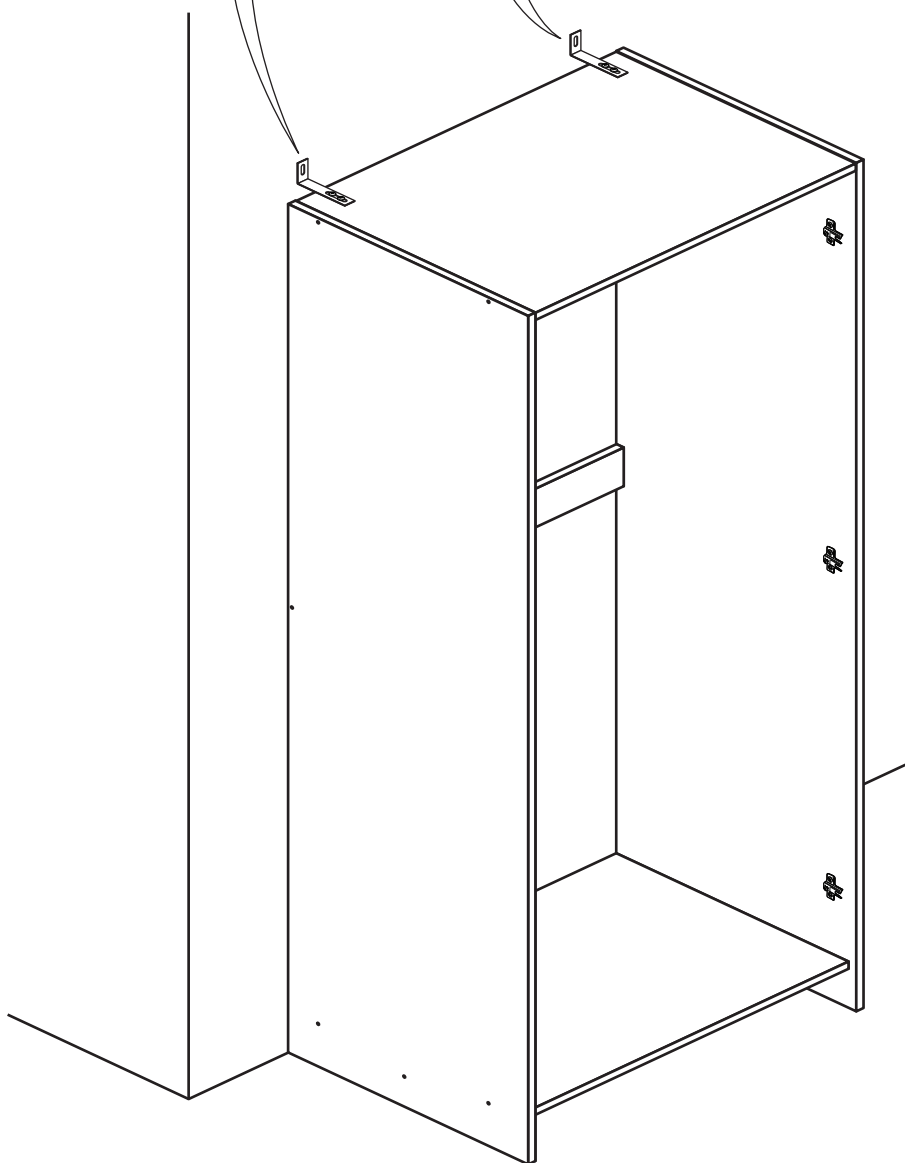
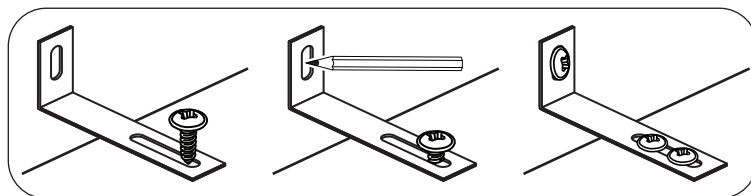

A Guide to Wall Mounting & Fixings

Important note:

If plastic wall plugs are supplied with your product:

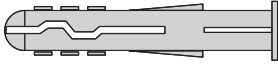

- these are only suitable for use in masonry walls.

If you are in any doubt about the correct wall plugs for your wall, seek professional advice.

Failure of the product due to using incorrect fixings is the responsibility of the installer.



Important: When drilling into walls always check that there are no hidden wires or pipes etc.

Make sure that the screws and wall plugs being used are suitable for supporting your unit. Consult a qualified tradesperson if you are unsure.

Hints:

- 1: General rule:  Always use a larger screw and wall plug if you are not sure.
- 2: Ensure you use the recommended drill bit to match the wall plug and hole size.
- 3: Ensure you drill the hole horizontally, do not force the drill or enlarge the hole.
- 4: Take extra care when drilling high walls, ceilings and ceramic tiles. Ensure wall plugs are inserted beyond the thickness of the ceramic tiles to avoid the tiles splitting or cracking.
- 5: Ensure wall plugs are well fitted and are a tight fit in the drilled hole.

Types of walls

You can use one of the following types of wall plug if your walls are made of brick, breeze block, concrete, stone or wood.

No.1 "General Purpose" wall plug

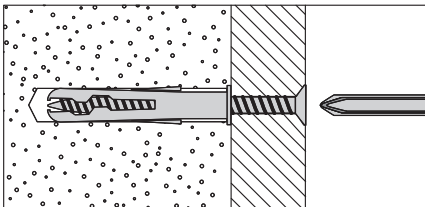

Generally aerated blocks should not be used to support heavy loads, use a specialist fitting in this case. For light loads, general purpose wall plugs can be used.

No.2 "Plasterboard" wall plug

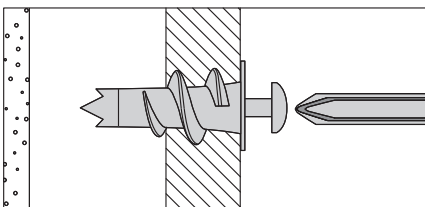

For use when attaching light loads on to plasterboard partitions.

No.3 "Cavity Fixing" wall plug

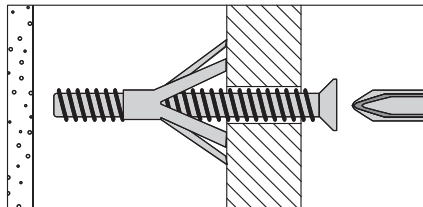

For use with plasterboard partitions or hollow wooden doors.

No.4 "Cavity Fixing-Heavy Duty" wall plug

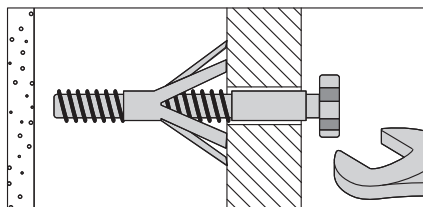

For use when fitting or supporting heavy loads such as shelving, wall cabinets and coat racks.

No.5 "Hammer Fixing" wall plug

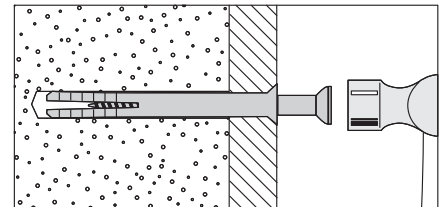

For use with walls stuck with plasterboard. The hammer fixing allows it to be fixed to the wall rather than the plasterboard. Always check the fixing is secure to the retaining wall.

No.6 "Shield Anchor" wall plug Heavy loads

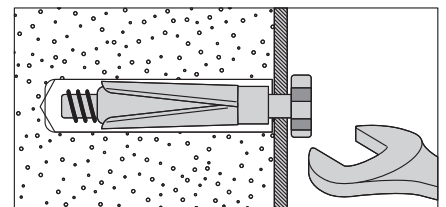

For use with heavier loads such as TV & HiFi speakers and satellite dishes etc.



Care & Maintenance

Safety: Always check the fitting and location to ensure your safety in and around the home.

Fitting: From time to time check the fitting to ensure the wall plugs or screws do not become loose.

11

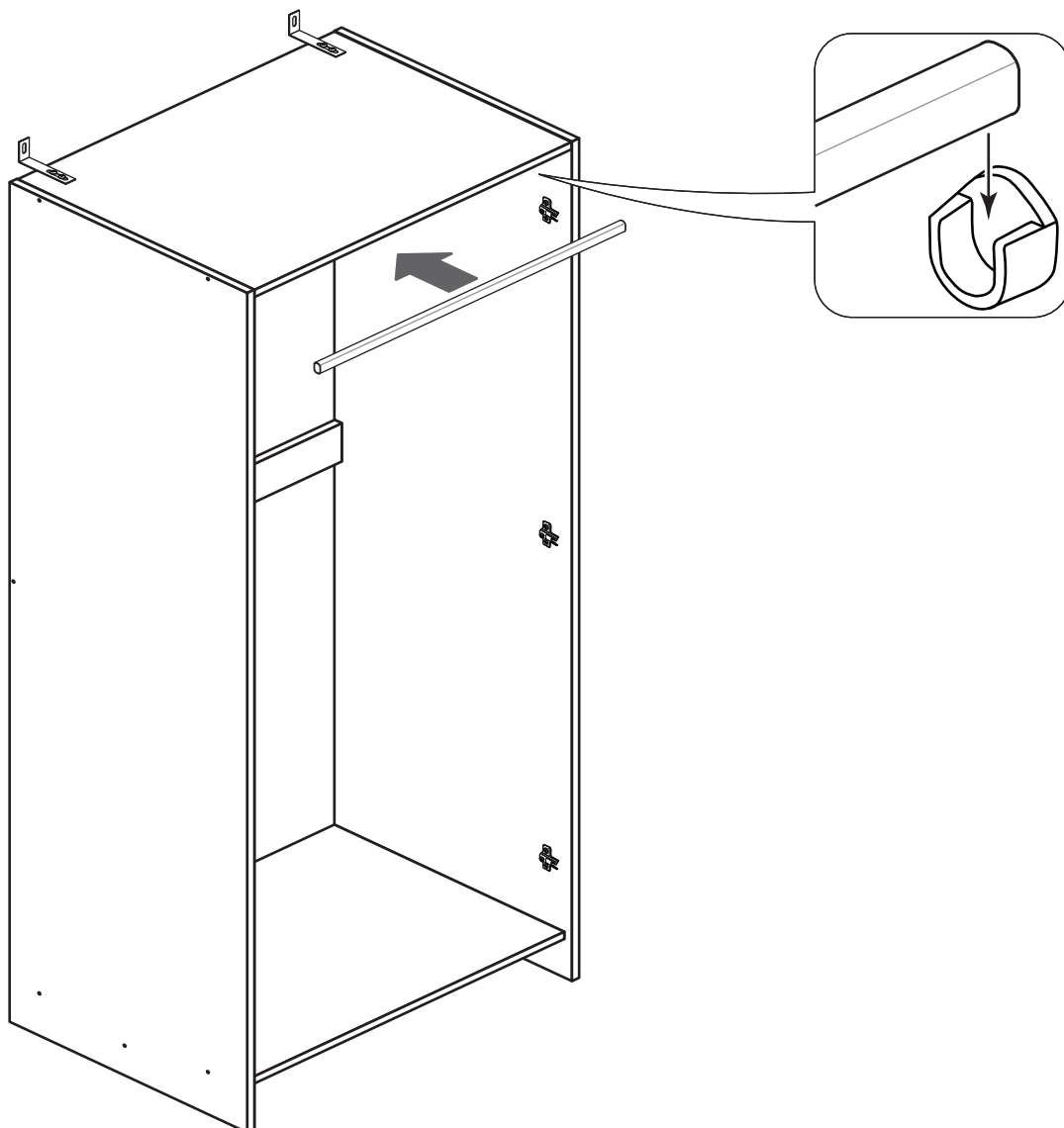
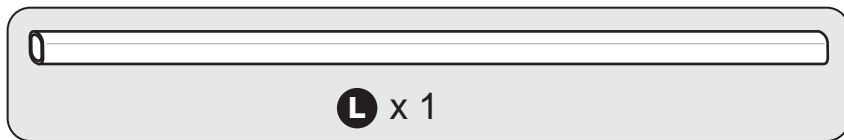

12

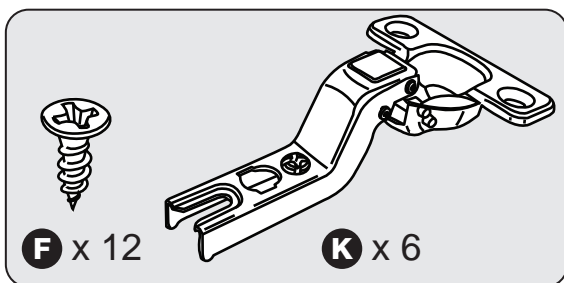

Hinge Fixing and Door Adjustment
www.youtube.com/watch?v=wIMhUHeLBtg

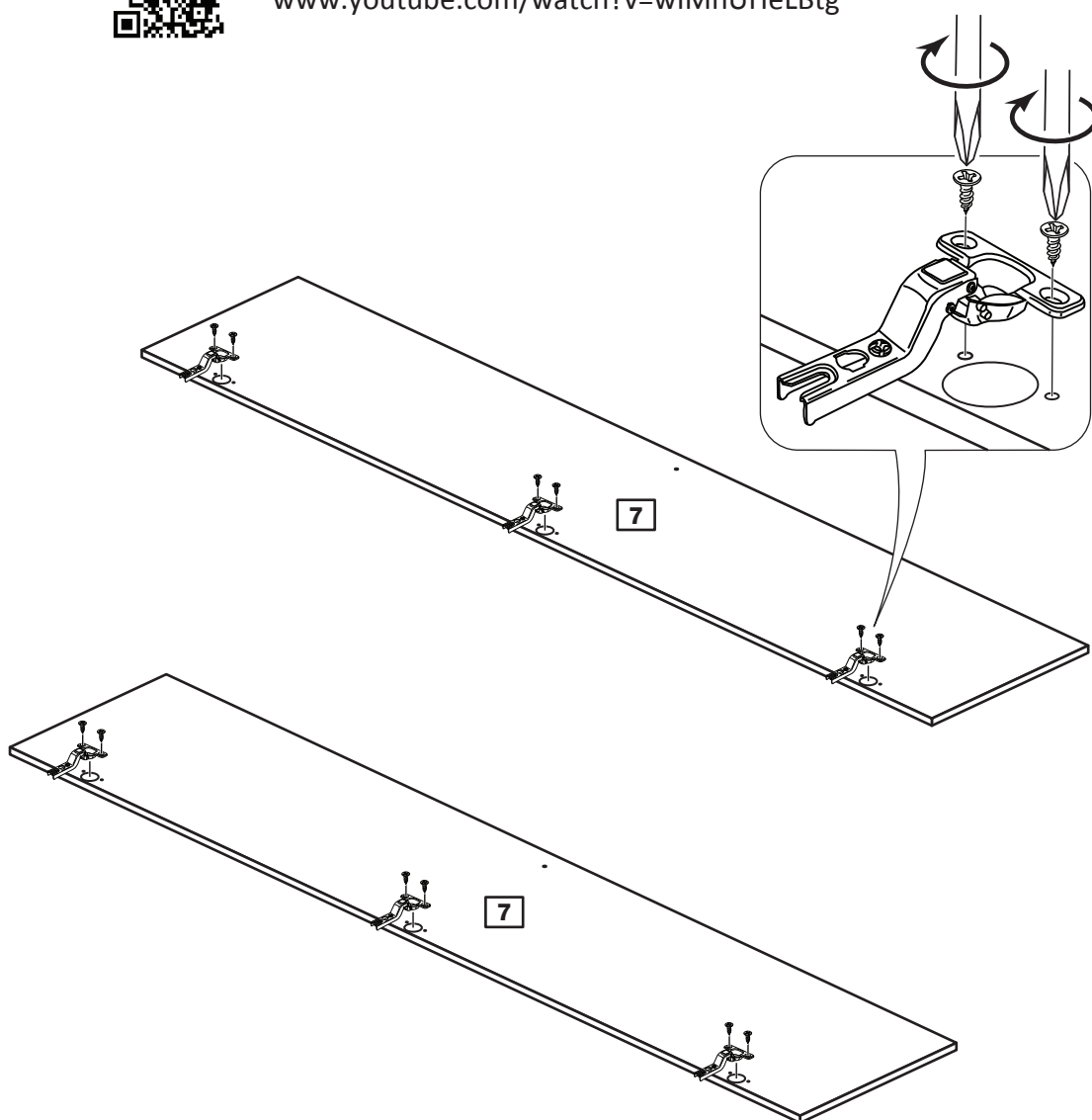

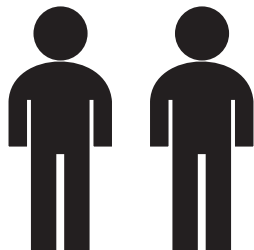

Use 2 people

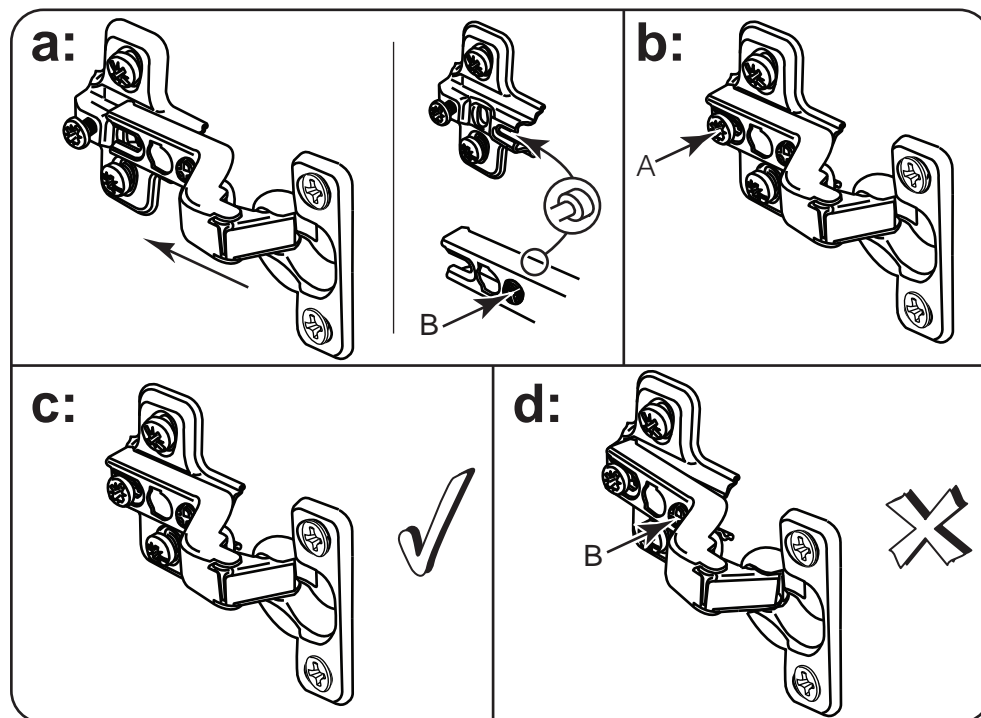

Fitting the Doors

Fit the top Hinge Arm 1st, then align and fit the other Hinge Arms.

a: The recess at the bottom of screw B on the Hinge Arm goes into the slot in the Hinge Plate.

b: Keep the Hinge Arm flat and slide it across the Hinge Plate as far as it will go, then tighten screw A.

c: The Hinge Arm must be flat against the Hinge Plate prior to any adjustment.

d: The Hinge Arm must not be at an angle to the Hinge Plate when assembled.
 This indicates that the recess at the bottom of screw B is not located in the slot in the Hinge Plate. Remove the Hinge Arm and re-assemble carefully following instructions a to c.

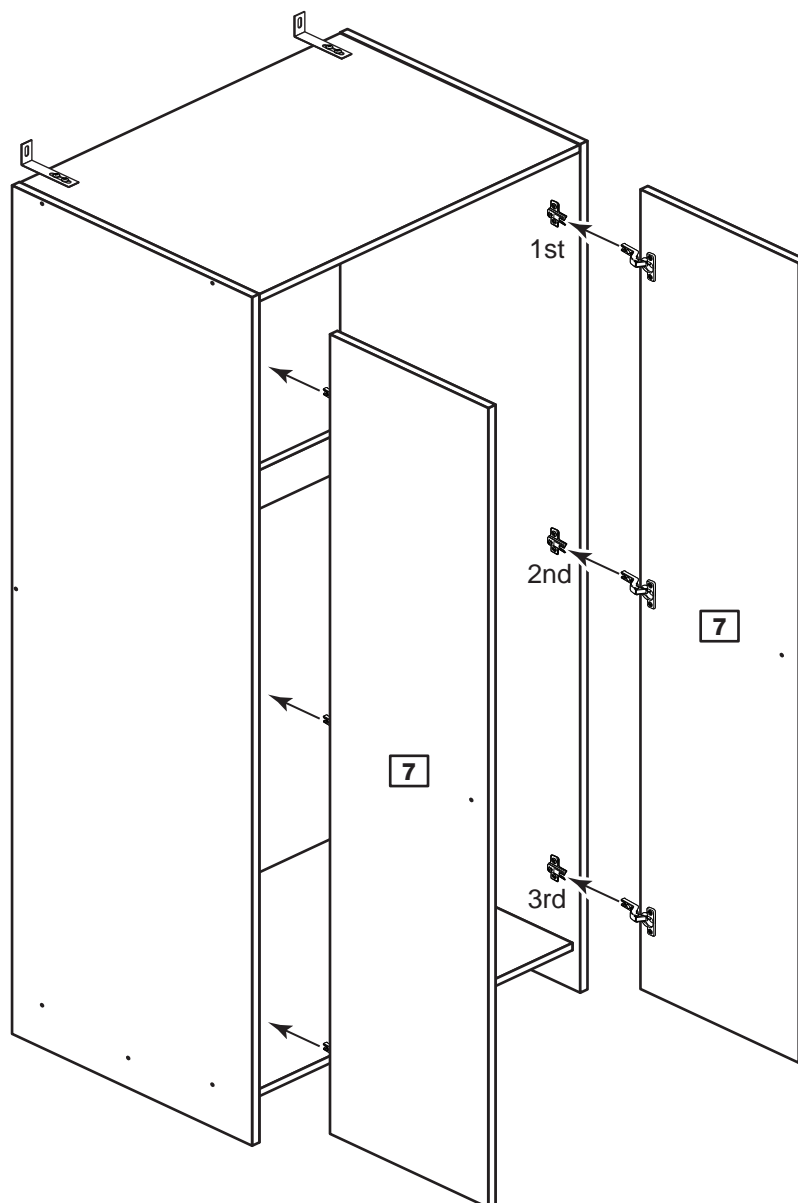

14

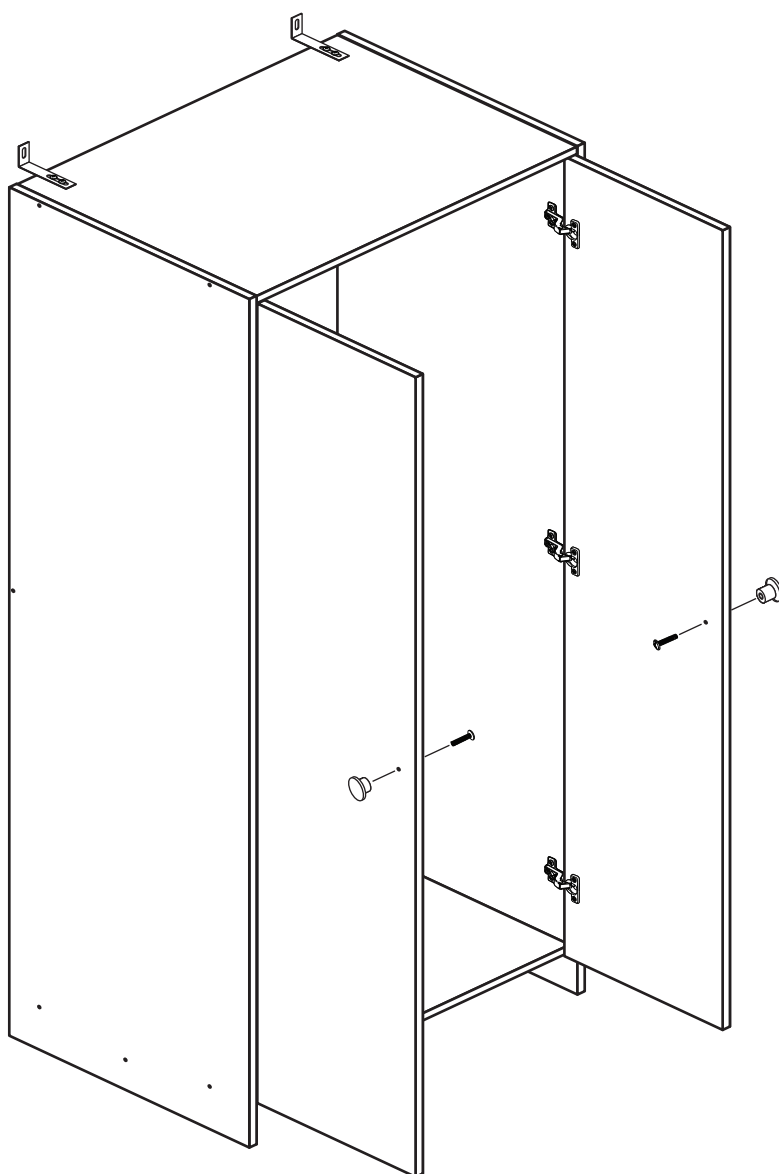
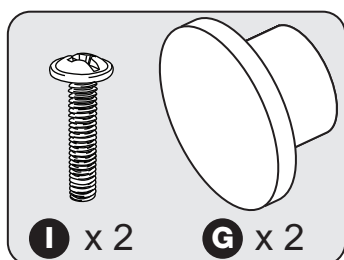



Adjust the Doors if required

a: Before adjusting the Doors, use a spirit level to check the Base (or Top) of the unit is level, front-to-back and side-to-side in the 3 positions shown.

Use suitable packing pieces (not supplied) to make the unit level BEFORE making any adjustment to the Hinges, as shown.

b: Height adjustment.

Loosen screws A on Hinge Plates and move Door up or down as required.

Retighten screw A.

C: Forward and Back adjustment.

Loosen screw B on Hinge Plate and move door in or out as required.

Retighten screw B.

d: Sideways adjustment.

To move door 'out' loosen screw C.

To move door 'in' tighten screw C.

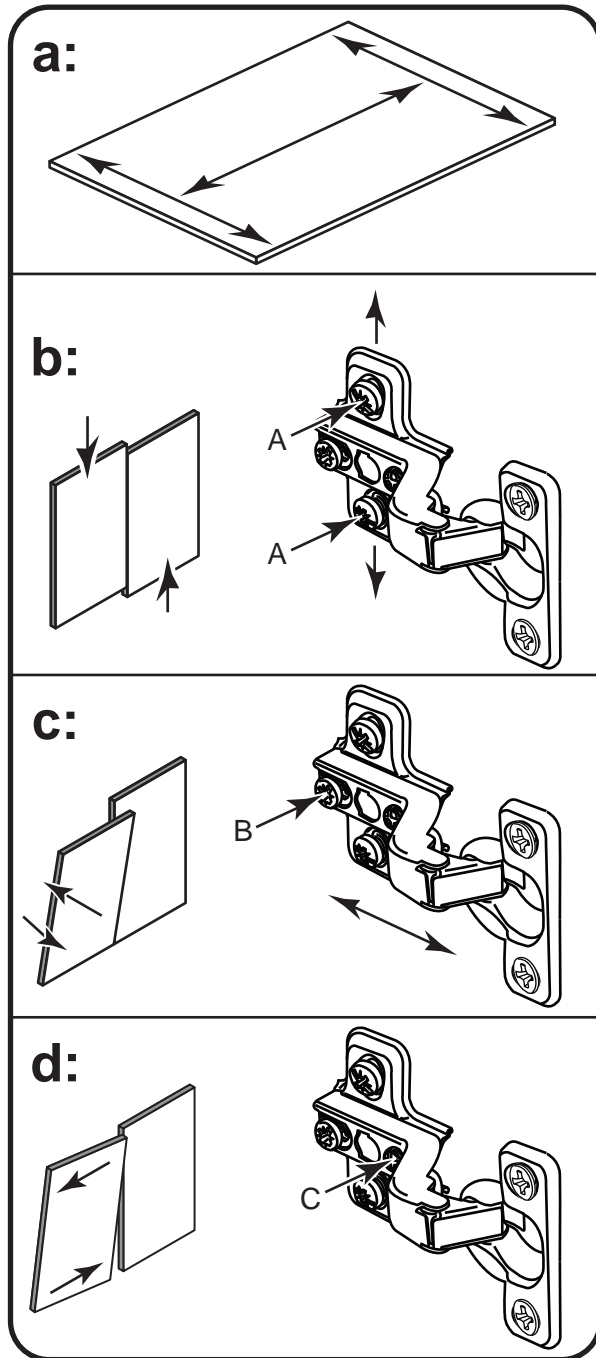

Assembly is complete

Please remove any blue protective film from panel edges
 and clear protective film from panel surfaces