

# zinc

3+

## THREE WHEELED FOLDING SCOOTER T-MOTION

### WARRANTY

SO THAT YOUR WARRANTY IS  
VALID PLEASE REGISTER AT  
**WWW.ZINCSPORTS.COM**  
WITHIN 30 DAYS OF  
RECEIVING THE PRODUCT.



### UNFOLDING THE SCOOTER

TO BE SUPERVISED BY AN ADULT.

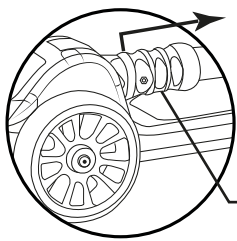

Pull the 'handlebar lock' to release.

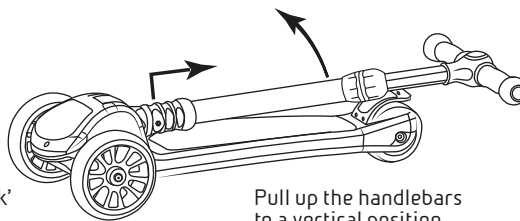

Pull up the handlebars to a vertical position.

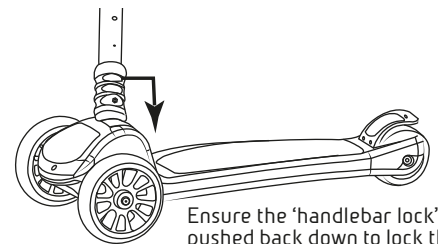

Ensure the 'handlebar lock' is pushed back down to lock the bars in position.

### FOLDING THE SCOOTER

TO BE SUPERVISED BY AN ADULT.

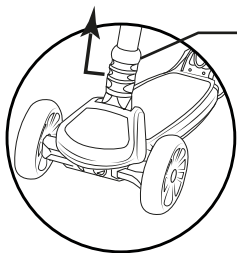

Pull up the 'handlebar lock' to release.

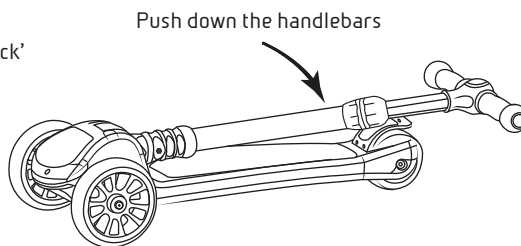

Push down the handlebars

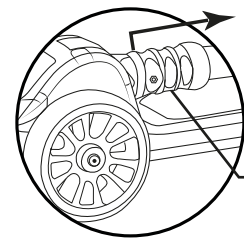

Ensure the 'handlebar lock' springs back to lock in position.

### ADJUSTING THE HANDLEBAR HEIGHT

TO BE SUPERVISED BY AN ADULT.

Loosen the handlebars stem adjuster & pull out handlebars...

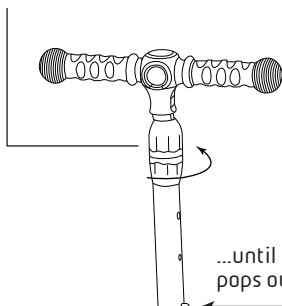

...until the button pops out.

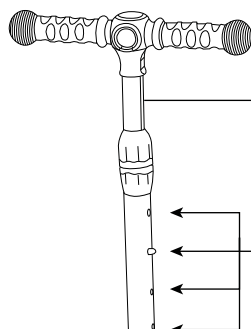

Push in the button and pull the handlebars up and down until it is the correct height for your child.

There are four height options: 72cm, 75.5cm, 79cm, 83cm.

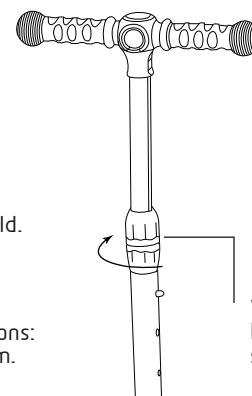

When at the desired height, screw tight the stem adjuster.

## STEERING THE SCOOTER

TO BE SUPERVISED BY AN ADULT.

The T-Motion is a 'Lean and Steer' Scooter.  
So instead of turning the handlebars, you lean them to the left or right.

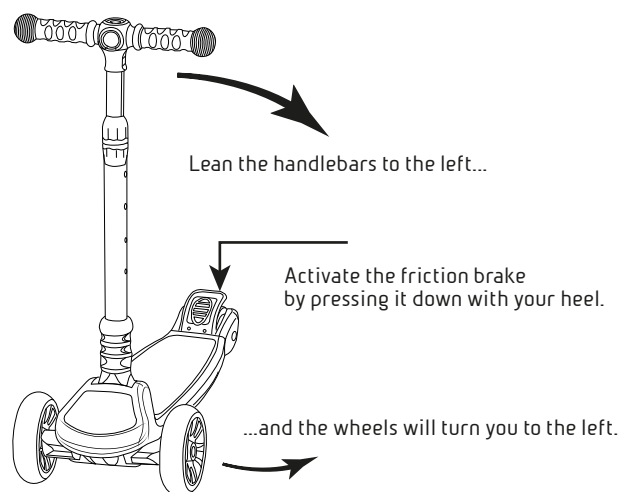
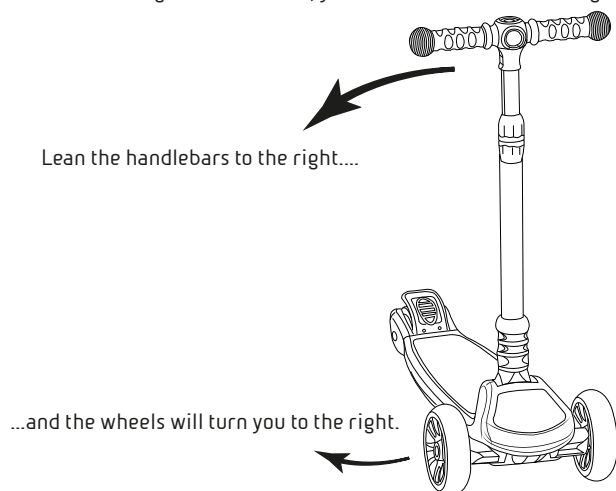

## TO USE

TO BE SUPERVISED BY AN ADULT.

1. Grip the handlebars with your hands, place one foot on the deck and the other foot on the ground.
2. Pay attention to your surroundings and make sure that your riding area is clear.
3. Kick backwards with your foot beside the scooter to give you motion.
4. Repeat this kicking action in order to stay in motion.
5. To stop or slow down, place your kicking foot on the brake pedal above the rear wheel to slow down, then put your kicking foot on the ground.
6. Do not over-steer as this could cause you to fall off the scooter.

## IMPORTANT SAFETY INFORMATION

1. The product is recommended for users of 3 years and up.
2. After checking that all parts are in good condition, remember to check that all the screws and wheels are tightly in place before using the scooter. (Hex keys are supplied to tighten these if necessary)
3. Remember to wear a helmet, knee pads, wrist pads, elbow pads, protective clothing and proper shoes.
4. The maximum weight that this product can hold is 80kg.
5. The scooter must only be used by one rider at a time.
6. Do not use this product for jumping stunts or tricks. The scooter is not designed for such use.
7. This product is not a road vehicle and should be used for leisure purposes only.
8. Do not use this product at night, poor weather (rain, snow or poor visibility) or around heavily populated areas (pavements, streets, muddy areas, rocky surfaces and slippery surfaces). We recommend that you use this product in a park or other open space.
9. Do not take this product apart.
10. The brake will get hot from continuous use. Do not touch after braking.
11. Do not take this scooter on the road or public highway.
12. Check the limitation of use according to regulations of road safety.

## WARNING!

Warning! Not suitable for children under 36 months, due to small parts. This scooter must be assembled by an adult.

The scooter is not designed to be dropped when not in use. If the scooter is dropped after use, over a period of time you will damage the handgrip and the aluminium tubing. If you damage this part of the scooter, it is strongly advised that you replace the damaged parts as soon as possible to avoid any accident caused by making contact with these parts.

The scooter should not be used on any other surface other than on flat even ground. It is not designed for graveled roads, on grass surfaces or any other uneven surfaces as this could cause not only damage to scooter but also the rider.

Warning: Protective equipment should be worn. Not to be used in traffic. 80kg max. The scooter shall be used with caution, since it requires great skill, so as to avoid falls or collisions causing injury to the user and the third parties.

Adult supervision is recommended

CAUTION! PLEASE REGULARLY CHECK THAT ALL FIXINGS INCLUDING WHEELS ARE TIGHTENED DURING USE.

- ! - Never ride the scooter without tightening the scooter.
- - Check all clamping devices for tightness and foot brake prior to riding.

## MAINTENANCE

1. After use, please wipe the product with mild detergent.
2. Do not leave this product in high temperature, intense sunlight or dusty areas.
3. Store in a dry place.
4. Always make sure all screws and nuts are securely tightened before every use.
5. No modification other than to the manufacturer's instructions shall be made.
6. Please rotate the bearings and wheels to check if they are rolling smoothly.
7. It is suggested to clean and add lubricant every 6 months paying extra attention to the moving parts, clearing them of grit and dirt so they move freely.
8. Self-locking nuts and other self-locking fixing may lose their effectiveness over time. If any of these components are no longer functioning how they should, it is strongly recommended that you discontinue use of the product and seek replacement parts from the dealer or importer of this product.

## WARRANTY

### ZINC SPORTS NON-ELECTRIC SCOOTER WARRANTY POLICY

Thank you for purchasing a Zinc Scooter and we hope that you enjoy using it. Please ensure that you read the following warranty.

In order for your warranty to be valid you must satisfy the following conditions:

- All products must be registered at [www.zincsports.com](http://www.zincsports.com) within 30 days of receiving the product for the warranty to be valid.
- Proof of purchase is also required for your warranty to be valid.
- You must be the original purchaser who bought the product from an authorised dealer, your warranty cannot be transferred.
- You must report any defects to Zinc Sports within 30 days of discovery of said defect else the warranty will not be valid.

Failure to follow the conditions highlighted above means that your warranty will be void. We recommend that you save your original sales receipt.

The warranty lasts **1 year** from the date of purchase.

The warranty covers any manufacturing defects in materials or workmanship when used under normal use conditions and in compliance with the stipulations in the instruction manual and warranty guidelines.

The warranty does not cover wear, and tear or parts deemed to be wearing parts such as but not limited to bearings, brakes, wheels, grip tape or folding mechanisms. The warranty does not cover cosmetic parts, or parts deemed as cosmetic parts such as but not limited to paint, stickers and labels. The warranty does not cover loss of parts. Spare parts may be available for purchase from Zinc Sports if you are not covered by the warranty.

Under no circumstance will Zinc Sports be obliged to provide compensation for bodily injuries, death, property damages, losses, hindrance of profits, prevention of use or any other damage that will be caused directly or indirectly as a result of usage of this device. Zinc Sports advise that you contact your insurance company to determine whether coverage is provided for the use of this scooter, or to take out a new policy.

For the full warranty policy please visit our website at [zincsports.com](http://zincsports.com)

Product code: **ZC05964 - THREE WHEELED FOLDING T-MOTION - BLACK**  
**ZC07947 - THREE WHEELED FOLDING T-MOTION - BLUSH PINK**  
**ZC07948 - THREE WHEELED FOLDING T-MOTION - POWDER BLUE**

## CUSTOMER HELPLINE

Hy-Pro advise you to contact us directly and not to return this item to the place of purchase. Hy-Pro has taken great care to ensure this item has reached you in good condition, should you have a query please ring our helpline +44 (0)800 731 0006 where your call will be dealt with promptly. Alternatively, please contact us on email: [customerservices@zinchq.com](mailto:customerservices@zinchq.com)

REMOVE ALL THE PACKAGING AND ASSEMBLE BEFORE GIVING TO A CHILD.

- Complies with BS EN14619:2019 / EN14619:2019. Maximum weight 80kg for Class A
- KEEP THE INSTRUCTION SINCE IT CONTAINS IMPORTANT INFORMATION
- COLOUR & CONTENTS MAY VARY FROM THOSE SHOWN ON PACKAGING



[www.hy-pro.co.uk](http://www.hy-pro.co.uk) [www.zincsports.com](http://www.zincsports.com)

**HY-PRO®**  
LU5 5BN, UK

Hy-Pro House, Centrus Park, Arenson Way,  
Dunstable, Bedfordshire LU5 5BN. UK

Hy-Pro Europe, Cube Building  
Monahan Road, Cork  
T12H1XY, Republic of Ireland

Hy-Pro Asia  
Room 1011, 10/F, Peninsula Centre,  
67 Mody Road, Kowloon, Hong Kong

**Need Help?** Visit our website for replacement parts and product support [WWW.ZINCSPORTS.COM](http://WWW.ZINCSPORTS.COM)  
Contact us at [customerservices@zinchq.com](mailto:customerservices@zinchq.com) OR CALL OUR CUSTOMER SERVICE LINE ON +44(0) 800 731 0006