

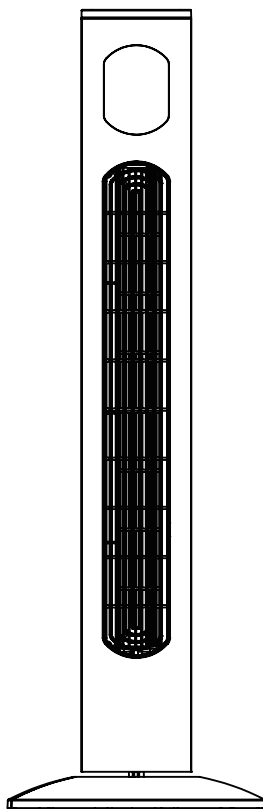

Digital Tower Fan 38-Inch
INSTRUCTION MANUAL
Model No. LG38-02AR



Read all instructions before using this appliance. Carefully retain these instructions for future reference.

Thank you for choosing a **Challenge** fan. It is a remarkably versatile product which offers a choice of air-circulation for summer comfort. This fan has been designed and manufactured to high standards of engineering and with proper use and care, as described in this leaflet, this appliance will give you years of useful service.

Please read these instructions carefully.

GENERAL CARE AND SAFETY GUIDE

- Use only the voltage specified on the rating plate of the fan.
- Do not cover or restrict airflow to the inlet or exhaust grilles in any manner as the appliance may overheat and become a fire risk.
- NEVER cover the fan : this may cause a fire.
- Do not block air inlets or outlets in any manner. Check the openings from time to time for accumulated dust.
- Ensure long shag carpet does not obstruct airflow under the unit.
- Do not place the appliance close to a radiant heat source.
- Do not operate in areas where gasoline, paint or other flammable liquids are used or stored.
- Do not insert or allow foreign objects to enter any ventilation or exhaust opening, as this may cause an electric shock, fire or damage to the appliance.
- Do not operate any appliance with a damaged cord, plug or after the appliance malfunctions or has been dropped or damaged in any manner. Return to a qualified electrical person for examination, electrical or mechanical adjustment, service or repair.
- This appliance is intended for household use only and not for commercial or industrial use.
- Use this appliance only as described in this manual.
Other uses not recommended may cause fire, electric shock or personal injury.
- Do not use abrasive cleaning products on this appliance. Clean with a damp cloth (not wet) rinsed in hot soapy water only. Always remove the plug from the mains supply before cleaning.
- Do not connect the appliance to the mains voltage until completely assembled and adjusted.
- Switch off and use handles where provided when moving.
- Always set and operate the appliance on a dry, level, smooth and sturdy surface.

- Do not remove the plug from power socket until the appliance has been switched off.
- Do not remove the plug from power socket by pulling flex - always grip plug.
- Always unplug the appliance when not in use.
- Do not allow the cord to come in contact with heated surfaces during operation.
- Do not run the cord under carpeting, throw rugs or runners etc. Arrange cord away from traffic areas so that it will not be tripped over.
- Do not twist, kink or wrap the cord around the appliance, as this may cause the insulation to weaken and split.
- Always ensure that all cord has been removed from any cord storage area.
- Always keep the fan out of the reach of children.
- Children should be supervised to ensure they do not play with the appliance.
- Do not use this appliance in the immediate surrounds of a bath, a shower or a swimming pool or other liquids.
- Do not use this appliance outdoors, or on wet surfaces. Avoid spilling liquid on the appliance.
- Always switch off the fan at the controls and at the power outlet then unplug fan from the power outlet when not in use.
- Important-This fan is intended for floor or desk use only. Do not mount on ceiling or walls.
- If the supply cord is damaged, it must be replaced by the manufacturer, its service agent or a similarly qualified person in order to avoid a hazard.
- Do not operate the fan with wet hands.
- Do not operate the fan near to curtains or any other fabric which could be sucked into the fan unit.
- Ensure that the fan is switched off from the supply mains before removing the guard.
- The appliance is not intended for use by persons (including children) with reduced physical, sensory or mental capabilities, or lack of experience and knowledge, unless they have been given supervision or instruction concerning use of the appliance by a person responsible for their safety.

- This appliance can be used by children aged from 8 years and above and persons with reduced physical, sensory or mental capabilities or lack of experience and knowledge if they have been given supervision or instruction concerning use of the appliance in a safe way and understand the hazards involved.
- Children shall not play with the appliance.
- Cleaning and user maintenance shall not be made by children without supervision.
- Trip Hazard. Beware of trailing cables when in use and while in storage.
- Strangulation Hazard. Children have STRANGLED in cords. Keep power cords out of reach of children. Never leave a cord positioned where a child could reach it.
- To protect against electrical shock, do not immerse the appliance, the plug or the cord in water or spray with liquid.
- It is not advisable to expose people (especially babies and elderly) to a continuous cold air stream for a long time.
- DO NOT use the fan in a very hot to humid environment, such as bathroom.
- DO NOT operate the fan by the windows. Raining may cause an electric hazard.

PARTS

- 1.Body
- 2.Front base
- 3.Rear base
- 4.Plastic screw nut
- 5.Power cord
- 6.Remote control

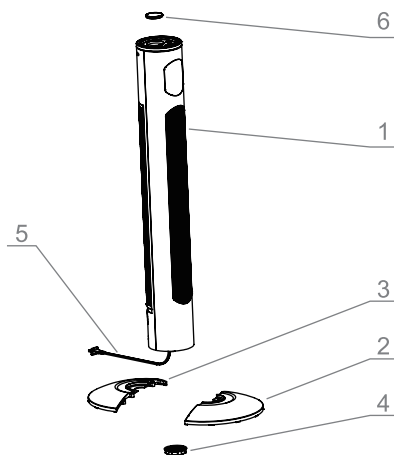

INSTRUCTIONS FOR ASSEMBLY

The products divided into two parts, Main body and base for Transportation

1. Unscrew the plastic screw nut from the base of main body.

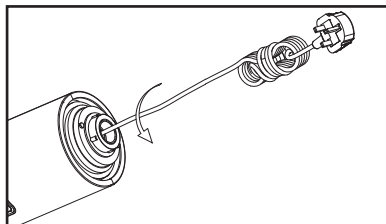

2. Position the base parts to the bottom of the main body, to insert the guide pins on the base part to the other one. Make sure they combine into one base plate

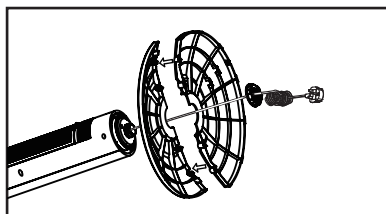

3. Align the hole on the base plate to the guide pin on the bottom of main body. Then place the base plate onto the bottom part of main body.

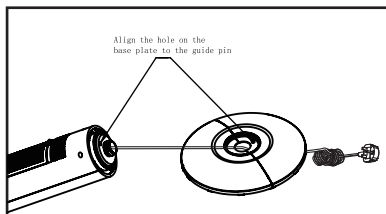

4. Secure the base plate to the main body by turning the plastic screw nut in clockwise.

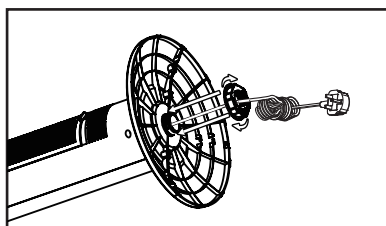

5. Check the screw nut has been locked securely and arrange the cord as illustrated. Then you can turn the fan in upright position and start to use.

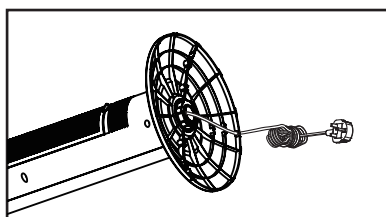

Tips for assembly of the base

- 1. Align the hole on the plates
- 2. Move the Plates together and gap is found.
- 3. Press the buckle on the base to the plate together.
- 4. Then no gap should be found between two plates.

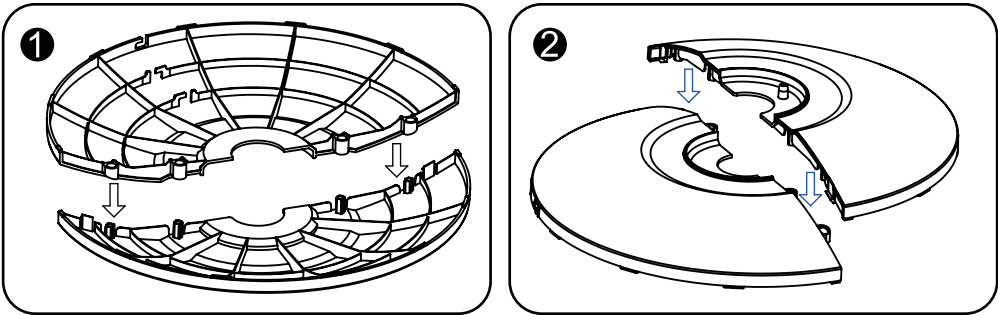

Operating Instructions

- 1. Set the appliance on a dry, Level, smooth and sturdy surface.
- 2. Plug the appliance into the mains.

Tower Fan Operation Instructions:

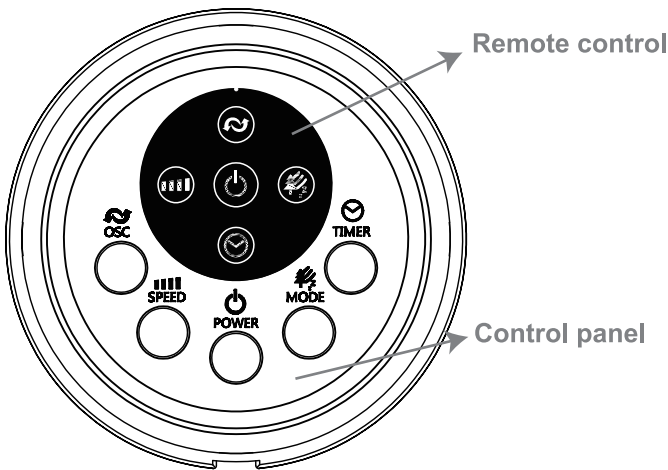

Symbol	Description
	Oscillation
	Speed selection
	Power/Stand-by
	Wind mode selection
	Timer

SPEED SELECTION

To turn on the fan, press "Power"  button (on the remote control or on the control panel). It will start at low speed fan setting. To select the fan speed, continue to press "SPEED" button to desired speed setting (L, M or H) - L=slow speed, M=medium speed & H=high speed.

To turn it off, press "Power"  button once again (on the remote control or on the control panel). It will stop immediately.

OSCILLATION



To have oscillation, press "OSC"  button (on the remote control or on the control panel). It will start oscillation.

To stop oscillation, press "OSC"  button once again (on the remote control or on the control panel). It will stop oscillation.

TIMER

The timer can be set up to 12 hours. Continue to press "TIMER" until the timer indicators (01h / 02h / 03h to a maximum of 12 hours) illuminate to your desired time (Press on the remote control or on the control panel). It will turn itself off when time is arrived. To cancel the timer, continue to press the "TIMER" until all the timer indicator goes off.

MODE

After the fan start-up, press button "MODE". (Press on the remote control or on the control panel). There are three wind types which are general wind(), nature wind() and sleep wind(). Press the MODE button repeatedly until the desired wind type is shown in the display. A bleep sound will be heard when the wind type is changed.

NOTE FOR REMOTE CONTROL BATTERY REPLACEMENT

The keys on remote control have the same functions with the same keys on the control panel of the tower fan.

Battery replacement

Push the locking tab to one side and pull out the battery compartment at the back side of remote control.

Remove the old battery from the remote control and insert a new one of the same type, observing the battery polarity, as illustrated.

Push the battery compartment back into the remote control.

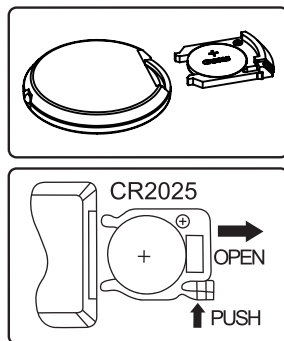

BATTERY WARNING: KEEP OUT OF REACH OF CHILDREN

Swallowing may lead to serious injury or death. If swallowed go straight to a medical emergency room. Dispose of used batteries immediately.

BATTERY WARNING

1. Do not dispose of batteries in fire, batteries may explode or leak.
2. Do not mix old and new batteries.
3. Do not mix alkaline, standard (carbon-zinc) or rechargeable (nickel-cadmium) batteries.
4. Non-rechargeable batteries are not to be recharged.
5. Batteries are to be inserted with the correct polarity.
6. Exhausted batteries are to be removed from the product.
7. The batteries must be removed from the remote controller before it is scrapped and that they are disposed of safely.

Considerate Hint:

- The effective control range is up to about 5 meters and within an angle of 30° of the sensor.
- Avoid any obstacles between the sensor and the remote control.
- Avoid the direct sunlight to affect the operation of the remote control.
- When the battery is not using for a long period of time, remove the battery to avoid battery leakage.
- If battery is leakage, throw it away. Thoroughly clean the battery compartment with a dry cloth.

CLEANING AND MAINTENANCE

Your fan requires little maintenance and contains no user serviceable parts. Do not attempt to dismantle the Fan Motor body yourself. The fan is permanently lubricated and will not require additional lubrication.

Cleaning: Always unplug the fan from the mains outlet before cleaning the appliance. The fan can be cleaned with a soft cloth. Deposition of dust can be removed by using a vacuum cleaner, ensuring that the air vents and grilles remain free from dust to prevent over-heating.

The body of the fan can be cleaned with a damp cloth rinsed hot soapy water. Always remove the plug from the mains outlet before cleaning.

Important: Do not allow water to run into the interior of the fan, as this will cause an electric shock.
DRY THE FAN THOROUGHLY with a dry cloth, check that the fan is completely dry before operating the fan.

Important Safety Instructions

When using electrical appliance, basic precautions should be followed to reduce the risk of fire and personal injury.
(see inside front cover of this leaflet)

CONNECTION TO POWER

Before Switching on make sure that the voltage of your electricity supply is the same as that indicated on the rating plate

MAIN CORD

This appliance may be fitted with a non-rewireable plug.

If it is necessary to change the fuse in a non-rewireable plug the fuse cover must be refitted. If the fuse cover is lost or damaged, the plug must not be used until a replacement is obtained.

It is important that the color of the replacement fuse cover corresponds with the colour marking on the base of the plug.

If the plug has to be changed because it is not suitable for your socket, or becomes damaged, it should be cut off and an appropriate plug fitted following the wiring instructions below.

The plug removed must be disposed of safely as insertion into a 13 A socket is likely to cause an electrical hazard. For your own safety read the following instructions carefully before attempting to connect this unit to mains. The wires in this mains lead are coloured in accordance with the following code:

BLUE = NEUTRAL
BROWN = LIVE

IMPORTANT

As the colours of the wire in the mains lead of this appliance may not correspond with the coloured markings identifying the terminals in your plug, proceed as following:-

The wire which is coloured blue must be connected to the terminal which is marked with the letter N or coloured black.
The wire which is coloured brown must be connected to the terminal which is marked with the letter L or coloured red.
No connection is to be made to the earth terminal of the plug.

If a 13 Amps (BS 1363) plug is used, it must be fitted with a 3 Amp Fuse conforming to BS1362 and be ASTA approved. If in doubt consult a qualified electrician who will be pleased to do this for you.

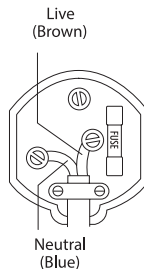

Technical Specifications

Description	Symbol	Value	Unit
Model no.	—	LG38-02AR	—
Voltage	—	230V, 50Hz	VAC
Insulation class	—	Class II	--
Maximum fan flow rate	F	6,53	m ³ /min
Fan power input	P	36,5	W
Service value	SV	0,18	(m ³ /min)W
Off mode power consumption	P _{Off}	--	W
Fan sound power level	L _{WA}	54,68	dB(A)
Maximum air velocity	C	2,28	meters/sec
Seasonal electricity consumption	Q	11,88	kWh/a
Standby power consumption	P _{SB}	0,18	W
Measurement standard for service value	EN 60704-2-7: 1998, EN 60704-1: 2010+A11: 2012 EN 50564: 2011 EN ISO 5801: 2008		
Contact details for obtaining more information	Customer helpline 0345 640 2020		

We apologise for any inconvenience caused by any minor inconsistencies in these instructions, which may occur as a result of product improvements and development.

RECYCLING ELECTRICAL PRODUCTS



You should now recycle your waste electrical goods and in doing so help the environment.

This symbol means an electrical product should not be disposed of with normal household waste. Please ensure it is taken to a suitable facility for disposal when finished with.

Visit www.recycle-more.co.uk, click on “bank locator” and enter your postcode to find your nearest recycling site.

Produced in China and imported
for

Argos Limited,
489-499 Avebury Boulevard,
Milton Keynes, MK9 2NW.



PRODUCT GUARANTEE

This product is guaranteed against manufacturing defects for a period of



Year

This product is guaranteed for twelve months from the date of original purchase. Any defect that arises due to faulty materials or workmanship will either be replaced, refunded or repaired free of charge where possible during this period by the dealer from whom you purchased the unit.

The guarantee is subject to the following provisions:

- The guarantee does not cover accidental damage, misuse, cabinet parts, knobs or consumable items.
- The product must be correctly installed and operated in accordance with the instructions contained in this manual.
- It must be used solely for domestic purpose.
- The guarantee will be rendered invalidated if the product is re-sold or has been damaged by inexperienced repair.
- Specifications are subject to change without notice.
- The manufacturer disclaims any liability for the incidental or consequential damages.
- The guarantee is in addition to, and does not diminish your statutory or legal rights.

Guarantor: Argos Ltd
489 - 499 Avebury Boulevard
Central Milton Keynes
MK9 2NW
www.argos-support.co.uk