

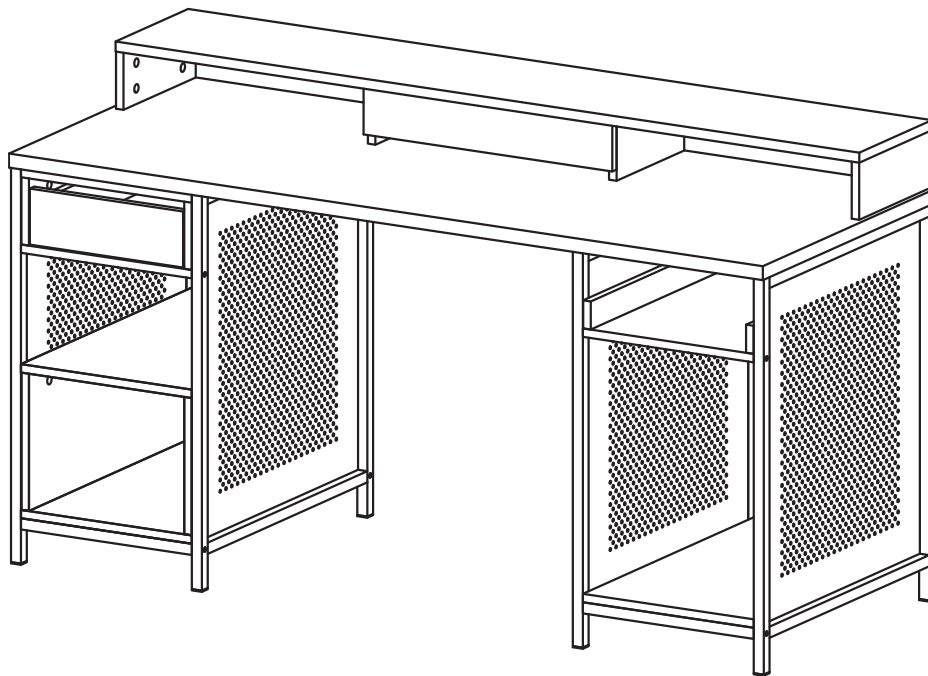

MODULAR GAMING DESK



Spare Parts

 www.argos-support.co.uk

 Help@ClickSpares.co.uk

 0370 112 1928

Customer Support

 0345 640 2020



Safety and Care Advice

Product Details

766/1411 AH MODULAR GAMING DESK OAK AND LIGHT GREY

851/8525 AH MODULAR GAMING DESK OAK AND BLACK

IMPORTANT, RETAIN FOR FUTURE REFERENCE: READ CAREFULLY.

- Keep children and animals away from the work area, small parts could choke if swallowed.

- Make sure you have enough space to layout the parts before starting.

- This product has been constructed to be used in the domestic environment only and not for commercial purposes.

- Assemble the item as close to its final position (in the same room) as possible.

- Assemble on a soft level surface to avoid damaging the unit or your floor.

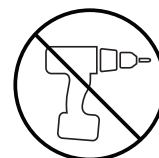

- We do not recommend the use of power drill/drivers for inserting screws as this could damage the unit. Only use hand screwdrivers.

- Parts of the assembly will be easier with 2 people.

- Dispose of all packaging carefully and responsibly.

Care and maintenance

- Only clean using a damp cloth and mild detergent. Do not use abrasive cleaners.

- Use a dry cloth to clean the product, furniture polish is not recommended.

- From time to time check that there are no loose screws, nuts or bolts. If there are please re-tighten.

- This product should not be discarded with household waste. Take to your local authority waste disposal centre.

Additional Guidance

- Assemble all parts and bolts loosely during assembly, only once the product is complete should you fully tighten the bolts.

- Regularly check and ensure that all bolts and fittings are tightened properly.

- Maximum user weight 50 kgs

- This product is compliant EN12521.

Sainsbury's Argos is a trading name of both: Argos Limited, Registered office: 489-499 Avebury Boulevard, Milton Keynes, United Kingdom, MK9 2NW, registered number: 01081551 (England and Wales); and Sainsbury's Supermarkets Limited, Registered office: 33 Holborn, London, EC1N 2HT, registered number: 03261722 (England and Wales). Both companies are subsidiaries of J Sainsbury's plc.

Fittings (Shown to scale)

Bag 1

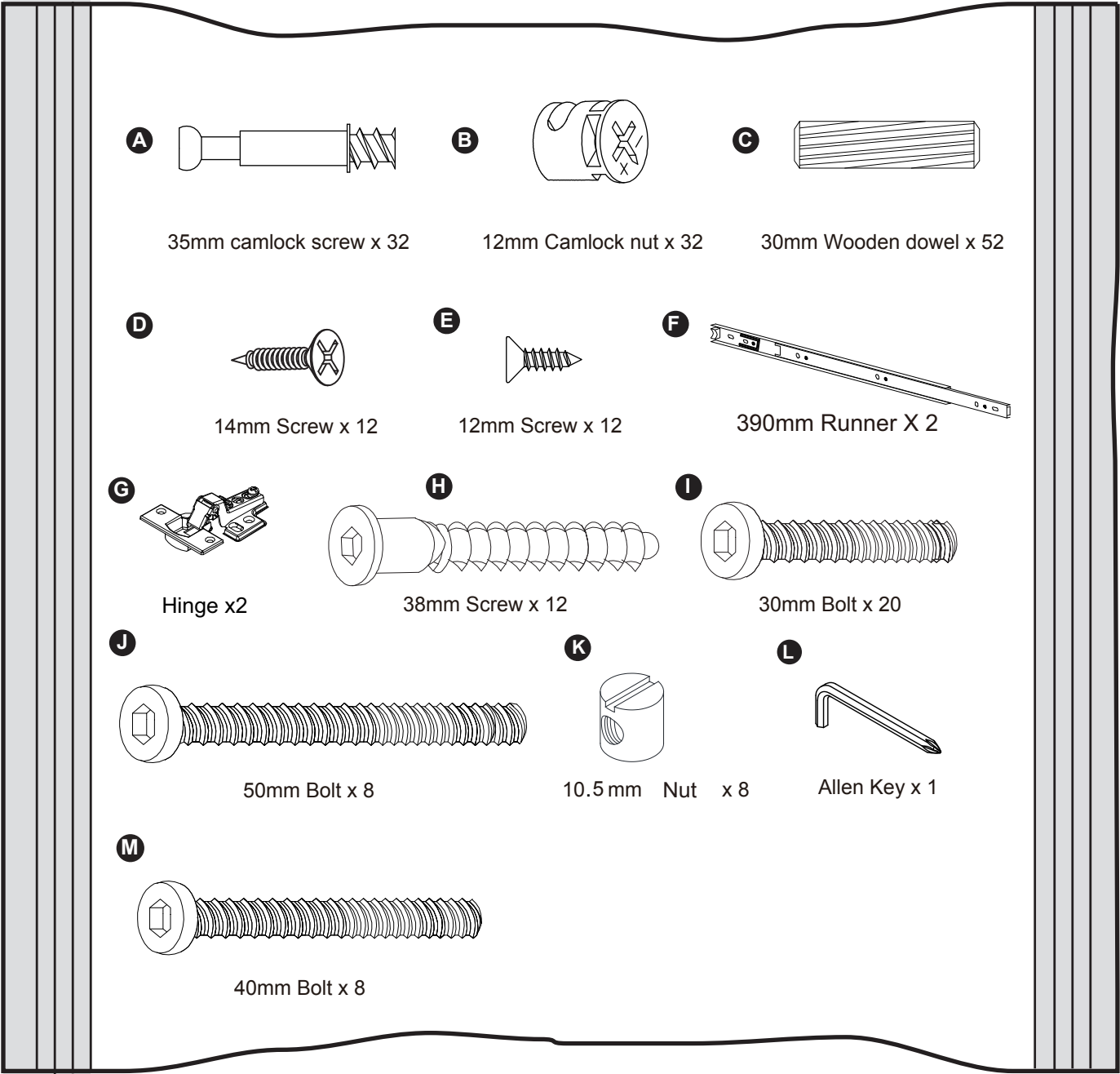

Tools required

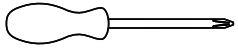

Phillips screwdriver
(small & medium)

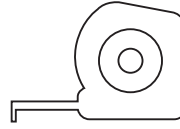

Ruler/tape
measure

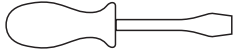

Phillips screwdriver
(small & medium)

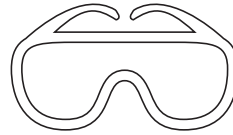

Eye protection
(when using a
hammer or glue)

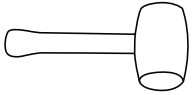

Rubber hammer

Panels

- 1 Table Top x 1
(1500 x 600 mm)



- 2 Hutch Top x 1
(1480 x 250 mm)

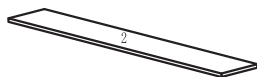

- 3 Side Panel x 2
(249 x 102 mm)



- 4 Middle Board x 2
(243 x 102 mm)



- 5 Back Board x 1
(480 x 102 mm)

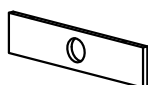

- 6 Door x 1
(510 x 83 mm)

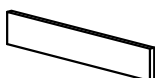

- 7 Bottom Board x 2
(590 x 340 mm)



- 8 Shelf Sideboard L x 1
(590 x 50 mm)



- 9 Shelf Sideboard x 1
(590 x 50 mm)



- 10 Shelf Backboard x 1
(309 x 50 mm)



- 11 Bottom Board x 1
(590 x 340 mm)

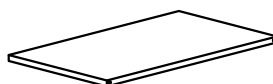

- 12 Cube Topboard x 2
(590 x 340 mm)



- 13 Drawer Leftboard x 1
(590 x 120 mm)



- 14 Drawer Rightboard x 1
(590 x 120 mm)



- 15 Drawer Back x 1
(309 x 120 mm)



- 16 Drawer Front x 1
(305 x 100 mm)



- 17 Drawer Leftboard x 1
(400 x 82 mm)



- 18 Drawer Rightboard x 1
(400 x 82 mm)



- 19 Drawer Back x 1
(259 x 82 mm)



- 20 Drawer Bottom x 1
(395 x 268 mm)



- 21 Cube Leftboard x 1
(590 x 245 mm)

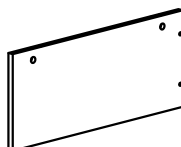

- 22 Cube Rightboard x 1
(590 x 245 mm)

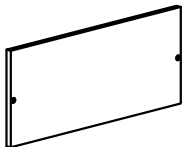

- 23 Cube Backboard x 1
(309 x 245 mm)

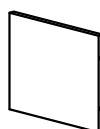

- 24 Cube Bottomboard x 1
(590 x 340 mm)



- 25 Cross Bar x 4
(340 x 20 mm)

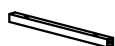

- 26 Leg x 4
(590 x 705 mm)

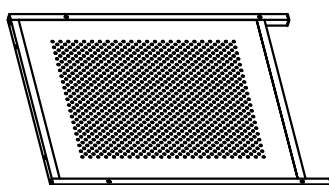

A 35mm camlock screw x 32

B 12mm Camlock nut x 32

C 30mm Wooden dowel x 52

D 14mm Screw x 12

E 12mm Screw x 12

F 390mm Runner X 2

G Hinge x 2

H 38mm Screw x 12

I 30mm Bolt x 20

J 50mm Bolt x 8

K 105mm Nut x 8

L Allen Key x 1

M 40mm Bolt x 8

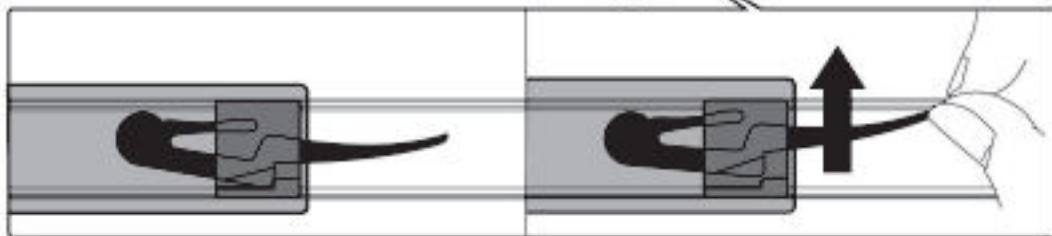

F1

390mm Runner X 2

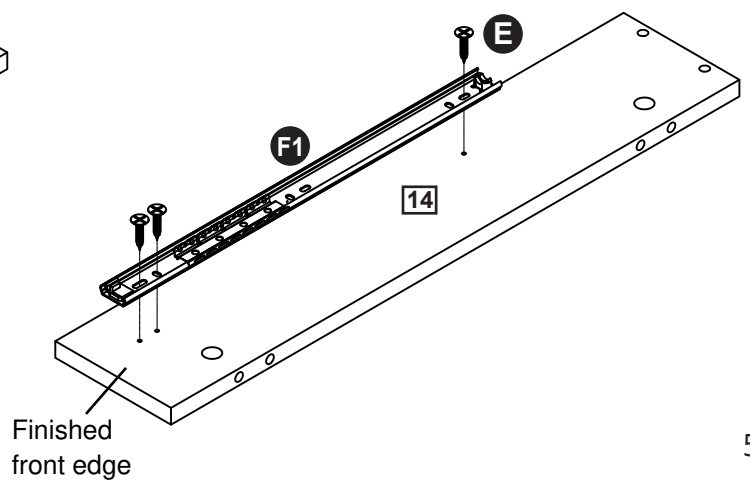
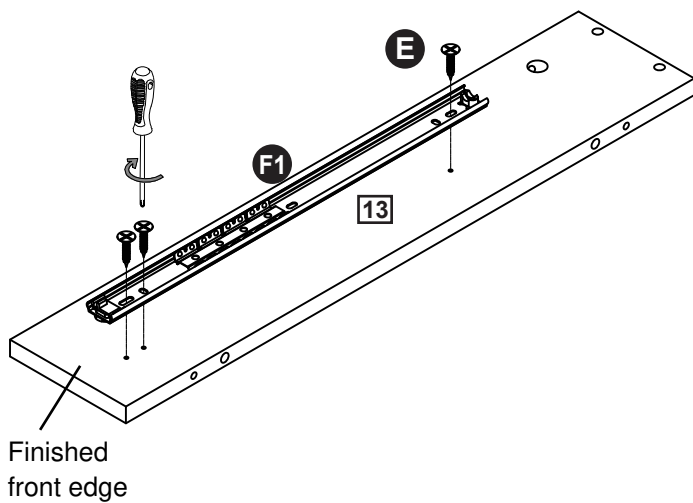
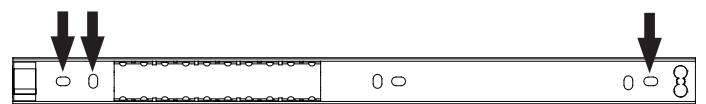
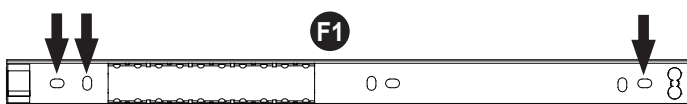
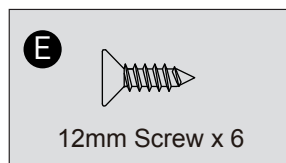

3

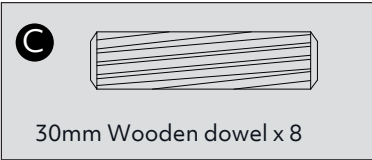
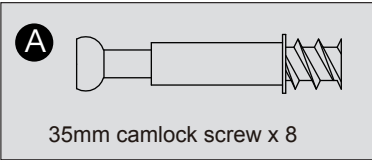

X2

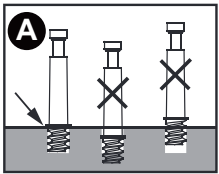
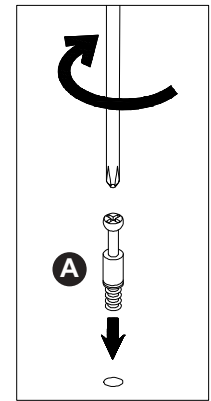
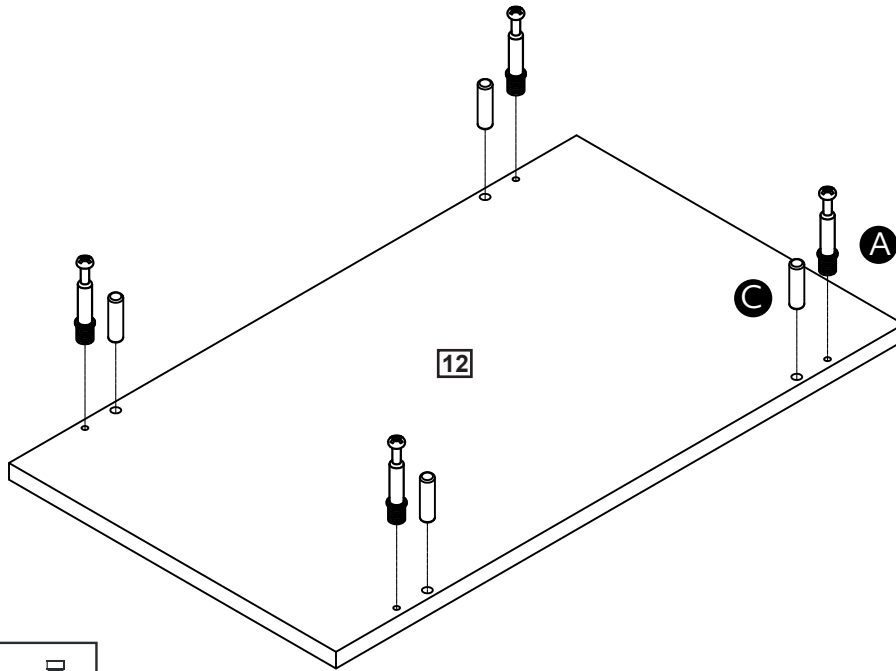

4

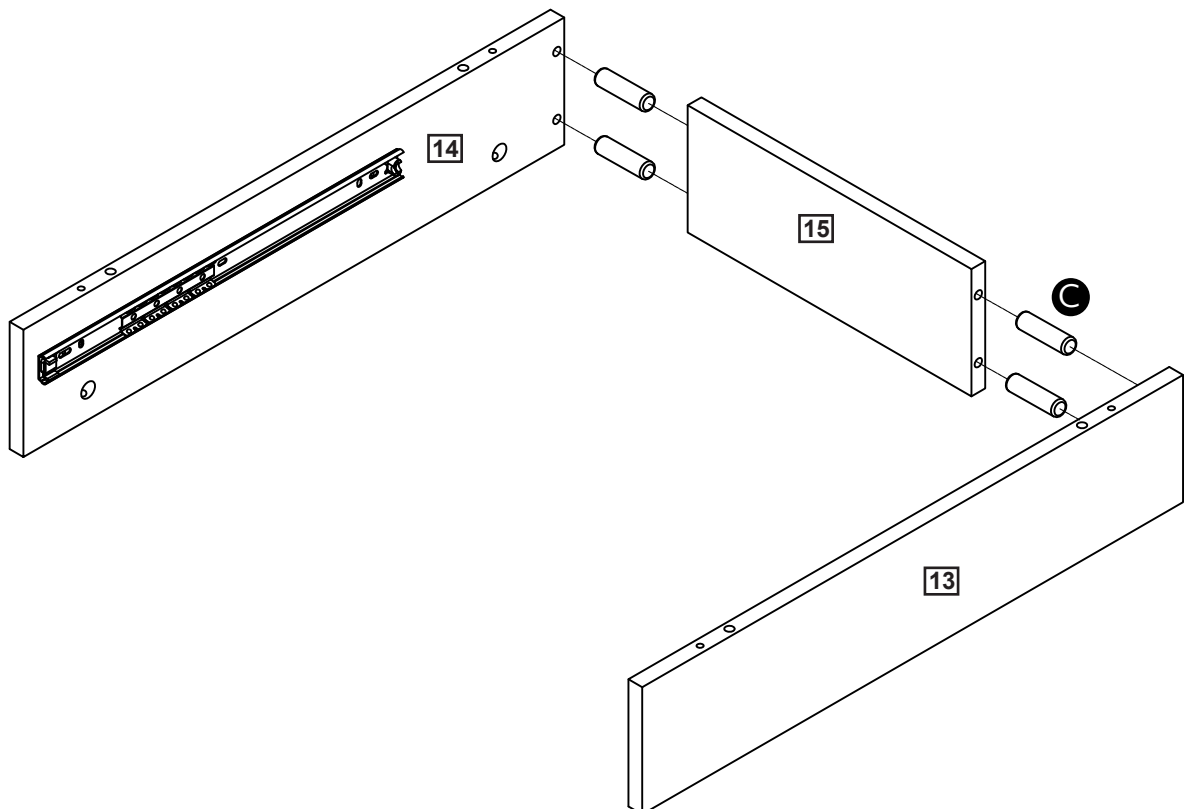
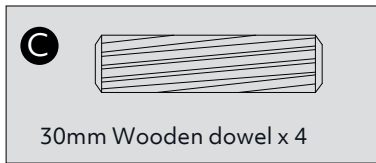

5

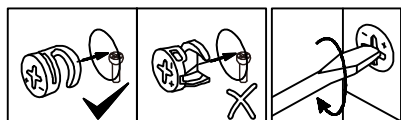
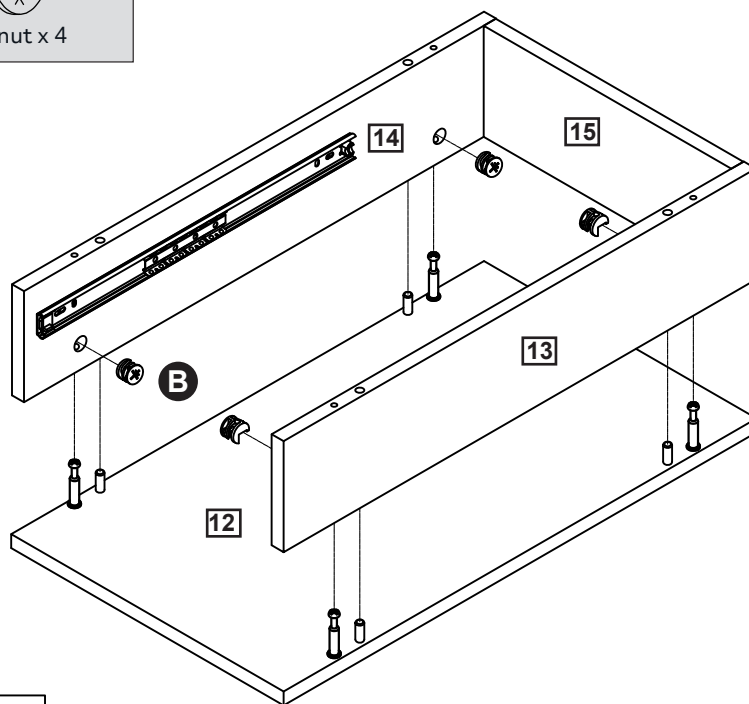
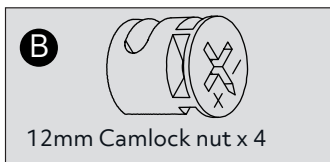

6

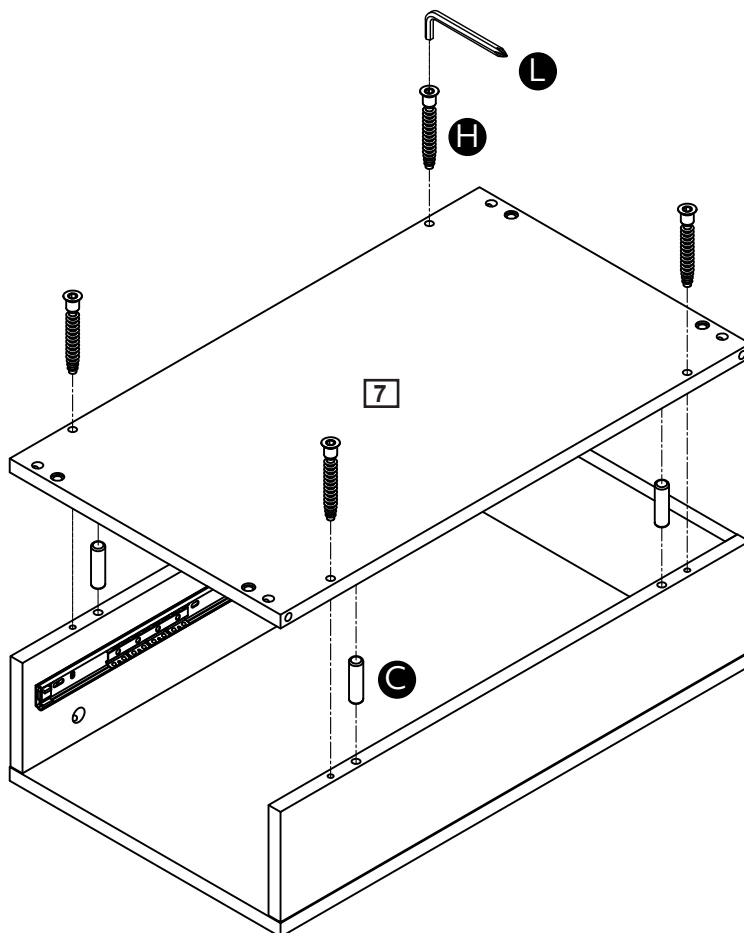
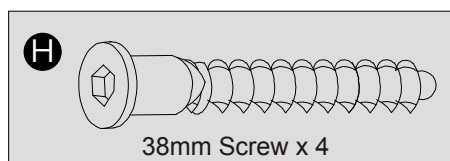
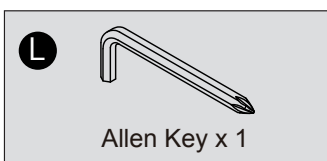
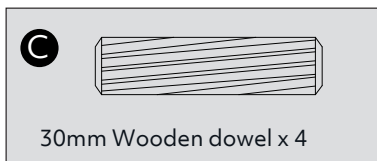

7

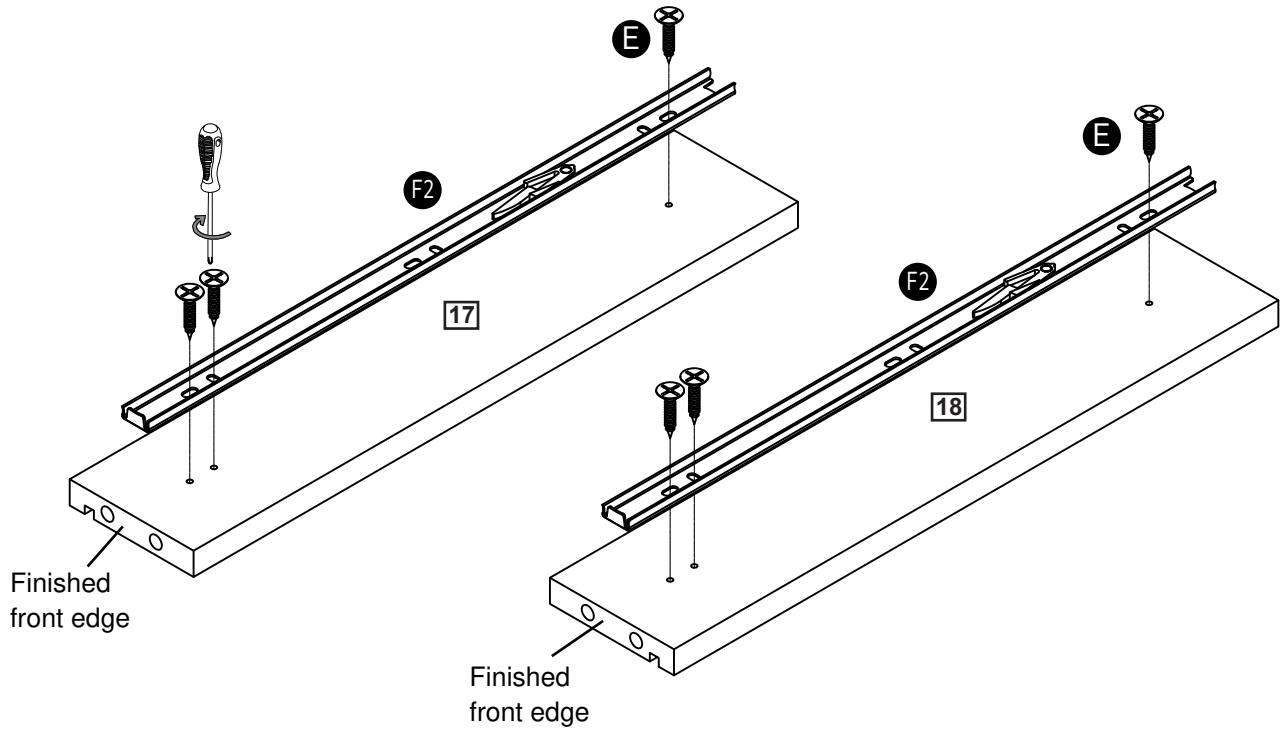
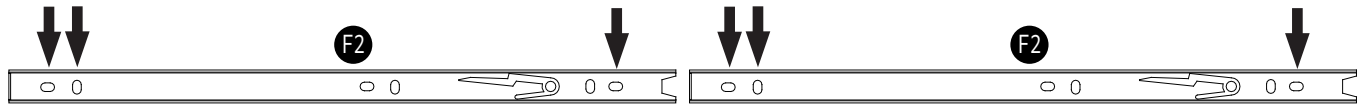
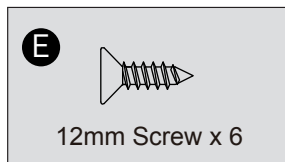
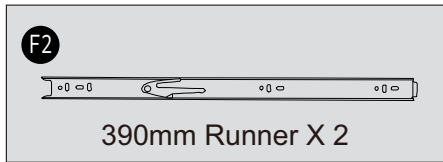

8

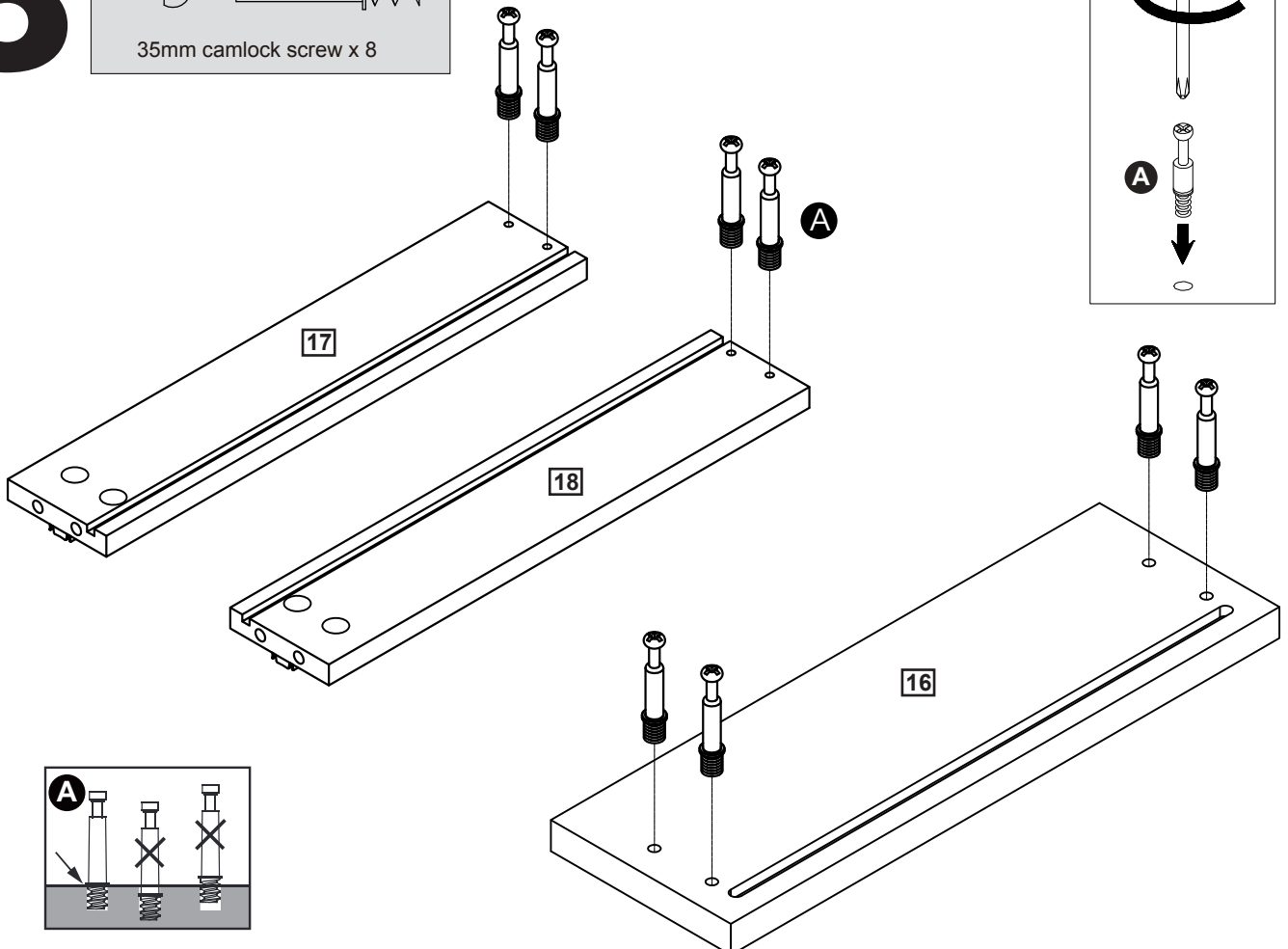
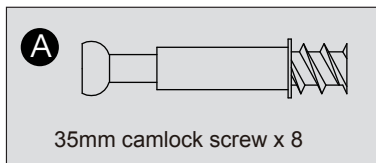

9

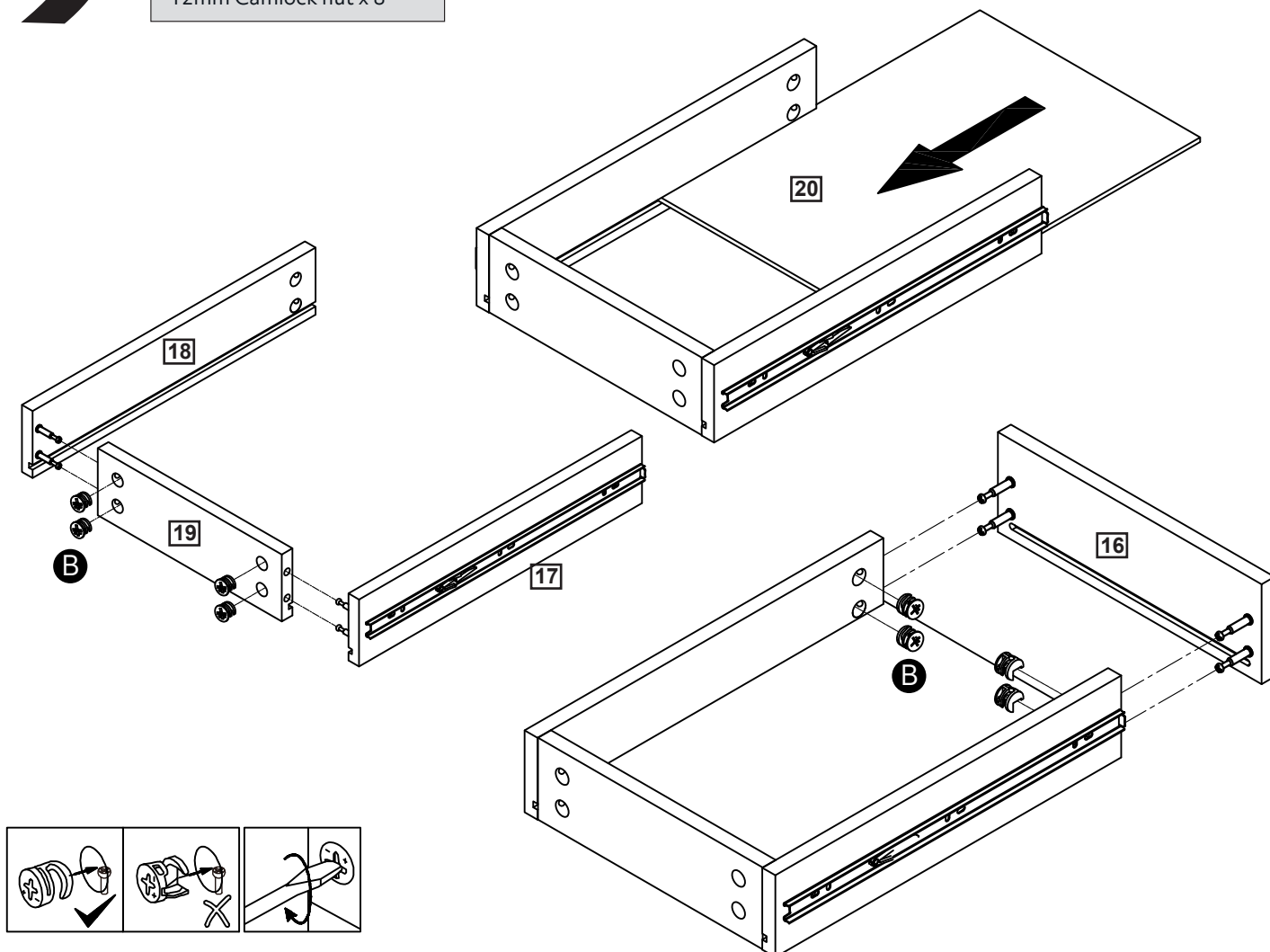
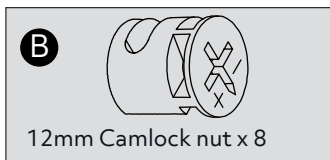

10

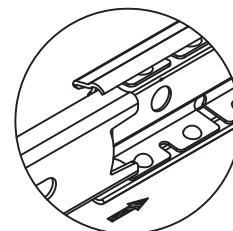
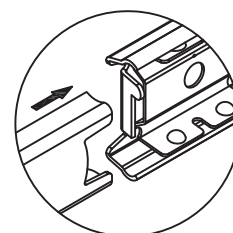
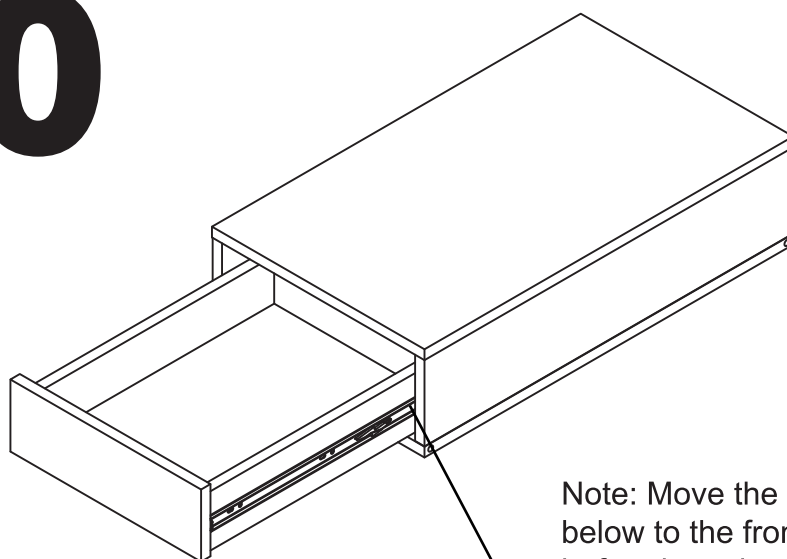

Note: Move the sliding part as shown below to the front end on both sides before inserting the drawer. This will assist for easier assembly.

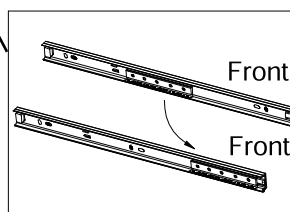

11

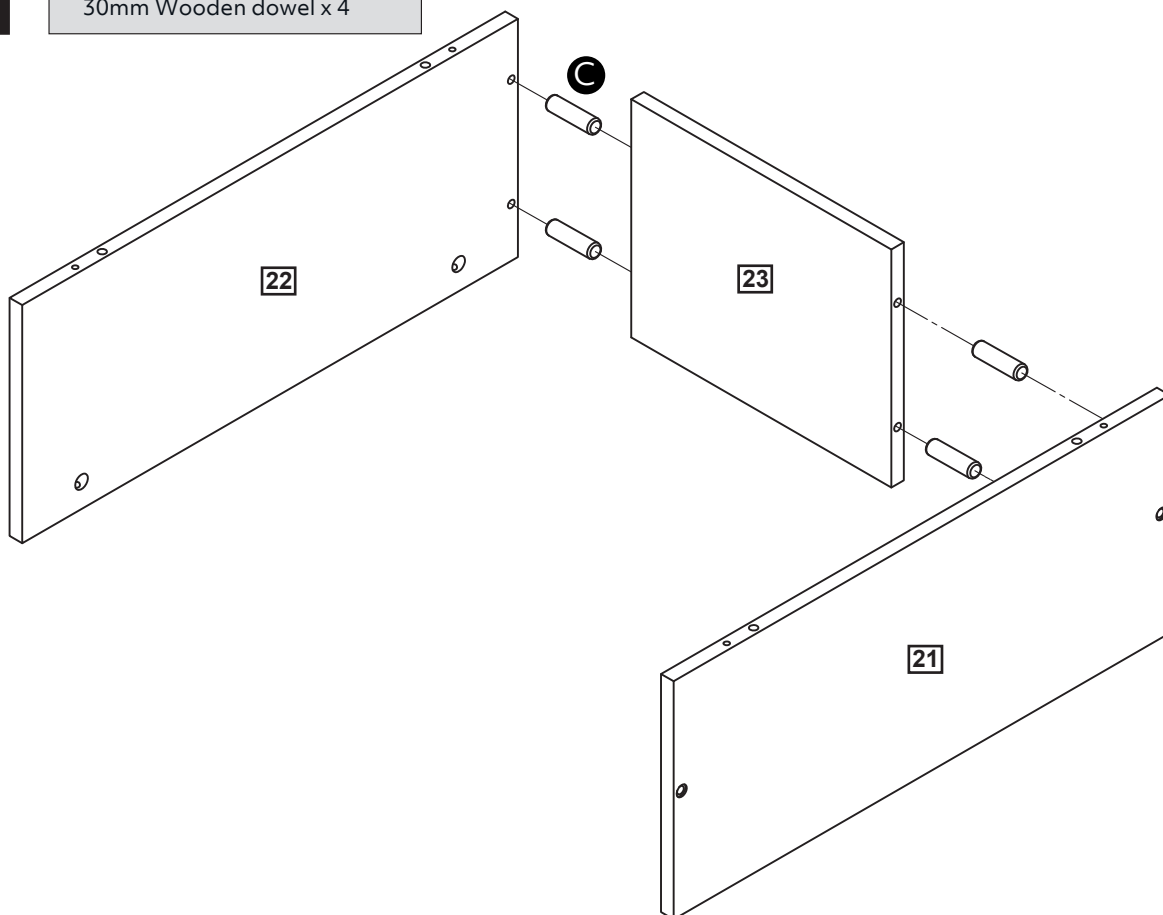
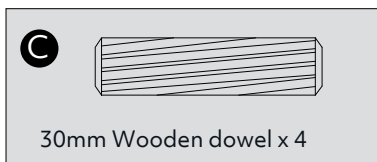

12

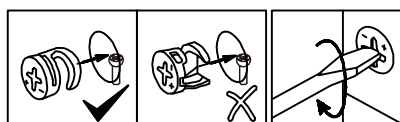
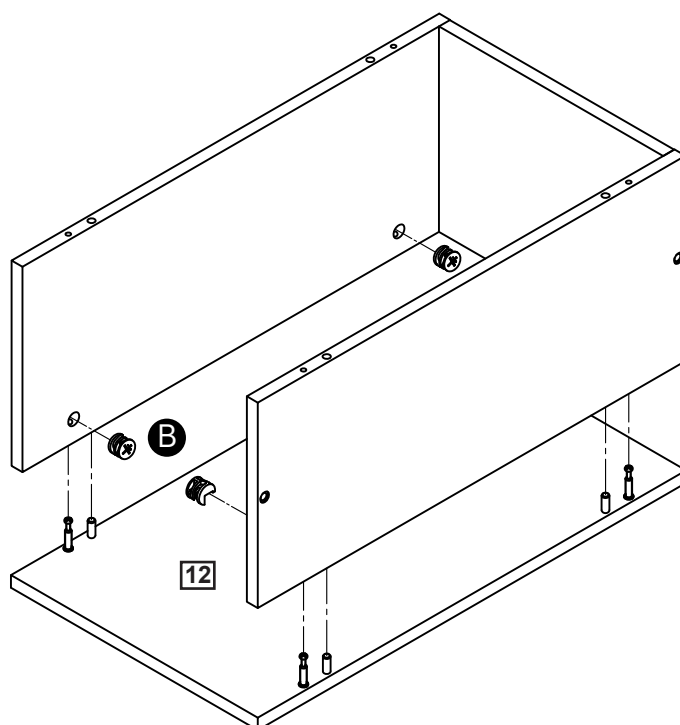
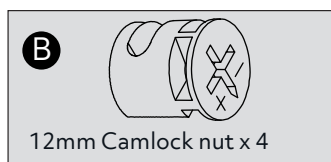

13

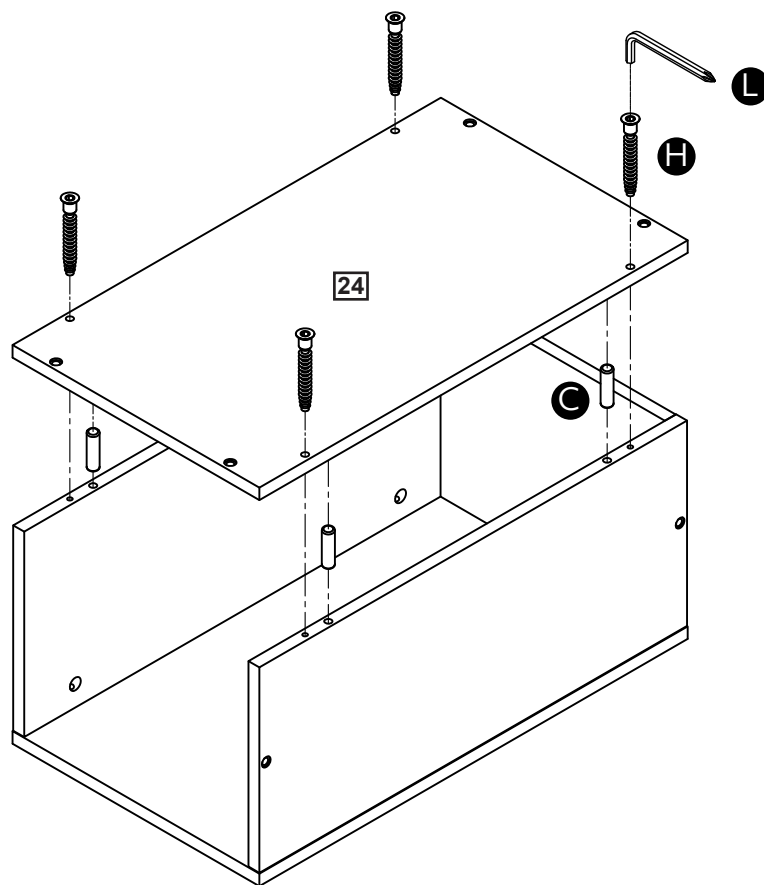
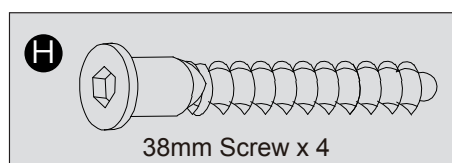
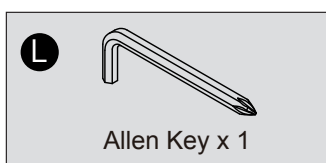
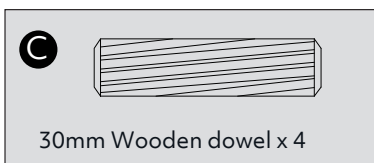

14

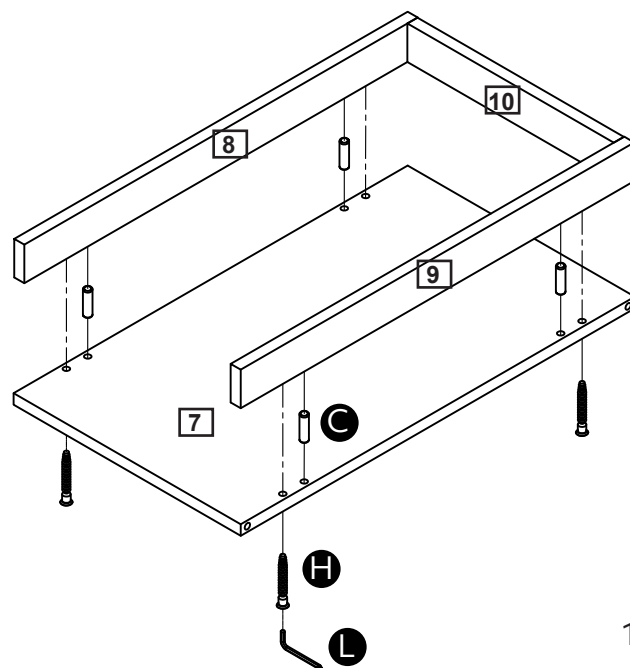
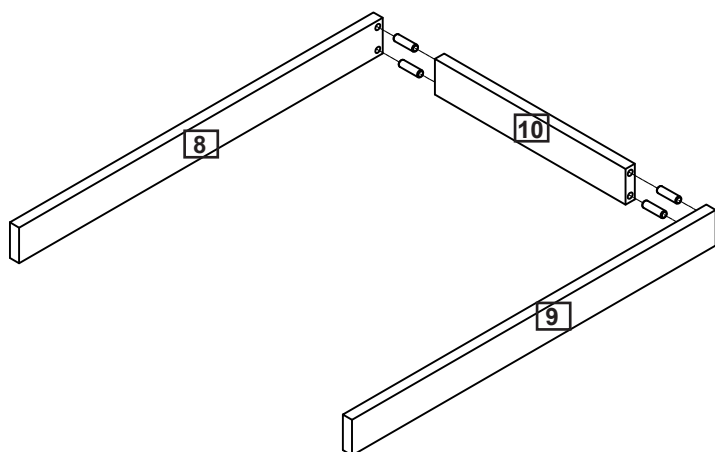
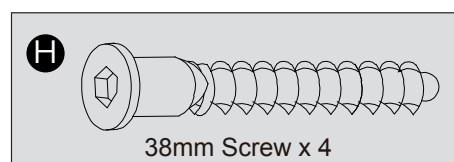
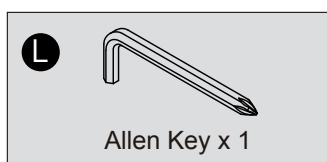
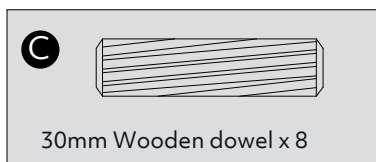

15

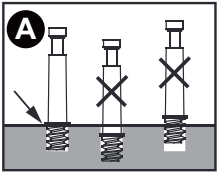
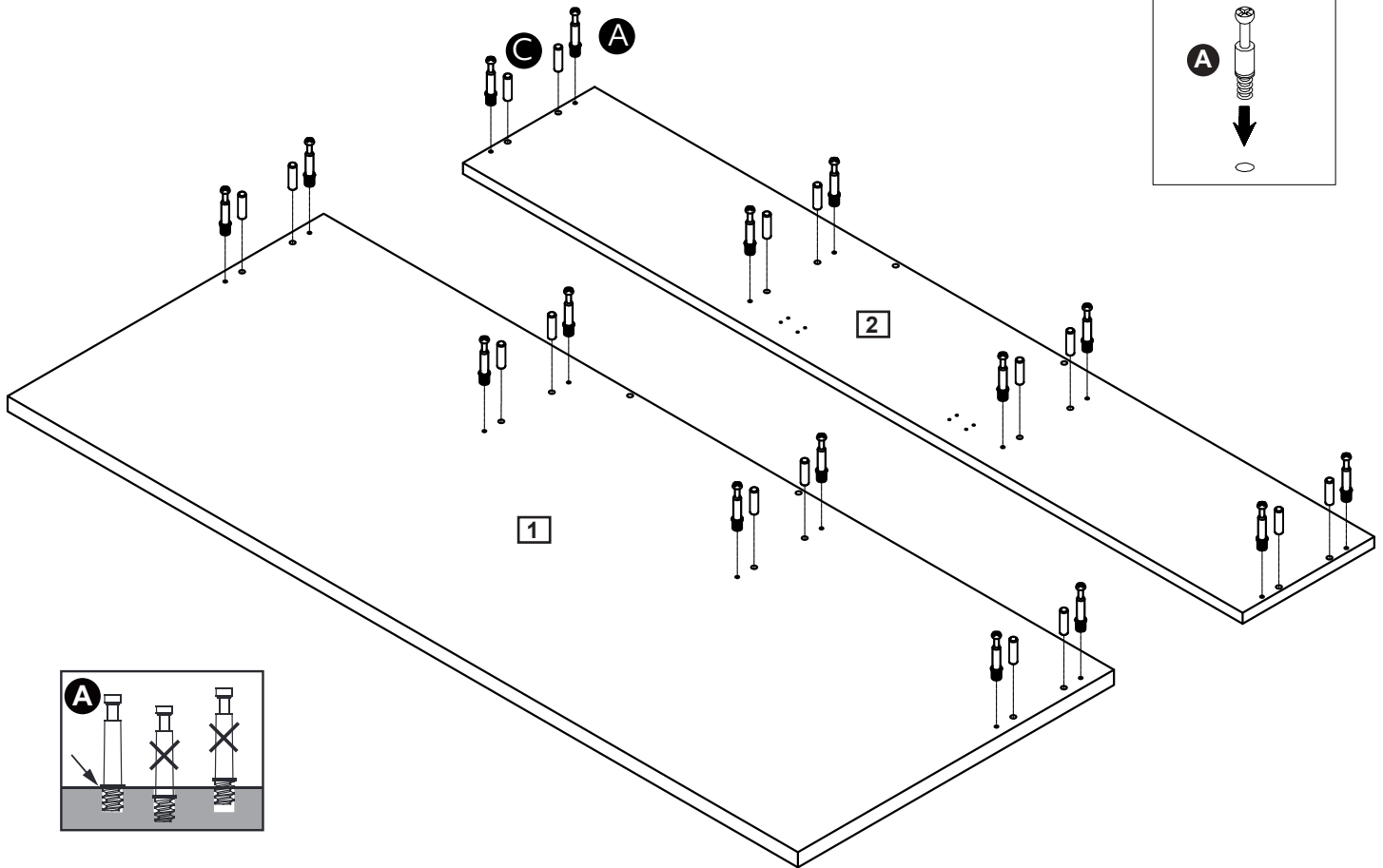
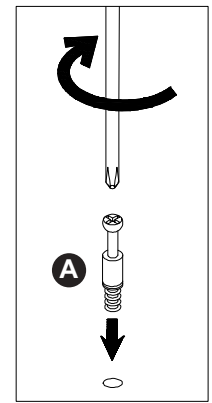
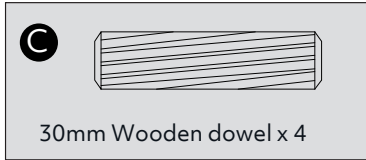
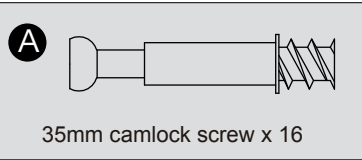

16

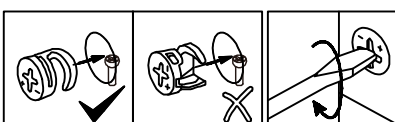
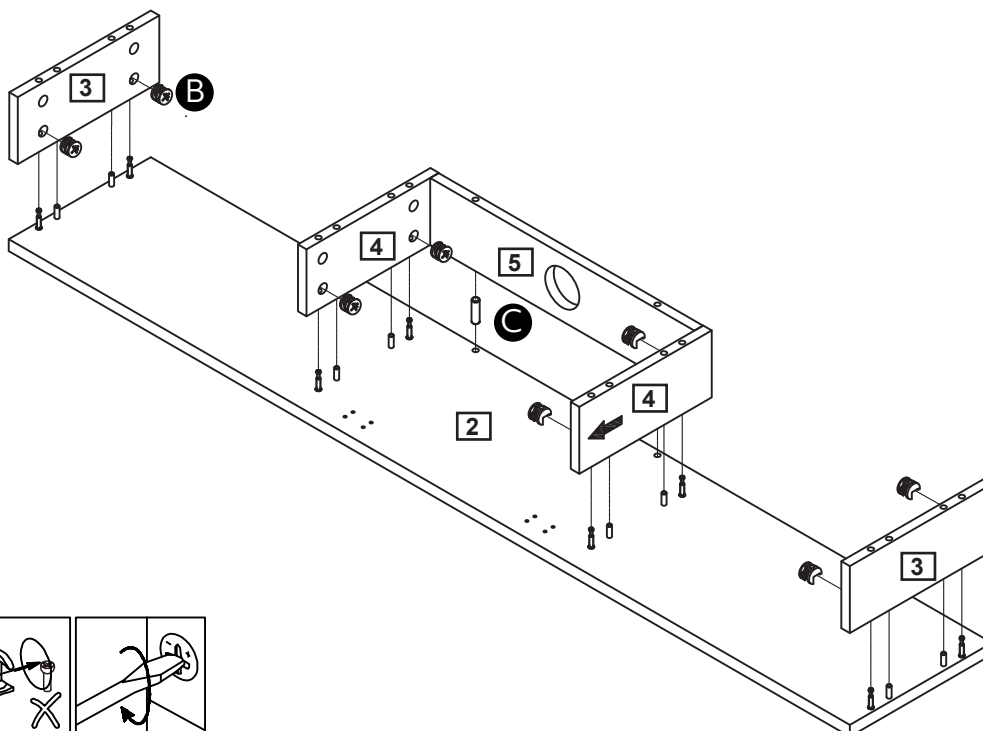
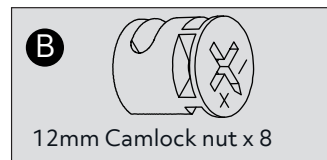
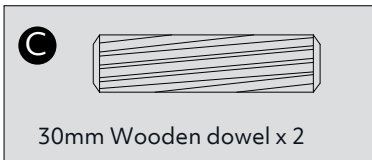

17

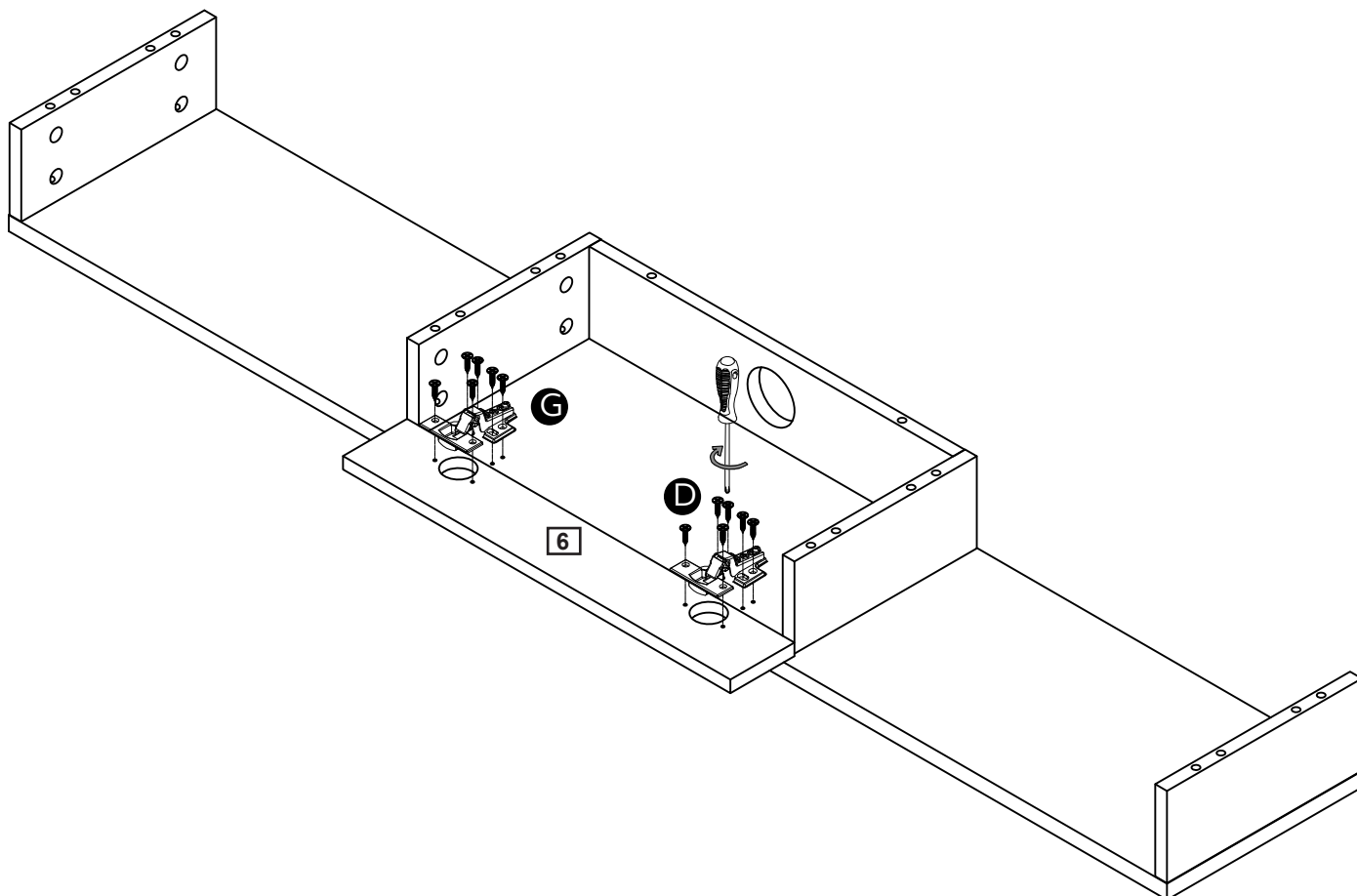
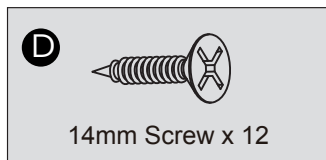

18

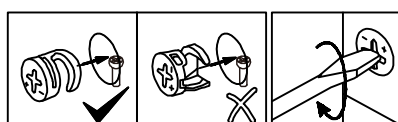
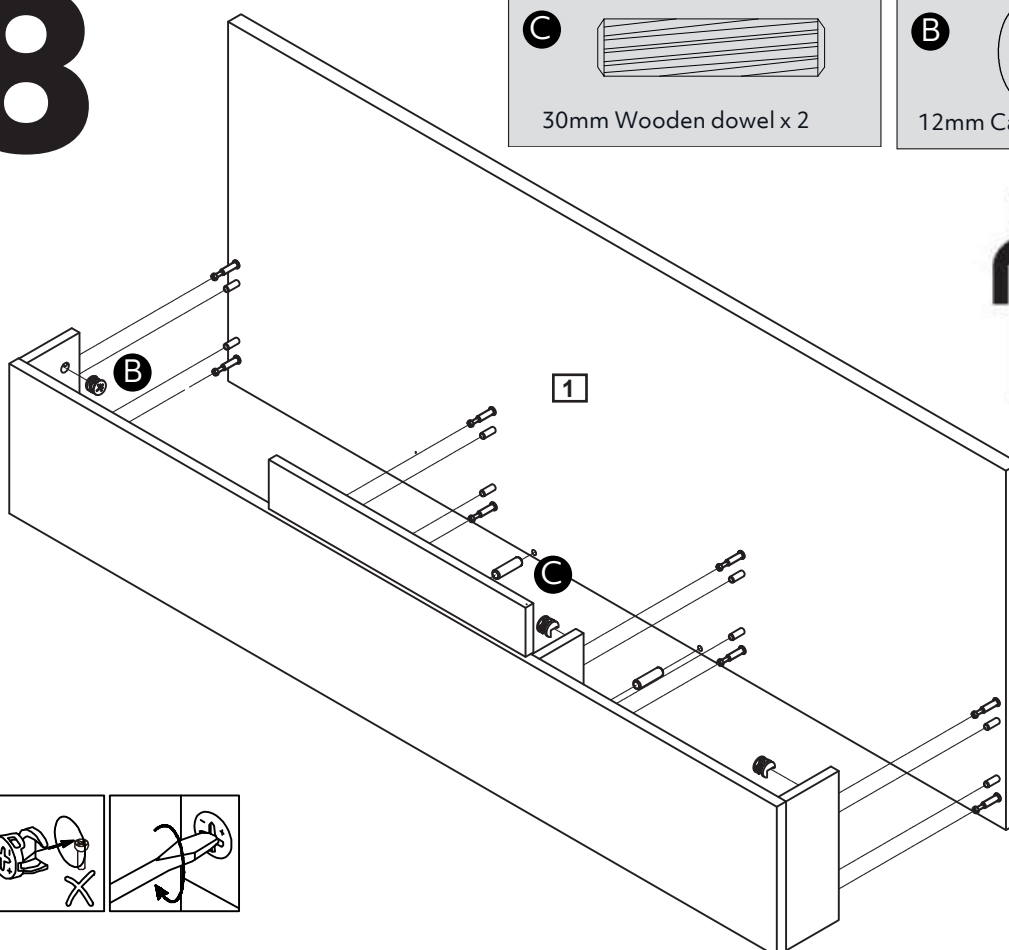
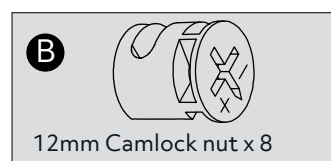
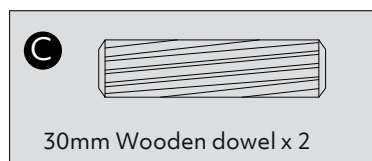

19

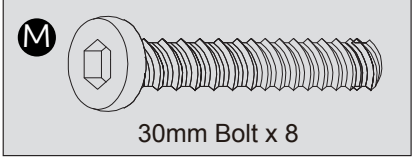

X2

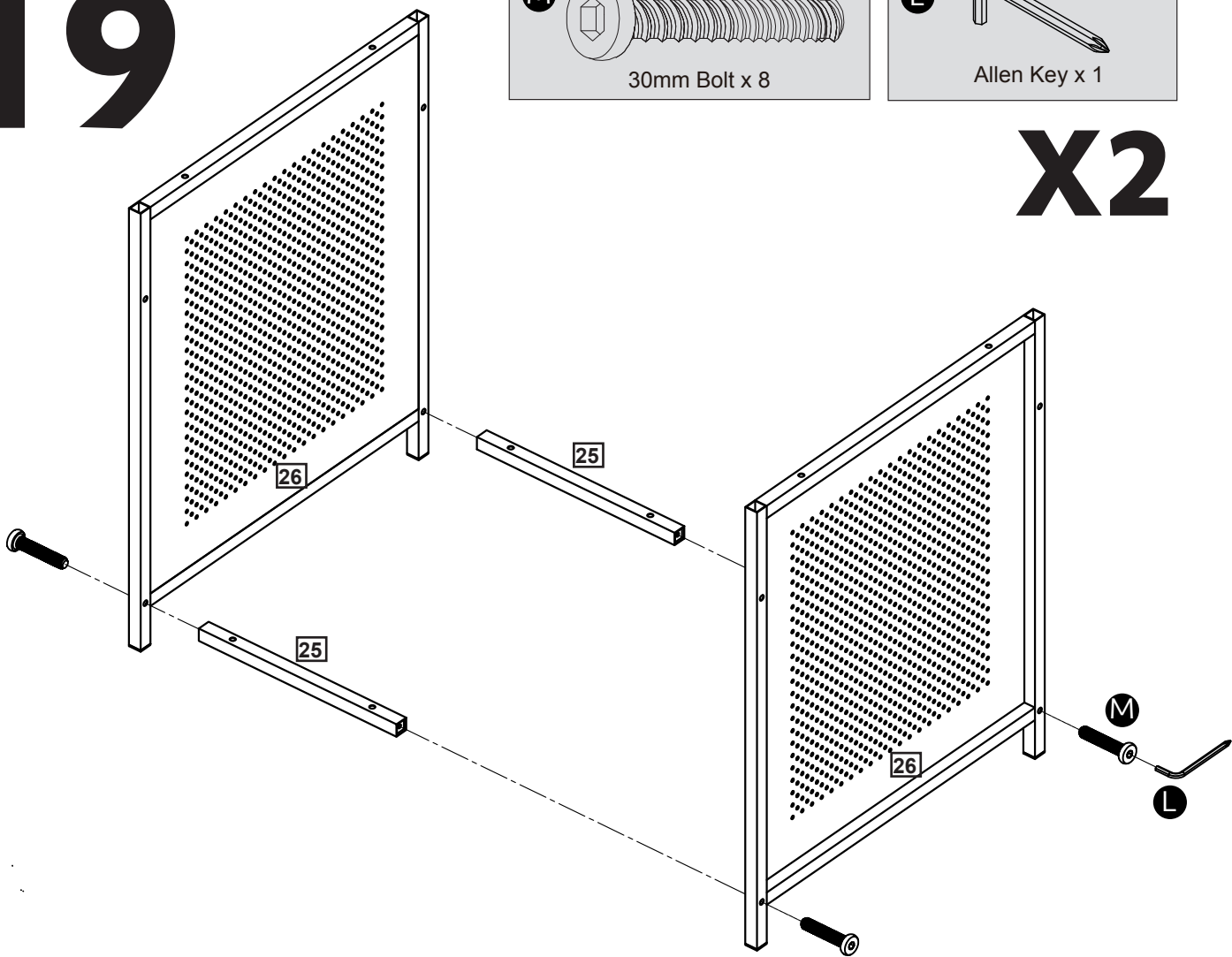

20

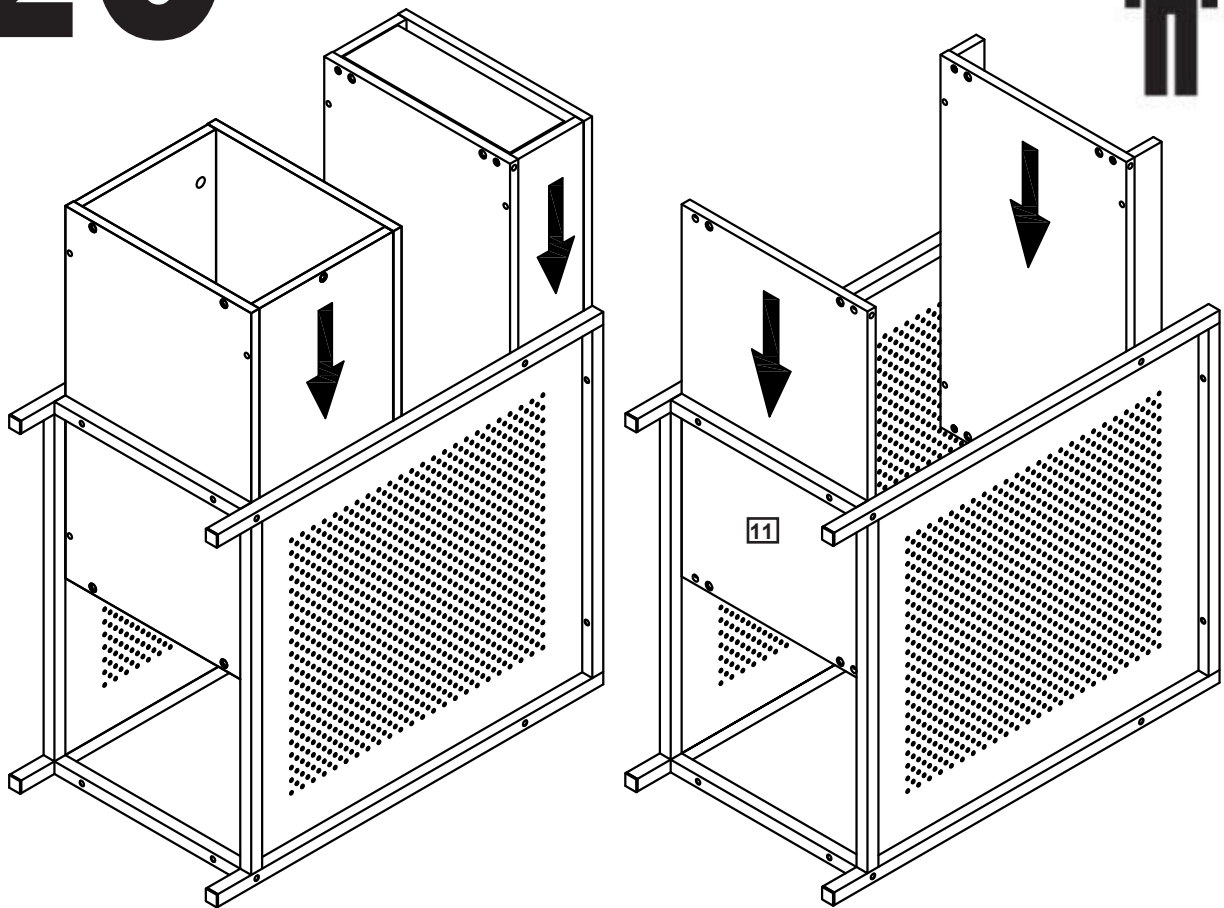
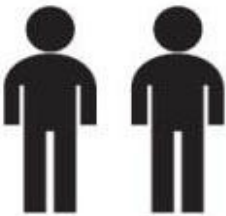

21

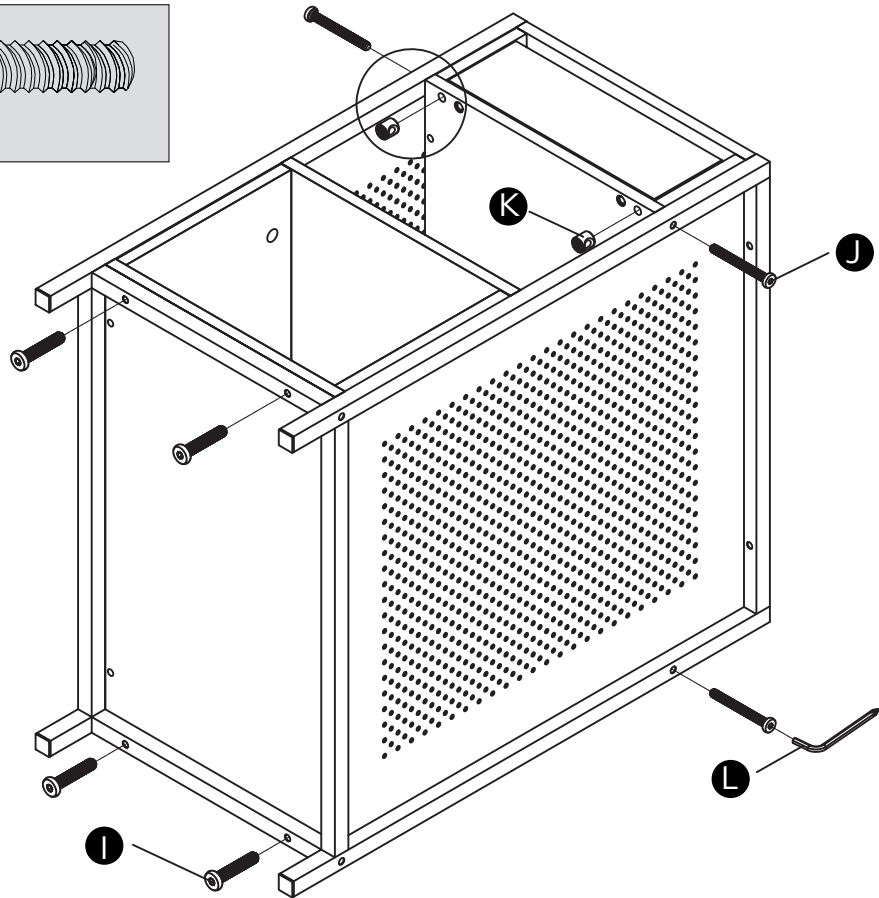
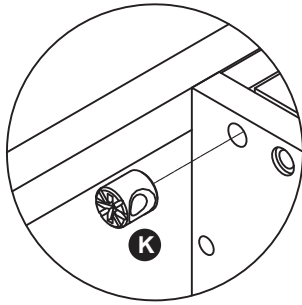
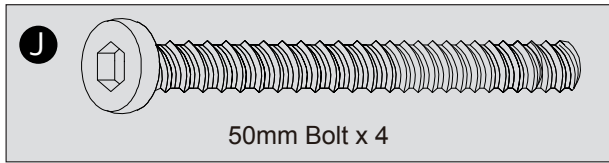
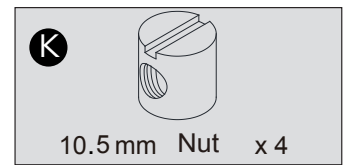
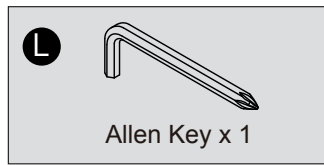
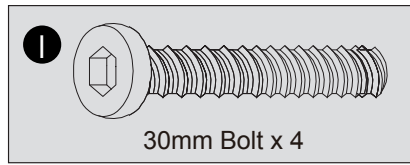

22

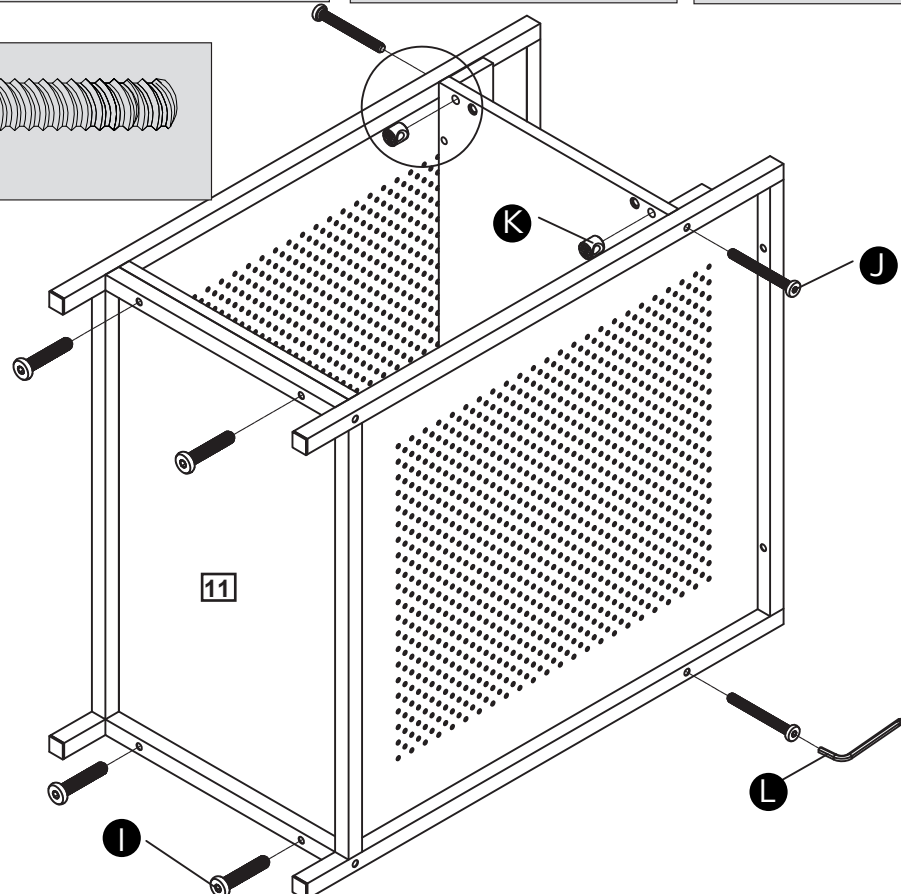
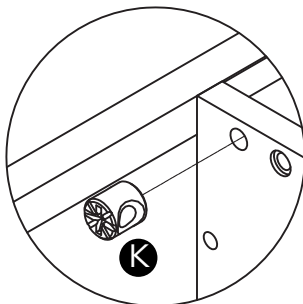
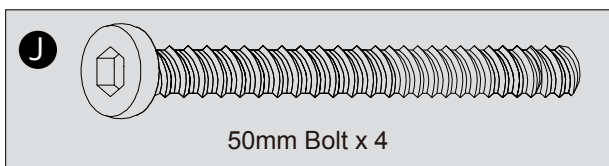
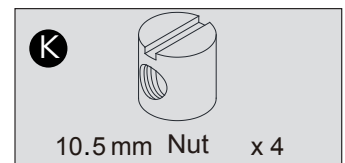
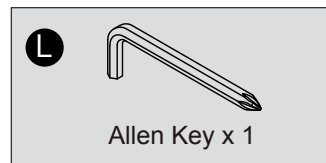
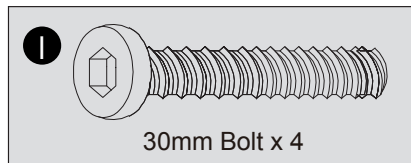

23

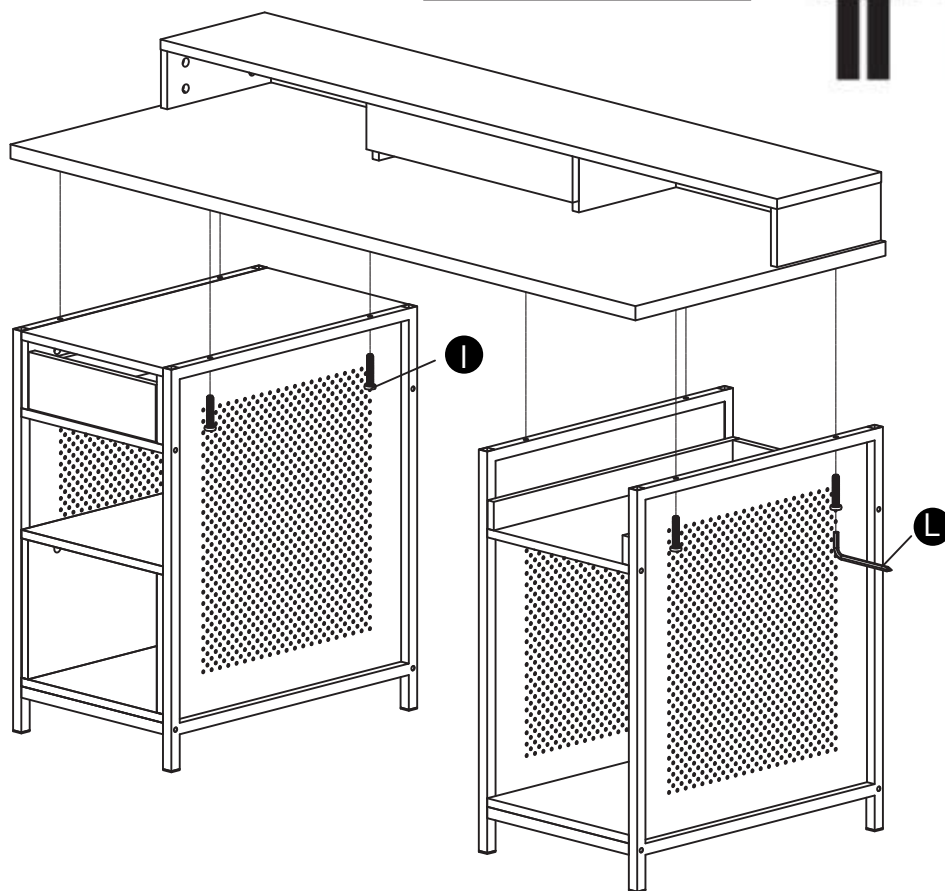
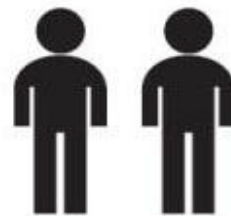
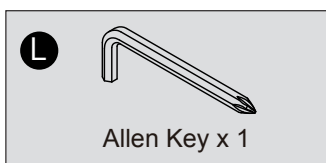
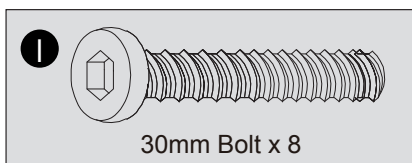

24

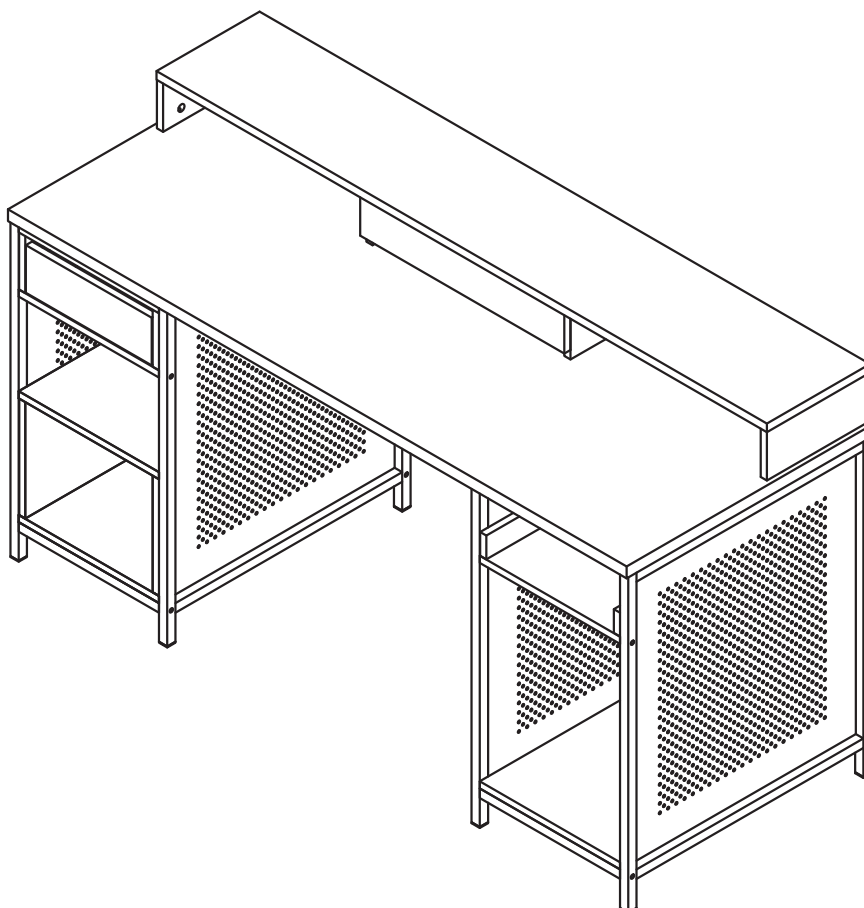

Assembly is complete

25 More Options

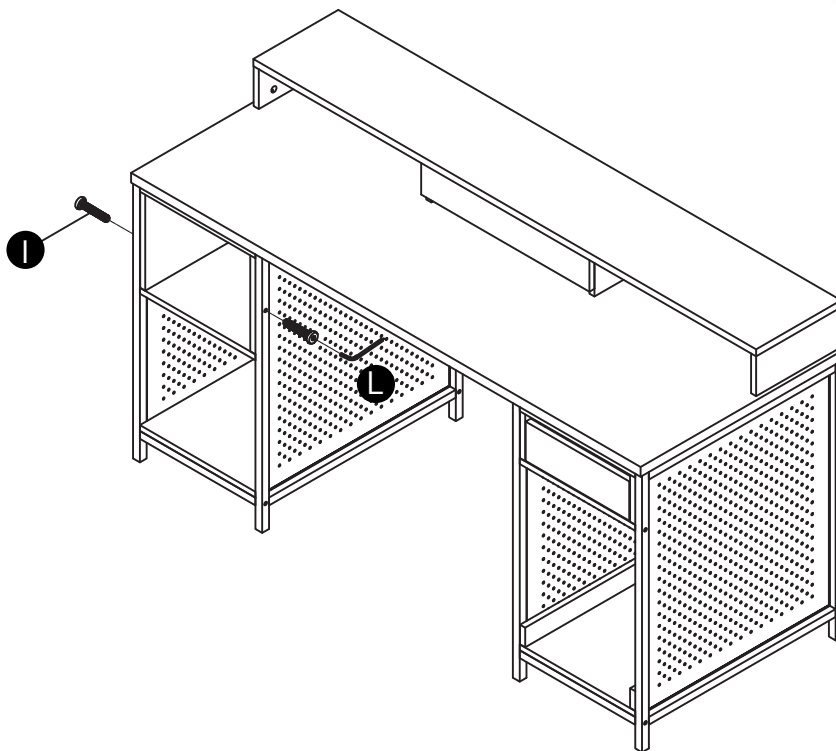
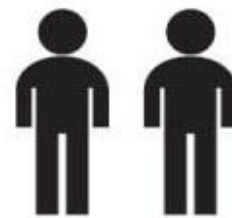
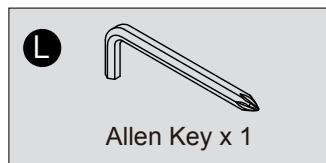
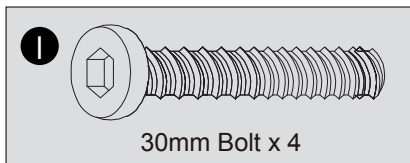

26

